

M37

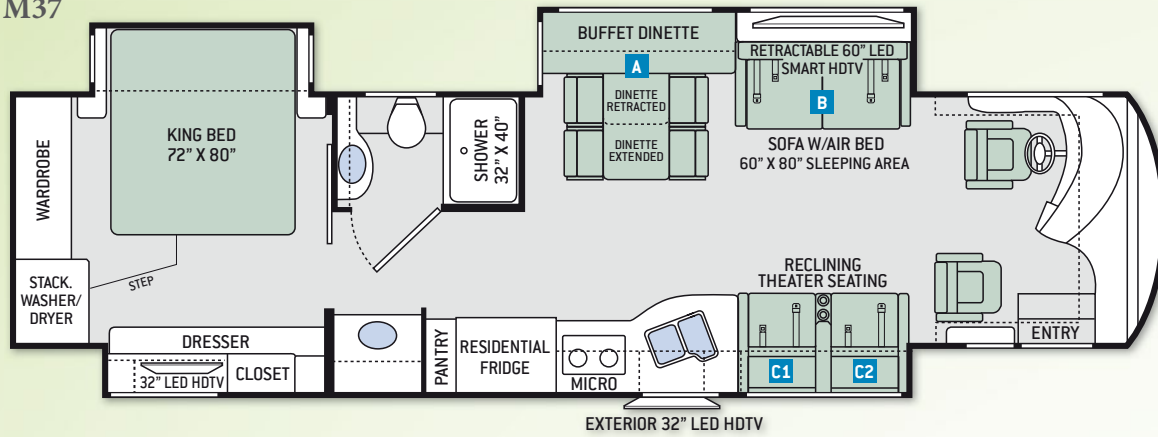

A40

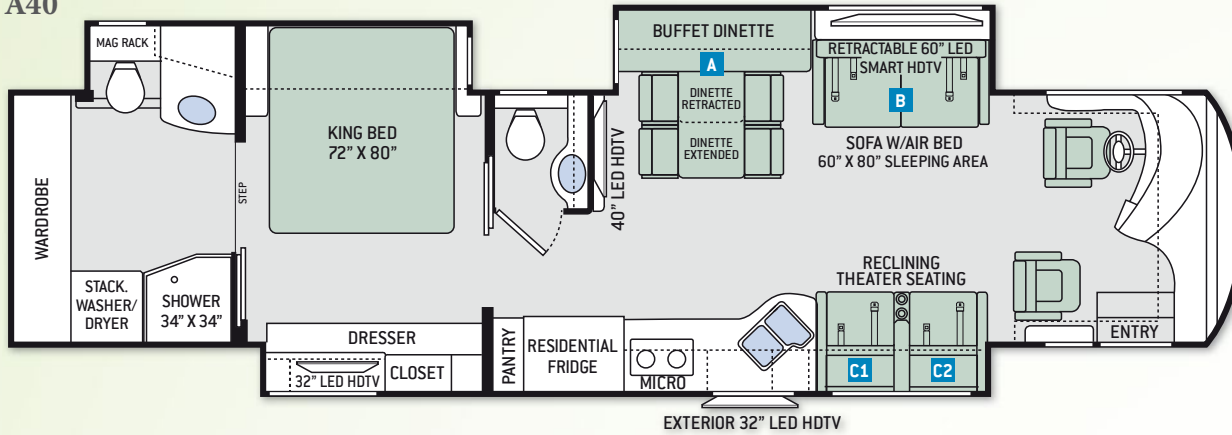

# VENETIAN

**OPTIONS** \*\*SOFA w/AIR BED ONLY AVAILABLE WHEN EURO RECLINER w/DESKTOP & FIREPLACE IS OPTIONED

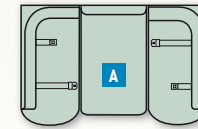

OPTIONAL DREAM DINETTE  
48" X 74" SLEEPING AREA

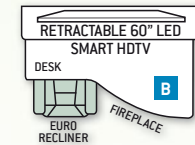

OPTIONAL EURO RECLINER  
w/DESKTOP & FIREPLACE

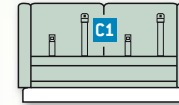

OPTIONAL JACK-KNIFE SOFA  
40" X 60" SLEEPING AREA

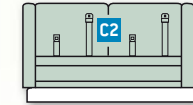

OPTIONAL SOFA w/AIR BED\*\*  
60" X 80" SLEEPING AREA

**FLOOR PLAN**

	M37	A40
Chassis	Freightliner XC-R	Freightliner XC-R
Gross Vehicle (GVWR)	38,320	38,320
Gross Combined (GCWR)	48,320	48,320
Wheel Base	242"	272"
Exterior Length (w/out ladder)	38'-5"	40'-11"
Exterior Height (w/AC)	12'-7"	12'-7"
Exterior Width (w/out mirrors)	101"	101"
Interior Height	85"	85"
Awning Size	16'-5"	16'-5"
Fuel (gal)	150	150
LPG (lbs)	104	104
Fresh/Waste/Gray Water (gal)	91 / 51 / 51	91 / 51 / 51
Water Heater (gal)	10	10
Furnace (BTUs)	(2) 20,000	(1) 20,000 & (1) 25,000
Exterior Storage Capacity (cu. ft.)	185	225



CASABLANCA FULL-BODY PAINT



GOLD COAST FULL-BODY PAINT



DYNASTY FULL-BODY PAINT



TRADE WINDS FULL-BODY PAINT



## CONSTRUCTION & EXTERIOR

- Freightliner® XC-R Raised Rail Chassis
- Cummins® ISL Engine with 380HP & 1,150 lb.-ft. Torque (M37)
- Cummins® ISL Engine with 400HP & 1,250 lb.-ft. Torque (A40)
- 6-Speed Allison MH-3000 Automatic Transmission
- Air-Ride Suspension
- I-Beam Front Axle with 55° Wheel Cut
- Exhaust Brake
- Sachs® Shock Absorbers
- Dual Fuel Fills
- One-Piece Fiberglass Front & Rear Caps
- Invisible Bra
- One-Piece Tinted Windshield
- Full-Body Paint Package with Gel-Coat Sidewalls
- Automatic Leveling Jacks with Touchpad Controls
- Locking Side-Hinged Compartment Doors
- Full Basement Pass-Through Storage
- Easy Slide Storage Tray
- Power Entry Door & Patio Awnings with Integrated LED Lighting
- Slideout Topper Awnings
- Roof Ladder
- Two (2) Patio Lights
- Frameless Dual Pane Windows
- Outside Shower

## AUTOMOTIVE & COCKPIT

- 10" Touchscreen AM/FM Dash Radio with CD/DVD Player, Bluetooth® & Back-Up Monitor
- Chrome Heated/Power Mirrors with Integrated Side View Cameras
- Push Button Start
- Leatherette Reclining/Swivel Captain's Chairs with 6-Way Power Adjustment
- Driver & Passenger Overhead Storage Cabinetry
- VIP Smart Wheel
- Cruise Control
- Air Horns
- Fog Lights
- Electric Windshield Solar & Privacy Shades

- Manual Side Solar & Privacy Shades
- Solid Surface Entry Steps
- Electric Step Cover
- 10,000-lb. Trailer Hitch with 7-pin Round Connector
- 275/80R 22.5" Radial Tires with Aluminum Wheels

## INTERIOR

- Porcelain Tile Throughout
- Ceiling Ducted Whisper Air™ Central Cooling System
- High-Gloss Glazed Cabinetry with Raised Panel Hardwood Cabinet Doors & Nickel Finish Hardware
- Hardwood Veneer in Select Areas
- LED Ceiling Lights
- Window Solar & Privacy Shades
- Driver's Side Leatherette Sofa with Air Bed
- Leatherette Theater Seating with Footrest
- Buffet Dinette with Four (4) Chairs – Includes Two (2) Folding

## INTERIOR OPTIONS

- Euro Recliner w/Desktop & Fireplace
- Passenger's Side Leatherette Sofa with Air Bed\*\*
- Passenger's Side Leatherette Jack-Knife Sofa
- Leatherette Dream Dinette® Booth

## KITCHEN

- 21 cu. ft. Stainless Steel Residential Refrigerator with In-Door Ice & Water Dispenser
- 3-Burner Gas Cooktop
- 1.9 cu. ft. Stainless Steel Over-the-Range Convection Microwave Oven
- Solid Surface Countertops, Cooktop Cover & Sink Covers
- Large Double Bowl Kitchen Sink with Single Handle Faucet & Pull-Down Sprayer
- Designer Backsplash with Tile Accent
- 12-volt Attic Fan

## BEDROOM & BATHROOM

- Denver Mattress® Pillowtop King Size Bed
- Bedspread with Throw Pillows
- Porcelain Toilet
- Oversized Full Height Shower with Glass Door
- 12-volt Attic Fan in Bathroom

## ENTERTAINMENT

- 40" LED HDTV & 60" LED Smart HDTV in Living Area (A40)
- 60" LED Smart HDTV in Living Area (M37)
- Surround Sound Blu-Ray Home Theater
- 32" LED HDTV in Bedroom
- Cable TV & HDMI Video Ready
- Winegard™ TRAV'LER HD Satellite

## ENTERTAINMENT OPTIONS

- 32" LED HDTV in Cockpit Overhead (M37)
- Exterior 32" LED HDTV
- Canadian Winegard™ TRAV'LER HD Satellite

## ELECTRICAL & PLUMBING

- Cummins Onan® RV QD 8000 Diesel Generator
- Automatic Generator Start
- 50-amp Shoreline Power Cord
- Pre-Wired for Solar Charging
- 2000-watt Inverter / 100-amp Converter
- Dual 15,000 BTU Low-Profile Ducted Air Conditioners with Two (2) Heat Pumps
- Dual 20,000 BTU Ducted Electronic Ignition Furnaces (M37)
- (1) 20,000 & (1) 25,000 BTU Ducted Electronic Ignition Furnace (A40)
- Energy Management System
- Emergency Start Switch
- Four (4) Auxiliary House Batteries
- Battery Disconnect Switch
- Exterior GFCI Recept
- 10-gallon DSI Gas/Electric Water Heater
- Enclosed & Heated Holding Tanks
- E-Z Flow Water Panel with Whole-House Water Filtration
- Black Tank Flush System
- Stackable Washer & Dryer
- Central Vacuum System with Toe-Kick Dustpan

\*\*SOFA w/AIR BED ONLY AVAILABLE WHEN EURO RECLINER w/DESKTOP & FIREPLACE IS OPTIONED



HIGH-GLOSS GLAZED MILAN CHERRY



HIGH-GLOSS GLAZED RESORT CHERRY

Thor Motor Coach is the industry leader in innovative design and builds a variety of unique styles, sizes and floor plans that feel custom-made – at a truly competitive price.

**IMPORTANT–PLEASE READ:** This brochure reflects product design, fabrication, material, components and specifications at the date of printing, which date is disclosed below. Please visit us online at [ThorMotorCoach.com](http://ThorMotorCoach.com) or consult with your selling dealership for the latest in standards, options, specification and technical information. Photographs in the brochure may depict optional equipment or may only be available in certain floor plans. Components, appliances and the chassis may have been manufactured in a calendar year before the vehicle's designated model year. All capacities are approximate. The actual length of the vehicle may differ from that indicated in the brochure due to variances in the manufacturing processes and/or installed components. All dry weights are based on standard model features and do not include optional features or equipment. Component part and appliance manufacturers issue limited warranties covering portions of the vehicle not covered under the limited warranty we issue. Copyright Thor Motor Coach, Inc. © 10/01/15 V2

YOUR LOCAL THOR MOTOR COACH DEALER



Made to fit.

P.O. Box 1486, Elkhart, IN 46515  
Sales Department: 800.860.5658  
Customer Service: 877.855.2867



[VenetianMotorcoach.com](http://VenetianMotorcoach.com)