

# LIFESTYLE *TESLA*

---

L U X U R Y   F I F T H   W H E E L S





LUXURY MEETS HIGH-END FUNCTION



# EXPERIENCE THE TESLA LIFESTYLE.



TESLA LUXURY FIFTH WHEELS

AS TOUGH AS IT IS LUXURIOUS.

Luxury meets road-ready function in the Tesla fifth-wheel toy hauler. There's no need to sacrifice luxurious amenities for a fully equipped garage. With the Tesla you can have both. Most Tesla floorplans have a 12-foot garage separate from the living area so you can enjoy the best of both worlds.

Relax at the end of the day in the spacious living area featuring high, barrel ceilings. Plush recliner sofas and lounge chairs provide comfort for the entire crew and when the toys are out, the party continues outside on the optional party deck system.



The garage isn't made for all work and no play; an optional party deck system brings the party outside.





## REMARKABLE KITCHENS

### TESLA LUXURY

CHOOSE A KITCHEN PERFECT FOR YOUR FAMILY.

Open concept island kitchens and L-shaped galleys are among some of the kitchen configurations to choose from in the Tesla line. All Tesla kitchens are built with the quality found in any home like residential-size drawers and pantry.



Corian® countertops, an under-mount stainless steel sink with high-rise faucet and over-the-range microwave make for a luxurious kitchen to prepare meals after a long day.



The Tesla 3970 and 3914 have a residential refrigerator with pullout freezer below and water and ice in the door.



This dishwasher option available on some models is built into the kitchen island.



An open concept living and kitchen area in the Tesla 3950 features an island layout with an entertainment center and fireplace at the focal point. Above a lofted sleeping area is perfect for guests.





## AFTER A DAY ON THE TRAILS

### TESLA LUXURY

The Tesla 3212 bedroom exudes comfortable elegance. An incredible amount of storage can be found throughout the master bedroom. From the large wardrobe to the tall dresser there is plenty of room for long trips.

#### Easy Cleanup.

After a hard day on the trails, cleanup in style. A residential walk-in shower is comfortable. Stylish touches throughout include a porcelain foot flush toilet and Corian countertop with under-mount solid surface sink.

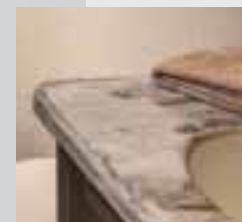





Bedrooms feature optional king beds and copious closet and wardrobe space ready to outfit your next adventure.

# TESLA

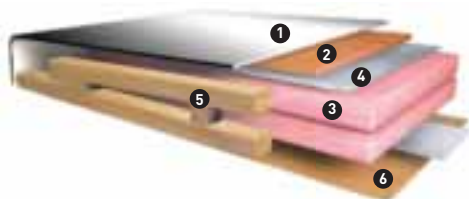

## A ROOF STRUCTURE

Heavy-Duty Barrel Truss Roof with R-38 Insulation.

Reinforced Trusses run entire length.

- 1 TPO Hybrid Roofing
- 2 OSB Decking
- 3 Two Layers, Owens Corning Fiberglass Insulation
- 4 FlexFoil™
- 5 Wood Truss 16" on Center
- 6 Decorated Interior Ceiling Board

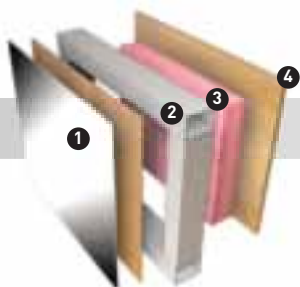

## B WALL STRUCTURE

Walls that stand up to the elements and support a Tesla Toy Hauler RV. Layers of gel-coat, foam, high grade aluminum framing, protecting decorated interior wall board.

- 1 Gel-Coat Fiberglass Luan
- 2 High-Grade Aluminum
- 3 Block Foam Insulation
- 4 Decorated Interior Wall Board

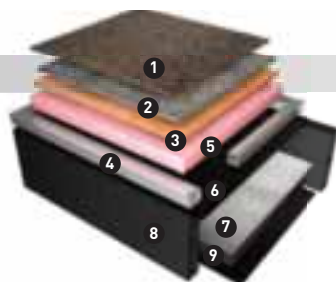

## C FLOOR STRUCTURE

Absolute Coverage, From the Inside Out.

Carpet is set over a re-bond carpet pad with a solid foundation of 5/8-inch tongue and groove plywood over high-grade aluminum on 12-inch centers. Protection from the elements starts with an air-dam over an Owens fiberglass blanket covering the entire floor. A layer of Flex Foil insulation, and poly strand vapor barrier over the top and underbelly of the Titan 2.0 Chassis, protect the coach from moisture and road grime.

- 1 Carpet/Linoleum
- 2 Rebond Carpet Pad
- 3 5/8" Tongue and Groove Plywood
- 4 High Grade Aluminum
- 5 Owens Fiberglass
- 6 FlexFoil Insulation
- 7 Polystranded Vapor Barrier
- 8 Titan 2.0 Chassis System
- 9 Polyflex Vapor Barrier

## SUPERIOR STRUCTURE & SURFACE

THE ONE & ONLY TESLA TOY HAULER RV

## YOUR INVESTMENT IN A TESLA.

Your decision to invest in a Tesla Toy Hauler RV is also an investment in superior engineering and design. From our exclusive Titan 2.0 Chassis System™ to boasting the industry's highest insulation R-values for climate control under extreme weather conditions, we are proud to share all the details of our unique construction processes and quality material specifications.



### Box-framed Steel Deck in Bath and Bedroom Area

Exclusive to Tesla is a box frame that creates a solid foundation for large bedroom slide systems. With less flexing and twisting, higher structural integrity and support.





#### CLIMATE CONTROL

Efficient, year-round comfort comes with ducted, forced-air heating and cooling with a standard 40,000 BTU extreme heat furnace. Standard 15,000 AC for the common area and 13,500 bedroom areas. (Optional 13,500 garage AC.)



#### STORAGE

Tesla fifth wheels lead the industry in storage space by featuring a large main pass-through storage area with heavy duty slam latch doors.



#### LEVEL UP®

- One-touch automatic leveling
- Level the RV in less than 1 minute
- Lightweight aluminum jacks



#### ALUMI-TREAD

- Sleek, Euro-style design
- Lightweight, durable aluminum treads
- Anti-slip rubber grooves

#### equa-flex



- Reduces fore-to-aft trailer movement
- Absorbs road shock and vibration
- Delivers a ride as smooth as torsion axles



## TITAN 2.0

CHASSIS SYSTEM

#### THE CUSTOM ENGINEERED TITAN 2.0 CHASSIS SYSTEM

The Titan 2.0 Chassis System is custom engineered to each brand of the full line of Tesla Toy Hauler fifth-wheels. Each Titan 2.0 Chassis is custom designed to meet the weight and strength specifications of the individual floorplan it supports. Every chassis is custom engineered to perfectly integrate slide outs, leveling, suspension systems with the flex, camber and weight transfer of each unit. The Titan 2.0 Chassis System is then precision matched with the axles and suspension to assure a smoother running Tesla for years to come.

## FLOORPLANS FOR EVERY LIFESTYLE



**T3212**



**T3914**

### **T3212**

Total Dry weight.....	12,200
Dry hitch.....	2,700
GVWR .....	16,700
Fresh water.....	174
Gray water.....	70
Black water.....	40
LP capacity .....	60
Cargo carry .....	2,913
Overall length .....	37' 10"
Height.....	13'1"
Width.....	102"
Bed size.....	60 x 80
Power awnings .....	18'/14'
Tire size.....	ST235/80R16

### **T3914**

Total Dry weight.....	14,817
Dry hitch.....	2,963
GVWR .....	20,963
Fresh water.....	174
Gray water.....	70
Black water.....	70
LP capacity .....	60
Cargo carry .....	4,559
Overall length .....	42'9"
Height.....	13'1"
Width.....	102"
Bed size.....	60x80
Power awnings .....	16'/16'
Tire size.....	ST235/80R16



**T3950**



**T3970**

**T3950**

Total Dry weight.....	14,700
Dry hitch.....	3,300
GVWR .....	21,000
Fresh water.....	174
Gray water.....	40
Black water.....	80
LP capacity .....	60
Cargo carry .....	4,700
Overall length .....	43' 6"
Height.....	13' 1"
Width .....	102"
Bed size.....	60x80
Power awnings .....	16'/12'
Tire size.....	ST235/80R16

**T3970**

Total Dry weight.....	15,080
Dry hitch.....	3,185
GVWR .....	21,000
Fresh water.....	174
Gray water.....	80
Black water.....	40
LP capacity .....	60
Cargo carry .....	4,333
Overall length .....	43' 6"
Height.....	13' 1"
Width .....	102"
Bed size.....	60 x 80
Power awnings .....	16' /12'
Tire size.....	ST235/80R16



## TESLA STANDARDS AND OPTIONS

### EXTERIOR

Titan 2.0 wide body chassis with drop frame  
Aluminum wheels with 16-inch E rated radial tires  
Equa-flex suspension system  
Heavy-duty easy assist ramp door  
174-gallon fresh water capacity  
Fuel station with 40-gallon fuel tank  
Ramp door patio  
Generator prep  
6,000-pound rated tie downs  
Solar prep  
Pre wired for 3rd air conditioner  
Dual awnings  
EZ lube axle system  
Six point hydraulic auto leveling system  
Five-sided aluminum frame construction  
Two-inch foam insulated gel coat poured sidewall  
Plywood and aluminum floor construction  
3.5-inch thick aluminum frame triple insulated floor  
Triple insulated barrel truss - full walk on roof  
DiFlex Hybrid roof covering  
Aluminum frame laminated slide room with walk on roofs  
Aluminum frame laminated rear wall  
Gel-coat painted fiberglass cap  
High intensity LED running lights  
Painted side mount roof ladder  
Dutch style slam latch doors  
Simplicity docking station  
Double tint frameless safety glass windows  
Marine grade exterior speakers  
Power awning with integrated LED light  
Heated and enclosed holding tanks and valves  
Full perimeter painted aluminum skirting  
Industrial grade flooring in exterior storage area  
Oversize basement storage  
EZ pullout anodized aluminum quad step  
60-pound LP propane  
Hydraulic slide room system (most slides)  
Battery disconnect  
Swing out grab handle at entry door  
50 amp electrical service with detachable cord

### INTERIOR

Fireplace  
Extra tall slide-out room  
Solid wood cabinets with raised panel doors  
Hidden hinge cabinet doors

Crown molding ceilings and cabinets  
Wall switch LED interior lighting  
Residential ornamental plank Beauflor  
Designer series glass front doors  
USB electronic charging docks  
MCD blackout roller shades  
Designer series window lambrequins in living area  
H-series air conditioning delivery system  
Multiplex heat delivery system  
Plywood built drawers with hardwood fronts  
Residential drawer guides with soft touch close  
Shaw residential carpet and pad  
Vented slide room windows  
Triple insulated barrel truss full walk on roof  
Ultra leather recliner sofas  
50-inch LED TV in living room

### KITCHEN

Undermount stainless steel sink  
Solid surface sink and range cover  
Built in trash can storage (most models)  
Residential size drawers and pantry  
Residential pullout faucet  
Corian® brand solid surface counter tops  
Stainless steel appliances  
Easy-to-clean backsplash  
Power vent  
Stainless steel convection microwave  
Residential refrigerator with water and ice in door  
Stainless steel gas range

### BEDROOM

Queen-size mattress  
Reading lights over bed  
Nightstand with hardwood top and power outlets  
Residential smoke glass closet doors  
Bedroom dresser with hardwood top  
Padded bench seat  
40-inch LED TV

### BATHROOM

Residential, one-piece fiberglass walk-in shower  
Opaque skylight over shower  
Medicine cabinet with vanity lights  
Adjustable nickel plate showerhead  
Porcelain foot flush toilet  
Triple slide safety glass shower door  
Corian sink top with undermount solid surface sink  
One touch power exhaust fan

### UTILITIES

Dometic 15,000 BTU air conditioner  
Dometic 13,300 BTU bedroom air conditioner  
40,000 BTU forced air furnace  
Satellite prep/Solar prep  
10-gallon gas/electric/DSI quick recovery water heater  
Central vacuum  
Quad battery prep

### OPTIONAL EQUIPMENT

Stainless steel dishwasher (T3950 only)  
King bed with Black Label mattress (N/A T3212)  
3rd A/C - garage 13,500 BTU with thermostat sensor  
12V tank heater with interior switches  
Dual pane safety glass windows  
Kitchen power fan with rain sensor and thermostat  
Garage power fan with rain sensor and thermostat (N/A with 3rd A/C option)  
Bathroom Power fan with rain sensor and thermostat  
Trailair pin box  
Back-up camera with monitor  
Slide out awning topper - double slides  
Slide out awning topper - triple slides  
Generator - Onan 5.5 kW gasoline generator  
Pull down garage door screen (N/A 3-season patio doors)  
Three-season patio doors with removable tinted windows and screens (N/A pull down garage door screen)  
Two Tesla loungers  
LED large TV in garage  
Custom Tesla helmet rack with clothes bar (IPO locker T3970)  
Mini fridge and cabinet/counter storage area (T3950)  
Full painted exterior

## THE LIFESTYLE PEACE OF MIND WARRANTY.

We're so confident in our quality that we're willing to stand behind our travel trailers and fifth-wheels with one of the best warranties in the industry.

- 12-year Roofing Materials Warranty
- 3-Year Limited Structural Warranty\*
- 1-Year Limited Warranty
- 1-Year Free Roadside Assistance Program

\*Contact your Lifestyle dealer for an applicable copy of all limited warranties

Learn more about our full-line of quality Lifestyle Fifth Wheels.  
[www.lifestylelr.com](http://www.lifestylelr.com)

## COMPLIMENTS OF:

See the above dealer for further information and prices.

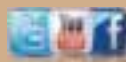

51700 Lovejoy Dr. • Middlebury, IN 46540 • Phone: (574) 825-5578 • Fax: (574) 825-5508  
[www.GoEverGreenRV.com](http://www.GoEverGreenRV.com)    [www.LifestyleLRV.com](http://www.LifestyleLRV.com)