



THE FIRST NAME IN CAMPING. THE TRUSTED NAME IN RVs.



The Outdoor Company®



# THE FIRST NAME IN CAMPING

For more than 100 years, millions of people have trusted the Coleman name to help them thrive in the great outdoors. These all-new Coleman RVs deliver on that same reputation, packing more camping conveniences into one value-packed product! With multiple floorplans to choose from and a number of residential-style features throughout, the campground awaits you and your Coleman RV.



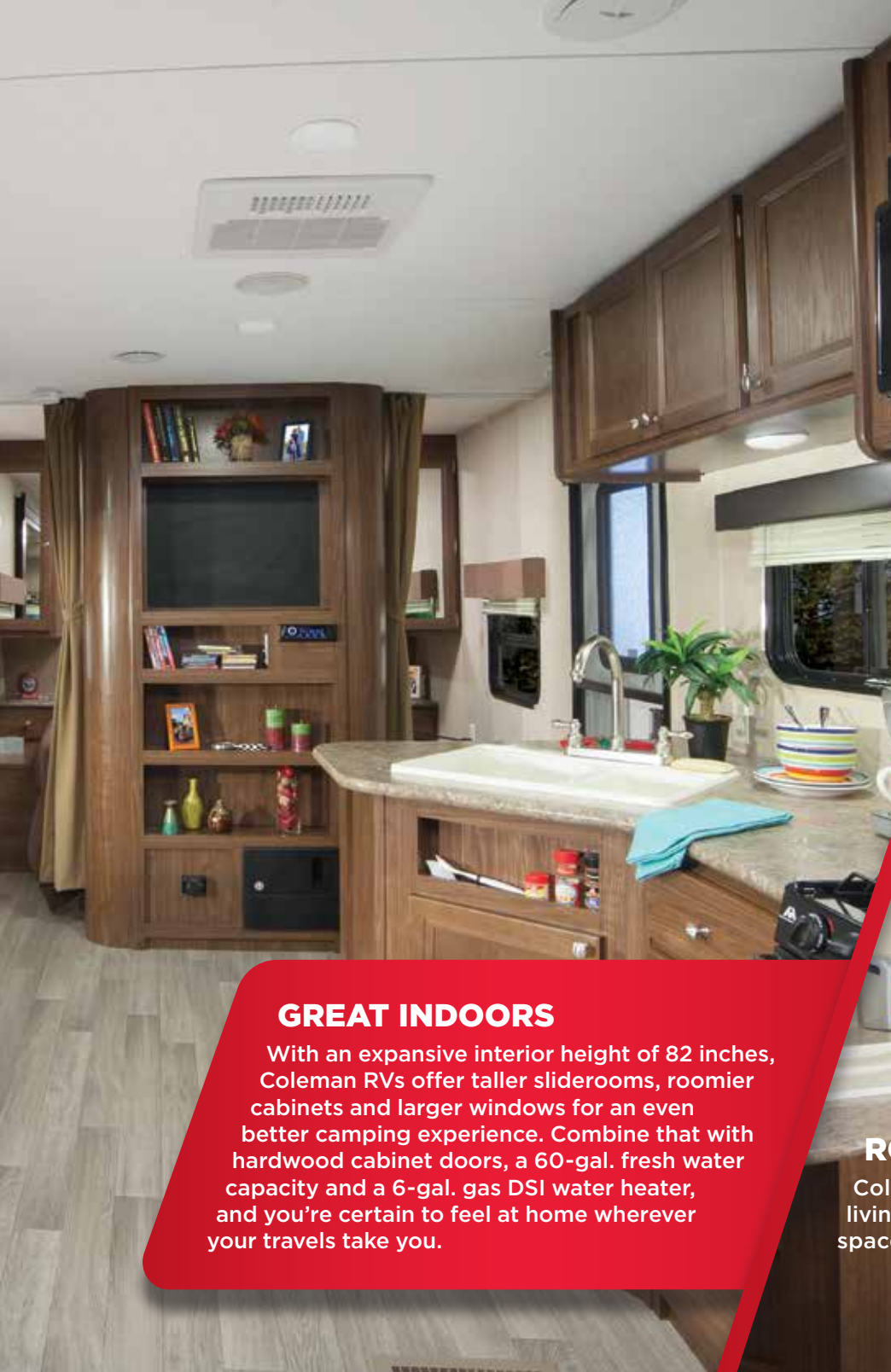

## GREAT INDOORS

With an expansive interior height of 82 inches, Coleman RVs offer taller sliderooms, roomier cabinets and larger windows for an even better camping experience. Combine that with hardwood cabinet doors, a 60-gal. fresh water capacity and a 6-gal. gas DSI water heater, and you're certain to feel at home wherever your travels take you.



## SWEET DREAMS

The comfortable master bedroom features handy nightstands, mirrored cabinets, a bonus storage shelf and a queen-sized mattress.



## ROOM TO RELAX

Coleman's oversized slideout creates a roomy living area with plenty of seating and sleeping space for family and guests.

# NORTH AMERICA'S **TRUSTED** NAME IN RVS



## **OUTDOOR KITCHEN**

Select models feature an exterior kitchen, perfect for Coleman outdoor enthusiasts.



## **FULL-EXTENSION DRAWER GUIDES**

The heavy-duty metal guides offer solid drawer support for many years of use.



## **INTERIOR POWER COMMAND CENTER**

Control your lights, sliderooms, power awning and more all from one smart location.



## **BLACK DIAMOND PLATE ROCK GUARD**

The black diamond-plate rock guard protects your RV from the rigors of the road.

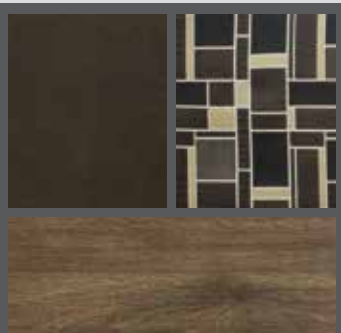

## **MACKINAC DECOR**

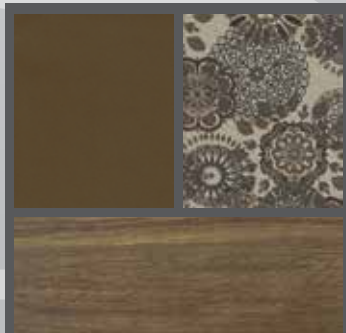

## **SHORELINE DECOR**





## LANTERN LT

Whether you're a couple wanting to enjoy the great outdoors or a young family looking to create your own camping traditions, Lantern LT is a series that will appeal to you. With the wide array of features and upgraded interior amenities, you are sure to see why Coleman is one of the fastest-growing brands in the market.



## LANTERN

Coleman's Lantern Series features spacious floorplans and one of the longest lists of amenities in its class. Combining old-world craftsmanship with over-the-top conveniences, like a power awning with LED lights, standard front and rear jacks and a solid-state converter with built-in battery charger, your family will love everything the Coleman Lantern offers to help you get away from it all.





The Outdoor Company®



# THE FIRST NAME IN **CAMPING**

Every day is an adventure with Coleman, especially when you ramp up the fun with an outing in the Lantern SUT. Part toy hauler, part travel trailer, this model packs garage space for the toys, a HappiJac power bed for the guests and a private bedroom for the two leaders in the pack. Plus, the flush-floor cargo area doesn't sacrifice space to bulky wheel wells. Coleman, we believe in practical design.



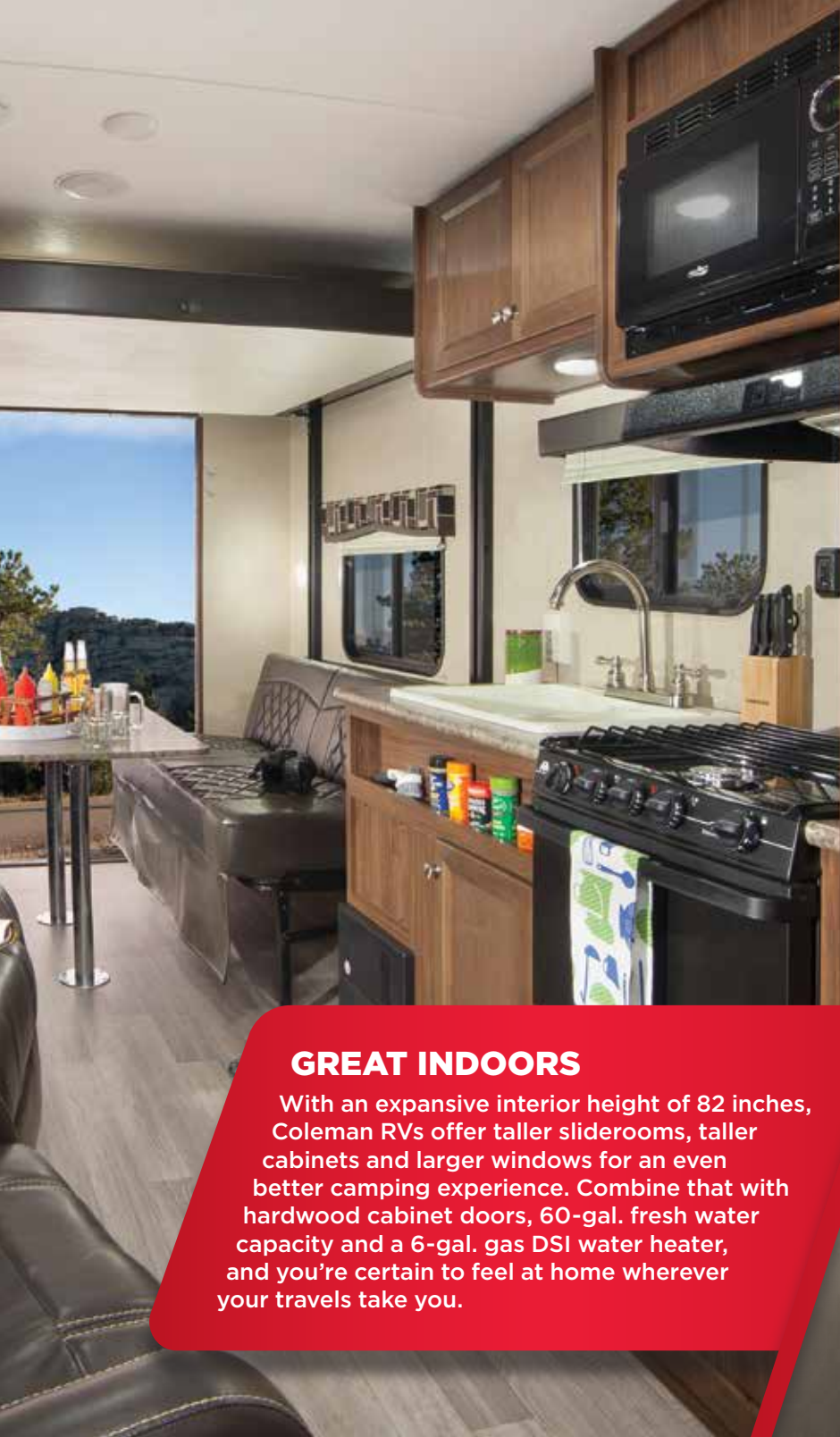

## GREAT INDOORS

With an expansive interior height of 82 inches, Coleman RVs offer taller sliderooms, taller cabinets and larger windows for an even better camping experience. Combine that with hardwood cabinet doors, 60-gal. fresh water capacity and a 6-gal. gas DSI water heater, and you're certain to feel at home wherever your travels take you.



## BUNKS UP

The comfortable master bedroom features handy nightstands, mirrored cabinets, a bonus storage shelf and a queen-sized mattress.

## BUNKS DOWN

Coleman's oversized slideout creates a roomy living area with plenty of seating and sleeping space for family and guests.

## COLEMAN LANTERN LT MODELS

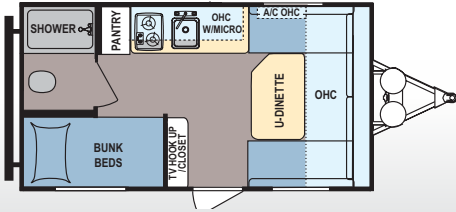

**Lantern LT | 15BH**

Sleeps 4

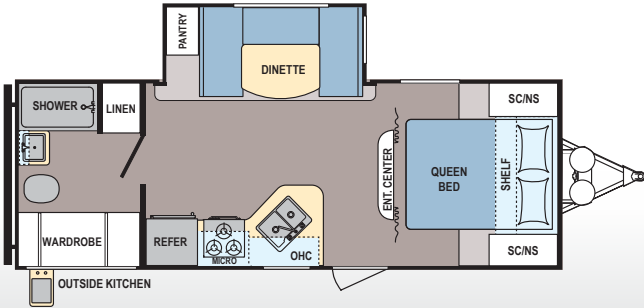

**Lantern | 225QB**

Sleeps 4

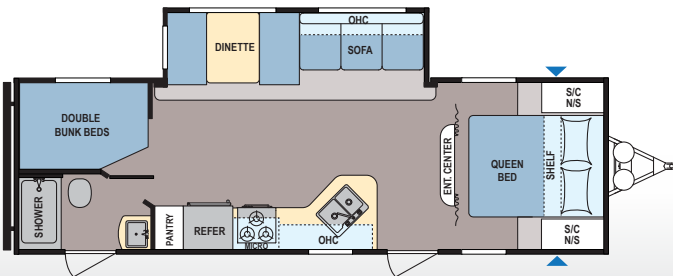

**Lantern | 263BH**

Sleeps 8

## COLEMAN LANTERN MODELS

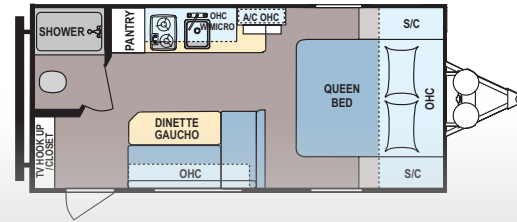

**Lantern LT | 16FB**

Sleeps 2-3

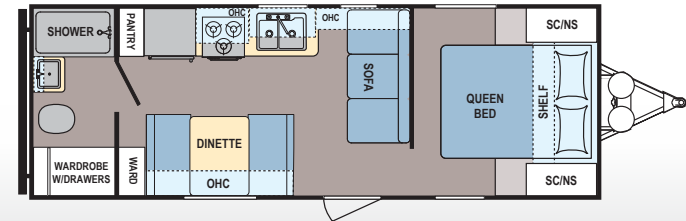

**Lantern | 235QB**

Sleeps 5

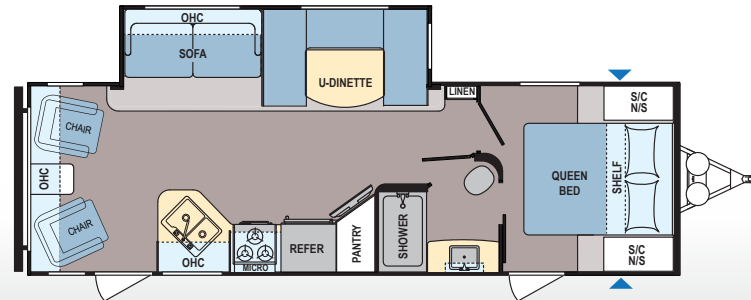

**Lantern | 270RL**

Sleeps 4-5



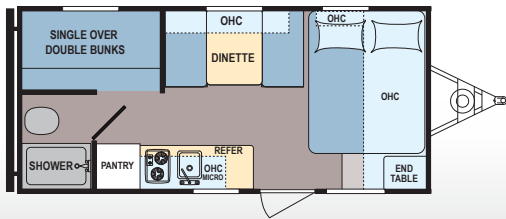

**Lantern LT | 17FQ**  
Sleeps 6

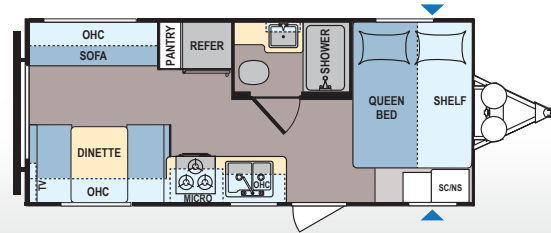

**Lantern | 192RD**  
Sleeps 4-5

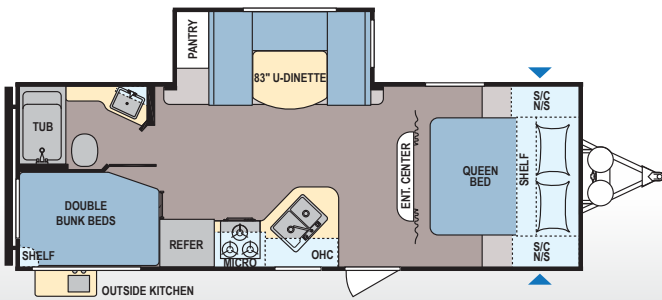

**Lantern | 244BH**  
Sleeps 6-8 Western Region production\*

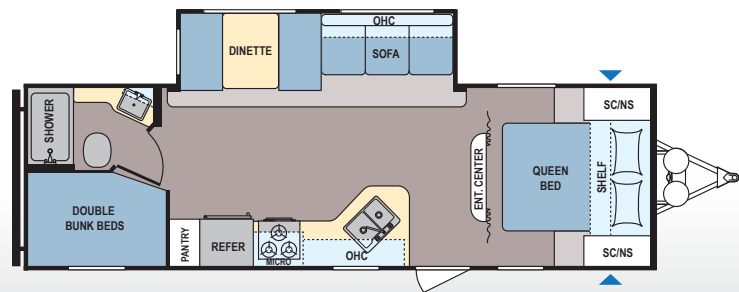

**Lantern | 262BH**  
Sleeps 8-10

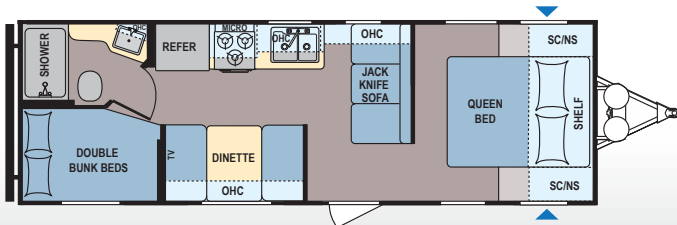

**Lantern | 274BH**  
Sleeps 7-8

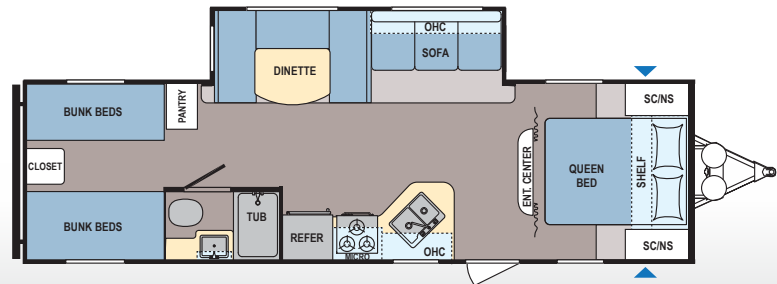

**Lantern | 295QB**  
Sleeps 8-9

# FLOORPLANS

## COLEMAN LANTERN MODELS CONTINUED

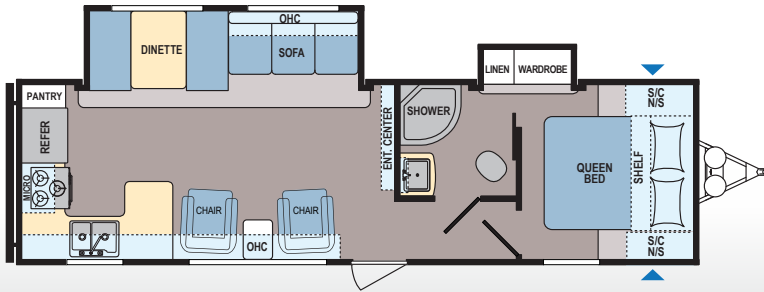

### Lantern | 296RK

Sleeps 6

## COLEMAN LANTERN SUT MODELS

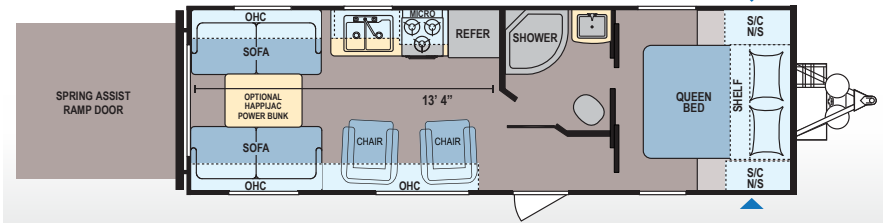

### Lantern SUT | 250TQ

Sleeps 6

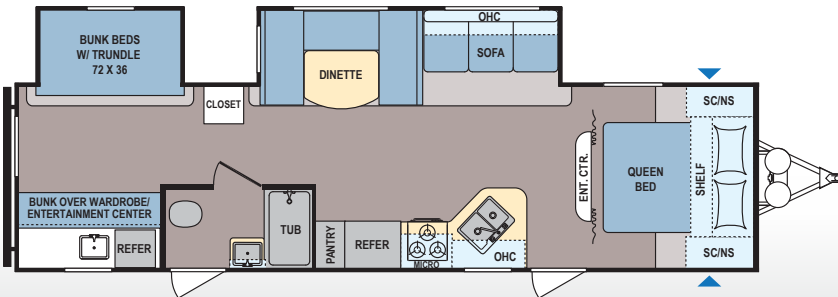

### Lantern | 314BH

Sleeps 9-10 Eastern Region production\*\*

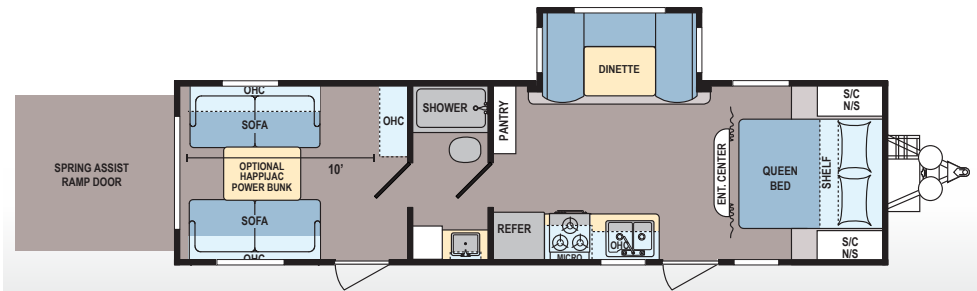

### Lantern SUT | 300TQ

Sleeps 8

## COLEMAN LANTERN LT MODELS

Awning
Diamond plate
Tinted safety-glass windows
28" entrance door without window
Entry handle
Single-entry step
Porch light with switch on light
Rear jacks
E-Z Lube axles
Radial tires with silver spoke rims
Spare tire
20-lb. propane bottle
30-amp power cord
Exterior outlet
Solid-state converter with built-in battery charger
6-gal. gas water heater
Water heater bypass kit
18,000-BTU furnace
Acrylic kitchen sink with faucet
3.3 cu. ft. refrigerator
2-burner cooktop
Range hood with 12V light and exhaust fan
Microwave
Full-extension drawer guides throughout
Mini blinds throughout
Residential-grade vinyl flooring

Stereo AM/FM/MP3/SC/AUX
Interior speakers
Non-power bath/galley fan
Skylight in bath
Shower curtain
Foot pedal flush toilet

### OPTIONAL EQUIPMENT

8,000-BTU air conditioner
CSA upfit and seal

## COLEMAN LANTERN MODELS

Awning
Diamond plate
Tinted safety-glass windows
28" entrance doors
Entry handle(s)
Folding entry steps (double- or triple-entry on select models)
Smooth-finish entry and baggage doors
Large storage compartment
Exterior TV connection on entry-door side
Backers for rear ladder
Front and rear jacks
E-Z Lube axles
Radial tires with nitro fill and silver spoke rims
Dual 20-lb. propane bottles with ABS cover
30-amp power cord
120V exterior outlet

Solid-state converter with built-in battery charger
13,500-BTU A/C
6-gal. gas DSI water heater with bypass kit
Residential galley sink with high-rise faucet
6 cu. ft. double-door refrigerator
3-burner cooktop
Range hood with 12V light and exhaust fan
Microwave
Interior power command center
Full-extension drawer guides throughout
Mini blinds throughout
Residential-grade vinyl flooring
Dinette storage compartment with side access (select models)
Under-bed storage
Upgraded Rest Easy mattress
Bedroom TV hookup
Backers for bedroom TV mount
Luxury furniture
2 swivel rockers (select models)
Cable/satellite TV hookup
Stereo AM/FM/CD/AUX
Glass shower door (select models)
Shower curtain rod (select models)
Power bath fan
Foot pedal flush toilet
Medicine cabinet with mirror

## COLEMAN LANTERN SUT MODELS

1,600-lb. rated rear ramp door
2,500-lb. rates recessed D-Rings
Maximized storage flat floors
Happi-Jac power bed with removable ladder
Opposing rear fold-away sofas

### OPTIONAL EQUIPMENT

Yukon Package
Spare tire and carrier
15,000-BTU A/C in place of 13,500 (n/a 192)
CSA upfit and seal

### YUKON PACKAGE (Mandatory)

Power awning with LED patio light
Exterior speakers
Enclosed and insulated fresh water tank
Oven with 3-burner range



To check for recent updates to floorplans and specifications. Scan this **QR CODE** with your favorite QR Reader application.

## SPECIFICATIONS

FLOORPLAN	15BH	16FB	17FQ	192RD	225QB	235QB	244BH	262BH	263BH	270RL	274BH	295QB	296RK	314BH	250TQ	300TQ
*AVG SHIPPING WEIGHT (LBS)	2,883	3,088	3,296	3,923	5,288	4,544	5,450	5,744	5,702	5,954	4,630	6,318	6,660	7,414	5,418	6,846
CARGO CAPACITY (LBS)	917	712	645	3,677	2,401	3,127	2,150	1,856	1898	1,646	2,970	3,362	3,020	2,266	4,262	2,794
DRY HITCH WEIGHT (LBS)	346	339	453	472	612	474	670	733	760	695	602	840	820	1778	812	1,184
EXTERIOR HEIGHT (WITH A/C)	8' 8"	8' 11"	8' 8"	9' 11"	11' 1"	10' 6"	11' 4"	11' 4"	11' 4"	11' 2"	10' 4"	11' 4"	11' 6"	11' 6"	11' 4"	12' 4"
**EXTERIOR TRAVEL LENGTH	18' 9"	21' 5"	21' 5"	22' 11"	26' 4"	27' 2"	27' 7"	30' 7"	30' 7"	30' 8"	28' 7"	32' 8"	32' 11"	34' 9"	29' 7"	34' 7"
EXTERIOR WIDTH	8'	8'	8'	8'	8'	8'	8'	8'	8'	8'	8'	8'	8'	8'	8'	8'
***FRESH WATER CAPACITY	27	27	27	60	60	60	60	60	60	60	60	60	60	60	60	60
BLACK WATER CAPACITY	28	28	28	42	6	42	42	42	42	42	42	42	42	42	42	42
GREY WATER CAPACITY	28	28	28	42	42	42	42	42	42	42	42	42	42	42	42	42
FURNACE BTU OUTPUT	19,000	19,000	19,000	25,000	30,000	25,000	25,000	30,000	25,000	30,000	25,000	30,000	30,000	30,000	20,000	30,000

\*Our weights represent how most units are built, inclusive of many commonly-ordered options. \*\*Length is defined as the distance from the centerline of hitch pin/coupler to rear bumper of trailer. \*\*\*Fresh water capacity includes water heater capacity.

# NORTH AMERICA'S TRUSTED NAME IN RVs



Since 1900, the **Coleman® Company, Inc.** has led the world in the manufacture of camping gear and outdoor equipment. From the renowned Coleman lantern to stoves, tents, sleeping bags and coolers, Coleman's reputation for high-quality camping products is legendary.

Whether your outdoor activities involve hiking, camping, fishing, hunting, boating, swimming, tailgating or simply relaxing, Coleman offers everything you need to satisfy your family's dreams.

Coleman's floorplans are not only loaded with added value and innovative features, they're designed to help your family get the most out of every camping experience.

After all, Coleman is Camping!

We invite you to visit your nearest Coleman RV dealer today, and find out for yourself why Coleman is the most respected name in outdoor recreation.



Manufactured under license by:  
Dutchmen Manufacturing, Inc.  
PO Box 2000 • 2164 Caragana Court  
Goshen, Indiana 46527  
(574) 537-0600  
[www.dutchmen.com](http://www.dutchmen.com)

**YOUR LOCAL DEALER**

Disclaimer: Product information is as accurate as possible as of the date of publication of this brochure. Features, floorplans and specifications are subject to change without notice. Please consult our website for more current product information and specifications. Coleman®, Dutchmen® and  are trademarks of The Coleman® Company, Inc., and are used under license.