

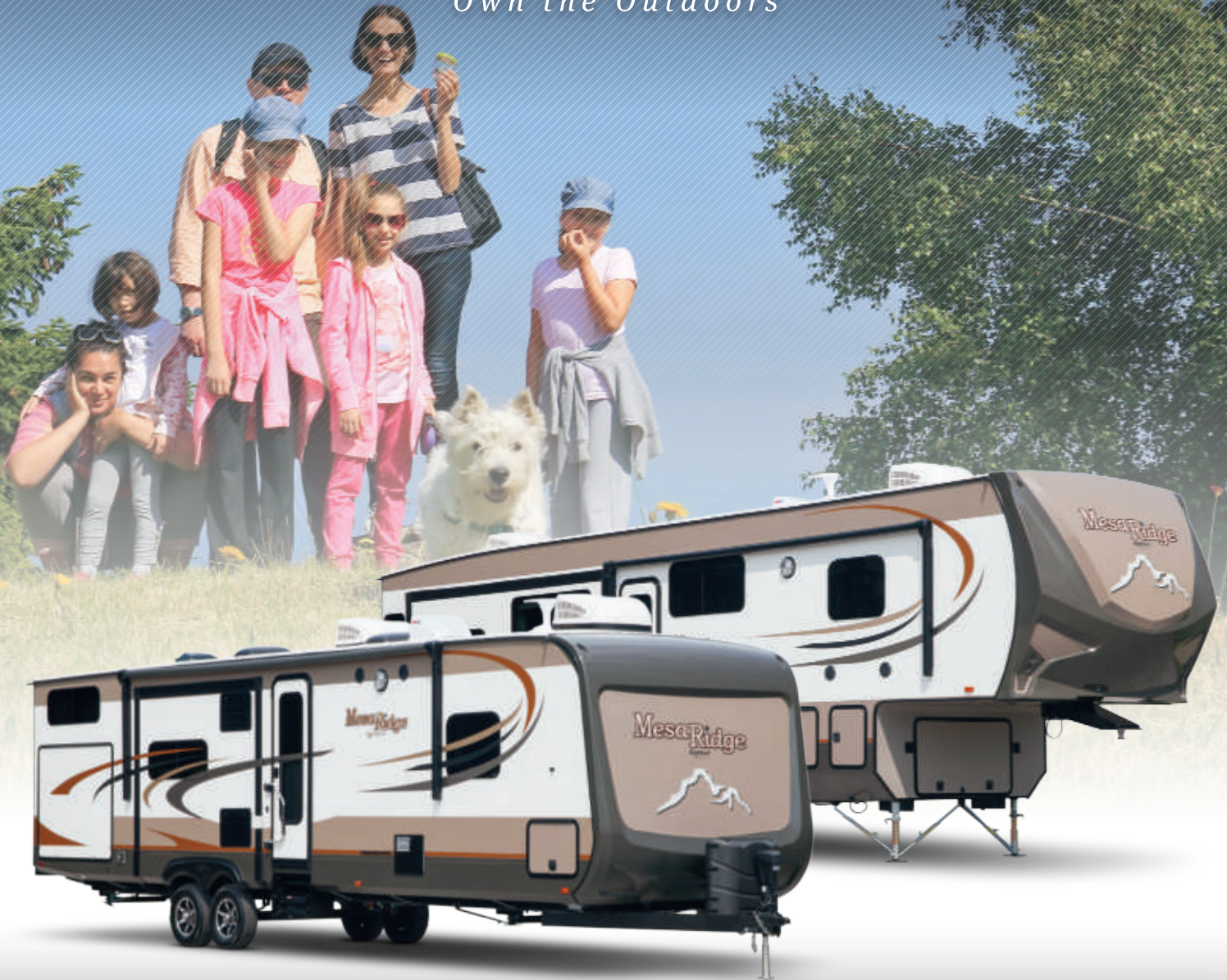

Highland

RIDGE RV

Own the Outdoors



Mesa Ridge

MESA RIDGE FIFTH WHEELS

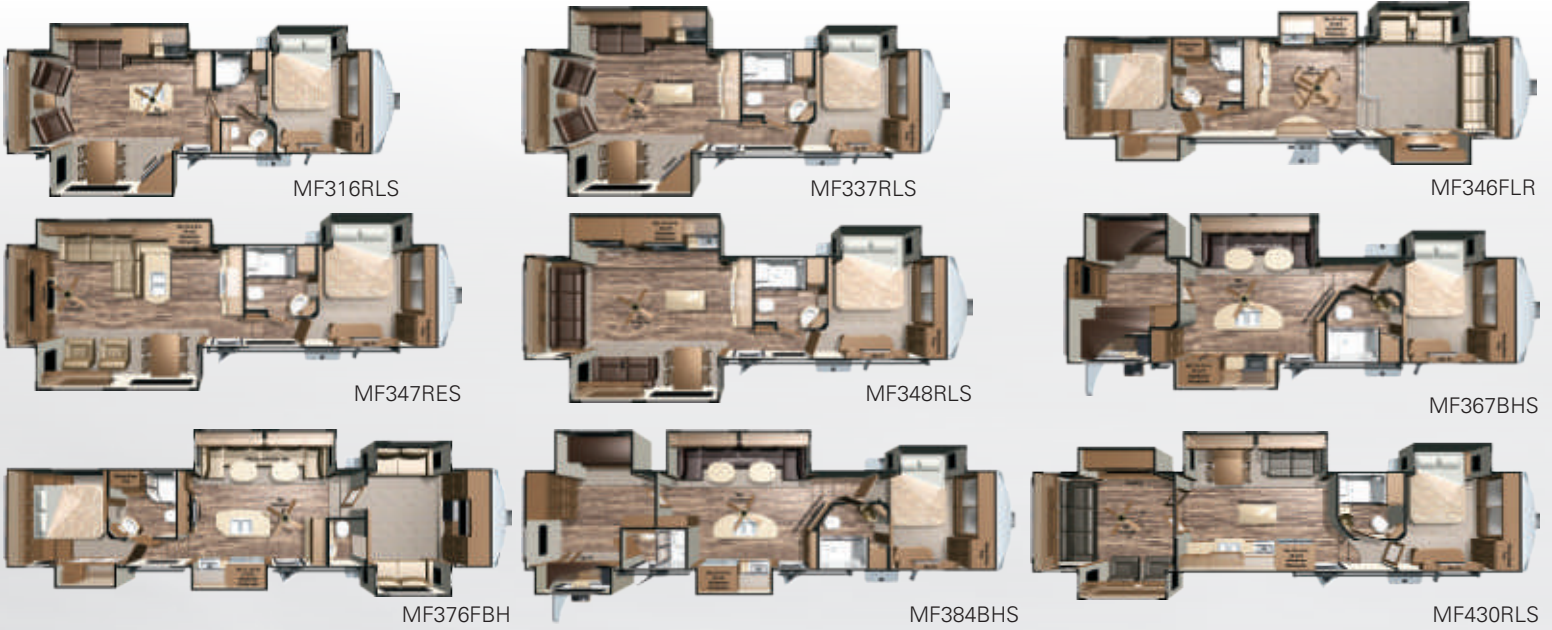

	MF316RLS	MF337RLS	MF346FLR	MF347RES	MF348RLS	MF367BHS	MF376FBH	MF384BHS	MF430RLS
UVW	9285	9657	10245	10605	10485	11305	12015	12135	11800
Hitch Wt.	2205	2320	2312	2130	2440	2360	2665	2295	2370
Length	31'5"	34'	38'1"	36'4"	36'10"	36'10"	41'11"	41'2"	42'7"
Cargo (Gross)	3200	3063	4067	3605	3510	3295	4445	3365	4290

MESA RIDGE TRAVEL TRAILERS

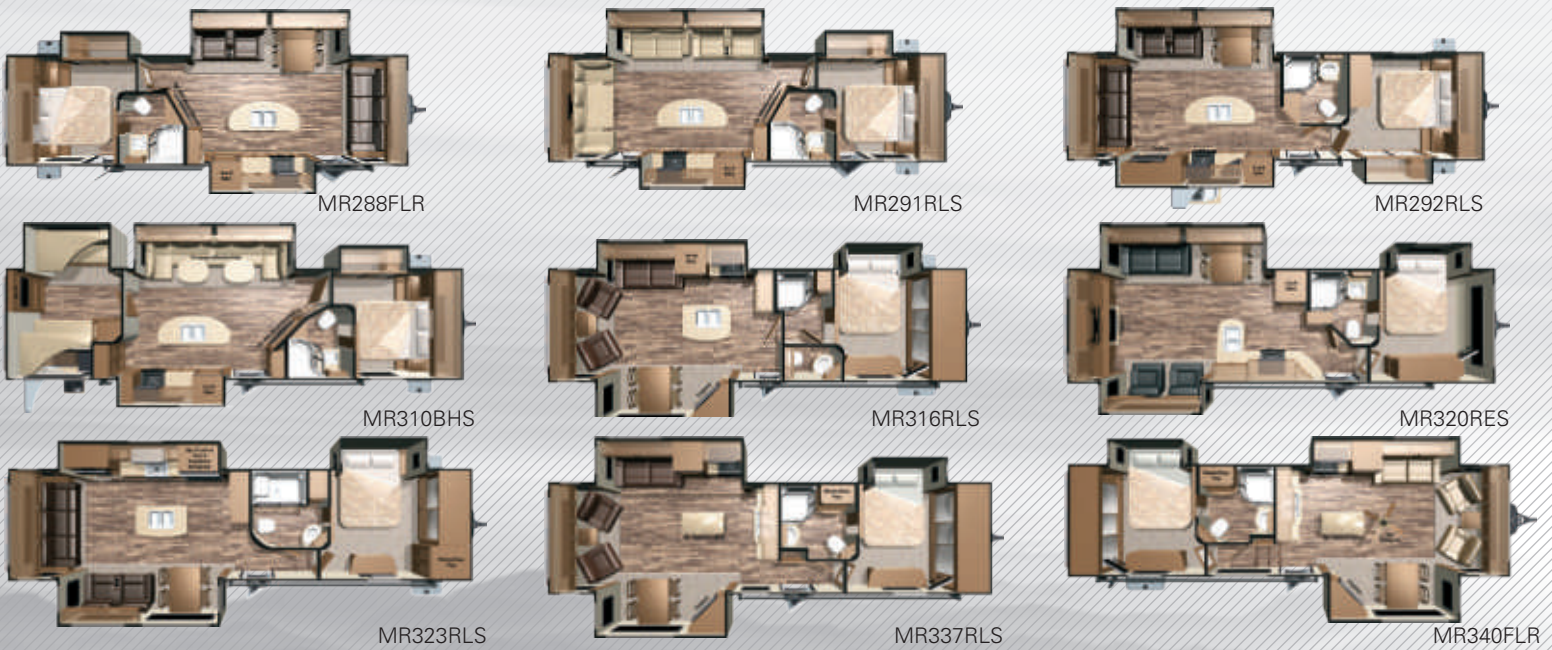

	MR288FLR	MR291RLS	MR292RLS	MR310BHS	MR316RLS	MR320RES	MR323RLS	MR337RLS	MR340RLS
UVW	7815	7865	8370	9265	8007	8070	8815	8755	8885
Hitch Wt.	1000	1040	960	1210	1200	810	1035	850	1350
Length	33'6"	33'6"	35'	37'3"	33'8"	34'6"	37'8"	36'4"	36'
Cargo (Gross)	1963	1930	2030	2235	1983	1920	2620	4095	4465



MF347RES



MF376FBH



MR323RLS



MF376FBH



MR323RLS

DECOR OPTIONS



IVORY

LIMESTONE

SONIC

THE HIGHLAND ASSURANCE

The Highland Assurance is our promise to quality and innovation. It's building RVs that are rooted in the needs and suggestions of our customers. Most importantly, it's about giving you the assurance of an enjoyable trouble-free RV experience. But even if there is trouble, we've got your back.



We stand behind our product, one owner to the next. At Highland Ridge RV, we are one of the few manufacturers that have a 2-Year Limited Transferable Warranty.

MORE ROOM LESS WEIGHT

This is our mission at Highland Ridge RV. It drives us to innovate and revolutionize the RV industry and it's why our products are 10 - 15% lighter than the competition.



We are pursuing perfection through innovation and quality. Our process starts with you! Your RV experiences drive the evolution of our products in a constant state of improvement.



Every new Highland Ridge RV design must undergo a grueling 500 mile durability test. A battery of figure eights, inverted chatters, undulations, and staggered bumps will test and prove our workmanship.

Highland Ridge RVs are built to withstand the harshest of environments. We put our products into a zero degree chamber for five hours. The results speak for themselves.



THE RESULTS

BEDROOM	72°F
KITCHEN	70°F
SLIDE-OUT	66°F
BATHROOM	72°F
LIVING ROOM	70°F
WASTE WATER TANK	62°F
STORAGE UNDER RV	58°F

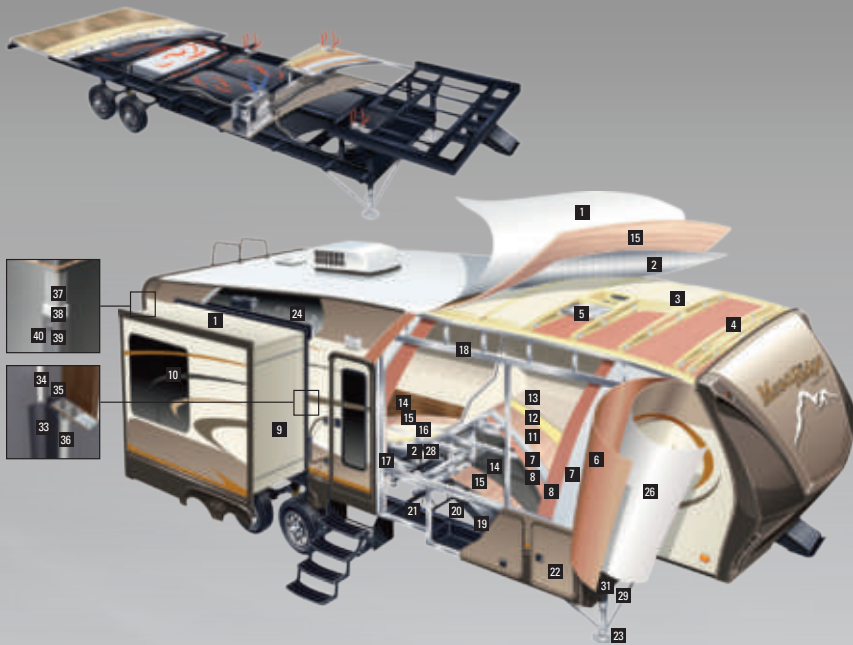

- | | | | |
|--|--|---|---------------------------|
| 1. PVC Roof Material | 11. Double Layer Luan | 20. Polypropylene Underbelly | 29. JT Strong Arms |
| 2. R-38 Radiant Technology Insulation | 12. Residential Rebound Carpet Pad | 21. Steel I-Beam Frame | 31. TPO Under Hitch Area |
| 3. R-14 Batten Insulation | 13. Carpet | 22. 1" Thick Double Insulated Baggage Doors | 33. Rubber Seal (Outside) |
| 4. 5" Roof Truss | 14. BeauFlor® Vinyl Flooring | 23. 9" Elephant Pad | 34. Water Dam |
| 5. Foam A/C Ducting | 15. Plywood Decking | 24. Accu-Slide Slide-Out System | 35. Rubber Seal (Inside) |
| 6. Exterior Wall Substrate | 16. R-7 Batten Insulation | 25. Lamilux 1000 Gel Coated Fiberglass | 36. Bulb Seal |
| 7. R-9 Block Foam Insulation | 17. "Darco" Anti-Puncture Material | 26. 3/4" Vapor Barrier (R-5) | 37. 3M Flashing Tape |
| 8. Luan | 18. 2" x 3" Aluminum Header | 27. 3/4" Vapor Barrier (R-5) | 38. Butyl Tape |
| 9. Laminated Slide-Out End Walls (R-9) | 19. R-38 Radiant Technology Insulation (Extreme Arctic Package)*Optional | 28. 12" On Center 2" x 2" Aluminum Floor Joists | 39. L-Molding |
| 10. Frameless Windows | | | 40. Geo-Cell Caulk |

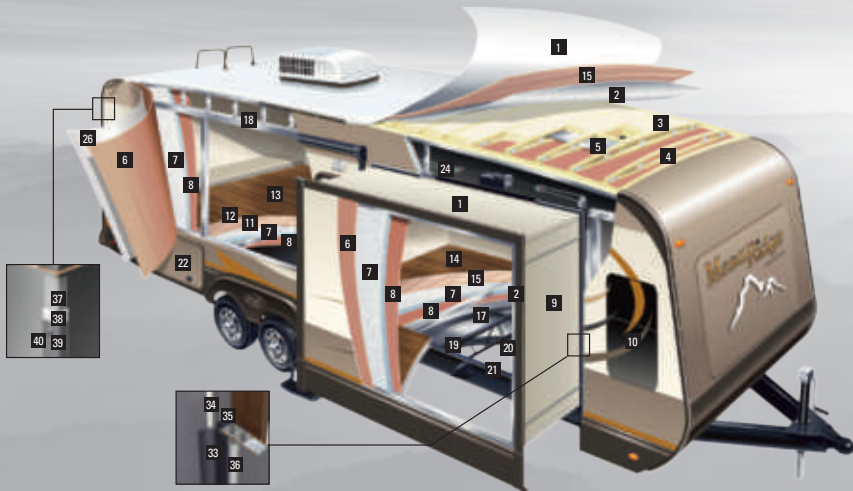

- | | | | |
|--|------------------------------------|--|--------------------------|
| 1. PVC Roof Material | 10. Frameless Windows | 19. R-38 Radiant Technology Insulation (Extreme Arctic Package)*Optional | 34. Water Dam |
| 2. R-38 Radiant Technology Insulation | 11. Double Layer Luan | 20. Polypropylene Underbelly | 35. Rubber Seal (Inside) |
| 3. R-14 Batten Insulation | 12. Residential Rebound Carpet Pad | 21. Steel I-Beam Frame | 36. Bulb Seal |
| 4. 5" Roof Truss | 13. Carpet | 22. 1" Thick Double Insulated Baggage Doors | 37. 3M Flashing Tape |
| 5. Foam A/C Ducting | 14. BeauFlor® Vinyl Flooring | 23. 9" Elephant Pad | 38. Butyl Tape |
| 6. Exterior Wall Substrate | 15. Plywood Decking | 24. Accu-Slide Slide-Out System | 39. L-Molding |
| 7. R-9 Block Foam Insulation | 16. R-7 Batten Insulation | 25. Lamilux 1000 Gel Coated Fiberglass | 40. Geo-Cell Caulk |
| 8. Luan | 17. "Darco" Anti-Puncture Material | 26. 3/4" Vapor Barrier (R-5) | |
| 9. Laminated Slide-Out End Walls (R-9) | 18. 2" x 3" Aluminum Header | 27. 3/4" Vapor Barrier (R-5) | |

STANDARD FEATURES:

- "Maxx Air" Vent Cover
- 100" Wide Body Frame
- 50 Amp Service
- 60 Lbs of LP Capacity
- Ext. Utility Center w/ Black Tank Flush
- Fireplace (Most Models)
- Heavy Duty Full Extension Drawer Guides
- Large Lavatory Sink
- Lippert Equa-Flex Suspension
- Lippert Wide-Stance Axles
- LP Quick Connect
- Nitrogen Filled Radial Tires
- Porcelain Toilet w/ Foot Pedal Flush
- Prepped for Observation Camera
- PVC Roof Material
- 16" Aluminum Tires & Wheels (FW)
- Ladder (FW)
- 15" Aluminum Wheels & Tires (TT) (16" 337&340)
- Front & Rear Stab Jacks (TT)
- Power Tongue Jack (TT)

EXECUTIVE PACKAGE: (MANDATORY)

- 12V CD/DVD Player w/ Bluetooth®
- Bedroom Speakers
- Corian® Countertops
- Crown Molding
- Digital TV Antenna w/Booster
- Flat Screen TV in Living Area
- Frameless Windows
- Full View Vented Entrance Door
- Large 8 Cu. Ft. Refrigerator
- LED Lighting in Ceiling
- Longitude Power Awning w/ LED Awning Light & Flex Guard
- Multi-Port Satellite Hook-Up
- Soundbar in Living Area
- USB/12V Charging Port
- Western Aspen Cabinet Doors
- Wired and Framed for 2nd A/C
- 15k BTU A/C w/"Quick Cool" Feature (FW)
- 20 GPH Quick Recovery Gas/Electric Water Heater (FW)
- 30" OTR Microwave (FW)
- Fantastic Fan in Kitchen (FW)
- One-Touch Automatic Leveling System (FW)
- 18 GPH Quick Recovery Gas/Electric Water Heater (TT)

FOUR SEASONS PACKAGE: (MANDATORY)

- Atwood® High Performance Furnace
- Digital Thermostat
- Double Insulated Baggage Doors
- Heated & Enclosed Dump Valves
- Heated and Enclosed Underbelly
- Insulated Slide Floors
- R-38 Insulation in Roof & Floor
- R-9 Insulation in Sidewall
- Heated Storage Area (FW)

OPTIONAL FEATURES:

- 2 Bar Stools
- 24" Bedroom TV
- 2nd A/C (13.5k BTU Ducted)
- Appliance Package (323,346,347,367,376,384,430)
- BBQ Grill
- Coffee Table Ottoman w/ Storage
- Corian® Island on Castors (337,340,337,430)
- Dual Pane Windows
- Dyson Vacuum Cleaner
- Extreme Arctic Package
- Fantastic Fan(s)
- French Door(s)
- King Bed IPO Queen Bed (323,430) (Std. 347,348)
- Observation Camera
- One-Piece Neo-Round Shower (337,340,316,346)
- Party Room Package (310,367)
- Rear Storage Tray
- Slide-Out Awning Covers
- Wall-Mount Fireplace (288,291,310,367,384)
- 12 Cu. Ft. Refrigerator (FW)
- 39" Outside TV (346) (FW)
- 3rd A/C (13.5k BTU Ducted) (FW)
- Ceiling Fan (FW & 340)
- Fantastic Fan in HALF Bathroom (384) (FW)
- LP Generator Prep (FW)
- 15k BTU Main A/C (TT)
- Corian® Sink Covers (TT)
- Ladder (TT)
- Lock Arm Stabilizers (TT)
- One-Piece Fiberglass Front Cap (N/A 340) (TT)
- Power Front & Rear Stab Jacks (TT)

***Please contact your local dealer to ensure availability of standards and options on a specific floorplan.*



Highland
RIDGE RV

Own the Outdoors

START YOUR ADVENTURE AT: WWW.HIGHLANDRIDGERV.COM

Due to continual research and advances, manufacturer reserves the right to change specifications, design, price, and equipment without notice, and assumes no responsibility for any error in the literature. Some items shown are not included as standard or optional equipment.

Your Mesa Ridge Dealer:

©2015 Highland Ridge RV, Shipshewana, Indiana. Published Date: 12/8/2015

