



GREYHAWK™

2016

2016 GREYHAWK CLASS C MOTORHOMES



MAKE A MOVE  
#LETSJAYCO



HANDS DOWN,  
THE BEST RIDE.

**2**  
YEAR  
WARRANTY





# #LETSJAYCO

When you travel with Jayco, fun is the only thing on the agenda. That's because we go the extra mile so you can live in the moment. From comfortable, amenity-packed floorplans to weather-shielding insulation and superior frame construction, you'll have everything you need to adventure every day and make yourself at home every night. Let's get away. Let's make it count. Let's Jayco—and make memories that last a lifetime.

## GENERATIONS OF FAMILY FUN





# GREYHAWK

WE CARE ABOUT GETTING THERE AS MUCH AS BEING THERE

There may be bumps in the road—but you won't feel them in your 2016 Greyhawk. With every engineering and construction detail, we kept smooth handling—and unbeatable value—in mind.



## A GREYHAWK STANDARD

JRide Plus is a powerful blend of precise handling and renowned stability.

Put JRide Plus to the test—and rule out the competition.

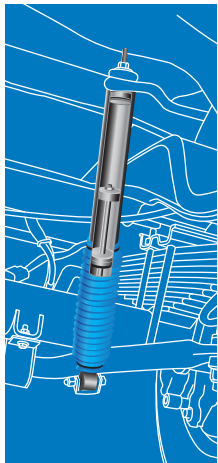

**1. Bilstein® shock absorbers** feature a unique monotube gas pressure design that provides optimum ride quality and vehicle control; Bilstein shock absorbers last 2-3 times longer than the conventional twin tube piston and are found in many high-end luxury vehicles (see photo)

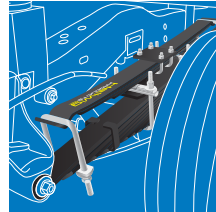

**2. Hellwig® helper springs** work with the chassis' existing springs to give the RV more support, improving sway control under heavy loads

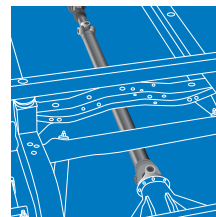

**4. Computer-balanced driveshaft** ensures reduced shudder and vibrations, and efficient power transfer to the wheels

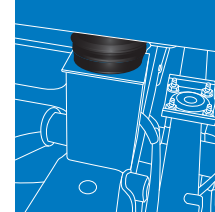

**3. Rubber isolation body mounts** are positioned near the tires to absorb road shock, dampen noise and minimize vibrations

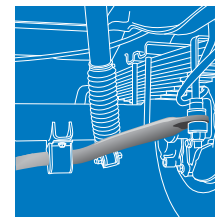

**5. Oversized sway bar** raises and lowers each side of the unit to similar heights, reducing sideways tilting when cornering

SHARE YOUR PHOTOS AND STORIES ON SOCIAL MEDIA WITH [#LETSJAYCO](#).





29MV WITH ALMOND INTERIOR



HYDRAULIC LEVELING JACKS



OUR WINDOWS



COMPETITOR'S WINDOWS



OUR FRONT CAP



COMPETITOR'S FRONT CAP

**Frameless windows (Customer Value Package)** create a stunning exterior look while protecting the window seals from UV radiation

**Seamless fiberglass front cap** for increased durability and ultimate weather protection





## INTERIOR DÉCOR

### ALMOND



### CAPPUCCINO



### FRENCH VANILLA



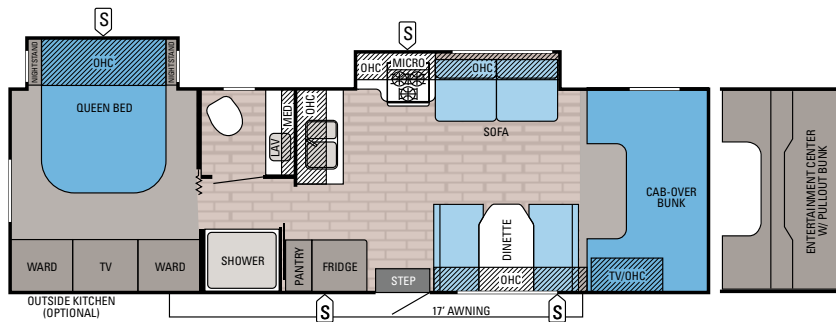

### GREYHAWK | 29KS

Exterior Length: 31' 1" Exterior Height: 11' 6" Sleeps: 5-7

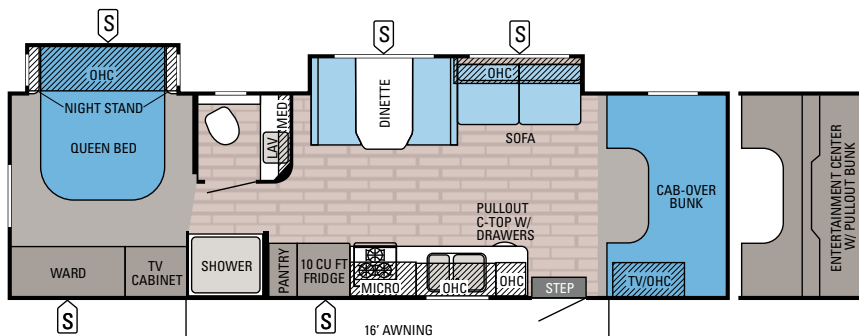

### GREYHAWK | 29MV

Exterior Length: 32' 0" Exterior Height: 11' 6" Sleeps: 5-7

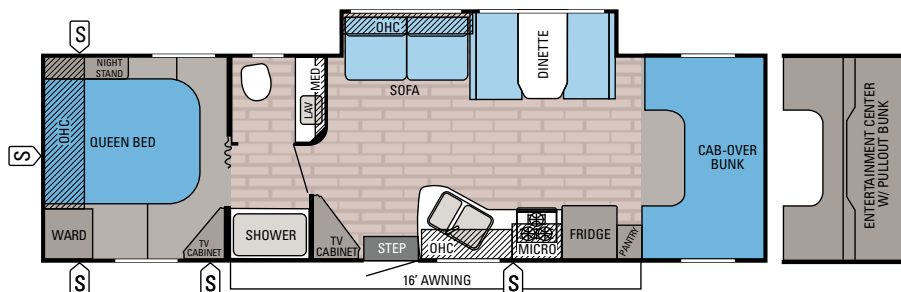

### GREYHAWK | 31FK

Exterior Length: 32' 0" Exterior Height: 11' 6" Sleeps: 5-7

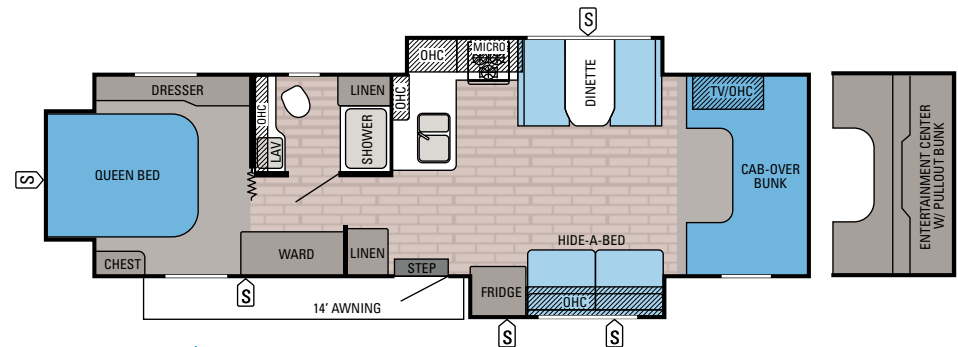

### GREYHAWK | 29ME

Exterior Length: 32' 5" Exterior Height: 11' 6" Sleeps: 5-7

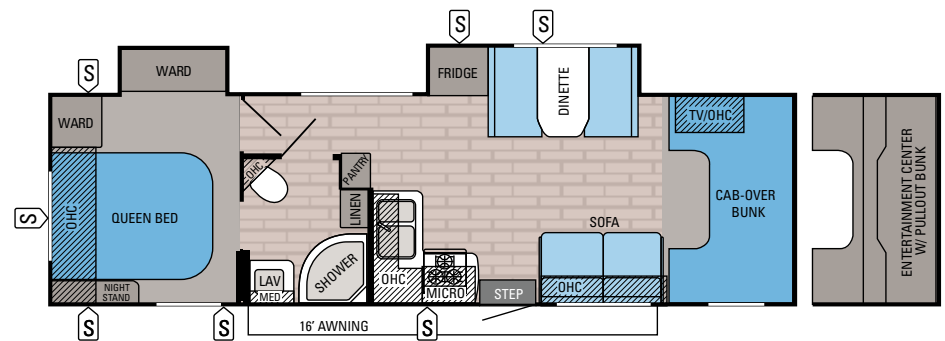

### GREYHAWK | 31DS

Exterior Length: 32' 5" Exterior Height: 11' 6" Sleeps: 5-7

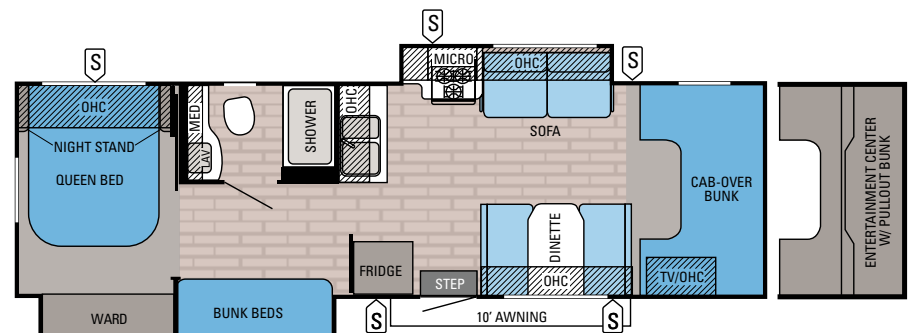

### GREYHAWK | 31FS

Exterior Length: 32' 5" Exterior Height: 11' 6" Sleeps: 7-9

## EXTERIORS



STANDARD EXTERIOR (GRAPHICS)



BLACK CRIMSON (FULL-BODY PAINT OPTION)



MAHOGANY MIST (FULL-BODY PAINT OPTION)

## STANDARDS AND OPTIONS

### CUSTOMER VALUE PACKAGE

JRide Plus: Computer-balanced drive shaft, Bilstein shock absorbers, Hellwig helper springs, rubber isolation mounts and oversized sway bar  
Hydraulic leveling jacks  
Infotainment system with in-dash, touch-screen radio with 6.5-inch LCD color display, DVD/USB, Bluetooth® and built-in GPS  
Backup and side-view cameras/monitor  
Remote-control, heated side-view mirrors  
Frameless windows  
12V electric awning with LED lights  
Tankless water heater  
1,000-watt inverter  
15,000-BTU A/C with heat pump  
24-inch LED TV in bedroom

### STANDARD DRIVING EQUIPMENT

Ford® E-450 chassis—14,500-pound GVWR, 22,000-pound GCWR  
Triton® 6.8L EFI V-10 305 HP engine with 420 lb-ft torque  
5-speed TorqShift® series transmission with overdrive  
7,500-pound hitch with 750-pound tongue capacity and 7-pin plug  
55-gallon fuel tank  
120-amp alternator  
Auxiliary start switch  
Power anti-lock brakes with power steering  
A/C and cruise control  
Tilt steering wheel  
6-way-start power driver seat  
Driver and passenger air bags  
Power windows and door locks  
Third brake light  
Steel wheel liners

### STANDARD EXTERIOR EQUIPMENT

TuffShell™ vacuum-bonded, laminated floor, sidewalls and roof  
Bead-foam insulation (R-24 max roof, R-9 max floor, R-5 max walls)  
Cream fiberglass exterior with vinyl graphics

Seamless, molded front fiberglass cap  
Fiberglass running boards and transition wings  
Fiberglass, radius-cornered entrance door with large window  
One-piece fiberglass roof  
Keyless entry door, touch-pad lock system  
Electric-powered entrance step  
High-output, marine-grade exterior speakers (2)  
Pass-through storage compartment with Slam-latch™ and light (select models)  
Locking exterior storage compartments  
Onan® 4,000-watt MicroQuiet generator  
Slideout battery tray with house battery  
Illuminated battery-disconnect switch  
12V electrical system with 120V, 60-amp power converter  
30-amp power cord  
120V GFCI-protected exterior receptacle  
56-pound propane tank  
Heated holding tanks (12V pads)  
4-inch bumper-tube with sewer hose storage  
Black tank sprayer  
Outside shower  
Roof ladder (n/a 29ME)  
Remote keyless entry

### STANDARD INTERIOR EQUIPMENT

84-inch ceiling height with padded vinyl ceiling  
High-intensity, recessed LED ceiling lights  
Honey Cherry cabinetry with raised-panel doors and deluxe hidden hinges  
Ball-bearing drawer guides  
3-burner range with 9,000-BTU SuperBurner™ and piezo igniter  
8-cubic-foot, flush-mount, double-door refrigerator  
Residential microwave oven  
Oven  
One-piece, solid-surface, high-gloss countertop with integrated deep-bowl sinks and covers (2)  
12V demand water pump  
Water filtration system  
Dream Dinette mechanism, raises and lowers dinette tabletop  
Lap safety belts on all seating areas  
Hide-a-bed sofa (29ME)  
Linoleum flooring  
Interior command center  
31,000-BTU auto-ignition furnace with wall thermostat  
32-inch digital LED HDTV  
Cable TV hookup with RG-6 coax  
Digital antenna with powered amplifier  
Satellite dish prep  
ABS shower with one-piece, decorative surround  
Skylight in shower with light  
Toilet with foot flush  
Queen-sized bed with bedspread  
Bedroom carpet with pad  
Under-bed storage (select models)  
Full cab-over bunk (750-pound rating)  
Bunk beds (300-pound rating; 31FS)

### OPTIONS

Black Crimson exterior paint  
Mahogany Mist exterior paint  
Aluminum rims  
Front entertainment center with 40-inch LED HDTV  
Outside kitchen (29KS)  
Bunk CD/DVD players (2) (31FS)

## GREYHAWK SPECIFICATIONS

MODELS		DIMENSIONS			DRIVING FEAT.	TANKS (GALS.)		
FLOORPLAN	EXTERIOR LENGTH	EXTERIOR WIDTH	EXT. HEIGHT (WITH A/C)	INTERIOR HEIGHT	WHEEL BASE	FRESH WATER CAPACITY	GREY WASTE WATER CAPACITY	BLACK WASTE WATER CAPACITY
29KS	31' 1"	100"	11' 6"	84"	212"	33	41	32
29ME	32' 5"	100"	11' 6"	84"	223"	33	41	32
29MV	32' 0"	100"	11' 6"	84"	223"	33	41	32
31DS	32' 5"	100"	11' 6"	84"	223"	33	41	32
31FK	32' 0"	100"	11' 6"	84"	223"	33	41	32
31FS	32' 5"	100"	11' 6"	84"	223"	33	41	32

**Gross Vehicle Weight Rating (GVWR):** The maximum permissible weight of the motorhome, including the Unloaded Vehicle Weight (UVW) plus passengers, personal items, all cargo, fluids, options and dealer-installed accessories. The GVWR is equal to or greater than the sum of the UVW and the Cargo Carrying Capacity.

**Gross Combined Weight Rating (GCWR):** The maximum allowable combined weight of the motorhome used as a tow vehicle and the attached towed vehicle.

It is important for your safety and enjoyment that you are aware of the weights and tow ratings of the RV you select. Consult a competent advisor for questions or advice. Whether you are new to RVing or a veteran, get a feel for the performance of your RV before heading out on the roadways. When you tow a vehicle with your RV, you must drive differently than when you drive a single vehicle. Practice hooking up, driving, backing up and braking in a safe environment or seek out professional instruction. Jayco affixes a weight label to each RV which lists weight information for that vehicle. Refer to that label to verify the vehicle will meet your requirements. See specifications chart above.



# LET'S JAYCO—AND ENJOY EVERY MILE.

We know that your family fun rides on our commitment to quality. So we go the extra mile to make products that last—and stand behind them longer than anyone in the business.



## THE JAYCO DIFFERENCE

When you go with Jayco, you get one of the industry's strongest frames and rock-solid construction.

1. **Seamless fiberglass front cap** for increased durability and ultimate weather protection
2. **750-pound overhead bunk capacity** offers nearly 250 pounds more than the industry average for greater safety and peace of mind
3. **Integrated electric step** maximizes ground clearance and floor space
4. **Third brake light** is a Class C first that improves safety on the road
5. **Seatbelts in every position** secure the most precious cargo



Generations of family fun.

## Meet your Jayco Dealer

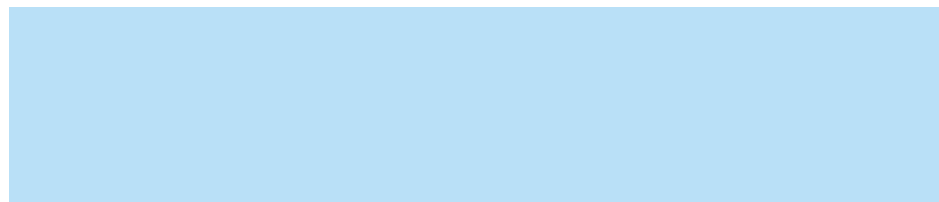

We work hard—so you can play hard. From finding the perfect Jayco for your family to providing flexible financing options and full-service support, we're here to help.

## Follow Jayco



Jayco, Inc., P.O. Box 460, Middlebury, IN 46540, [www.jayco.com](http://www.jayco.com)

 See dealer for further information and prices. All information in this brochure is the latest available at the time of publication approval. Jayco reserves the right to make changes and to discontinue models without notice or obligation. Photos in this brochure may show optional equipment and props for photography purposes. RVs built for sale in Canada may differ to conform to Canadian codes. ©2015 Jayco, Inc. 0815-60K Printed in U.S.A.

# 2

**YEAR**  
WARRANTY

Our industry-leading, bumper-to-bumper limited warranty helps you travel with confidence.

For a copy of our 2-year limited warranty with full terms and conditions, please contact your local Jayco dealer.

# FREE

**ROADSIDE  
ASSISTANCE**

Travel worry-free with Jayco's Customer First Roadside Assistance program, yours at no cost during the first year of ownership. This program is offered through Coach-Net™, the country's largest RV emergency road service, and gives you immediate access to assistance.

## eco advantage™

### Jayco's long-term commitment to generations of family fun

After four years of increased efforts to eliminate waste, conserve energy and increase recycling, we've come a long way in building RVs that are not only better for your family—but also better for the planet. **Learn more at [Jayco.com/EcoAdvantage](http://Jayco.com/EcoAdvantage)**