

Apex

BY COACHMEN

ULTRA LITE TRAVEL TRAILERS

Reaching New Heights



**Coachmen**
Recreational Vehicles
A Division of Forest River, Inc.



Apex

ULTRA LITE

APEX – LIGHT AND EASY...

Perfect for Smaller Tow Vehicles

Pack up, back up, hitch up and go. Apex Ultra Lights are perfect for towing with half ton trucks and SUVs for optimized fuel efficiency. All Apex floor plans are designed with rich, warm interiors, contemporary cabinetry, fabrics and flooring. Apex travel trailers and hybrid expandables are built incredibly lightweight and durable, with fully laminated, aluminum framed sidewalls, floor and roof.



Lightweight Durability! – APEX CONSTRUCTION

Apex is constructed with **AZDEL** vacuum bonded composite panels. AZDEL is 50% lighter than wood, increases insulation value, and won't rot, mold or sustain water damage for years of trouble free camping.

APEX IS TRA GOLD LEVEL RATED.

As a certified green RV, APEX utilizes effective production techniques in combination with healthy materials, plus efficient usage of energy and water to produce a high quality RV with less environmental impact.

These Ultra-Light Travel Trailers are designed for towing with today's half-ton trucks and SUVs, with weights ranging from under 3,000 to 6,000 lbs.



288BHS This comfortable single slide features seamless countertops, a double bowl stonecast sink, a large dinette, plenty of windows for natural light and hard bedroom privacy doors. Shown in Pebble decor.

Apex is available in three decor choices

Cayenne Shadow



Latte



Pebble

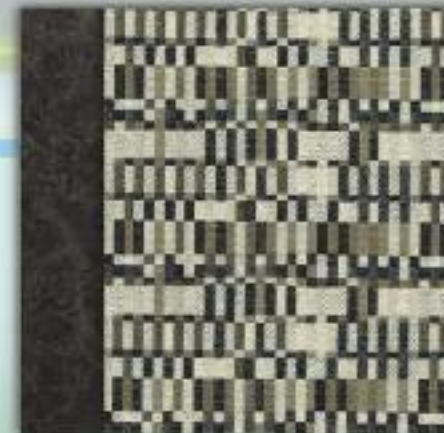



Apex

ULTRA LITE

235BHS Apex standard exterior



This convenient outside kitchen includes a Coleman grill, large refrigerator, plumbed sink, gooseneck faucet and additional storage for outdoor grilling at its best! It's standard on **215RBK** and **300BHS** models.

269RBSS There's abundant storage in this spacious walk-in pantry.





The family-friendly, **269RBSS** is a spacious, dual slide model that features both a private bedroom and is shown with an optional Hide-a-bed sofa. Standards include a double bowl island sink, a convenient walk-in pantry and a spacious dinette. This Summit Package model is shown in Cayenne Shadow decor.



Apex
NANO



This storage friendly super-lightweight Nano **191RBS** features a curved ceiling, large kitchen counter space, pantry, double bowl sink, walk-around bed, full length wardrobes, plus a generous bathroom wardrobe.

187RB



Apex



The super-lightweight **Nano 15X** is a comfortable home base for memorable family outings in the fresh air! Features include large windows, a double entry step, a 12' power awning and 14" tires.



This **Expandable Nano 15X** features dual queen beds, plenty of storage and a spacious kitchen. Shown in Latte decor.

Apex

ULTRA LITE

7-1/2 FT. MODELS

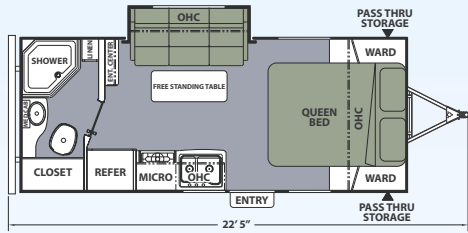

22QBS

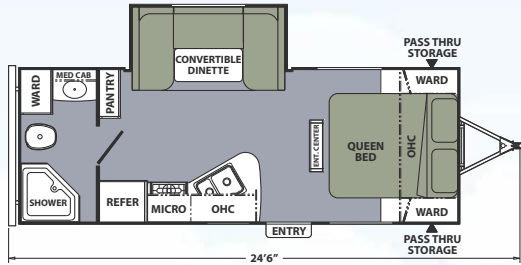

214RB

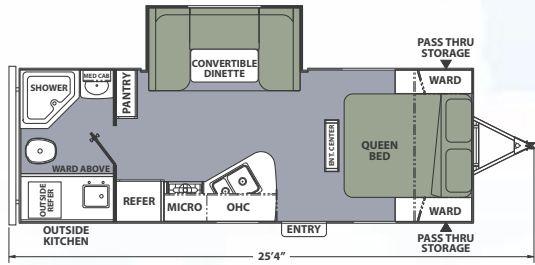

215RBK

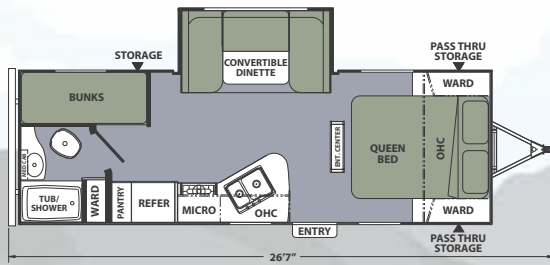

235BHS

8 FT. MODELS*

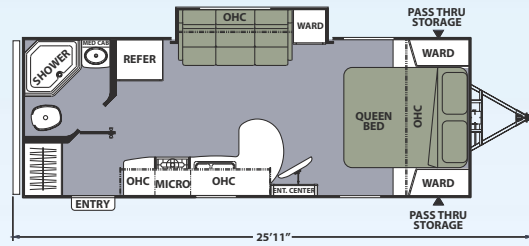

239RBS

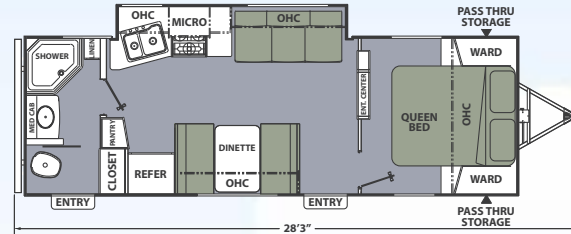

249RBS

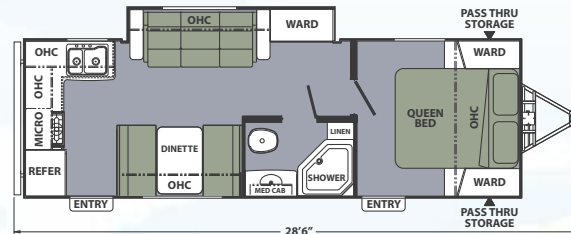

258RKS

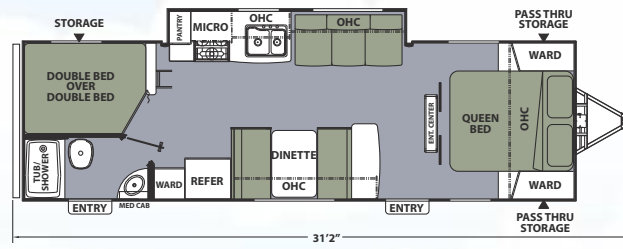

288BHS

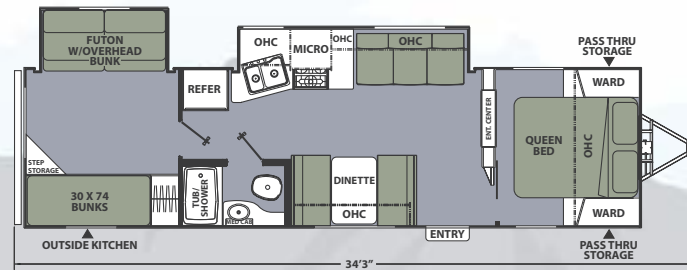

300BHS

8 FT. DEEP SLIDES*

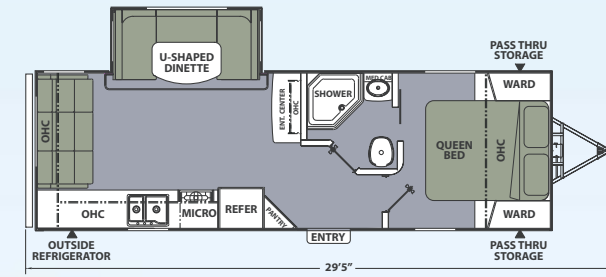

250RLS

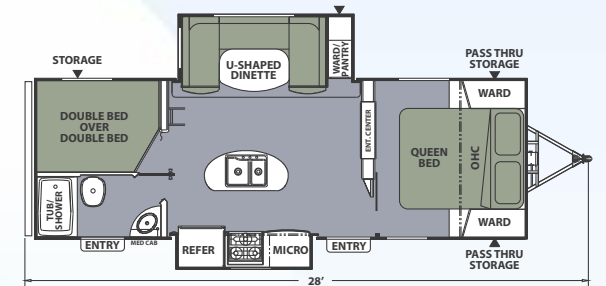

259BHSS

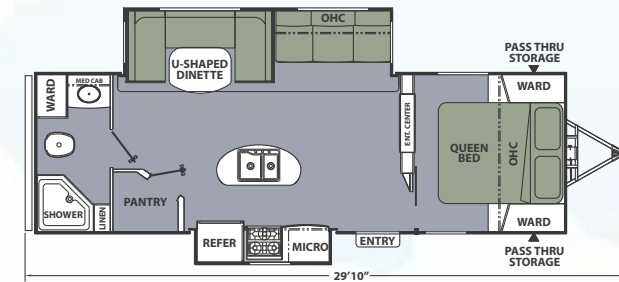

269RBS

APEX 7.5' WIDE MODELS

	22QBS	214RB	215RBK	235BHS	239RBS
UVW	3608	4111	4325	4277	4180
Hitch Weight	482	461	446	542	490
Carrying Capacity	2350	1847	2133	2181	2278
GVWR	6000	6000	6500	6500	6500
Ext. Length	22'5"	24'6"	25'4"	26'7"	25'11"
Ext. Height w/AC	10'2"	10'2"	10'2"	10'2"	10'2"
Fresh Water	30 GAL	30 GAL	30 GAL	30 GAL	50 GAL
Gray Water	30 GAL	30 GAL	30 GAL	30 GAL	35 GAL
Waste Water	30 GAL	30 GAL	30 GAL	30 GAL	35 GAL

APEX NANOS

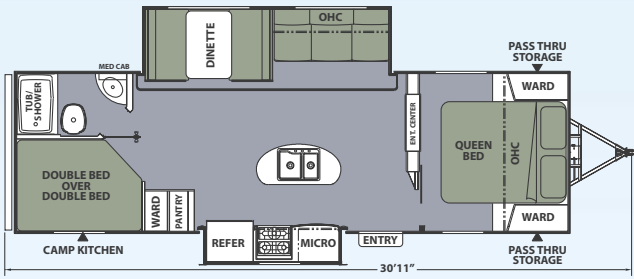

276BHSS

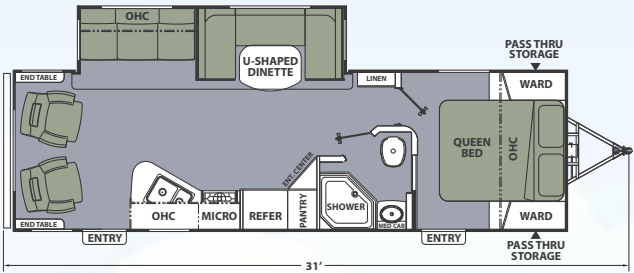

279RLSS

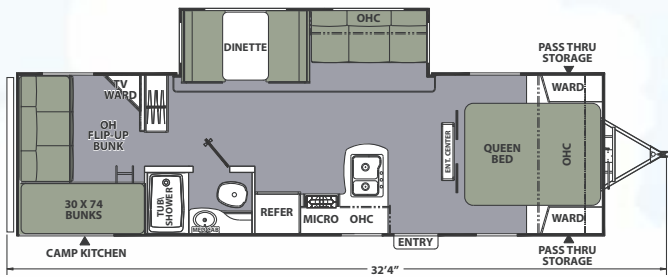

289TBSS

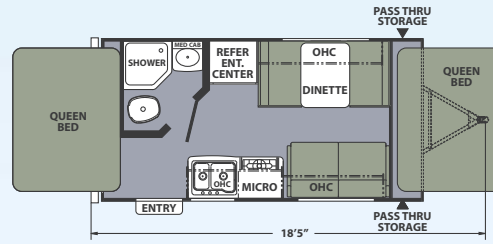

15X

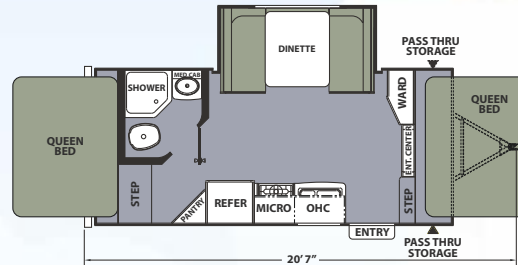

17X

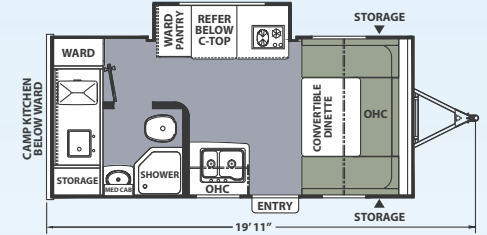

172CKS

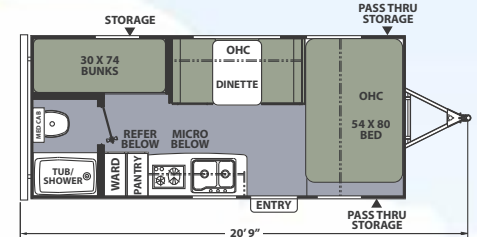

185BH

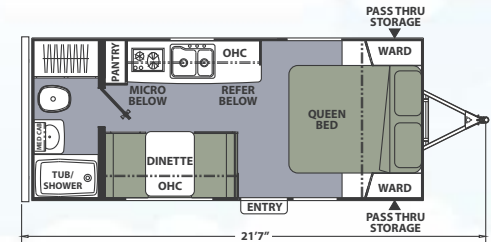

187RB

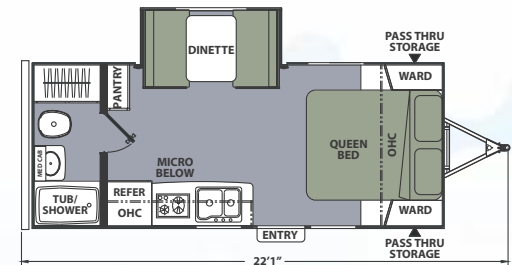

191RBS

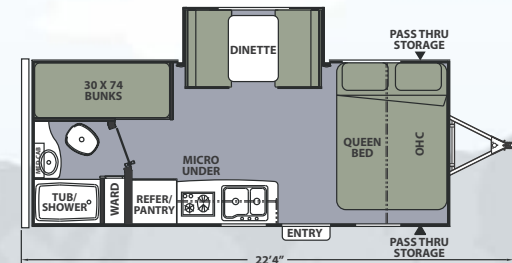

193BHS

GVWR (Gross Vehicle Weight Rating) is the maximum permissible weight of the unit when fully loaded. It includes all weights, inclusive of all fluids, cargo, optional equipment and accessories. For safety and product performance do NOT exceed the GVWR.

GAWR (Gross Axle Weight Rating) is the maximum permissible weight, including cargo, fluids, optional equipment and accessories that can be safely supported by a combination of all axles.

UVW (Unloaded Vehicle Weight)* is the typical weight of the unit as manufactured at the factory. It includes all weight at the unit's axle(s) and tongue or pin and LP Gas. The UVW does not include cargo, fresh potable water, additional optional equipment or dealer installed accessories. *Estimated Average based on standard build optional equipment.

CCC (Cargo Carrying Capacity)** is the amount of weight available for fresh potable water, cargo, additional optional equipment and accessories. CCC is equal to GVWR minus UVW. Available CCC should accommodate fresh potable water (8.3 lbs per gallon). Before filling the fresh water tank, empty the black and gray tanks to provide for more cargo capacity. **Estimated average based on standard build optional equipment.

Each Forest River RV is weighed at the manufacturing facility prior to shipping. A label identifying the unloaded vehicle weight of the actual unit and the cargo carrying capacity is applied to every Forest River RV prior to leaving our facilities. The load capacity of your unit is designated by weight, not by volume, so you cannot necessarily use all available space when loading your unit.

8' WIDE MODELS*				8' WIDE DEEP SLIDES*						APEX NANOS							
249RBS	258RKS	288BHS	300BHS	250RLS	259BHSS	269RBS	276BHSS	279RLSS	289TBSS	15X	17X	172CKS	185BH	187RB	191RBS	193BHS	
4914	4871	4992	5980	5170	5330	5550	5660	5450	5965	2900	3732	3262	2830	3014	3315	3350	
480	675	585	680	550	680	720	740	620	812	360	456	336	350	316	382	406	
2228	1587	2116	1578	1788	2128	2008	1898	2108	1597	858	2268	1268	949	765	1164	1229	
7000	6500	7000	7600	7000	7500	7600	7600	7600	7600	3800	6000	4500	3800	3800	4500	4600	
28'3"	28'6"	31'2"	34'3"	29'5"	28'	29'10"	30'11"	31'	32'4"	18'7"	20'7"	19'11"	20'9"	21'7"	22'1"	22'4"	
10'2"	10'2"	10'2"	10'4"	10'8"	10'8"	10'8"	10'8"	10'8"	10'8"	9'10"	9'10"	9'9"	9'7"	9'7"	9'9"	9'9"	
50 GAL	50 GAL	50 GAL	50 GAL	50 GAL	50 GAL	50 GAL	50 GAL	50 GAL	50 GAL	30 GAL	30 GAL	30 GAL	30 GAL	30 GAL	30 GAL	30 GAL	
35 GAL	35 GAL	35 GAL	35 GAL	35 GAL	35 GAL	35 GAL	70 GAL	35 GAL	35 GAL	30 GAL	30 GAL	30 GAL	30 GAL	30 GAL	30 GAL	30 GAL	
35 GAL	35 GAL	35 GAL	35 GAL	35 GAL	35 GAL	35 GAL	35 GAL	35 GAL	35 GAL	30 GAL	30 GAL	30 GAL	30 GAL	30 GAL	30 GAL	30 GAL	

*All 8' Wides include the Elite and Summit Packages (150 lbs.)



Standard Features

INTERIOR AND DÉCOR

- ▲ Glazed Grace Cherry cabinetry
- ▲ Overhead bedroom cabinets
- ▲ Sealed edge countertops
- ▲ Congoleum Carefree flooring
- ▲ Mini-blinds - throughout
- ▲ Pedestal dinette table
- ▲ Large oversized booth - U-shaped dinette
- ▲ 68" Residential sofa (Most models)
- ▲ Energy efficient LED interior lighting
- ▲ Hardwood mortise & tenon cabinet door frames
- ▲ Stile & rail cabinet front construction
- ▲ LP leak alarm
- ▲ Fire extinguisher
- ▲ Smoke alarm
- ▲ Carbon monoxide detector

ELECTRICAL/ HEATING/AC

- ▲ Furnace - forced air/ducts per floorplan
- ▲ 55 Amp power center
- ▲ Outside receptacle GFI
- ▲ Patio light
- ▲ TV antenna with cable TV hookups
- ▲ AM/FM/CD player
- ▲ 2 Outside speakers
- ▲ Ducted air conditioner (8' Wides)
- ▲ Detachable power cord

GALLEY

- ▲ Microwave
- ▲ 3-Burner cooktop with oven
- ▲ Double door refrigerator
- ▲ Power/lighted range hood
- ▲ Brushed nickel hardware
- ▲ Stonecast double bowl sink

BATH AND WATER

- ▲ Power bath vent
- ▲ 6 Gal. gas/elec. DSI hot water heater
- ▲ Water heater bypass valve
- ▲ Demand water pump
- ▲ Medicine cabinet
- ▲ Below floor low point drains
- ▲ Foot flush toilet
- ▲ Tub surround
- ▲ Glass shower door - 34" neo-angle showers

SLEEPING

- ▲ Reversible plush comforter
- ▲ Evergreen sleep mattress
- ▲ Bunk shelves - double over double

EXTERIOR/ CONSTRUCTION

- ▲ 13.5 Roof A/C
- ▲ Power awning
- ▲ Spare tire kit with spare tire
- ▲ 4 Stabilizer jacks
- ▲ LP port
- ▲ Double 20# LP tanks
- ▲ Rubber roof

- ▲ Fully laminated aluminum framed radius rubber roof - R-11 (7-1/2' Wides)

- ▲ Fully laminated aluminum framed radius rubber roof - R-14 (8' Wides)

- ▲ Vacuum bond Azdel/fiberglass sidewalls (Additional R-2)

- ▲ Laminated aluminum framed fully insulated sidewalls - R-9

- ▲ Laminated aluminum framed floor - R-11

- ▲ Gutter rail
- ▲ Dead bolt lock

- ▲ Tinted safety glass radius windows
- ▲ Radius entrance door

- ▲ Radius thumb latch baggage doors
- ▲ I-beam chassis construction

- ▲ Corrosion resistant powder coated frame

- ▲ Dual battery tray
- ▲ Heated/enclosed holding tanks (8' Wides)

- ▲ Break away switch
- ▲ Schwintek slide room system (N/A Deep slides)

- ▲ Lighted pass-thru storage
- ▲ Double entry step

- ▲ EZ lube axles
- ▲ Nitro filled radial tires

- ▲ Gray exterior fiberglass
- ▲ Exterior door side cable hook-up

- ▲ Aluminum rims

Optional Features

▲ APEX ELITE PACKAGE (MANDATORY ON 8' WIDES)

- Hard valances with side curtains
- Night shades
- Dual sink cover
- AM/FM/CD/DVD/Bluetooth stereo
- 24" LED TV (7-1/2' Wides)
- 32" LED TV (8' Wides with entertainment center)
- Access doors under dinette
- Ground effects (Metal skirting & ABS fender skirts)
- Slam latch doors at pass thru
- Black tank flush

- Magnetic door catches
- Stone guard
- Hot/cold outside shower
- Bottle covers
- Apex fleece blanket - Sofa models

▲ SUMMIT PACKAGE*

- Painted fiberglass front cap with LED lighting
- Blue awning LED rope lighting
- Power tongue jack with light
- Swing-away assist handle at main entry
- Backsplash behind stove
- Black metal refrigerator panels

- Hi-rise kitchen faucet with pull-out sprayer
- Crown molding with LED uplighting in kitchen (N/A 259BHSS, 269RBSS, 276BHSS)
- Built-in headboard shelf with LED light and USB ports

ADDITIONAL OPTIONS

- ▲ Frameless dark tint windows
- ▲ 15,000 BTU roof air conditioner
- ▲ Tri-fold Destination Hide-a-Bed sofa (Deep slide models)

*The Apex Elite Package is required with the Summit Package.

HALF TON & SUV TOWABLE

From 18' to 34' - All units are less than 6,000 lbs. Apex Ultra-Light Travel Trailers are designed for towing by today's half-ton trucks and SUVs.



STONE CAST SINK (N/A Nano models)

- ▲ Double bowl
- ▲ Stain resistant
- ▲ Heat resistant up to 500°



MAGNETIC DOOR CLOSURES (Elite Package)

- ▲ Holds door up and out of the way while accessing storage



AZDEL COMPOSITE PANELS

- ▲ 50% Lighter than wood
- ▲ Will not rot, mold or sustain water damage
- ▲ Increases insulation value

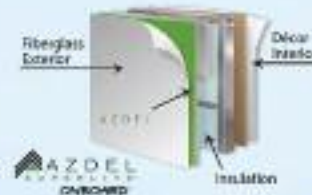

VACUUM BONDED WALLS, ROOF AND FLOOR

- ▲ Stronger construction
- ▲ Lighter weight



APEX IS TRA GOLD LEVEL RATED.

As a certified green RV, APEX utilizes effective production techniques in combination with healthy materials, plus efficient usage of energy and water to produce a high quality RV with less environmental impact.



LED INTERIOR LIGHTING

- ▲ Energy efficient
- ▲ Long lasting



ONE-PIECE SEAMLESS COUNTERTOP

- ▲ Stain resistant
- ▲ Lighter weight
- ▲ No T-mold (Helps prevent water damage)



WELDED ALUMINUM FRAMING (Including front cage)

- ▲ All cutouts - windows, doors, vents, compartments
- ▲ Lighter weight
- ▲ Will not rot



POWER AWNING

- ▲ Available on all APEX models
- ▲ Long-lasting LED lights (Summit Package)



VACUUM BONDED ONE-PIECE ALUMINUM ROOF

- ▲ Even insulation that will not deteriorate
- ▲ Durable, walk-on roof
- ▲ Less weight



5

AVAILABLE FIBERGLASS FRONT CAP

- ▲ Wrap around design (Better aerodynamics and towability with a high end look)
- ▲ Painted not infused
- ▲ With LED marker lights



7

APEX

10

9

8

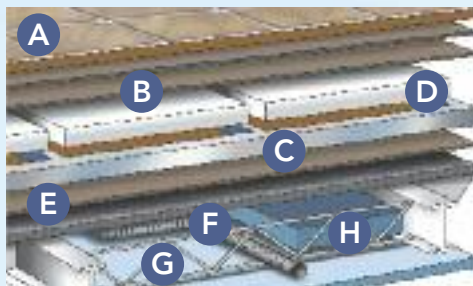

SIX LAYER LAMINATED FLOOR

- A Residential durable floor covering
- B Double layer Luan plywood top decking
- C Welded aluminum frame
- D Block foam structural insulation
- E Luan plywood bottom decking
- F Darco waterproof floor wrap
- G Cross member support
- H Holding tank

CONSTRUCTION FEATURES

- 3M breathable graphics
- Tinted, safety glass windows
- Welded Aluminum structure, vacuum-bonded sidewalls, floor and roof
- Aluminum reinforced laminated roof
- EDPM rubber roofing
- Azdel Composite Panels
- Aerodynamic front profile (Shown with painted front cap - Summit Pkg.)
- Dual 20 lb. LP gas tanks
- Insulated slam latch doors with magnetic hold ups (Elite Package)
- Smooth exterior fiberglass skin
- Aluminum framed openings
- Fully enclosed, heated under belly (8' wide models)
- Fully welded tubular aluminum floor structure
- Schwintek™ and rack and pinion slide systems (Deep slides)
- Congoleum Carefree resilient flooring
- Powder E-coated, welded I-beam frame
- Super-Lube® axle hubs
- Nitrogen filled radial tires

Apex NANO

Standard Features

INTERIOR AND DÉCOR

- ▲ Glazed Grace Cherry cabinetry
- ▲ Overhead bedroom cabinets
- ▲ One-piece sealed edge countertops
- ▲ Congoleum Carefree flooring
- ▲ Mini-blinds throughout
- ▲ Pedestal dinette table
- ▲ Large oversized booth/U-shaped dinette
- ▲ Hardwood mortise & tenon cabinet door frames
- ▲ Reversible plush comforter (Select models)
- ▲ Stile & rail cabinet front construction
- ▲ 2" Thick insulated floor
- ▲ LP leak alarm
- ▲ Fire extinguisher
- ▲ Smoke alarm
- ▲ Carbon monoxide detector

ELECTRICAL/ HEATING/AC

- ▲ Outside receptacle GFI
- ▲ Patio light
- ▲ Detachable power cord

GALLEY

- ▲ Microwave
- ▲ Black appliances
- ▲ Brushed nickel hardware

BATH AND WATER

- ▲ Power bath vent
- ▲ Water heater bypass valve
- ▲ Demand water pump
- ▲ Hand-crafted wood medicine cabinet
- ▲ Below floor low point drains
- ▲ Foot flush toilet

EXTERIOR/ CONSTRUCTION

- ▲ 20# LP tank
- ▲ Rubber roof
- ▲ Vacuum bond Azdel/fiberglass sidewalls (R-9)
- ▲ Gutter rail
- ▲ Dead bolt lock
- ▲ Tinted safety glass radius windows
- ▲ Radius entrance door with window
- ▲ Radius thumb latch baggage doors
- ▲ Corrosion resistant powder coated frame
- ▲ Dual battery tray
- ▲ Break away switch
- ▲ Stone guard
- ▲ Pass-thru storage
- ▲ Double entry step
- ▲ EZ lube axles
- ▲ Nitro filled radial tires

Nano Package (Mandatory)

- ▲ Vacuum bond Azdel fiberglass sidewalls
- ▲ Vacuum bond laminated crowned roof/ceiling
- ▲ Aluma-cage construction
- ▲ Welded aluminum framed floor
- ▲ Schwintek slide room system
- ▲ Insulated floor with seamless decking
- ▲ High efficiency LED interior lighting
- ▲ 2 Outside speakers
- ▲ Stabilizer jacks (4)
- ▲ TV antenna with cable hookups
- ▲ DSI water heater
- ▲ Microwave
- ▲ 3.0 Cu. ft. 2-way refrigerator (4.0 cu. ft. 15X, double door 17X)
- ▲ 2-Burner cooktop
- ▲ AM/FM/CD Stereo
- ▲ Skylight in bath
- ▲ Evergreen sleep mattress
- ▲ Gray exterior fiberglass
- ▲ LP port

Optional Features

▲ COMFORT PACKAGE

- 13.5 BTU roof air conditioner
- 20,000 BTU direct vent furnace
- Power awning

ADDITIONAL OPTION

- ▲ Spare tire and carrier

Apex



Expand Your Horizons

Apex Nano Expandables are the perfect lightweight solution for families on the go. They're easy to tow – and easy to set up for years of fun-filled outdoor adventure.

15X Apex Nano Expandable



BIG BENEFITS FOR NEW OWNERS

FREE One Year Membership – Coachmen Owners Association! Coachmen is proud to sponsor the largest manufacturer sponsored camping club in North America...

Coachmen Owners' Association (COA). COA provides you a world of ways to enjoy your RV. This is FUN ON OVERDRIVE and provides: Free Trip Routing, Exciting Tours & Rallies, Free Campground Directory, Local/State Club Activities, Easy RVing Magazine Free, Theme Park Discounts, Fuel Discounts, Free onebigplanet® Memberships with discounts at 180,000 merchants and Much More! Every new Coachmen RV buyer is eligible for a 1 Year FREE membership in the Coachmen Owners' Association. It all adds up to an easy ownership experience!



TRAVEL EASY™ ROADSIDE ASSISTANCE

RVing is easier with Coachmen's Travel Easy™ Roadside Assistance provided FREE the first year of ownership to those who purchase a New Coachmen RV. Administered by Coach-Net, this service provides you with 24/7 operational, technical and emergency road service coverage. Also included is towing, fuel delivery, jump starts, lockout service, tire changes, mobile mechanic and unlimited technical assistance. Anywhere. Anytime. Travel Easy™ is the security of knowing that help is an easy phone call away.

Apex

ULTRA LITE

423 N. Main Street ■ P.O. Box 30
Middlebury, IN 46540

To learn more about Coachmen RV and our products and see how Coachmen is making the easy life easier, visit www.coachmenrv.com



Forest River, Inc. encourages our customers to purchase their Forest River products from a local dealership whenever possible for the following reasons:

- 1) Forest River, Inc. dealers are independently owned and operated businesses so priority service and scheduling is at their discretion and is often provided to customers that purchased their unit at that dealership.
- 2) Purchasing locally allows customers to establish meaningful relationships with a dealer, enhancing the RV experience through assistance with product questions, user tips or RV regulations for your state or country, and much more!
- 3) Canadian customers must meet requirements to bring an RV purchased out of the country to their home. These requirements may involve additional inspections and certifications, taxes and fees. Your local Canadian Dealer is a professional at meeting these requirements.
- 4) Scheduling timely warranty repairs and adjustments through a local dealership provides far greater flexibility and convenience to you, the customer!

It is the goal of Forest River, Inc. that all of our RV owners fully enjoy the RV experience and that customer satisfaction meets or exceeds their expectations!



Learn More
Scan this barcode using a QR Reader on your smart phone to learn more about Forest River.



A Berkshire Hathaway company.

Your Apex Dealer

All information contained in this brochure is believed to be accurate at the time of publication. However, during the model year, it may be necessary to make revisions and Coachmen reserves the right to make all such changes without notice, including prices, colors, materials, equipment and specifications as well as the addition of new models and the discontinuance of models shown in this brochure. Therefore, please consult with your Coachmen dealer and confirm the existence of any materials, design or specifications that are material to your purchase decision.

©2015 Coachmen RV a Division of Forest River, Inc., A Berkshire Hathaway company. All Rights Reserved. 9/15