

# SOLAIRE

BY PALOMINO



X

SOLAIRE  
BY PALOMINO  
ULTRA  
SUPER LITE

SOLAIRE  
BY PALOMINO  
*Forever*  
EDITION

163 X IN ASH

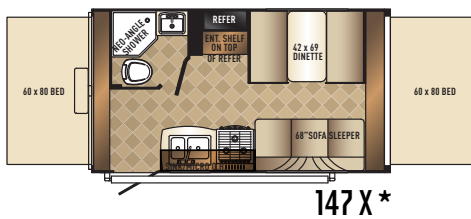

147 X \*

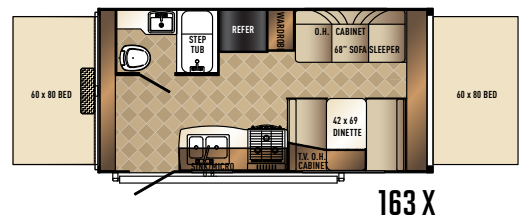

163 X

HITCH DRY WEIGHT (LBS.)	315	EXTERIOR WIDTH	8'
DRY AXLE WEIGHT (LBS.)	2720	TRAVEL LENGTH	18'6"
TOTAL DRY WEIGHT (LBS.)	3035	FRESH WATER CAPACITY (GAL.)	30
GVWR (LBS.)	3815	GRAY WATER CAPACITY (GAL.)	30
UNLOADED VEHICLE WEIGHT (LBS.) *	3069	BLACK WATER CAPACITY (GAL.)	30
INTERIOR HEIGHT	6' 8"	CARGO CARRYING CAPACITY (LBS.)	746
EXTERIOR HEIGHT **	9'3"		

HITCH DRY WEIGHT (LBS.)	400	EXTERIOR WIDTH	8'
DRY AXLE WEIGHT (LBS.)	3169	TRAVEL LENGTH	20'2"
TOTAL DRY WEIGHT (LBS.)	3569	FRESH WATER CAPACITY (GAL.)	30
GVWR (LBS.)	4996	GRAY WATER CAPACITY (GAL.)	30
UNLOADED VEHICLE WEIGHT (LBS.) *	3603	BLACK WATER CAPACITY (GAL.)	30
INTERIOR HEIGHT	6' 8"	CARGO CARRYING CAPACITY (LBS.)	3797
EXTERIOR HEIGHT **	9'3"		

SEE BACK PAGE FOR SPECIFICATION DEFINITIONS.



SOLAIRE

# EXPANDABLES



190 X

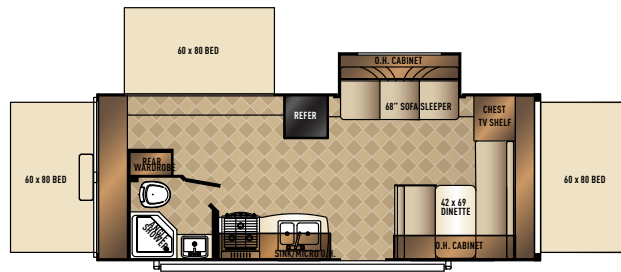

213 X

HITCH DRY WEIGHT (LBS.)	620	EXTERIOR WIDTH	8'
DRY AXLE WEIGHT (LBS.)	3990	TRAVEL LENGTH	22'10"
TOTAL DRY WEIGHT (LBS.)	4610	FRESH WATER CAPACITY (GAL.)	30
GVWR (LBS.)	5996	GRAY WATER CAPACITY (GAL.)	30
UNLOADED VEHICLE WEIGHT (LBS.) *	4644	BLACK WATER CAPACITY (GAL.)	30
INTERIOR HEIGHT	6' 8"	CARGO CARRYING CAPACITY (LBS.)	2976
EXTERIOR HEIGHT **	9'3"		

HITCH DRY WEIGHT (LBS.)	532	EXTERIOR WIDTH	8'
DRY AXLE WEIGHT (LBS.)	3782	TRAVEL LENGTH	25'2"
TOTAL DRY WEIGHT (LBS.)	4314	FRESH WATER CAPACITY (GAL.)	30
GVWR (LBS.)	5996	GRAY WATER CAPACITY (GAL.)	30
UNLOADED VEHICLE WEIGHT (LBS.) *	4348	BLACK WATER CAPACITY (GAL.)	30
INTERIOR HEIGHT	6' 8"	CARGO CARRYING CAPACITY (LBS.)	3184
EXTERIOR HEIGHT **	9'3"		

\* 147 X SINGLE AXLE WITH 5 CU. FT. REFRIGERATOR AND NO DUCTED A/C.

# WELCOME TO THE REDESIGNED SOLAIRE ULTRA SERIES

We've always been proud to build an excellent product and this year we are continuing our tradition with three new option packages. Competitively priced, and loaded with features, it's easy to find your perfect fit. Choose from three trendy interior options: Mocha, Almond, or Ash.



MOCHA



ALMOND



ASH



315 RLTSEK IN ALMOND

## SOLAIRE ULTRA LITES

The Ultra Lite trailers approach the light-weight class with special emphasis on towability. Matched with the Dexter® Tor Flex Torsion Axle and you have a very smooth towing experience compared to other competitor's products. With a new approach Solaire trailers are available at three different price points.



**SOLAIRE**  
BY PALOMPO  
**ULTRA**  
SUPER LITE

239 DSBH IN MOCHA WITH TOURING PACKAGE



SOLAIRE  
by PALOMINO  
*Touring*  
EDITION

251 RBSS IN MOCHA W/GT3 PACKAGE



SOLAIRE  
by PALOMINO  
**GT3**

239 DSBH IN MOCHA W/ TOURING PACKAGE



SOLAIRE  
ULTRA LITES





Dinette

239 DSBH KITCHEN W/TOURING PACKAGE



251 RBSS IN MOCHA W/GT3 PACKAGE



## CHOOSE FROM THREE VALUE LOADED PACKAGES

### SOLAIRE ULTRA SUPER LITE

- Power awning w/LED lights
- Power vent in bathroom
- Dexter Tor Flex Torsion Axles
- Co2 detector
- 4 stabilizer jacks
- Pearl infused fiberglass exterior
- 2-20 lb. LP tanks w/cover
- Gel Coated front cap
- 13,500 BTU ducted AC
- LED interior lights
- 6 gal. gas/elec DSI water heater
- 60x80 queen pillow top mattress
- Tub surround w/skylight
- Spare tire and carrier
- Jensen DVD/bluetooth/App control w/ HDMI connectivity
- Slam latch baggage doors w/magnets
- Ball bearing drawer guides
- Black tank flush
- Microwave

### SOLAIRE TOURING EDITION

- Includes all features of Ultra package
- Roller Night Shades
- 9" Denver 60 x 80 mattress
- Gel Coated full front cap protected by Line X®
- Solid Surface Kitchen Counter Tops
- Aluminum Wheels
- Power Hitch Jack
- Upgraded Bedspread

**\$5000 VALUE**





Entertainment Center / Fireplace



8. cu. ft. Refrigerator

## SOLAIRE GT3

- Includes all features of Ultra package
- Roller Nite Shades
- Gel Coated full front cap protected by Line X®
- Solid surface Counter tops
- Aluminum wheels
- Power Hitch Jack
- Upgraded bedspread
- Tri Fold Sofa
- Hi-Gloss Gel Coat Exterior Finish
- 36" Fireplace Entertainment Center
- Bonded Frameless Windows
- Power Stabilizer Jacks
- Heated Holding Tanks
- Color Matching Skirting
- Soft Close Drawers
- Water Filtration System

**\$8000 VALUE**

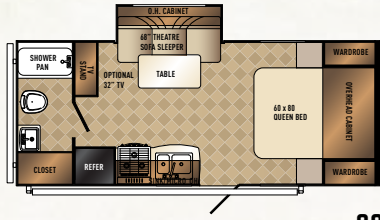

**201 SS**

HITCH DRY WEIGHT (LBS.)	460	EXTERIOR WIDTH	8'
DRY AXLE WEIGHT (LBS.)	3390	TRAVEL LENGTH	23'4"
TOTAL DRY WEIGHT (LBS.)	3850	FRESH WATER CAPACITY (GAL.)	30
GVWR (LBS.)	4996	GRAY WATER CAPACITY (GAL.)	38
UNLOADED VEHICLE WEIGHT (LBS.) *	3884	BLACK WATER CAPACITY (GAL.)	30
INTERIOR HEIGHT	6' 8"	CARGO CARRYING CAPACITY (LBS.)	3576
EXTERIOR HEIGHT	10' 10"		

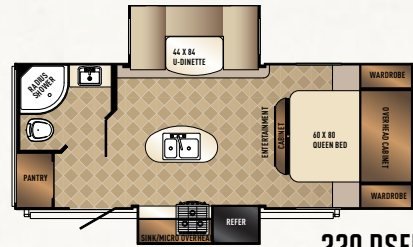

**220 DSFB**

HITCH DRY WEIGHT (LBS.)	760	EXTERIOR WIDTH	8'
DRY AXLE WEIGHT (LBS.)	4640	TRAVEL LENGTH	25'6"
TOTAL DRY WEIGHT (LBS.)	5400	FRESH WATER CAPACITY (GAL.)	30
GVWR (LBS.)	7760	GRAY WATER CAPACITY (GAL.)	68
UNLOADED VEHICLE WEIGHT (LBS.) *	5434	BLACK WATER CAPACITY (GAL.)	30
INTERIOR HEIGHT	6' 8"	CARGO CARRYING CAPACITY (LBS.)	2326
EXTERIOR HEIGHT	10' 10"		

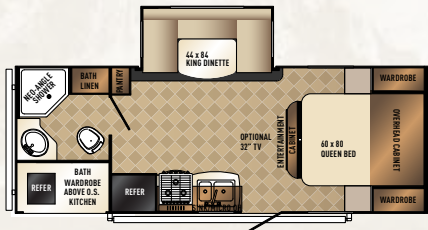

**226 RBK**

HITCH DRY WEIGHT (LBS.)	710	EXTERIOR WIDTH	8'
DRY AXLE WEIGHT (LBS.)	4305	TRAVEL LENGTH	25'10"
TOTAL DRY WEIGHT (LBS.)	5015	FRESH WATER CAPACITY (GAL.)	30
GVWR (LBS.)	7710	GRAY WATER CAPACITY (GAL.)	68
UNLOADED VEHICLE WEIGHT (LBS.) *	5049	BLACK WATER CAPACITY (GAL.)	38
INTERIOR HEIGHT	6' 8"	CARGO CARRYING CAPACITY (LBS.)	2661
EXTERIOR HEIGHT	10' 10"		

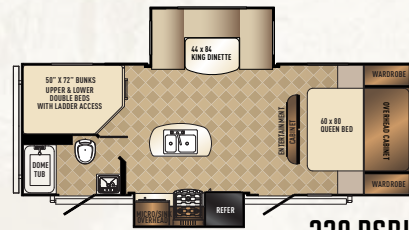

**239 DSBH**

HITCH DRY WEIGHT (LBS.)	800	EXTERIOR WIDTH	8'
DRY AXLE WEIGHT (LBS.)	4590	TRAVEL LENGTH	27'1"
TOTAL DRY WEIGHT (LBS.)	5390	FRESH WATER CAPACITY (GAL.)	30
GVWR (LBS.)	7800	GRAY WATER CAPACITY (GAL.)	76
UNLOADED VEHICLE WEIGHT (LBS.) *	5424	BLACK WATER CAPACITY (GAL.)	30
INTERIOR HEIGHT	6' 8"	CARGO CARRYING CAPACITY (LBS.)	2376
EXTERIOR HEIGHT	10' 10"		

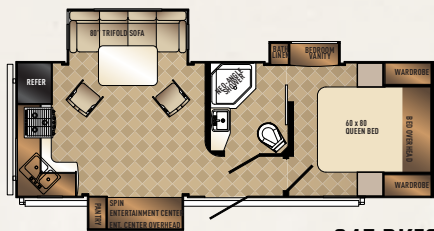

**247 RKES**

HITCH DRY WEIGHT (LBS.)	709	EXTERIOR WIDTH	8'
DRY AXLE WEIGHT (LBS.)	5272	TRAVEL LENGTH	28'0"
TOTAL DRY WEIGHT (LBS.)	5981	FRESH WATER CAPACITY (GAL.)	30
GVWR (LBS.)	8709	GRAY WATER CAPACITY (GAL.)	76
UNLOADED VEHICLE WEIGHT (LBS.) *	6015	BLACK WATER CAPACITY (GAL.)	38
INTERIOR HEIGHT	6' 8"	CARGO CARRYING CAPACITY (LBS.)	2694
EXTERIOR HEIGHT	10' 10"		

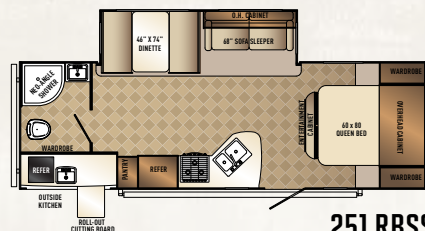

**251 RBSS**

HITCH DRY WEIGHT (LBS.)	520	EXTERIOR WIDTH	8'
DRY AXLE WEIGHT (LBS.)	4930	TRAVEL LENGTH	29'3"
TOTAL DRY WEIGHT (LBS.)	5450	FRESH WATER CAPACITY (GAL.)	30
GVWR (LBS.)	7520	GRAY WATER CAPACITY (GAL.)	76
UNLOADED VEHICLE WEIGHT (LBS.) *	5484	BLACK WATER CAPACITY (GAL.)	38
INTERIOR HEIGHT	6' 8"	CARGO CARRYING CAPACITY (LBS.)	2036
EXTERIOR HEIGHT	10' 10"		

\* SEE BACK PAGE FOR SPECIFICATION DEFINITIONS.

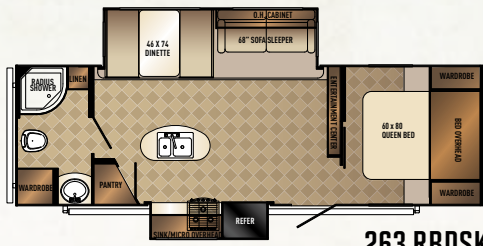

**263 RBDSK**

HITCH DRY WEIGHT (LBS.)	790	EXTERIOR WIDTH	8'
DRY AXLE WEIGHT (LBS.)	5420	TRAVEL LENGTH	30'0"
TOTAL DRY WEIGHT (LBS.)	6210	FRESH WATER CAPACITY (GAL.)	30
GVWR (LBS.)	7790	GRAY WATER CAPACITY (GAL.)	68
UNLOADED VEHICLE WEIGHT (LBS.) *	6244	BLACK WATER CAPACITY (GAL.)	38
INTERIOR HEIGHT	6' 8"	CARGO CARRYING CAPACITY (LBS.)	1546
EXTERIOR HEIGHT	10' 10"		

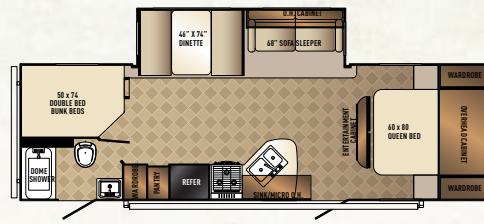

**267 BHSK**

HITCH DRY WEIGHT (LBS.)	759	EXTERIOR WIDTH	8'
DRY AXLE WEIGHT (LBS.)	4855	TRAVEL LENGTH	30'11"
TOTAL DRY WEIGHT (LBS.)	5614	FRESH WATER CAPACITY (GAL.)	30
GVWR (LBS.)	7759	GRAY WATER CAPACITY (GAL.)	76
UNLOADED VEHICLE WEIGHT (LBS.) *	5648	BLACK WATER CAPACITY (GAL.)	38
INTERIOR HEIGHT	6' 8"	CARGO CARRYING CAPACITY (LBS.)	2111
EXTERIOR HEIGHT	10' 10"		

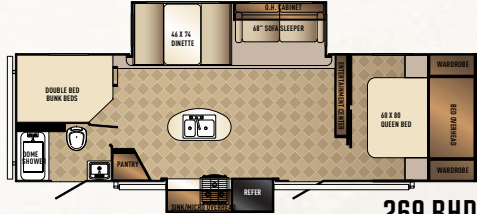

**269 BHDSK**

HITCH DRY WEIGHT (LBS.)	990	EXTERIOR WIDTH	8'
DRY AXLE WEIGHT (LBS.)	5330	TRAVEL LENGTH	32'3"
TOTAL DRY WEIGHT (LBS.)	6320	FRESH WATER CAPACITY (GAL.)	30
GVWR (LBS.)	8990	GRAY WATER CAPACITY (GAL.)	76
UNLOADED VEHICLE WEIGHT (LBS.) *	6354	BLACK WATER CAPACITY (GAL.)	38
INTERIOR HEIGHT	6' 8"	CARGO CARRYING CAPACITY (LBS.)	2636
EXTERIOR HEIGHT	10' 10"		

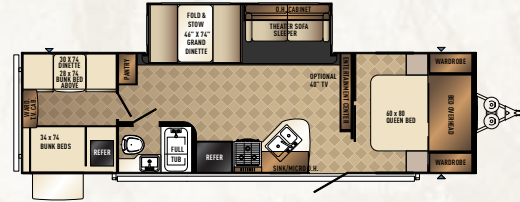

**292 QBSK**

HITCH DRY WEIGHT (LBS.)	885	EXTERIOR WIDTH	8'
DRY AXLE WEIGHT (LBS.)	4970	TRAVEL LENGTH	33'4"
TOTAL DRY WEIGHT (LBS.)	5855	FRESH WATER CAPACITY (GAL.)	30
GVWR (LBS.)	7885	GRAY WATER CAPACITY (GAL.)	38
UNLOADED VEHICLE WEIGHT (LBS.) *	5889	BLACK WATER CAPACITY (GAL.)	38
INTERIOR HEIGHT	6' 8"	CARGO CARRYING CAPACITY (LBS.)	1996
EXTERIOR HEIGHT	10' 10"		

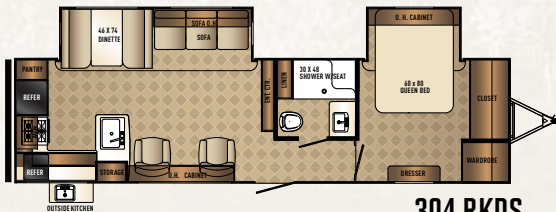

**304 RKDS**

HITCH DRY WEIGHT (LBS.)	TBD	EXTERIOR WIDTH	8'
DRY AXLE WEIGHT (LBS.)	TBD	TRAVEL LENGTH	35'8"
TOTAL DRY WEIGHT (LBS.)	TBD	FRESH WATER CAPACITY (GAL.)	30
GVWR (LBS.)	TBD	GRAY WATER CAPACITY (GAL.)	76
UNLOADED VEHICLE WEIGHT (LBS.) *	TBD	BLACK WATER CAPACITY (GAL.)	38
INTERIOR HEIGHT	6' 8"	CARGO CARRYING CAPACITY (LBS.)	TBD
EXTERIOR HEIGHT	10' 10"		

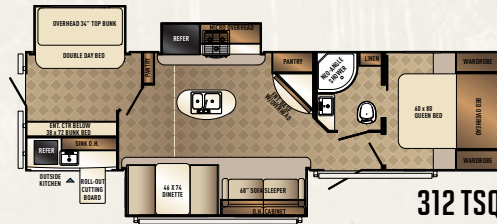

**312 TSQBK**

HITCH DRY WEIGHT (LBS.)	805	EXTERIOR WIDTH	8'
DRY AXLE WEIGHT (LBS.)	7055	TRAVEL LENGTH	35'1"
TOTAL DRY WEIGHT (LBS.)	7860	FRESH WATER CAPACITY (GAL.)	30
GVWR (LBS.)	8805	GRAY WATER CAPACITY (GAL.)	114
UNLOADED VEHICLE WEIGHT (LBS.) *	7894	BLACK WATER CAPACITY (GAL.)	30
INTERIOR HEIGHT	6' 8"	CARGO CARRYING CAPACITY (LBS.)	911
EXTERIOR HEIGHT	10' 10"		

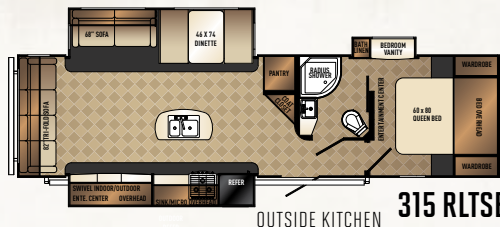

**315 RLTSK**

HITCH DRY WEIGHT (LBS.)	815	EXTERIOR WIDTH	8'
DRY AXLE WEIGHT (LBS.)	6220	TRAVEL LENGTH	35'1"
TOTAL DRY WEIGHT (LBS.)	7035	FRESH WATER CAPACITY (GAL.)	30
GVWR (LBS.)	8815	GRAY WATER CAPACITY (GAL.)	76
UNLOADED VEHICLE WEIGHT (LBS.) *	7069	BLACK WATER CAPACITY (GAL.)	38
INTERIOR HEIGHT	6' 8"	CARGO CARRYING CAPACITY (LBS.)	1746
EXTERIOR HEIGHT	10' 10"		

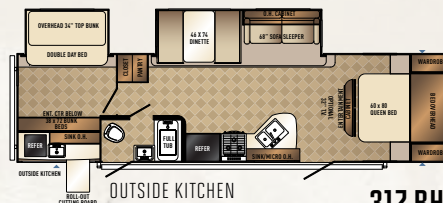

**317 BHSK**

HITCH DRY WEIGHT (LBS.)	625	EXTERIOR WIDTH	8'
DRY AXLE WEIGHT (LBS.)	6445	TRAVEL LENGTH	35'1"
TOTAL DRY WEIGHT (LBS.)	7070	FRESH WATER CAPACITY (GAL.)	30
GVWR (LBS.)	8625	GRAY WATER CAPACITY (GAL.)	38
UNLOADED VEHICLE WEIGHT (LBS.) *	7104	BLACK WATER CAPACITY (GAL.)	38
INTERIOR HEIGHT	6' 8"	CARGO CARRYING CAPACITY (LBS.)	1521
EXTERIOR HEIGHT	10' 10"		

SOLAIRE

# POPULAR FEATURES



Power Front Jack



Slam latch baggage doors



NEW Kitchen skylight with shade to let natural light in



Tinted Frameless Windows



Stabilizer Jacks



Tri-Fold Sofa Bed

## Features:

- Slam Latch baggage doors
- Dexter Tor Flex Torsion Axles
- Gel-Coated Pearl Front Cap
- Power Awning w/LED lights
- 6 sided Aluminum cage – vacuum bonded lamination
- Full walk on Laminated Roof
- 8 cu ft. extra-large refrigerator
- Glass top flush mount range cover
- LED interior lighting package
- 60 x 80 residential queen beds
- Hardwood Glazed fascia and chair rail
- Mega booth storage
- App controlled Jensen Audio system – HDMI connectivity
- Kitchen Skylight w/shade

## Options:

- Touring Pkg (see page 10 for package details)
- GT3 pkg (see page 11 for package details)
- Aluminum Wheels
- LED TV (sizes vary depending on floorplan)
- Free standing tables and chairs (N/A on all floorplans)
- Heated Holding Tanks
- Power Front Hitch Jack
- Power Stabilizer jacks (N/A on all floorplans)
- RVQ Grill
- Roller Night Shades
- Roof ladder (N/A on all floorplans)
- Solid surface counter tops
- Theater Seating

[SEE OUR WEBSITE FOR A COMPLETE LIST OF AVAILABLE OPTIONS](#)



**NEW** Hammered aluminum finish exterior kitchen counter tops.



Solaires include a standard torsion axle with independent wheel suspension and includes rubber cushioning to eliminate the metal on metal contact.



The electric awning with self-contained LED light strip provides quick and easy set-up.



LED interior lighting provides:

- 80% less power
- Emits less heat
- LED's last 30,000 hours vs. 1,000 hours of halogen

- COB (chip on board) is the latest technology in LED lighting
- COB's and bulbs are both 3200k, for consistent appearance throughout



**NEW** Slow Rise roller night shades (included in Touring and GT3 pkgs option on Ultras)



**VACUUM-BONDED LAMINATED CONSTRUCTION**

Solaire provides a fully 6 sided vacuum-bonded trailer. Our walls, floors, roof, fronts and backs are all built vacuum-bonded to ensure a light weight strong structural trailer.



**VALTED RADIUS ROOF**

Vacuum bonded radius roof with vaulted ceiling providing superior insulation and more interior height.



SOLAIRE

# SUPERIOR CONSTRUCTION

- |    |  |    |   |
|----|--|----|---|
| A. | Alpha Super Flex Membrane                                    | K. | High Density Block Foam insulation  |
| B. | Plywood Substrate  | L. | Plywood Substrate   |
| C. | Pearl Infused High Gloss Fiberglass Exterior                 | M. | Plywood Substrate   |
| D. | Plywood Substrate  | N. | Congoleum® Wood Grain Flooring  |
| E. | High Density Block Foam insulation                           | O. | Sub-floor Holding Tanks - Gray, Black and Fresh Water   |
| F. | High Density Block Foam insulation                           | P. | Aluminum Wheel Upgrade - Optional on Ultra, Standard on Touring and GT3 Packages                      |
| G. | Plywood Substrate  | Q. | Dexter Tor-Flex Torsion Axles - Rubber Cushioning Eliminates Metal-to-Metal Contact for a Softer Ride |
| H. | Gel-Coated Pearl Infused Front Cap with Rock Guard           |    |   |
| I. | Residential Shaw Carpet - r2x Stain & Soil Resistance System |    |   |
| J. | Fully Welded Aluminum Cage Super Structure                   |    |   |

SOLAIRE

# DARE TO COMPARE CHALLENGE

	SOLAIRE	BRAND X
<b>CONSTRUCTION:</b>		
Aluminum cage laminated construction	✓	
Vacuum bonded lamination: Roof, floor, sidewalls, rear wall, slide out box	✓	
Barreled walk on roof – block foam insulation for the most rigid construction available	✓	
Rack and pinion thru-frame flush floor slide out with manual override	✓	
<b>EXTERIOR:</b>		
Fully enclosed underbelly	✓	
Pearl infused gel coated front cap with stone guard	✓	
Slam latch exterior baggage doors with magnetic door catches	✓	
Dexter TORFLEX Torsion axles – independent suspension, rubber cushioning eliminates metal-to-metal contact	✓	
Extra deep tread entry step	✓	
Power awning with LED patio lights	✓	
Powder coated exterior kitchen tops and base – designed for the exterior elements	✓	
Alpha Superflex roofing – creates more usable space	✓	
<b>INTERIOR:</b>		
8 cubic foot Dometic refrigerator	✓	
Glass top flush mount range cover	✓	
LED interior lights	✓	
Hardwood cabinet doors, chair rail and fascia – no wrapped “MDF” like our competitors	✓	
46” Mega booth standard in non-island kitchen models	✓	
Skylight in every kitchen and includes a night shade	✓	
Jensen Audio system – CD/DVD/Bluetooth with App control and HDMI connectivity	✓	
Porcelain foot flush Dometic Toilet	✓	
USB charging station	✓	

SINCE 1968

# PALOMINO

Recreational Vehicles

a Division of Forest River



Forest River, Inc. encourages our customers to purchase their Forest River products from a local dealership whenever possible for the following reasons:

- 1) Forest River, Inc. dealers are independently owned and operated businesses so priority service and scheduling is at their discretion and is often provided to customers that purchased their unit at that dealership.
- 2) Purchasing locally allows customers to establish meaningful relationships with a dealer, enhancing the RV experience through assistance with product questions, user tips or RV regulations for your state or country, and much more!
- 3) Canadian customers must meet requirements to bring an RV purchased out of the country to their home. These requirements may involve additional inspections and certifications, taxes and fees. Your local Canadian Dealer is a professional at meeting these requirements.
- 4) Scheduling timely warranty repairs and adjustments through a local dealership provides far greater flexibility and convenience to you, the customer!

It is the goal of Forest River, Inc. that all of our RV owners fully enjoy the RV experience and that customer satisfaction meets or exceeds their expectations!



#### PRE-DELIVERY INSPECTION FACILITY

20,000 square feet of quality assurance. The bare essentials for a premium product. This state-of-the-art facility gives immediate daily feedback to production for quality assurance in every unit built.

#### Specification Definitions

**GVWR (Gross Vehicle Weight Rating)** - is the maximum permissible weight of the unit when fully loaded. It includes all weights, inclusive of all fluids, cargo, optional equipment and accessories. For safety and product performance do NOT exceed the GVWR.

**GAWR (Gross Axle Weight Rating)** - is the maximum permissible weight, including cargo, fluids, optional equipment and accessories that can be safely supported by a combination of all axles.

**UVW (Unloaded Vehicle Weight)\*** - is the typical weight of the unit as manufactured at the factory. It includes all weight at the unit's axle(s) and tongue or pin and LP Gas. The UVW does not include cargo, fresh potable water, additional optional equipment or dealer installed accessories.

\*Estimated average based on standard build optional equipment.

**CCC (Cargo Carrying Capacity)\*\*** - is the amount of weight available for fresh potable water, cargo, additional optional equipment and accessories. CCC is equal to GVWR minus UVW. Available CCC should accommodate fresh potable water (8.3 lbs per gallon). Before filling the fresh water tank, empty the black and gray tanks to provide for more cargo capacity.

\*\* Estimated average based on standard build optional equipment

Each Forest River RV is weighed at the manufacturing facility prior to shipping. A label identifying the unloaded vehicle weight of the actual unit and the cargo carrying capacity is applied to every Forest River RV prior to leaving our facilities.

The load capacity of your unit is designated by weight, not by volume, so you cannot necessarily use all available space when loading your unit.

All information contained in this brochure is believed to be accurate at the time of publication. However, during the model year, it may be necessary to make revisions and Forest River, Inc., reserves the right to make all such changes without notice, including prices, colors, materials, equipment and specifications as well as the addition of new models and the discontinuance of models shown in this brochure. Therefore, please consult with your Forest River, Inc., dealer and confirm the existence of any materials, design or specifications that are material to your purchase decision. Litho. U.S.A P / W: 2014.09.17

**FREE MEMBERSHIP**  
to Forest River Owners' Group

[www.forestriverfrog.com](http://www.forestriverfrog.com)



SOLAIRE DEALER

#### 24/7 EMERGENCY ROADSIDE ASSISTANCE

For a worry-free ownership experience Forest River includes one

**Coach-Net®**  
RV Technical & Roadside Assistance

year of Coach-Net RV Technical & Roadside Assistance with each RV purchase. Whether new to the RV lifestyle or an experienced RV enthusiast, Forest River owners have 24/7 access to technical, operational and emergency road service coverage throughout the US & Canada. Coach-Net's fast, dependable service is just a phone call away.



**Learn More**  
Scan this barcode using a QR Reader on your smart phone to learn more about Forest River.



A Berkshire Hathaway company.

#### PALOMINO RV

1047 EAST M-86 | COLON, MI 49040 | P: 269.432.3271 | F: 269.432.2516  
[www.palominorv.com](http://www.palominorv.com)