

WINDSPORT

MADE TO FIT
YOUR ENDEAVORS



WINDSPORT

 BY THOR MOTOR COACH

WHEN WE SAY *MADE TO FIT*, WE MEAN IT.

With so many unique models available, Thor Motor Coach motorhomes are priced to fit anyone's budget – from families buying their first motorhome, to full-timers looking for a roaming "dream home". No matter how you choose to spend your time or your money, there's a TMC motorhome that fits your needs. Welcome to the Windsport, the motorhome that is ***Made to Fit*** your travels.



31S | FUSION GREY | SYDNEY MAPLE



31S | FUSION GREY | SYDNEY MAPLE



35C | GOLDEN MINK | OLYMPIC CHERRY



35C | GOLDEN MINK | OLYMPIC CHERRY





BEAUTY INSIDE & OUT



FUSION GREY



GOLDEN MINK



TOFFEE DELIGHT

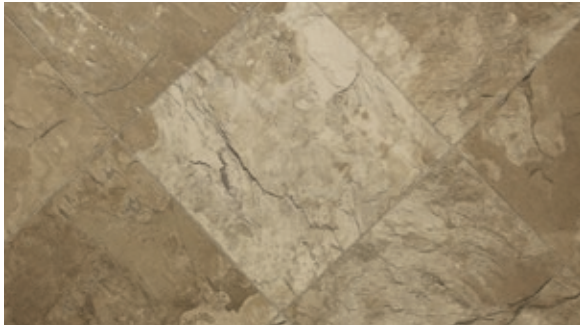

RESIDENTIAL VINYL FLOORING

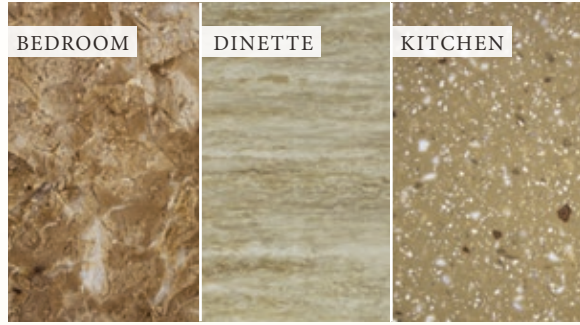

COUNTERTOPS



OLYMPIC CHERRY



SYDNEY MAPLE



LAKESHORE-CHAMPAGNE **70HD**



WINDSWEPT-CHAMPAGNE **70HD**

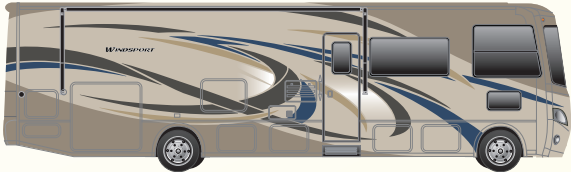

HARBOR MIST-CHAMPAGNE **70HD**
ON PARTIAL PAINT

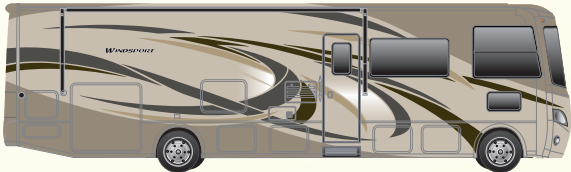

MOONBEAM-CHAMPAGNE **70HD**
ON PARTIAL PAINT

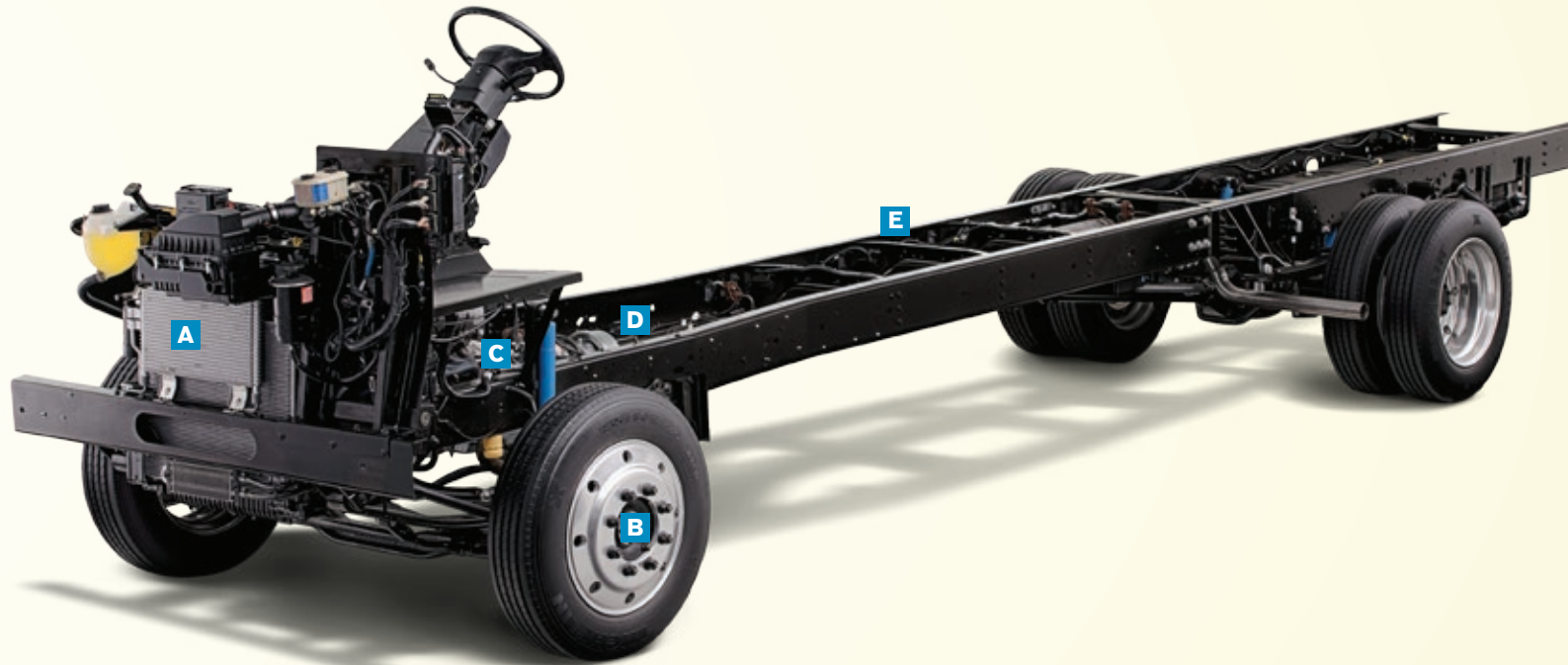

A | TRITON® V10 ENGINE

The 6.8L V10 engine has a proven track record of durability and low-hassle maintenance. Extremely smooth running with a commanding 362-horsepower and 457 lb.-ft. of torque.

B | POWER 4-WHEEL DISC ANTI-LOCK BRAKES

Maintains brake balance in heavy use and varying road conditions. Reduces wheel lock up and helps maintain superior steering control.

C | BILSTEIN SHOCKS

Long lasting, rugged shocks provide greater stability and better road handling.

D | TORQSHIFT™ 6-SPEED AUTOMATIC TRANSMISSION

Provides crisp, firm and quick shifting without sacrificing driver comfort.

E | LIMITED WARRANTY

The Ford® Motorhome Chassis has a Bumper-to-Bumper Limited Warranty for 3 years or 36,000 miles and a Powertrain Limited Warranty for 5 years or 60,000 miles, whichever comes first.

Taking the extra time to ensure the best possible structure is exactly what you deserve, and this is why Thor Motor Coach insists on vacuum-bond laminating not only the sidewalls of the motorhome, but also the floor and roof. Vacuum-bonding is the optimum manufacturing process to ensure maximum strength.



ROOF

- A** One-piece exterior TPO membrane
- B** Luan panels
- C** Aluminum structure with bowed framing
- D** Block foam insulation
- E** Interior panel with hard vinyl covering

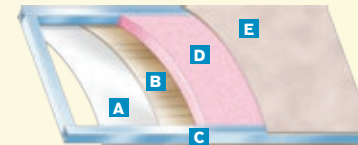

SIDEWALLS

- A** High-gloss fiberglass
- B** Luan panels
- C** Aluminum structure with framing at all openings
- D** Block foam insulation
- E** Interior panel with designer wall covering



FLOOR

- A** Residential vinyl flooring
- B** OSB structure wood base
- C** Structural steel framing
- D** Block foam insulation
- E** Luan with woven plastic exterior finish

FLOOR PLANS

29M

Chassis	Ford
Gross Vehicle (GVWR)	18,000
Gross Combined (GCWR)	23,000
Wheel Base	190"
Exterior Length (w/o ladder)	31'
Exterior Height (w/AC)	12'-2"
Exterior Width (w/o mirrors)	99"
Interior Height	82"
Awning Size	18'
Fuel (gal)	80
LPG (lbs)	88
Fresh/Waste/Gray Water (gal)	50 / 40 / 40
Water Heater (gal)	6
Furnace (BTUs)	35,000
Exterior Storage Capacity (cu. ft.)	64 / 90*

*Without Exterior Kitchen

29M

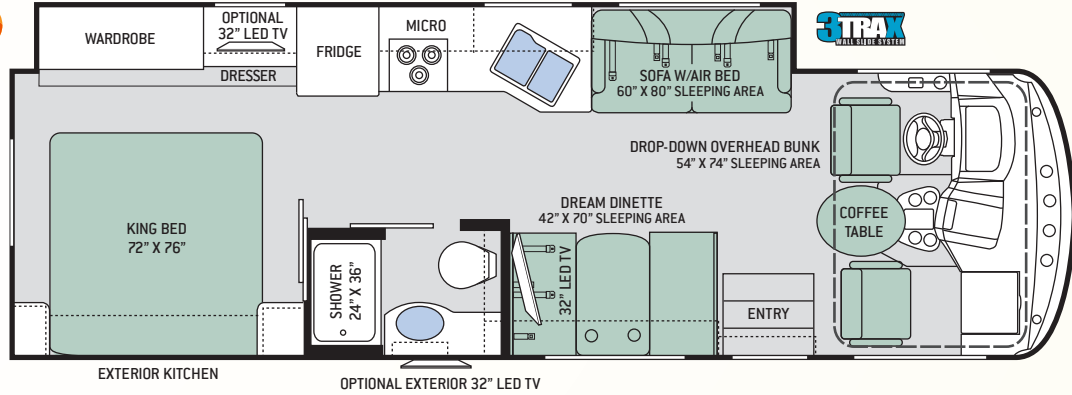

31S

Chassis	Ford
Gross Vehicle (GVWR)	18,000
Gross Combined (GCWR)	23,000
Wheel Base	190"
Exterior Length (w/o ladder)	31'-9"
Exterior Height (w/AC)	12'-2"
Exterior Width (w/o mirrors)	99"
Interior Height	82"
Awning Size	18'
Fuel (gal)	80
LPG (lbs)	88
Fresh/Waste/Gray Water (gal)	50 / 24.5 / 44
Water Heater (gal)	6
Furnace (BTUs)	35,000
Exterior Storage Capacity (cu. ft.)	67 / 91*

*Without Exterior Kitchen

31S

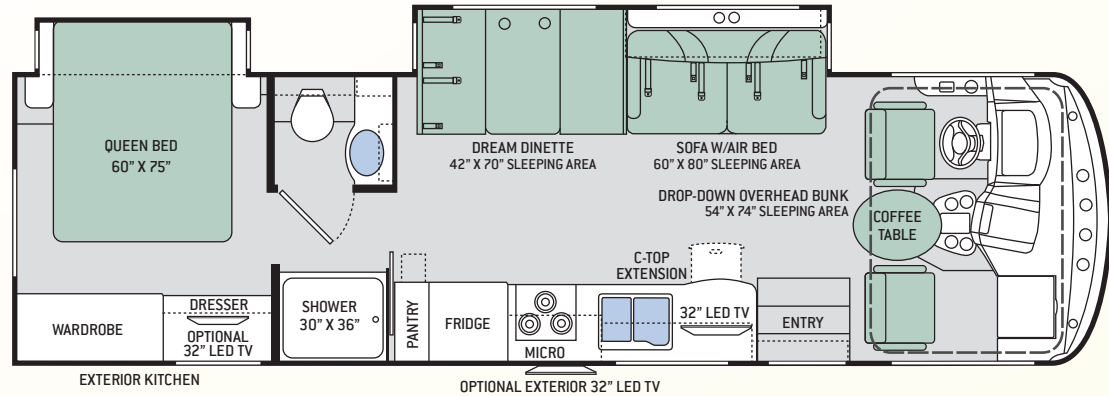

34F

Chassis	Ford
Gross Vehicle (GVWR)	22,000
Gross Combined (GCWR)	26,000
Wheel Base	242"
Exterior Length (w/o ladder)	36'-3"
Exterior Height (w/AC)	12'-2"
Exterior Width (w/o mirrors)	99"
Interior Height	82"
Awning Size	18'
Fuel (gal)	80
LPG (lbs)	88
Fresh/Waste/Gray Water (gal)	50 / 40 / 40
Water Heater (gal)	6
Furnace (BTUs)	35,000
Exterior Storage Capacity (cu. ft.)	111 / 147*

*Without Exterior Kitchen

34F

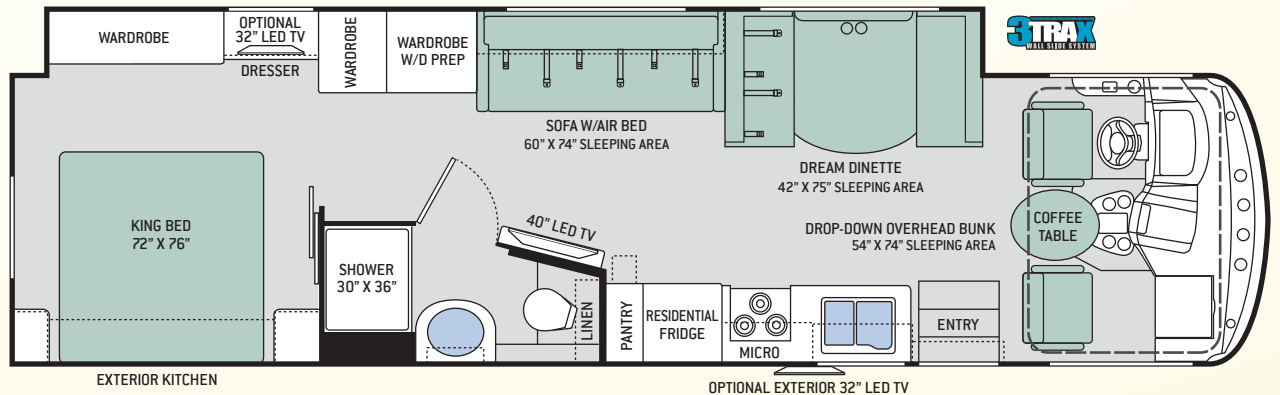

34J

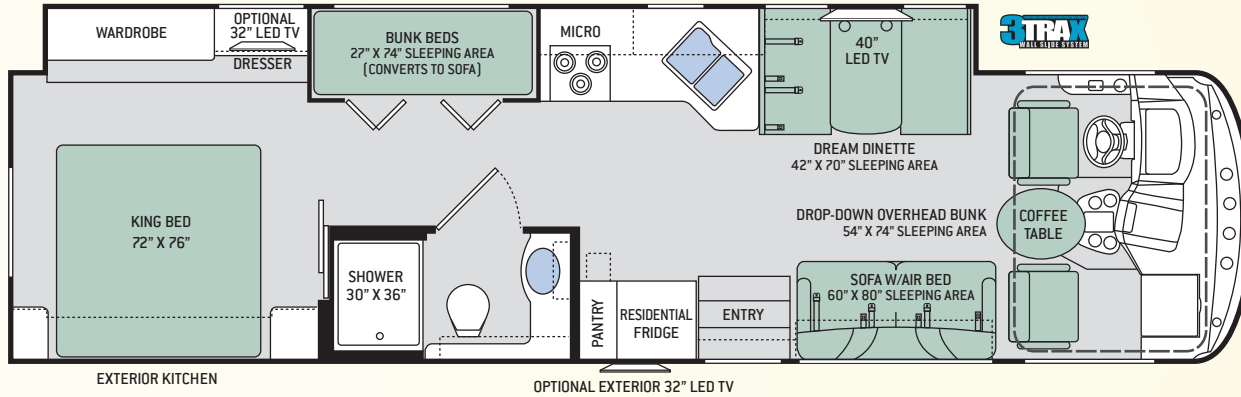

34J

Chassis	Ford
Gross Vehicle (GVWR)	22,000
Gross Combined (GCWR)	26,000
Wheel Base	242"
Exterior Length (w/o ladder)	35'-10"
Exterior Height (w/AC)	12'-2"
Exterior Width (w/o mirrors)	99"
Interior Height	82"
Awning Size	18'
Fuel (gal)	80
LPG (lbs)	88
Fresh/Waste/Gray Water (gal)	50 / 40 / 40
Water Heater (gal)	6
Furnace (BTUs)	35,000
Exterior Storage Capacity (cu. ft.)	116 / 152'

35C

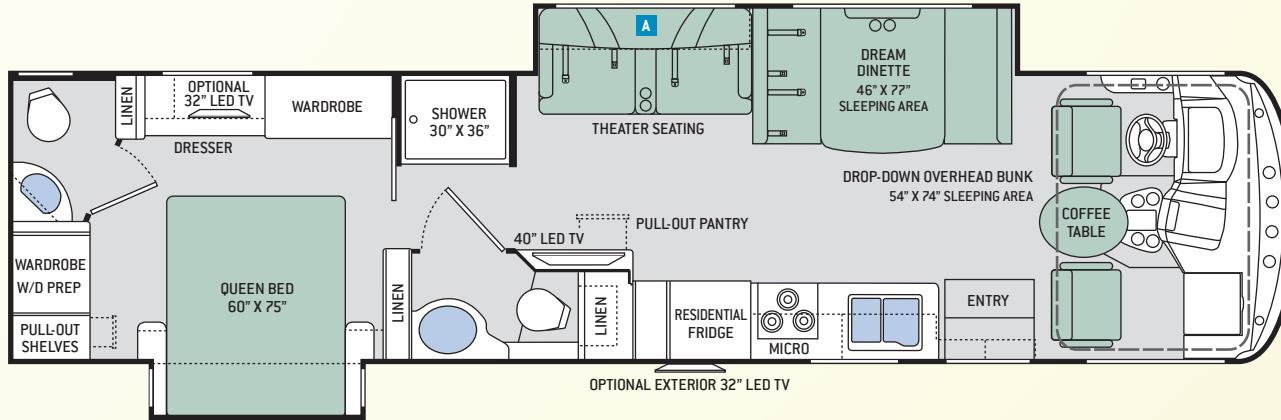

35C

Chassis	Ford
Gross Vehicle (GVWR)	22,000
Gross Combined (GCWR)	26,000
Wheel Base	242"
Exterior Length (w/o ladder)	37'
Exterior Height (w/AC)	12'-2"
Exterior Width (w/o mirrors)	99"
Interior Height	82"
Awning Size	18'
Fuel (gal)	80
LPG (lbs)	88
Fresh/Waste/Gray Water (gal)	50 / 40F-32R / 40F-29R
Water Heater (gal)	6
Furnace (BTUs)	35,000
Exterior Storage Capacity (cu. ft.)	124

OPTION



OPTIONAL SOFA W/AIR BED
60" X 74" SLEEPING AREA



3TRAX™ is our in-wall slideout system, housing all the moving and mechanical parts within the sidewall of the motorhome. This triple track design supports large rooms, like those found in full-wall slideouts, ensuring simple, reliable, maintenance-free operation. What sets 3TRAX™ apart is the patented rail system, in-floor roller guides and electric motor design. For more information, visit thormotorcoach.com/3TRAX.



Made to fit.

STANDARDS & OPTIONS

CONSTRUCTION & EXTERIOR

- Ford® F-53 Chassis – 6.8L Triton® V10 Engine, 362HP, 457 lb.-ft. Torque – TorqShift® 6-Speed Automatic with Overdrive Transmission
- One-Piece Fiberglass Front & Rear Caps
- One-Piece Windshield
- Slick Fiberglass Exterior Sidewalls
- HD-MAX® Exterior with Graphics Package
- Rotocast Storage Compartments
- Side-Hinged Flush Mount Radius Compartment Doors (In Select Areas)
- Automatic Leveling Jacks with Touchpad Controls
- Power Patio Awning with Integrated LED Lighting
- 3TRAX® Wall Slide System (29M, 34F & 34J) 
- Pet-Link™ Multi-Purpose Tie-Down
- Rubber Tread Entry Steps
- Single Electric Automatic Entry Step
- Roof Ladder
- Outside Shower
- Frameless Windows

CONSTRUCTION & EXTERIOR OPTIONS

- HD-MAX® Exterior with Graphics Package on Partial-Paint
- Frameless Dual Pane Windows

AUTOMOTIVE & COCKPIT

- Touchscreen AM/FM Dash Radio with CD Player, Bluetooth® & Back-Up Monitor
- Heated/Remote Exterior Mirrors with Integrated Side View Cameras
- Reclining/Swivel Leatherette Captain's Chairs with Stow-Away Coffee Table in Between
- Tilt Steering Wheel
- Driver Conversation Mirror
- Dash Workstation with 110-volt & 12-volt Outlets
- Fog Lights
- 19.5" Tires with Stainless Steel Wheel Liners

- 8,000-lb. Trailer Hitch with 7-pin Round Connector
- Valve Stem Extenders on Rear Tires

AUTOMOTIVE & COCKPIT OPTION

- 6-Way Power Adjustment Driver's Seat

INTERIOR

- Residential Vinyl Flooring Throughout
- 82" Interior Ceiling Height
- LED Ceiling Lights
- Ceiling Ducted Air Conditioning System
- Raised Panel Upper Cabinet Doors with Nickel Finish Hardware & Glass Inserts on Select Upper Cabinet Doors
- Full Extension Drawer Guides Throughout
- Super-Sized Dream Dinette® Booth (34F & 35C)
- Dream Dinette® Booth (29M, 31S & 34J)
- Leatherette Sofa with Air Bed (29M, 31S, 34F & 34J)
- Leatherette Theater Seating with Footrests (35C)
- Window Privacy Shades
- Power Drop-Down Hide-Away Overhead Bunk with Cotton Cloud™ Mattress & Bunk Ladder

INTERIOR OPTION

- Leatherette Sofa with Air Bed (35C)

KITCHEN

- Double Door Refrigerator (29M & 31S)
- 11 cu. ft. Residential Refrigerator with Ice Maker (34F, 34J & 35C)
- 3-Burner Gas Cooktop with Oven
- 30" Over-the-Range Microwave Oven
- Solid Surface Kitchen Countertops with Designer Backsplash & Pressed Laminate Dinette Countertop
- Large Double Bowl Kitchen Sink with Single Handle Faucet & Pull-Down Sprayer
- Countertop Extension (31S)
- Pull-Out Pantry (31S, 34F, 34J & 35C)

KITCHEN OPTION

- 12-volt Attic Fan

BEDROOM & BATHROOM

- Denver Mattress® King Size Bed (29M, 34F & 34J)
- Denver Mattress® Queen Size Bed (31S & 35C)
- Designer Headboard, Bedspread & Pillow Shams
- Bunk Beds in Hallway Slideout (34J)
- Foot Flush Porcelain Toilet
- Shower with Glass Door
- Power Vent

BEDROOM & BATHROOM OPTION

- 12-volt Attic Fan in Bedroom (29M & 31S – N/A when Rear A/C is Optioned)

ENTERTAINMENT

- 32" LED TV in Living Area (29M & 31S)
- 40" LED TV in Living Area (34F, 34J & 35C)
- 13" & 24" LED TVs & DVD Player in Bunk Bed (34J)
- Overhead Speakers above Sofa
- Cable TV & HDMI Ready
- Digital TV Antenna*
- Bluetooth® Coach Radio System in Bedroom with Exterior Speakers
- Power Charging Center for Electronics
- Exterior Kitchen with 2.6 cu. ft. Refrigerator, Sink & Portable Gas Grill (29M, 31S, 34F & 34J)

ENTERTAINMENT OPTIONS

- 32" LED TV in Bedroom
- Exterior 32" LED TV
- Storage Area with Shelf IPO Exterior Kitchen (29M, 31S, 34F & 34J)

ELECTRICAL & PLUMBING

- Cummins Onan® RV QG 4000 Gas Generator (29M & 31S)
- Cummins Onan® RV QG 5500 Gas Generator (34F, 34J & 35C)
- 30-amp Detachable Shoreline Power Cord (29M & 31S)
- 50-amp Detachable Shoreline Power Cord (34F, 34J & 35C)
- Dual Auxiliary House Batteries with Battery Tray that Holds up to Four Batteries (34F, 34J & 35C)
- 1000-watt Inverter (29M & 31S)
- 1800-watt Inverter (34F, 34J & 35C)
- Automatic Generator Start (34F, 34J & 35C)
- 13,500 BTU Front Roof Air Conditioner
- 13,500 BTU Rear Roof Air Conditioner (34F, 34J & 35C)
- Battery Disconnect Switch
- 6-gallon DSI Gas/Electric Water Heater
- Water Heater Bypass System
- Enclosed & Heated Holding Tanks (31S, 34F, 34J & 35C)
- Enclosed Holding Tanks with Heat Pads (29M)
- Black Tank Flush System
- Stackable Washer/Dryer Prep (34F & 35C)
- Systems Control Center
- **Rapid Camp®** Wireless Control System

ELECTRICAL & PLUMBING OPTIONS

- 50-amp Detachable Shoreline Power Cord, 13,500 BTU Rear Roof Air Conditioner, and Cummins Onan® RV QG 5500 Gas Generator (29M & 31S – 12-volt Attic Fan in Bedroom N/A)**
- 15,000 BTU (IPO 13,500) Front Roof Air Conditioner (29M & 31S – N/A when Rear A/C is Optioned)
- Second Auxiliary House Battery (29M & 31S)

*INCLUDED ON UNITS BUILT AFTER 10/01/15

**AVAILABLE AFTER 02/15/16.

Thor Motor Coach is the industry leader in innovative design and builds a variety of unique styles, sizes and floor plans that feel custom-made – at a truly competitive price.

IMPORTANT–PLEASE READ: This brochure reflects product design, fabrication, material, components and specifications at the date of printing, which date is disclosed below. **Please visit us online at ThorMotorCoach.com or consult with your selling dealership for the latest in standards, options, specification and technical information.** Photographs in the brochure may depict optional equipment or may only be available in certain floor plans. Components, appliances and the chassis may have been manufactured in a calendar year before the vehicle's designated model year. All capacities are approximate. The actual length of the vehicle may differ from that indicated in the brochure due to variances in the manufacturing processes and/or installed components. All dry weights are based on standard model features and do not include optional features or equipment. Component part and appliance manufacturers issue limited warranties covering portions of the vehicle not covered under the limited warranty we issue. Copyright Thor Motor Coach, Inc. © 12/15/15

YOUR LOCAL THOR MOTOR COACH DEALER



Made to fit.

P.O. Box 1486, Elkhart, IN 46515
Sales Department: 800.860.5658
Customer Service: 877.855.2867

thormotorcoach.com/windspport