



VERSATILITY REDEFINED



www.primetimerv.com

FIFTH WHEELS
SPARTAN
TRAVEL TRAILERS

SPARTAN



North America's
Favorite RV Company!

VERSATILITY REDEFINED

From the first impression to the last detail, Spartan will draw you in. Every aspect of the interior and exterior was designed for full comfort and convenience . . . and no luxury was spared. Whether you're looking to relax in the residential reclining sofa, indulge in the gourmet kitchen, rest in the resort-like bedroom, or spend the day tinkering with your toys in the ultra-functional garage, Spartan is for **YOU**.

Spartan 1234X Kitchen



LUXURY REDEFINED

If Luxury is what you're looking for, Spartan is your oasis. No checkered flag interiors and flashy uncomfortable seating here. Welcome to an intersection of sizzle and steak; of style and substance. Abundant storage and residential amenities adorn each Spartan floorplan and the "designer's touch" is hard to miss. Spartan is a place to get away, yet give up nothing. Enjoy your stay . . .



Spartan 1245 Kitchen



Spartan 1245

COMFORT REDEFINED

From the first impression to the last detail, Spartan cuts no corners in the bedroom and bathroom. Every aspect of these spaces has been carefully thought out and perfectly executed. In the bedroom, oversized wardrobe closets, chest of drawers, HUGE overhead cabinets, and massive walkways create optimal space and comfort that surpasses anything in its class. And rest assured, you'll find a great night's sleep on the 80" Denver Mattress® pillowtop bed.

As you enter the bathroom, you'll find that Spartan has listened closely to our customers and elevated our design to exceed even the loftiest expectations. Abundant countertop space, large medicine cabinet, and numerous LED lights, provide all the conveniences of home. The intelligent high-rise porcelain toilet, extra-large showers with glass doors, Skyview skylight and clever "STOR-MOR" Shower Caddy provide a level of comfort only found in Spartan.

Spartan 1234X Bedroom



Spartan 1234X Bathroom



FUNCTIONALITY REDEFINED



Spartan's garages provide room for all your toys, plus a wide range of entertainment options.

In addition to 22" Black Diamond Plate wall protection, flip-down hanging rack, and D-Rings that are BOLTED to the chassis frame, the garage area also features LED TV framed in cherry cabinetry, advanced control center, and Bluetooth® enabled stereo.

- A.** Optional Rear Patio
- B.** Power Rear Awning
(included with patio option)
- C.** All LED Exterior Lights
- D.** Standard Pull Down Screen
- E.** Standard Happi-Jack Drop Down Bed and Folding Sofas
- F.** Gas/Oil Resistant Flooring

SPARTAN FLOORPLANS

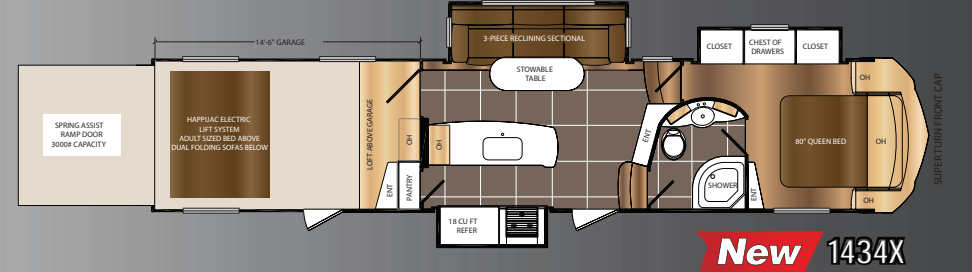
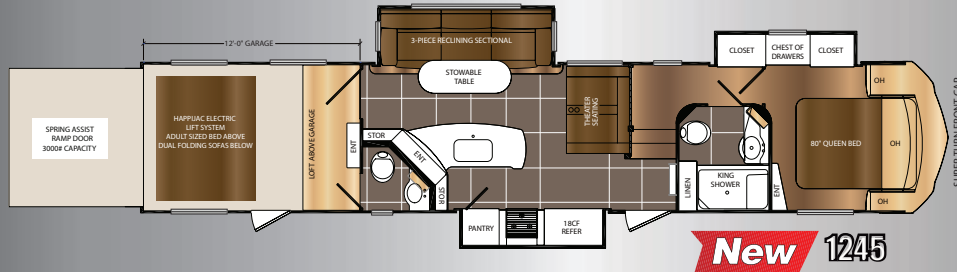
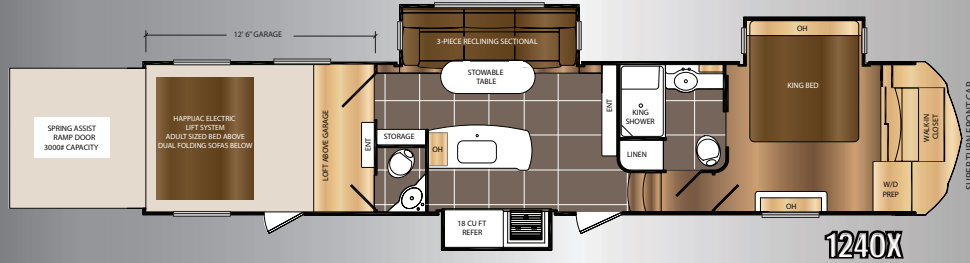
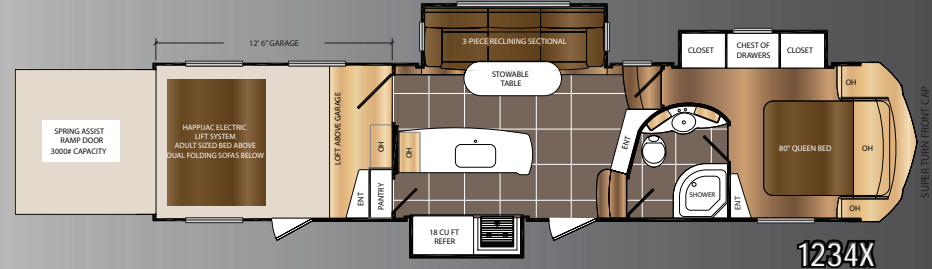
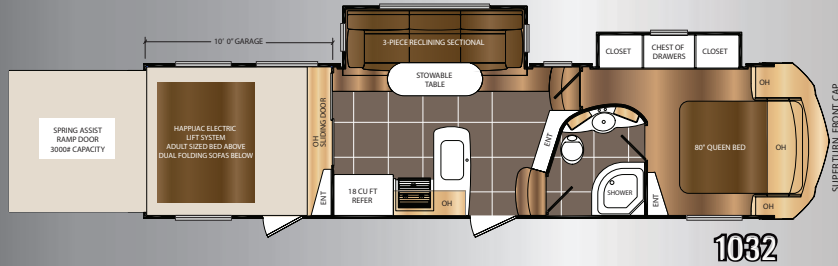

SPECIFICATIONS	1032	1234X	1240X	1242X	1245	1434X
LENGTH	36' 2"	39' 3"	43' 2"	42' 10"	43' 6"	41' 3"
HEIGHT	13' 3"	13' 3"	13' 3"	13' 3"	13' 3"	13' 3"
HITCH WEIGHT	2,593 lb.	2,780 lb.	2,783 lb.	2,820 lb.	2,627 lb.	2,442 lb.
UNLOADED VEHICLE WEIGHT (UVW)	12,557 lb.	13,857 lb.	14,951 lb.	15,064 lb.	15,051 lb.	14,501 lb.
CARGO CARRYING CAPACITY (CCC)	40,36 lb.	4,143 lb.	6,049 lb.	5,936 lb.	5,949 lb.	3,499 lb.



UVW (Unloaded Vehicle Weight)* is the typical weight of the unit as manufactured at the factory. It includes all weight at the unit's axle(s) and tongue or pin and LP Gas. The UVW does not include cargo, fresh potable water, additional optional equipment or dealer installed accessories. *Estimated Average based on standard build optional equipment.

CCC (Cargo Carrying Capacity)** is the amount of weight available for fresh potable water, cargo, additional optional equipment and accessories. CCC is equal to GVWR minus UVW. Available CCC should accommodate fresh potable water (8.3 lbs per gallon). Before filling the fresh water tank, empty the black and gray tanks to provide for more cargo capacity. ** Estimated average based on standard build optional equipment.

See back page for additional specification definitions.

SPARTAN STANDARDS & OPTIONS

ETERNABOND® Construction

- 2" Laminated Aluminum Framed Sidewalls
- 3" Laminated Aluminum Framed Main Floor
- 5/8" One-Piece Floor Decking On Main Floor
- 1" One-Piece Garage Floor Decking
- Laminated Aluminum Framed Slide Room Walls & Roof
- Welded Construction
- 100% Glue Coverage On All Laminated Parts
- EGS Backers In Walls And Floors

Thermal Package*

- Tested At Zero Degrees
- Heated And Enclosed Water Lines
- Enclosed Underbelly
- Heated Holding Tanks
- 12 Volt Holding Tank Heat Pads
- Radiant Shield Technology Wrapped Holding Tanks (R-38)
- Double Layer Of Fiberglass Insulation In Roof (R-14)
- Radiant Shield Technology In Roof (R-38)
- 3" Hi Density EPS Foam In Main Floor (R-14)
- Radiant Shield Technology Under Main Floor (R-38)
- Double Layer Of Fiberglass Insulation In Front Wall (R-14)
- Radiant Shield Technology In Front Wall (R-38)
- Insulated Slide Room Floors (R-38)
- Insulated Bath And Bed Deck Floors (R-38)
- Heated Pass Thru Storage

INTERIOR

- Native American Glazed Cherry Hardwood Cabinet Doors
- Native American Glazed Cherry Hardwood Drawers
- Baltic Birch Residential Drawer Boxes
- 18 CU. FT. Refrigerator
- Pots-N-Pans Drawers
- Full Extension Drawer Guides
- Large, Easy-To-Pull Cabinet Pull Handles
- 30" OTR Residential Microwave
- Deluxe Range With Heavy Grates
- Glass Top Range Cover
- Backsplash Behind Cook Top
- Solid Surface Kitchen Countertop
- Solid Surface Flush-Mount Sink Covers
- High Arch Kitchen Faucet With Pull Out Sprayer
- Stainless Steel Kitchen Sink With Extra Deep Bowls
- Jensen® LED TV (Living Room)
- Jensen® Blu Ray DVD Player (Living Room)
- Jensen® Sub-Woofers (Living Room)
- Residential Furniture Exclusively By Franklin Furniture
- Linoleum With 5-Year Warranty
- Central Vacuum System With 30' Hose
- Electric Fireplace With 5,100 BTU Heating Element
- MCD Roller Shades
- Deluxe Power Vent Fan With Remote Lid
- Flush-Mount LED Ceiling Lights With High Dispersion Lenses
- Cell Phone Storage Center With Charging Station (Some Models)

BEDROOM

- Large LED TV
- Satellite And Cable Connection
- "Stay Cool" LED Reading Lights Above Bed
- Wardrobe Closets With Drawers
- Mirrored Wardrobe Doors
- Oversized Chest Of Drawers
- Massive Under-Bed Storage
- Night Stands With Overhead Cabinets
- Denver Mattress® 80" Pillow Top Queen Bed (Most Models)
- Denver Mattress® 80" Pillow Top King Bed (Some Models)
- Designer Bedspread With Decorative Pillows
- Glass Bedroom Entrance Door

BATHROOM

- Extra Large Shower With Glass Door
- Adjustable Shower Faucet
- Deluxe "Sky View" Skylight
- "STOR-MOR" Shower Caddy
- Dual Lever Bath Faucet
- 12V Power Vent Fan In Bath
- Hi Rise Porcelain Toilet
- Heating & Air Conditioning Vents

EXTERIOR

Advantage Package

- 6-Point Hydraulic Leveling System
- 2nd "Quiet Cool" Ducted Air Conditioner
- Generator Prep
- Happi-Jack Electric Bed And Double Sofa/Bed

Spartan Suspension Package

- "EZ-Flex" Rubberized Suspension
- Heavy Duty Shock Absorbers
- Eight Point Greasable "Wet" Bolts
- Long Lasting Brass Bushings
- Long Lasting 1/2" Shackle Plates
- 7000 lb. Axles
- "EZ Lube" Greasable Axle Hubs
- 16" Aluminum Wheels
- 8 Lug Wheels
- Upgraded Radial Tires
- "DURA GLOSS" Champagne Colored Hi Temp Fiberglass Sidewalls
- 5" Truss Roof Rafters, 16" On Centers
- 3/8" "WALK ON" Roof Decking
- Color Coordinated One-Piece TPO Roof With 12-Year Warranty
- Powder Coated 12" I-Beam
- Oversized Pass Thru Storage With Intelligent Design
- "SUPER TURN" Aerodynamic Fiberglass Front Cap
- Undermount Spare Tire
- Coax TV Connection In Pass Thru Storage
- 110V Electrical Outlet In Pass Thru Storage
- Dual Electric Awnings With LED Lights (Most Models)

- Slam Latch Baggage Doors With "DURA GLOSS" Finish
 - Magnetic Baggage Door Catches
 - 30" Wide Radius Main Entrance Door With Gas Strut
 - Large Swing Out Grab Handles
 - Hitch Pin Cover
 - Digital Ready TV Antenna With Booster
 - Dual Vented Attic
 - Easy Access Roof Ladder
 - (3) LED Security Lights
 - (2) LED Garage Loading Lights
 - Upgraded Frameless, Deep Tint Windows On Sidewalls
 - DOT Approved Safety Glass Windows
 - Extra Large PVC Sewer Hose Storage
 - Extended Drip Spouts
 - Quad Entry Step With Oversized Steps
 - Centralized Holding Tank Pull Handles
 - Easy Winterization Valve And Connection
 - Easy Access Low Point Drains
 - Easy Access Low Point Drain Valves
 - Upgraded Oetiker Clamp Ring Water Line Fittings
- Universal Docking Center That Includes:**
- Outside Shower With 15' Flex Hose
 - Black Tank Flush
 - Battery Disconnect
 - Cable Connection
 - Triple Satellite Connections For LR, BR, And Garage

GARAGE

- Large LED TV
- Satellite And Cable Connection
- Hi Power Jensen® Stereo With DVD Player
- Hi Power Jensen® Speakers (Garage and Exterior)
- Steel Tie Downs Bolted To Chassis
- 8' Spring Assisted Ramp Door
- Recessed Storage In Beaver Tail
- 22" "BLACK DIAMOND" Protection On Walls
- Gas/Oil Resistant Flooring
- (2) Ram Air Vents
- Bunk Ladder
- Free Standing Table With Folding Legs
- Full Sized Garage Throw Rug
- Pull Down Garage Screen
- Power Vent With Remote Lid
- Air Conditioning Vents With Adjustable Louvers
- Washer/Dryer Prep (All Models)
- Folding Wardrobe Hook (Most Models)
- Ducted Heat

UTILITIES

- Hydraulic Front Landing Gear
- "SOLID STANCE" Front Jack Legs
- "SOLID STANCE" Oversized Landing Pads
- Convenient Hydraulic Selector Valves (Where Applicable)
- Fuel Station With 12V Pump
- Dual 30 Gallon Fuel Tanks
- Dual "Quiet Cool" Ducted Air Conditioners

- Dual Zone Temperature Sensors
- Digital Thermostat
- 35,000 BTU Furnace
- 10 Gallon Gas/Electric Quick Recovery Water Heater
- Direct Spark Ignition Water Heater
- Water Heater By-Pass
- Hi Capacity Water Pump
- 50AMP (110) Power
- Detachable Power Cord
- 90AMP (12V) Converter
- Dual 30# LP Bottles
- CO Detector

OPTIONS

- Trail Air "Roto Flex" Pin Box
- Dual Pane Windows
- Slide Out Awnings
- Onan Marquis Gold 5.5KW Gas Generator
- Rear Patio With Electric Awning
- G-Rated Tires

*R-Values Calculated at 80° F Ambient Temperature



SPARTAN FEATURES



FUEL STATION

Spartan's fuel stations feature two 30 gallon fuel tanks; one for your generator and one for your toys!



SPARTAN INTELLIGENT SUSPENSION

Spartan features EZ Flex rubberized suspension with 7000lb axles and automotive style shock absorbers!



"QUIET COOL" A/C SYSTEM

Spartan features dual "Quiet Cool" air conditioners with residential programmable thermostat for zoned heating and cooling comfort!



PRIME TIME PROUDLY USES DEXTER AXLES

2 Year Warranty
DEXTER AXLE COMPANY

Your safety and peace-of-mind while traveling are assured with high quality, heavy duty Dexter Axles.



"LEVEL-UP" AUTO LEVELING SYSTEM

This one touch Auto Leveling System makes setting up your camping site a breeze!



R-52 EXTREME THERMAL PACKAGE*

R-52 Extreme Thermal Package provides superior protection from the elements, while keeping you cool in the summer and warm in the winter.



DUAL LED LIT POWER ADJUSTABLE AWNINGS

Enjoy the convenience of Prime Time's push button electric adjustable awning with LED lights.



ELECTRIC DROP DOWN BUNK AND SOFAS

The Happi-Jack electric bunk and sofas provide comfortable seating and stow away at the touch of a button!

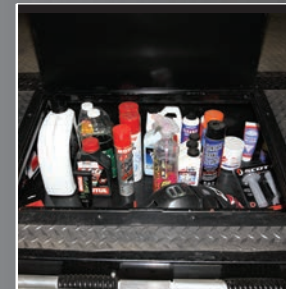

BEAVERTAIL STORAGE

The large recessed storage in the garage is a great place to store tools and gear without taking up additional garage space!



22" BLACK DIAMOND PROTECTION & PERIMETER STEEL TIE DOWNS

The garage is intelligently designed with 22" of black diamond plate wall protection & garage tie downs that are bolted to the frame for secure storage.



OPTIONAL REAR PATIO KIT WITH ELECTRIC AWNING

The rear patio option expands Spartan's living space and allows great comfort while enjoying the outdoors!

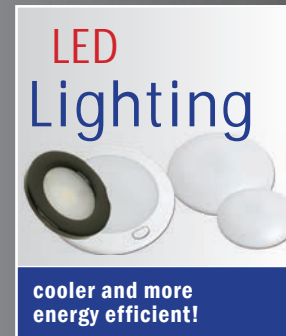

LED Lighting

cooler and more energy efficient!

ALL LED INTERIOR AND EXTERIOR LIGHTING

All Spartans feature LED interior & exterior lights throughout. These energy efficient lights allow you to maximize your electrical service and they put off virtually no heat!

*R-Values Calculated at 80° F Ambient Temperature

VALUE REDEFINED

A quick examination of the Spartan 300 Series will lead you to one conclusion: The 300 Series Spartan travel trailers and fifth wheels are quite simply the BEST VALUE in the Toy Hauler segment! The feature-rich nature of the 300 Series Spartan affords you total comfort and all of the amenities needed for your next journey at an attainable price point. If luxurious residential furniture, largest-in-class optional generator, high-gloss weather proof exterior fiberglass, and functional garage space is what you're looking for, then look no further! Dive deeper into the spacious, storage laden floorplans and surprising standard features to find the perfect fit for your next home away from home!

Spartan 4012 Kitchen Area



SPARTAN 300-SERIES

SPARTAN 300 SERIES FLOORPLANS

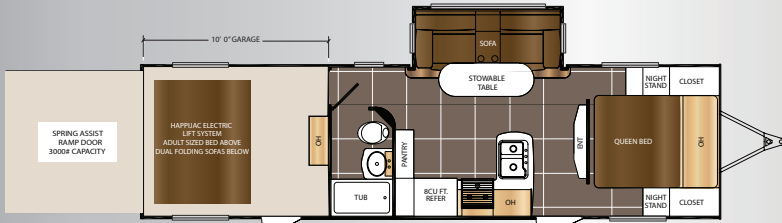

3010 TRAVEL TRAILER

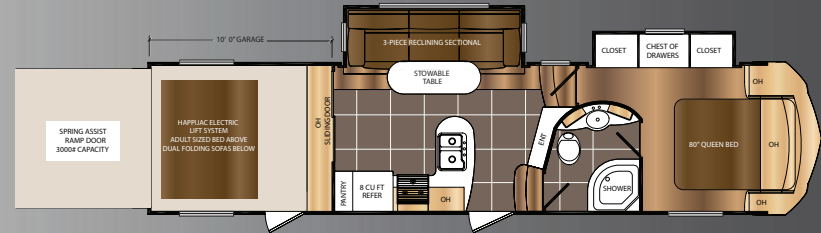

3210

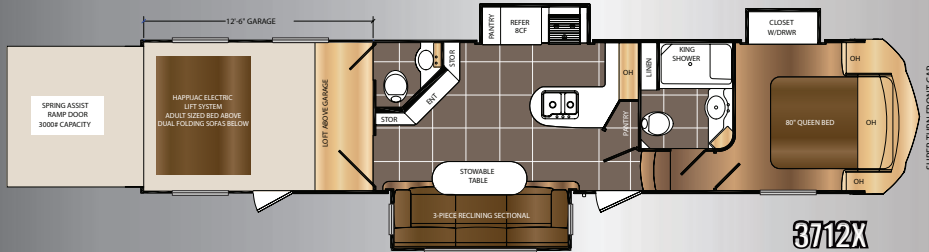

3712X

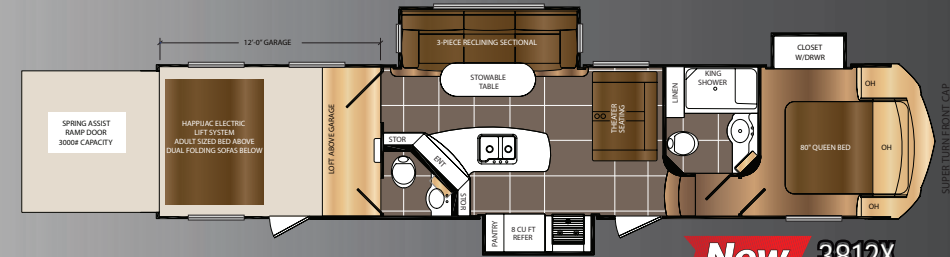

New 3812X

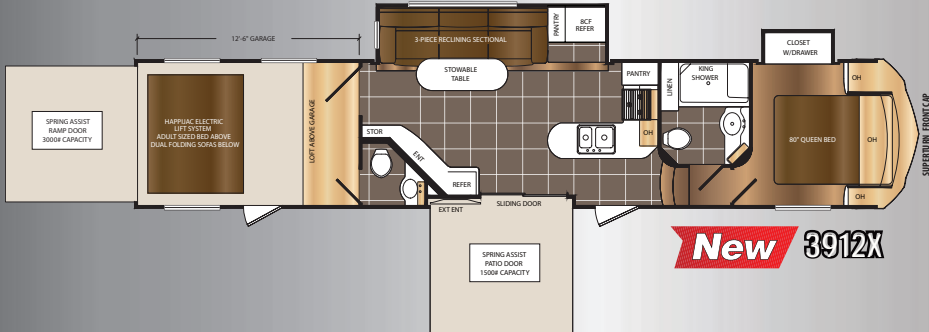

New 3912X

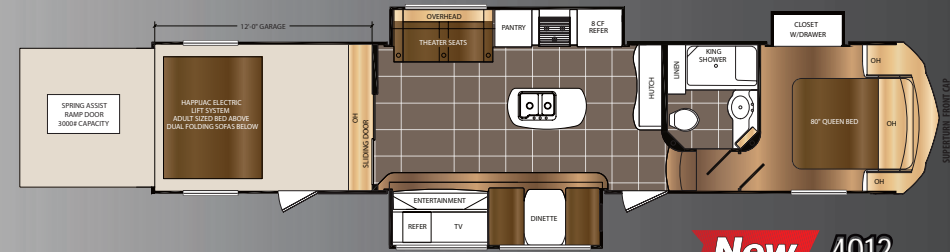

New 4012

SPECIFICATIONS	3010	3210	3712X	3812	3912X	4012
LENGTH	34' 5"	36' 2"	40' 8"	40' 11"	43' 0"	42' 3"
HEIGHT	12' 1"	13' 2"	13' 3"	13' 3"	13' 3"	TBD
HITCH WEIGHT	1,150 lb.	2,616 lb.	3,106 lb.	3,207 lb.	3,478 lb.	TBD
UNLOADED VEHICLE WEIGHT (UVW)	8,575 lb.	11,731 lb.	13,752 lb.	14,048 lb.	14,541 lb.	TBD
CARGO CARRYING CAPACITY (CCC)	4,537 lb.	4,885 lb.	7,248 lb.	6,952 lb.	6,459 lb.	TBD

300-SERIES

UVW (Unloaded Vehicle Weight)* is the typical weight of the unit as manufactured at the factory. It includes all weight at the unit's axle(s) and tongue or pin and LP Gas. The UVW does not include cargo, fresh potable water, additional optional equipment or dealer installed accessories. *Estimated Average based on standard build optional equipment.

CCC (Cargo Carrying Capacity)** is the amount of weight available for fresh potable water, cargo, additional optional equipment and accessories. CCC is equal to GVWR minus UVW. Available CCC should accommodate fresh potable water (8.3 lbs per gallon). Before filling the fresh water tank, empty the black and gray tanks to provide for more cargo capacity. ** Estimated average based on standard build optional equipment.

See back page for additional specification definitions.

SPARTAN 300 SERIES STANDARDS & OPTIONS

ETERNABOND® Construction

- 2" Laminated Aluminum Framed Sidewalls
- Laminated Aluminum Framed Main Floor
- Laminated Aluminum Framed Slide Room Walls and Roof
- Welded Construction
- 100% Glue Coverage on All Laminated Parts
- EGS Backers in Walls And Floors

Thermal Package*

- Heated and Enclosed Water Lines
- Enclosed and Heated Underbelly
- Double Layer of Fiberglass Insulation in Roof (R-14)
- Radiant Shield Technology in Roof (R-38)
- Hi Density EPS Foam in Main Floor (R-14)
- Radiant Shield Technology Under Main Floor (R-38)
- Double Layer of Fiberglass Insulation in Front Wall (R-14)
- Radiant Shield Technology in Front Wall (R-38)
- Insulated Slide Room Floors (R-38)
- Insulated Bath and Bed Deck Floors (R-38) (FW)
- Heated Pass Thru Storage (FW)

INTERIOR

- Native American Glazed Cherry Hardwood Cabinet Doors
- Native American Glazed Cherry Hardwood Drawers
- Baltic Birch Residential Drawer Boxes
- Raised Cherry Panel Refrigerator Front
- 8 CU. FT. Refrigerator
- Pots-N-Pans Drawers with Full Extension Guides
- Large, Easy-To-Pull Cabinet Pull Handles
- Microwave with Vented Range Hood
- Deluxe Range with Heavy Grates
- High Arch Kitchen Faucet
- Oversized Kitchen Sink with Extra Deep Bowls
- Upgraded Residential Furniture
- Linoleum with 5-Year Warranty
- Pleated Shades
- Deluxe Power Vent Fan with Remote Lid
- High Dispersion Flush-Mount LED Ceiling Lights

BEDROOM

- Satellite and Cable Connection
- "Stay Cool" LED Reading Lights Above Bed
- Wardrobe Closets With Drawers (Most Floorplans)
- Mirrored Wardrobe Doors
- Oversized Chest Of Drawers (FW)
- Massive Under-Bed Storage
- Night Stands with Overhead Cabinets
- Queen Bed Mattress and Designer Bedspread

BATHROOM

- Extra-Large Shower with Glass Shower Door (FW)
- Oversized Tub with Shower Surround (TT)
- Adjustable Shower Faucet
- Deluxe "Sky View" Skylight (FW)
- Dual Lever Bath Faucet
- 12V Power Vent Fan in Bath
- Hi Rise Porcelain Toilet
- Heating and Air Conditioning Vents

EXTERIOR

- Electric Front Landing Gear
- "Quiet Cool" Ducted Air Conditioner
- Generator Prep
- Happi-Jack Electric Bed and Double Sofa/Bed
- 7,000 lb. Axles (FW)
- 6,000 lb. Axles (TT)
- "EZ Lube" Greasable Axle Hubs
- 16" Aluminum Wheels
- 8 Lug Wheels
- Upgraded Radial Tires
- "DURA GLOSS" Hi Temp Fiberglass Sidewalls
- 5" Truss Roof Rafters, 16" on Centers
- 3/8" "WALK ON" Roof Decking
- One-Piece TPO Roof With 12-Year Warranty
- Powder Coated 12" I-Beam (FW)
- Powder Coated 10" I-Beam (TT)
- Oversized Pass Thru Storage With Intelligent Design
- "SUPER TURN" Fiberglass Front Cap (FW)
- HP Fiberglass Front Cap (TT)
- Undermount Spare Tire
- Electric Awning with LED Light
- "DURA GLOSS" Slam Latch Baggage Doors
- Magnetic Baggage Door Catches
- 30" Wide Radius Main Entrance Door with Gas Strut
- Large Swing Out Grab Handle
- Digital Ready TV Antenna with Booster
- Collapsible Roof Ladder (FW)
- (2) LED Garage Loading Lights
- Edge Protected, Deep Tint Windows On Sidewalls
- DOT Approved Safety Glass Windows
- Extra Large PVC Sewer Hose Storage
- Extended Drip Spouts
- Triple Entry Step with Oversized Steps
- Easy Winterization Valve and Connection
- Easy Access Low Point Drains
- Easy Access Fresh Water Drain Valve
- Upgraded Oetiker Clamp Ring Water Line Fittings

Universal Docking Center That Includes:

- Outside Shower with 15' Flex Hose
- Black Tank Flush
- Battery Disconnect
- Satellite and Cable Connection

GARAGE

- Satellite and Cable Connection
- Steel Tie Downs Bolted to Chassis
- 8' Spring Assisted Ramp Door
- 22" "BLACK DIAMOND" Protection on Walls
- Gas/Oil Resistant Flooring
- (2) Ram Air Vents
- Bunk Ladder
- Free Standing Table with Folding Legs
- Pull Down Garage Screen
- Air Conditioning Vents with Adjustable Louvers

UTILITIES

- Fuel Station with 12V Pump
- 30 Gallon Fuel Tank
- "Quiet Cool" Ducted Air Conditioner
- Digital Thermostat
- 35,000 BTU Furnace
- Gas/Electric Quick Recovery Water Heater
- Direct Spark Ignition Water Heater
- Water Heater By-Pass
- Hi Capacity Water Pump
- 50AMP (110) Power
- Detachable Power Cord
- 90AMP (12V) Converter (FW)
- 60AMP (12V) Converter (TT)
- Dual 30# LP Bottles
- CO Detector

OPTIONS

- G-Rated Tires
- Onan Marquis Gold 5.5KW Gas Generator
- Dual Pane Windows
- Second "Quiet Cool" Ducted A/C

†BATTLE PACK:

- 6-Point Electric Leveling (FW)
- Rear Patio Kit (FW)
- 4-Step Aluminum Entry Stairs (FW)
- Patio Kit (TT)
- 3-Step Aluminum Entry Stairs (TT)
- "Sick Soundz"™ Audio/Video System (TT)

TT = Travel Trailer

FW - Fifth Wheel

300-SERIES



*R-Values Calculated at 80° F Ambient Temperature

†Ask your local dealer for details and availability of the "Battle Pack."

DSI QUALITY CIRCLE AWARD WINNER - 2010, 2011, 2012, 2013, 2014, 2015

Prime Time Manufacturing is proud to be recognized as an industry leader in value, reliability, and overall quality by the Recreational Vehicle Dealers Association. This was accomplished by committing ourselves to "A Higher Standard" in design, construction, testing, and customer service. Check us out – we know you'll be impressed!



Seal Tech Air Pressure Test



ETERNABOND®
Construction



Rain Bay



Seek-A-Leak Pressure Test

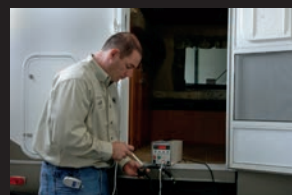

65 Point Secondary PD



Web Based
Customer Service



Executive Quality Audits



Advanced Engineering

ADDITIONAL SPECIFICATIONS:

GAWR (Gross Axle Weight Rating) is the maximum permissible weight, including cargo, fluids, optional equipment and accessories that can be safely supported by a combination of all axles.

Each Forest River RV is weighed at the manufacturing facility prior to shipping. A label identifying the unloaded vehicle weight of the actual unit and the cargo carrying capacity is applied to every Forest River RV prior to leaving our facilities. The load capacity of your unit is designated by weight, not by volume, so you cannot necessarily use all available space when loading your unit.



www.primetimeriv.com
PO Box 330 • 55470 CR 1 • Elkhart, IN 46515

f Follow Us On Facebook

HERE'S JUST A SAMPLE OF THE BENEFITS*

- Mobile Mechanic
- Fuel Delivery
- Free Jump Starts
- Service Assistance
- Tire Changes
- Custom Trip Routing and Maps
- \$2000 Trip Interruption
- 24 Hour Emergency Messaging
- Appointment Assistance
- Lock Out Service

*Exclusions and restrictions apply. See member guide for details.

24/7 EMERGENCY ROADSIDE ASSISTANCE

Coach-Net®
RV Technical & Roadside Assistance

For a worry-free ownership experience Forest River includes one year of Coach-Net RV Technical & Roadside Assistance with each RV purchase. Whether new to the RV lifestyle or an experienced RV enthusiast, Forest River owners have 24/7 access to technical, operational and emergency road service coverage throughout the US & Canada. Coach-Net's fast, dependable service is just a phone call away.

**FROG™ the Forest
River Owners' Group!**

FREE MEMBERSHIP
to Forest River Owners' Group

www.forestriverfrog.com



Forest River, Inc. encourages our customers to purchase their Forest River products from a local dealership whenever possible for the following reasons:

- 1) Forest River, Inc. dealers are independently owned and operated businesses so priority service and scheduling is at their discretion and is often provided to customers that purchased their unit at that dealership.
- 2) Purchasing locally allows customers to establish meaningful relationships with a dealer, enhancing the RV experience through assistance with product questions, user tips or RV regulations for your state or country, and much more!
- 3) Canadian customers must meet requirements to bring an RV purchased out of the country to their home. These requirements may involve additional inspections and certifications, taxes and fees. Your local Canadian Dealer is a professional at meeting these requirements.
- 4) Scheduling timely warranty repairs and adjustments through a local dealership provides far greater flexibility and convenience to you, the customer!

It is the goal of Forest River, Inc. that all of our RV owners fully enjoy the RV experience and that customer satisfaction meets or exceeds their expectations!

All information contained in this brochure is believed to be accurate at the time of publication. However, during the model year, it may be necessary to make revisions and Forest River, Inc., reserves the right to make all such changes without notice, including prices, colors, materials, equipment and specifications as well as the addition of new models and the discontinuance of models shown in this brochure. Therefore, please consult with your Forest River, Inc., dealer and confirm the existence of any materials, design or specifications that are material to your purchase decision.

©2015 Prime Time Manufacturing
A Division Of Forest River, Inc.,
A Berkshire Hathaway Company.
All Rights Reserved



Learn More
Scan this barcode using a QR Reader on your smart phone to learn more about Forest River.



A Berkshire Hathaway company.

DEALER