

europa

2026



Pictured with Optional Extended Front Cap with Cab-Over Bunk and Optional Blackout Package



CHASSIS

- Freightliner M2 106B PLUS Chassis (33,000-lbs. GVWR / 46,000-lbs. GCWR)
- Cummins B 6.7L Turbo Diesel Engine (360hp / 800 lb-ft. of Torque)
- Allison 3200 TRV Six-Speed Automatic Transmission
- 5.56 Rear Axle Ratio
- Trailer Hitch (15,000 Tow lbs. / 1,500 Tongue lbs.) with 7-Way Round Tow Connection
- 100-Gallon Fuel Capacity (Twin 50-Gallon Aluminum Fuel Tanks) with Equiflo Inboard Fuel System
- 6-Gallon Diesel Exhaust Fluid Tank
- 160-Amp Alternator
- Air Brakes with 4-Wheel ABS
- Fuel Filter/Water Separator with Primer Pump
- Cummins VG Exhaust Brake System
- Brake Controller
- Airliner 21,000-lb. Rear Air Suspension
- Manual Air Suspension Dump Valve Switch on the Dash
- SACHS Front Shock Absorbers
- Front Sway Bar
- Cruise Control
- Steel-Reinforced, Aluminum Cab
- Chrome Grille
- LED Headlights
- Daytime Running Lights
- Tinted Door Glass and Wing Windows
- Front and Rear Tires: 275/80R22.5 (14 Ply Radials)
- Alcoa Aluminum Wheels (Set of Four)
- Single Front Wheels and Dual Rear Wheels (22.5" x 8.25")
- Valve Extensions
- Tire Pressure Monitoring System
- Quick Disconnect Fitting with Tire Inflation Kit
- Engine Block Heater

- Leatherette Driver and Passenger Air Ride Seats with Air Lumbar Controls
- Quad-View Camera System (Right Side, Left Side, Hitch, and Rear Horizon Views)
- Sony 10.1" HD Touch Screen Dash Infotainment System with AM/FM, Bluetooth, Sirius/XM (Tuner and Antenna), Wired and Wireless Apple CarPlay / Android Auto Connectivity, USB-C Port, and High-Resolution Audio
- 12V Accessory Ports
- Chassis Battery Shut Off Switch in Cab
- Air Horn
- One Valve Parking Brake System with Warning Indicator
- Engine After-Treatment Device, Automatic Over-the-Road Regeneration, and Dash-Mounted Regeneration Switch
- Momentary Battery Booster Switch for Connecting Chassis and House Batteries
- Marker Lights with Separate Interrupter Switch
- Low Air Pressure Light and Buzzer
- Adjustable Steering Column
- 18" Leather-Wrapped Steering Wheel
- Power and Heated Exterior Mirrors
- Power Windows and Locks
- 3-Point Seat Belts

CONSTRUCTION

- 2" Aluminum-Framed, Laminated Sidewalls with High-Density Block Foam Insulation
- Composite Exterior Fiberglass (No Exterior Wood)
- Aluminum-Framed Floor
- Aluminum-Framed Roof Trusses
- Crowned, One-Piece Fiberglass Roof
- Foil-Lined Ductwork Throughout
- Fiberglass Rear Cap and Front Wing Panels
- Automatic, 4-Point Hydraulic Leveling Jacks
- Dual-Pane, Dark-Tinted, Frameless Square Windows with Built-In Night Shades & Screens

EUROPA

The Europa's clean, contemporary styling features modern hardwood cabinetry and is equipped with all the comforts, including a king size bed, a solid surface kitchen countertop, a comfortable trifold sleeper sofa (optional power theater seats shown) and a roomy dream dinette.



34SS Shown with Optional Blackout Package

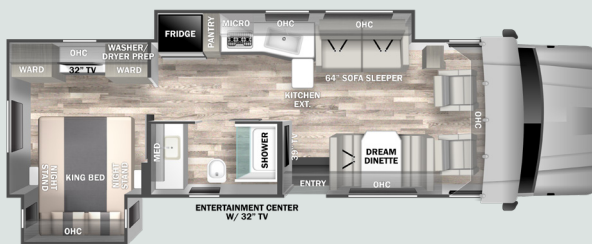
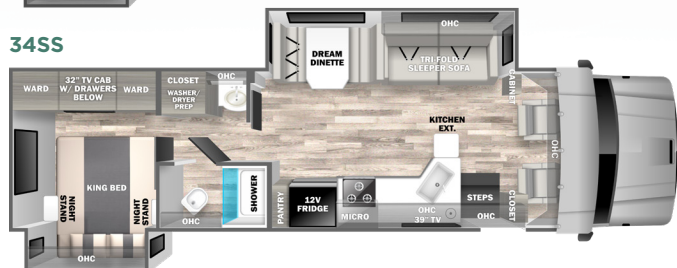
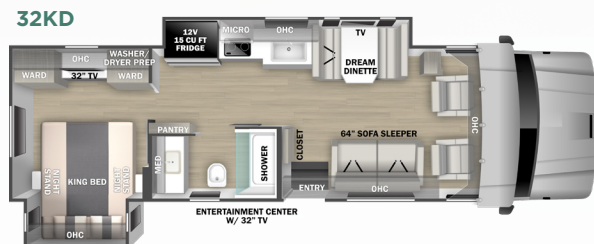

OPTIONS



DUAL POWER THEATER SEATS
IPO Sofa Sleeper (31SS, 32KD)



15 CU. FT. FRIDGE
(Standard on 34SS)



**THREE-SEAT POWER
THEATER SEATS**
IPO Sofa Sleeper (34SS)

SPECIFICATIONS	31SS	32KD	34SS
GVWR (lbs.)	33,000	33,000	33,000
GCWR (lbs.)	46,000	46,000	46,000
GAWR - Front (lbs.)	12,000	12,000	12,000
GAWR - Rear (lbs.)	21,000	21,000	21,000
UVW* (lbs.)	20,281	20,281	24,456
Overall Length	33' 5"	33' 10"	36' 8"
Exterior Width	101"	101"	101"
Wheelbase	245"	245"	268"
Overall Exterior Height	12' 9"	12' 9"	12' 9"
Interior Height	84"	84"	84"
Fuel Capacity (Gal.)	100	100	100
Water Capacities (Gal.) Fresh/Gray/Black	94/52/52	98/52/52	94/52/52
LPG Capacity (WC) (Gal.)	20.3	20.3	20.3
Awning Length	16'	16'	16'

*UVW is an estimate only based on standard equipment.

- Seamless Rotocast Storage Compartments with LED Lighting
- Side-Hinged, Locking Aluminum Exterior Storage Doors with Paddle Latches

EXTERIOR

- Custom Full Body Paint Package
- Premium Cut and Buffed Paint Finish
- Front-End Diamond Shield Paint Protection
- Armless Patio Awning with LED Lighting and Motion-Activated Retraction
- Slideout Toppers
- LED Patio Light
- Entry Door with Rotary Latch; Dark-Tinted, Frameless Window; and Integrated Shade
- Keyless Entry Touch Pad at Entry Door
- Lighted Acrylic Entry Grab Handle
- Power Entry Steps with Upgraded SeaDek Step Treads
- Exterior Wall-Mounted Entertainment Center with 40" LED Smart TV with Integrated JBL Sound Bar on Swivel Extension Mount (31SS: 32" TV)
- Front and Rear LED Clearance and Marker Lighting
- Rear Docking Lights
- Rear "DYNAMAX" Rock Guard
- Black Steel Cab Step Treads

INTERIOR

- Luxury Vinyl Tile Throughout
- Soft-Touch Padded Vinyl Ceiling
- Luxury Vinyl Tile Entry
- Dimmable LED Recessed Ceiling Lights
- Sprung, Residential Style Dinette Seats with Lift Up Storage
- Tri-Fold Sofa
- Hardwood Shaker-Style Cabinetry
- Full Extension, Soft-Closing Drawer Guides (where applicable)
- Hidden Hinges
- 42" Smart LED TV (Living Area)
- JBL Sound Bar
- Magnetic Thermal, Reflective Front Privacy Shades
- USB/USB-C Charging Ports

KITCHEN

- 16 cu. ft. Residential Refrigerator with Ice Maker (31SS & 32KD)
- *12V 15 cu. ft. 3-Door Compressor-Driven Refrigerator (Starting at EUC007202 / 32KD: Starting at EUC007228)

- 12V 15 cu. ft. 3-Door Compressor-Driven Refrigerator (34SS)
- Sealed Gas Range with Glass Cover
- *Induction Range (32KD: Starting at EUC007228 / 31SS & 34SS: Starting at EUC007394)
- Convection Microwave Oven with Air Fryer Functionality
- Solid Surface Countertops with LED Edge Lighting and Backsplash
- Stainless Steel Sink with Solid Surface Covers
- Residential Black Spring Gooseneck Faucet
- Pantry
- Overhead Cabinet Accent Lighting
- Under-Cabinet Lighting
- MaxxAir Power Vent with Built-In Rain Cover

BEDROOM

- King Bed (71" x 75") with Gel-Infused Memory Foam Mattress (31SS)
- King Bed (71" x 78") with Gel-Infused Memory Foam Mattress (N/A - 31SS)
- Designer Bedding Package
- 32" LED Smart TV
- Cedar-Lined Wardrobe
- LED Reading Lights
- USB/USB-C Charging Ports

BATHROOM

- Designer Shower (31SS: 36" x 36") (32KD/34SS: 30" x 36")
- Glass Shower Door
- Shower Skylight
- Oxygenics Body Spa RV Shower Head
- Top-Mount Sink with Residential Faucet
- Porcelain Foot-Flush Toilet (31SS)
- Porcelain Electronic-Flush Macerator Toilet (N/A - 31SS)
- MaxxAir Power Vent with Built-In Rain Cover

UTILITIES

- Dual 12V 8D AGM Deep-Cycle, Maintenance-Free Batteries (490Ah Total)
- 200W Glass Solar Panel with 30-Amp Controller
- 3,000W Hybrid Pure Sine Wave Inverter/Charger
- 50-Amp Service with 36' Power Cord Reel
- Firefly Multiplex Wiring with Touch Screen Command Center, Switch Panels, and Bluetooth Smart Phone App Control
- 8kW Onan Diesel Generator with Auto Transfer Switch (Mounted on Isolator Pads)

- Automatic Generator Start
- Energy Management System (EMS)
- Battery Disconnect
- Dual Ducted, Low-Profile 15,000-BTU Air Conditioners with Heat Pumps
- 40,000-BTU LP Furnace with Electronic Ignition
- 60,000-BTU Truma AquaGo Comfort Plus On-Demand Water Heater (LP)
- Combo Washer/Dryer Prep (31SS & 32KD)
- Stackable Washer/Dryer Prep (34SS Only)
- 20.3-Gallon LP Tank (WC)
- LP Quick Connect
- Water Filtration System
- Exterior Shower in Service Bay
- Exterior GFCI Receptacle
- Starlink Satellite Internet System (Roof-Mounted) *Starting at EUC007192
- Winegard OTA HDTV Antenna
- KING DISH Tailgater Pro Premium HD Satellite with DISH Network Receiver
- *Starting at EUC007250: Winegard In-Motion Satellite
- 4X4 HDMI Matrix
- Cable TV / Satellite Hookup in Service Bay
- Thetford Sani-Con Turbo Macerator System
- Black Tank Flush
- SureLevel Tank Level Monitoring System
- Furnace-Heated Utility Compartment
- Enclosed and Furnace-Heated Holding Tanks
- Upgraded 12V On-Demand Water Pump (4 gallons per minute)
- Carbon-Monoxide, LP, and Smoke Detectors
- Fire Extinguisher

OPTIONS

- Aerodynamic Fiberglass Front Cap with Cab-Over Cabinets
- Extended Fiberglass Front Cap with Cab-Over Bunk Mattress (50" x 79") and Privacy Curtain
- Black Out Package (Cab Entry Steps, Side Mirrors, Rock Guard, Wheels, Headlight Bezels, Exterior Grab Handle Trim, Custom Grille and Vent)
- Single Color Full Body Paint
- Dual, Power Reclining Theater Seats in Place of Sofa (31SS & 32KD)
- Three-Seat, Power Reclining Theater Seats in Place of Sofa (34SS - Only Outer Seats are Powered)

- Xplorer Package - includes Insulated Cab Curtain; Two Lithium House Batteries (540aH Total); 1,000W Solar Package; Insulated Utility Bay with Secondary Tank Heater and Temperature Sensor; & Access to Exclusive Xplorer Package Paint Scheme (Dark, Light, or Midnight)
- *Starting at EUC007264: Three Lithium House Batteries (720Ah Total)

AVAILABLE OPTIONS



Extended Front Cap with Cab-Over Bunk



Aerodynamic Front Cap with Cab-Over Cabinets



Blackout Package

FULL BODY PAINT PACKAGES

With Front-End Diamond Shield, shown with optional cab-over bed



Platinum (Single Color Full Body Paint)



Admiral Blue



Quicksilver



Stone Ridge

THE OPTIONAL, ALL-SEASON XPLOER PACKAGE

Tested and developed for over a decade in the Canadian Rockies



Shown with Xplorer Package Full Body Paint available in "Light" (Left), "Dark" (Right) or "Midnight" (to come).

Xplorer Package includes:

- **Dual Lithium Batteries** – 540Ah with built-in heaters to maximize off-grid efficiency
- **Enhanced Solar Power** – 1000 Watts with MPPT controllers for up to a 30% better charging rate
- **Furnace-Heated Utility Bays with Thermal-Foil Insulation** – enhance heat retention.
- **Secondary 12V Tank Heater in Utility Bay** – thermostatically-controlled; provides auxiliary/back-up heat
- **Temperature Sensor in Utility Bay** – displays on interior multiplex panel
- **Enhanced Insulation in Walls, Floor, and Roof** – more easily maintains optimal interior temperature
- **Insulated Cab Curtain** – closes off the cab area in colder climates to minimize heat loss

CONSTRUCTION



1. One-Piece Crowned Fiberglass Roof
2. Wood Decking
3. Fiberglass Insulation
4. Ultra-Duct, Foil Faced A/C Duct
5. Aluminum Trusses
6. Vacuum-Bonded Laminated Sidewalls
7. Decorative Wall Board
8. Aluminum Framing
9. Metal Backers
10. High Density Block Foam Insulation
11. Vacuum-Bonded Laminated Floor System
12. Tongue and Groove Plywood Decking
13. Luxury Vinyl Tile

DÉCOR SELECTIONS

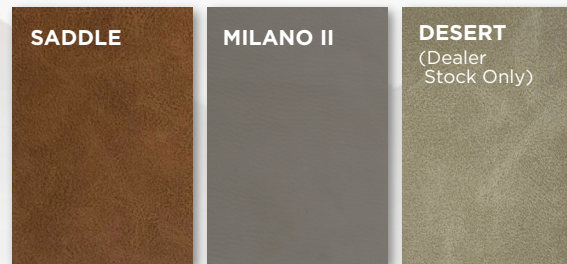

DYNAMAX

2745 Northland Dr. • Elkhart IN 46514
574-262-3474 • www.dynamaxcorp.com

GVWR (Gross Vehicle Weight Rating) - is the maximum permissible weight of the unit when fully loaded. It includes all weights, inclusive of all fluids, occupants, cargo, optional equipment and accessories. For safety and product performance do NOT exceed the GVWR.

GCWR (Gross Combined Weight Rating) - is the maximum permissible loaded weight of your motor home and any towed trailer or towed vehicle. Actual GCWR of this vehicle may be limited by the sum of the GVWR and the installed hitch receiver maximum capacity rating; see hitch rating label for detail.

GAWR (Gross Axle Weight Rating) - is the maximum permissible weight, including cargo, fluids, optional equipment and accessories that can be safely supported by each axle.

UVW (Unloaded Vehicle Weight)* - is the typical weight of the unit as manufactured at the factory. It includes all weight at the unit's axle(s), including full fuel, all fluids and LP Gas. The UVW does not include cargo, fresh potable water, additional optional equipment or dealer installed accessories.

*Estimated Average based on standard build optional equipment.

CCC (Cargo Carrying Capacity)** - is the amount of weight available for fresh potable water, cargo, passengers, additional optional equipment and accessories. CCC is equal to GVWR minus UVW. Available CCC should accommodate fresh potable water (8.3 lbs per gallon). Before filling the fresh water tank, empty the black and gray tanks to provide for more cargo capacity.

**Estimated average based on standard build optional equipment.

Each Forest River RV is weighed at the manufacturing facility prior to shipping. A label identifying the unloaded vehicle weight of the actual unit and the cargo carrying capacity is applied to every Forest River RV prior to leaving our facilities.

The load capacity of your unit is designated by weight, not by volume, so you cannot necessarily use all available space when loading your unit.

Actual towing capacity is dependent upon your particular loading and towing circumstances, which includes the GVWR, GAWR and GCWR as well as adequate trailer brakes. Please refer to the Operator's Manual of your vehicle for further towing information.

All information contained in this brochure is believed to be accurate at the time of publication. However, during the model year, it may be necessary to make revisions and Forest River, Inc., reserves the right to make all such changes without notice, including prices, colors, materials, equipment and specifications as well as the addition of new models and the discontinuance of models shown in this brochure. Therefore, please consult with your Forest River dealer and confirm the existence of any materials, design or specifications that are material to your purchase decision.

©2025 Dynamax, a Division of Forest River, Inc., a Berkshire Hathaway company. All Rights Reserved. 11/25



Find us on
Facebook

FREE MEMBERSHIP
to Forest River Owners' Group

www.forestriverfrog.com



Dynamax Owner

"Digital Kit" App

Now you can have your Owner's Manual with you wherever you are. Download our FREE App from the App Store or Google Play and you'll have the information right at your fingertips.



Paint Video

<https://www.youtube.com/watch?v=sLgLoR26jfs>

Factory Video Tour

<https://www.youtube.com/watch?v=q5cG43PD7SE>



Learn More:

Scan this barcode using a QR reader on your smart phone to learn more about Forest River.



Your Authorized Europa Dealer