

# SUNSEEKER

**SUNSEEKER** Available on Ford E450

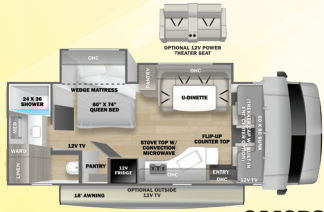

**2440DS**

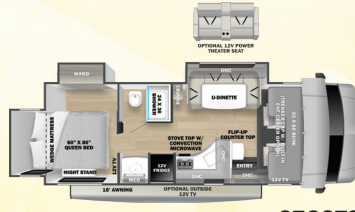

**2500TS**

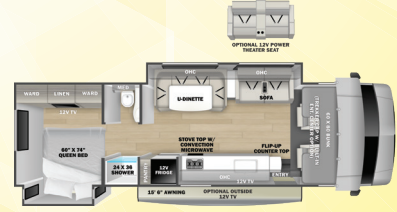

**3010DS**

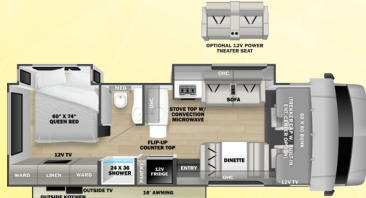

**2860DS**

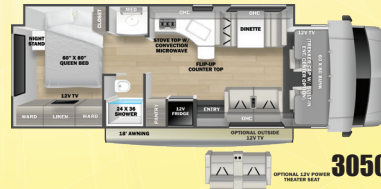

**3050S**

## SUNSEEKER LE



**1950LE**



**2150SLE**



**2250SLE**



**2350LE**

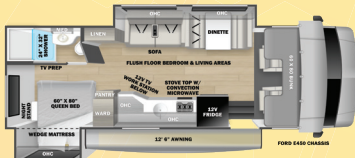

**2550DSLE**

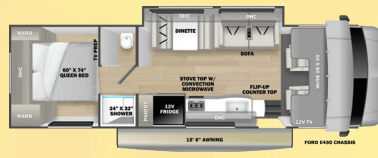

**2850SLE**

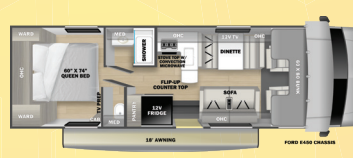

**2950SLE**

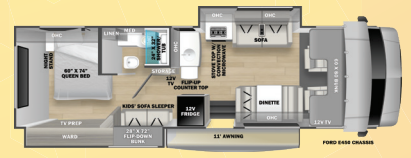

**3250DSLE**

## SUNSEEKER MBS Available on Mercedes 3500

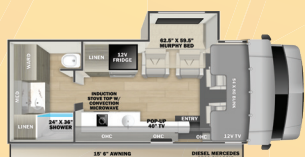

**2400M**

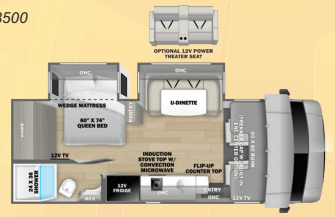

**2400BDS**

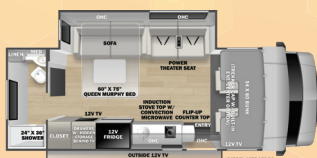

**2400T**

## SUNSEEKER TS



**2370TS**



**2380TS**

## SUNSEEKER PM SERIES



**2030RP**



SCAN FOR MORE SUNSEEKER INFO!



**FOREST RIVER**

[FORESTRIVERINC.COM](http://FORESTRIVERINC.COM)

STANDARDS, FEATURES, AND OPTIONS

O = OPTION • S = STANDARD • NA = NOT APPLICABLE

WARRANTY	STD	LE	MBS	TS	PM
12 months/12,000 mile basic limited warranty	S	S	S	S	S
Chassis warranty (see owners manual)					
SYSTEMS	STD	LE	MBS	TS	PM
Battery disconnect	S	S	S	S	S
Water heater bypass	S	S	S	S	S
(2) Deep cycle coach batteries	S	S	S	S	N/A
(1) Deep cycle coach battery	N/A	N/A	N/A	N/A	S
LED lighting with dimmer switch	S	S	S	S	S
Easy access battery in step-wall	S	S	S	S	S
30 AMP service with power cord	S	S	S	S	S
60 AMP Progressive Dynamics converter	S	S	S	S	S
6 gallon DSI gas/electric water heater	S	S	S	N/A	N/A
30,000 BTU furnace	S	S	S	N/A	N/A
Truma Combi water heater/furnace	N/A	N/A	N/A	S	S
Emergency start switch	S	S	N/A	S	N/A
Satellite/cable connection	S	S	S	S	S
13,500 BTU ceiling high efficiency roof air w/heat pump	N/A	N/A	N/A	S	N/A
15,000 BTU ceiling ducted ultra quiet roof air (13.5 BTU non-ducted A/C on some models)	S	S	S	N/A	S
Optional dual A/C w/power shedding system (most models)	O	O	N/A	N/A	N/A
4.0 KW gas generator	S	S	S	N/A	N/A
2.8 KW gas generator (only available on gasoline model)	N/A	N/A	N/A	S	S
Auto generator start system (most models)	S	N/A	S	S	S
EZ Ryde upgraded suspension system (Ford only)	S	N/A	N/A	N/A	N/A
Heated, enclosed holding tanks and valves (N/A 2250SLE, 2550DSLE)	S	S	N/A	N/A	N/A
Heated, enclosed underbelly (N/A 1950, 2250 and 2550)	S	S	N/A	N/A	N/A
Arctic Package (12V tank heaters)	S	N/A	S	S	N/A
CO, LP, and smoke detector	S	S	S	S	S
Magnadyne Digital Antenna with Wifi Prep	S	S	S	S	S
200 W roof-mounted solar powered 12 V charging system	S	S	S	S	S
EXTERIOR	STD	LE	MBS	TS	PM
2" aluminum framed laminated sidewalls	N/A	N/A	S	S	S
Gel Coat exterior fiberglass	S	S	S	S	S
Block foam insulation	S	S	S	S	S
Power patio awning with LED light strip	S	S	S	S	S
Slide-out awnings	S	S	S	S	N/A
Laminated fiberglass roof	S	S	S	S	S
One-piece fiberglass front cap	S	S	S	S	S
Roto-cast storage compartments	S	S	S	S	S
Driver side security light	S	S	S	S	S
Fiberglass running boards (standard on Full Paint Classics)	O	N/A	S	S	N/A
Aluminum running boards	S	S	N/A	N/A	S
Tinted sliding windows	S	S	N/A	N/A	N/A
Tinted acrylic dual pane windows	N/A	N/A	S	S	S
Heated, remote exterior mirrors	S	N/A	S	S	S
7,500 lbs hitch, 7-pin connector (E450)	S	S	N/A	N/A	N/A
7,000 lbs hitch, 7 pin connector (Chevy)	N/A	S	N/A	N/A	N/A
5,000 lbs hitch, 7 pin connector (E350)	N/A	S	N/A	N/A	N/A

EXTERIOR	STD	LE	MBS	TS	PM
4,200 lbs hitch, 7 pin connector	N/A	N/A	S	N/A	N/A
4,000 lbs hitch, 7 pin connector	N/A	N/A	N/A	S	N/A
Spare tire	S	N/A	N/A	S	N/A
Integrated entry step	S	S	N/A	S	N/A
Power entry step	N/A	N/A	S	N/A	S
Automatic leveling system (4-point) (N/A on Chevy)	O	O	O	N/A	N/A
LP quick connect	S	S	S	S	S
Full body paint	O	N/A	O	O	N/A
Outside shower	S	N/A	S	S	N/A
Outside 12V LED Smart TV (see floorplans)	O	N/A	O	N/A	N/A
Black tank flush	S	S	S	S	S
On-the-Go™ ladder bracket (most models)	S	S	S	S	S
CAB AREA	STD	LE	MBS	TS	PM
10" touch screen CarPlay/Android radio w/USB and Bluetooth	S	N/A	S	S	S
Power windows and door locks	S	S	S	S	S
Keyless entry (N/A Chevy)	S	S	S	S	S
Backup camera/side view cameras with 3-way monitor	S	N/A	S	S	S
Back up camera	N/A	S	N/A	N/A	N/A
Swivel driver seat (Ford and Promaster only)	O	N/A	N/A	S	S
Swivel passenger seat (Ford and Promaster only)	O	N/A	N/A	S	S
Ultra leather driver and passenger seats (N/A Chevy)	S	N/A	N/A	N/A	N/A
Power heated leather swivel driver and passenger seats	N/A	N/A	S	N/A	N/A
KITCHEN	STD	LE	MBS	TS	PM
Recessed 3-burner range with flush glass cover (2 burner on 1950/51 only)	S	S	N/A	N/A	N/A
Single burner induction cooktop	N/A	N/A	S	S	S
1.1 CU FT microwave with air fryer (Transit: .9 CU FT)	S	S	S	S	S
10.7 CU FT 12V refrigerator	S	S	S	N/A	N/A
Soft touch self-closing drawer guides	S	S	S	S	S
Cordless charging plate in pop-up charging center	S	S	S	S	S
BATHROOM	STD	LE	MBS	TS	PM
Electric roof fan	S	S	S	S	S
Oxygen-infused shower head with flexible extension	S	S	S	S	S
Motion sensor light	S	N/A	S	S	S
Shower skylight	S	S	S	S	S
BEDROOM	STD	LE	MBS	TS	PM
Black-out shades	S	S	S	S	S
12V bedroom TV	S	N/A	S	S	N/A
LIVING ROOM	STD	LE	MBS	TS	PM
Convertible dinette for additional sleeping capacity	S	S	S	N/A	N/A
Theater seats (standard on 2401T MBS)	O	N/A	O	N/A	N/A
Black out shades	S	S	S	S	S
12V LED flat panel adjustable side smart TV	S	S	S	S	S
Child seat head tethers in dinette	S	S	S	N/A	N/A
Maxx Air multi-speed power fan with cover	S	S	S	S	S
12V USB charging station	S	N/A	S	S	S

EACH NEW FOREST RIVER PURCHASE PROVIDES:

- ✔ Pre-delivery Inspection.
- ✔ Digital Owner's Manual.
- ✔ Free Membership to Forest River Owners Group (FROG). Learn more at [www.forestriverfrog.com](http://www.forestriverfrog.com).
- ✔ A Contribution to Care Camps Foundation [www.carecamps.org](http://www.carecamps.org).
- ✔ 1 Year Free Roadside Assistance from Date of Purchase.



LEARN MORE:

Scan this QR code with your mobile device to learn more about Forest River.



SPECIFICATION DEFINITIONS:

Scan this barcode using a QR reader on your smartphone to learn RV terminology and more!



YOUR **SUNSEEKER** DEALER

All information contained in this brochure is believed to be accurate at the time of publication. However, during any model year, it may be necessary to make changes to the manufacturing process of the units and information in this brochure. Your unit may differ from the information in this brochure due to any changes in the manufacturing process and equipment. Forest River, Inc., reserves the right to make all such changes without notice, including prices, colors, combinations, materials, equipment and specifications of any model as well as the addition of new models and the discontinuance of models shown in this brochure. Therefore, please consult with your Forest River dealer and confirm the availability of any materials, combinations, designs, or specifications that are meaningful to your purchase decision. © 2025 Sunseeker, a Division of Forest River, Inc., a Berkshire Hathaway Company. All Rights Reserved. Forest River, Inc. 08/25