

**22MLWE**

WEIGHT 5850 LENGTH 26'10"

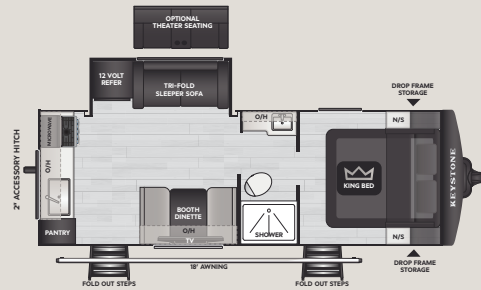

**22RKWE**

WEIGHT 6020 LENGTH 26'11"

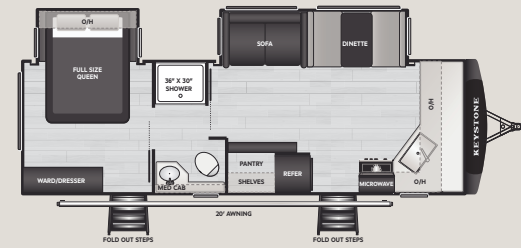

**25FKWE**

WEIGHT 7060 LENGTH 30'0"

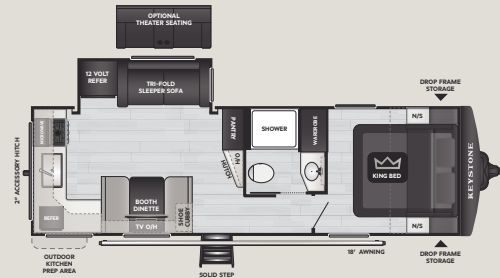

**25MLWE**

WEIGHT 6500 LENGTH 29'11"

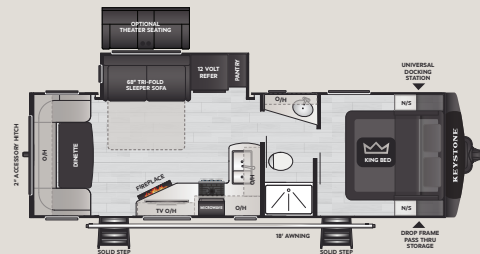

**25RDWE**

WEIGHT 6330 LENGTH 29'10"

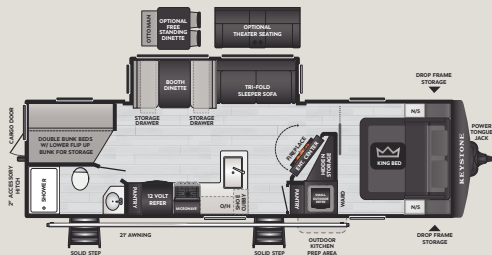

**28BHWE**

WEIGHT 7290 LENGTH 32'11"

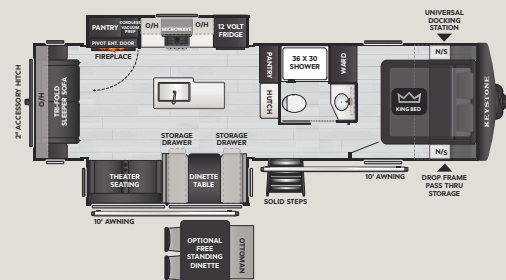

**29RLWE**

WEIGHT 7530 LENGTH 33'7"

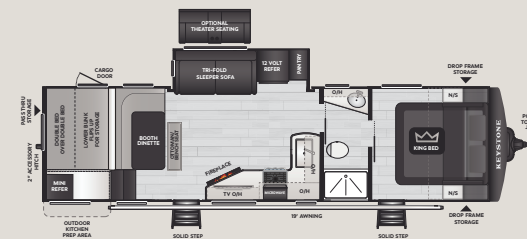

**30BHWE**

WEIGHT 7403 LENGTH 34'5"



## STANDARD FEATURES & OPTIONS

### WESTERN ELEVATION PACKAGE

- ♦ 80 Gallon Fresh Water Capacity
- ♦ Gravity Fill for Fresh Water
- ♦ Offroad Rainier ST Apex Tires
- ♦ Tire Linc TPMS Prep
- ♦ Full Size Spare Tire
- ♦ 2" Accessory Hitch
- ♦ Lippert Axles w/ Anti-Lock Braking System
- ♦ Curt Road Armor Shock Absorbing Equalizer
- ♦ Bronze bushings, heavy duty 1/2 shackle plates & wet bolts
- ♦ Dual 30 lb. LP Tanks
- ♦ Gas and Electric 6 gal. Water Heater
- ♦ Fast Track Stabilizer Jacks with Cordless Drill Bit
- ♦ Hot and Cold water Exterior Shower
- ♦ Exterior TV Hookups with Exterior Mounting Bracket
- ♦ LP Quick Disconnect for Grilling - (all models)
- ♦ 12 volt AM/FM Stereo
- ♦ 12 volt Power Vent Fan in Kitchen / Living Room
- ♦ Vent-All Window System
- ♦ Rear observation camera prep

### PROFESSIONAL GRADE CAMPING PACKAGE

- ♦ Drop-Frame with Increased Storage (most models)
- ♦ Extra-Wide entry step with composite step treads
- ♦ Entry Door Privacy Shade
- ♦ 5-Sided Aluminum Superstructure
- ♦ AlphaPly roof membrane with Limited Lifetime Warranty

- ♦ Fully Walkable Roof and Slide-out Roof
- ♦ Dimmable Lights in Main Slide, Living Room
- ♦ High Definition Smart TV
- ♦ Dual Zone Bluetooth Audio System
- ♦ Winegard Mini Antenna
- ♦ 12V Charging Stations Throughout
- ♦ Blackout Roller shades Throughout
- ♦ Linoleum Slideout Flooring
- ♦ Single Bowl Stainless Steel Kitchen Sink
- ♦ High Rise Kitchen Faucet w/ Pullout Sprayer
- ♦ Furrion 17" Oven w/ 3 Burner Cooktop
- ♦ Universal Docking Station - Easy Winterization
- ♦ Exterior Awning Switch in Pass-Thru
- ♦ Water Pump Easy Access w/ Hinged Door (select models)
- ♦ Hardwood Cabinet Doors w/ Soft Close Hidden Hinges
- ♦ Key-Alike lock system
- ♦ Under Bed Storage w/ Strut Assist
- ♦ Nightstands w/ 110 Outlets and USB Ports
- ♦ Booth Dinette w/LED Lights and Drawers (select models)
- ♦ Slide Topper Prep
- ♦ Dedicated shower light
- ♦ Oxygenics® shower head and hose
- ♦ Reverse warning lights in taillight

### CLIMATE GUARD PROTECTION PACKAGE

- ♦ 15K Furrion A/C, Ducted
- ♦ 30K BTU Furnace
- ♦ Tinted Windows w/ Black-Out Roller Shades
- ♦ Astrofoil Insulated Underbelly
- ♦ 12Volt-Heat Pads on Holding Tanks
- ♦ Forced-Air Heated & Enclosed Underbelly
- ♦ Reflective Foil in Front Cap, Slide Floors
- ♦ Dual Attic Vents
- ♦ Pex Plumbing Lines
- ♦ Foil backed, foam core A/C duct with Tuf-Lok™ joiners

### INNOVATION PACKAGE

- ♦ HIGH GLOSS HyperCore® Composite Sidewalls
- ♦ Hyper-Deck Water Resistant Flooring
- ♦ Color Coded & Unified Wiring System
- ♦ Giggy Box-Industry's 1st Organized 12 volt Wiring Box, patented
- ♦ MY KEYSTONE Owners Mobile App
- ♦ Painted Front Cap w/ Automotive Clear Coat
- ♦ Tank Guardian High Tensile Strength Strap System
- ♦ Double Welded Aluminum Frame Construction
- ♦ Decorative Snap-In Ceiling & Crown Molding Treatments
- ♦ Power converter with auto-detect battery recognition
- ♦ Automotive Windshield (25FKWE only)