

COUGAR — FIFTH WHEELS

SCAN FOR MORE INFO

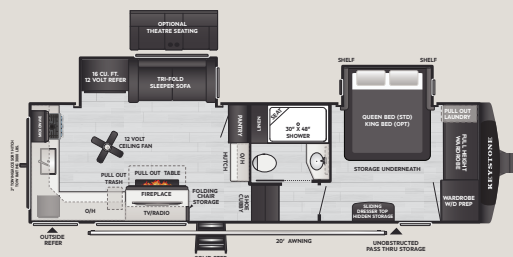

260MLE | WEIGHT 9674 | LENGTH 30' 11"

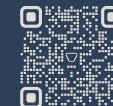
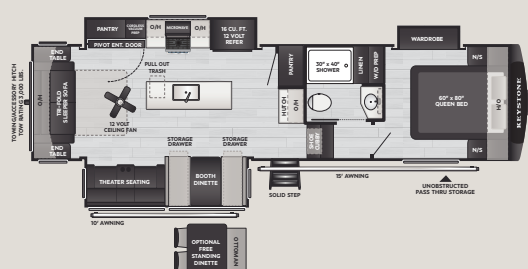

290RLS | WEIGHT 10567 | LENGTH 33' 8"



316RLS | WEIGHT 11050 | LENGTH 35' 8"

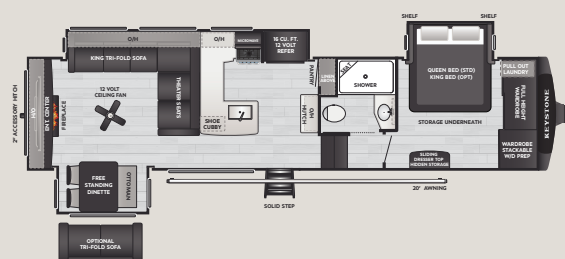

320RDS | WEIGHT 11133 | LENGTH 36' 10"

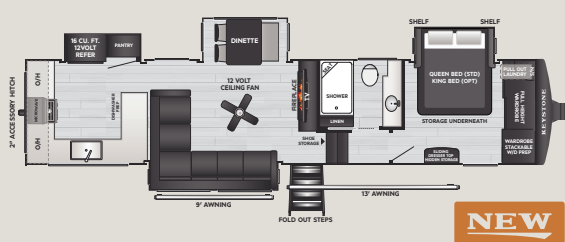

350LLK | WEIGHT 11945 | LENGTH 39' 3"

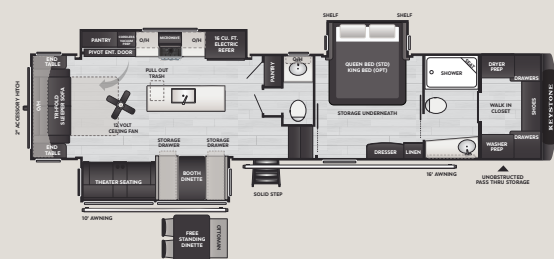

355FBS | WEIGHT 11740 | LENGTH 39' 3"

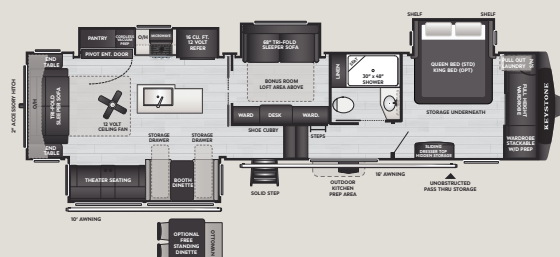

360MBI | WEIGHT 11740 | LENGTH 39' 3"

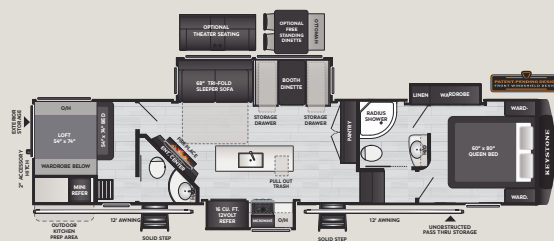

364BHL | WEIGHT 11718 | LENGTH 39' 0"



DISCLAIMER: Product information is as accurate as possible as of the date of publication of this publication. All features, floor plans, and specifications in this publication are subject to change without notice. Please also consult Keystone's web site at www.keystonev.com for more current product information and specifications. **Tow Vehicle Disclaimer.** Owners of Keystone recreational vehicles are solely responsible for the selection and proper use of tow vehicles. All customers should consult with a motor vehicle manufacturer or their dealer concerning the purchase and use of suitable tow vehicles for Keystone products. Keystone disclaims any liability or damages suffered as a result of the selection, operation, use or misuse of a tow vehicle. **KEYSTONE'S LIMITED WARRANTY DOES NOT COVER DAMAGE TO THE RECREATIONAL VEHICLE OR THE TOW VEHICLE AS A RESULT OF THE SELECTION, OPERATION, USE OR MISUSE OF THE TOW VEHICLE.** *Length is defined as the distance from the centerline of hitch pin/coupler to rear bumper of trailer. ** Fresh water capacity includes water heater. Please review owner's manual prior to purchase for more information on service warranties, extended use, towing and maintenance. Owner's manuals can be found at Keystonev.com.

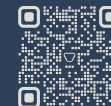

STANDARD FEATURES & OPTIONS

PROFESSIONAL GRADE CAMPING PACKAGE

- ♦ 75 Gallon Fresh Water Tank
- ♦ Washer/Dryer Prep (N/A 364BHL)
- ♦ Hidden Dresser Storage
- ♦ Extra-Wide Entry Step With Composite Step Treads
- ♦ Entry Door Privacy Shade
- ♦ Vent-All Window System
- ♦ On-Demand Water Heater
- ♦ 5-Sided Aluminum Superstructure
- ♦ AlphaPly roof membrane with Limited Lifetime Warranty
- ♦ Fully Walkable Roof and Slideout Roof
- ♦ Dual 30lb LP Tanks
- ♦ LP Quick Disconnect for Grilling - (All Models)
- ♦ Power Watchdog™ Safeview Smart RV Power Inlet: 50 Amp
- ♦ Washable PVC Sewer Hose Storage
- ♦ Dimmable Lights in Main Slide, Living Room & Bedroom
- ♦ Heat & Massage Theater Seats
- ♦ 50" High Definition Smart TV
- ♦ Dual Zone Bluetooth Audio System
- ♦ Winegard 360 Plus w/ WIFI Prep, Satellite Pass-through
- ♦ 12V Charging Stations Throughout
- ♦ Power Vent w/ Rain Sensor in Kitchen
- ♦ 30" Residential Microwave Vents to Exterior
- ♦ Furrion 21" Oven w/ 3 Burner Cooktop & Oven Drawer
- ♦ Solid Surface Kitchen Countertops
- ♦ Pull-out Trash Cans w/ Paper Towel Holder (SELECT MODELS)
- ♦ Exterior Awning Switch in Pass-Thru
- ♦ Water Pump Easy Access w/ Hinged Door
- ♦ Hardwood Cabinet Doors w/ Soft Close Hidden Hinges
- ♦ Key-Alike Lock System

- ♦ Lighted Termination Points
- ♦ MORryde® Telescoping Safe-T-Rail Entry Handle
- ♦ Booth Dinette w/LED Lights and Drawers
- ♦ Slide Topper Prep
- ♦ Oxygenics® Shower Head and Hose
- ♦ LED Closet Rod Lighting (SELECT MODELS)

TOWING W/ CONFIDENCE PACKAGE WITH ABS

- ♦ MaxTurn™ Technology
- ♦ Lippert™ Axles w/ Anti-Lock Braking System
- ♦ Bronze Bushings, Heavy Duty 1/2 Shackle Plates & Wet Bolts
- ♦ Rainier H Rated 16 Ply Tires w/ 8 Year Warranty
- ♦ 16" 6 Lug Wheels
- ♦ Tire Linc® TPMS Prep & H Rated Full Size Spare Tire
- ♦ Curt Helux™ Series Coil Spring Pin Box
- ♦ Curt Road Armor™ Shock Absorbing Equalizer
- ♦ Reverse Warning Lights in Taillight
- ♦ 2" Accessory Hitch (SELECT MODELS)
- ♦ 2" Towing Hitch with 4 way plug (SELECT MODELS)
- ♦ Rear Observation Camera Prep

COUGAR INNOVATION PACKAGE

- ♦ Water Management Center Providing Individual Shut-off Valves
- ♦ HIGH GLOSS HyperCore® Composite Sidewalls
- ♦ Color Coded & Unified Wiring System
- ♦ Giddy Box-Industry's 1st Organized 12 Volt Wiring Box, Patented

- ♦ KeyTV™ Multisource Signal Controller, Patented
- ♦ Spacesaver Fifth Wheel Chassis
- ♦ Painted Front Cap w/ Automotive Clear Coat
- ♦ Automotive Windshield - (Select Models)
- ♦ Tank Guardian High Tensile Strength Strap System
- ♦ Double Welded Aluminum Frame Construction
- ♦ Tuf-Lok™ Thermoplastic Air Conditioning Duct Joiners
- ♦ Decorative Snap-In Ceiling & Crown Molding Treatments
- ♦ Power Converter with Auto-Detect Battery Recognition

CLIMATE GUARD PROTECTION PACKAGE

- ♦ 18k Furrion High Efficiency Chill® Cube A/C
- ♦ 15k Ducted Bedroom A/C
- ♦ 3rd A/C Prep & 30k BTU Furnace
- ♦ Astro-Foil Insulated Underbelly
- ♦ 12Volt-Heat Pads on Holding Tanks
- ♦ Forced-Air Heated & Enclosed Underbelly
- ♦ Heated Basement Storage & Convenience Center
- ♦ Reflective Foil in Front Cap, Slide Floors
- ♦ Dual Attic Vents
- ♦ PEX Plumbing Lines
- ♦ Insulated Gooseneck & Bulkhead Divider
- ♦ Foil Backed, Foam Core A/C duct with Tuf-Lok™ Joiners

OPTIONS

- ♦ Full Body Paint Packages Available: Midnight Edition-Black Onyx or Phantom Gray, Hero Edition, 1776 Edition