

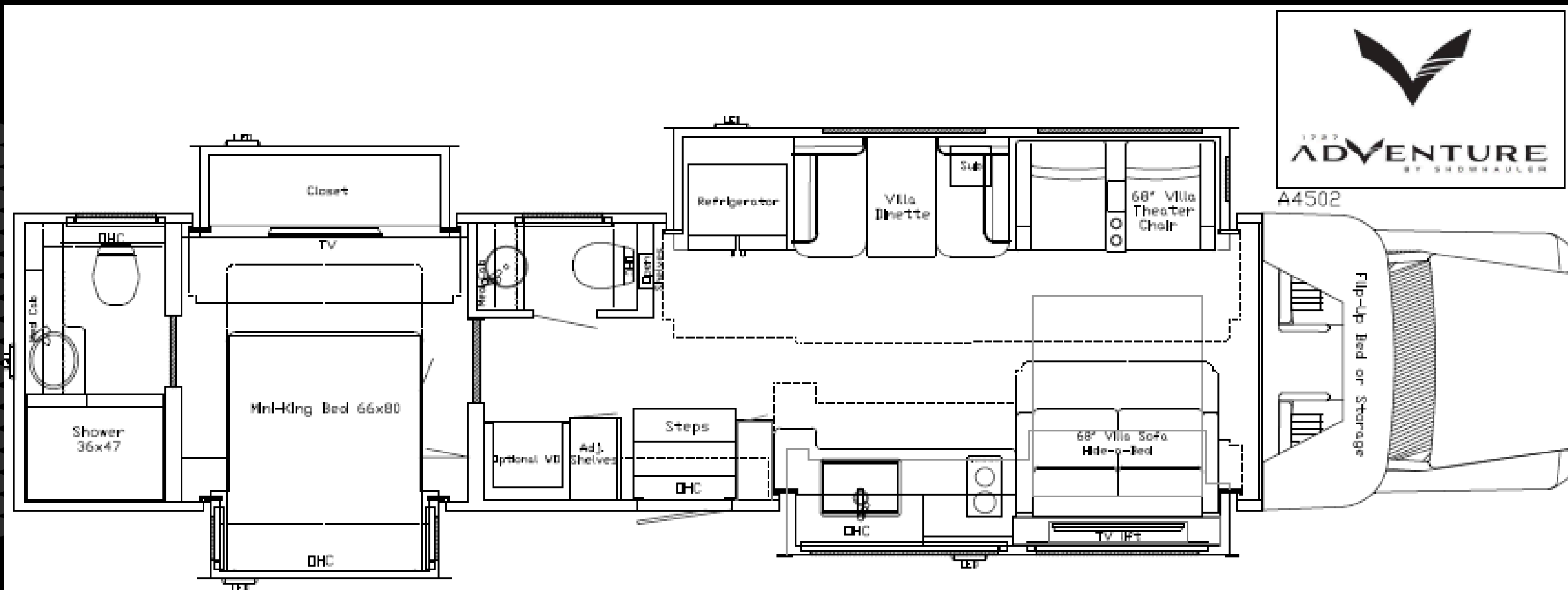

ADVENTURE

BY SHOWHAULER



A4501
UVW: 46,500 LBS.
GVWR: 58,000 LBS.
EXTERIOR HEIGHT: 13'6"
EXTERIOR LENGTH: 44'11.5"
EXTERIOR WIDTH: 100"
FUEL CAPACITY: 120
GALLONS
DEF CAPACITY: 13 GALLONS

EXTERIOR & CONSTRUCTION

- ALL-STEEL CAGE CONSTRUCTION (WELDED)
- ALL-STEEL TUBULAR FLOOR FRAME
- UNDERCOATED MAIN FRAME & STORAGE BOX FRAME
- 100" WIDE BODY
- 1-7/8" LAMINATED FLOOR-INSULATED
- CLOSED CELL SPRAY FOAM INSULATED WALLS AND CEILING
- 3" BOARD INSULATION BETWEEN STEEL FLOOR CROSS MEMBERS
- ALL WALLS, FLOORS, CEILINGS INSULATED
- .063 EXTERIOR ALUMINUM SKIN
- ONE PIECE ROOF-100% WALK ON
- O/S LIGHTED STORAGE COMPARTMENTS-PUSH BUTTON DOORS & POWER REMOTE LOCKING
- 30K TAG HITCH W/7 WAY BARGMAN PLUG (6K TONGUE WEIGHT-TANDEM AXLE)
- 50 AMP/120V REAR PLUG
- ELECTRIC BRAKE CONTROL
- LIGHTED GRAB HANDLE W/ KEYPAD FOR REMOTE LOCKING
- BLACK & GREY WASTE TANKS (72 GALLON EACH) W/HEAT PADS
- OPEN STORAGE LOWER ENTRY STEP
- 3 PIECE FIBERGLASS REAR CAP
- GLAD HAND AIR CONNECTIONS AT HITCH
- CHASSIS AIRBAG OVER INFLATE
- PAIR OF COMBINED STORAGE COMPARTMENTS (PASSENGER SIDE)
- EXTERIOR HOT/COLD SHOWER IN WET BAY

INTERIOR & DECOR

- POWER ROLLER DAY/NIGHT SHADES
- HARDWOOD CABINETS/ HARDWOOD DOORS AND RECESSED HINGES
- DOVETAIL DRAWERS W/SOFT-CLOSE GUIDES
- BLACK STAINLESS-WORKSTATION SINK
- QUARTZ COUNTERTOP W/ BLACKSPASH
- SINGLE LEVER FAUCET W/ PULL-OUT SPRAYER
- LED CLOSET LIGHTS
- MINI-KING 66X80 ORTHOREST MATTRESS W/ GEL TOP (NOTCHED FOR S/O MOTOR)
- FIBERGLASS AERO CAP W/FLIP UP BED OR STORAGE
- PADDED VINYL CEILING
- LUXURY PADDED VINYL CEILING, UPPER/LOWER WALLS
- VILLA FURNITURE
- FULL LENGTH MIRROR ON BEDROOM WALL
- ELECTRONIC SAFE
- COAT HOOKS OVER ENTRY DOOR
- PORCELAIN HEATED TILE THROUGHOUT
- TILED ENTRY STEPS
- ROLL OUT WASTE CAN IN KITCHEN BASE CABINET

APPLIANCES

- GE CAFE APPLIANCES REFRIGERATOR, OTR CONVECTION MICROWAVE OVEN/VENTED OUTSIDE, OPTIONAL DISHWASHER
- TV ANTENNA W/ BOOSTER AND WIFI BOOSTER
- OASIS NE HYDRONIC HEAT, HOT WATER/CHASSIS PRE-HEAT
- (3) 15,000 BTU LO PRO ROOF MOUNT A/C W/ HEAT STRIP
- 2 BURNER INDUCTION COOKTOP
- COOLER/FREEZER IN SLIDE TRAY IN EXTERIOR COMPARTMENT
- DIRT DEVIL-CENTRAL VACUUM W/ DUST PAN

BATH & WATER

- PORCELAIN TOILET
- 2-75 GALLON FRESHWATER TANKS BELOW BED W/12V PUMP (150 GALLONS TOTAL)
- WHOLE COACH WATER FILTER
- SINGLE VALVE CITY WATER HOOKUP/FRESH WATER FILL
- (2) MED CABINETS W/ MIRRORS
- (2) LAVATORY W/ BASE AND CABINET STORAGE
- TILED SHOWER W/ GLASS DOOR
- OASIS HEAT EXCHANGERS IN HOLING TANK COMPARTMENTS
- WASHER/DRYER PREP W/ ADJ. SHELVES/DUAL STRIP LIGHTS/HANGING RODS
- VESSEL BOWL SINK IN ½ BATH & GEMSTONE SINK IN REAR BATH
- BLACK STAINLESS-WORKSTATION KITCHEN SINK
- SANICON HOLDING TANK MACERATOR PUMP

ELECTRICAL SYSTEMS

- 12.5W GENERATOR-ONAN DIESEL
- STARLINK
- 1200 W SOLAR PACKAGE
- (2)-3000W MULTIPLUS INVERTERS
- BATTLEBORN GC3 1620 AH LITHIUM BATTERY BANK
- FIREFLY MULTI-PLEX LIGHTING/CONTROL SYSTEM
- LED INT./EXT.MARKER, SCENCE, DOCKING & MIDSHIP TURN SIGNAL LIGHTS
- MAX AIR ROOF EXHAUST VENTS
- E-START SWITCH IN CAB
- 50" LED SMART TV IN MAIN AREA
- 43" LED SMART TV IN BEDROOM
- 43" EXTERIOR LED SMART TV
- 360 CAMERA/MONITOR
- HITCH/CAMERA PLUG(2ND MONITOR MOUNTED ON DASH/CAMERA LEAD/1 CAMERA)

OPTIONS

- FREIGHTLINER CASCADIA BLACKOUT PACKAGE
- DRIVER SIDE -GIRARD DUAL PITCH ROOF MOUNT AWNINGS
- ADDITIONAL 100 GALLON FRESH WATER TANK BETWEEN FRAME RAILS
- TEAK FOLD DOWN SEAT
- DISHWASHER
- WASHER & DRYER STACK
- WINEGARD HD TRAV'LER PRO (STATIONARY SAT., RECEIVER PREP ONLY)(NOT SUPPLIED)
- IN MOTION SATELLITE W/ RECEIVER PREP.
- OVER CAB OPTION: FLIP-UP BED OR STORAGE

ADVENTURE
BY SHOWHAULER