

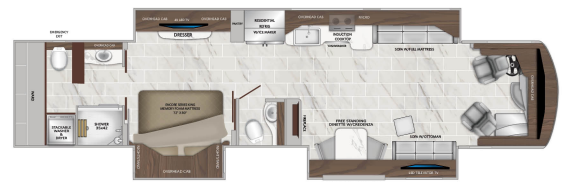

42Q | 45A | 45D | 45P

### COMPREHENSIVE FEATURES

- Liberty Bridge® Integrated Freightliner® Custom Chassis XCM & SL with BrakeSync
- 45' units to 20k front axle w/ 365 tires **NEW FOR MY25**
- Forward Fuel Tank - 150 gal **NEW FOR MY25**
- FCCC® Chassis XCM (42Q) SL (45A, 45D, 45P)
- Cummins Diesel Engine (450HP - 605HP)
- 12.5kW Onan QD Generator with AGS
- 2,800w Pure Sine Wave Inverter
- Luggage Doors - ALL NEW powered push button locks for extra convenience & added lock/unlock button on exterior grab bar
- Basement Slide Trays (2) increased size by 25% per tray **NEW FOR MY25**
  - Manual Trays STANDARD, Power Trays OPTION
  - ALL NEW Stow N Go storage compartments OPTION
- Aqua-Hot 450D for Unlimited Hot Water and Comfortable Even Interior Heat
- Electrical & Battery Compartment Redesign **NEW FOR MY25**
  - Improved functionality by fully enclosing batteries, creating storage area in bay
  - Hinge down electrical component access above battery tray
  - Lithium GC3 Batteries (3) 270Ah each OPTION
- Sani Con Turbo 600S waste management system
- Aqua-Hot Bay modified for increased serviceability and storage
- Safety - 360 Camera now STANDARD **NEW FOR MY25**
- ALL NEW Rev-A-Shelf swivel pull out pantry **NEW FOR MY25**
- Updated Lighting - overhead linear lighting in place of puck lights (in select areas) **NEW FOR MY25**
- Cabinet Doors - top hinge (in select areas) and new mitered corner design **NEW FOR MY25**
- Increased Shower Size (in select floor plans) **NEW FOR MY25**
- Floor Heat in primary/rear bath OPTION **NEW FOR MY25**
- Shurflo accumulator tank-in-line water pressure tank bladder
- Increased soundproofing in cockpit **NEW FOR MY25**
  - Additional insulating/soundproofing materials applied in front cap, dash, driver footwell, entry step well and improved entry door sealing
- A/C condensation lines relocated increasing system performance **NEW FOR MY25**
- **Platinum Experience Warranty** includes -2yr / 24k mile coach, 5yr / 50k structural, 3 years REV assist roadside assistance, dedicated customer service team and now includes the PX owner's mobile app.
- **FCCC® RoadWatch** state-of-the-art driving and safety system includes automatic traction control, electronic stability control with roll stability support, adaptive cruise control, and collision mitigation with forward warning and active braking.
- **UltraSteer** tag axle reduces turning by 17' compared to a fixed tag axle or 8' tighter than the competitions passive steer tag.
- **HWH Updates** - pump and manifold relocated **NEW FOR MY25**
  - Improved performance and serviceability
  - Increased basement storage
  - Enhanced weight distribution

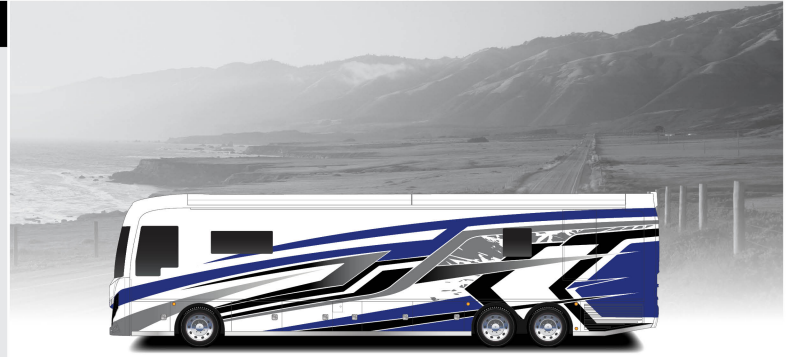

42Q

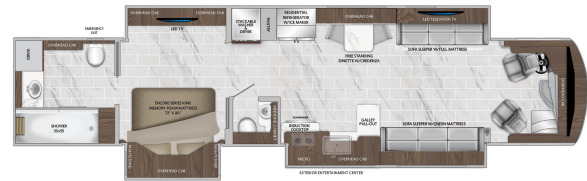

45A



45D



45P

### AVAILABLE OPTIONS

- Starlink Satellite System
- Winegard In-Motion Satellite Dish
- Winegard Trav'ler w/DISH Network
- Winegard Trav'ler w/DIRECT Network
- Roof Mounted Awning (2nd Door Side)
- 43" Front Overhead LED TV
- Standard Cabinet w/o Dishwasher
- Co-Pilot Monitor with 7" Screen
- Lithium Battery Package
- Sofa Bed w/Mattress (42Q Twin Mattress, 45A Queen Mattress)
- Motion Power Lounge (42Q, 45A)
- Dual Recliners (45D, 45P)
- Booth Dinette (45A)
- Exterior Freezer
- Exterior Storage Stow N Go (2) (42' = 4.0ft3, 45' = 4.8ft3)
- Technology Package: Wifi Ranger™ Denali-LTE w/router, Cell Booster, 330W Solar Panel, JBL Premium Audio Sound System

## RENDEZVOUS DÉCOR

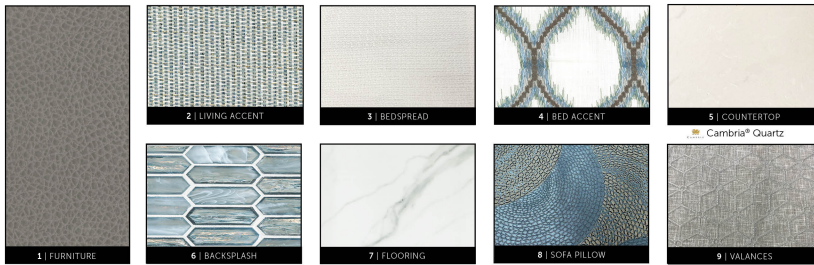

## ROCKPORT DÉCOR

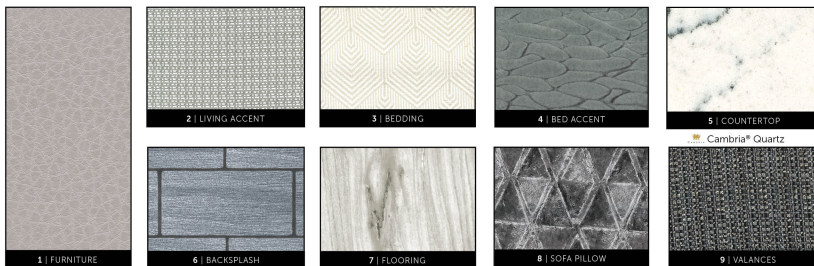

## SAND CREEK DÉCOR

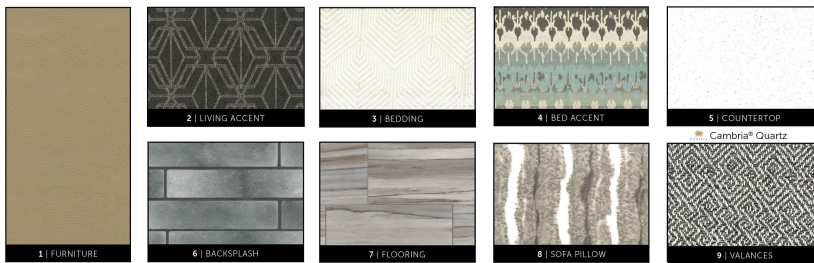

## HARDWOOD CABINETY

## TRADITIONAL DOOR PROFILE

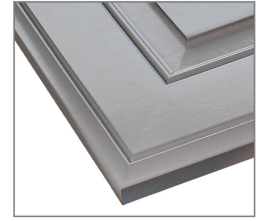

CHELSEA

CATHEDRAL  
PAINTED CABINETY

IMPERIAL

RUSHMORE  
PAINTED CABINETY

## CHASSIS

MODEL	42Q	45A	45D	45P
Wheelbase	30' 2"	319"	319"	319"
Front GAWR (lbs)	17,000	20,000	20,000	20,000
Rear GAWR (lbs)	20,000	20,000	20,000	20,000
Tag GAWR (lbs)	10,000	14,000	14,000	14,000
GCWR (lbs)	62,000	74,000	74,000	74,000
Hitch Rating Weight (lbs)	15,000	20,000	20,000	20,000
Tongue Weight (lbs)	1,500	2,000	2,000	2,000
Fuel Capacity (gal)	150	150	150	150



## LIBERTY BRIDGE® (42Q)

Model: Freightliner Custom Chassis® XCM  
 Engine: Cummins® L9  
 Horsepower: 450HP  
 Torque: 1,250 lb. ft  
 Transmission: Allison® 3000 MH 6-Speed  
 w/ Electronic Shift Control  
 Alternator: 170 Amp

## LIBERTY BRIDGE® (45A, 45D, 45P)

Model: Freightliner Custom Chassis® SL  
 Engine: Cummins® X15  
 Horsepower: 605HP  
 Torque: 1,950 lb. ft  
 Transmission: Allison® 4000 MH 6-Speed w/  
 Electronic Shift Control  
 Alternator: 240 Amp

## DIMENSIONS &amp; CAPACITIES

MODEL	42Q	45A	45D	45P
Overall Length	42' 11"	44' 11"	44' 11"	44' 11"
Overall Height	13' 1"	13' 1"	13' 1"	13' 1"
Overall Width*	102"	102"	102"	102"
Interior Height*	84"	84"	84"	84"
Interior Width*	96"	96"	96"	96"
Patio Awning Width	18'	19' 8"	19' 8"	19' 8"
Interior Storage (cu. ft.)	233	212	212	212
Exterior Storage (cu. ft.)	131	150	150	150
Fresh Water Capacity (gal)	100	105	105	105
Grey Water Capacity (gal)	60	75	75	75
Black Water Capacity (gal)	40	50	50	50

\*Overall Width, interior height and width measured with slide-box in.

## EXTERIORS

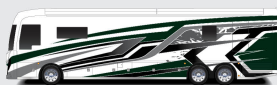

BLACK FOREST



CAMARILLO



MAVERICK

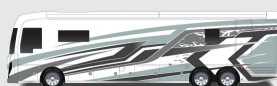

MORNING MIST

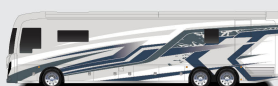

OCEAN FRONT



VERMILION CLIFFS