



 **ADVENTURER**

2025 Camper Guide



The Difference

Adventurer Campers stand out for their rugged durability, Nordic aesthetic, and compact design, making them ideal for both seasoned adventurers and casual campers. Rooted in Adventurer Manufacturing's TRU product and design ethos, which emphasizes authenticity and transparency, our campers provide customers with straightforward, accurate information, and product they can trust. Features like versatile interiors, off-grid capabilities, and eco-friendly options offer comfort without sacrificing mobility. With a 3-year structural warranty, Adventurer Campers deliver a reliable, well-rounded camping experience that blends adventure with peace of mind.

TRU. COMPOSITE. CONSTRUCTION.

When it comes to quality, we take the high road. Our teams design and source the absolute best materials to ensure superior strength and lightweight performance.

TRU. EXPERIENCE.

We have more experience building slide-in truck campers than anyone out there – bar none. With over 55 years manufacturing campers and over 11 million miles on the road each year, our experience is the driving factor behind our product innovation, design, and quality.

TRU. WEIGHTS.

No games, no hidden weight packages. We take great care in providing accurate truck camper weights and measurements. We believe in providing full transparency for all our lightweight models so you know exactly what you're getting.

TRU. FOUR. SEASON.

Adventurer exclusively uses closed-cell block foam insulation which provides more R-value per inch than standard foam board. 360 degrees of insulation helps you maintain a controlled and comfortable internal temperature, year round + off-sets being insulated.

TRU. CONFIDENCE.

Adventurer Camper's 3-year warranty offers peace of mind by covering structural defects, ensuring long-term durability and protection against unexpected repair costs. With comprehensive coverage and reliable customer support, this warranty reflects our commitment to quality and provides owners with the confidence to enjoy their camper without worrying about unforeseen issues.

Floor Plans // Weights & Measures

80RB

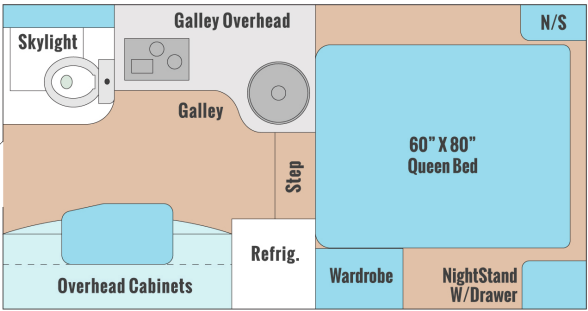

86FB

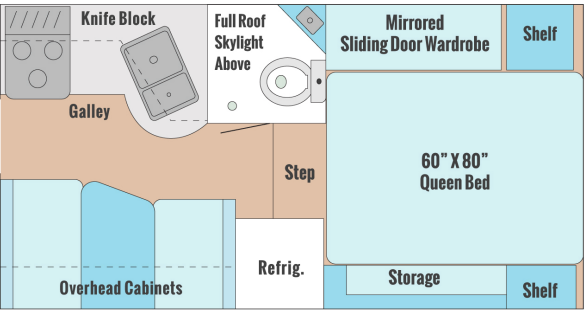

89RB

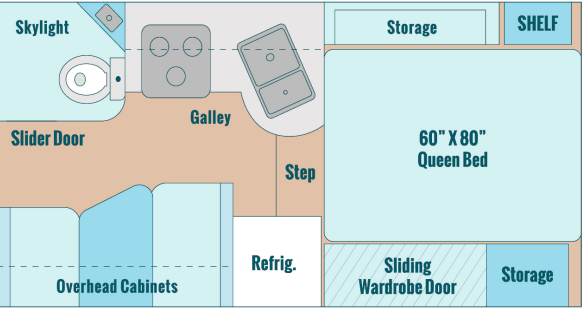

89RBS

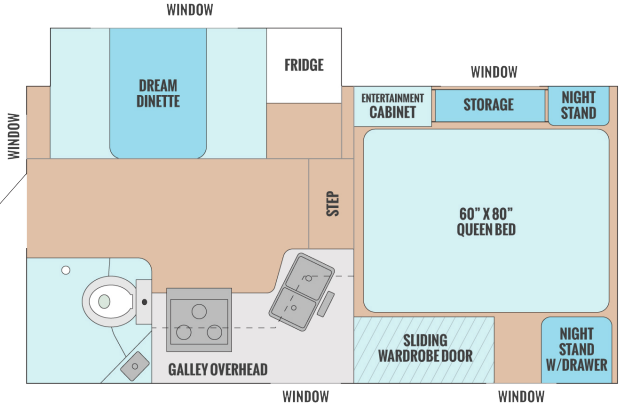

901SB

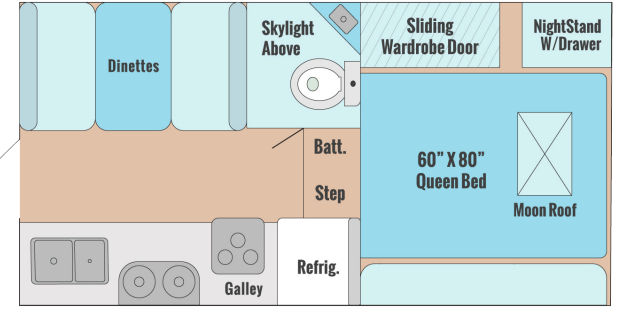

910DB

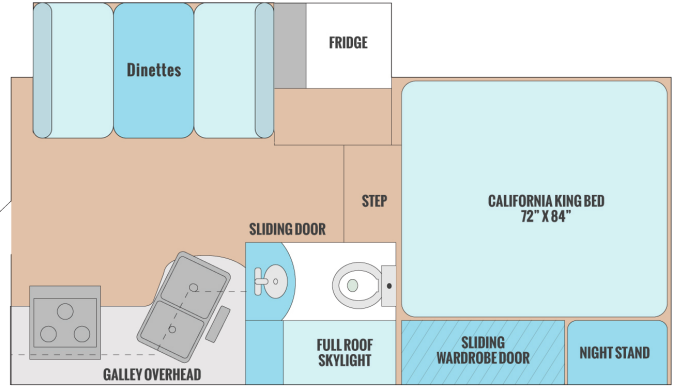

Weights & Measures	80RB	86FB	89RB	89RBS	901SB	910DB
Standard Sleeping Capacity	3	4	4	4	4/5*	4/5*
Floor Length	8'4"	8'11"	9'1"	9'1"	9'5"	10'2"
Exterior Width	90"	96"	96"	96"	96"	96"
Exterior Overall Length	15'10"	16'5"	16'8"	16'8"	17"	18'1"
Exterior Height (Floor to top of AC)	92"	106"	106"	106"	106"	106"
Interior Height	78"	78"	78"	78"	78"	78"
Dinette Size	42" x 68"	40" x 72"	40" x 76"	43" x 66"	48" x 72"	48" x 72"
Fresh Water Capacity (US Gallons/Liters)	15/57	42/159	44/167	42/167	42/159	44/167
Grey Water Capacity (US Gallons/Liters)	6/23	30/113	25/95	25/95	28/106	31/117
Black Water Capacity (US Gallons/Liters)	6/23	30/113	22/83	22/83	28/106	31/117
Hot Water Capacity (US Gallons/Liters)	4	4	4	6	6	6
Refrigerator Size (Cubic Feet)	3.5	6	6	6	6	6
Dry Weight (Lbs./Kgs.)	1787/810	2650/1202	2669/1210	3337/1513	3036/1377	3557/1613
Long and Short Bed Compatible	Yes	Yes	Yes	Yes	Yes	Long Bed

Adventurer 80RB

The 80RB is the most agile and compact model in the lineup that fits short and long-box full-size trucks.



// WHAT'S NEW

- 3-way fridge
- Motion Entry Light
- Upgraded Vinyl Seat Cushions
- Pop-out Outlets
- Removable Marine Carpet

// OPTIONAL ADDITIONS

- Jensen AM/FM/CD/DVD/Bluetooth Stereo
- Interior Decor: Canvas, Dark Night
- Happijac Wireless Jacks
- Rear Awning 12V W/LED
- 5-Step Glowstep
- Stainless Microwave
- Low Profile AC

* Full list of standard features at adventurercampers.com

// STANDARD FEATURES

- Dometic Fridge/Freezer (3.5 cu.ft.)
- Stainless Steel Range Hood w/ Fan & LED Light
- 2-Burner cooktop w/ Residential Grate
- Stainless Steel Round Sink
- Grayson Maple Hardwood Cabinet Doors
- Overhead cabinets, drawers, camper caddy
- Queen Mattress w/ Double Density Foam
- Flush Mounted Interior LED Lights
- Wet Bath + Porcelain Toilet
- Next Generation Happijac– Manual Jacks
- Fantastic Fan w/ Exhaust Roof Vent
- Furnace & Water Heater
- Phat Ladder
- LED Porch Light

// FLOOR PLAN

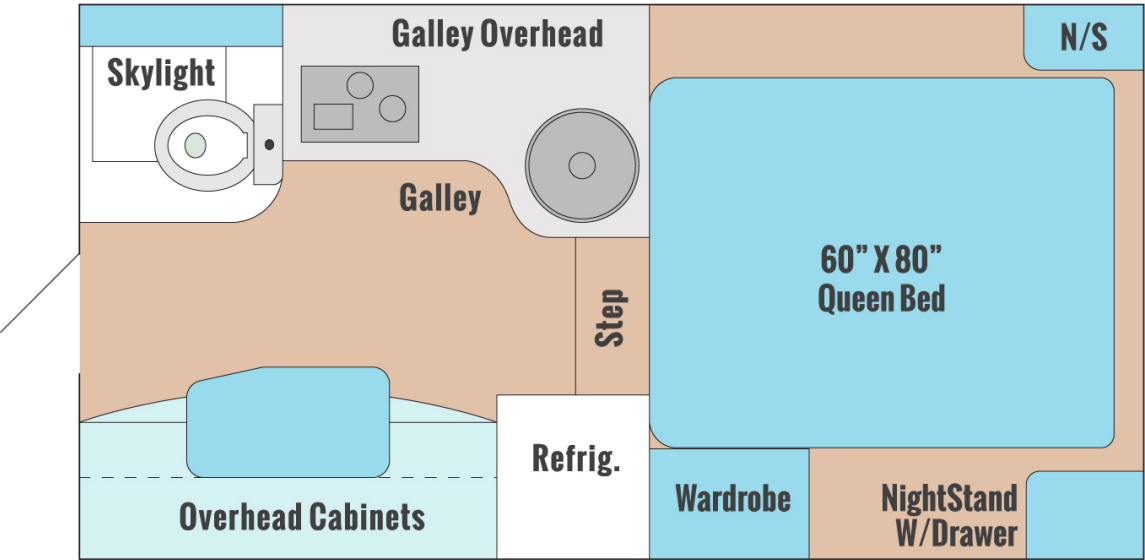

// FEATURE HIGHLIGHTS



TRU COMPOSITE CONSTRUCTION

Lamilux 4000 high gloss gel-coat fiberglass exterior with closed cell, block foam insulation



PRECISION ROUTING

Panels are CNC routed and cut for laser precision, each panel is locked into the opposing panel to increase structural integrity and strength



ABRAISION-RESISTANT ROOF

One-piece, abrasion -resistant roof material (TPO). Walk-on friendly with 12-year warranty.



STRUCTURE LOC

Custom aluminum extrusion provides rock-solid footing for our camper frames, increasing overall durability.



CABINETRY & WOODWORK

Bonded, screwed and stapled, our cabinetry is bomb-proof. Face mounts are fully laminated with no screws for a clean aesthetic.



INTEGRATED TRUCK TIE-DOWNS

Structurally integrated tie-down points bolt directly to aluminum extrusion for maximum strength.

Dry (lbs)	Fresh Water	Gray Water	Black Water
1,787	15 gal	6 gal	6 gal
Propane Tank Capacity	Ext. Length	Ext. Width	Ext. Height
20 lbs	15'10"	7'6"	6'8"
Sleeping Capacity	Floor Length	Interior Height	
3	8'4"	6'6"	

Adventurer 86FB

The 86FB is lightweight, versatile, sleeps up to four people, and fits short and long-box full-size trucks.



// WHAT'S NEW

- Motion Entry Light
- Upgraded Vinyl Seat Cushions
- Pop-out Outlets
- Removable Marine Carpet

// OPTIONAL ADDITIONS

- 19" LCD TV w/ Triple Pivot Mount
- Jensen AM/FM/CD/DVD/Bluetooth Stereo
- Interior Décor: Canvas, Dark Night
- New Generation Happijac Wireless Jacks w/ Vertical Motors
- Exclusive Comfort Step Bumper w/ Dual Tread, Double Step
- Generator – Onan QG 2500 LPG
- Auxillary Solar Panel
- Rear Awning 12V w/ LED light
- 5-Step Glowstep
- Stainless Steel Microwave
- Low Profile AC

* Full list of standard features at adventurercampers.com

// STANDARD FEATURES

- Dometic 2-door Stainless Steel Fridge/Freezer (7cu.ft)
- Dream Dinette w/ Bed Conversion
- Stainless Steel Range Hood w/ Fan & LED Light
- 3-Burner cooktop w/ Residential Grate
- Large Stainless Steel Oven
- Stainless Steel Double Bowl Sink
- Grayson Maple Hardwood Cabinet Doors
- Overhead cabinets, drawers, PJ cabinet
- Queen Mattress w/ Double Density Foam
- Mirrored double-door wardrobe closet
- Flush Mounted Interior LED Lights
- Wet Bath + Porcelain Toilet
- Basement Slide-Out Gear Storage Tray
- Next Generation Happijac– Manual Jacks
- Fantastic Fan w/ Exhaust Roof Vent
- Furnace & Water Heater
- Phat Ladder
- LED Porch Light

// FLOOR PLAN

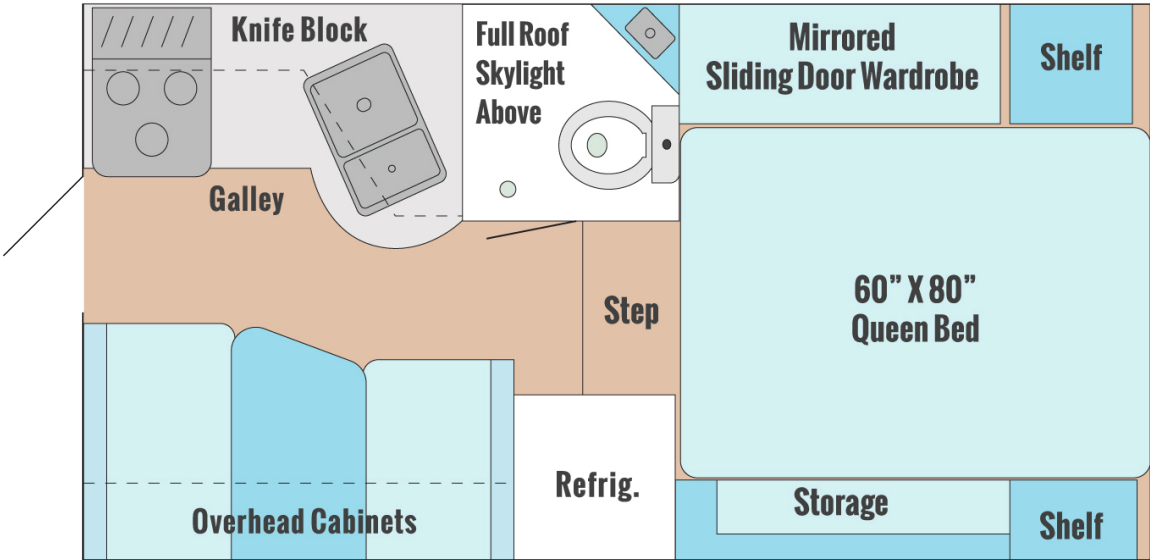

// FEATURE HIGHLIGHTS



TRU COMPOSITE CONSTRUCTION

Lamilux 4000 high gloss gel-coat fiberglass exterior with closed cell, block foam insulation



PRECISION ROUTING

Panels are CNC routed and cut for laser precision, each panel is locked into the opposing panel to increase structural integrity and strength



ABRAISION-RESISTANT ROOF

One-piece, abrasion -resistant roof material (TPO). Walk-on friendly with 12-year warranty.



STRUCTURE LOC

Custom aluminum extrusion provides rock-solid footing for our camper frames, increasing overall durability.



CABINETRY & WOODWORK

Bonded, screwed and stapled, our cabinetry is bomb-proof. Face mounts are fully laminated with no screws for a clean aesthetic.



INTEGRATED TRUCK TIE-DOWNS

Structurally integrated tie-down points bolt directly to aluminum extrusion for maximum strength.

Dry (lbs)	Fresh Water	Gray Water	Black Water
2,650	42 gal	30 gal	6 gal
Propane Tank Capacity	Ext. Length	Ext. Width	Ext. Height
2x20 lbs	15'10"	8'	8'10"
Sleeping Capacity	Floor Length	Interior Height	
4	8'11"	6'6"	

Adventurer 89RB

The 89RB is a time-tested and proven floor-plan that fits short and long-box full-size trucks.



// WHAT'S NEW

- Motion Entry Light
- Upgraded Vinyl Seat Cushions
- Pop-out Outlets
- Removable Marine Carpet

// OPTIONAL ADDITIONS

- 19" LCD TV w/ Triple Pivot Mount
- Jensen AM/FM/CD/DVD/Bluetooth Sterio
- Interior Décor: Canvas, Dark Night
- New Generation Happijac Wireless Jacks w/ Vertical Motors
- Exclusive Comfort Step Bumper w/ Dual Tread, Double Step
- Generator – Onan QG 2500 LPG
- Auxillary Solar Panel
- Rear Awning 12V w/ LED light
- Stainless Steel Microwave
- Low Profile AC

* Full list of standard features at adventurecampers.com

// STANDARD FEATURES

- Dometic 2-door Stainless Steel Fridge/Freezer (7cu.ft)
- Dream Dinette w/ Bed Conversion
- Stainless Steel Range Hood w/ Fan & LED Light
- 3-Burner cooktop w/ Residential Grate
- Large Stainless Steel Oven
- Stainless Steel Double Bowl Sink
- Aria Premier Hardwood Cabinet Doors
- Overhead cabinets, drawers, PJ cabinet
- Queen Mattress w/ Double Density Foam
- Double-door wardrobe closet
- Flush Mounted Interior LED Lights
- Wet Bath + Porcelain Toilet
- Basement Slide-Out Gear Storage Tray
- Next Generation Happijac– Manual Jacks
- Fantastic Fan w/ Exhaust Roof Vent
- Furnace & Water Heater
- Phat Ladder
- LED Porch Light

// FLOOR PLAN

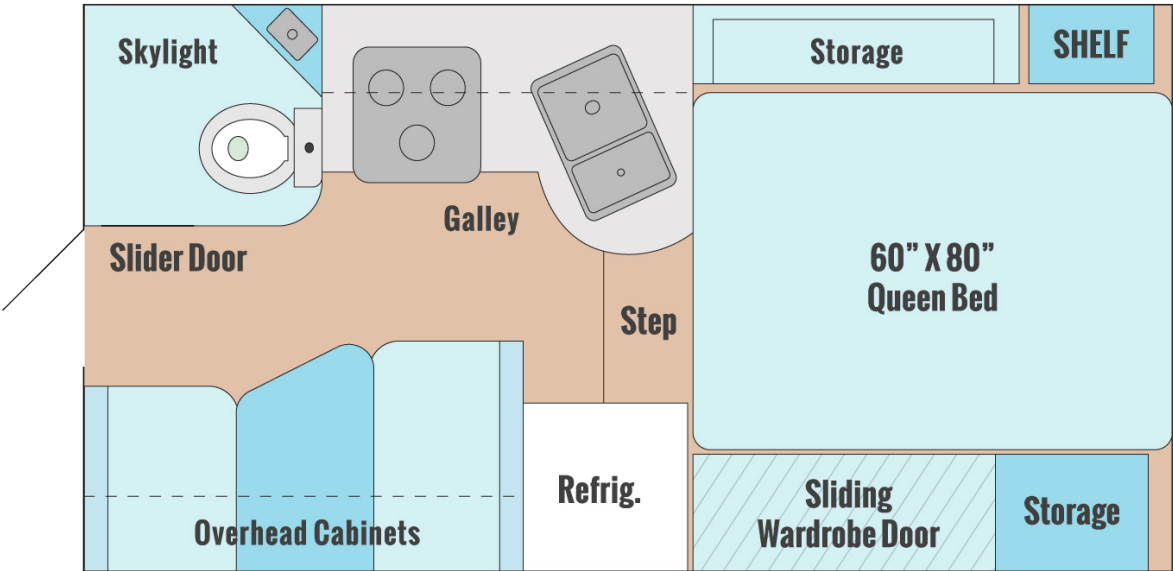

// FEATURE HIGHLIGHTS



TRU COMPOSITE CONSTRUCTION

Lamilux 4000 high gloss gel-coat fiberglass exterior with closed cell, block foam insulation



PRECISION ROUTING

Panels are CNC routed and cut for laser precision, each panel is locked into the opposing panel to increase structural integrity and strength



ABRAISION-RESISTANT ROOF

One-piece, abrasion -resistant roof material (TPO). Walk-on friendly with 12-year warranty.



STRUCTURE LOC

Custom aluminum extrusion provides rock-solid footing for our camper frames, increasing overall durability.



CABINETRY & WOODWORK

Bonded, screwed and stapled, our cabinetry is bomb-proof. Face mounts are fully laminated with no screws for a clean aesthetic.



INTEGRATED TRUCK TIE-DOWNS

Structurally integrated tie-down points bolt directly to aluminum extrusion for maximum strength.

Dry (lbs)	Fresh Water	Gray Water	Black Water
2,669	42 gal	25 gal	22 gal
Propane Tank Capacity	Ext. Length	Ext. Width	Ext. Height
2x20 lbs	16'8"	8'	8'10"
Sleeping Capacity	Floor Length	Interior Height	
4	9'1"	6'6"	

Adventurer 89RBS

The 89RBS adds a full wall-slide to expand interior living space, built to fit short and long-box full-size trucks



// WHAT'S NEW

- Motion Entry Light
- Upgraded Vinyl Seat Cushions
- Pop-out Outlets
- Removable Marine Carpet

// OPTIONAL ADDITIONS

- Jensen AM/FM/CD/DVD/Bluetooth Stereo System
- Interior Décor: Canvas, Dark Night
- New Generation Happijac Wireless Jacks w/ Vertical Motors
- Generator – Onan QG 2500 LPG
- Auxillary Solar Panel
- Rear Awning 12V w/ LED light
- Stainless Steel Microwave
- Low Profile AC

* Full list of standard features at adventurercampers.com

// STANDARD FEATURES

- Dometic 2-door Stainless Steel Fridge/Freezer (7cu.ft)
- Dream Dinette w/ Bed Conversion
- Stainless Steel Range Hood w/ Fan & LED Light
- 3-Burner cooktop w/ Residential Grate
- Large Stainless Steel Oven
- Stainless Steel Double Bowl Sink
- Aria Premeer Hardwood Cabinet Doors
- Overhead cabinets, drawers, PJ cabinet
- Queen Mattress w/ Double Density Foam
- Double-door wardrobe closet
- Flush Mounted Interior LED Lights
- Wet Bath + Porcelain Toilet
- Basement Slide-Out Gear Storage Tray
- Next Generation Happijac– Manual Jacks
- Fantastic Fan w/ Exhaust Roof Vent
- Furnace & Water Heater
- Phat Ladder
- LED Porch Light

// FLOOR PLAN

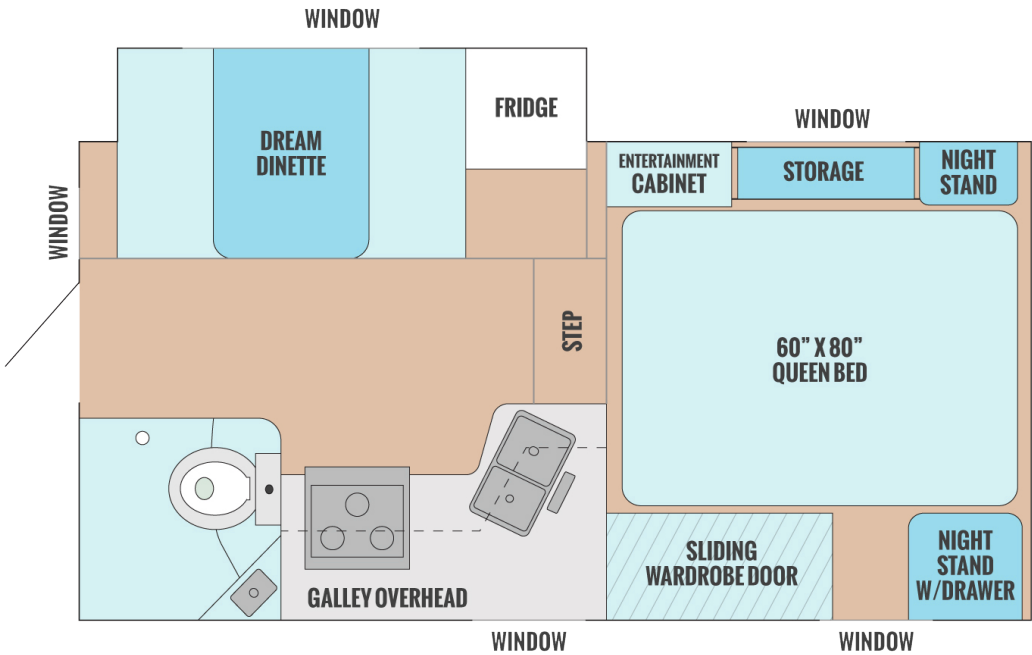

// FEATURE HIGHLIGHTS



TRU COMPOSITE CONSTRUCTION

Lamilux 4000 high gloss gel-coat fiberglass exterior with closed cell, block foam insulation



PRECISION ROUTING

Panels are CNC routed and cut for laser precision, each panel is locked into the opposing panel to increase structural integrity and strength



ABRAISION-RESISTANT ROOF

One-piece, abrasion -resistant roof material (TPO). Walk-on friendly with 12-year warranty.



STRUCTURE LOC

Custom aluminum extrusion provides rock-solid footing for our camper frames, increasing overall durability.



CABINETRY & WOODWORK

Bonded, screwed and stapled, our cabinetry is bomb-proof. Face mounts are fully laminated with no screws for a clean aesthetic.



INTEGRATED TRUCK TIE-DOWNS

Structurally integrated tie-down points bolt directly to aluminum extrusion for maximum strength.

Dry (lbs)	Fresh Water	Gray Water	Black Water
3,337	42 gal	25 gal	22 gal
Propane Tank Capacity	Ext. Length	Ext. Width	Ext. Height
40 lbs	16'8"	8'	8'10"
Sleeping Capacity	Floor Length	Interior Height	
4	9'1"	6'6"	

Adventurer 901SB

The 901SB is spacious and flexible with an optional power bunk that’s great for families and friends. Fits short and long-box full-size trucks.



// WHAT'S NEW

- Motion Entry Light
- Upgraded Vinyl Seat Cushions
- Pop-out Outlets
- Removable Marine Carpet

// OPTIONAL ADDITIONS

- Electric Power Bunk
- 19" LCD TV w/ Triple Pivot Mount
- Jensen AM/FM/CD/DVD/Bluetooth Stereo System
- Interior Décor: Canvas, Dark Night
- New Generation Happijac Wireless Jacks w/ Vertical Motors
- Generator – Onan QG 2500 LPG
- Auxillary Solar Panel
- Rear Awning 12V w/ LED light
- Stainless Steel Microwave
- Low Profile AC

Full list of standard features at adventurercampers.com

// STANDARD FEATURES

- Dometic 2-door Stainless Steel Fridge/Freezer (7cu.ft)
- Dream Dinette w/ Bed Conversion
- Stainless Steel Range Hood w/ Fan & LED Light
- 3-Burner cooktop w/ Residential Grate
- Large Stainless Steel Oven
- Stainless Steel Double Bowl Sink
- Grayson Maple Hardwood Cabinet Doors
- Overhead cabinets, drawers, PJ cabinet
- Queen Mattress w/ Double Density Foam
- Double-door wardrobe closet
- Flush Mounted Interior LED Lights
- Wet Bath + Porcelain Toilet
- Basement Slide-Out Gear Storage Tray
- Next Generation Happijac– Manual Jacks
- Fantastic Fan w/ Exhaust Roof Vent
- Furnace & Water Heater
- Phat Ladder
- LED Porch Light

// FLOOR PLAN

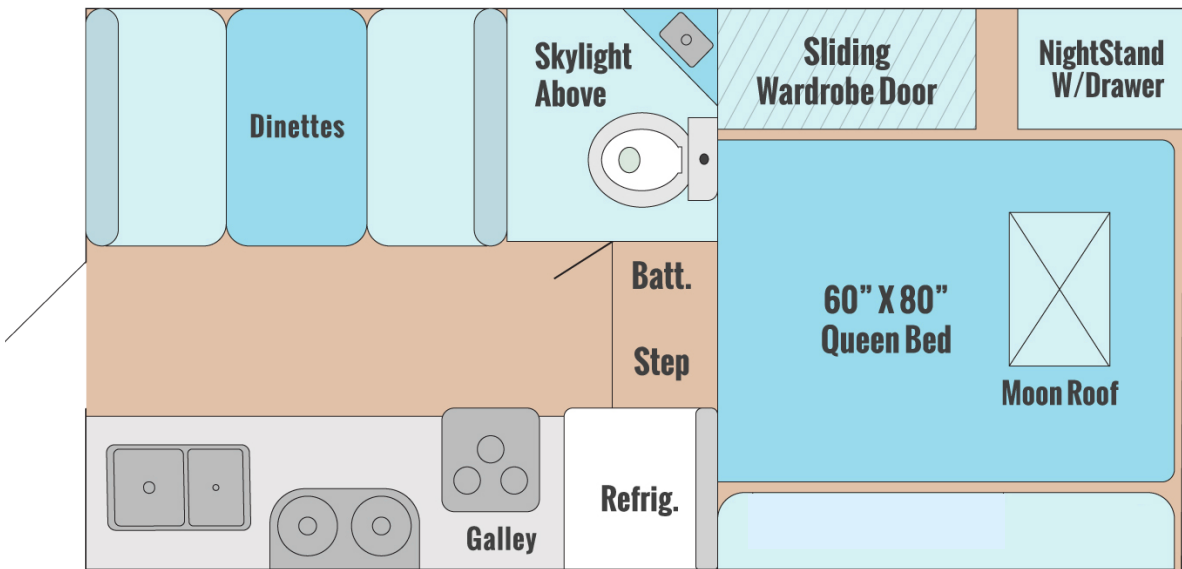

// FEATURE HIGHLIGHTS



TRU COMPOSITE CONSTRUCTION

Lamilux 4000 high gloss gel-coat fiberglass exterior with closed cell, block foam insulation



PRECISION ROUTING

Panels are CNC routed and cut for laser precision, each panel is locked into the opposing panel to increase structural integrity and strength



ABRAISION-RESISTANT ROOF

One-piece, abrasion -resistant roof material (TPO). Walk-on friendly with 12-year warranty.



STRUCTURE LOC

Custom aluminum extrusion provides rock-solid footing for our camper frames, increasing overall durability.



CABINETRY & WOODWORK

Bonded, screwed and stapled, our cabinetry is bomb-proof. Face mounts are fully laminated with no screws for a clean aesthetic.



INTEGRATED TRUCK TIE-DOWNS

Structurally integrated tie-down points bolt directly to aluminum extrusion for maximum strength.

Dry (lbs)	Fresh Water	Gray Water	Black Water
3,036	42 gal	28 gal	28 gal
Propane Tank Capacity	Ext. Length	Ext. Width	Ext. Height
40 lbs	17'	8'	8'10"
Sleeping Capacity	Floor Length	Interior Height	
4-5*	9'5"	6'6"	

*power bunk adds 1

Adventurer 910DB

The 910DB is the largest model in our lineup. Fully equipped with a full wall-slide and optional power bunk, it's highly capable and designed for long-box trucks



// WHAT'S NEW

- Motion Entry Light
- Upgraded Vinyl Seat Cushions
- Pop-out Outlets
- Removable Marine Carpet

// OPTIONAL ADDITIONS

- Electric Power Bunk
- 19" LCD TV w/ Triple Pivot Mount
- Jensen AM/FM/CD/DVD/Bluetooth Stereo System
- Interior Décor: Canvas, Dark Night
- New Generation Happijac Wireless Jacks w/ Vertical Motors
- Generator – Onan QG 2500 LPG
- Auxillary Solar Panel
- Rear Awning 12V w/ LED light
- Stainless Steel Microwave
- Low Profile AC

Full list of standard features at adventurercampers.com

// STANDARD FEATURES

- Dometic 2-door Stainless Steel Fridge/Freezer (7cu.ft)
- Dream Dinette w/ Bed Conversion
- Stainless Steel Range Hood w/ Fan & LED Light
- 3-Burner cooktop w/ Residential Grate
- Large Stainless Steel Oven
- Stainless Steel Double Bowl Sink
- Aria Premeer Hardwood Cabinet Doors
- Overhead cabinets, drawers, PJ cabinet
- King Mattress w/ Double Density Foam
- Double-door wardrobe closet
- Flush Mounted Interior LED Lights
- Dry Bath w/ separate one-piece fiberglass shower
- Porcelain Toilet
- Basement Slide-Out Gear Storage Tray
- Next Generation Happijac– Manual Jacks
- Fantastic Fan w/ Exhaust Roof Vent
- Furnace & Water Heater
- Phat Ladder
- LED Porch Light

Dry (lbs)	Fresh Water	Gray Water	Black Water
3,557	44 gal	31 gal	31 gal
Propane Tank Capacity	Ext. Length	Ext. Width	Ext. Height
40 lbs	18'1"	8'	8'10"
Sleeping Capacity	Floor Length	Interior Height	
4-5*	10'2"	6'6"	

*power bunk adds 1

// FLOOR PLAN

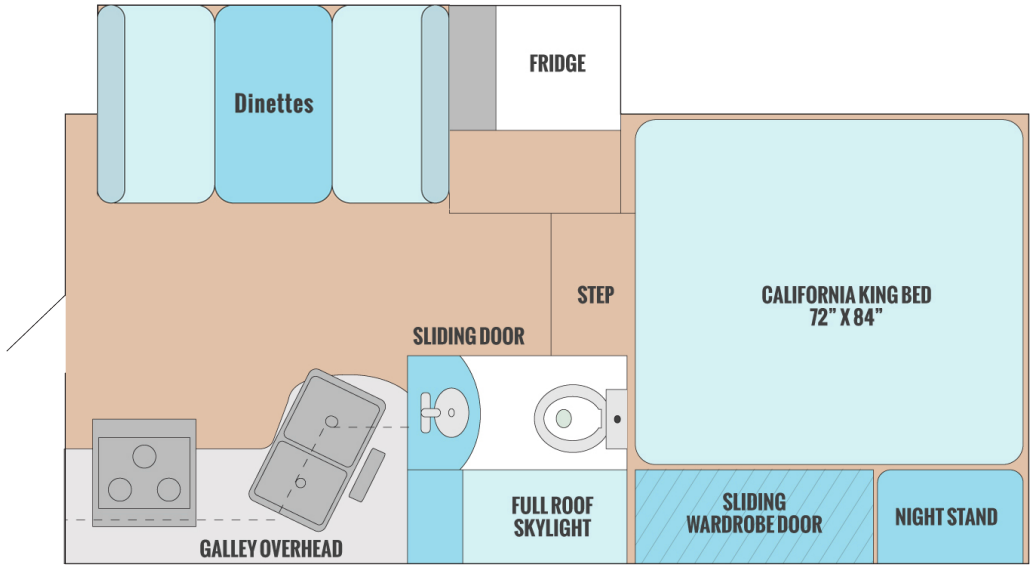

// FEATURE HIGHLIGHTS



TRU COMPOSITE CONSTRUCTION

Lamilux 4000 high gloss gel-coat fiberglass exterior with closed cell, block foam insulation



PRECISION ROUTING

Panels are CNC routed and cut for laser precision, each panel is locked into the opposing panel to increase structural integrity and strength



ABRAISION-RESISTANT ROOF

One-piece, abrasion -resistant roof material (TPO). Walk-on friendly with 12-year warranty.



STRUCTURE LOC

Custom aluminum extrusion provides rock-solid footing for our camper frames, increasing overall durability.



CABINETRY & WOODWORK

Bonded, screwed and stapled, our cabinetry is bomb-proof. Face mounts are fully laminated with no screws for a clean aesthetic.



INTEGRATED TRUCK TIE-DOWNS

Structurally integrated tie-down points bolt directly to aluminum extrusion for maximum strength.

The Leader in Comfort and Craftsmanship, since 1969.





4-Season Truck Campers Built for Adventure.

3303 W Washington Ave
Yakima, WA 98903
(509) 895-7064

www.adventurercampers.com



Proudly Built in the USA