

TRAVEL

S U P R E M E

C SERIES SE

22AF

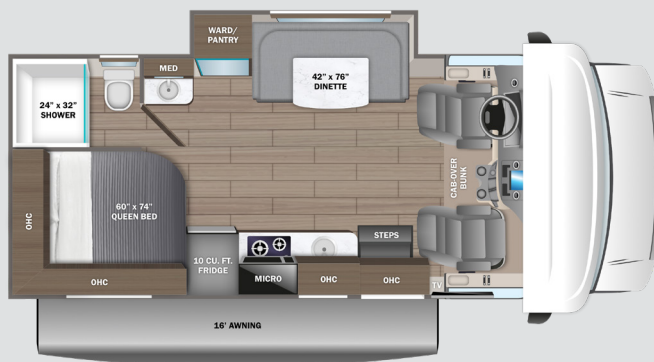

22CF



EXTERIOR SELECTIONS



Standard Graphics Package

STANDARDS & OPTIONS

CUSTOMER VALUE PACKAGE

One-piece, seamless, fiberglass front cap
Heated holding tanks (12V pads)
Electric patio awning
Black holding tank sprayer
Backup camera
LED HD Smart TV

STANDARD DRIVING EQUIPMENT

Ford® E-350 chassis
GVWR - 12,500 lb.
GCWR - 18,500 lb.
7.3L V-8 325 HP engine with 450 ft.-lb. torque
6-speed TorqShift® series transmission with overdrive
210-amp alternator
5,000 lb. hitch with 500 lb. tongue capacity and 7-pin plug
Catalytic converter theft deterrent
E-rated highway tires- LT225/75R16
Tire pressure monitoring system (TPMS)
12V chassis battery
Power anti-lock brakes with power steering
Remote-controlled, side-view mirrors
Hill start assist
Tilt steering wheel
Cruise control
Electronic stability control
Traction control
Power windows and door locks
Auxiliary start switch
Driver and passenger airbags

STANDARD EXTERIOR EQUIPMENT

TuffShell™ vacuum-bond laminated roof, floor and sidewalls
Bead-foam insulation (R-24 max roof, R-9 max floor, R-5 max walls)

Tufflex™ PVC laminated roof
Aluminum running boards
Fiberglass exterior walls with vinyl graphics
Entrance door with industry's largest travel-view window
Electric-powered entrance step with integrated house battery compartment
Third brake light
4 in. bumper tube sewer hose storage
Cable TV hookup with RG-6 coax
Digital antenna with signal booster
4,000W generator
Solar prep
12V house battery
Transfer switch with reverse polarity protection
30-amp electrical service
12.2 gal. propane tank (41 lb.)
LP quick-connect hookup
Exterior utility center
Winterization drain system
Outside shower
12V demand water pump
Water filtration system

STANDARD INTERIOR EQUIPMENT

Overhead bunk with 750 lb. capacity
84 in. ceiling height
High-intensity, recessed LED ceiling lights
Hardwood cabinet doors
Ball-bearing drawer guides
42 in. x 78 in. U-shaped dinette (22AF)
Easy-operation legless dinette table (22CF)
2-point lap safety belts in all designated seating locations
Interior entrance door grab handle
Interior command center
Pleated blackout shades
13,500 BTU ducted A/C
30,000 BTU auto-ignition furnace
6 gal. gas/electric DSI auto-ignition water heater

Smoke alarm
Carbon monoxide detector
Fire extinguisher
10 cu. ft. 12V refrigerator
2-burner cooktop with flush cover
Convection microwave oven
Stainless steel kitchen sink
Queen-size bed with bedspread
Large wardrobes (select models)
Shower with decorative ABS surround and skylight
Stainless steel bathroom sink
Toilet with foot flush

OPTIONS

Automatic hydraulic leveling jacks
200W solar panel with dual controller and second house battery

FLOORPLAN	GVWR (lbs.)	GCWR (lbs.)	WHEEL BASE	OVERALL LENGTH	EXTERIOR HEIGHT WITH SATELLITE AND A/C	EXTERIOR WIDTH	INTERIOR HEIGHT	FRESH WATER CAPACITY (gal.)	GRAY WASTE WATER CAPACITY (gal.)	BLACK WASTE WATER CAPACITY (gal.)
22AF	12,500	18,500	158"	24' 9"	11' 6"	100"	84"	44	40	32
22CF	12,500	18,500	158"	24' 9"	11' 6"	100"	84"	44	40	31

Meet your Travel Supreme Dealer

Some specs at the time of print may include estimates. For the most updated information, please visit [Travel Supreme.com](http://TravelSupreme.com)



Scan QR code for specification definitions

TRAVEL
SUPREME

Travel Supreme Inc. | P.O. Box 460 | Middlebury, IN 46540
See dealer for further information and prices. All information in this brochure and on www.travelsupreme.com is the latest available at the time of publication approval. Travel Supreme reserves the right to make changes and to discontinue models without notice or obligation. Photography may show optional equipment or props used for decoration purposes only. RVs built for sale in Canada may differ to conform to Canadian codes. TRAVEL SUPREME is a registered trademark of Jayco, Inc. Printed in USA 1/25 ©2025 Jayco, Inc. 2032963

Travel Supreme - Part of Jayco Family of Companies