

# TRAVEL SUPREME A SERIES PREMIER

**OPTIONS**

**A**



15 Cu. Ft. Fridge

**B**



Theater Sofa

**31UL**    **OPTIONS: A,B**



**34G**    **OPTION: A**

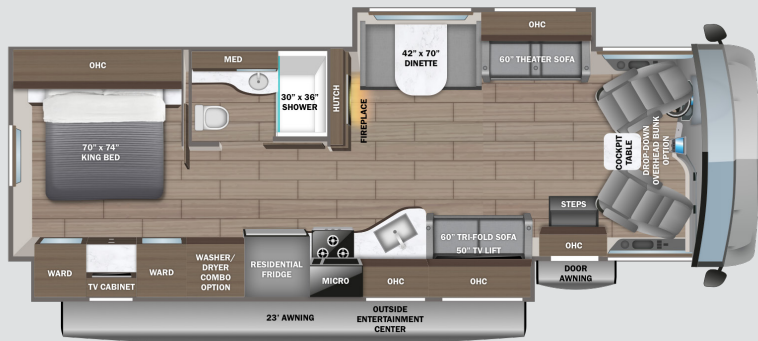

## EXTERIOR SELECTIONS



Standard Graphics Package



Cypress Full-Body Paint



Merion Full-Body Paint

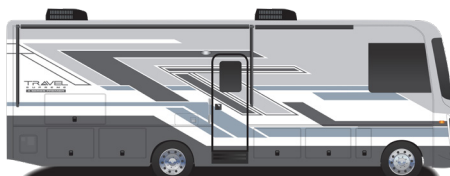

Muirfield Full-Body Paint



Oakmont Full-Body Paint

# STANDARDS & OPTIONS

## CUSTOMER VALUE PACKAGE

Supreme Ride +: Computer-balanced driveshaft, Bilstein® steering stabilizer, Koni® shocks, variable-rate front and rear jounce bumpers, heavy-duty front and rear stabilizer bars, 22.5 in. Michelin® tires  
Automatic hydraulic leveling jacks  
Lippert™ 4000 series frameless bonded windows  
15,000 BTU A/C unit with heat pump and second 13,500 BTU A/C unit  
Exterior entertainment center with outside speakers and LED HD Smart TV mounted on swivel bracket  
Electric patio awning with LED lights  
Slideout cover awnings  
5,500W generator with auto-gen start  
1,200W inverter  
50-amp electrical service  
10 gal. gas/electric water heater  
Sony® infotainment center with Apple CarPlay® and Android Auto™  
Backup and side-view cameras  
Removable driver/passenger cockpit table  
LED-lit, solid-surface kitchen countertops with recessed stainless steel sink and sink covers  
LED HD Smart TV in living area  
Integrated day/night cassette shades

## STANDARD DRIVING EQUIPMENT

Ford® F53 chassis  
GVWR - 22,000 lb.  
GCWR - 26,000 lb.  
7.3L V-8 335 HP engine with 468 ft.-lb. torque  
6-speed automatic TorqShift® transmission with overdrive and tow haul mode  
210-amp alternator  
Catalytic converter theft deterrent  
G-rated highway tires - 235/80R22.5  
Front and rear disc, 4-wheel anti-lock brakes  
5,000 lb. rear hitch receiver with dual connector and 7-pin plug  
12V chassis battery  
80 gal. fuel tank  
120 in. panoramic windshield  
6-way power and swivel driver/passenger seats  
Soft-touch, vinyl-wrapped automotive dash

Tilt steering wheel  
Cruise control  
Hill start assist  
Electronic stability control  
Traction control  
Auxiliary start  
Power front privacy shade with manual side privacy shades

## STANDARD EXTERIOR EQUIPMENT

TuffShell™ vacuum-bond laminated roof, floor and sidewalls  
Bead-foam insulation (R-24 max roof, R-9 max floor, R-8 max walls)  
One-piece, seamless fiberglass front cap with partial paint  
One-piece, seamless fiberglass rear cap  
One-piece, seamless, crowned fiberglass roof  
Fiberglass exterior walls with vinyl graphics  
Entrance door with industry's largest travel-view window  
Electric-powered entrance steps  
Lockable pass-through storage compartments with metal slam latches  
Third brake light  
Roof ladder  
Prep for satellite dish  
Cable TV hookup with RG-6 coax  
Winegard 2.0 Wi-Fi/4G antenna  
200W solar panel with dual controller  
(2) 6V AGM (220Ah) house batteries on slideout tray  
Transfer switch with reverse polarity protection  
Detachable power cord  
16.5 gal. propane tank (56-lb.)  
LP quick-connect hookup  
Heated holding tanks (12V pads)  
Exterior utility center  
Winterization drain system  
Black tank flush  
Outside shower  
12V demand water pump  
Water filtration system

## STANDARD INTERIOR EQUIPMENT

Firefly Multiplex system - wall-mounted touchscreen and mobile app for total coach control  
84 in. interior ceiling height with padded vinyl ceiling  
High-intensity recessed LED ceiling lights  
LED-lit fascia  
Hardwood cabinet doors and drawer fronts  
Ball-bearing drawer guides  
30,000 BTU auto-ignition ducted furnace  
Electric fireplace (34G)  
Easy-operation legless dinette table  
2-point lap safety belts in all designated seating locations  
Car seat tethers (select floorplans)  
JBL® audio system  
Smoke alarm  
Carbon monoxide detector  
Fire extinguisher  
Residential refrigerator  
Furrion® all-in-one cooktop and oven  
Residential-size microwave  
Decorative kitchen backsplash  
Walk-around, king-size bed with bedspread and nightstands  
USB port and wireless charging in nightstands  
Under-bed storage (select models)  
LED HD Smart TV in bedroom  
Large wardrobes  
Shower with decorative surround, glass door, skylight and light  
Recessed stainless steel bathroom sink  
Porcelain toilet with foot flush  
Powered roof vent in bathroom with wall switch

## OPTIONS

Drop-down overhead bunk in cab area with 750 lb. capacity  
Combination washer/dryer (34G)  
15 cu. ft. 12V refrigerator

FLOORPLAN	GVWR (lbs.)	GCWR (lbs.)	WHEEL BASE	OVERALL LENGTH	EXTERIOR HEIGHT WITH SATELLITE AND A/C	EXTERIOR WIDTH	INTERIOR HEIGHT	FRESH WATER CAPACITY (gal.)	GRAY WASTE WATER CAPACITY (gal.)	BLACK WASTE WATER CAPACITY (gal.)
31UL	22,000	26,000	228"	36' 11"	12' 10"	101"	84"	72	40	40
34G	22,000	26,000	238"	36' 6"	12' 10"	101"	84"	72	40	50

Meet your Travel Supreme Dealer

Some specs at the time of print may include estimates. For the most updated information, please visit [Travel Supreme.com](https://www.travelsupreme.com)



Scan QR code for specification definitions

**TRAVEL**  
SUPREME

**Travel Supreme Inc. | P.O. Box 460 | Middlebury, IN 46540**  
See dealer for further information and prices. All information in this brochure and on [www.travelsupreme.com](https://www.travelsupreme.com) is the latest available at the time of publication approval. Travel Supreme reserves the right to make changes and to discontinue models without notice or obligation. Photography may show optional equipment or props used for decoration purposes only. RVs built for sale in Canada may differ to conform to Canadian codes. TRAVEL SUPREME is a registered trademark of Jayco, Inc. Printed in USA 1/25 ©2025 Jayco, Inc. 2032963

Travel Supreme - Part of Jayco Family of Companies