

2025 E-SERIES



2025 E SERIES SPARK





EMBER

RECREATIONAL VEHICLES

2025 E-SERIES TRAVEL TRAILERS

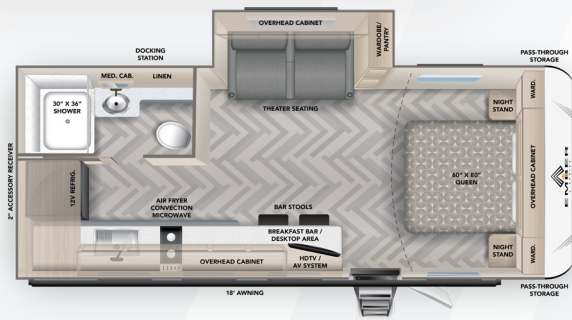
21RKE

LENGTH	HEIGHT	DRY WEIGHT	HITCH WEIGHT
25'3"	11'2"	5,035 LBS	525 LBS

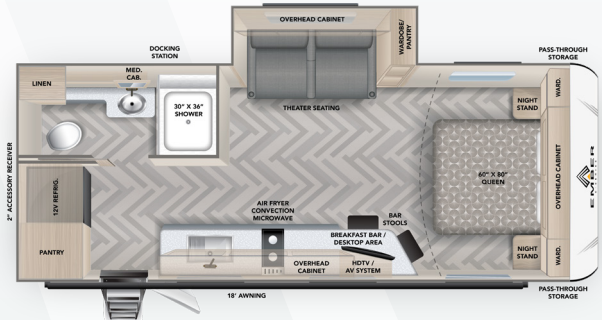
21FBE

LENGTH	HEIGHT	DRY WEIGHT	HITCH WEIGHT
25'11"	11'2"	5,110 LBS	550 LBS

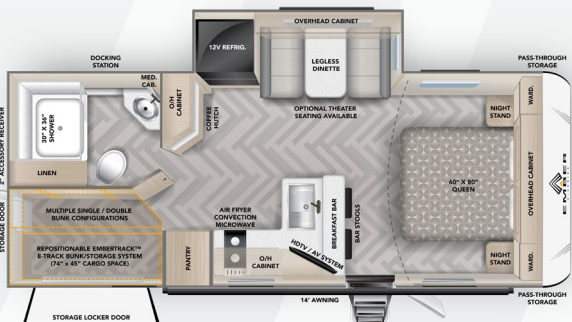
22ETS

LENGTH	HEIGHT	DRY WEIGHT	HITCH WEIGHT
27'1"	11'2"	5,330 LBS	610 LBS

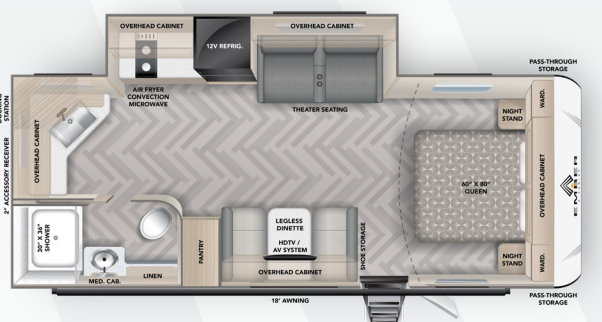
22MLQ

LENGTH	HEIGHT	DRY WEIGHT	HITCH WEIGHT
27'1"	11'2"	5,225 LBS	575 LBS

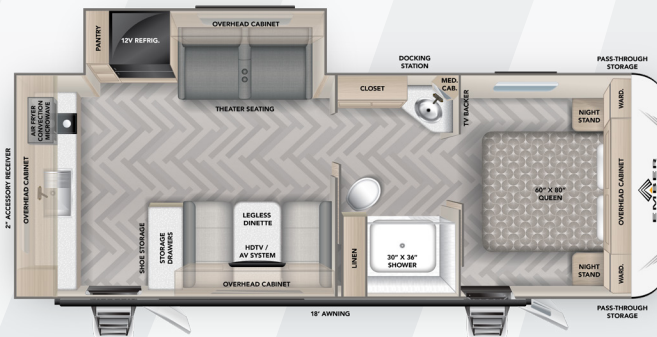
24RLD

LENGTH	HEIGHT	DRY WEIGHT	HITCH WEIGHT
28'7"	11'2"	5,600 LBS	630 LBS

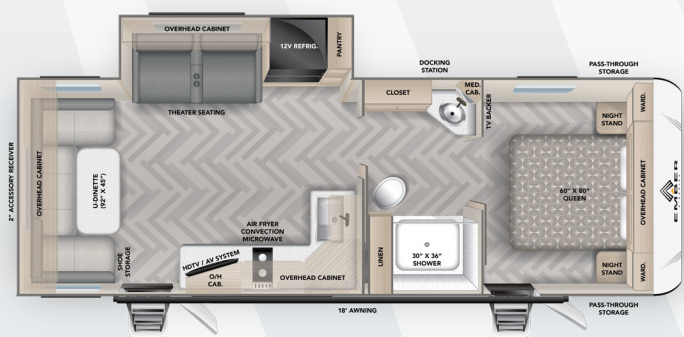
25RUD

LENGTH	HEIGHT	DRY WEIGHT	HITCH WEIGHT
30'1"	11'2"	5,640 LBS	690 LBS

TOP FEATURES:

- 18,000 BTU Max Cool "Whisper Quiet" A/C (Largest Single A/C in Class) with Remote Control
- 15" Goodyear Endurance® Tires (Load Range E, Made in the USA!)
- Laminated Azdel Onboard® Composite Walls
- Best-in-Class 82" Ceiling Height (More Overhead Storage)
- Walk-around True Residential Queen Size 60" x 80" Front Bed
- Congoleum® DiamondFlor® "Carpetless" Interior
- Air Fryer Convection Microwave
- EmberLink™ "Smart RV" System Controls Slides, Awning, and Lights
- XL 55 gal. Fresh, 35 gal. Gray (dual 35 gal. Gray on 24RLD, 25RUD, 26ETS) & 35 gal. Black Tanks
- Optional Off-grid Solar Package with (2) 200W Rooftop Panels (400W total), 2000W Inverter, and Victron® MPPT Solar Controller

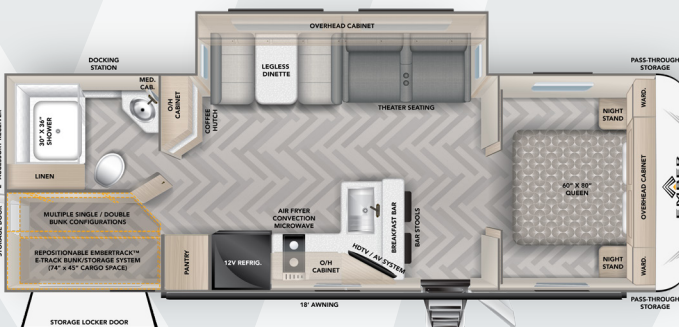
26ETS

LENGTH	HEIGHT	DRY WEIGHT	HITCH WEIGHT
31'7"	11'2"	6,100 LBS	670 LBS

Please Note: Information on this flyer is the latest available at the time of publication approval. Ember Recreational Vehicles reserves the right to make changes and to discontinue models without notice or obligation. RVs built for sale in Canada may differ to conform to Canadian codes. EMBER is a registered trademark of Ember Recreational Vehicles, Inc. ©2024 EMBER RECREATIONAL VEHICLES, INC. REV240829

EXPLORE MORE AT EmberRV.com

STANDARDS

Construction

- Laminated Azdel Composite Walls
- Best-in-Class 82" Ceiling Height
- Aluminum-framed Sidewall Construction
- Gel-coated Fiberglass Exterior
- Aluminum-framed Laminated Floor
- Fully Walkable Roof with One-piece Tufflex® PVC Roofing (Lifetime Warranty)
- Dexter® Axles with E-Z Lube Hubs and Forward Self-Adjusting Electric Brakes

Exterior

- 15" Goodyear Endurance® Load Range E Tires (including spare; Made in the USA!)
- Custom Aluminum Rims
- Adjustable Solid Step™ Entry Stairs
- Slam-Latch Baggage Doors
- Electric Awning with Dimmable LED Light
- Front Electric Tongue Jack with LED Light and Built-In 7-Way Cable Holder
- Front and Rear Quick Drop™ Stabilizers
- High-Visibility LED Exterior Lighting
- Back-Up Lighting
- Fully-Enclosed Radiant Barrier Underbelly
- XL Fresh Water Tank (55 gallons)
- 12V Tank Heaters
- Dual 20# LP Tanks (40# total capacity)
- LP Quick Connect
- 30 Amp Service
- Detachable Shore Power Cord
- Battery Disconnect
- Outside Shower
- Black Tank Flush
- 30" Friction-Hinge Entrance Door
- Frame-Integrated Rear 2" Accessory Receiver (300# capacity)
- Repositionable/Telescoping Roof Ladder + Rear-Mounted Bracket
- Winegard Air 360+ Omnidirectional Antenna (Wi-Fi/LTE Prep)
- Keyed-Alike™ Locking System
- 360 Siphon® Roof Vent Caps
- Coiled Break-Away Cable
- Sewer Hose Caddy

- PREPPED FOR: Solar Upgrades (Side and Rooftop Solar Ports), Rear/Side Observation Camera, Tire Pressure Monitoring System (TPMS), Inverter, Slide Topper, and Starlink Cable

Interior

- 18,000 BTU Max Cool "Whisper Quiet" A/C (Largest Single A/C in Class)
- 60" x 80" Residential-Sized Queen Bed with USB-A, USB-C, and 120V Powered Cubbies with LED Lights on Each Side
- EmberLink™ Smart RV Control System
- 12V Refrigerator (10 cu. ft.)
- Air Fryer Convection Microwave
- 12V HD Smart TV with Built-In JBL® Soundbar Bluetooth® AV System
- Hardwood Framed Cabinet Doors with Hidden Hinges
- Soft Close Hardwood Drawers
- Roller Shades
- 12V Multi-speed Fan (Main Room)
- Seamless Countertops
- Stainless Steel Kitchen Sink with Pull-out Sprayer Faucet
- Dual-burner Cooktop
- Dimmable Interior LED Lighting
- Congoleum® DiamondFlor® "Carpetless" Interior
- Tankless "On Demand" Water Heater
- Porcelain Foot-Flush Toilet
- 30K BTU Furnace
- Medicine Cabinet with LED Backlight
- Bathroom Skylight and 12V Fan
- Smoke/CO/LP Detectors
- Fire Extinguisher

OPTIONS

- Wireless Side/Rear Observation Camera System with 12V Monitor
- Theater Seating (in place of Booth)
- Tire Pressure Monitoring System (TPMS)
- Off-Grid Solar Package: Dual GoPower!® 200W Rooftop Solar Panels (400W total), 2000W Pure Sine Wave Inverter, and Victron® MPPT Solar Controller



FURRIONCHILL™
18K BTU "WHISPER QUIET"
CHILL® CUBE VARIABLE SPEED
ROOFTOP AIR CONDITIONER
LARGEST AIR CONDITIONING
SYSTEM IN OUR CLASS!

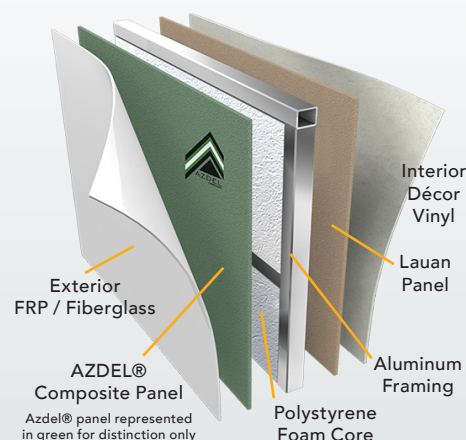

E-SERIES SIDEWALL CUT-AWAY
LAMINATED AZDEL ONBOARD®
COMPOSITE WALLS WITH
ALUMINUM FRAMING AND
GEL-COATED FIBERGLASS



NOTES



EMBER

RECREATIONAL VEHICLES

2025 E-SERIES SPARK TRAVEL TRAILERS

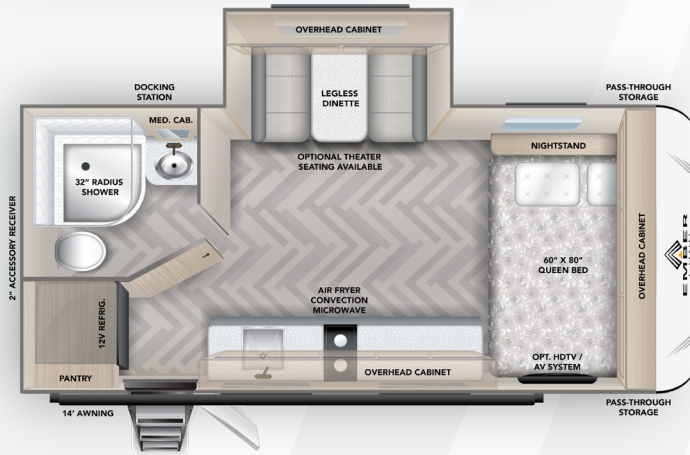

18BE

LENGTH
21'4"

HEIGHT
11'3"

DRY WEIGHT
4,165 LBS

HITCH WEIGHT
435 LBS

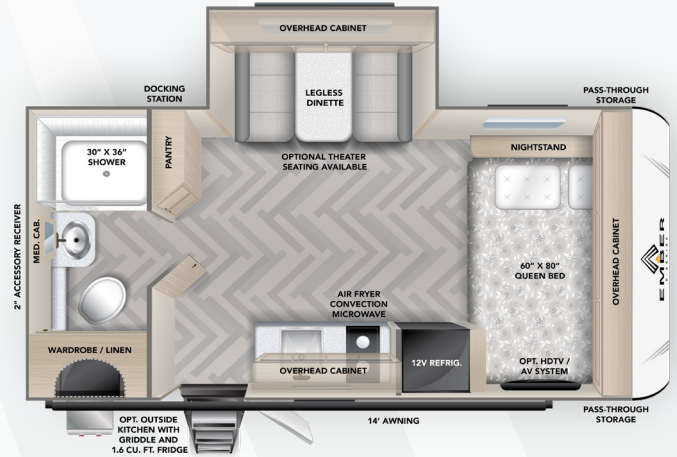

18RB

LENGTH
TBD

HEIGHT
11'3"

DRY WEIGHT
TBD LBS

HITCH WEIGHT
TBD LBS

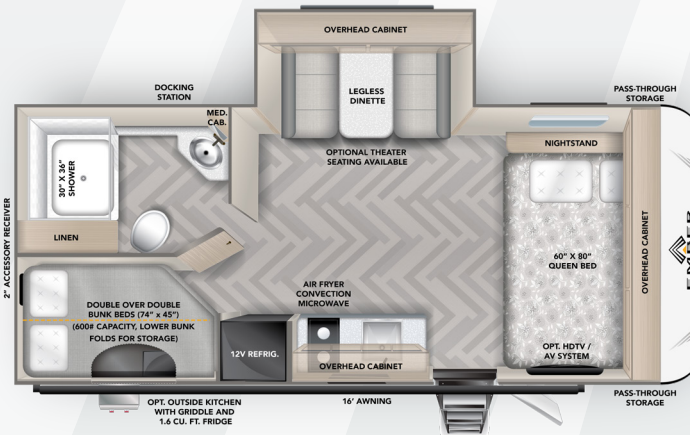

19DBE

LENGTH
23'4"

HEIGHT
11'3"

DRY WEIGHT
TBD LBS

HITCH WEIGHT
TBD LBS

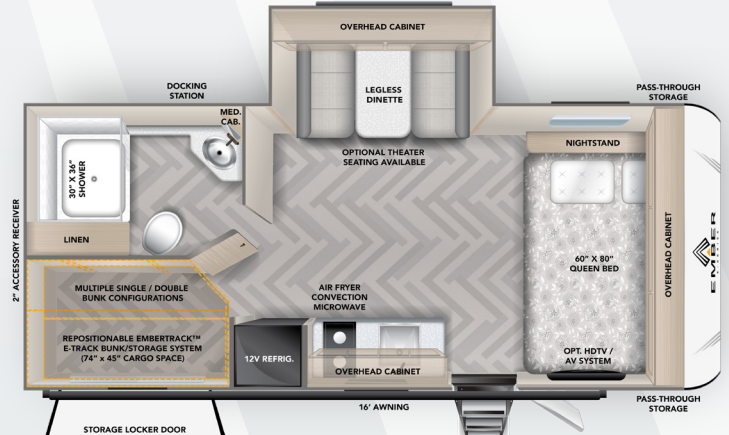

19ETS

LENGTH
23'4"

HEIGHT
11'3"

DRY WEIGHT
4,545 LBS

HITCH WEIGHT
575 LBS

SPARK

TOP FEATURES

*** AVAILABLE THEATER SEATING OPTION**
RECLINING WALL-HUGGER THEATER SEATS WITH CUP HOLDERS AND ROTATING SIDE TABLES CAN BE OPTIONED IN PLACE OF THE BOOTH DINETTE

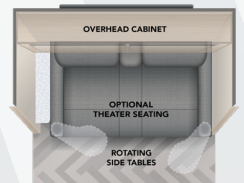

- 18,000 BTU Max Cool "Whisper Quiet" A/C (Largest Single A/C in Class) with Remote Control
- 15" Goodyear Endurance® Tires (Load Range E, Made in the USA!)
- Laminated Azdel Onboard® Composite Walls
- Best-in-Class 82" Ceiling Height
- Full 8' WIDTH (96") vs. Typical 7' or 7.5' Width
- True Residential Queen Size 60" x 80" Front Bed
- Air Fryer Convection Microwave

- "Legless" Booth Dinette with Storage Below with Optional Theater Seating Available
- Congoleum® DiamondFlor® "Carpetless" Interior
- EmberLink™ "Smart RV" system controls Slide Room, Awning, and Lighting
- XL 55 gal. Fresh, 35 gal. Gray & Black Tanks
- Optional Off-grid Solar Package with (2) 200W Rooftop Panels (400W total), 2000W Inverter, and Victron® MPPT Solar Controller

Please Note: Information on this flyer is the latest available at the time of publication approval. Ember Recreational Vehicles reserves the right to make changes and to discontinue models without notice or obligation. RVs built for sale in Canada may differ to conform to Canadian codes. EMBER is a registered trademark of Ember Recreational Vehicles, Inc. ©2024 EMBER RECREATIONAL VEHICLES, INC. REV240829

EXPLORE MORE AT EmberRV.com

STANDARDS

Construction

- Laminated Azdel® Composite Walls
- Best-in-Class 82" Ceiling Height
- Aluminum-framed Sidewall Construction
- Gel-coated Fiberglass Exterior
- Aluminum-framed Laminated Floor
- Fully Walkable Roof with One-piece Tufflex® PVC Roofing (Lifetime Warranty)
- Dexter® Axle with E-Z Lube Hubs and Forward Self-Adjusting Electric Brakes

Exterior

- 15" Goodyear Endurance® Load Range E Tires (including spare; Made in the USA!)
- Custom Aluminum Rims
- Adjustable Solid Step™ Entry Stairs
- Slam-Latch Baggage Doors
- Electric Awning with LED Lighting
- Front Electric Tongue Jack with LED Light and Built-In 7-Way Cable Holder
- Front and Rear Quick Drop™ Stabilizers
- High-Visibility LED Exterior Lighting
- Back-Up Lighting
- Fully-Enclosed Radiant Barrier Underbelly
- XL Fresh Water Tank (55 gallons)
- Dual 20# LP Tanks (40# total capacity)
- LP Quick Connect
- 30 Amp Service
- Detachable Shore Power Cord
- Battery Disconnect
- Outside Shower
- Black Tank Flush
- 30" Friction-Hinge Entrance Door
- Frame-Integrated Rear 2" Accessory Receiver (300# capacity)
- Winegard Air 360+ Omnidirectional Antenna (Wi-Fi/LTE Prep)
- Keyed-Alike™ Locking System
- Coiled Break-Away Cable
- PREPPED FOR: Solar Upgrades (Side and Rooftop Solar Ports), Rear/Side Observation Camera, Tire Pressure Monitoring System (TPMS), Inverter, Slide Topper, and Starlink Cable

Interior

- 18,000 BTU Max Cool "Whisper Quiet" A/C (Largest Single A/C in Class)
- 60" x 80" Residential-Sized Queen Bed with USB-A, USB-C, and 120V Powered Cubbies with LED Lights on Each Side
- EmberLink™ Smart RV Control System
- 12V Refrigerator (10 cu. ft.)
- Air Fryer Convection Microwave
- Hardwood Framed Cabinet Doors with Hidden Hinges
- Soft Close Hardwood Drawers
- Roller Shades
- Seamless Countertops
- Stainless Steel Kitchen Sink with Pull-out Sprayer Faucet
- Dual-burner Cooktop
- Congoleum® DiamondFlor® "Carpetless" Interior
- Tankless "On Demand" Water Heater
- Porcelain Foot-Flush Toilet
- 20K BTU Furnace
- Medicine Cabinet
- Bathroom Skylight and 12V Fan
- Smoke/CO/LP Detectors
- Fire Extinguisher

OPTIONS

- 32" 12V "Smart" TV with Built-In JBL® Soundbar Bluetooth® AV System
- 12V Multi-speed Fan (Main Room)
- Theater Seating (in place of Dinette)
- Repositionable/Telescoping Roof Ladder
- Thermostatically-Controlled 12V Tank Heaters (Fresh, Gray, Black)
- Wireless Side/Rear Observation Camera System with 12V Monitor
- Tire Pressure Monitoring System (TPMS)
- Outside Kitchen with Griddle (Connects to LP Quick Connect) and 120V Mini-Fridge (18RBE, 19DBE)
- Off-Grid Solar Package: Dual GoPower!® 200W Rooftop Solar Panels (400W total), 2000W Pure Sine Wave Inverter, and Victron® MPPT Solar Controller



FURRION CHILL™
18K BTU "WHISPER QUIET"
CHILL® CUBE VARIABLE SPEED
ROOFTOP AIR CONDITIONER
LARGEST AIR CONDITIONING
SYSTEM IN OUR CLASS!

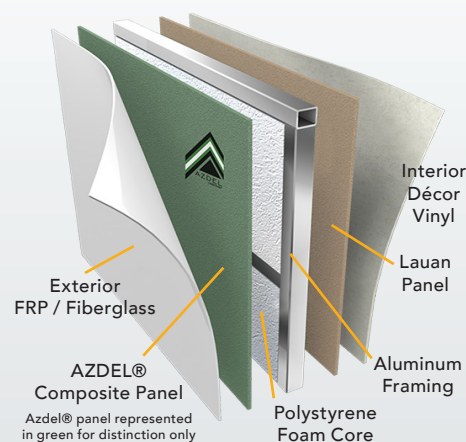

E-SERIES SIDEWALL CUT-AWAY
LAMINATED AZDEL ONBOARD®
COMPOSITE WALLS WITH
ALUMINUM FRAMING AND
GEL-COATED FIBERGLASS



NOTES