

ADLAR

SOARING EAGLE
CAMPERS

TRD

GO ANYWHERE.. CAMP ANYWHERE.

SOARING EAGLE CAMPERS

Affordable, Lightweight, Truck Campers for Outdoorsmen & Families!



SIMPLY BETTER



SOARING EAGLE CAMPERS

A lot of entry level truck campers feature mostly wood construction, covered by thin metal or ribbed fiberglass. SOARING EAGLE CAMPERS constructs our campers using



all-welded tubular aluminum construction with thick fiberglass exteriors with composite backing. Our models are minimalistic in nature, yet refined with special attention given to quality and craftsmanship. Our target customers love camping and are

more focused on the adventure and time spent outdoors than what amenities are found inside their camper. Soaring Eagle Campers customers tend to be hunters, fishermen, hikers, kayakers, mountain bikers, etc. who just want a more comfortable night's sleep in a camper that will not overload their medium and light duty trucks. Soaring Eagle Campers provides a quality-built product, made with superior materials, that will provide years of carefree use, making it a very good value for the money.



The structure of our camper is welded together to form a strong, UNI-BODY construction that will stand the test of time and the rigors of the road! The unit is easy to keep



STRUCTURE SCREWED & WELDED TOGETHER

warm or cool as it is fully insulated, including the floor, walls and roof. For

those planning on camping in sub-freezing temperatures, you can now order a TRUMA LP furnace in most Adlar models as an option.

The dinette bases in the Soaring Eagle Campers' Adlar models are crafted out of durable, lightweight, high-tech composites that are both lighter than wood and much longer lasting.



The entire structure is actually wood-free, providing the best value for your money!



NO WOOD - NO ROT!!

DESIGNED TO FIT INSIDE THE BED OF YOUR TRUCK WITH THE TAILGATE UP!

Being able to close your tailgate with the camper IN the truck is a game changer! Many tailgates in today's truck models feature built-in steps, as well as their rear view camera and other safety sensors. Soaring Eagle Campers took that into account when designing our

models and our customers really appreciate it. Each Adlar model offers the ability to have the camper in your truck with the tailgate closed - in most models of trucks. That means you can still utilize all of the functions of your tailgate including the built-in steps!



Truck campers continue to grow in popularity every day as they allow you to take your fishing boat, ATVs, etc. or just go completely off road where people towing travel trailers could never go!

Anywhere your truck can go, you can set up camp and enjoy nature at its finest.

**GO CAMPING
WHERE EVER
YOUR TRUCK
CAN TAKE
YOU - WITH A
SOARING
EAGLE
CAMPER!**



Explore the World - From Your Truck

ADULTS



TRUE HALF-TON TRUCK CAMPERS THAT WILL NOT OVER LOAD YOUR TRUCK!



Ranging in weight from ONLY 850 lbs. – 1,270 lbs.!

FAMILY FRIENDLY with Sleeping for 4



Load up your gear and GO! Soaring Eagle Campers are perfect for half-ton truck owners and even smaller trucks. The overall interior spaciousness afforded by the ADLAR XL interior will surprise you, with plenty of headroom, along with a roomy dinette, 12V refrigerator and loads of counter top and storage space.

Shown above with an optional bat-wing awning and exterior shower, the ADLAR offers comfortable sleeping areas in the upper cabover, as well as in the dinette that quickly converts into a secondary sleeping area.

The pull-out queen bed is wide enough to sleep three in a pinch, but is perfect for two adults.



ADLAR XL



ENJOY THE COMFORTS OF HOME WHILE CAMPING!



You'll appreciate the convenience afforded by the 12V refrigerator, now standard in most models, which can hold all your food and drinks when traveling. This ADLAR XL model comes in both a 6.5 length as well as an 8' length so that these unique campers will fit in any full size truck bed, from 5.5 to 6.5 to 8.0.





THE ADLAR XL MODELS – Offering a quiet retreat to relax, eat, play games or sleep.

You will find the ADLAR surprisingly spacious with four windows which make the interior feel even larger while providing a great view of your surroundings. The composite dinette bases offer a ruggedness not found in pine and paneling built dinettes, and also features built in storage areas, as well as a built-in battery box with room for multiple batteries. The large cabinet on the passenger side can hold an optional microwave oven or our optional TRUMA Vario Furnace for those camping in very cold climates.



ADLAR XLS



XLS MODEL - For Those Looking for More of a Kitchen.

For those looking for more of a kitchen in their ADLAR camper, we have the XLS model in both the 6.5 and 8.0 size. Offering a lot of countertop space and kitchen amenities on one side and a roomy side-by-side dinette on the other.





There is loads of storage in the XLS model, as well as countertop space - perfect for meal preparation.



The cooktop is portable and can be removed to take outside and plug in.



The sink offers a convenient way to wash hands or dishes.



A swivel dinette table allows easy access to the dinette - which quickly and easily converts to a secondary sleeping area for kids.

GO ANYWHERE - CAMP ANYWHERE!

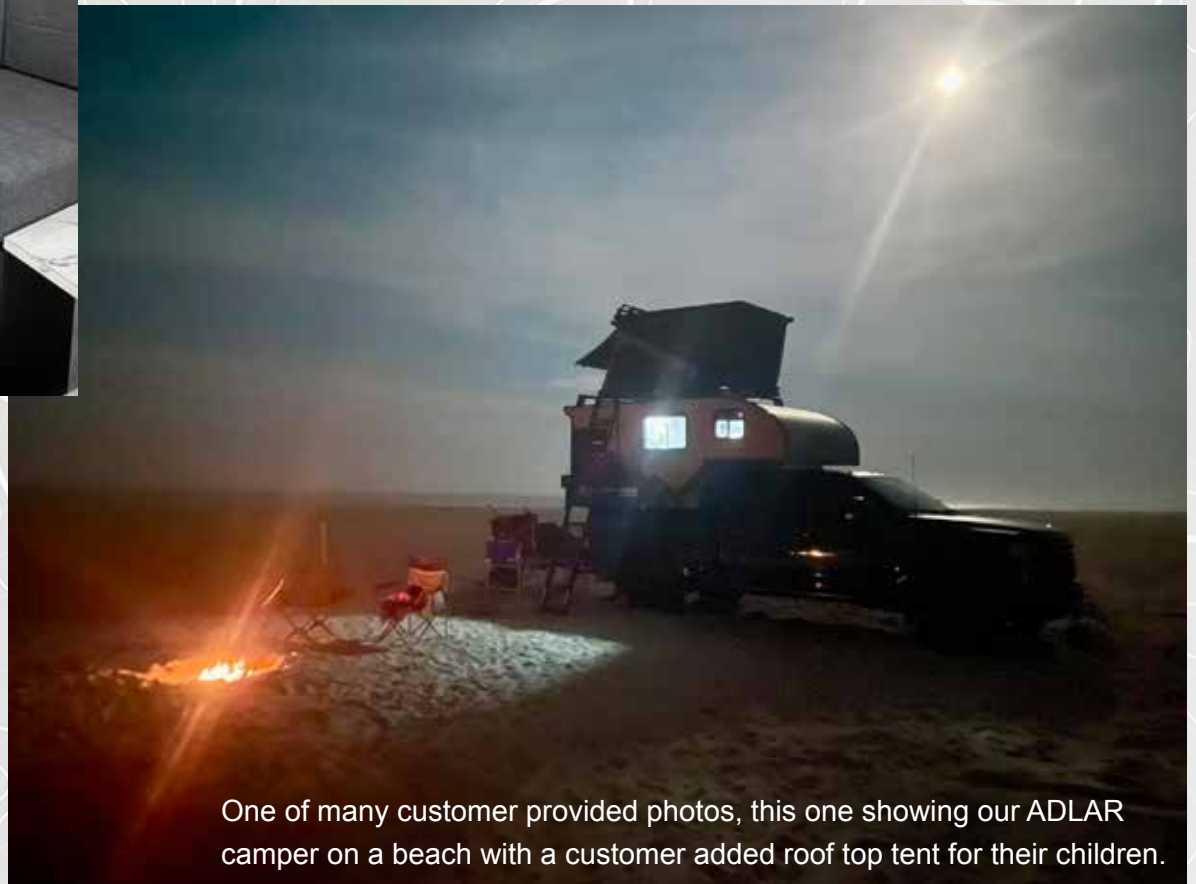

One of many customer provided photos, this one showing our ADLAR camper on a beach with a customer added roof top tent for their children.

ADLAR 5.0 & 6.0



The ADLAR 5.0 will fit comfortably in just about any small truck model including the Tacoma, Ranger, Gladiator, Colorado, Ridgeline and more! This model will even fit most Ford Mavericks - one of the smallest trucks on the market. The Adlar 5.0 model has opened up truck camping to millions

more truck owners than ever before! Whether your truck has a 5' bed or a 6' bed, we have an ADLAR model that is perfect for your truck - both dimensionally and more importantly, the right weight to not overload your truck's CCC!

Standards include a MaxxAir fan with rain sensor and remote; 12V refrigerator, pull-out queen bed, dinette which converts to a secondary sleeping area, 100AH lithium battery and more. Popular options include a A/C with heat pump, roof solar panels, quick detach jacks, microwave oven, portable toilet, and more.



Lots of floor and countertop space for your extra storage needs.

**DESIGNED
SPECIFICALLY
FOR THE
SMALL TRUCK
MARKET!**



NO LONGER will small truck owners have to settle for awkward roof top tents that are difficult to climb up into to accommodate their camping needs! The ADLAR 5.0 and 6.0 models were designed specifically with the small truck market in mind and offer a fully-enclosed, slide-in truck camper that is family friendly - sleeping two adults and two kids!

**Fits in Most Models
with the Tailgate Closed!**



MODELS FOR SMALLER SIZE, QUARTER-TON TRUCKS

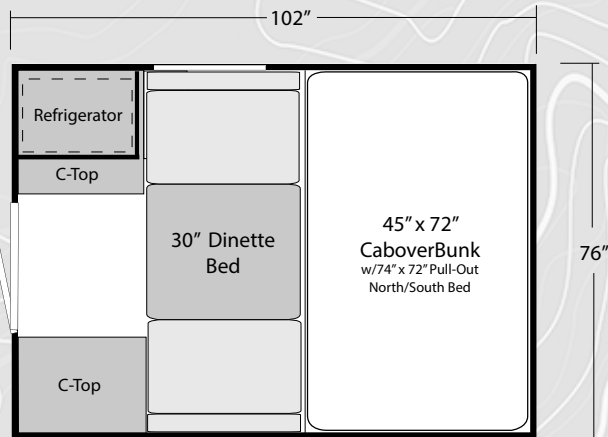

850 lbs.

960 lbs. w/popular options

ADLAR 5.0

Floor 41 x 57

ADLAR

NOTE: We weigh each of our campers. Some campers may weigh slightly more or less depending on which options are added. Note: our removable jacks option will allow you to take approximately 110 lbs. off of the camper when traveling.

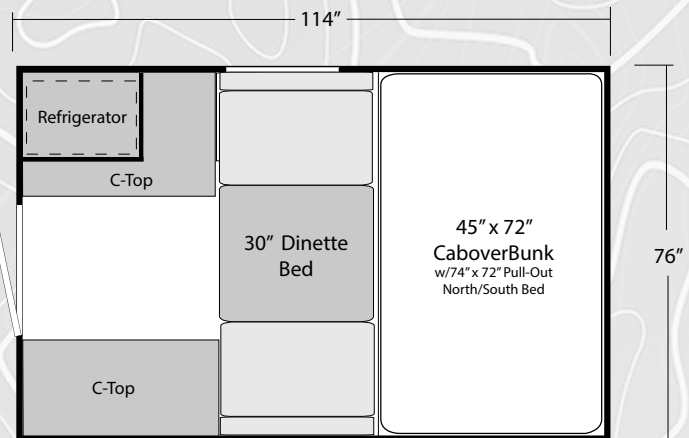

860 lbs.

970 lbs. w/popular options

ADLAR 6.0

Floor 41 x 69



MODELS FOR FULL SIZE, HALF-TON TRUCKS

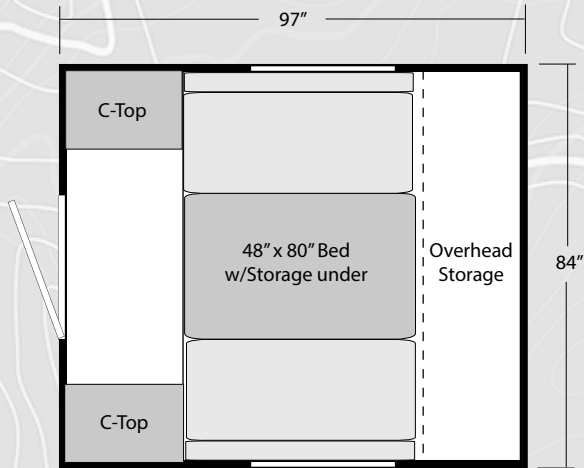

850 lbs.
960 lbs. w/popular options

ADLAR 6.5
Floor 49 x 75

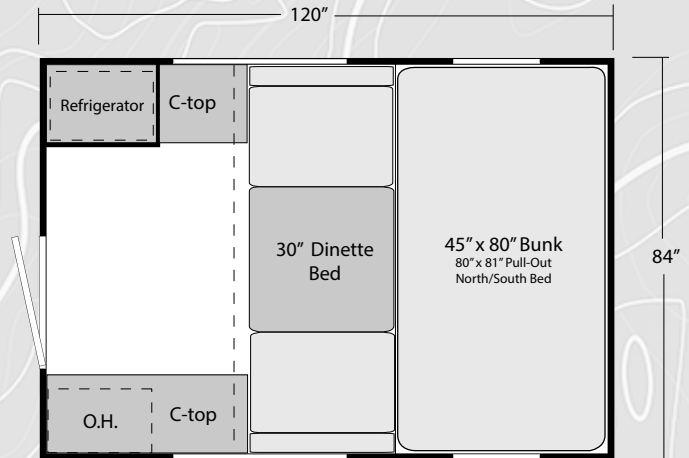

1,125 lbs.
1,235 lbs. w/popular options

ADLAR 6.5XL
Floor 49 x 75

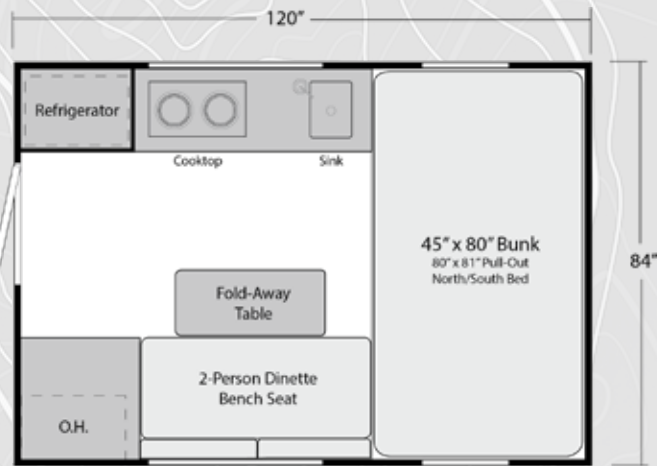

1,200 lbs.
1,310 lbs. w/popular options

ADLAR 6.5XLS
Floor 49 x 75

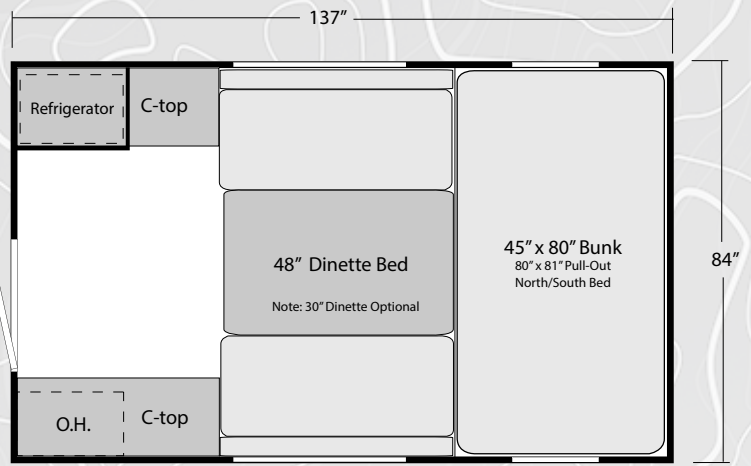

1,240 lbs.
1,350 lbs. w/popular options

ADLAR 8.0XL
Floor 49 x 91

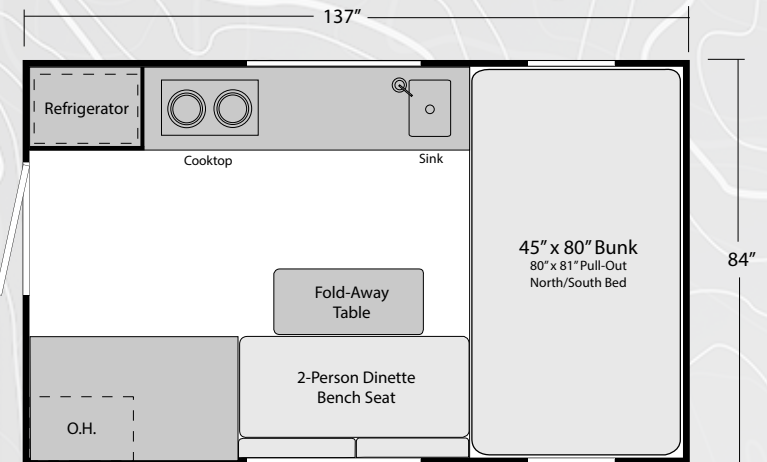

1,270 lbs.
1,380 lbs. w/popular options

ADLAR 8.0XLS
Floor 49 x 91

Helping you make lasting Family Memories.



SOARING EAGLE CAMPERS ARE NOT CHEAP.

It's not cheap to build a truck camper using all welded, tubular aluminum framing and composites instead of wood.

It's not cheap to use 3" tubular aluminum in parts of our structure and cover the entire unit with one-piece, seamless fiberglass.

It's not cheap to craft an all-aluminum basement storage area to allow the main floor to expand side to side in the truck.

It's not cheap to put the super-efficient TRUMA Combi furnace and water heater in our camper as Standard in place of a typical RV system.

It's not cheap to use automotive grade foam in our seating and to use a residential style mattress in our bed.

We could make it cheap, but then it wouldn't be a Soaring Eagle Camper!

ADLAR

**PROUDLY
MADE IN THE
USA**



SOARING EAGLE CAMPERS

1025 E. WATERFORD
WAKARUSA, IN 46573

www.SOARINGEAGLECAMPERS.com

Email us at inquire@soaringeaglecampers.com