



2025 WILDWOOD FSX MIDWEST
2024 WILDWOOD FSX NORTHWEST



WILDWOOD FSX



FOREST RIVER

FORESTRIVERINC.COM

2025 LE TRAVEL TRAILERS

SINGLE AXLE FLOORPLANS



164RBLE
LENGTH: 20' 0" UVW: 2819 LBS



174BHLE
LENGTH: 20' 1" UVW: 2899 LBS



174DBLE
LENGTH: 21' 8" UVW: 3229 LBS

TANDEM AXLE FLOORPLANS



233RBLE
LENGTH: 28' 3" UVW: 4714 LBS



266BHLE
LENGTH: 29' 11" UVW: 4853 LBS

2025 SINGLE AXLE TRAVEL TRAILERS

COUPLES FLOORPLANS

BUNK FLOORPLANS



161QK

LENGTH: 23' 6" UVW: 3691 LBS



177BH

LENGTH: 21' 10" UVW: 3509 LBS



167RBK

LENGTH: 21' 8" UVW: 3489 LBS



179DBK

LENGTH: 22' 6" UVW: 3439 LBS



PLATINUM EDITION



STANDARD EDITION

2025 SINGLE AXLE TRAVEL TRAILERS

COUPLES FLOORPLANS

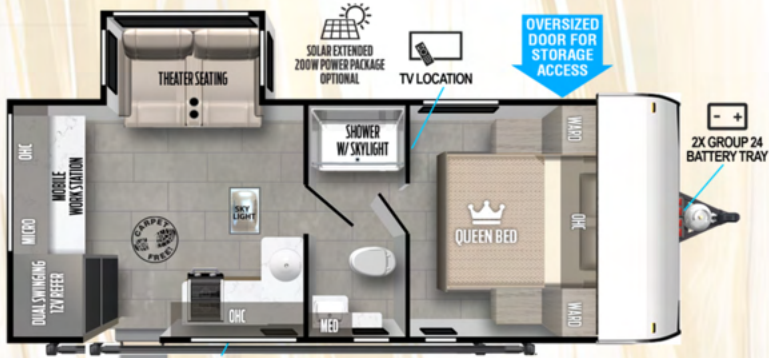

163RDSK

LENGTH: 21' 11" UVW: 4299 LBS



169RSK

LENGTH: 23' 0" UVW: 4274 LBS

BUNK FLOORPLANS



178BHSK

LENGTH: 22' 11" UVW: 4394 LBS



162RBS

LENGTH: 23' 2" UVW: 4659 LBS



STANDARD EDITION

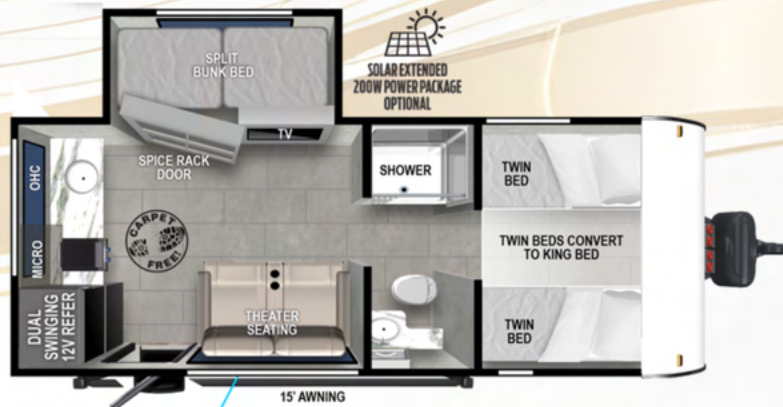

165RKS

LENGTH: 23' 3" UVW: 4879 LBS

2025 SUT TRAVEL TRAILERS

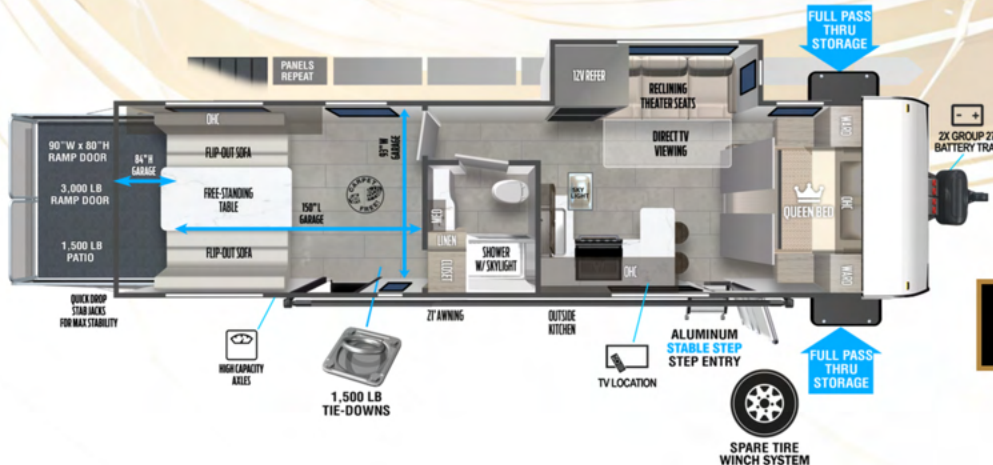
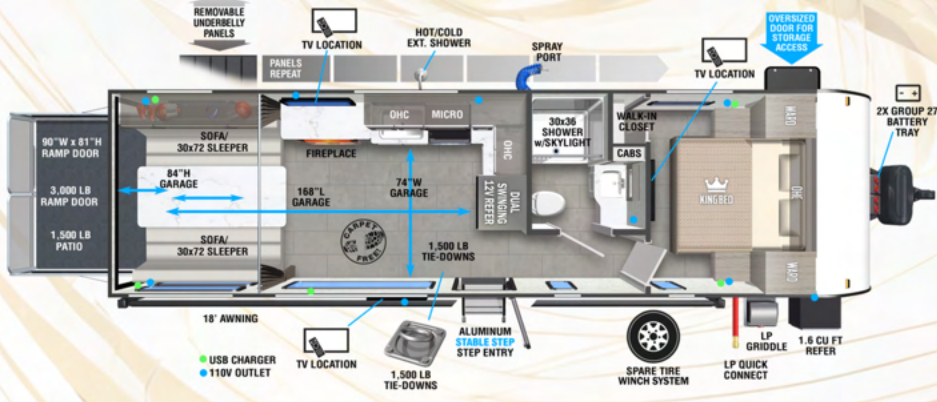
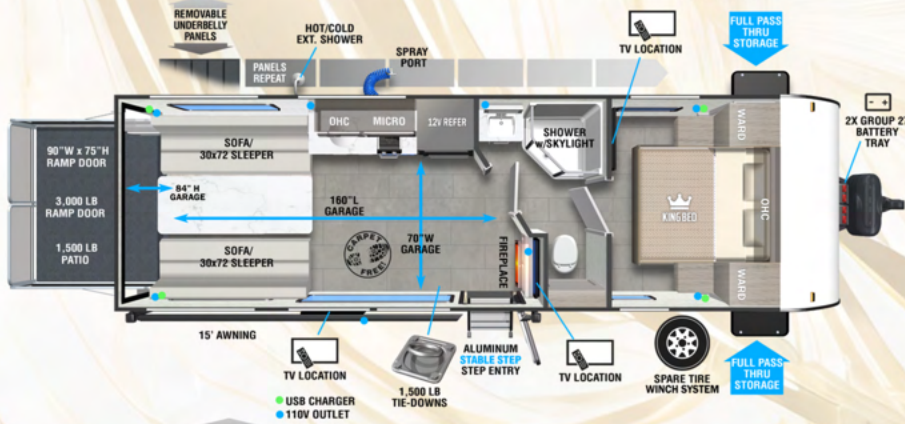
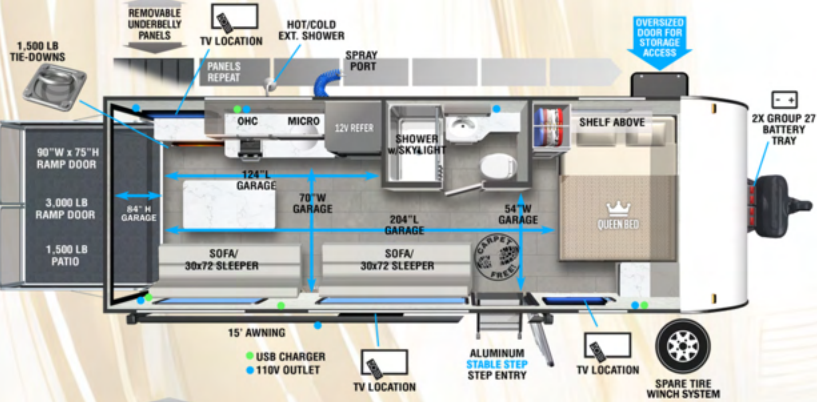
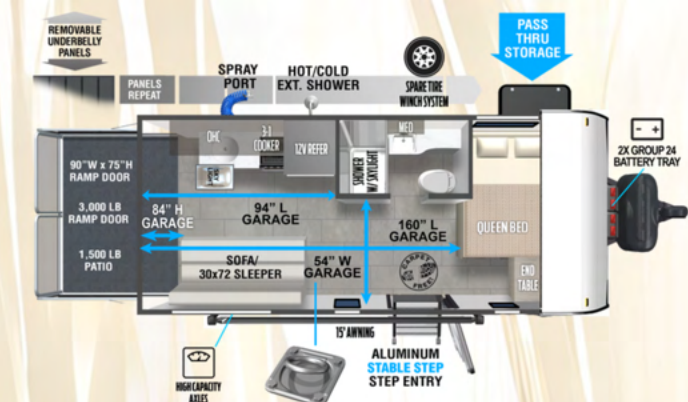

2025 VC VERSATILE TRAVEL TRAILERS

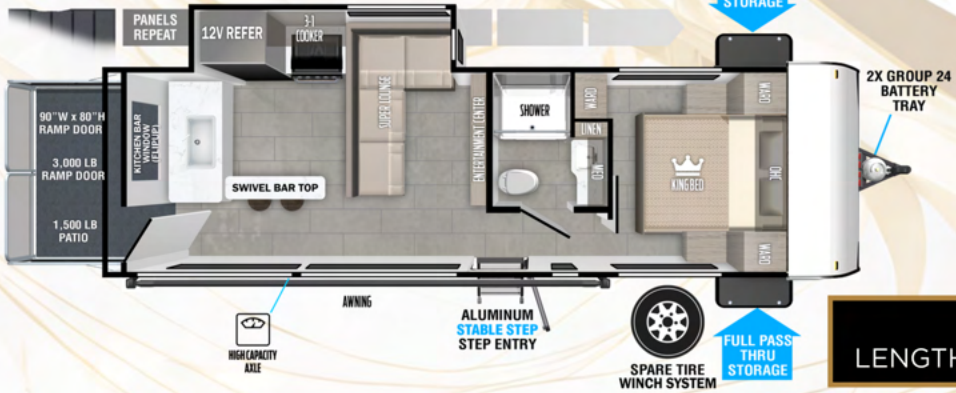



PLATINUM EDITION





WILDWOOD FSX

FOR THE MOST RECENT SPECS,
PICTURES, AND VIRTUAL TOURS VISIT
FORESTRIVERINC.COM/WILDWOOD
OR
SCAN QR CODE



EACH NEW FOREST RIVER PURCHASE PROVIDES:

- Pre-delivery Inspection.
- Digital Owner's Manual.
- Free Membership to Forest River Owners Group (FROG).
Learn more at www.forestriverfroq.com.
- A Contribution to Care Camps Foundation www.carecamps.org.
- 1 Year Free Roadside Assistance from Date of Purchase.



Learn More:
Scan this barcode
using a QR reader on
your smart phone to
learn more about
Forest River.



SPECIFICATION DEFINITIONS:

Scan this barcode using a QR reader on your
smartphone to learn RV terminology and more!



YOUR **WILDWOOD**
DEALER

FOREST RIVER
WILDWOOD



FOREST RIVER WILDWOOD



22ERAS

UVW	HITCH	CCC	LENGTH	HEIGHT	CAPACITY (GAL)		
6,196	685	1,489	28' 2"	TBD	40	60	30



22RBS

UVW	HITCH	CCC	LENGTH	HEIGHT	CAPACITY (GAL)		
5,647	771	2,124	27' 0"	11' 2"	61	64	32



25RD

UVW	HITCH	CCC	LENGTH	HEIGHT	CAPACITY (GAL)		
6,704	912	3,295	31' 2"	11' 0"	50	65	40



25RKE

UVW	HITCH	CCC	LENGTH	HEIGHT	CAPACITY (GAL)		
5,978	780	1,802	29' 7"	10' 9"	61	64	32



26BDUB

UVW	HITCH	CCC	LENGTH	HEIGHT	CAPACITY (GAL)		
6,988	824	2,636	33' 9"	11' 2"	61	75	32



29VIEW

UVW	HITCH	CCC	LENGTH	HEIGHT	CAPACITY (GAL)		
8,001	1,010	1,809	34' 10"	11' 4"	40	60	30

WILDWOOD X-LITE

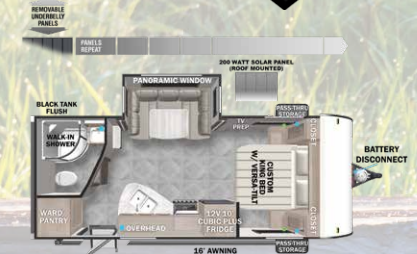

210RBXL

UVW	HITCH	CCC	LENGTH	HEIGHT	CAPACITY (GAL)		
4,830	500	2,670	25' 2"	10' 8"	61	42	32



220BHXL

UVW	HITCH	CCC	LENGTH	HEIGHT	CAPACITY (GAL)		
4,691	563	2,872	27' 6"	10' 6"	40	64	28



24RLXL

UVW	HITCH	CCC	LENGTH	HEIGHT	CAPACITY (GAL)		
5,063	550	2,487	28' 11"	10' 5"	40	30	40



24VIEW

UVW	HITCH	CCC	LENGTH	HEIGHT	CAPACITY (GAL)		
6,205	781	2,37	29' 11"	10' 8"	61	64	32



241BHXL

UVW	HITCH	CCC	LENGTH	HEIGHT	CAPACITY (GAL)		
5,520	2,090	610	28' 11"	10' 8"	39	74	32



263BHXL

UVW	HITCH	CCC	LENGTH	HEIGHT	CAPACITY (GAL)		
6,440	768	1,328	32' 1"	10' 8"	61	74	32



273QBXL

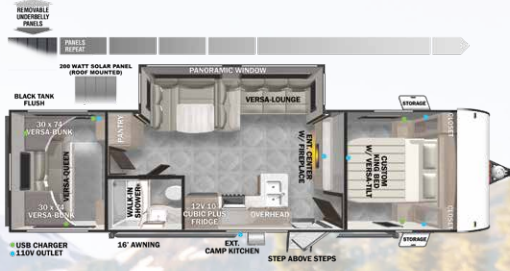

28VBXL

UVW	HITCH	CCC	LENGTH	HEIGHT	CAPACITY (GAL)		
6,550	752	2,002	33' 8"	10' 8"	61	32	42

UVW	HITCH	CCC	LENGTH	HEIGHT	CAPACITY (GAL)		
6,438	710	2,072	33' 10"	10' 8"	61	32	42



SINGLE AXLE FLOORPLANS



161QK



175BHL



178BHSK

UVW	HITCH	CCC	LENGTH	HEIGHT	CAPACITY (GAL)		
3,605	559	1,354	23' 6"	10' 2"	39	27	32

UVW	HITCH	CCC	LENGTH	HEIGHT	CAPACITY (GAL)		
2,961	340	879	20' 2"	9' 4"	39	27	27

UVW	HITCH	CCC	LENGTH	HEIGHT	CAPACITY (GAL)		
4,116	530	814	22' 11"	10' 8"	39	27	27

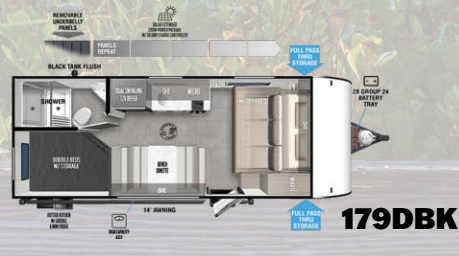

179DBK



181RT

UVW	HITCH	CCC	LENGTH	HEIGHT	CAPACITY (GAL)		
3,530	490	1,360	22' 5"	10' 2"	39	27	27

UVW	HITCH	CCC	LENGTH	HEIGHT	CAPACITY (GAL)		
3,578	530	1,352	21' 8"	10' 2"	39	30	28



187RBK

UVW	HITCH	CCC	LENGTH	HEIGHT	CAPACITY (GAL)		
3,481	387	1,306	22' 10"	10' 2"	39	27	27

DOUBLE AXLE FLOORPLANS



189RSK



191SS

UVW	HITCH	CCC	LENGTH	HEIGHT	CAPACITY (GAL)		
4,325	516	3,191	24' 9"	10' 8"	39	27	32

UVW	HITCH	CCC	LENGTH	HEIGHT	CAPACITY (GAL)		
4,513	490	2,977	24' 9"	10' 8"	39	27	27



TOY HAULERS

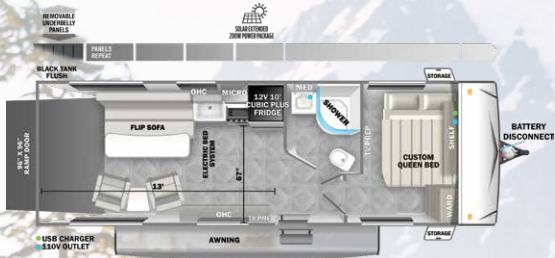

211SSXL

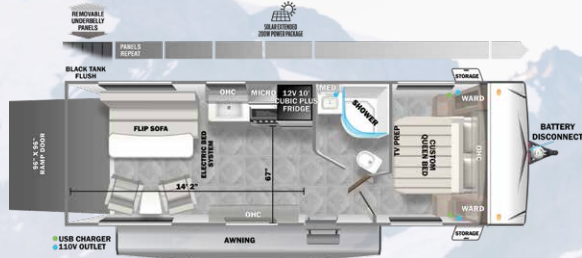

251SSXL

UVW	HITCH	CCC	LENGTH	HEIGHT	CAPACITY (GAL)		
5,490	678	2,988	27' 10"	11' 8"	61	32	32

UVW	HITCH	CCC	LENGTH	HEIGHT	CAPACITY (GAL)		
5,714	726	2,812	30' 1"	11' 8"	61	32	32



251SSXL



251SSXL



PRE-DELIVERY INSPECTION FACILITY

20,000 square feet of quality assurance. The bare essentials for a premium product. This state-of-the-art facility gives immediate daily feedback to production for quality assurance in every unit built.

CUSTOMER SATISFACTION



www.ForestRiverBuyLocal.com

Download our Forest River mobile app or visit our dynamic online manual to enhance your ownership experience. These interactive options provide incredible ease and insight into use, maintenance and enjoyment of your Forest River product.

Ranging from "How-To" videos, pictures and illustrations of various components, systems and features, to fully searchable content and downloadable PDFs for individual component owner's manuals, answers are always just a click away. View the online manual at www.forestriverinc.com/OnlineManual or download our FREE app from the App Store or Google Play!



FREE MEMBERSHIP
to Forest River Owners' Group

www.forestriverfrog.com



GVWR (Gross Vehicle Weight Rating) - is the maximum permissible weight of the unit when fully loaded. It includes all weights, inclusive of all fluids, cargo, optional equipment and accessories. For safety and product performance do NOT exceed the GVWR.

GAWR (Gross Axle Weight Rating) - is the maximum permissible weight, including cargo, fluids, optional equipment and accessories that can be safely supported by a combination of all axles.

UVW (Unloaded Vehicle Weight)* - is the typical weight of the unit as manufactured at the factory. It includes all weight at the unit's axle(s) and tongue or pin and LP Gas. The UVW does not include cargo, fresh potable water, additional optional equipment or dealer installed accessories.

CCC (Cargo Carrying Capacity)** - is the amount of weight available for fresh potable water, cargo, additional optional equipment and accessories. CCC is equal to GVWR minus UVW. Available CCC should accommodate fresh potable water (8.3 lbs per gallon). Before filling the fresh water tank, empty black and gray tanks for more cargo capacity.

*Estimated Average based on standard build optional equipment. ** Estimated average based on standard build optional equipment. Values estimated at time of printing.

Each Forest River RV is weighed at the manufacturing facility prior to shipping. A label identifying the unloaded vehicle weight of the actual unit and the cargo carrying capacity is applied to every Forest River RV prior to leaving our facilities. The load capacity of your unit is designated by weight, not by volume, so you cannot necessarily use all available space when loading your unit.

All information contained in this brochure is believed to be accurate at the time of publication. However, during the model year, it may be necessary to make revisions and Forest River, Inc., reserves the right to make all such changes without notice, including prices, colors, materials, equipment and specifications as well as the addition of new models and the discontinuance of models shown in this brochure. Therefore, please consult with your Forest River, Inc., dealer and confirm the existence of any materials, design or specifications that are material to your purchase decision.

©2024 Wildwood, a division of Forest River Inc., a Berkshire Hathaway company.



Learn More
Scan this barcode using a QR Reader on your smart phone to learn more about Forest River.



A Berkshire Hathaway company.

**24/7 EMERGENCY
ROADSIDE ASSISTANCE
WITH VEHICLE PURCHASE***

- TOWING
- JUMP-STARTS
- TIRE CHANGES
- FLUID DELIVERY
- LOCKOUT SERVICE
- WINCH-OUT
- MOBILE MECHANIC
- TECHNICAL SUPPORT
- DEALER LOCATOR SERVICES



*VALID FOR 1 YEAR FROM DATE OF PURCHASE