

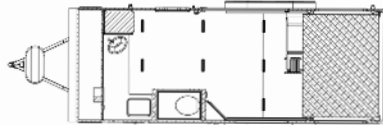

450 Series 2016

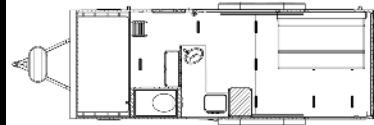

450 Series 2011



ALL NEW AND READY TO CONFIGURE

The PLA 450 is our mid-size toy hauler with full amenities and a small footprint that is easy to tow and maneuver behind a half ton truck or large SUV. With the configurable garage area, it can haul a side-by-side, golf cart, motorcycles, kayaks, ATVs, e-bikes, and much more!

Details at ATCtrailers.com

STANDARD ON ALL PLA 450 SERIES MODELS:

- ATC LifeTrac configurable garage area.
- All aluminum and composite construction, no wood.
- 10-year structural warranty.
- Solar power standard w/ option to upgrade.

(See reverse side for a complete list of features and packages.)

Built to PLA.

BASE MODELS

450 Series 2011
450 Series 2016

COLORS

Exterior

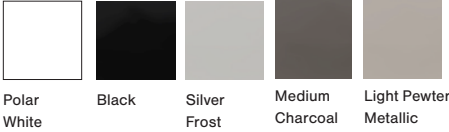

Interior Wall



STANDARD FEATURES

- Exterior Black Trim w/ Skirting
- Tongue Jack
- (4) Stabilizer Jacks
- Tongue Storage Tray
- Goodyear A/T Tires on Aluminum Wheels
- Space Tire on Hide-A-Spare - EZ Access
- Fold Out Adjustable Step
- Grab Handle
- Entry Door w/ Tinted Window & Screen Door
- Exterior Storage
- Frameless Dual Pane Tinted Windows
- Scene Light
- Power Awning w/ Lightstrip
- LP Quick Connect on Exterior
- Configurable Furniture Track System
- 200-Watt Solar Panel
- Solar Port
- Cable-less Rear Ramp Door w/ Non Slip Tread
- Loading Lights at Rear
- RVIA Seal
- Blackout Roller Shades
- Airline Track Tie Down System
- DSI LP Gas/Electric Water Heater
- Ducted LP Furnace
- (1) A/C Unit
- City Water Hook-up w/ Fill
- 20' Sewer Hose w/ Storage
- Waste (Black) Tank Flush
- 30 Amp Distribution Panel w/ Motorbase & Detachable Shorecord
- 12V Outlets
- Type A USB & Type C Throughout
- Touchscreen User Control Panel
- Lithium Battery Prep
- Convection Microwave
- Single Bowl Stainless Steel Sink
- 12V Refrigerator
- Flush Mount LP Cook top
- Decorative Back splash
- Wet Bath - Shower & Porcelain Toilet
- Bunk Beds w/ Reading Lamps (n/a 2016)

MANDATORY PACKAGES

Above and Beyond Package

- Full Perimeter Welded Frame (6 sides welded together, no wood)
- Axles - Torsion w/ EZ Lube & Self-Adjusting Brakes
- 1-Piece Aluminum Roof
- 3,000# Rated Composite Ramp Door
- Low Angle Ramp for Easier Loading
- Dimmable Ceiling Lights Throughout
- Composite Walls Panels (no wood)

All Weather Protection Package

- Enclosed Underbelly w/ Radiant Barrier
- Closed Cell Insulation in Walls (R7)
- Closed Cell Insulation in Ceiling (R4)
- Structural Foam Sub Floor (R7)
- Ducted Furnace

ENERGY LEVEL CHOICE (MUST SELECT 1)

Energy Prep Package (Standard)

- 200-Watts
- 20 Amp MPPT CC
- 1 Lithium Battery Prep
- Exterior Solar Port

Energy Package 2000

- 400-Watts
- 30 Amp MPPT CC
- 2000-Watt Inverter
- 200 Amp Hours of Battery

Energy Package 3000

- 800-Watts
- 60 Amp MPPT CC
- 3000-Watt Inverter
- 540 Amp Hours of Battery

INDEPENDENT ADD ON OPTIONS

- Battery- 12V 100AH LifePo4 Heated (n/a w/ energy pkg 2000 or 3000)
- Bed Lift (Happijac) Single Queen
- Deck Package (railing w/ steps, vinyl rear screen roll up)
- Speaker - Bluetooth, Portable Waterproof
- Tie Down Rings - Single Stud
- Tie Down Rings - Triple Stud
- Tongue Jack - Electric
- TV - 12V Smart
- Vinyl Rear Screen Roll Up w/ Windows (included w/ deck package)

PRE-CONFIGURED PACKAGES

Table & Chairs Package #1

- (1) 45" Table
- (2) Folding Chairs

Table & Chairs Package #2

- (1) 45" Table
- (2) Swivel/Reclining Chairs

Table & Chairs Package #3

- (1) Fold-up Dinette Table
- (4) Folding Chairs

Dinette w/ Benches (Sleeper Package)

- (1) Fold-up Dinette Table
- (2) Fold-Up Sofas

72" Upper/Lower Wall Cabinet Package w/ Poly

- (2) 12" x 24" Cabinets
- 48" Shelf
- 48" x 24" Cabinet
- 24" x 24" Cabinet

2nd Sofa, Table & Vertical Cab Package w/ Poly

- Sofa Sleeper
- 36" Table
- 48" x 24" Cabinet
- 24" x 24" Cabinet

The depictions of car haulers in this brochure are for general information purposes only as to those manufactured by ATC during the current model year. Since we continually strive to improve our products, actual products may differ and prices and specifications are subject to change without notice. Product information, specifications, photography, and promotions in this brochure may contain some features that are optional on your car hauler. All capacities are approximate and dimensions are nominal. Availability may be limited. ©2024 ATC | 2024-01-15