

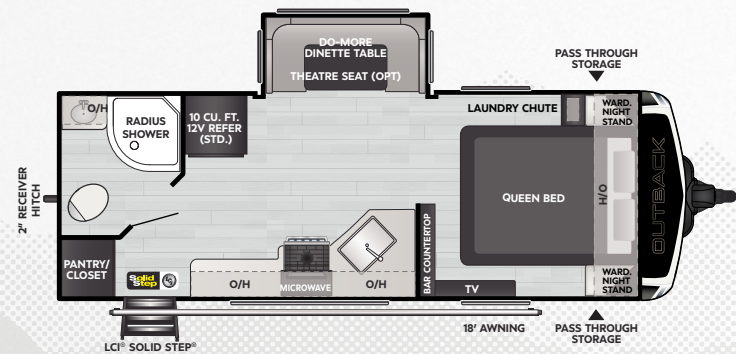

KEYSTONE
RV COMPANY

OUTBACK

2025 | LUXURY TRAVEL TRAILERS



212RB | WEIGHT **TBD** | LENGTH **25' 11"**

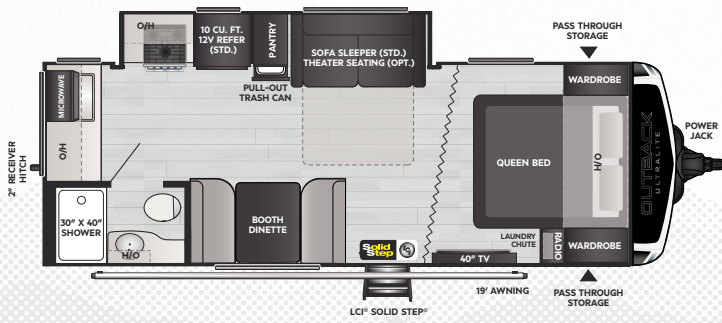

221MD | WEIGHT **5304** | LENGTH **27' 0"**

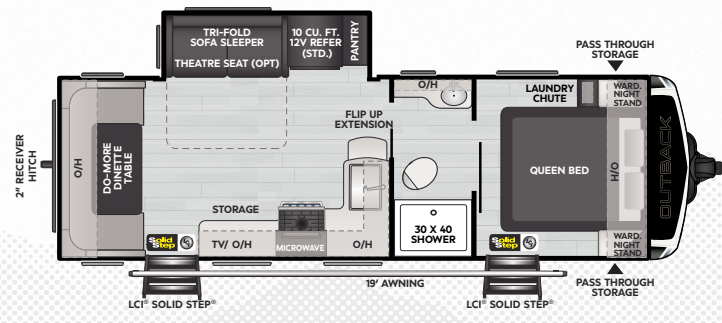

252RD | WEIGHT **TBD** | LENGTH **29' 11"**

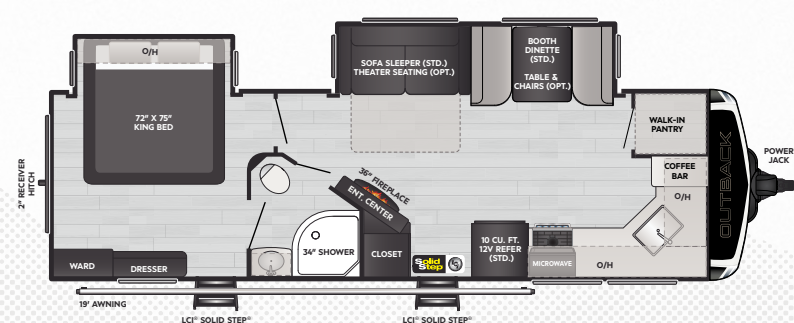

271FK | WEIGHT **TBD** | LENGTH **31' 3"**

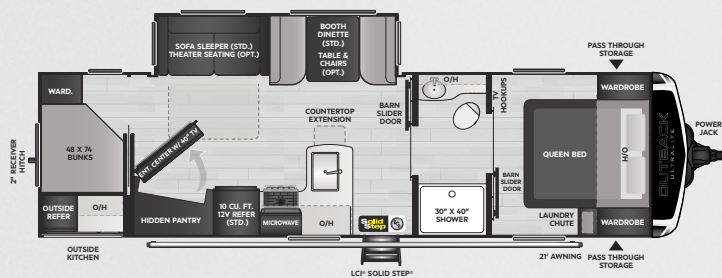

291BH | WEIGHT **TBD** | LENGTH **TBD**

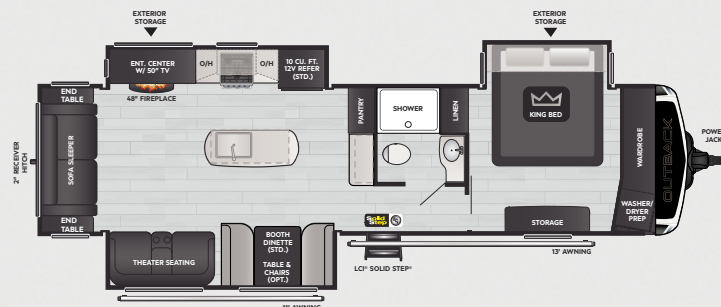

328RL | WEIGHT **8495** | LENGTH **36' 11"**

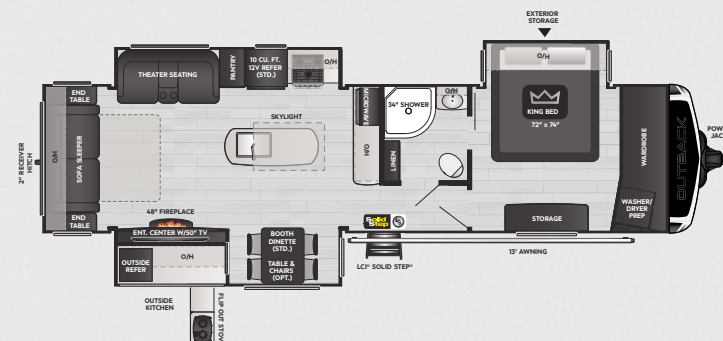

330RL | WEIGHT **8764** | LENGTH **36' 11"**

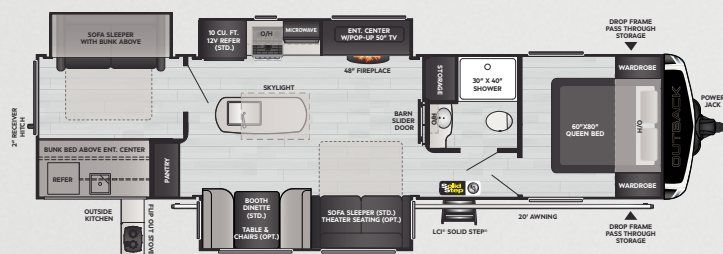

340BH | WEIGHT **8930** | LENGTH **37' 11"**

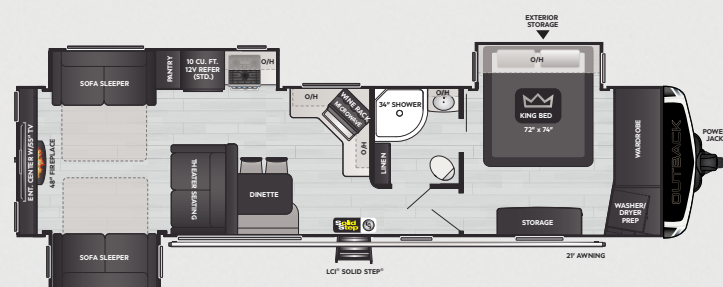

341RD | WEIGHT **8410** | LENGTH **37' 6"**

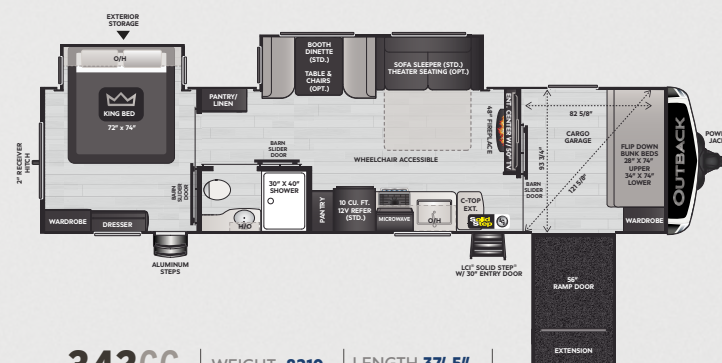

342CG | WEIGHT **8210** | LENGTH **37' 5"**

DISCLAIMER: Product information is as accurate as possible as of the date of this publication. All features, floor plans, and specifications are subject to change without notice. Pre-production estimated weights & lengths may be listed; visit Keystonerv.com for the most current product information and specifications.

CAMP BETTER
KINDNESS · COMMUNITY · PLANET





KEYSTONE
RV COMPANY

OUTBACK

2025 | LUXURY TRAVEL TRAILERS

INTERIOR

- » Fiberglass Backed Linoleum Floor W/ No Carpet
- » Extra Tall Slide Height
- » Real Touch 3D High-Definition Fascia Covering
- » Black Out Roller Shades
- » Designer Upholstered Window Valances
- » Pre-Drilled and Screwed Hand-Glazed Modern Cabinetry
- » Thomas Payne® Collection Theater Seating
- » 78" Arched Interior Ceilings
- » Hardwood Cabinetry
- » Solid Surface Kitchen Countertops
- » Deep Single Basin Stainless Steel Sink W/ 3" Drains and Rollup Sink Cover
- » High-Rise Faucet W/ Pull-Out Sprayer
- » Dream Dinette W/ Max-Store
- » Pressed Bathroom Countertops
- » Power Roof Vent and Skylight Over Tub
- » Porcelain Foot-Flush Toilet
- » Queen or King Size Bed W/ Built-In Pet Kennel Storage

EXTERIOR

- » Power Tongue Jack
- » Pinch Rolled Laminated Gel-Coated Fiberglass Exterior
- » Large Panoramic Black Framed Tinted 80% Safety Glass Windows
- » Painted Fiberglass Front Cap W/ LED Strip Lights & Rock Guard
- » Fully Walkable 3/8" Roof Decking & One-Piece TPO Membrane
- » Rear Ladder
- » BAL® Cable Driven Slide System W/ Manual Slide Backup
- » One-Piece Polypropylene Heated Enclosed Underbelly
- » 5K LBS. Dexter® E-Z Lube Axles W/ 10" Electric Brakes
- » MORryde Suspension
- » 15" Maxxis Radial Tires W/Spare
- » Suburban Stow Away Steps

OPTIONS

- » BAL® 7.3 Auto-Leveling
- » Theater Seating IPO Tri-Fold Sofa
- » Free Standing Dinette (Select Models)
- » 2nd A/C

EQUIPMENT

- » Underbody LED Lighting
- » 4G LTE and WiFi Prep
- » KeyTV™ Multisource Signal Controller
- » Blade™ Pure
- » BAL® 5.1 Stabilizing System
- » Back-Up Camera Installed & Side Marker Camera Prep
- » 50 AMP Shore Power Line
- » TPMS
- » Power Pro™ Smart RV System W/ Voice Command
- » TV Hook-Up
- » (2) 30 LBS. Propane Bottles W/ Auto Changeover
- » 18K BTU Chill Cube A/C & 35K BTU Furnace
- » On Demand Hot Water Heater
- » 40"/50" HDTV and AM/FM/CD Stereo W/ DVD Player, MP3 Hookup and Bluetooth Enabled
- » 10 Cu.Ft. 12V GE Refrigerator
- » Microwave
- » 3-Burner Gas Range and 21" Furrion Stove W/ Low Pro Hood Vent
- » Washer/Dry Prep (Select Models)

CONSTRUCTION

- » 12V Color-Coded Wiring
- » Tuf-Lok™ Thermoplastic A/C Duct Joiners
- » Tru-Fit™ Slide Construction
- » In-Floor Heating Ducts
- » HyperDeck™ Flooring
- » 10 1/2" BAL® Huck® Bolted "Z" Channel Frame
- » 53 Gallon Fresh Water Tank

MISCELLANEOUS

- » 3-Year Limited Structural Warranty
- » 1-Year Limited Base Warranty
- » Keystone Digital Owner's Manual
- » First Time Camper's Video Series
- » DIY Repair Program

STANDARD FEATURES & OPTIONS



DISCLAIMER: Product information is as accurate as possible as of the date of this publication. All features, floor plans, and specifications are subject to change without notice. Pre-production estimated weights & lengths may be listed; visit Keystonerv.com for the most current product information and specifications.

CAMP BETTER
KINDNESS · COMMUNITY · PLANET





KEYSTONE
RV COMPANY

OUTBACK

2025 | OBX TRAVEL TRAILERS

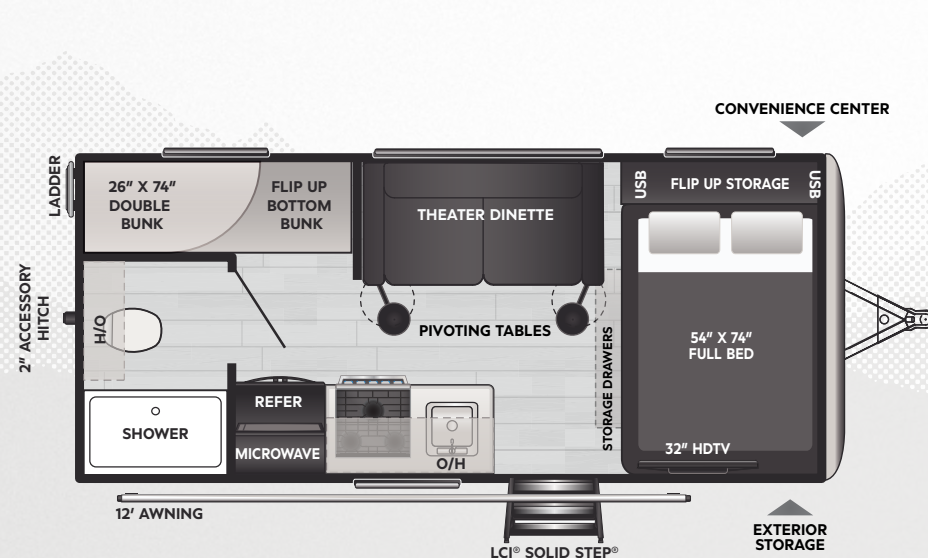

17BH | WEIGHT **3925** | LENGTH **20' 5"**

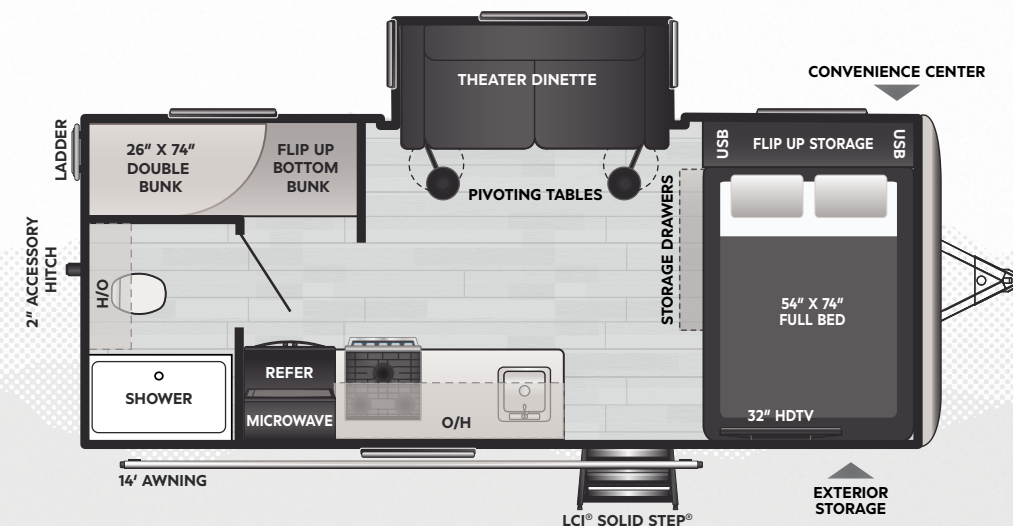

18BHS | WEIGHT **4205** | LENGTH **22' 1"**

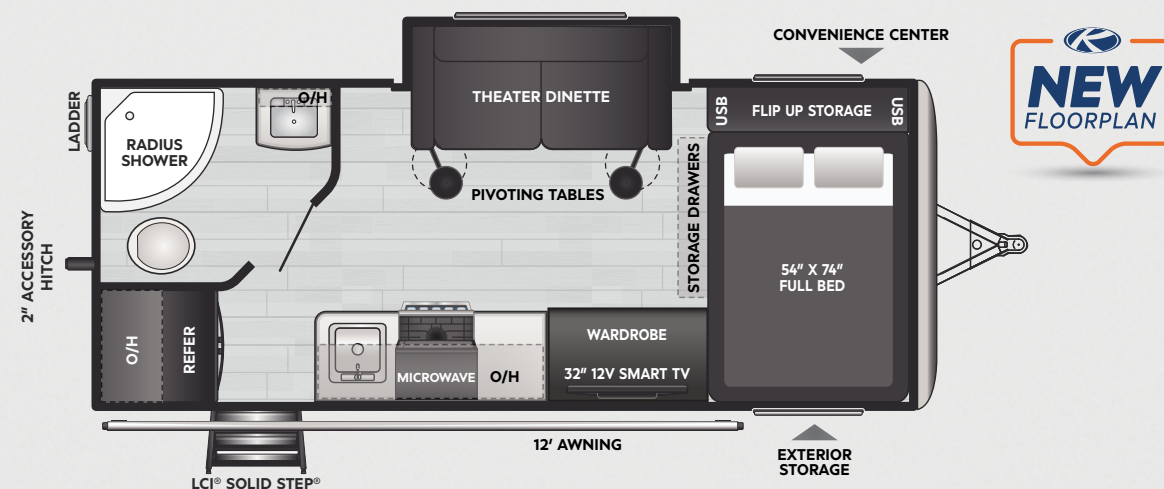

19RBS | WEIGHT **TBD** | LENGTH **22' 0"**

DISCLAIMER: Product information is as accurate as possible as of the date of this publication. All features, floor plans, and specifications are subject to change without notice. Pre-production estimated weights & lengths may be listed; visit Keystonerv.com for the most current product information and specifications.

CAMP BETTER
KINDNESS · COMMUNITY · PLANET





KEYSTONE
RV COMPANY

OUTBACK

2025 | OBX TRAVEL TRAILERS

INTERIOR

- » Pre-Drilled and Screwed Hand-Glazed Modern Cabinetry
- » Hardwood Cabinetry
- » Pressed Kitchen Countertops
- » Deep Single Basin Stainless Steel Sink W/ 3" Drains
- » High-Rise Faucet W/ Pull-Out Sprayer
- » Power Roof Vent and Skylight Over Tub
- » Porcelain Foot-Flush Toilet
- » TV Hook-Up
- » Decorative Bedspread Package

EXTERIOR

- » Power Tongue Jack
- » Pinch Rolled Laminated Gel-Coated Fiberglass Exterior
- » Painted Front Cap W/ LED Strip Lights
- » Fully Walkable 3/8" Roof Decking and One-Piece TPO Membrane
- » Rear Ladder
- » One-Piece Polypropylene Heated Enclosed Underbelly
- » 5K LBS. Dexter® E-Z Lube Axles W/ 10" Electric Brakes
- » Dexter® Torsion Axles
- » 14" Radial Tires on Aluminum Wheels W/ Spare
- » Lippert® SolidStep® W/ Extra-Wide First Step
- » Friction-Hinge Entry Door W/ Self Closing Screen Door and Oversized Grab Handle
- » Water Docking Stations
- » Outside Kitchen
- » Outside Shower
- » Cargo Rack Prep on All Bumpers
- » SolarFlex™ Protect 220

EQUIPMENT

- » 4G LTE and WiFi Prep
- » KeyTV™ Multisource Signal Controller
- » Back-Up Camera Prep
- » Double Welded Dual Battery Brackets W/ Battery Disconnect
- » 50-AMP Shore Power Line
- » Lighted Power Awning W/ Adjustable Arms
- » (2) 20 LBS. Propane Bottles W/ Auto Changeover
- » 18K BTU A/C W/ Variable Speed Compressor
- » 20K BTU Furnace
- » On Demand Hot Water Heater
- » Microwave
- » 3-Burner Gas Range & 17" Furrion Stove W/ Low Pro Hood Vent
- » LED Lighting Throughout
- » 55 AMP Converter
- » Ram Air Vent

MISCELLANEOUS

- » 3-Year Limited Structural Warranty
- » 1-Year Limited Base Warranty
- » Keystone Digital Owner's Manual
- » First Time Camper's Video Series
- » DIY Repair Program

CONSTRUCTION

- » 12V Color-Coded Wiring
- » Tuf-Lok™ Thermoplastic A/C Duct Joiners
- » HyperDeck™ Flooring
- » 7 1/2" BAL® Huck® Bolted "Z" Channel Frame

OPTIONS

- » BAL® Independent Suspension System
- » SolarFlex™ Discover
- » (2) 100 AMP Hour Dragonfly® Energy Lithium-Ion Batteries

STANDARD FEATURES & OPTIONS



DISCLAIMER: Product information is as accurate as possible as of the date of this publication. All features, floor plans, and specifications are subject to change without notice. Pre-production estimated weights & lengths may be listed; visit Keystonerv.com for the most current product information and specifications.

CAMP BETTER
KINDNESS · COMMUNITY · PLANET

