

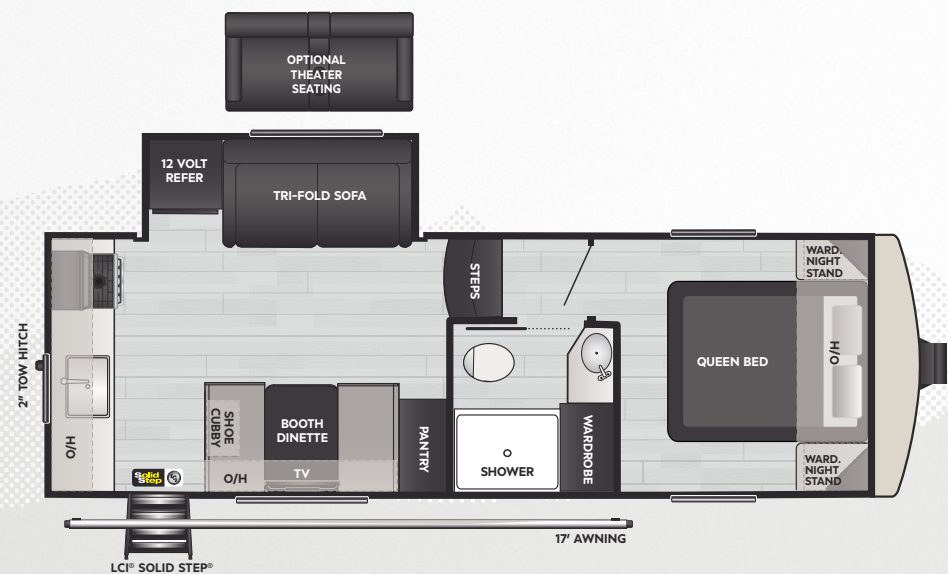

KEYSTONE  
RV COMPANY

# ARCADIA

2025 | SELECT FIFTH WHEELS



**21SRK** | WEIGHT **6817** | LENGTH **27' 3"**

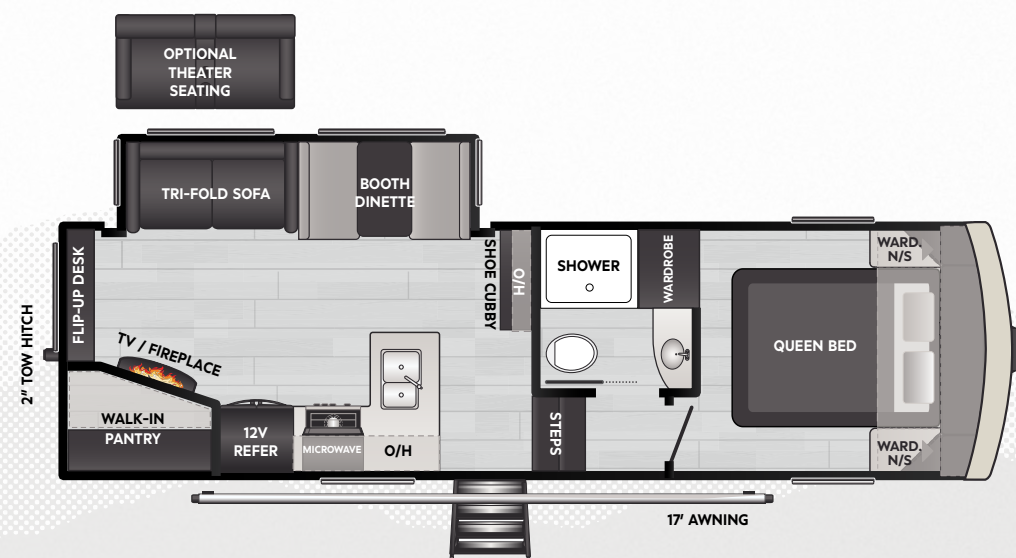

**24SRE** | WEIGHT **TBD** | LENGTH **29' 6"**



**25SRD** | WEIGHT **7275** | LENGTH **29' 3"**

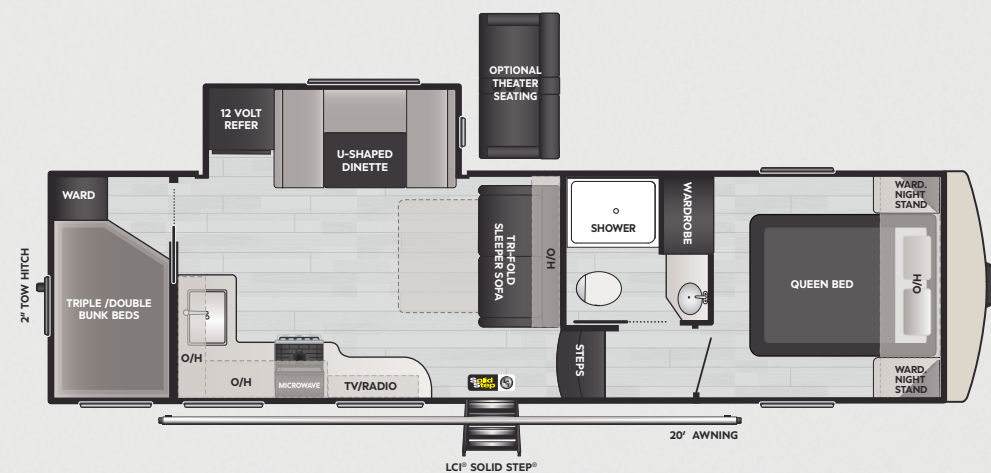

**27SBH** | WEIGHT **7751** | LENGTH **32' 8"**

DISCLAIMER: Product information is as accurate as possible as of the date of this publication. All features, floor plans, and specifications are subject to change without notice. Pre-production estimated weights & lengths may be listed; visit [Keystonerv.com](http://Keystonerv.com) for the most current product information and specifications.

**CAMP BETTER**  
KINDNESS · COMMUNITY · PLANET





**KEYSTONE**  
RV COMPANY

# ARCADIA

2025 | SELECT FIFTH WHEELS

## EXTERIOR

- » Automotive-Grade Painted Fiberglass Front Cap w/ KeyShield™ Protection & Amber LED Lights
- » One-Piece Alpha SuperFlex™ TPO Roof Membrane w/ Limited Lifetime Warranty
- » Electric Stabilizer Jacks
- » Lippert SolidStep® on Main Entry Door
- » Upgraded Roto-Flex Pinbox w/ Maxturn™ Technology
- » Tinted Frameless Windows
- » Rear Observation Prep
- » Slam Latch Compartment Doors
- » Two 30lb. LPG Bottles
- » Winegard® Air 360+ Omni-Directional Rooftop Antenna w/ Exclusive Satellite Pass-Through
- » Exterior Convenience Center
- » SolarFlex™ Protect 220
- » 1-Year Limited Base Warranty & 3-Year Limited Structural Warranty (See [KeystoneRV.com](http://KeystoneRV.com) For Details)
- » Heated & Enclosed Underbelly

## INTERIOR

- » HyperDeck™ Water-Resistant Floors
- » Girard® Tankless On-Demand Water Heater
- » Furrion 17" Range w/ Piezo Ignition & Glass Stove-top Cover
- » 10 Cu. Ft. 12V Refrigerator
- » Tall Slides for Added Comfort and Headroom
- » High Rise Chef's Faucet and Sprayer
- » Queen Beds
- » Carpetless Flooring

## STANDARD FEATURES



DISCLAIMER: Product information is as accurate as possible as of the date of this publication. All features, floor plans, and specifications are subject to change without notice. Pre-production estimated weights & lengths may be listed; visit [KeystoneRV.com](http://KeystoneRV.com) for the most current product information and specifications.

**CAMP BETTER**  
KINDNESS · COMMUNITY · PLANET





**KEYSTONE**  
RV COMPANY

# ARCADIA

2025 | SUPER LITE FIFTH WHEELS

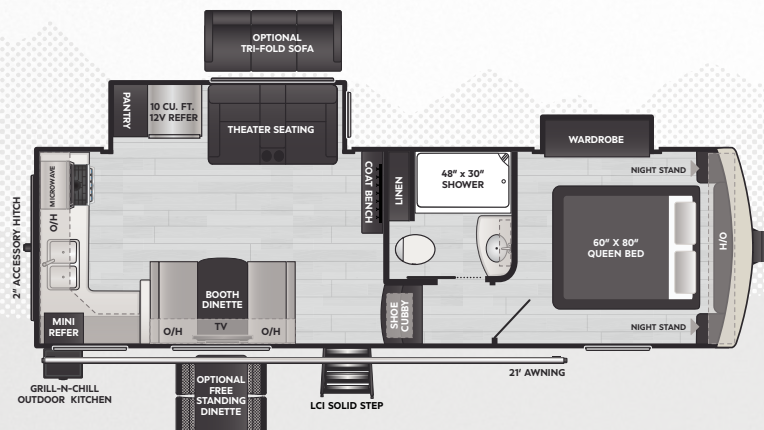

**242SLMD** | WEIGHT **7765** | LENGTH **28' 6"**

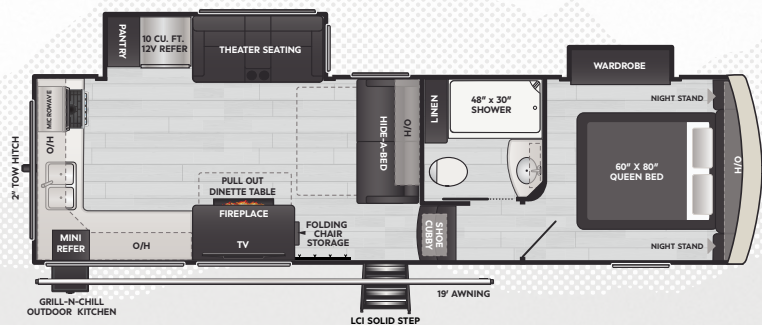

**260SLCL** | WEIGHT **TBD** | LENGTH **30' 11"**

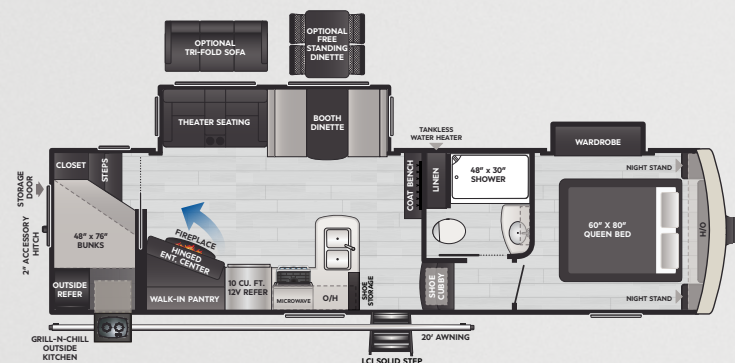

**288SLBH** | WEIGHT **8756** | LENGTH **32' 8"**

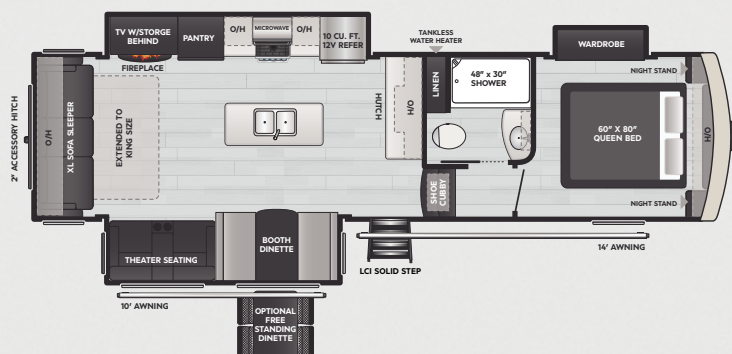

**292SLRL** | WEIGHT **9122** | LENGTH **33' 2"**

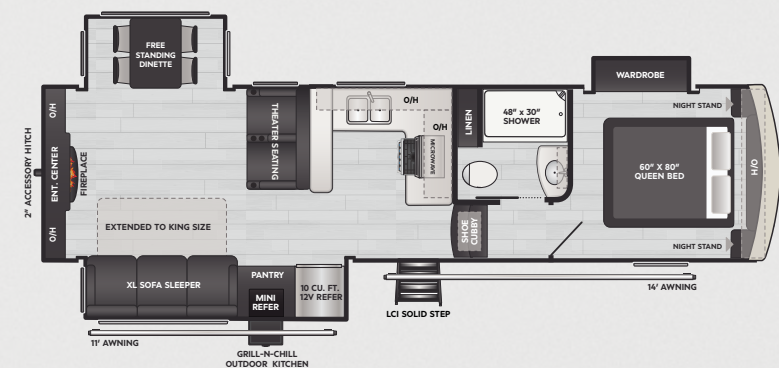

**294SLRD** | WEIGHT **9065** | LENGTH **33' 2"**

DISCLAIMER: Product information is as accurate as possible as of the date of this publication. All features, floor plans, and specifications are subject to change without notice. Pre-production estimated weights & lengths may be listed; visit [Keystonerv.com](http://Keystonerv.com) for the most current product information and specifications.

**CAMP BETTER**  
KINDNESS · COMMUNITY · PLANET





**KEYSTONE**  
RV COMPANY

# ARCADIA

2025 | SUPER LITE FIFTH WHEELS

## OPTIONS

- » 2nd 13.5K BTU A/C
- » Dual Pane Frameless Windows
- » Freestanding Dinette with 4 Chairs IPO Booth Dinette
- » Trifold Sofa IPO Theater Seats (242SLMD, 288SLBH)
- » 12V Cooling Drawer
- » Slide Awning Package
- » SolarFlex™ Discover 440i
- » Optional Dragonfly® Energy Lithium-Ion Batteries

## INTERIOR

- » HyperDeck™ Water-Resistant Floors
- » Peak™ Weather Protection Package
- » Upgraded 35K BTU Furnace
- » Fireplace w/ Additional 5.1K BTU Heating Element (Select Models)
- » Girard® Tankless On-Demand Water Heater
- » Coleman®-Mach® Quiet Series 15K BTU Air Conditioner, w/ Optional 13.5K A/C
- » Soft-Close Cabinet Doors
- » Extra Large, 12V Solar-Friendly Refrigerator
- » Upgraded Residential-Size 60"x80" Queen Mattress
- » Vinyl Roller Shades
- » High Watt Shower Light
- » Oxygenics Shower Head and Hose

## EXTERIOR

- » NEW ABS Braking
- » Painted Cap & Exterior Graphics w/ Dynamic Two-Tone Skirt Metal
- » One-Piece Alpha SuperFlex™ TPO Roof Membrane w/ Limited Lifetime Warranty
- » Lippert Road Defense™ Powder-Coated Chassis Protection
- » Road Armor™ Upgraded Suspension Package
- » Upgraded E-Load Tires w/ 6-Year Warranty
- » Enclosed, Heated Holding Tanks w/ 12V Heat Pads
- » Straight-Line Pass-Through Storage
- » Individual Shut Off Valves On Water Lines & Plumbing Fixtures
- » Nautilus Water Control Center
- » NEW Water Filtration System
- » Safeview Smart Power Inlet
- » Taillight w/ Backup Light Feature
- » SolarFlex™ Protect 220
- » 1-Year Limited Base Warranty & 3-Year Limited Structural Warranty (See [KeystoneRV.com](http://KeystoneRV.com) For Details)

# STANDARD FEATURES & OPTIONS



DISCLAIMER: Product information is as accurate as possible as of the date of this publication. All features, floor plans, and specifications are subject to change without notice. Pre-production estimated weights & lengths may be listed; visit [KeystoneRV.com](http://KeystoneRV.com) for the most current product information and specifications.

**CAMP BETTER**  
KINDNESS · COMMUNITY · PLANET

