

ROAMER

2025 FIFTH WHEELS



35.8022° N, 82.3452° W
Asheville, North Carolina

Roam Wild





2025 Roamer 264RLS

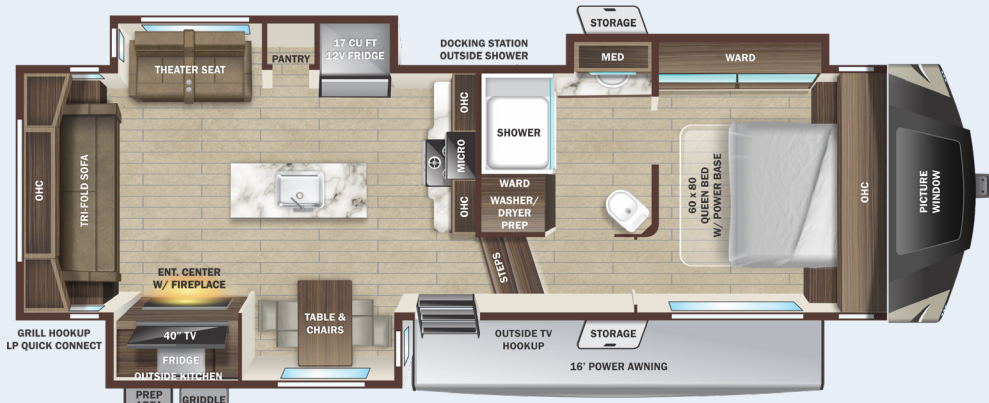

264RLS

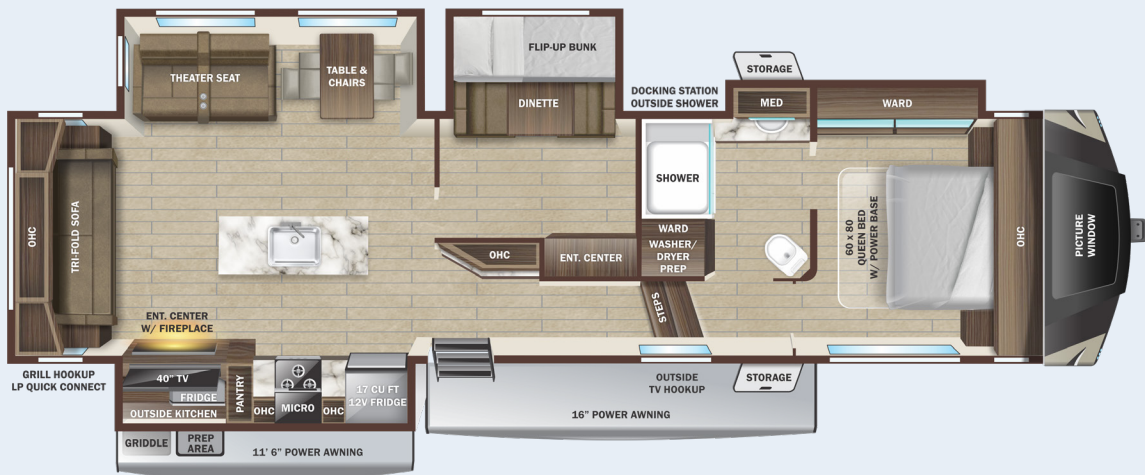

354MBH A OPTION

ROAMER FW

FLOORPLAN OPTION

A

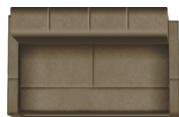

Tri-Fold Sofa (Bunkroom)

STANDARD INTERIOR EQUIPMENT

- » 17 cu. ft. 12V refrigerator
- » 60" x 80" residential queen bed with adjustable power base
- » 75 lb. ball bearing drawer guides
- » Cable and satellite prep
- » Flush floor slides with residential vinyl flooring
- » Glass Residential Shower Door
- » Hardwood cabinet doors
- » Hardwood slideout fascia
- » Large oven and 3-burner range with flush mount glass cover
- » LED interior lighting
- » Observation camera prep
- » Residential microwave
- » Roller blackout night shades
- » Theater seating with power recline
- » Wall controlled power vent (kitchen/living room area)
- » Washer/dryer prep

STANDARD EXTERIOR EQUIPMENT

- » 100" wide body frame
- » 2" receiver hitch
- » 3-20 lb. LP bottles
- » 50 amp service
- » ACCU-SLIDE™ slide system (42" deep 4-corner compression)
- » Battery disconnect switch
- » Brass hanger bushings with wet bolts
- » Equa-Flex® axle suspension
- » Exterior grill/griddle quick connect port
- » Laminated block foam floor

- » LevelLoc™ - 4 point automatic leveling with JT's Strong Arms®
- » PVC roofing membrane (limited lifetime warranty)
- » Rear roof access ladder
- » Self-adjusting electric brakes
- » Spare tire
- » TuffShell™ -vacuum bonded laminated construction, reinforced with heavy-duty fiberglass and welded aluminum frames
- » Xtend Solar I Package (1-200 watt solar panel with 30 amp controller)

EXECUTIVE PACKAGE (MANDATORY)

- » Cutting board and sink strainer
- » Dome style digital TV antenna with Wi-Fi prep
- » Interior convenience center light
- » Keyed-Alike® entry and baggage doors
- » Painted fiberglass front cap with LED lighting and automotive tinted window
- » Power awning with LED lighting
- » Quick recovery gas/electric water heater
- » Quick release fresh water drain
- » Residential high-rise faucet with pull-down sprayer
- » Single basin stainless steel under-mount kitchen sink
- » Smart Entertainment HDTV with Bluetooth®, Soundbar and Built in Stereo
- » Solid swing-down entry steps
- » Solid-surface kitchen countertops
- » Stainless steel appliances
- » TravelLINK® - Smart RV system that allows for Bluetooth® control of awnings, lighting, slideouts, heating, cooling and more
- » USB/12V charging port

FOUR SEASON PACKAGE (MANDATORY)

- » Double insulated baggage doors
- » Ducted heat to underbelly with cold air return
- » Enclosed cable operated gate valves
- » Enclosed exterior docking station with black tank flush
- » Heated and enclosed underbelly
- » High performance furnace
- » R-38 reflective foil insulation in ceiling and underbelly
- » R-9 block foam insulation in sidewalls

OPTIONS

- » 15,000 BTU ducted 2nd A/C
- » Booth dinette with theater seating (N/A 264RLS)
- » Frameless dual pane windows
- » Generator prep-LP
- » Main bedroom TV- 32"
- » Observation camera
- » On demand water heater
- » Rear table with chairs & mega lounge IPO tri-fold sofa (354MBH)
- » Slideout awning covers
- » Wall controlled power vent - bathroom
- » Wi-Fi router
- » Xtend Solar II Package (2-200 watt solar panels with 30 amp solar controller and 1800 watt inverter) (Replaces standard Xtend Solar I Package)

SPECIFICATIONS

May Include Estimated Values

	264RLS	354MBH
Unloaded Vehicle Weight (lbs.)	9,735	11,310
Dry Hitch Weight (lbs.)	1,790	2,245
Gross Vehicle Weight Rating (GVWR)	11,800	13,500
Cargo (Gross)	2,065	2,190
Exterior Length (Pin to Rear)	31' 10"	38' 5"
Exterior Length (Overall)	32' 8"	39' 1"
Exterior Height	12' 6"	13' 1"
Exterior Width	8' 4"	8' 4"
Exterior Width (Slides Out)	13' 11"	15' 2"
Interior Height (Upper Deck)	6' 4"	6' 4"
Interior Height (Lower Deck)	8' 6"	8' 2"
Fresh Water Capacity (Gal.)*	81	81
Gray Waste Water Capacity (Gal.)	97	97
Black Waste Water Capacity (Gal.)	40	40
LP Capacity (lbs.)	60	60
Tire Size	16"	16"
Awning Size	16'	16', 11' 6"

*Includes Water Heater

LOCAL DEALER INFO

TO LEARN MORE VISIT
highlandridgerv.com

Highland Ridge RV – Part of the Jayco Family of Companies



Due to continual research and advances, manufacturer reserves the right to change specifications, design, price, and equipment without notice, and assumes no responsibility for any error in the literature. Some items shown are not included as standard or optional equipment.