



EXPANDABLE TRAVEL TRAILERS
BY **ROCKWOOD**

PROUDLY
Millersburg Made
SINCE 1974



FOREST
RIVER

Roo Travel Trailers

HOP INTO VALUE WITH THE ROO!

The 2024 Roo combines the feel of a traditional with expandable fold out beds with heated mattresses, providing a spacious interior and unique camping experience.

Amenities include a standard 1800W inverter with inverted outlets, 200W roof mounted solar panel with a 30A controller, 15,000 BTU A/C, hybrid woven flooring in flush floor slide outs, aluminum framed dinette and bed bases, and a Showermiser water saving system.



SUPERIOR CONSTRUCTION

1. Complete **Composite** Wall Construction
2. 5/8" Tongue & Groove Plywood Floor
3. Fully Laminated Walkable Roof
4. Six-Sided Full-Aluminum Frame
5. Aluminum Floor Joists
6. Frameless Windows
7. Aluminum Truss Roof Bracing
8. Easy Reach Lockable Latch System

STANDARD FEATURES

9. 200W Solar Panel w/1800W Inverter & 30A Charge Controller
10. Back-Up Camera Prep
11. (2) Maxxair® Fans with Cover
12. Winegard Air 360+ Prepped for Wi-Fi
13. Key-Alike Lock System
14. Slam Baggage Doors
15. Additional Solar Prep
16. Double Battery Boxes
17. Double 20 Lb. LP Tanks
18. 5-Year Tent Warranty

SAFETY STANDARDS

19. Nitrogen-Filled Tires
20. Dexter® Torflex® Axles
21. TST Tire Pressure Monitor System
22. Goodyear Endurance Tires
23. MORryde® Strut Assist Steps¹

CLIMATE PROTECTION PACKAGE

24. 12V Thermostat-Controlled Heated Tanks
25. Radiant Foil in Underbelly

OPTIONAL FEATURES

26. Additional 200W Solar Panel

¹ N/A 19/183/233S



ROCKWOOD

ROO TRAVEL TRAILERS

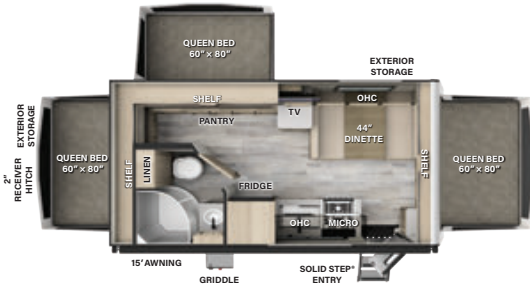

183

LENGTH: 21' 2" OPEN LENGTH: 25' 7" WIDTH: 8' HEIGHT: 10' 6"

HITCH: 450 AXLE: 3771 UVW: 4259 CCC: 1471

F 54 GAL G 30 GAL B 30 GAL

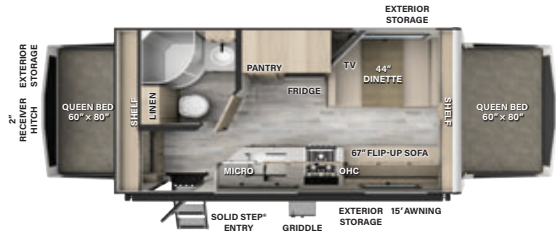

19

LENGTH: 22' OPEN LENGTH: 26' 5" WIDTH: 8' HEIGHT: 10' 6"

HITCH: 522 AXLE: 3795 UVW: 4355 CCC: 1447

F 54 GAL G 30 GAL B 30 GAL

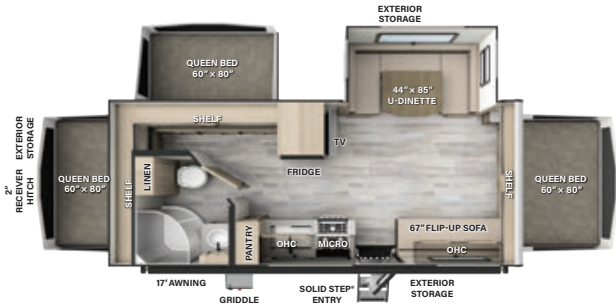

233S

LENGTH: 24' 10" OPEN LENGTH: 29' 7" WIDTH: 8' HEIGHT: 10' 6"

HITCH: 652 AXLE: 4421 UVW: 5111 CCC: 1541

F 54 GAL G 30 GAL B 30 GAL

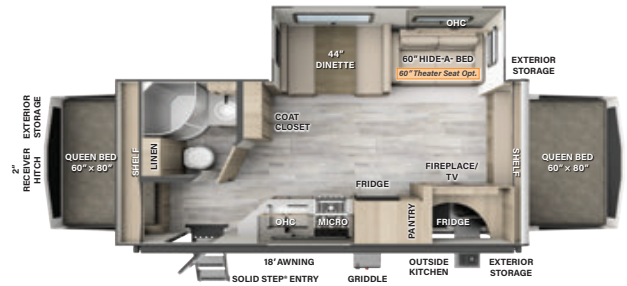

235S

LENGTH: 24' 10" OPEN LENGTH: 29' 7" WIDTH: 8' HEIGHT: 10' 11"

HITCH: 738 AXLE: 4863 UVW: 5639 CCC: 1259

F 54 GAL G 30 GAL B 30 GAL

Millersburg, Indiana is a special place with special people. This is a town built upon care, craftsmanship, and teamwork. Millersburg is our home and we're grateful for the opportunity to employ many of our neighbors, friends, and families. Rockwood is a proud employer of multiple generations of Millersburg residents and our quality-first reputation is second to none, thanks to our Millersburg home.

We're happy to have zero stoplights, two banks, two parks, one gas station, one car mechanic, an elementary school, and a few churches in our humble corner of Elkhart County. We work hard, care, build, craft, and take care of each other and our families. Millersburg keeps North America camping, one Rockwood at a time, made with pride and value.



SCAN THE QR CODE WITH YOUR MOBILE DEVICE

VIRTUAL TOURS, PHOTOS, VIDEOS, FOLLOW ROCKWOOD ON SOCIAL MEDIA, AND MORE!



Download the App!

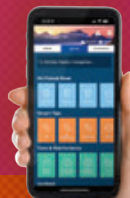

Apple and App Store are registered trademarks of Apple Inc. Google Play and the Google Play logo are trademarks of Google LLC.

CUSTOMER SATISFACTION



Rockwood Warranty. Our Promise.

www.ForestRiverBuyLocal.com

FOR DETAILS ON ROCKWOOD'S COMPLETE WARRANTY PROGRAM, SEE YOUR ROCKWOOD DEALER.

When it comes to backing products with the same quality and commitment it does when it begins the manufacturing process, the only name you have to remember when you're looking for a recreational vehicle is Rockwood. Rockwood offers the following additional limited warranties to the original purchasers. Consult written warranty for details.

1 Limited Lifetime roofing warranty.*

2 Two-year fiberglass warranty.

3 Ten-year Torflex® axle warranty.

4 One-year bumper to bumper warranty.

*Lifetime warranty is limited to original owner

Specification Definitions

GVWR (Gross Vehicle Weight Rating): is the maximum permissible weight of the unit when fully loaded. It includes all weights, inclusive of all fluids, cargo, optional equipment and accessories. For safety and product performance do NOT exceed the GVWR.

GAWR (Gross Axle Weight Rating): is the maximum permissible weight, including cargo, fluids, optional equipment and accessories that can be safely supported by a combination of all axles.

UVW (Unloaded Vehicle Weight):¹ is the typical weight of the unit as manufactured at the factory. It includes all weight at the unit's axle(s) and tongue or pin and LP Gas. The UVW does not include cargo, fresh potable water, additional optional equipment or dealer installed accessories.

CCC (Cargo Carrying Capacity):¹ is the amount of weight available for fresh potable water, cargo, additional optional equipment and accessories. CCC is equal to GVWR minus UVW. Available CCC should accommodate fresh potable water (8.3 IWW per gallon). Before filling the fresh water tank, empty the black and gray tanks to provide for more cargo capacity.

Each Forest River RV is weighed at the manufacturing facility prior to shipping. A label identifying the unloaded vehicle weight of the actual unit and the cargo carrying capacity is applied to every Forest River RV prior to leaving our facilities.

The load capacity of your unit is designated by weight, not by volume, so you cannot necessarily use all available space when loading your unit.

All information contained in this brochure is believed to be accurate at the time of publication. However, during the model year, it may be necessary to make revisions and Forest River, Inc., reserves the right to make all such changes without notice, including prices, colors, materials, equipment and specifications as well as the addition of new models and the discontinuance of models shown in this brochure. Therefore, please consult with your Forest River dealer and confirm the existence of any materials, design or specifications that are material to your purchase decision. © 2023 Rockwood RV, a Division of Forest River, Inc., a Berkshire Hathaway Company. All Rights Reserved.

08/10 Rockwood

1 Estimated Average based on standard build optional equipment

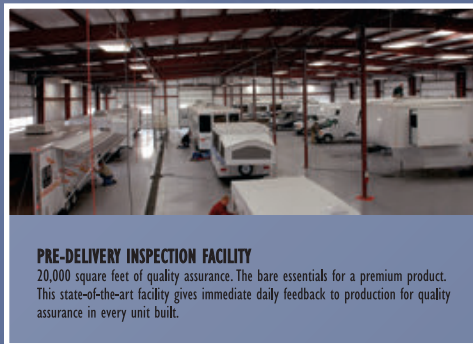

PRE-DELIVERY INSPECTION FACILITY
20,000 square feet of quality assurance. The bare essentials for a premium product. This state-of-the-art facility gives immediate daily feedback to production for quality assurance in every unit built.

24/7 EMERGENCY ROADSIDE ASSISTANCE WITH VEHICLE PURCHASE*

TOWING	WINCH-OUT
JUMP-STARTS	MOBILE MECHANIC
TIRE CHANGES	TECHNICAL SUPPORT
FLUID DELIVERY	DEALER LOCATOR SERVICES
LOCKOUT SERVICE	

SAFERIDERV MOTOR CLUB

*VALID FOR 1 YEAR FROM DATE OF PURCHASE



RV WITH US



@RockwoodRVs



FOREST RIVER OWNER'S GUIDE

Now you can have your Owner's Manual with you wherever you are. Download our FREE App from the App Store or Google Play and you'll have the information right at your fingertips.

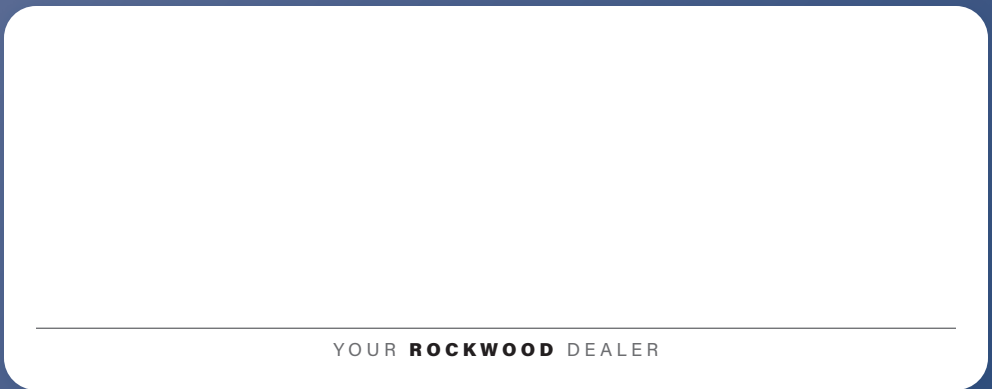

YOUR **ROCKWOOD** DEALER



Learn More
Scan this barcode using a QR Reader on your smart phone to learn more about Forest River.



A Berkshire Hathaway company

ROCKWOOD

201 WEST ELM MILLERSBURG, IN 46543
WWW.FORESTRIVERINC.COM/ROCKWOOD

574.642.2640

FREE MEMBERSHIP
to Forest River Owners' Group

www.forestriverfrog.com

