



READY FOR ADVENTURE

**CLASSIC / LXE**

*And home on the road has never been more luxurious*



ENVIRONMENTALLY FRIENDLY



CAMPERS SINCE 1984

## Aliner: Classic and LXE

This is the model that started it all. All other Aliner models are variations of this original design. Classic earned its name by satisfying customers for over 39 years. It's not the largest or smallest. It's not the heaviest or lightest. It's what Classic owners like to call "just right." Versatile, adaptable, comfortable with everything you want and nothing you don't. The Classic is just that ...classic.

## Features

- Real Hardwood Cabinet Doors
- LED Exterior Running Lights
- Additional Corner Windows
- Exterior Electrical Outlet
- Microwave
- Larger 3.0 cu. ft. Refrigerator
- Hard Dormer Option
- Azdel Lightweight, Composite Interior Wall and Ceiling Panels
- Exterior Propane Connection
- 3 Interior Electrical Outlets
- Front Utility Light
- Radial Tires
- LED Interior Floor Light
- 2 Exterior Bag Doors
- Cable Hook-Up
- Optional Extreme Off-Road Package

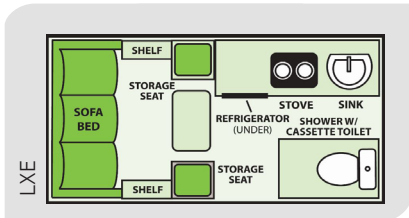
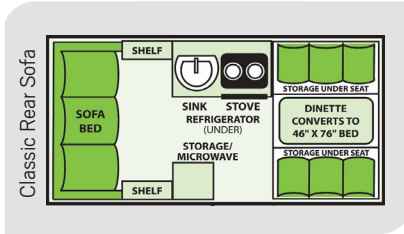
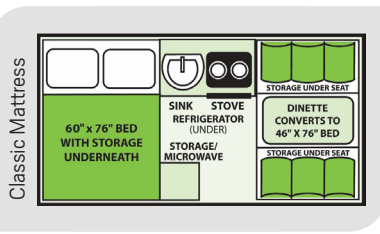

**ALINER**  
Aliner.com | 724-237-5227

**CAMPER SPECS**
**Classic Mattress/Rear Sofa**
**LXE**

Overall Length (feet)	15'	15'
Width (inches)	78"	78"
Closed Height (inches)	64"	64"
Dry Weight (lbs.)	1,725 lbs.	1,930 lbs.
Tires and Wheels	14" Aluminum Standard	14" Aluminum Standard
Gross Vehicle Weight Rating (GVWR) & Axle Rating	3,000 lbs.	3,000 lbs.
Dry Hitch Weight	180 lbs.	180 lbs.

**INTERIOR**

Sink	S	S
Shower and Toilet Combo	N/A	S
Fresh Water	11 gallon	11 gallon
Electrical Outlets	3	3
LED Interior Lights	S	S
Front Bed	46" x 76"	N/A
Rear Bed	60" x 76"	74" x 76"

**APPLIANCES**

Water Pump	S	S
Dometic Refrigerator	3.0 cu. ft. Gas/Electric	3.0 cu. ft. Gas/Electric
Microwave	S	S
Stove Top (2 Burner)	In/Out	Built-In
18,000 Btu Furnace	S	S
6 Gallon DSI Water Heater	S	S
Air Conditioning -Heat Pump	S	S

**EXTERIOR**

Stabilizer Jacks	4	4
Outside Shower	S	S
Baggage Doors	2	2
Front Utility Light	S	S
LED Running Lights	S	S
Exterior Outlet	S	S
Outside LP Connection	S	S
Gray Fiberglass	S	S

**DORMERS**

Front Dormer (Soft)	O	O
Rear Dormer (Soft)	O	O
Front Dormer (Hard)	O	S
Rear Dormer (Hard)	O	O

**CONVENIENCE**

Dual Tanks and Cover	S	S
High Wind Lift Assist	S	S
15" Off-Road Tires w/ Graphics Pkg.	O	O
Outside Grill	O	O