

HIDEOUT

TRAVEL TRAILERS

2024 EASTERN + WESTERN EDITION



KEYSTONE
RV COMPANY

CAMP BETTER
KINDNESS · COMMUNITY · PLANET

HIDEOUT

TRAVEL TRAILERS



KEYSTONE
RV COMPANY

CAMP BETTER
KINDNESS · COMMUNITY · PLANET

HIDEOUT SPORT SINGLE-AXLE TRAVEL TRAILERS

Welcome to a world of boundless possibilities in smaller, lightweight packages, making spontaneous getaways a reality. Towable by many SUVs and most half-ton trucks, Hideout Sport's scaled-down size brings endless adventure within reach. Your pathway to adventure begins with Hideout Sport – compact, convenient, and calling you to embark on unforgettable escapades.

SPORT SINGLE-AXLE FEATURES

- Floorplan-Specific Frames w/ Full Width Outriggers
- Dynaspan™ Floor Decking w/ 25 Year Warranty
- Hardwood Cabinet Doors
- Bathroom Vanity
- Bedroom Wardrobe
- 20K BTU Furnace
- Shower w/ Skylight And Surround
- Large Entry Door Grab Handle
- Tinted Windows
- Lippert® Tire Pressure Monitoring System Prep
- Solarflex™ Ready Solar Power Prep
- Girard® On-Demand Tankless Water Heater
- 1-Year Limited Base Warranty & 3-Year Limited Structural Warranty (SEE KEYSTONERV.COM FOR DETAILS)

VISIT OUR WEBSITE FOR PHOTOS,
360° TOURS, AND FULL PRODUCT DETAILS



We have the 2021 Keystone Hideout 318BR. Some of the main things we enjoy about our Hideout are the outdoor kitchen with the sink, stove top burner & fridge. Perfect for cooking outside on hot summer days and storing additional beverages. This model has a Furrion Bluetooth radio & outdoor speakers, so you can enjoy music while cooking and hanging with friends. Let's not forget the outdoor shower allows us to wash down the kids before they head inside; it also doubles as a dog wash and is perfect for filling our dog bowls. The bunkhouse room was the main thing that attracted us to this model. It is located at the rear of the rig and sleeps three comfortably; it has a sliding door for privacy & lounge area for watching TV. This is our first RV, and we are so happy we purchased a Keystone. We have enjoyed living in it full time for three years & have slept up to 9 people comfortably along with our 200lb mastiff & 10lb Chigle. The insulated underbelly and electric fireplace have kept us warm in the snow. We have stayed cozy in single-digit temperatures without using our furnace once! The electric fireplace is our favorite amenity in the rig.



@RV_HIDEOUT_ADVENTURES — HIDEOUT 318BR OWNERS

SPORT SINGLE-AXLE TRAVEL TRAILERS

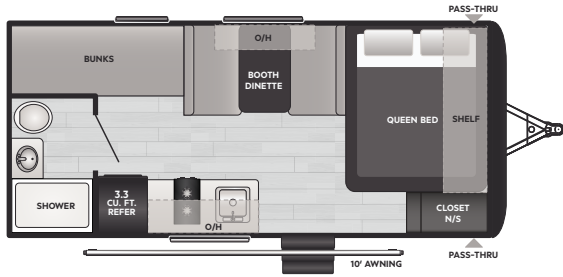

175BH | WEIGHT 3170 | LENGTH 20' 6"

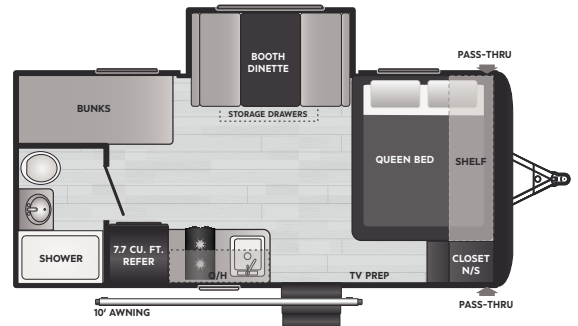

176BH | WEIGHT 3810 | LENGTH 21' 5"

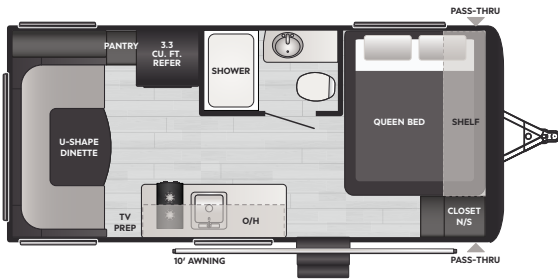

177RD | WEIGHT 3522 | LENGTH 21' 5"

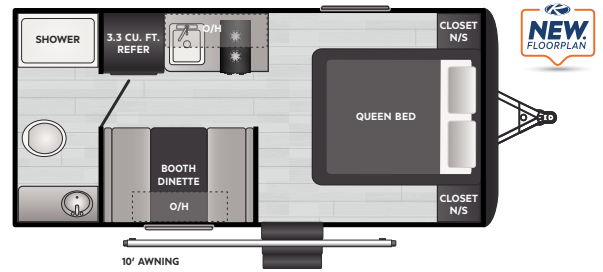

178RB | WEIGHT 3040 | LENGTH 20' 11"

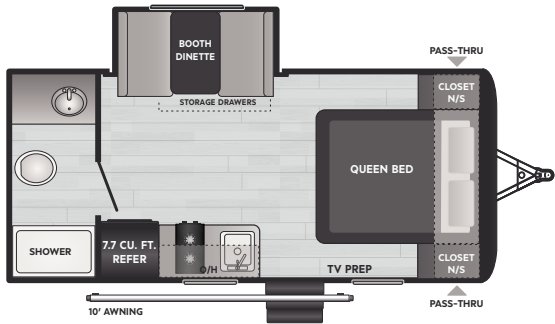

179RB | WEIGHT 3753 | LENGTH 21' 5"

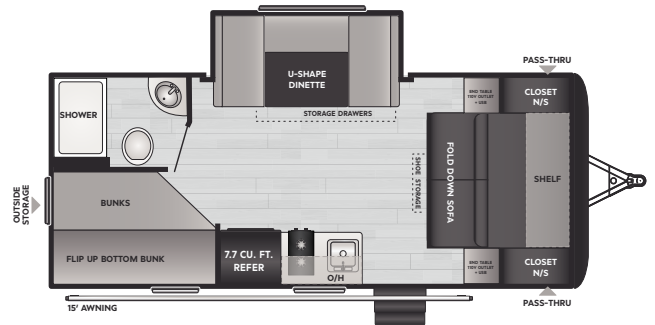

181BH | WEIGHT 4515 | LENGTH 22' 9"

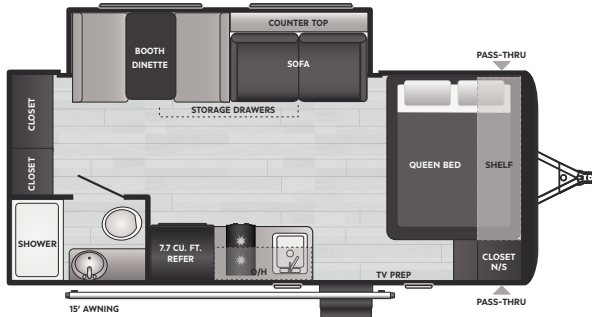

186SS | WEIGHT 4374 | LENGTH 22' 10"

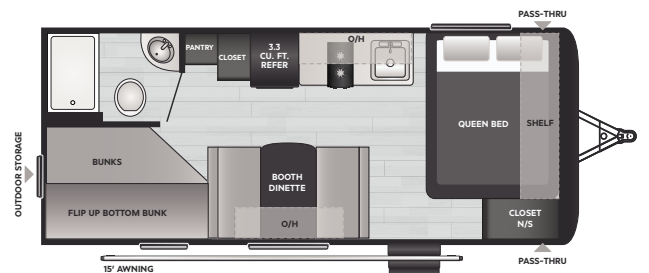

201BH | WEIGHT 4266 | LENGTH 22' 9"

HIDEOUT SPORT DUAL-AXLE TRAVEL TRAILERS

Experience the essence of camping redefined with the all-new Hideout Sport Value Collection – an ultra-affordable lineup that brings you back to the heart of the great outdoors. RV camping simplified, focusing on what truly matters, providing everything you need and nothing you don't. Our mission is to bring RVing within reach for all Americans, ensuring that the joy of adventure is accessible to everyone.

SPORT DUAL-AXLE FEATURES

- Dynaspan™ Floor Decking w/ 25-Year Warranty
- Hardwood Cabinet Doors
- Power Package: Tongue Jack, Stabilizer Jacks, Awning
- 81" Ceiling Height
- Fully Walkable Roof
- Improved Bedroom Storage
- Lippert® Ladder Prep
- Lippert® Tire Pressure Monitoring System Prep
- 30K BTU Ducted Furnace
- Shelves in Kitchen Overhead Cabinetry
- 15.5K BTU A/C
- Girard® On-Demand Tankless Water Heater
- Solarflex™ Ready Solar Power Prep
- Extra Large Entry Door Grab Handle
- 10 Cu. Ft. 12-Volt Refrigerator
- Dual Exterior Bluetooth Speakers
- 1-Year Limited Base Warranty & 3-Year Limited Structural Warranty (SEE KEYSTONERV.COM FOR DETAILS)

SPORT DUAL-AXLE TRAVEL TRAILERS

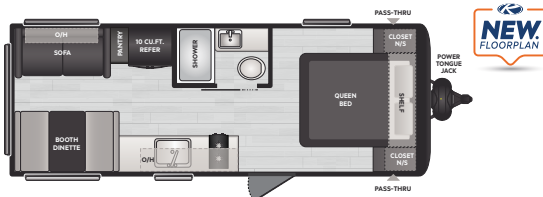

200RL | WEIGHT 4535 | LENGTH 25' 4"

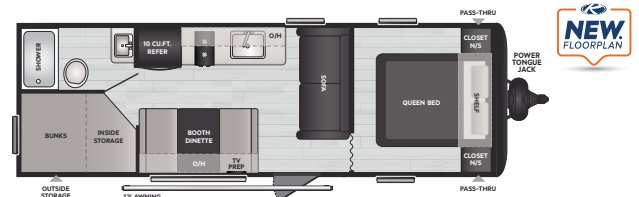

240BH | WEIGHT 4875 | LENGTH 28' 10"

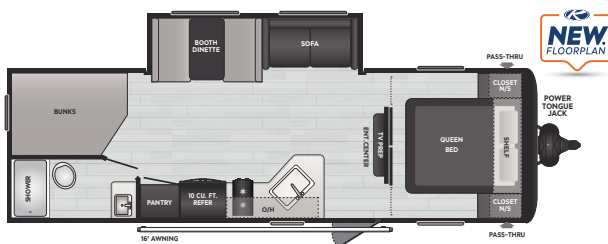

261BH | WEIGHT 6115 | LENGTH 30' 8"

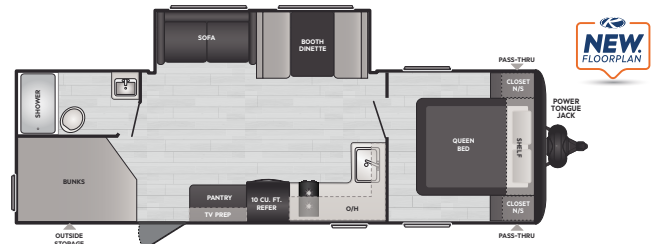

269DB | WEIGHT 6185 | LENGTH 30' 8"

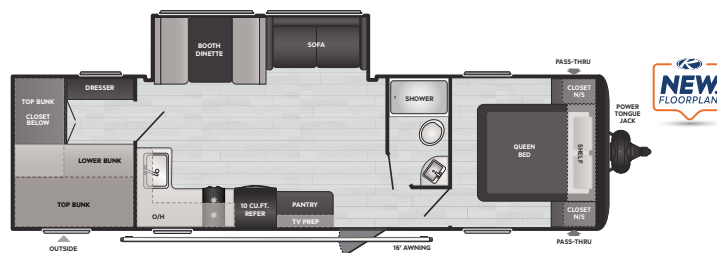

291BR | WEIGHT 6730 | LENGTH 33' 11"

HIDEOUT TRAVEL TRAILERS

Embark on a journey where affordable adventure awaits, and quality meets style – welcome to the world of Hideout Travel Trailers. Hideout is perfect balance of affordability, comfort, and endless exploration. Whether you're seeking tranquil escapes or thrilling adventures, Hideout Travel Trailers promise to be your gateway to unforgettable experiences, where the joy of the journey is matched only by the memories you make at the destination.

HIDEOUT FEATURES

- Floorplan-Specific Frames w/ Full Width Outriggers
- Power Package: Tongue Jack, Stabilizer Jacks, Awning
- Dynaspan™ Floor Decking w/ 25-Year Warranty
- Hardwood Cabinet Doors
- 30K BTU Ducted Furnace
- 15.5K BTU A/C
- Shelves in Kitchen Overhead Cabinetry
- Improved Bedroom Storage
- Pressed Kitchen Countertops
- Stainless Steel Single-Basin Sink
- MORryde® Step Above® Entry Steps
- Fully Walkable Roof
- Lippert® Ladder Prep
- Lippert® Tire Pressure Monitoring System Prep
- Girard® On-Demand Tankless Water Heater
- Blade™ High-Performance Air Flow System
- Solarflex™ Ready Solar Power Prep
- Do-More Dinette
- Medicine Cabinet Above Bathroom Sink
- 81" Ceiling Height
- 10 Cu. Ft. 12-Volt Refrigerator
- Dual Exterior Bluetooth Speakers
- 1-Year Limited Base Warranty & 3-Year Limited Structural Warranty (SEE KEYSTONERV.COM FOR DETAILS)

HIDEOUT TRAVEL TRAILERS

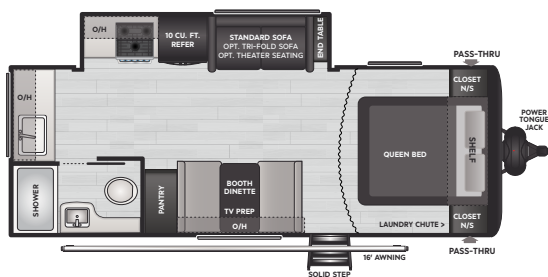

22MLS | WEIGHT **5645** | LENGTH **26' 2"**

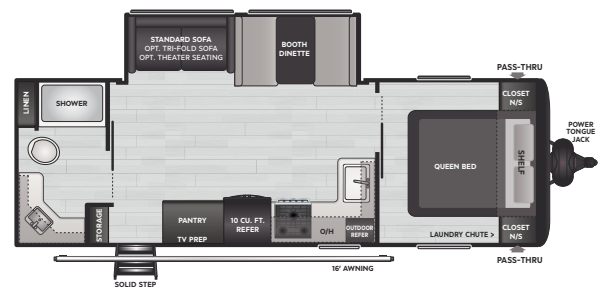

24RBS | WEIGHT **6265** | LENGTH **28' 11"**

VISIT OUR WEBSITE FOR PHOTOS,
360° TOURS, AND FULL PRODUCT DETAILS



HIDEOUT TRAVEL TRAILERS

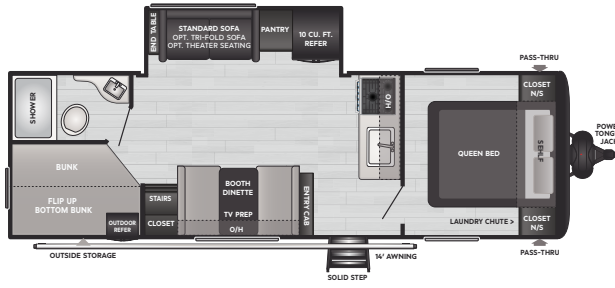

25BHS | WEIGHT 6370 | LENGTH 29' 11"

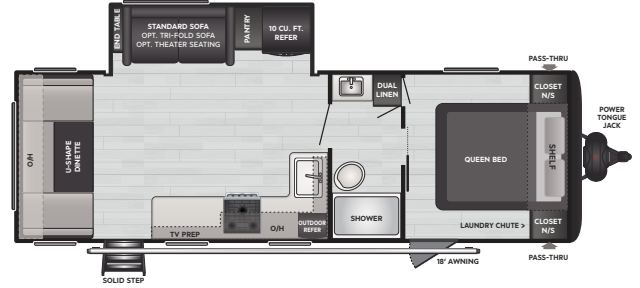

25RDS | WEIGHT 6330 | LENGTH 29' 5"

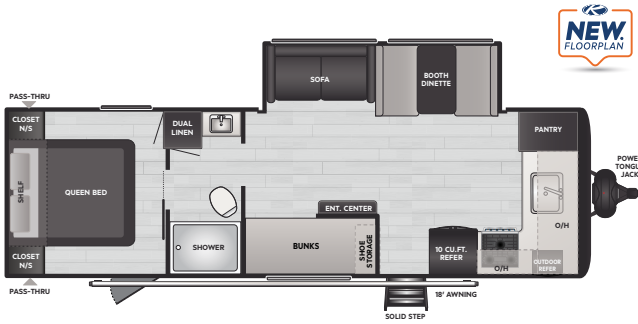

26FKS | WEIGHT 6635 | LENGTH 30' 11"

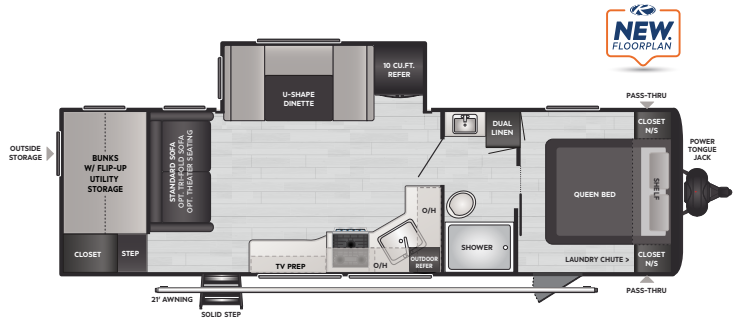

28BUS | WEIGHT TBD | LENGTH 33' 1"

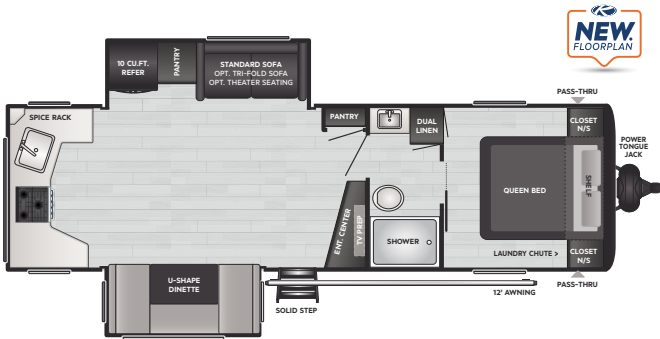

28RKD | WEIGHT 7170 | LENGTH 32' 5"

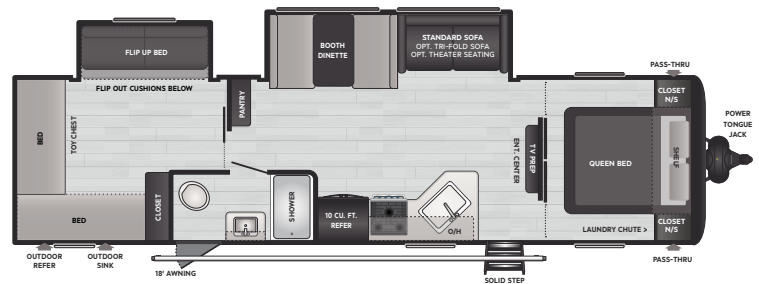

31BRD | WEIGHT 7751 | LENGTH 35' 11"

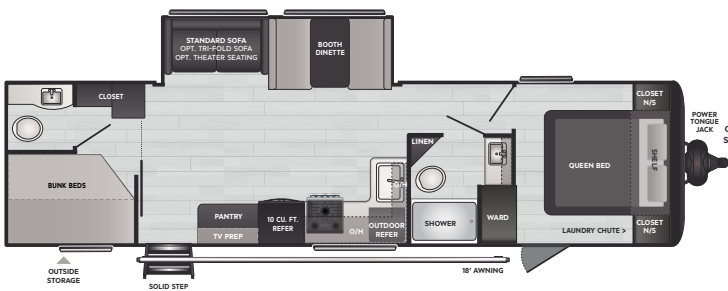

31DBS | WEIGHT 7640 | LENGTH 35' 11"

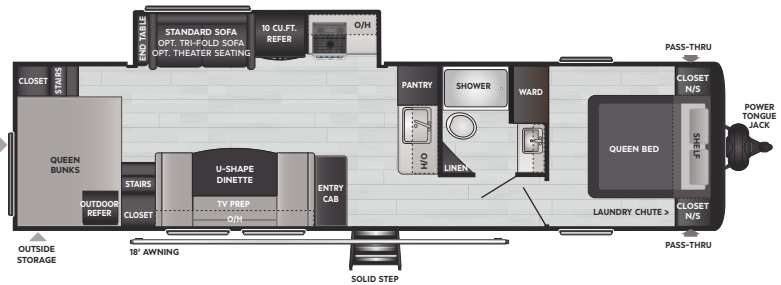

32TQS | WEIGHT 7360 | LENGTH 36' 11"

KEYSTONE OWNER'S SUPPORT

Keystone makes operating and maintaining your new RV easy with world-class resources and support. Owners have access to a wide variety of support tools and services via the MyKeystone mobile app and the Owner's section of KeystoneRV.com.

FIRST TIME CAMPER'S VIDEO SERIES

A comprehensive guide to RV camping basics with Keystone's Matt & Bart.

PRO TIPS DIY OPERATION & MAINTENANCE VIDEO LIBRARY

Visit our growing collection of step-by-step video and written guides to operating, maintaining, and repairing your Keystone RV.

DIGITAL OWNER'S MANUAL

Our new online owner's manual is fully searchable and features helpful visual and video support.

DIY REPAIR PROGRAM*

Which includes free parts for small repairs within your first year of ownership

1-YEAR LIMITED BASE WARRANTY*

3-YEAR LIMITED STRUCTURAL WARRANTY*

*See KeystoneRV.com for full details. PRO TIP: Owners should work with their dealers or other Keystone authorized service center or mobile tech to document all warranty claims within the warranty period.

HIDEOUT SPECIFICATIONS

MODEL	WEIGHT	CARRYING CAPACITY	HITCH WEIGHT	FRESH WATER**	WASTE WATER	GRAY WATER	LPG	LENGTH*	WIDTH	HEIGHT	AWNING
175BH	3170	1215	385	21	30	30	20	20' 6"	8'	10' 2"	10'
176BH	3810	690	520	21	30	30	20	21' 5"	8'	10' 2"	10'
177RD	3522	878	540	21	30	30	20	21' 5"	8'	10' 2"	10'
178RB	3040	1360	440	21	30	30	20	20' 11"	8'	10' 2"	10'
179RB	3753	727	480	21	32	30	20	21' 5"	8'	10' 2"	10'
181BH	4515	585	595	21	30	60	20	22' 9"	8'	10' 4"	15'
186SS	4374	726	610	21	30	30	20	22' 10"	8'	10' 4"	14'
201BH	4266	1734	565	21	30	30	20/30 opt	22' 9"	8'	10' 5"	15'
200RL	4535	3015	555	46	39	39	40	25' 4"	8'	10' 11"	12'
240BH	4875	2725	645	43	39	78	40	28' 10"	8'	11' 0"	12'
261BH	6115	1885	885	46	30	30	40	30' 8"	8'	11' 1"	16'
269DB	6185	1625	810	46	30	60	40	30' 8"	8'	11' 1"	18'
291BR	6730	2270	865	46	30	69	40	33' 11"	8'	11' 1"	16'
22MLS	5645	1855	665	46	39	39	40	26' 2"	8'	11' 1"	16'
24RBS	6265	1395	665	46	39	69	40	28' 11"	8'	11' 1"	18'
25BHS	6370	1305	675	46	30	69	40	29' 11"	8'	11' 1"	16'
25RDS	6330	1375	705	46	30	69	40	29' 5"	8'	11' 1"	18'
26FKS	6635	1265	935	46	30	69	40	30' 11"	8'	11' 1"	18'
28BUS	TBD	TBD	TBD	46	30	39	40	33' 1"	8'	11' 3"	21'
28RKD	7170	2405	775	46	30	78	40	32' 5"	8'	11' 3"	12'
31BRD	7751	1849	870	46	39	69	40	35' 11"	8'	11' 3"	18'
31DBS	7640	2060	755	46	69	78	40	35' 11"	8'	11' 1"	18'
32TQS	7360	2240	800	46	30	69	40	36' 11"	8'	11' 2"	18'

SOLAR FLEX™



NEW 2024 PACKAGE UPDATES

For more information scan the QR code or visit keystonerv.com.

TAKE CHARGE OF HOW YOU CAMP

EXCEPTIONAL QUALITY, IMPOSSIBLY VERSATILE, SolarFlex™ IS SHATTERING CUSTOMER'S EXPECTATIONS OF FACTORY-INSTALLED SOLAR POWER. EXCLUSIVELY AVAILABLE ON ALL KEYSTONE RV MODELS.



Keystone RV is proud to partner with Dragonfly Energy to offer their legendary heated Lithium-ion batteries exclusively on all Keystone models.



FOLLOW US FOR THE LATEST!



DISCLAIMER: Product information is as accurate as possible as of the date of publication of this brochure. All features, floor plans, and specifications in this brochure are subject to change without notice. Please also consult Keystone's web site at www.keystonerv.com for more current product information and specifications. Tow Vehicle Disclaimer. CAUTION: Owners of Keystone recreational vehicles are solely responsible for the selection and proper use of tow vehicles. All customers should consult with a motor vehicle manufacturer or their dealer concerning the purchase and use of suitable tow vehicles for Keystone products. Keystone disclaims any liability or damages suffered as a result of the selection, operation, use or misuse of a tow vehicle. KEYSTONE'S LIMITED WARRANTY DOES NOT COVER DAMAGE TO THE RECREATIONAL VEHICLE OR THE TOW VEHICLE AS A RESULT OF THE SELECTION, OPERATION, USE OR MISUSE OF THE TOW VEHICLE. *Length is defined as the distance from the centerline of hitch pin/coupler to rear bumper of trailer. ** Fresh water capacity includes water heater. Please review owner's manual prior to purchase for more information on service warranties, extended use, towing and maintenance. Owner's manuals can be found at keystonerv.com.

PRINT 10.2023

HIDEOUT

TRAVEL TRAILERS

WESTERN EDITION



KEYSTONE
RV COMPANY

CAMP BETTER
KINDNESS · COMMUNITY · PLANET

HIDEOUT SPORT SINGLE-AXLE TRAVEL TRAILERS

Welcome to a world of boundless possibilities in smaller, lightweight packages, making spontaneous getaways a reality. Towable by many SUVs and most half-ton trucks, Hideout Sport's scaled-down size brings endless adventure within reach. Your pathway to adventure begins with Hideout Sport – compact, convenient, and calling you to embark on unforgettable escapades.

SPORT SINGLE-AXLE FEATURES

- Floorplan-Specific Frames w/ Full Width Outriggers
- Dynaspan™ Floor Decking w/ 25 Year Warranty
- Hardwood Cabinet Doors
- Bathroom Vanity
- Bedroom Wardrobe
- 20K BTU Furnace
- Shower w/ Skylight And Surround
- Large Entry Door Grab Handle
- Tinted Windows
- Lippert® Tire Pressure Monitoring System Prep
- Solarflex™ Ready Solar Power Prep
- Girard® On-Demand Tankless Water Heater
- 1-Year Limited Base Warranty & 3-Year Limited Structural Warranty (SEE KEYSTONERV.COM FOR DETAILS)

VISIT OUR WEBSITE FOR PHOTOS,
360° TOURS, AND FULL PRODUCT DETAILS



We have the 2021 Keystone Hideout 318BR. Some of the main things we enjoy about our Hideout are the outdoor kitchen with the sink, stove top burner & fridge. Perfect for cooking outside on hot summer days and storing additional beverages. This model has a Furrion Bluetooth radio & outdoor speakers, so you can enjoy music while cooking and hanging with friends. Let's not forget the outdoor shower allows us to wash down the kids before they head inside; it also doubles as a dog wash and is perfect for filling our dog bowls. The bunkhouse room was the main thing that attracted us to this model. It is located at the rear of the rig and sleeps three comfortably; it has a sliding door for privacy & lounge area for watching TV. This is our first RV, and we are so happy we purchased a Keystone. We have enjoyed living in it full time for three years & have slept up to 9 people comfortably along with our 200lb mastiff & 10lb Chigle. The insulated underbelly and electric fireplace have kept us warm in the snow. We have stayed cozy in single-digit temperatures without using our furnace once! The electric fireplace is our favorite amenity in the rig.



@RV_HIDEOUT_ADVENTURES — HIDEOUT 318BR OWNERS

SPORT SINGLE-AXLE TRAVEL TRAILERS

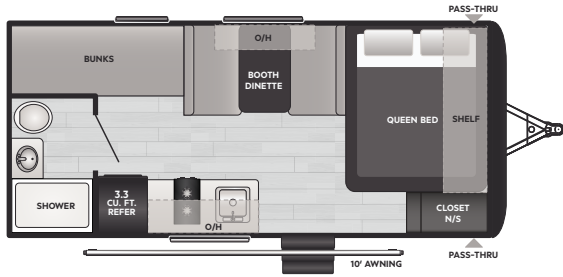

175BH | WEIGHT 3170 | LENGTH 20' 6"

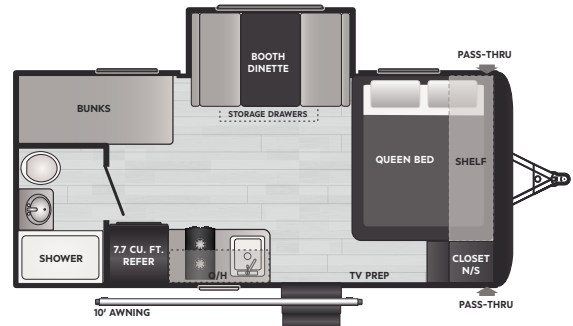

176BH | WEIGHT 3810 | LENGTH 21' 5"

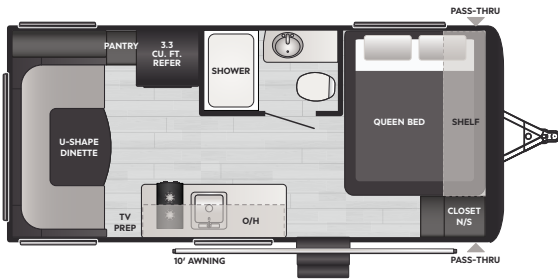

177RD | WEIGHT 3522 | LENGTH 21' 5"

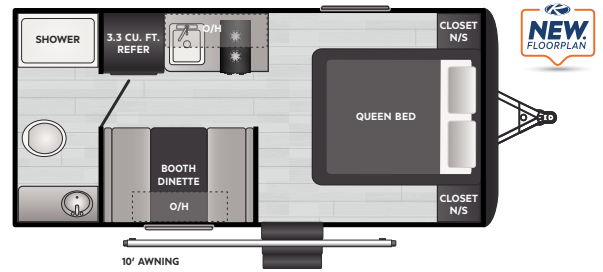

178RB | WEIGHT 3040 | LENGTH 20' 11"

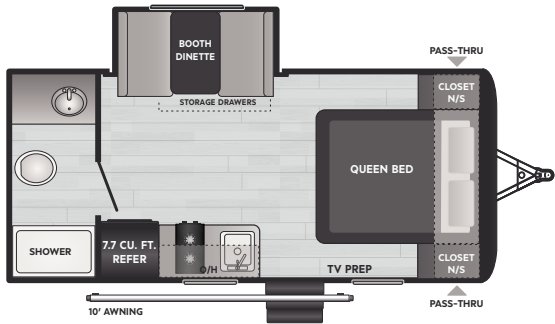

179RB | WEIGHT 3753 | LENGTH 21' 5"

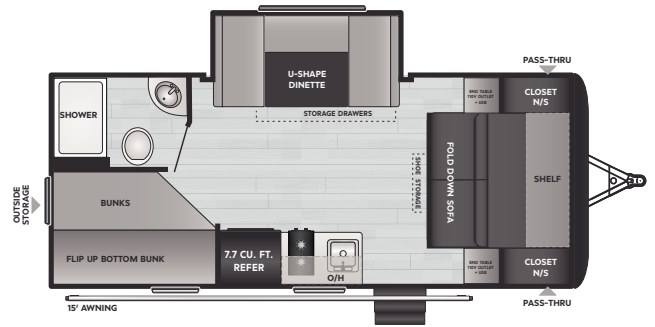

181BH | WEIGHT 4515 | LENGTH 22' 9"

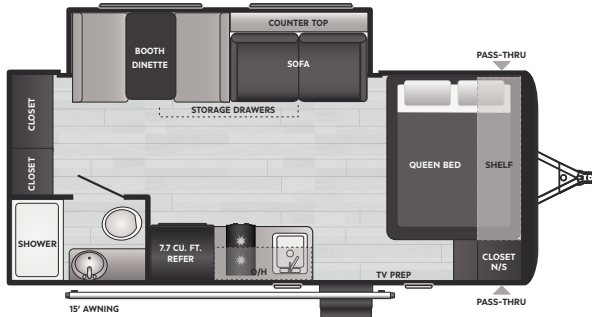

186SS | WEIGHT 4374 | LENGTH 22' 10"

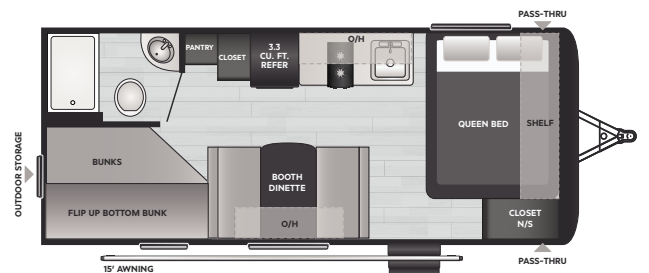

201BH | WEIGHT 4266 | LENGTH 22' 9"

HIDEOUT SPORT DUAL-AXLE TRAVEL TRAILERS

Experience the essence of camping redefined with the all-new Hideout Sport Value Collection – an ultra-affordable lineup that brings you back to the heart of the great outdoors. RV camping simplified, focusing on what truly matters, providing everything you need and nothing you don't. Our mission is to bring RVing within reach for all Americans, ensuring that the joy of adventure is accessible to everyone.

SPORT DUAL-AXLE FEATURES

- Dynaspan™ Floor Decking w/ 25-Year Warranty
- Hardwood Cabinet Doors
- Power Package: Tongue Jack, Stabilizer Jacks, Awning
- 81" Ceiling Height
- Fully Walkable Roof
- Improved Bedroom Storage
- Lippert® Ladder Prep
- Lippert® Tire Pressure Monitoring System Prep
- 30K BTU Ducted Furnace
- Shelves in Kitchen Overhead Cabinetry
- 15.5K BTU A/C
- Girard® On-Demand Tankless Water Heater
- Solarflex™ Ready Solar Power Prep
- Extra Large Entry Door Grab Handle
- 10 Cu. Ft. 12-Volt Refrigerator
- Dual Exterior Bluetooth Speakers
- 1-Year Limited Base Warranty & 3-Year Limited Structural Warranty (SEE KEYSTONERV.COM FOR DETAILS)

SPORT DUAL-AXLE TRAVEL TRAILERS

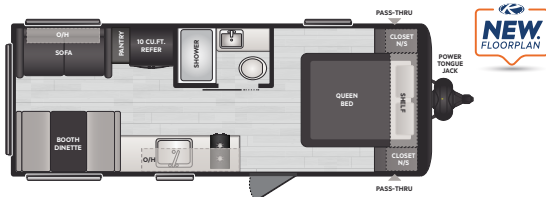

200RLWE | WEIGHT TBD | LENGTH 25' 1"

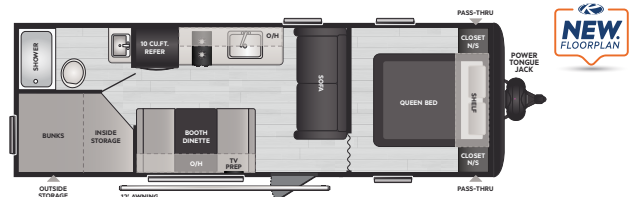

240BHWE | WEIGHT 5010 | LENGTH 28' 10"

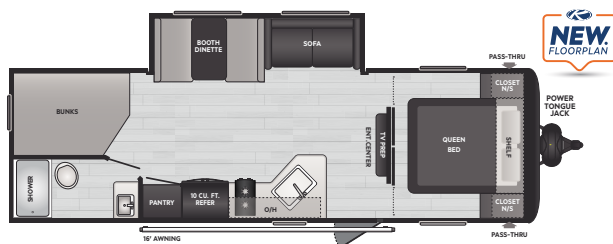

261BHWE | WEIGHT TBD | LENGTH 30' 8"

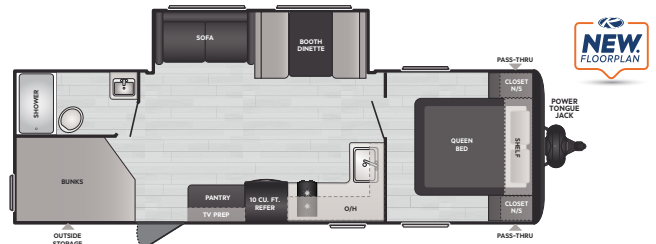

269DBWE | WEIGHT TBD | LENGTH TBD

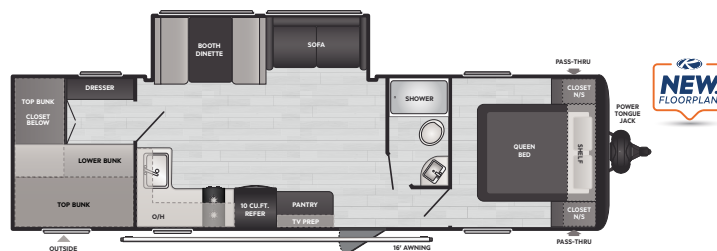

291BRWE | WEIGHT TBD | LENGTH TBD

HIDEOUT TRAVEL TRAILERS

Embark on a journey where affordable adventure awaits, and quality meets style – welcome to the world of Hideout Travel Trailers. Hideout is perfect balance of affordability, comfort, and endless exploration. Whether you're seeking tranquil escapes or thrilling adventures, Hideout Travel Trailers promise to be your gateway to unforgettable experiences, where the joy of the journey is matched only by the memories you make at the destination.

HIDEOUT FEATURES

- Floorplan-Specific Frames w/ Full Width Outriggers
- Power Package: Tongue Jack, Stabilizer Jacks, Awning
- Dynaspan™ Floor Decking w/ 25-Year Warranty
- Hardwood Cabinet Doors
- 30K BTU Ducted Furnace
- 15.5K BTU A/C
- Shelves in Kitchen Overhead Cabinetry
- Improved Bedroom Storage
- Pressed Kitchen Countertops
- Stainless Steel Single-Basin Sink
- MORryde® Step Above® Entry Steps
- Fully Walkable Roof
- Lippert® Ladder Prep
- Lippert® Tire Pressure Monitoring System Prep
- Girard® On-Demand Tankless Water Heater
- Blade™ High-Performance Air Flow System
- Solarflex™ Ready Solar Power Prep
- Do-More Dinette
- Medicine Cabinet Above Bathroom Sink
- 81" Ceiling Height
- 10 Cu. Ft. 12-Volt Refrigerator
- Dual Exterior Bluetooth Speakers
- 1-Year Limited Base Warranty & 3-Year Limited Structural Warranty (SEE KEYSTONERV.COM FOR DETAILS)

HIDEOUT TRAVEL TRAILERS

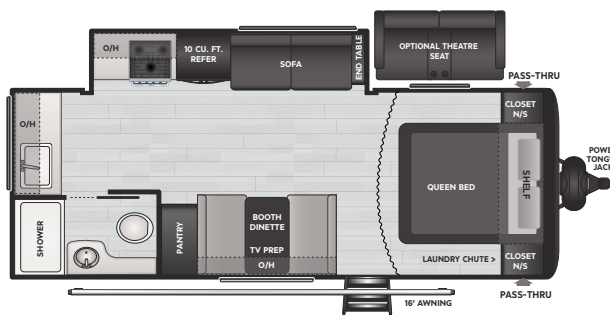

22MLSWE | WEIGHT **5490** | LENGTH **26' 4"**

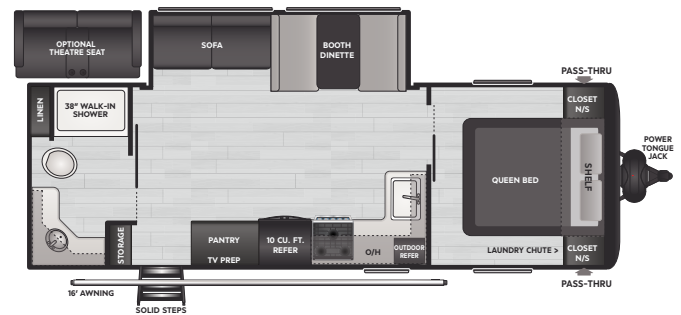

24RBSWE | WEIGHT **6130** | LENGTH **28' 11"**

VISIT OUR WEBSITE FOR PHOTOS,
360° TOURS, AND FULL PRODUCT DETAILS



HIDEOUT TRAVEL TRAILERS

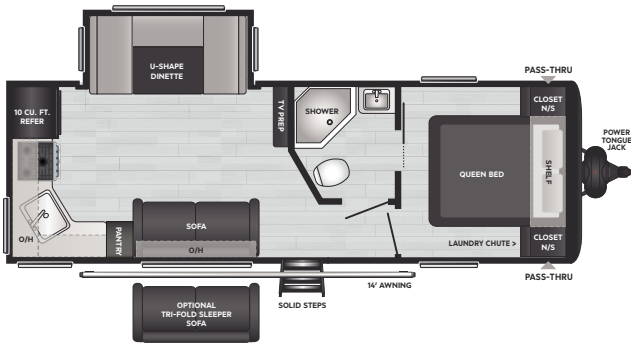

24RKSWE | WEIGHT **5980** | LENGTH **28' 11"**

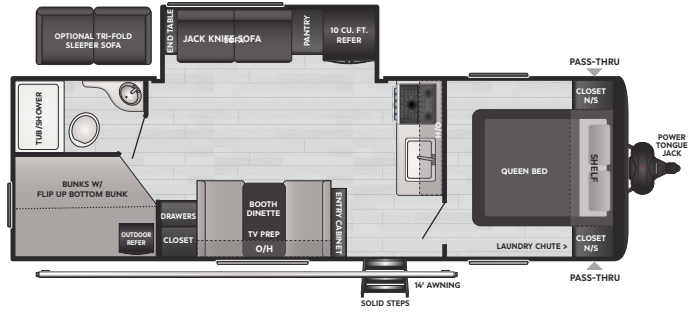

25BHSWE | WEIGHT **6250** | LENGTH **29' 5"**

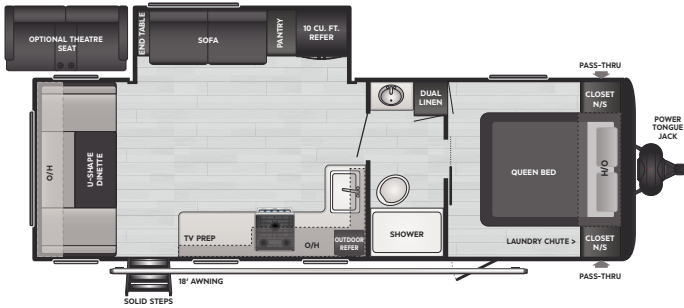

25RDSWE | WEIGHT **6240** | LENGTH **29' 5"**

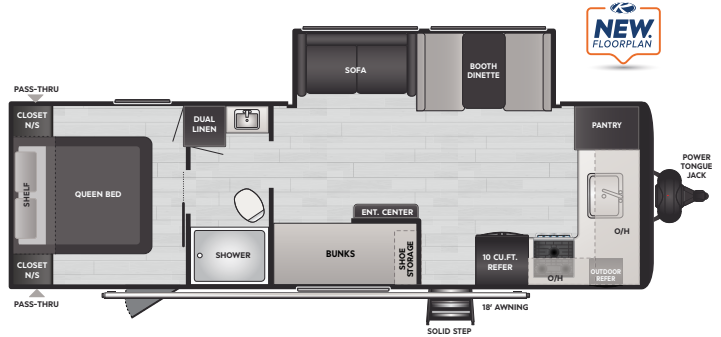

26FKSWE | WEIGHT **TBD** | LENGTH **TBD**

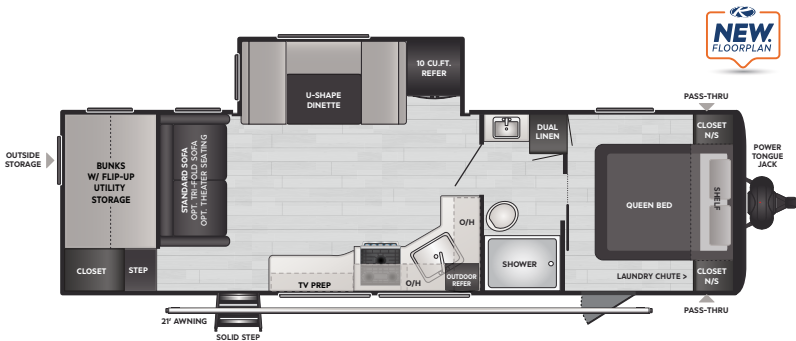

28BUSWE | WEIGHT **TBD** | LENGTH **TBD**

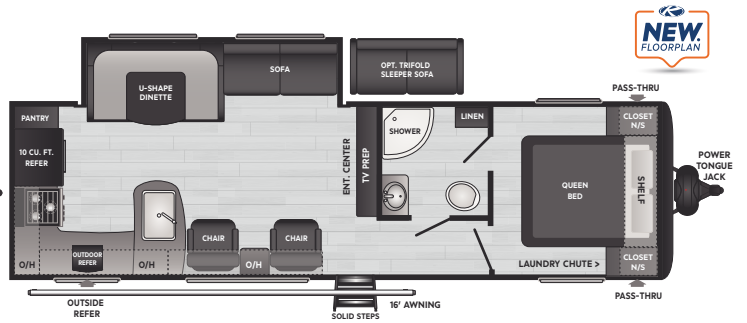

28RKSWE | WEIGHT **6895** | LENGTH **33' 1"**

KEYSTONE OWNER'S SUPPORT

Keystone makes operating and maintaining your new RV easy with world-class resources and support. Owners have access to a wide variety of support tools and services via the MyKeystone mobile app and the Owner's section of KeystoneRV.com.

FIRST TIME CAMPER'S VIDEO SERIES

A comprehensive guide to RV camping basics with Keystone's Matt & Bart.

PRO TIPS DIY OPERATION & MAINTENANCE VIDEO LIBRARY

Visit our growing collection of step-by-step video and written guides to operating, maintaining, and repairing your Keystone RV.

DIGITAL OWNER'S MANUAL

Our new online owner's manual is fully searchable and features helpful visual and video support.

DIY REPAIR PROGRAM*

Which includes free parts for small repairs within your first year of ownership

1-YEAR LIMITED BASE WARRANTY*

3-YEAR LIMITED STRUCTURAL WARRANTY*

*See KeystoneRV.com for full details. PRO TIP: Owners should work with their dealers or other Keystone authorized service center or mobile tech to document all warranty claims within the warranty period.

HIDEOUT SPECIFICATIONS

MODEL	WEIGHT	CARRYING CAPACITY	HITCH WEIGHT	FRESH WATER**	WASTE WATER	GRAY WATER	LPG	LENGTH*	WIDTH	HEIGHT	AWNING
175BH	3170	1215	385	21	30	30	20	20' 6"	8'	10' 2"	10'
176BH	3810	690	520	21	30	30	20	21' 5"	8'	10' 2"	10'
177RD	3522	878	540	21	30	30	20	21' 5"	8'	10' 2"	10'
178RB	3040	1360	440	21	30	30	20	20' 11"	8'	10' 2"	10'
179RB	3753	727	480	21	32	30	20	21' 5"	8'	10' 2"	10'
181BH	4515	585	595	21	30	60	20	22' 9"	8'	10' 4"	15'
186SS	4374	726	610	21	30	30	20	22' 10"	8'	10' 4"	14'
201BH	4266	1734	565	21	30	30	20/30 opt	22' 9"	8'	10' 5"	15'
200RLWE	TBD	TBD	TBD	54	38	38	40	25' 1"	8'	11' 0"	12'
240BHWE	5010	2590	680	54	39	78	60	28' 10"	8'	11' 0"	12'
241DBWE	TBD	TBD	TBD	TBD	TBD	TBD	TBD	TBD	TBD	TBD	TBD
261BHWE	TBD	TBD	TBD	54	39	78	40	30' 8"	8'	11' 1"	16'
269DBWE	TBD	TBD	TBD	TBD	TBD	TBD	TBD	TBD	TBD	TBD	TBD
291BRWE	TBD	TBD	TBD	TBD	TBD	TBD	TBD	TBD	TBD	TBD	TBD
22MLSWE	5490	2010	690	54	38	38	60	26' 4"	8'	11' 1"	16'
24RBSWE	6130	1520	650	54	38	38	60	28' 11"	8'	11' 1"	18'
24RKSWE	5980	1820	800	54	38	80	60	28' 10"	8'	11' 2"	14'
25BHSWE	6250	1390	640	54	38	38	60	29' 11"	8'	11' 1"	16'
25RDSWE	6240	1360	740	54	38	38	60	29' 5"	8'	11' 1"	18'
26FKSWE	TBD	TBD	TBD	TBD	TBD	TBD	TBD	TBD	TBD	TBD	TBD
28BUSWE	TBD	TBD	TBD	TBD	TBD	TBD	TBD	TBD	TBD	TBD	TBD
28RKSWE	6895	2645	740	54	38	76	60	33' 1"	8'	11' 1"	16'

SOLARTM FLEX



NEW 2024 PACKAGE UPDATES

For more information scan the QR code
or visit keystonerv.com.

TAKE CHARGE OF HOW YOU CAMP

EXCEPTIONAL QUALITY, IMPOSSIBLY VERSATILE, SolarFlexTM
IS SHATTERING CUSTOMER'S EXPECTATIONS OF FACTORY-INSTALLED SOLAR POWER.
EXCLUSIVELY AVAILABLE ON ALL KEYSTONE RV MODELS.



Keystone RV is proud to partner with Dragonfly Energy to offer their legendary heated Lithium-ion batteries exclusively on all Keystone models.



FOLLOW US FOR THE LATEST!



DISCLAIMER: Product information is as accurate as possible as of the date of publication of this brochure. All features, floor plans, and specifications in this brochure are subject to change without notice. Please also consult Keystone's web site at www.keystonerv.com for more current product information and specifications. Tow Vehicle Disclaimer. CAUTION: Owners of Keystone recreational vehicles are solely responsible for the selection and proper use of tow vehicles. All customers should consult with a motor vehicle manufacturer or their dealer concerning the purchase and use of suitable tow vehicles for Keystone products. Keystone disclaims any liability or damages suffered as a result of the selection, operation, use or misuse of a tow vehicle. KEYSTONE'S LIMITED WARRANTY DOES NOT COVER DAMAGE TO THE RECREATIONAL VEHICLE OR THE TOW VEHICLE AS A RESULT OF THE SELECTION, OPERATION, USE OR MISUSE OF THE TOW VEHICLE. *Length is defined as the distance from the centerline of hitch pin/coupler to rear bumper of trailer. ** Fresh water capacity includes water heater. Please review owner's manual prior to purchase for more information on service warranties, extended use, towing and maintenance. Owner's manuals can be found at keystonerv.com.

PRINT 10.2023