

2024 ENTEGRA COACH QWEST SE

Qwest SE

DIESEL CLASS C MOTORHOME



ENTEGRA
COACH®





ENTEGRACOACH®

2024 Qwest SE

24L

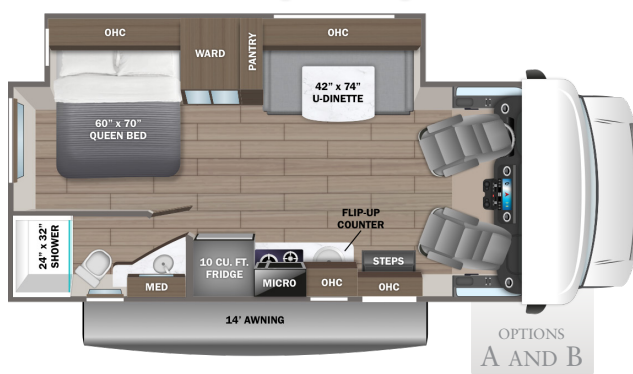

24R

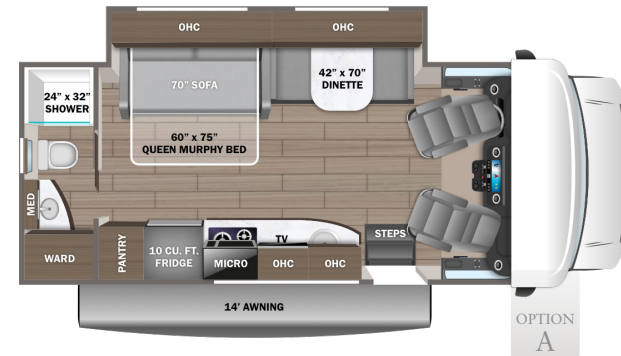

24T

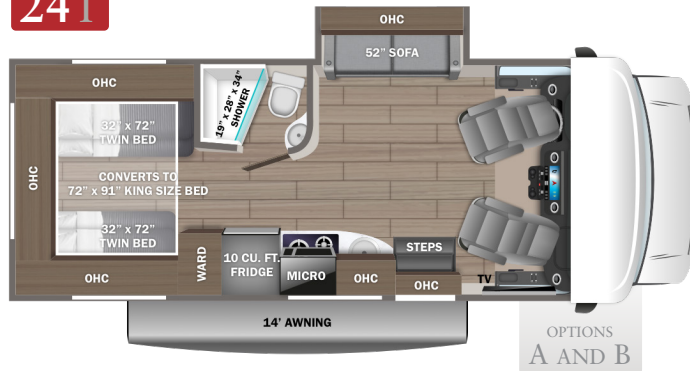

OPTIONS

A



Theater Sofa Option

B



Entertainment Center with Overhead Storage Option

EXTERIOR SELECTIONS



Standard Graphics



Optional Partial Paint

CUSTOMER VALUE PACKAGE

- One-piece, seamless, fiberglass front cap
- Frameless windows
- Heated holding tanks (12V pads)
- Heated, remote-controlled, side-view mirrors
- Electric patio awning with LED lights
- Backup and side-view cameras
- Keyless cab entry
- 7 in. integrated Mercedes-Benz® MBUX infotainment center with GPS, Apple® CarPlay™ and Android Auto™
- Swivel driver and passenger seats

CHASSIS

- Mercedes-Benz® 3500 chassis with 170 in. wheelbase
- GVWR- 11,030 lb.
- GCWR- 15,250 lb.
- 2L V4 Twin Turbo 211HP diesel engine with electronic fuel injection with 332 ft.-lb. torque
- 9-speed automatic transmission
- 220-amp alternator
- E-rated highway tires- 215/85R16
- Front and rear disc, 4-wheel anti-lock brakes
- 5,000 lb. rear hitch receiver with dual connector 7-pin plug
- 12V chassis battery
- 26.4 gal. fuel tank
- 5.8 gal. DEF tank

EXTERIOR

- TuffShell™ vacuum-bond laminated roof, floor and sidewalls
- Bead-foam insulation (R-24 max roof, R-9 max floor, R-5 max walls)
- TPO laminated roof
- Fiberglass running boards
- Fiberglass exterior walls with vinyl graphics
- Electric stabilizer jacks
- Slideout awning(s)
- Entrance door with industry's largest travel-view window
- Electric-powered entrance step with integrated house battery compartment
- Third brake light
- 4 in. bumper tube with sewer hose storage
- Prep for satellite dish
- Cable TV hookup with RG-6 coax

- Digital antenna with signal booster
- Onan® 3,600W LP generator
- Solar prep
- 12V house battery
- Transfer switch with reverse polarity protection
- 30-amp electrical service
- 12.2 gal. propane tank (41 lb.)
- LP quick-connect hookup
- Exterior utility center
- Winterization drain system
- Black tank flush
- Outside shower
- 12V demand water pump
- Water filtration system
- Winegard 2.0 Wi-Fi/4G antenna
- Onan® 3,600W LP generator with auto gen start
- 200W solar panel with dual controller
- 1,000W inverter
- (2) 12V house batteries
- Transfer switch with reverse polarity protection
- 30-amp electrical service
- 12.2 gal. propane tank (41 lb.)
- LP quick-connect hookup
- Exterior utility center
- Winterization drain system
- Black tank flush
- Outside shower
- 12V demand water pump
- Water filtration system

COCKPIT

- Tilt steering wheel
- Power windows and door locks
- Cruise control
- Crosswind assist
- Hill start assist
- Attention assist
- Brake Assist Plus
- Breakdown management
- Emergency call system
- Headlight assistant
- Auxiliary start switch
- Driver and passenger airbags
- Privacy curtain for cab area
- Overhead bunk with 750 lb. capacity

INTERIOR

- 83 in. interior ceiling height with padded vinyl ceiling
- High-intensity, LED ceiling lights
- LED-lit slideout fascia
- Hardwood cabinet doors and drawer fronts
- Ball-bearing drawer guides
- Pleated blackout shades
- 13,500 BTU A/C
- 30,000 BTU auto-ignition ducted furnace
- 6 gal. gas/electric water heater and water heater bypass
- Powered roof vent in living area with wall switch
- Entegra-exclusive, easy-operation legless dinette table (24R)
- U-shaped dinette with stow away pedestal legs (24L)
- 12V USB charging station in dinette area
- 2-point lap safety belts in all designated seating locations
- Car seat tethers (select floorplans)
- LED HD Smart TV
- Smoke alarm
- Carbon monoxide detector
- Fire extinguisher

KITCHEN

- 10 cu. ft. 12V refrigerator
- 2-burner, drop-in cooktop with flush cover
- Convection microwave
- Stainless steel sink with wooden cover/cutting board
- LED-lit pressed countertops
- Flip-up countertop extension (select models)
- Decorative kitchen backsplash

BEDROOM

- Queen-size bed with bedspread (24L)
- Queen-size power Murphy bed (24R)
- (2) twin-size beds with filler cushion converts to king-size bed (24T)
- USB port(s) in bedroom
- Bedroom TV prep
- Large wardrobes

BATHROOM

- Shower with decorative surround and skylight
- Stainless steel bathroom sink
- Toilet with foot flush
- Powered roof vent in bathroom with wall switch

OPTIONS

- Premium Mercedes chassis - includes active brake assist, chrome grill package, adaptive cruise control, heated captain's seats, smartphone tray with wireless charging, upgraded lighting package, rain-sensing wiper system, leather steering wheel, lane-keeping assist and traffic sign assist.
- Front entertainment center with 32 in. LED HD Smart TV
- 3,200W diesel generator
- Folding windshield sun shade
- 4-point hydraulic leveling jacks
- Theater seating ILO dinette (24L, 24R)
- 200W solar panel with dual controller and second house battery

WARRANTY



NO ONE OFFERS A BETTER WARRANTY

At Entegra Coach, we build our RVs to handle every adventure, then back them with our industry-leading 2+3 limited warranty. Our 2-year limited warranty has you covered for 2 camping seasons. That's 730 days. In addition, our 3-year structural limited warranty has you covered for 3 camping seasons or 1,095 days. You won't find a better limited warranty in the business, because the only strings we attach are those that deliver the ultimate in reliability. For a copy of our 2-year limited + 3-year structural limited warranty with complete terms and conditions, please contact your local Entegra Coach dealer.

| Floorplan | GVWR (lbs.) | GCWR (lbs.) | Wheel Base | Overall Length | Exterior Height w/ A/C & Satellite | Exterior Width | Interior Height | Fresh Water Capacity (gal.) | Grey Waste Water Capacity (gal.) | Black Waste Water Capacity (gal.) |
|-----------|-------------|-------------|------------|----------------|------------------------------------|----------------|-----------------|-----------------------------|----------------------------------|-----------------------------------|
| 24L | 11,030 | 15,250 | 170.3 | 25' 0" | 11' 5" | 96 | 83 | 43 | 31 | 31 |
| 24R | 11,030 | 15,250 | 170.3 | 25' 0" | 11' 5" | 96 | 83 | 35 | 31 | 31 |
| 24T | 11,030 | 15,250 | 170.3 | 25' 0" | 11' 5" | 96 | 83 | 43 | 31 | 31 |

It is important for your safety and enjoyment that you are aware of the weights and tow ratings of the RV you select. Consult a competent advisor for questions or advice. Whether you are new to RVing or a veteran, get a feel for the performance of your RV before heading out on the roadways. When you tow a vehicle with your RV, you must drive differently than when you drive a single vehicle. Practice hooking up, driving, backing up and braking in a safe environment or seek out professional instruction. Jayco affixes a weight label to each RV which lists weight information for that vehicle. Refer to that label to verify the vehicle will meet your requirements. Gross Vehicle Weight Rating (GVWR): The maximum permissible weight of the motorhome, including the Unloaded Vehicle Weight (UVW) plus passengers, personal items, all cargo, fluids, options and dealer-installed accessories. The GVWR is equal to or greater than the sum of the UVW and the Cargo Carrying Capacity. Gross Combined Weight Rating (GCWR): The maximum allowable combined weight of the motorhome used as a tow vehicle and the attached towed vehicle.



Part of Jayco Family of Companies

Entegra Coach, Inc., P.O. Box 460, Middlebury, IN 46540, www.entegracoach.com. See dealer for further information and prices. All information in this brochure is the latest available at the time of publication approval. Entegra Coach reserves the right to make changes and to discontinue models without notice or obligation. Photos in this brochure may show optional equipment and props for photography purposes. RVs built for sale in Canada may differ to conform to Canadian codes. ©2023 Entegra Coach, Inc. Printed in U.S.A. 2032828.2024



entegracoach.com/qwest