

COUGAR

FIFTH WHEELS / TRAVEL TRAILERS



KEYSTONE
RV COMPANY

CAMP BETTER
KINDNESS · COMMUNITY · PLANET

A N A M E R I C A N I C O N

Step into the legacy of RVing with the iconic Keystone Cougar. Our 2024 collection invites you to join generations of campers who have trusted Cougar as their choice for extraordinary journeys. With a range that includes fifth wheels, half-ton fifth wheels, and travel trailers, Cougar stands as a leader in the industry, embodying not just a brand, but a tradition of innovation, style, and unforgettable experiences.

From winding trails to wide highways, Cougar has been there, evolving with the spirit of RVing leading the way with unparalleled comfort and unmatched quality. Join the ranks of those who have discovered the thrill of travel with Cougar RVs – where the past meets the future, and where every adventure becomes an extraordinary chapter in your own unique American story.

COUGAR EXCEPTIONAL FEATURES

- One-Piece Alpha Super Flex TPO Roof Membrane w/ Limited Lifetime Warranty
- Electric, 4-Point Auto Leveling System (OPTIONAL ON SELECT TRAVEL TRAILER MODELS)
- Lippert Road Armor™ Suspension & Pin Box (FIFTH WHEEL MODELS ONLY)
- Goodyear™ Endurance 10-Ply E-Rated Tires w/ Roadside Assistance (N/A SPORTS)
- Lippert Tire Linc TPMS Prep
- Climate Guard Four-Season Protection Package
- 30K BTU Gas Furnace
- Coleman-Mach Quiet Series 15K BTU Air Conditioner (N/A SPORTS)
- Coleman-Mach Quiet Series 13.5K Bedroom Air Conditioner (OPTIONAL ON SOME MODELS) (N/A SPORTS)
- Blade Pure™ High-Performance, Airflow System w/MERV 9 Filtration (N/A SPORTS)
- Giggy Box 12-Volt Distribution Center w/ Battery Disconnect
- Hyperdeck™ High-Performance, Water-Resistant RV Floors (HALF-TON FW & TT MODELS ONLY)
- NEW MORryde® Safe-T-Rail Entry Handle (FIFTH WHEEL MODELS ONLY) (N/A SPORTS)
- Lippert SolidStep® Entry Steps
- Lippert Entry Door Thin Shade
- Durable Rubber Flooring in Pass-Through Storage (FIFTH WHEELS MODELS ONLY)
- iN-Command® w/ Global Connect® Smart RV Control System (N/A SPORTS)
- Winegard Air 360+ Omni-Directional Rooftop Antenna w/ Exclusive Satellite Pass-Through
- Key TV Multi-Source Signal Controller
- Color-Coded & Numbered Wiring
- Girard Tankless On-Demand Water Heater
- Amy Gray Signature™ Interior Design
- **NEW** Luxe Driftwood Decor (SEE KEYSTONERV.COM FOR DETAILS)
- Heated & Massage Theater Seats (MOST MODELS)
- **NEW** Soft-Close Cabinet Doors
- Ceiling Fans (MOST FIFTH WHEEL MODELS)
- Black Out Roller Shades (MOST FIFTH WHEEL MODELS)
- Furrion 12V Refrigerator
- Furrion 21" Oven w/ 3-Burner Cooktop
- Outdoor Kitchen w/ Griddle (select models)
- Deeper Bed Slide w/ More Walkaround Space (FIFTH WHEEL MODELS ONLY)
- CPAP-Ready Nightstands (MOST MODELS)
- **NEW** Recessed Medicine Cabinet (SELECT MODELS)
- Stackable Washer and Dryer Prep (FULL SIZE MODELS ONLY)
- SolarFlex™ Protect 220, Discover 440i, and Outlast 660i-L Solar Power Systems w/ Optional Dragonfly Energy Lithium-ion Batteries
- 1-Year Limited Base Warranty & 3-Year Limited Structural Warranty (SEE KEYSTONERV.COM FOR DETAILS)



NEW
**MIDNIGHT
EDITION**
FULL BODY PAINT

Available on Premium Fifth Wheel Models
SEE KEYSTONERV.COM FOR FULL DETAILS.

PREMIUM FIFTH WHEELS

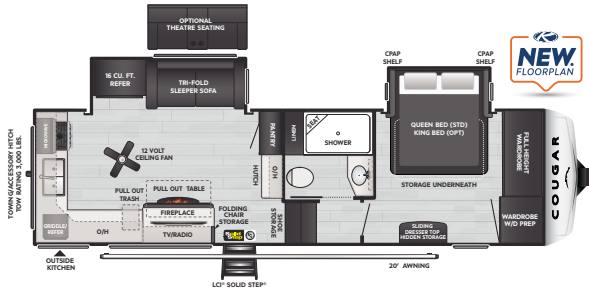

260MLE | WEIGHT 9575 | LENGTH 30' 11"

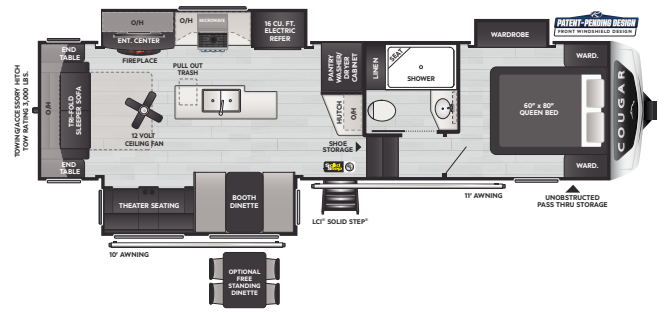

290RLS | WEIGHT 10124 | LENGTH 33' 8"

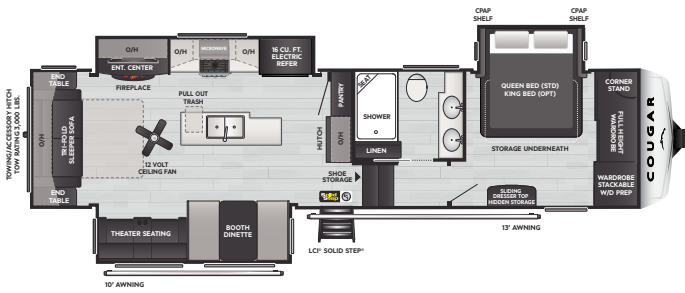

316RLS | WEIGHT 10679 | LENGTH 35' 8"

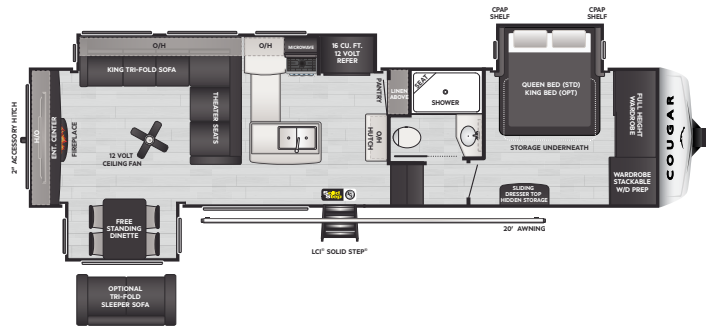

320RDS | WEIGHT 11133 | LENGTH 36' 10"

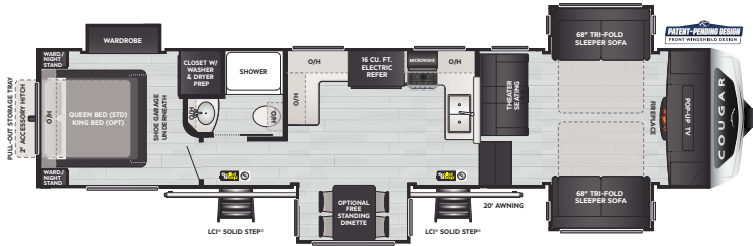

354FLS | WEIGHT 11041 | LENGTH 39' 2"

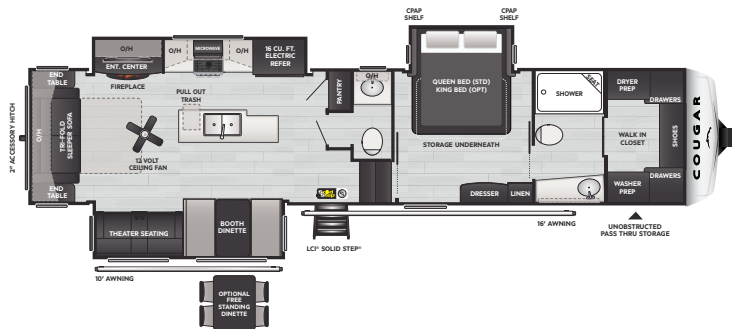

355FBS | WEIGHT 11357 | LENGTH 39' 3"

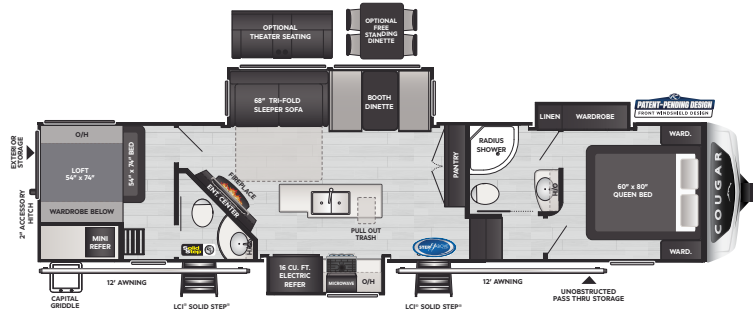

364BHL | WEIGHT 11404 | LENGTH 39' 0"

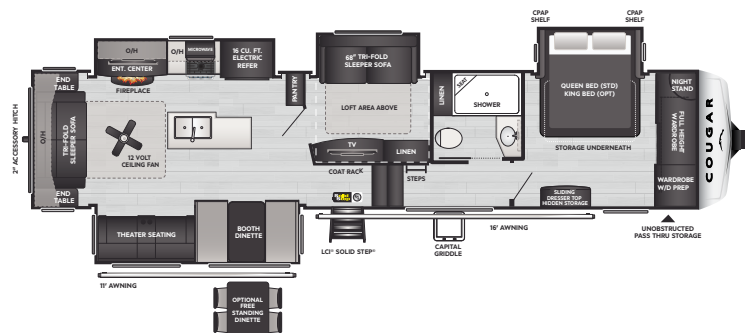

368MBI | WEIGHT 11847 | LENGTH 39' 3"

HALF-TON FIFTH WHEELS

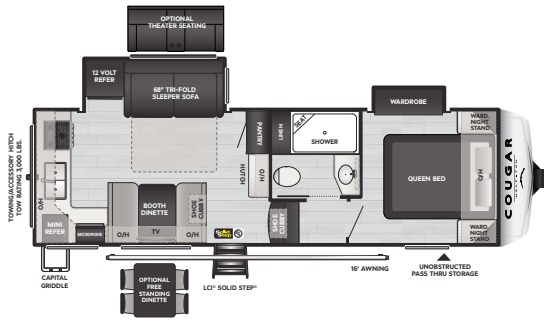

23MLE | WEIGHT 7678 | LENGTH 27' 11"

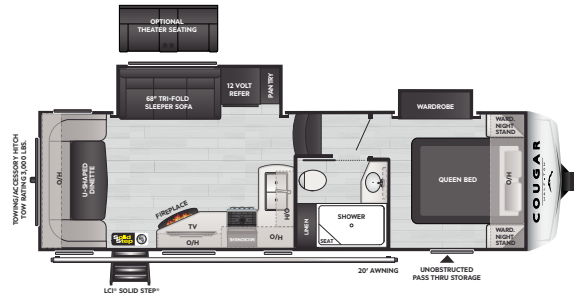

24RDS | WEIGHT 7612 | LENGTH 28' 10"

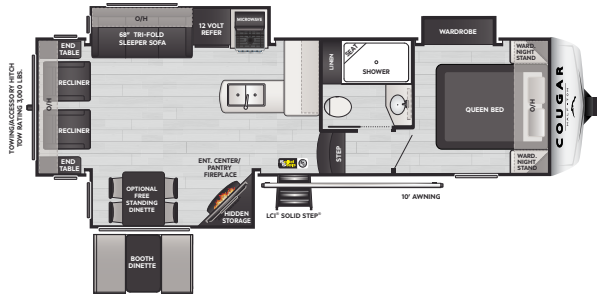

27SGS | WEIGHT 8211 | LENGTH 30' 6"

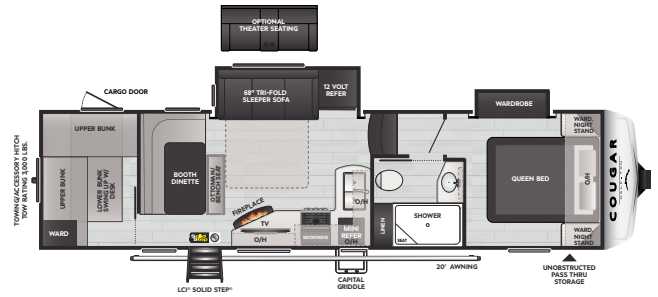

29BHL | WEIGHT 8345 | LENGTH 33' 4"

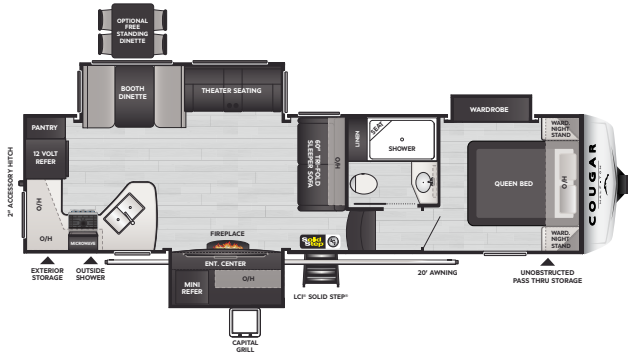

29RKS | WEIGHT 8958 | LENGTH 32' 9"

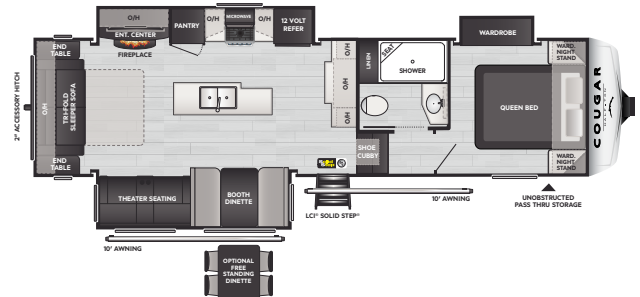

29RLI | WEIGHT 8893 | LENGTH 32' 9"

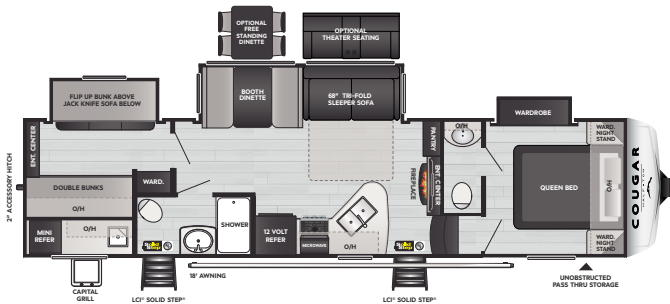

32BHS | WEIGHT 9428 | LENGTH 35' 8"

VISIT OUR WEBSITE FOR PHOTOS, 360° TOURS, AND FULL PRODUCT DETAILS



HALF-TON TRAVEL TRAILERS

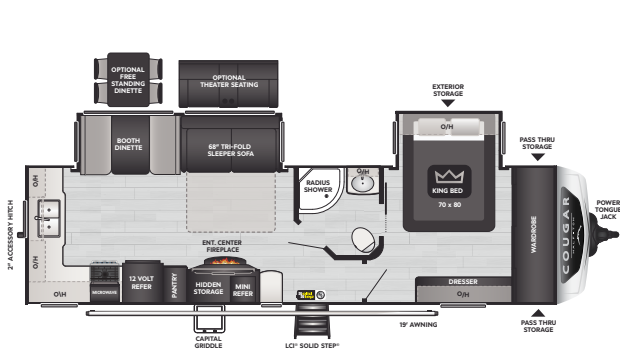

30RKD | WEIGHT **7772** | LENGTH **34' 9"**



33RLI | WEIGHT **8690** | LENGTH **37' 5"**

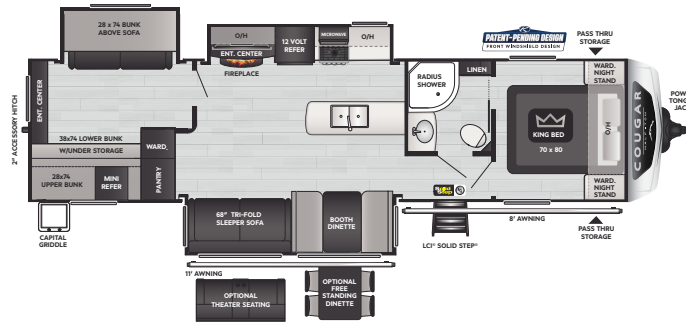

34TSB | WEIGHT **8678** | LENGTH **37' 5"**



INTRODUCING COUGAR SPORT

New high-spirited, ultra-affordable floorplans built for adventure and beyond.
SEE KEYSTONERV.COM FOR FULL PRODUCT DETAILS.

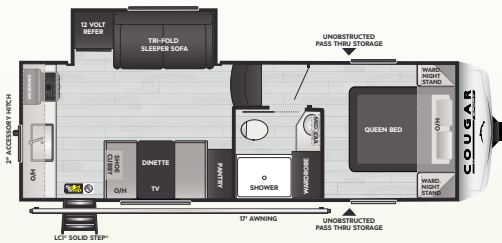

2100RK | WEIGHT **6815** | LENGTH **26' 3"**

SCAN HERE TO VIEW COUGAR SPORT FEATURES

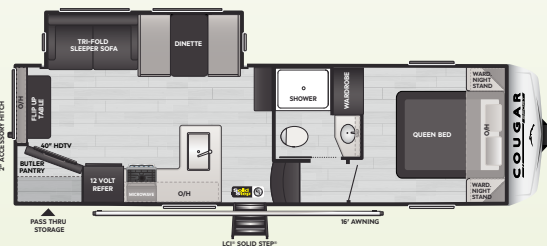

2400RE | WEIGHT **TBD** | LENGTH **28' 9"**

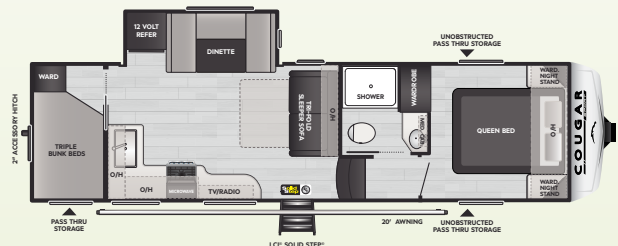

2700BH | WEIGHT **7580** | LENGTH **32' 3"**

COUGAR SPECIFICATIONS

MODEL	WEIGHT	CARRYING CAPACITY	HITCH WEIGHT	FRESH WATER**	WASTE WATER	GRAY WATER	LPG	LENGTH*	WIDTH	HEIGHT	AWNING
PREMIUM FW											
260MLE	9725	2275	1895	75	38	76	60	30' 11"	8'	13' 4"	20'
290RLS	10124	2776	1805	75	38	76	60	33' 8"	8'	13' 4"	11'/10'
316RLS	10679	1621	1900	75	38	76	60	35' 8"	8'	13' 4"	13'/10'
320RDS	11133	2617	1775	75	38	76	60	36' 10"	8'	13' 4"	20'
354FLS	11041	2959	2365	75	38	76	60	39' 2"	8'	13' 4'	20'
355FBS	11357	2543	1900	75	76	76	60	39' 3"	8'	13' 4'	16'/10'
364BHL	11404	2596	2200	75	76	76	60	39' 0"	8'	13' 5"	12'/12'
368MBI	11847	2133	1980	75	38	76	60	39' 3"	8'	13' 4"	16'/11'
HALF-TON FW											
23MLE	7678	2222	1200	54	30	60	60	27' 11"	8'	12' 0"	16'
24RDS	7612	2388	1430	54	30	60	60	28' 10"	8'	12' 7"	20'
27SGS	8211	2079	1495	54	30	60	60	30' 6"	8'	12' 7"	10'
29BHL	8345	2655	1610	54	30	60	60	33' 4"	8'	12' 8"	20'
29RKS	8958	1442	1605	54	30	60	60	32' 9"	8'	12' 7"	20'
29RLI	8893	2107	1630	54	30	60	60	32' 9"	8'	12' 8"	10'/10'
32BHS	9428	2072	1570	54	60	60	60	35' 8"	8'	12' 7"	18'
HALF-TON TT											
22RBS	5676	1524	755	54	30	30	60	25' 11"	8'	11' 5"	16'
22MLS	5887	1313	645	54	30	30	60	26' 10"	8'	11' 5"	18'
25FKD	TBD	TBD	TBD	54	30	60	60	29' 11"	8'	11' 5"	20'
25RDS	6419	2381	835	54	30	60	60	29' 10"	8'	11' 5"	19'
25MLE	6525	2275	695	54	30	60	60	29' 11"	8'	11' 5"	18'
26RBS	6796	2004	880	54	30	60	60	29' 11"	8'	11' 5"	20'
27BHS	7008	1992	730	54	30	60	60	31' 11"	8'	11' 3"	19'
30BHS	7285	2215	790	54	30	60	60	34' 5"	8'	11' 5"	19'
30RKD	7772	1728	955	54	30	60	60	34' 9"	8'	11' 5"	19'
33RLI	8690	1810	1215	54	30	60	60	37' 5"	8'	11' 4"	14'/10'
34TSB	8678	1822	1150	54	30	60	60	37' 5"	8'	11' 4"	8'/11'
SPORT FW											
2100RK	6815	1685	1120	54	30	60	60	26' 3"	8'	12' 0"	17'
2400RE	TBD	TBD	TBD	54	30	60	60	28' 9"	8'	12' 7"	16'
2700BH	7580	1920	1390	54	30	60	60	32' 3"	8'	12' 7"	20'



"We recently upgraded to a Keystone Cougar travel trailer and have been very pleased with it. It is roomy and very functional and it is clear that a lot of attention to detail went into designing and building the trailer. It has many thoughtful features throughout that make it a pleasure to stay in and use. Everything is well laid out and very convenient to access. It has all the latest available technology and it all works together very well to provide a great experience."

— RODRIGO **COUGAR 33RLI** OWNER

SOLAR FLEX™



NEW 2024 PACKAGE UPDATES

For more information scan the QR code or visit keystonerv.com.

TAKE CHARGE OF HOW YOU CAMP

EXCEPTIONAL QUALITY, IMPOSSIBLY VERSATILE, SolarFlex™ IS SHATTERING CUSTOMER'S EXPECTATIONS OF FACTORY-INSTALLED SOLAR POWER. EXCLUSIVELY AVAILABLE ON ALL KEYSTONE RV MODELS.



Keystone RV is proud to partner with Dragonfly Energy to offer their legendary heated Lithium-ion batteries exclusively on all Keystone models.



FOLLOW US FOR THE LATEST!



DISCLAIMER: Product information is as accurate as possible as of the date of publication of this brochure. All features, floor plans, and specifications in this brochure are subject to change without notice. Please also consult Keystone's web site at www.keystonerv.com for more current product information and specifications. Tow Vehicle Disclaimer. CAUTION: Owners of Keystone recreational vehicles are solely responsible for the selection and proper use of tow vehicles. All customers should consult with a motor vehicle manufacturer or their dealer concerning the purchase and use of suitable tow vehicles for Keystone products. Keystone disclaims any liability or damages suffered as a result of the selection, operation, use or misuse of a tow vehicle. KEYSTONE'S LIMITED WARRANTY DOES NOT COVER DAMAGE TO THE RECREATIONAL VEHICLE OR THE TOW VEHICLE AS A RESULT OF THE SELECTION, OPERATION, USE OR MISUSE OF THE TOW VEHICLE. *Length is defined as the distance from the centerline of hitch pin/coupler to rear bumper of trailer. ** Fresh water capacity includes water heater. Please review owner's manual prior to purchase for more information on service warranties, extended use, towing and maintenance. Owner's manuals can be found at keystonerv.com.

PRINT 10.2023

COUGAR

FIFTH WHEELS / TRAVEL TRAILERS

WESTERN EDITION



KEYSTONE
RV COMPANY

CAMP BETTER
KINDNESS · COMMUNITY · PLANET

A N A M E R I C A N I C O N

Step into the legacy of RVing with the iconic Keystone Cougar. Our 2024 collection invites you to join generations of campers who have trusted Cougar as their choice for extraordinary journeys. With a range that includes fifth wheels, half-ton fifth wheels, and travel trailers, Cougar stands as a leader in the industry, embodying not just a brand, but a tradition of innovation, style, and unforgettable experiences.

From winding trails to wide highways, Cougar has been there, evolving with the spirit of RVing leading the way with unparalleled comfort and unmatched quality. Join the ranks of those who have discovered the thrill of travel with Cougar RVs – where the past meets the future, and where every adventure becomes an extraordinary chapter in your own unique American story.

COUGAR EXCEPTIONAL FEATURES

- One-Piece Alpha Super Flex TPO Roof Membrane w/ Limited Lifetime Warranty
- Electric, 4-Point Auto Leveling System (OPTIONAL ON SELECT TRAVEL TRAILER MODELS)
- Lippert Road Armor™ Suspension & Pin Box (FIFTH WHEEL MODELS ONLY)
- Goodyear™ Endurance 10-Ply E-Rated Tires w/ Roadside Assistance (N/A SPORTS)
- Lippert Tire Linc TPMS Prep
- Climate Guard Four-Season Protection Package
- 30K BTU Gas Furnace
- Coleman-Mach Quiet Series 15K BTU Air Conditioner (N/A SPORTS)
- Coleman-Mach Quiet Series 13.5K Bedroom Air Conditioner (OPTIONAL ON SOME MODELS) (N/A SPORTS)
- Blade Pure™ High-Performance, Airflow System w/MERV 9 Filtration (N/A SPORTS)
- Giggy Box 12-Volt Distribution Center w/ Battery Disconnect
- Hyperdeck™ High-Performance, Water-Resistant RV Floors (HALF-TON FW & TT MODELS ONLY)
- NEW MORryde® Safe-T-Rail Entry Handle (FIFTH WHEEL MODELS ONLY) (N/A SPORTS)
- Lippert SolidStep® Entry Steps
- Lippert Entry Door Thin Shade
- Durable Rubber Flooring in Pass-Through Storage (FIFTH WHEELS MODELS ONLY)
- iN-Command® w/ Global Connect® Smart RV Control System (N/A SPORTS)
- Winegard Air 360+ Omni-Directional Rooftop Antenna w/ Exclusive Satellite Pass-Through
- Key TV Multi-Source Signal Controller
- Color-Coded & Numbered Wiring
- Girard Tankless On-Demand Water Heater
- Amy Gray Signature™ Interior Design
- **NEW** Luxe Driftwood Decor (SEE KEYSTONERV.COM FOR DETAILS)
- Heated & Massage Theater Seats (MOST MODELS)
- **NEW** Soft-Close Cabinet Doors
- Ceiling Fans (MOST FIFTH WHEEL MODELS)
- Black Out Roller Shades (MOST FIFTH WHEEL MODELS)
- Furrion 12V Refrigerator
- Furrion 21" Oven w/ 3-Burner Cooktop
- Outdoor Kitchen w/ Griddle (select models)
- Deeper Bed Slide w/ More Walkaround Space (FIFTH WHEEL MODELS ONLY)
- CPAP-Ready Nightstands (MOST MODELS)
- **NEW** Recessed Medicine Cabinet (SELECT MODELS)
- Stackable Washer and Dryer Prep (FULL SIZE MODELS ONLY)
- SolarFlex™ Protect 220, Discover 440i, and Outlast 660i-L Solar Power Systems w/ Optional Dragonfly Energy Lithium-ion Batteries
- 1-Year Limited Base Warranty & 3-Year Limited Structural Warranty (SEE KEYSTONERV.COM FOR DETAILS)



NEW
**MIDNIGHT
EDITION** 
FULL BODY PAINT

Available on Premium Fifth Wheel Models
SEE KEYSTONERV.COM FOR FULL DETAILS.

HALF-TON FIFTH WHEELS

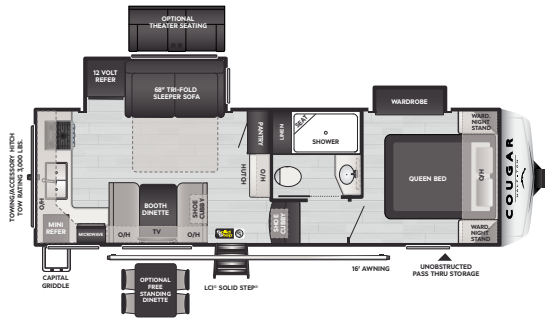

23MLE | WEIGHT 7678 | LENGTH 27' 11"

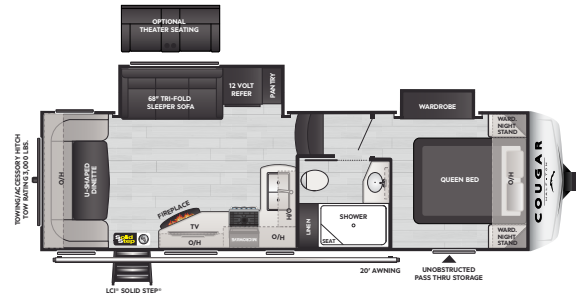

24RDS | WEIGHT 7612 | LENGTH 28' 10"

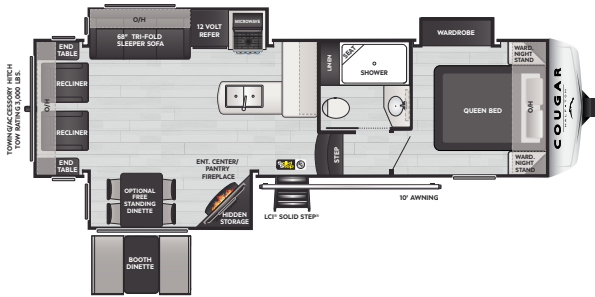

27SGS | WEIGHT 8211 | LENGTH 30' 6"

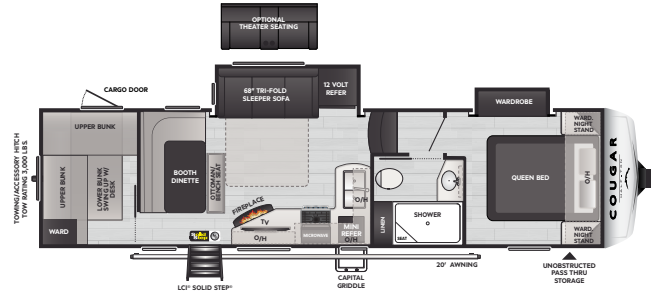

29BHL | WEIGHT 8345 | LENGTH 33' 4"

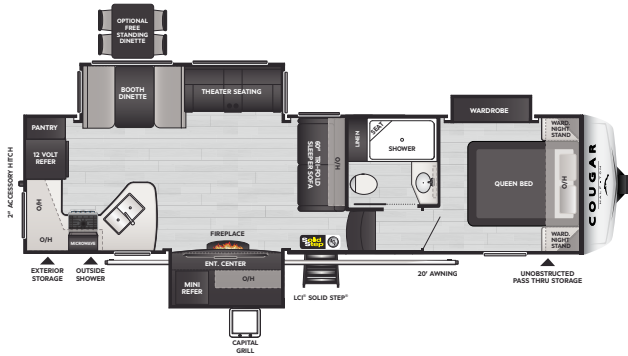

29RKS | WEIGHT 8958 | LENGTH 32' 9"

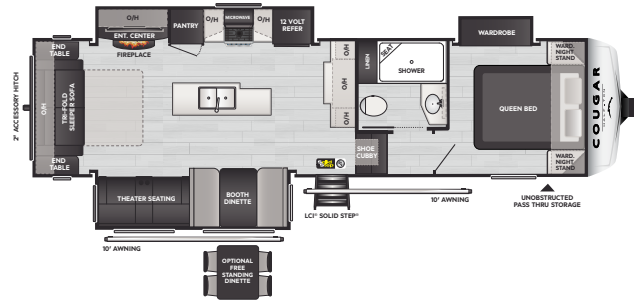

29RLI | WEIGHT 8893 | LENGTH 32' 9"

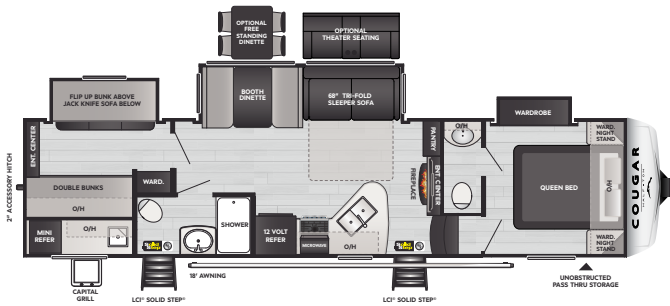

32BHS | WEIGHT 9428 | LENGTH 35' 8"

VISIT OUR WEBSITE FOR PHOTOS, 360° TOURS, AND FULL PRODUCT DETAILS



HALF-TON TRAVEL TRAILERS

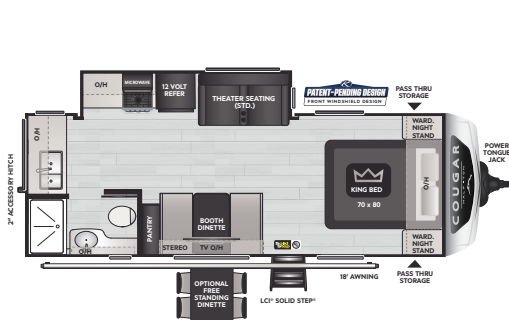

22MLSWE | WEIGHT **5880** | LENGTH **26' 10"**

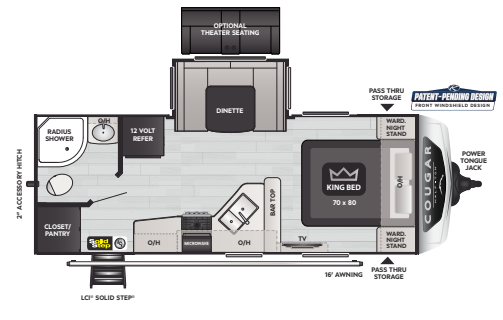

22RBSWE | WEIGHT **5648** | LENGTH **25' 11"**

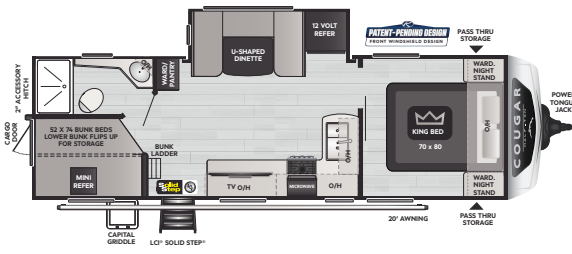

25DBSWE | WEIGHT **6287** | LENGTH **29' 10"**

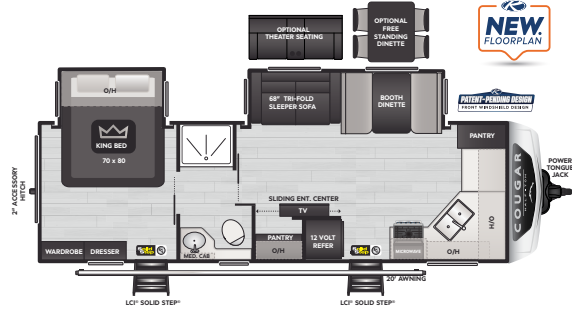

25FKDWE | WEIGHT **TBD** | LENGTH **29' 11"**

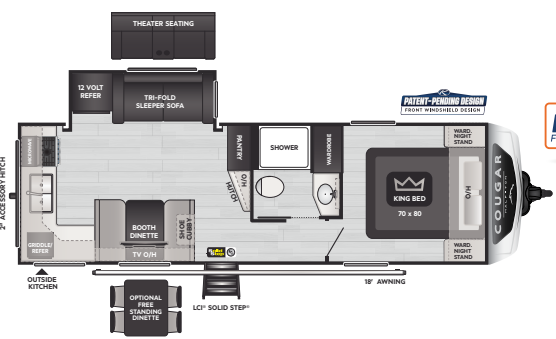

25MLEWE | WEIGHT **TBD** | LENGTH **29' 11"**

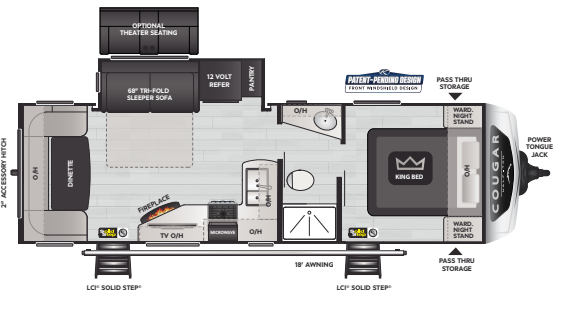

25RDSWE | WEIGHT **6361** | LENGTH **29' 10"**

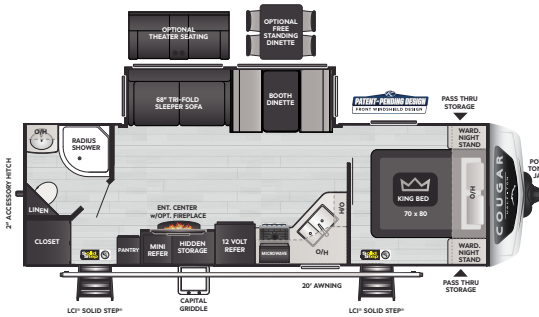

26RBSWE | WEIGHT **6796** | LENGTH **29' 11"**

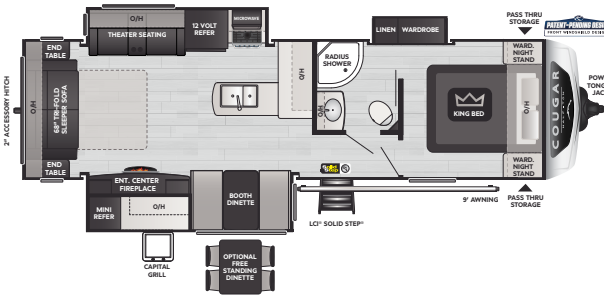

29RLKWE | WEIGHT **7798** | LENGTH **33' 3"**

HALF-TON TRAVEL TRAILERS

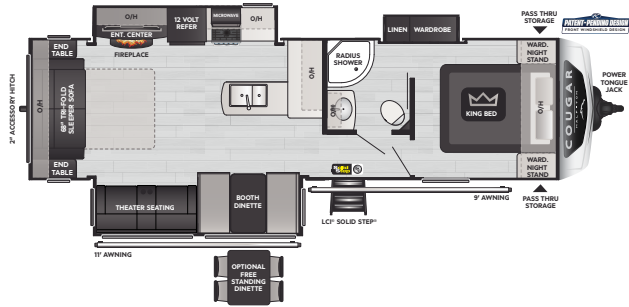

29RLSW | WEIGHT 7611 | LENGTH 33' 3"

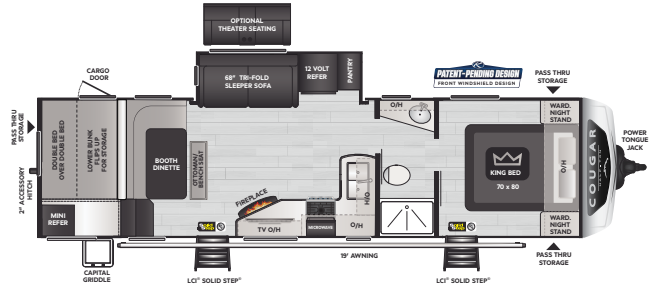

30BHSW | WEIGHT 7282 | LENGTH 34' 5"

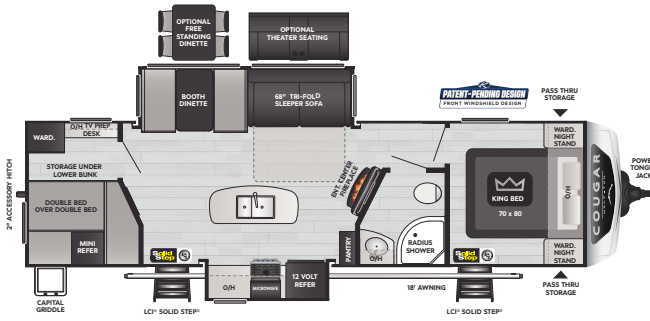

31BHKW | WEIGHT 7697 | LENGTH 34' 9"

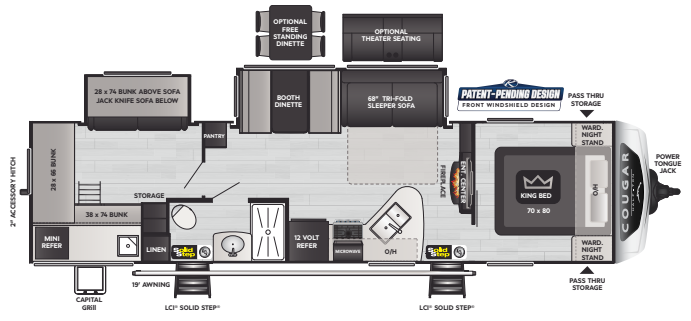

32RDBW | WEIGHT 8087 | LENGTH 36' 4"

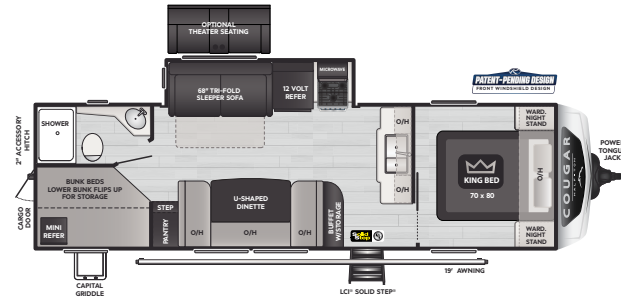

27BHS | WEIGHT 7008 | LENGTH 31' 11"

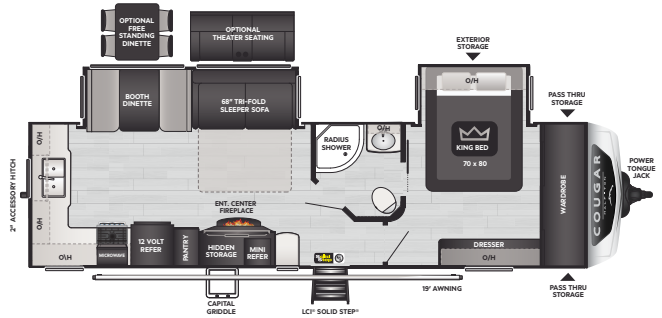

30RKD | WEIGHT 7772 | LENGTH 34' 9"

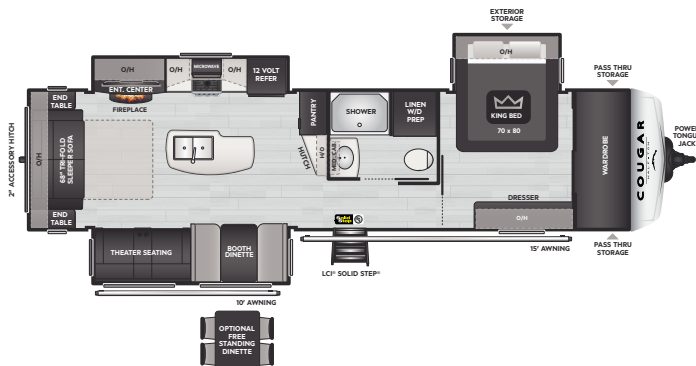

33RLI | WEIGHT 8690 | LENGTH 37' 5"



34TSB | WEIGHT 8678 | LENGTH 37' 5"

INTRODUCING COUGAR SPORT

New high-spirited, ultra-affordable floorplans built for adventure and beyond.

SEE KEYSTONERV.COM FOR FULL PRODUCT DETAILS.

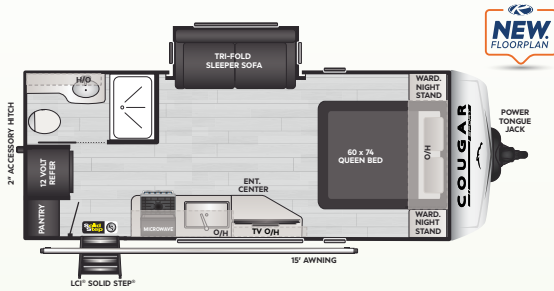

NEW FLOORPLAN

SCAN HERE
TO VIEW COUGAR
SPORT FEATURES



1900RBWE | WEIGHT TBD | LENGTH 23' 8"

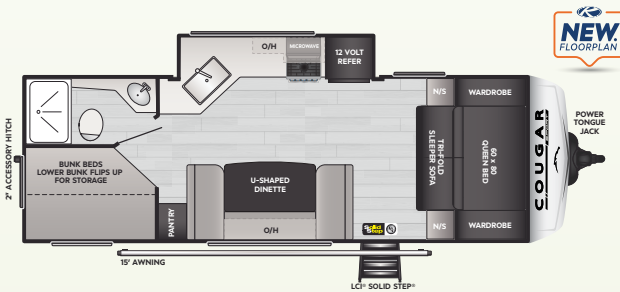

NEW FLOORPLAN

2300BHWE | WEIGHT TBD | LENGTH TBD

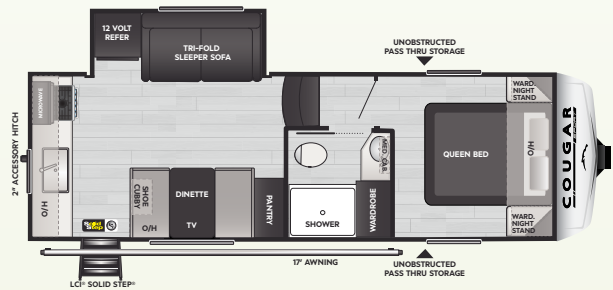

2100RK | WEIGHT 6815 | LENGTH 26' 3"

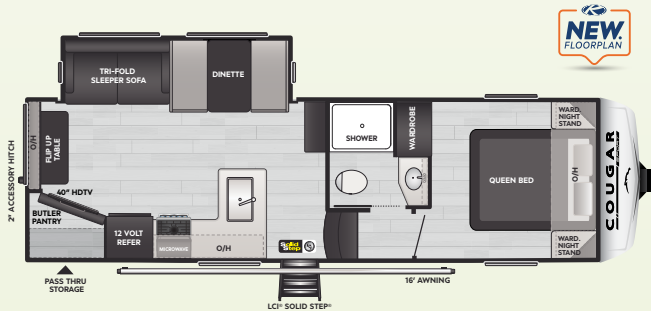

NEW FLOORPLAN

2400RE | WEIGHT TBD | LENGTH 28' 9"

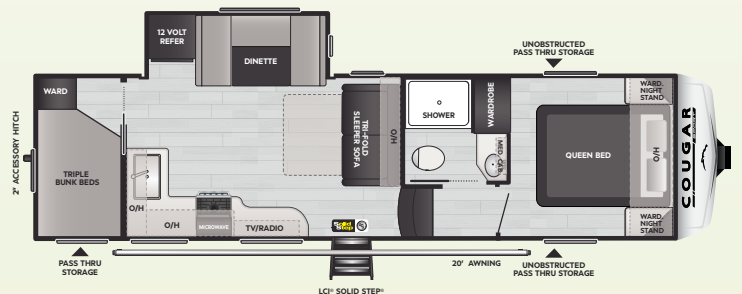

2700BH | WEIGHT 7580 | LENGTH 32' 3"



"We recently upgraded to a Keystone Cougar travel trailer and have been very pleased with it. It is roomy and very functional and it is clear that a lot of attention to detail went into designing and building the trailer. It has many thoughtful features throughout that make it a pleasure to stay in and use. Everything is well laid out and very convenient to access. It has all the latest available technology and it all works together very well to provide a great experience."

— RODRIGO COUGAR 33RLI OWNER

COUGAR SPECIFICATIONS

MODEL	WEIGHT	CARRYING CAPACITY	HITCH WEIGHT	FRESH WATER**	WASTE WATER	GRAY WATER	LPG	LENGTH*	WIDTH	HEIGHT	AWNING
PREMIUM FW											
260MLE	9725	2275	1895	75	38	76	60	30' 11"	8'	13' 4"	20'
290RLS	10124	2776	1805	75	38	76	60	33' 8"	8'	13' 4"	11'/10'
316RLS	10679	1621	1900	75	38	76	60	35' 8"	8'	13' 4"	13'/10'
320RDS	11133	2617	1775	75	38	76	60	36' 10"	8'	13' 4"	20'
354FLS	11041	2959	2365	75	38	76	60	39' 2"	8'	13' 4'	20'
355FBS	11357	2543	1900	75	76	76	60	39' 3"	8'	13' 4'	16'/10'
364BHL	11404	2596	2200	75	76	76	60	39' 0"	8'	13' 5"	12'/12'
368MBI	11847	2133	1980	75	38	76	60	39' 3"	8'	13' 4"	16'/11'
HALF-TON FW											
23MLE	7678	2222	1200	54	30	60	60	27' 11"	8'	12' 0"	16'
24RDS	7612	2388	1430	54	30	60	60	28' 10"	8'	12' 7"	20'
27SGS	8211	2079	1495	54	30	60	60	30' 6"	8'	12' 7"	10'
29BHL	8345	2655	1610	54	30	60	60	33' 4"	8'	12' 8"	20'
29RKS	8958	1442	1605	54	30	60	60	32' 9"	8'	12' 7"	20'
29RLI	8893	2107	1630	54	30	60	60	32' 9"	8'	12' 8"	10'/10'
32BHS	9428	2072	1570	54	60	60	60	35' 8"	8'	12' 7"	18'
HALF-TON TT											
22MLSWE	5880	1320	760	54	38	38	60	26' 10"	8'	11' 5"	18'
22RBSWE	5648	1552	580	54	38	76	60	25' 11"	8'	11' 3"	16'
25DBSWE	6287	2513	800	54	38	76	60	29' 10"	8'	11' 3"	20'
25RDSWE	6361	2439	790	54	38	76	60	29' 10"	8'	11' 3"	18'
26RBSWE	6728	2072	690	54	38	76	60	29' 11"	8'	11' 3"	20'
29RLKWE	7798	1702	810	54	38	76	60	33' 3"	8'	11' 3"	9'
29RLSWE	7611	1889	940	54	38	76	60	33' 3"	8'	11' 5"	9'/11'
30BHSWE	7282	2218	880	54	30	60	60	34' 5"	8'	11' 5"	19'
31BHKWE	7697	1803	810	54	38	76	60	34' 9"	8'	11' 3"	18'
32RDBWE	8087	2413	920	54	38	76	60	36' 4"	8'	11' 5"	19'
25MLEWE	TBD	TBD	TBD	54	30	60	60	29 ft, 11 in	8'	11' 5"	18'
25FKDWE	TBD	TBD	TBD	TBD	TBD	TBD	TBD	TBD	TBD	TBD	TBD
27BHS	7008	1992	730	54	30	60	60	31' 11"	8'	11' 3"	19'
30RKD	7772	1728	955	54	30	60	60	34' 9"	8'	11' 5"	19'
33RLI	8690	1810	1215	54	30	60	60	37' 5"	8'	11' 4"	14'/10'
34TSB	8678	1822	1150	54	30	60	60	37' 5"	8'	11' 4"	8'/11'
SPORT											
1900RBWE	4780	2640	420	54	30	30	40	23' 8"	8'	10' 8"	15'
2300BHWE	TBD	TBD	TBD	TBD	TBD	TBD	TBD	TBD	TBD	TBD	TBD
2100RK	6815	1685	1120	54	30	60	60	26' 3"	8'	12' 0"	17'
2400RE	TBD	TBD	TBD	54	30	60	60	28' 9"	8'	12' 7"	16'
2700BH	7580	1920	1390	54	30	60	60	32' 3"	8'	12' 7"	20'



FOLLOW US FOR THE LATEST!



DISCLAIMER: Product information is as accurate as possible as of the date of publication of this brochure. All features, floor plans, and specifications in this brochure are subject to change without notice. Please also consult Keystone's web site at www.keystonerv.com for more current product information and specifications. Tow Vehicle Disclaimer. CAUTION: Owners of Keystone recreational vehicles are solely responsible for the selection and proper use of tow vehicles. All customers should consult with a motor vehicle manufacturer or their dealer concerning the purchase and use of suitable tow vehicles for Keystone products. Keystone disclaims any liability or damages suffered as a result of the selection, operation, use or misuse of a tow vehicle. KEYSTONE'S LIMITED WARRANTY DOES NOT COVER DAMAGE TO THE RECREATIONAL VEHICLE OR THE TOW VEHICLE AS A RESULT OF THE SELECTION, OPERATION, USE OR MISUSE OF THE TOW VEHICLE. *Length is defined as the distance from the centerline of hitch pin/coupler to rear bumper of trailer. ** Fresh water capacity includes water heater. Please review owner's manual prior to purchase for more information on service warranties, extended use, towing and maintenance. Owner's manuals can be found at keystonerv.com.