

SKINNY GUY

C A M P E R S

ARMOR

PROUDLY DESIGNED AND MADE IN THE USA

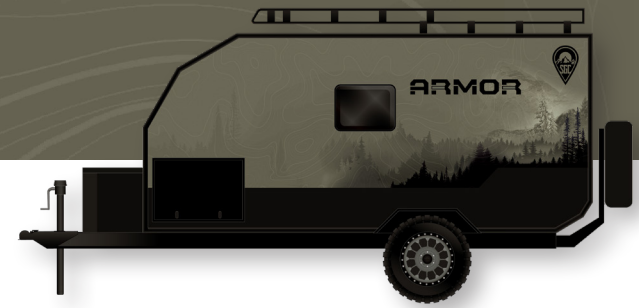

Chassis and Running Gear

- Norco mainframe, stamped, heavy gauge steel and powder-coated
- ARK fold-away tongue jack with dual swivel caster wheels
- BAL 5200 lbs. independent suspension and high clearance design with electric brakes
- Dual rear, heavy duty extendable BAL stabilizing jacks with foot pads
- Oversized All-Terrain radial tires with Black'd Out aluminum wheels
- Rear-mounted HD high-clearance, full-size spare tire carrier
- Front chassis mounted storage with tie-down hook points (for generator, propane, or gear)
- 2 inch trailer hitch ball receiver or Lock 'n Roll full articulating hitch

Culinary

- Pull-out outside kitchen with industry exclusive Traeger Pellet grill and integrated sink and faucet
- Pull-out and lowering tray with integrated Indoor/Outdoor Fridge/Freezer
- Interior portable induction burner

Construction

- Armor 3M™ full-body wrap film protection and graphics
- Armor EXO™ rubberized, water-repellent protection on exterior joints, trim, and skirting
- Armor EXO™ fully-body proprietary extrusion, full adhesive, and SIPs construction
- Zero wood construction
- SIPs composite panel construction for low thermal bridging
- High-density insulation
- Fully functional, powder-coated rock slider steps
- Roof-mounted tubular aluminum gear rack, mounted to EXO™ extrusions-only; Rooftop tent (RTT)-compatible
- Acrylic and aluminum entry door, lockable with built-in windows and interior screen
- Acrylic and aluminum windows with built-in screen and shades
- Rear bumper prep for recovery shackles or D-rings
- SGC-branded front-mounted Molle panel with Rotopax and Recovery Board mounting points
- Solid entry steps
- All aluminum and composite cabinetry construction

Comfort and Utilities

- REDARC RedVision Power Management System
- REDARC 3000W Inverter
- LED lighting on interior and exterior
- Under bed storage compartments
- Deluxe comfort Teddy Bear bed mattresses and seat cushions
- Low profile AC
- Exterior power / charging receptacle
- Accessory solar prep
- 200W Solar panel mounted to roof rack
- Prep for large battery bank
- Nautilus WaterWorks valve panel
- 110V, 12V, and USB outlets
- EZ swap propane tank
- Outside propane quick-connect
- Propane and CO detector
- Full wet bath (shower and toilet)
- Truma Combi Heater and Water Heater
- Fresh water tank
- Black water tank

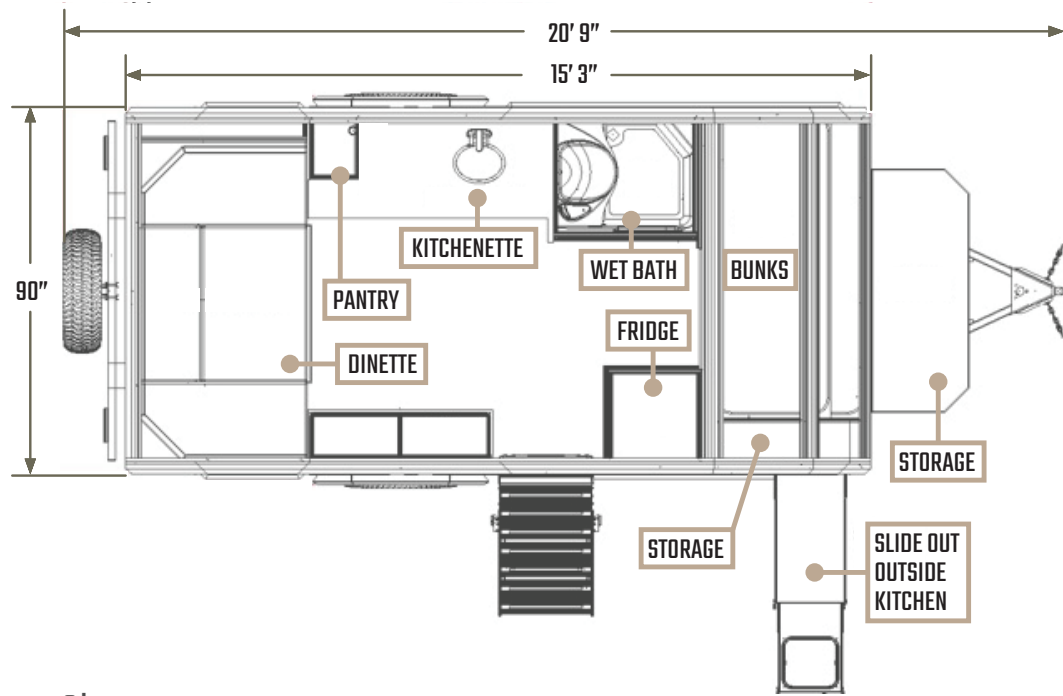

EXO™

Spec Sheet

| | |
|-------------------------------|-----------|
| Exterior Height | 10' 2" |
| Exterior Width | 90" |
| Exterior Length | 20' 9" |
| Interior Height | 78" |
| Refrigerator Capacity | 63 qt. |
| Sleeping Bunk Weight Capacity | 300 lbs. |
| Dimensional Size of Main Beds | 36" x 86" |
| Dimensional Size of Bunk Beds | 48" x 86" |
| Sleeping Capacity | 3-4 |
| Solar Panel Size | 200 W |
| External Propane Tank Size | 30 lbs. |
| Fresh Water Capacity | 38 gal. |
| Black Water Capacity | 52 gal. |
| GVWR | 5640 lbs. |

HIGHLIGHTS

- Zero wood construction
- SGC's proprietary EXO™ construction
- EXO™ = Proprietary extrusions, 3M film, and rubberized lower protectant
- Metal and composite cabinets
- Assembled with bolts, like a truck (not with staples or screws like an RV)
- BAL High Clearance and Independent Suspension
- Truma Combi Heater & Water Heater
- EXO Rubberized lower Protectant & Seal
- RedArc RedVision Power Mgmt System
- Acrylic Windows and Doors
- UnHoly™ Roof – minimal holes in roof