

STARCRAFT

Delight in a Drizzle



STARCRAFT 
GSL
2024 Travel Trailers



2024 Starcraft GSL TT 296BHS



290RLS OPTIONS A, C & D



275RLS OPTIONS A, B, C & D

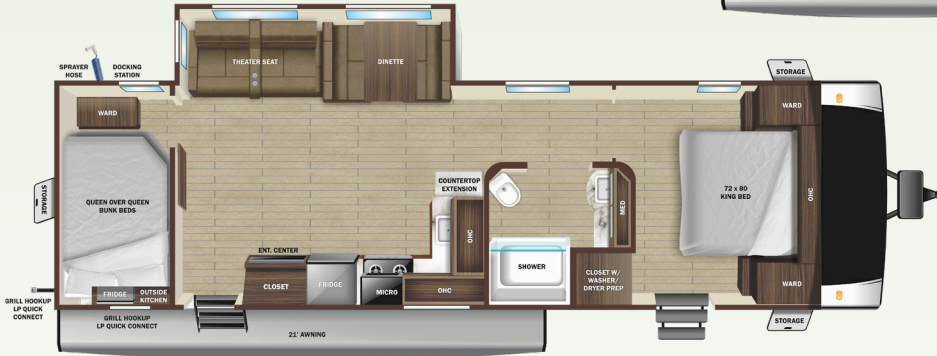

296BHS OPTIONS B, C, & D



321BHS OPTIONS B, C, D & E

3
YEAR
LIMITED
STRUCTURAL
WARRANTY

Go the distance with our 3-Year Limited Structural Warranty plus a 1-Year Limited Manufacturer's Warranty—freedom from worry is your best travel companion.

STARCRAFT GSL OPTIONS





2024 Travel Trailers

STANDARD INTERIOR EQUIPMENT

- 10 cu. ft. 12V refrigerator
- 15,000 BTU roof mounted A/C
- 5G antenna
- 50 amp service with 2nd A/C prep
- 75 lb. ball bearing drawer guides
- Cable and satellite prep
- Dome style digital TV antenna with Wi-Fi prep
- Electrical outlets and USB ports in master bedroom
- Flush floor slides with residential vinyl flooring
- Glass shower doors
- Hardwood cabinet doors
- Kitchen sink covers
- LED interior lighting
- Microwave
- Pressed membrane countertops
- Range hood vented outside
- Residential high-rise faucet with pull-down sprayer
- Roller blackout night shades
- Stainless steel single basin under-mount kitchen sink

STANDARD EXTERIOR EQUIPMENT

- 120 GFCI protected receptacle
- 5/8" main floor decking
- Class leading I-beam chassis and draw bar sizes
- Enclosed exterior docking station with black tank flush
- Equa-Flex® axle suspension
- Exterior grill/griddle quick connect port

- Fully walkable roof
- Gas/electric water heater
- In-frame battery rack
- Large grab handle on main entry door
- Magnetic baggage door catches
- Nitrogen filled radial tires with aluminum rims
- Power awning with LED lighting
- Power tongue jack
- PVC roofing membrane (limited lifetime warranty)
- Rain guttering with molded drip spouts
- Rear observation camera prep
- Roof mount solar prep
- Self-adjusting electric brakes
- Side marker light camera prep
- Thermal Seal- enclosed, insulated and heated underbelly and fully insulated roof with a PVC roofing membrane
- TuffShell™ - vacuum bonded laminated construction, reinforced with heavy-duty fiberglass and welded aluminum frames
- Xtend Solar I Package (200 watt solar panel with 30 amp solar controller)

- JBL® Premium indoor and outdoor multizone speakers
- Keyed-Alike™ entry and baggage doors
- Molded front cap with LED lighting and stoneguard protection
- Pop up wireless and USB charger in bedroom
- Smart HDTV
- TravellINK® - Smart RV system that allows for Bluetooth® control of awnings, lighting, slideouts, heating, cooling and more

OPTIONS

- Xtend Solar II Package (2-200 watt solar panels with 30 amp solar controller and 1800 watt inverter) (Replaces standard Xtend Solar I Package)
- 2nd A/C ducted
- 17" Griddle with bumper bracket
- 70" theater seats ipo standard tri-fold sofa (275RLS, 290RLS)
- Power front and rear stabilizer jacks
- Table with 2 chairs and bench ipo standard booth
- Table with 4 chairs ipo standard booth
- Theater seats 70" ipo Std. Tri-Fold Sofa (275RLS, 290RLS)
- Tri-fold sofa ipo standard theater seats (296BHS, 321BHS)
- Mega Lounge ipo standard theater seats and booth (275RLS, 296BHS, 321BHS)
- Wi-Fi router

CUSTOMER CONVENIENCE PACKAGE (Mandatory)

- 3-burner range with 17" oven and flush mount glass cover
- 72" x 80" residential style king bed
- JBL® Aura Cube stereo with Bluetooth® and miZONE™ technology

SPECIFICATIONS

(May Include Estimated Values)

	290RLS	275RLS	296BHS	321BHS
Unloaded Vehicle Weight (lbs.)	7,215	7,385	7,275	8,645
Dry Hitch Weight (lbs.)	1,020	1,005	880	1,075
Gross Vehicle Weight Rating (GVWR)	8,800	8,995	8,800	9,995
Cargo (Gross)	1,655	1,610	1,645	1,350
Exterior Length (Overall)	33' 5"	33' 11"	36' 3"	38' 0"
Exterior Height	11' 3"	11' 2"	11' 4"	11' 5"
Exterior Width	8' 1"	8' 1"	8' 1"	8' 1"
Exterior Width (Slides Out)	13' 2"	13' 2"	11' 2"	14' 2"
Interior Height	6' 9"	6' 9"	6' 9"	6' 9"
Fresh Water Capacity (Gal.)*	51	51	51	51
Gray Waste Water Capacity (Gal.)	58	58	29	58
Black Waste Water Capacity (Gal.)	29	29	29	29
LP Capacity (lbs.)	60	60	60	60
Tire Size	15"	15"	15"	15"
Awning Size	11', 10'	11' 5", 10'	21'	11', 10'

*Includes water heater

Learn more about our standard features and full options packages at StarcraftRV.com



StarcraftRV.com
#CampingPureAndSimple

LOCAL DEALER INFO

STARCRRAFT
Starcraft RV – Part of the Jayco Family of Companies
903 S. Main Street
Middlebury, IN 46540 USA
(800) 945-4787

Unloaded Vehicle Weight (UJVW): Sometimes referred to as "Dry Weight," UJVW means the typical weight of this trailer as built at the factory. The UJVW, as used in product literature and other promotional materials, does not include cargo, fresh water, propane, options or dealer-installed accessories. Hitch Weight (HW): The hitch weight, as used in product literature and other promotional materials, does not include cargo, fresh water, propane gas, options or dealer-installed accessories. The addition of these types of items will either add to or subtract from the stated hitch weight. It is important for your safety and enjoyment that your tow vehicle be adequately sized and equipped to tow and handle the GVWR of the RV you select. Review weights and rating of your tow vehicle and consult a competent advisor for questions or advice. Whether you are new to RVing or a veteran, get a feel for the performance of your tow vehicle before heading out on the roadways. When you tow an RV, you must drive differently than when you drive a single vehicle. Practice hooking up, driving, backing up and braking in a safe environment or seek out professional instruction. Starcraft affixes a weight label to each RV which lists weight information for that vehicle. See specifications chart on the respective pages of this brochure.

Starcraft RV | 903 S. Main Street | Middlebury, IN 46540 | See dealer for further information and prices. All information in this brochure and on www.StarcraftRV.com is the latest available at the time of publication approval. Starcraft RV reserves the right to make changes and to discontinue models without notice or obligation. Photography may show optional equipment or props used for decoration purposes only. RVs built for sale in Canada may differ to conform to Canadian codes. Starcraft and the S are registered trademarks of Jayco, Inc. Printed in U.S.A.