

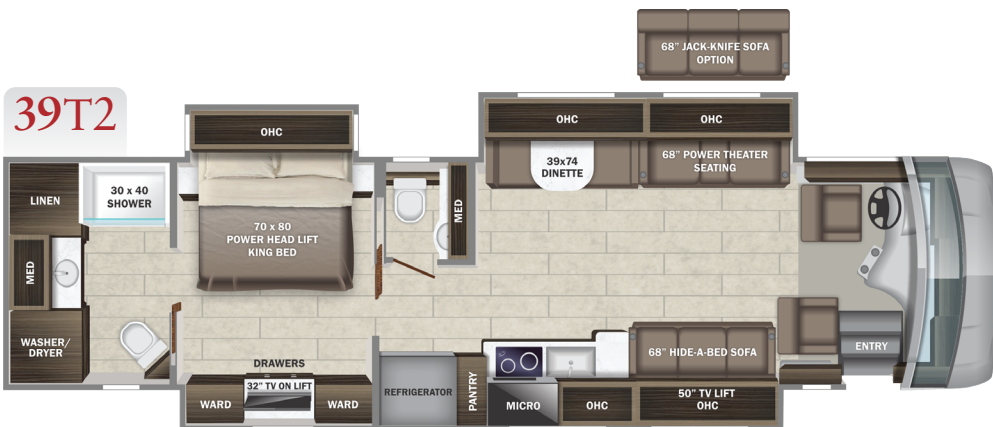

OUTSIDE ENTERTAINMENT
CENTER W/ 43" TV



OUTSIDE ENTERTAINMENT
CENTER W/ 43" TV



OUTSIDE ENTERTAINMENT
CENTER W/ 43" TV

PAINT SELECTIONS



Blue Velvet



Penny Graphite



Pewter Red



Red Carmel

CHASSIS

Spartan® K1 raised-rail chassis
 Cummins® B6.7 turbocharged 360 HP engine with 800 lb.-ft. torque at 1,800 RPM
 Allison® 3,000 MH 6-speed transmission
 Rear-mounted radiator
 170 amp alternator
 750W engine block heater
 Variable geometry turbo (VGT) engine brake
 Independent front air suspension (IFS) front axle - 12,600 lb. (37K) 14,320 lb. (39BH/39T2)
 Rear axle - 20,000 lb. (37K) 22,000 lb. (39BH/39T2)
 4.88 rear axle ratio
 Michelin® 275/80R 22.5 in. tires
 Bilstein® 46mm shocks
 Wireless tire pressure monitoring system (TPMS) with temperature monitoring
 Equalizer™ hydraulic automatic coach leveling
 Remote air connection
 (2) 12V chassis batteries
 100 gal. fuel tank
 10 gal. DEF tank
 Spartan® Safehaul tow vehicle air brake system
 10,000 lb. hitch with 7-pin plug

CONSTRUCTION

Roof: One-piece fiberglass with 3/8 in. plywood decking, 4 in. arched aluminum trusses, insulation and reflective Flexfoil® (R-24)
 Sidewalls: Vacuum-bonded, high-gloss gelcoat with R-8 bead-foam insulation
 Floors: Vacuum-bonded layers of Darco underbelly, a welded aluminum frame, R-9 bead-foam insulation, 3/8 in. Structurwood® and 1/4 in. plywood
 X-Bridge™ bracing welded into chassis frame
 Heated basement storage
 Insulated front and rear caps (R-24)
 Electric-powered slideout rooms

HEAT, A/C, WATER, AND POWER

Onan® 8,000W diesel generator, with automatic start, on slide-out tray
 2,000W pure sine wave inverter with 100 amp battery charger
 (2) L16 AGM batteries (6V/390 amp hrs. ea.)
 50 amp power cord
 Automatic transfer switch with surge protection
 (2) 190W Go Power!® solar panels

(3) 15,000 BTU A/C units with heat pumps [(2) 15,000 BTU units with heat pumps on 37K]
 35,000 BTU furnace (37K) / (1) 20,000 and (1) 30,000 (39BH, 39T2)
 Tankless gas water heater
 24.5 gal. propane tank
 LED-lit fireplace with 5,000 BTU heating element (37K only)
 Sani-Con® macerator holding tank dump system with manual gate valves and manual backup
 Black holding tank sprayer
 City and tank water filtration system

EXTERIOR

Carefree® power patio awning with LED lights
 Carefree® power entrance door awning with LED lights
 Carefree® slideout awnings
 Carefree® window awnings
 Frameless, dual-pane, tinted, safety-glass windows
 Grab handle and keypad system for keyless entry
 43 in. Samsung® 4K UHD Smart TV with tilt, swivel, and extend adjustment
 JBL® radio and speakers with USB port and receptacle
 Heated, remote-control, side-view mirrors with integrated cameras
 Diamond Shield™ front protective film mask
 Halogen high and low beam headlights and fog lights
 Daytime running lights
 LED marker lights, turn lights, license plate light, third brake light, accent lights and docking lights
 Porch light
 Mudflap with chrome "Entegra" nameplate
 Winegard® TRAV'LER satellite dish DIRECTV® - standard with USA option
 Winegard® TRAV'LER satellite dish Shaw TV - standard with CSA option
 Winegard Connect 2.0 Wi-Fi/4G antenna
 Exterior utility center
 Slideout basement storage tray
 Sikkens custom full-body paint

COCKPIT

Valid™ 12.3 in. digital dash with quad core graphics processor, on-board diagnostics, selector knob and ability to display traditional instrument cluster, 360° camera system or GPS navigation

Xite™ 360° HD digital camera system
 Xite™ XSG4 infotainment system with 9 in. touchscreen, iGO navigation, Bluetooth®, Sirius XM™ and AM/FM tuner, integrated camera control and house mode whole-coach audio distribution
 Steering wheel with integrated controls for cruise, wipers, radio and Bluetooth® phone functionality
 Manual tilt and telescoping steering column
 Ultra-Vision® one-piece wrap-around tinted windshield
 6-way power adjustable driver and passenger seats with power recline
 Powered flush stepwell cover
 Powered adjustable brake and accelerator pedals
 Powered front sun visors and privacy shades

INTERIOR

Firefly multiplex system with 10 in. VegaTouch
 Firefly multiplex system with 7 in. VegaTouch touchscreen for complete integration of coach controls (mobile app available)
 50 in. Samsung® 4K UHD Smart TV
 Samsung® sound bar with subwoofer
 Sony® Blu-ray™ player
 Premium furniture
 Hand-laid, woodgrain porcelain tiled floors
 LED interior lighting
 Decorative ceiling feature with integrated accent lighting
 Manual solar day shades and blackout night shades
 Central vacuum system
 Removable screen on entry door

KITCHEN

Window with push-out lever operation and screen
 Stainless steel residential refrigerator with ice maker and water dispenser
 Induction cooktop
 1.5 cu. ft. convection microwave oven
 Solid-surface countertops with stainless steel sink
 Fan-Tastic power exhaust fan with intake

BEDROOM

King-size pillow-top mattress on tilt bed
 32 in. Samsung® LED 1080P Smart TV
 Sony® Blu-ray™ player

BATHROOM

Solid-surface countertops with integrated sink
 One-piece fiberglass shower with skylight
 Aqua View SHOWERMISER™ water saving system
 Thetford® Aqua Magic toilet with foot flush
 Fan-Tastic power exhaust fan with intake
 Separate washer and dryer

SAFETY

Combination carbon monoxide detector and LP gas alarm
 Smoke alarm

OPTIONS

Canadian standards (CSA)
 Theater seating with power recliners (39BH)
 Winegard® in-motion satellite dome
 Winegard® TRAV'LER satellite dish Dish Network®
 Drop-down overhead bunk in cab area with 750 lb. capacity

WARRANTY



NO ONE OFFERS A BETTER WARRANTY

At Entegra Coach, we build our RVs to handle every adventure, then back them with our industry-leading 2+3 limited warranty. Our 2-year limited warranty has you covered for 2 camping seasons. That's 730 days. In addition, our 3-year structural limited warranty has you covered for 3 camping seasons or 1,095 days. You won't find a better limited warranty in the business, because the only strings we attach are those that deliver the ultimate in reliability. For a copy of our 2-year limited + 3-year structural limited warranty with complete terms and conditions, please contact your local Entegra Coach dealer.

Floorplan	GVWR (lbs.)	GCWR (lbs.)	Front GAWR (lbs.)	Rear GAWR (lbs.)	Tag GAWR (lbs.)	Wheel Base	Overall Length	Exterior Height w/ A/C & Satellite	Exterior Width	Interior Height	Fresh Water Capacity (gal.)	Grey Waste Water Capacity (gal.)	Black Waste Water Capacity (gal.)
37K	34,320	44,320	14,320	20,000	N/A	236"	37' 10"	12' 10"	101"	84"	100	62	41
39BH	36,320	46,320	14,320	22,000	N/A	261"	39' 11"	12' 10"	101"	84"	100	62	41
39T2	36,320	46,320	14,320	22,000	N/A	261"	39' 11"	12' 10"	101"	84"	100	62	41

It is important for your safety and enjoyment that you are aware of the weights and tow ratings of the RV you select. Consult a competent advisor for questions or advice. Whether you are new to RVing or a veteran, get a feel for the performance of your RV before heading out on the roadways. When you tow a vehicle with your RV, you must drive differently than when you drive a single vehicle. Practice hooking up, driving, backing up and braking in a safe environment or seek out professional instruction. Jayco affixes a weight label to each RV which lists weight information for that vehicle. Refer to that label to verify the vehicle will meet your requirements. Gross Vehicle Weight Rating (GVWR): The maximum permissible weight of the motorhome, including the Unloaded Vehicle Weight (UVW) plus passengers, personal items, all cargo, fluids, options and dealer-installed accessories. The GVWR is equal to or greater than the sum of the UVW and the Cargo Carrying Capacity. Gross Combined Weight Rating (GCWR): The maximum allowable combined weight of the motorhome used as a tow vehicle and the attached towed vehicle.