

Flagstaff

LTD, MAC, SE, HIGH WALL, &
HARD SIDE TENT CAMPERS

PROUDLY
Millersburg Made
SINCE 1974



FOREST
RIVER

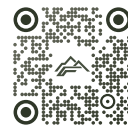

LIMITED

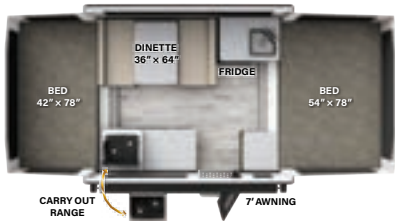

176LTD

CLOSED LENGTH: 11' 9" OPEN LENGTH: 17' 2" CLOSED HEIGHT: 5' 4"

BOX SIZE: 8' HITCH: 196 AXLE: 1299

LIMITED

UVW: 1514 CCC: 778 **F** 10 GAL **G** N/A **B** N/A

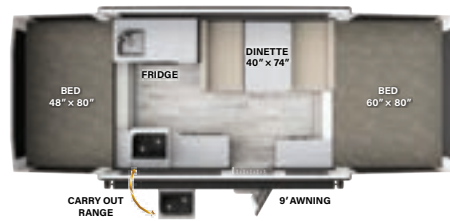

206LTD

CLOSED LENGTH: 13' 9" OPEN LENGTH: 20' 2" CLOSED HEIGHT: 5' 4"

BOX SIZE: 10' HITCH: 226 AXLE: 1440

LIMITED

UVW: 1685 CCC: 637 **F** 10 GAL **G** N/A **B** N/A

MAC

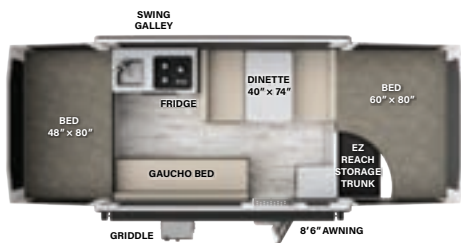

206M

CLOSED LENGTH: 16' 7" OPEN LENGTH: 20' 5" CLOSED HEIGHT: 5' 6"

BOX SIZE: 12' HITCH: 244 AXLE: 1865

MAC

UVW: 2147 CCC: 1097 **F** 20 GAL **G** N/A **B** N/A

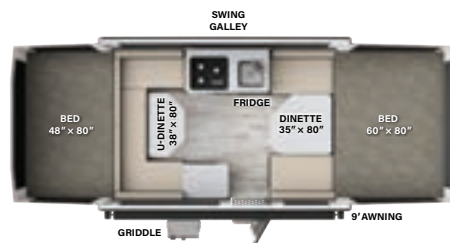

208

CLOSED LENGTH: 15' 7" OPEN LENGTH: 20' 2" CLOSED HEIGHT: 5' 6"

BOX SIZE: 10' HITCH: 296 AXLE: 1707

MAC

UVW: 2041 CCC: 1255 **F** 20 GAL **G** N/A **B** N/A

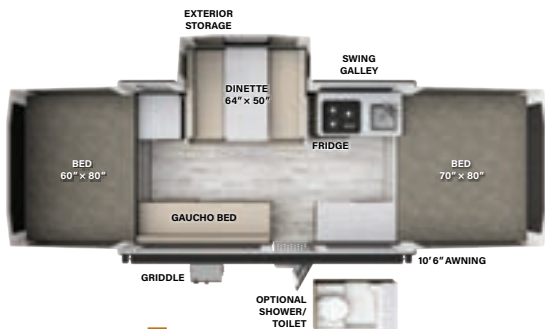

228D

CLOSED LENGTH: 16' 10" OPEN LENGTH: 23' 11" CLOSED HEIGHT: 5' 6"

BOX SIZE: 12' HITCH: 263 AXLE: 2157

MAC

UVW: 2458 CCC: 805 **F** 20 GAL **G** N/A **B** N/A

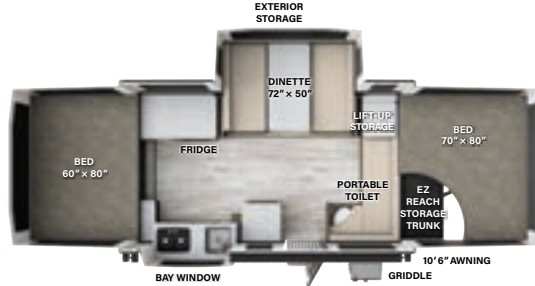

425M

CLOSED LENGTH: 19' OPEN LENGTH: 23' 9" CLOSED HEIGHT: 6'

BOX SIZE: 12' HITCH: 295 AXLE: 2340

MAC

UVW: 2673 CCC: 622 **F** 20 GAL **G** N/A **B** N/A

SE

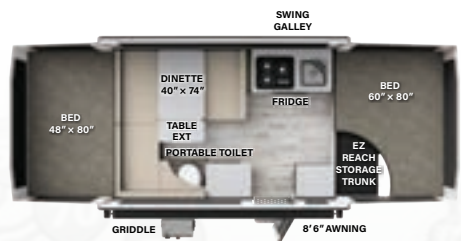

206STSE

CLOSED LENGTH: 16' 9" OPEN LENGTH: 20' 7" CLOSED HEIGHT: 5' 11"

BOX SIZE: 10' HITCH: 251 AXLE: 2052

SE

UVW: 2341 CCC: 769 **F** 20 GAL **G** N/A **B** N/A

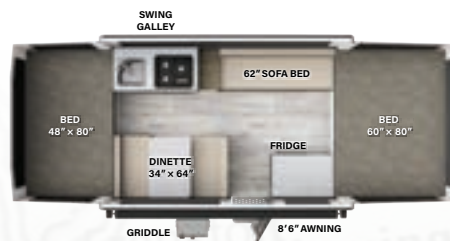

207SE

CLOSED LENGTH: 14' 11" OPEN LENGTH: 20' 1" CLOSED HEIGHT: 5' 11"

BOX SIZE: 10' HITCH: 268 AXLE: 1940

SE

UVW: 2246 CCC: 752 **F** 20 GAL **G** N/A **B** N/A

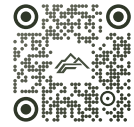

SE

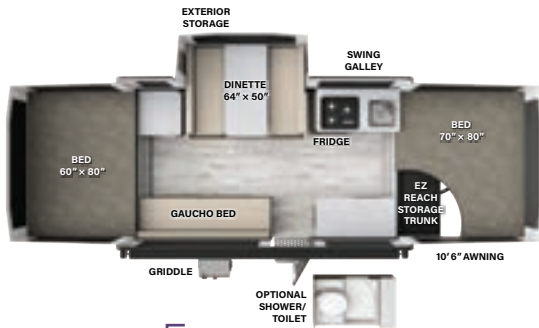

228BHSE

CLOSED LENGTH: 18' 7" OPEN LENGTH: 23' 11" CLOSED HEIGHT: 6' 2"

BOX SIZE: 12' HITCH: 338 AXLE: 2202

UVW: 2578 CCC: 1260 **F** 20 GAL **G** N/A **B** N/A

SE

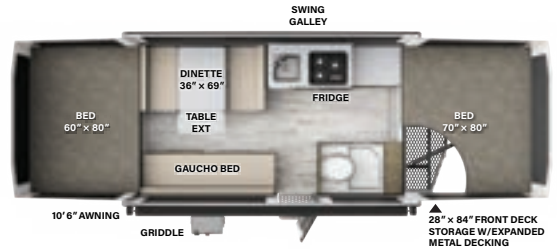

228SE

CLOSED LENGTH: 18' 7" OPEN LENGTH: 23' 11" CLOSED HEIGHT: 6' 2"

BOX SIZE: 12' HITCH: 375 AXLE: 2455

UVW: 2868 CCC: 1007 **F** 20 GAL **G** N/A **B** N/A

SE

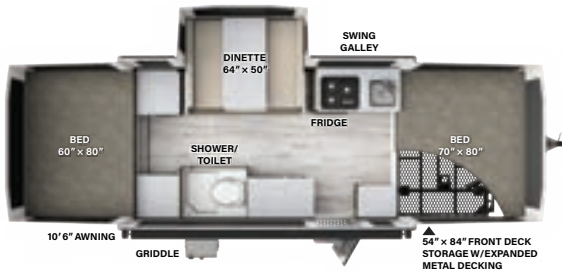

23SCSE

CLOSED LENGTH: 21' 6" OPEN LENGTH: 26' 5" CLOSED HEIGHT: 6' 2"

BOX SIZE: 12' HITCH: 294 AXLE: 2620

UVW: 2952 CCC: 842 **F** 20 GAL **G** N/A **B** N/A

SE

HARD SIDE

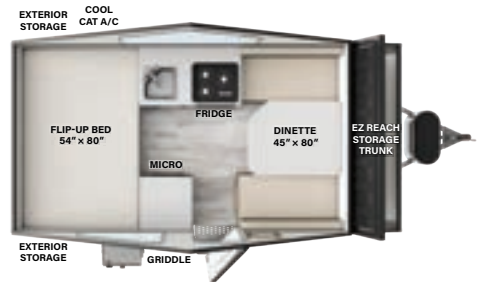

T12RBST

LENGTH: 18' 4" CLOSED HEIGHT: 5' 1"

BOX SIZE: 12' HITCH: 284 AXLE: 1798

UVW: 2120 CCC: 1164 **F** 20 GAL **G** N/A **B** N/A

HARD SIDE

HIGH WALL

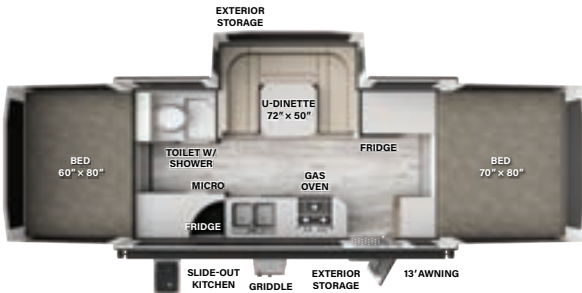

HW27KS

CLOSED LENGTH: 19' 3" OPEN LENGTH: 25' 9" CLOSED HEIGHT: 6' 7"

BOX SIZE: 14' HITCH: 380 AXLE: 2916

UVW: 3334 CCC: 546 **F** 20 GAL **G** 12 GAL **B** 12 GAL

HIGH WALL

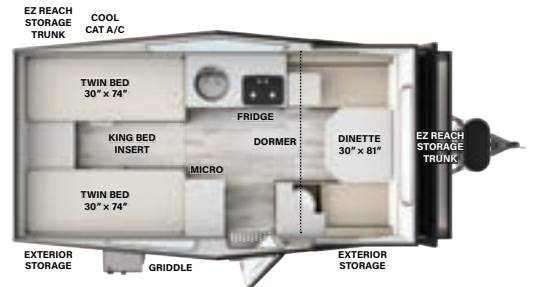

T21TBHW

LENGTH: 20' 4" CLOSED HEIGHT: 5' 8"

BOX SIZE: 14' HITCH: 372 AXLE: 2260

UVW: 2670 CCC: 702 **F** 20 GAL **G** N/A **B** N/A

HARD SIDE

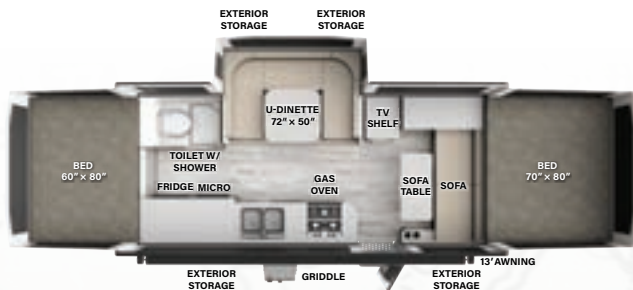

HW29SC

CLOSED LENGTH: 21' 3" OPEN LENGTH: 27' 9" CLOSED HEIGHT: 6' 9"

BOX SIZE: 16' HITCH: 378 AXLE: 3146

UVW: 3562 CCC: 1437 **F** 20 GAL **G** 12 GAL **B** 12 GAL

HIGH WALL

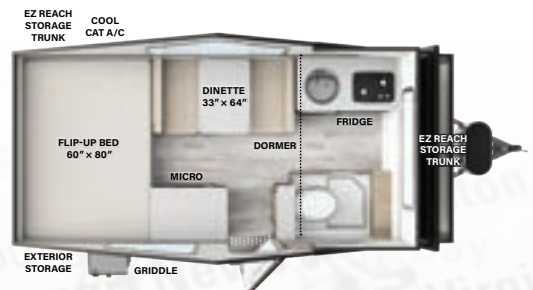

T21DMHW

LENGTH: 20' 4" CLOSED HEIGHT: 5' 8"

BOX SIZE: 14' HITCH: 353 AXLE: 2309

UVW: 2700 CCC: 653 **F** 20 GAL **G** N/A **B** N/A

HARD SIDE

CUSTOMER SATISFACTION



Flagstaff Warranty. Our Promise.

www.ForestRiverBuyLocal.com

FOR DETAILS ON FLAGSTAFF'S COMPLETE WARRANTY PROGRAM, SEE YOUR FLAGSTAFF DEALER.

When it comes to backing products with the same quality and commitment it does when it begins the manufacturing process, the only name you have to remember when you're looking for a recreational vehicle is Flagstaff. Flagstaff offers the following additional limited warranties to the original purchasers. Consult written warranty for details.

1 Five-year roof warranty

(Excludes Hard Side)

2 Twenty-five-year floor warranty

3 Five-year frame warranty

4 Five-year tent warranty

5 Ten-year Torflex® axle warranty

(Excludes LTD, MAC, SE)

6 LTD lifetime lifter system warranty

(Excludes Hard Side)

Specification Definitions

GVWR (Gross Vehicle Weight Rating): is the maximum permissible weight of the unit when fully loaded. It includes all weights, inclusive of all fluids, cargo, optional equipment and accessories. For safety and product performance do NOT exceed the GVWR.

GAWR (Gross Axle Weight Rating): is the maximum permissible weight, including cargo, fluids, optional equipment and accessories that can be safely supported by a combination of all axles.

UVW (Unloaded Vehicle Weight):¹ is the typical weight of the unit as manufactured at the factory. It includes all weight at the unit's axle(s) and tongue or pin and LP Gas. The UVW does not include cargo, fresh potable water, additional optional equipment or dealer installed accessories.

CCC (Cargo Carrying Capacity):¹ is the amount of weight available for fresh potable water, cargo, additional optional equipment and accessories. CCC is equal to GVWR minus UVW. Available CCC should accommodate fresh potable water (8.3 IWW per gallon). Before filling the fresh water tank, empty the black and gray tanks to provide for more cargo capacity.

Each Forest River RV is weighed at the manufacturing facility prior to shipping. A label identifying the unloaded vehicle weight of the actual unit and the cargo carrying capacity is applied to every Forest River RV prior to leaving our facilities.

The load capacity of your unit is designated by weight, not by volume, so you cannot necessarily use all available space when loading your unit.

All information contained in this brochure is believed to be accurate at the time of publication. However, during the model year, it may be necessary to make revisions and Forest River, Inc., reserves the right to make all such changes without notice, including prices, colors, materials, equipment and specifications as well as the addition of new models and the discontinuance of models shown in this brochure. Therefore, please consult with your Forest River dealer and confirm the existence of any materials, design or specifications that are material to your purchase decision. © 2023 Flagstaff RV, a Division of Forest River, Inc., a Berkshire Hathaway Company. All Rights Reserved.

08/23 Flagstaff

¹ Estimated Average based on standard build optional equipment

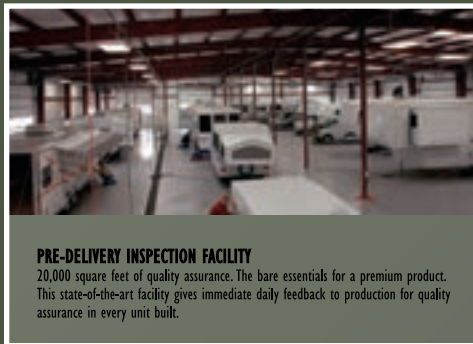

PRE-DELIVERY INSPECTION FACILITY
20,000 square feet of quality assurance. The bare essentials for a premium product. This state-of-the-art facility gives immediate daily feedback to production for quality assurance in every unit built.



**24/7 EMERGENCY
ROADSIDE ASSISTANCE
WITH VEHICLE PURCHASE***

TOWING
JUMP-STARTS
TIRE CHANGES
FLUID DELIVERY
LOCKOUT
SERVICE

WINCH-OUT
MOBILE MECHANIC
TECHNICAL
SUPPORT
DEALER LOCATOR
SERVICES



*VALID FOR 1 YEAR FROM DATE OF PURCHASE



RV WITH US



@FlagstaffRVs



FOREST RIVER OWNER'S GUIDE

Now you can have your Owner's Manual with you wherever you are. Download our FREE App from the App Store or Google Play and you'll have the information right at your fingertips.

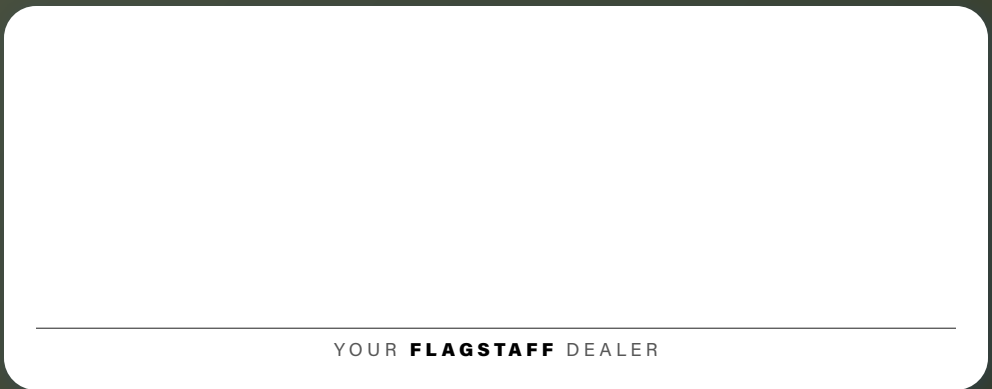

YOUR **FLAGSTAFF** DEALER



Learn More
Scan this barcode using a QR Reader on your smart phone to learn more about Forest River.



A Berkshire Hathaway company

Flagstaff

201 WEST ELM MILLERSBURG, IN 46543
WWW.FORESTRIVERINC.COM/FLAGSTAFF

574.642.2640

FREE MEMBERSHIP
to Forest River Owners' Group

www.forestriverfrog.com

