

# AVALANCHE

LUXURY FIFTH WHEEL



KEYSTONE  
RV COMPANY

CAMP BETTER



AVALANCHE 378BH



AVALANCHE 338GK

## 2023 AVALANCHE | EXCEPTIONAL FEATURES

- 100" WIDE BODY CONSTRUCTION
- DRAMATIC HIGH CEILINGS
- 6'10" TALL SUMMIT SLIDES W/ OVERSIZED WINDOWS
- FRAMELESS PANORAMIC WINDOWS THROUGHOUT
- HYDRAULIC, ONE-TOUCH AUTO-LEVELING SYSTEM WITH HITCH MEMORY
- HITCH VISION™ TECHNOLOGY IN FULLY PAINTED, MOLDED FRONT CAP
- ROAD ARMOR™ SUSPENSION W/ 1/2" SHACKLE PLATES
- ROAD ARMOR™ RUBBERIZED HITCH PIN
- 2" HITCH RECEIVER W/ 4-PIN TOWING HARNESS (SELECT MODELS)
- BACKUP CAMERA AND SIDE MOUNT CAMERA PREP
- EXCLUSIVE FOUR-SEASON RV POLAR PACK™ CLIMATE PROTECTION
- LAMINATED, DOUBLE-INSULATED REAR WALL
- DUAL A/CS WITH WHISPER QUIET TECHNOLOGY
- BLADE PURE™ HIGH PERFORMANCE AIR FLOW SYSTEM W/ MERV 9 AIR FILTRATION
- 40,000 BTU GAS FURNACE
- ATTIC VENTS IN ALL MODELS
- SUBURBAN 12-GALLON GAS/ELECTRIC WATER HEATER
- LG SOLID SURFACE COUNTERS
- FURRIOR® KITCHEN APPLIANCES
- 18 CU. FT. RESIDENTIAL OR GAS/ELECTRIC REFRIGERATOR
- STACKABLE WASHER AND DRYER PREP
- 48" FIBERGLASS SHOWER W/ SEAT
- KING BEDS
- BACKUP CAMERA AND SIDE-MOUNT CAMERA PREP
- SOLARFLEX™ 400I AND SOLARFLEX™ 600I-L SOLAR PACKAGE W/OPTIONAL DRAGONFLY ENERGY® LITHIUM-ION BATTERIES

VISIT OUR WEBSITE FOR PHOTOS,  
360° TOURS, AND FULL PRODUCT DETAILS





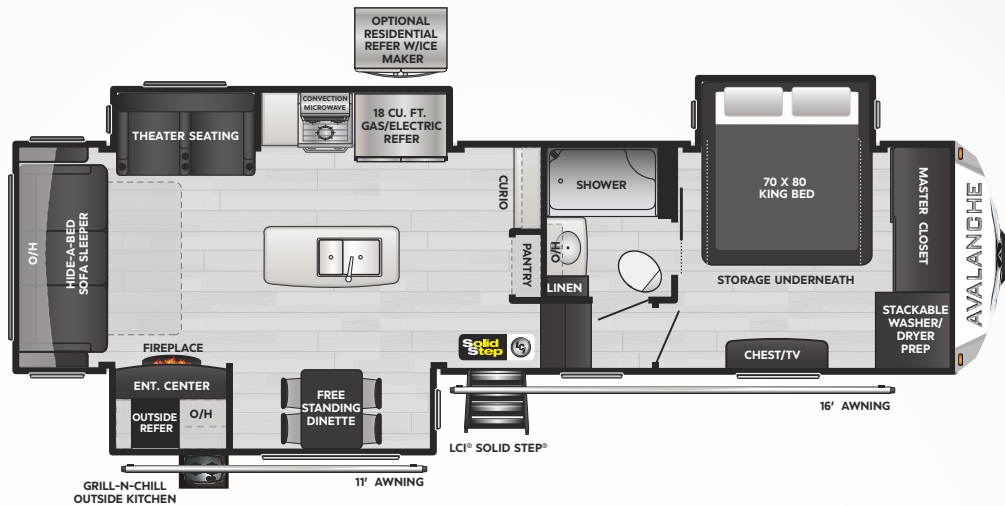

**NEW! 302RS** | WEIGHT 11755 | LENGTH 34' 9"

▪ REAR LIVING, MASTER SUITE W/ OUTDOOR KITCHEN

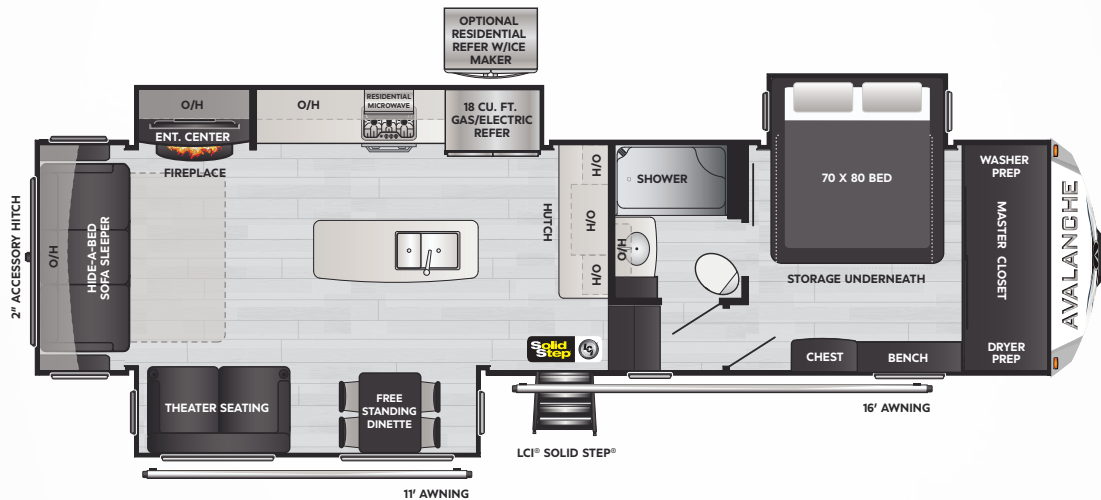

**322RL** | WEIGHT 12168 | LENGTH 36' 9"

▪ REAR LIVING, MID-KITCHEN, MASTER CLOSET



"We have the Avalanche 390DS and there is nothing like this model on the market. The double suite, huge loft and spacious living space checked all of our boxes. We've been traveling in it for about 10 months and we love our Avalanche!"



@OURBAREFOOTTRAVEL — AVALANCHE 390DS OWNERS

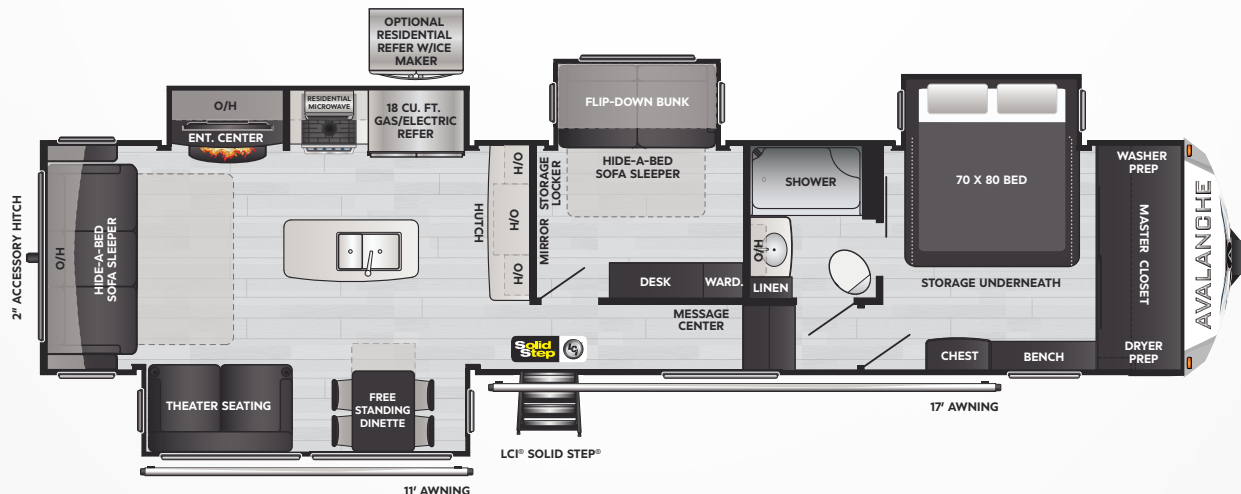
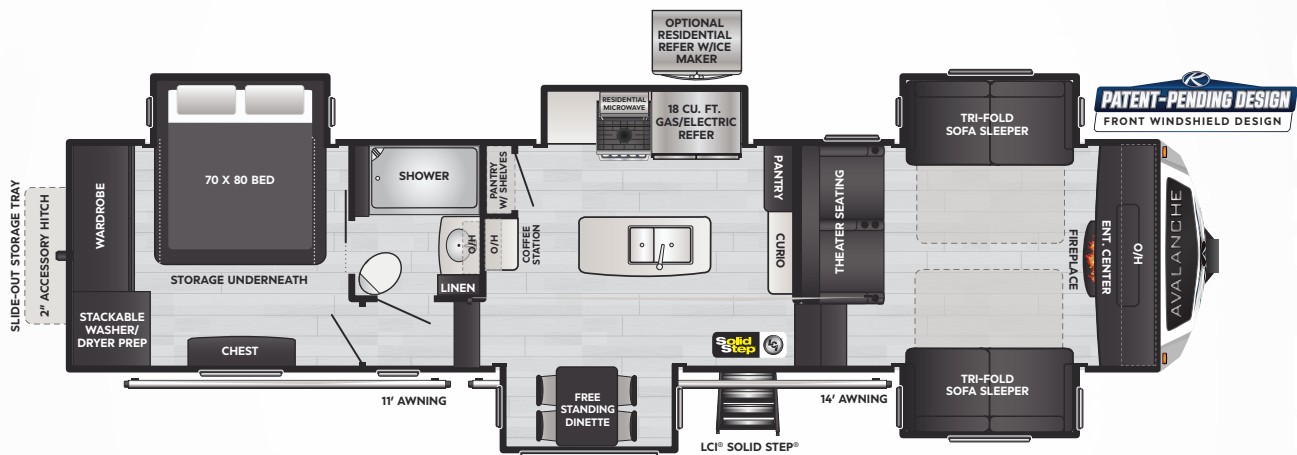
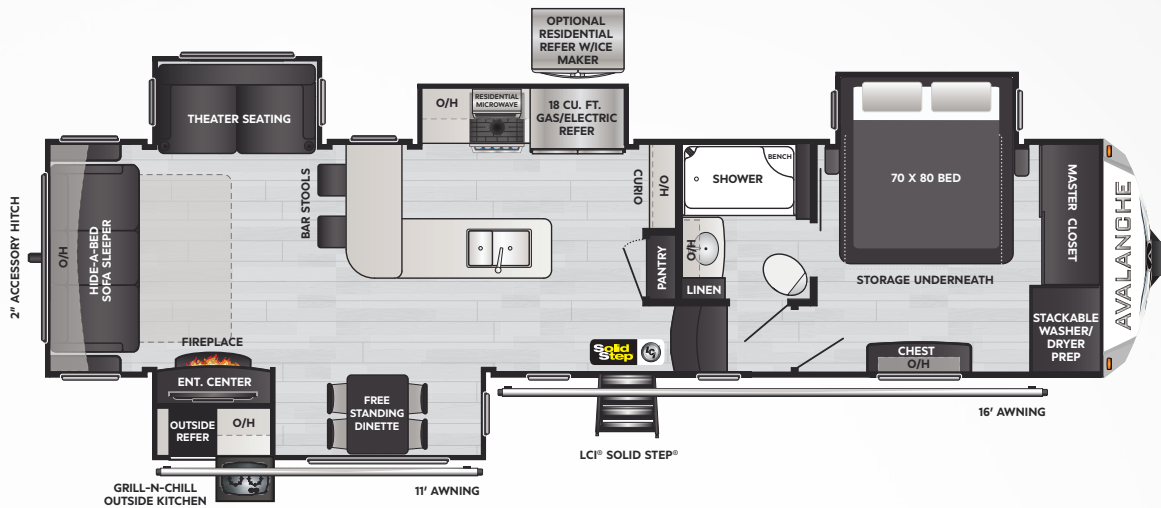

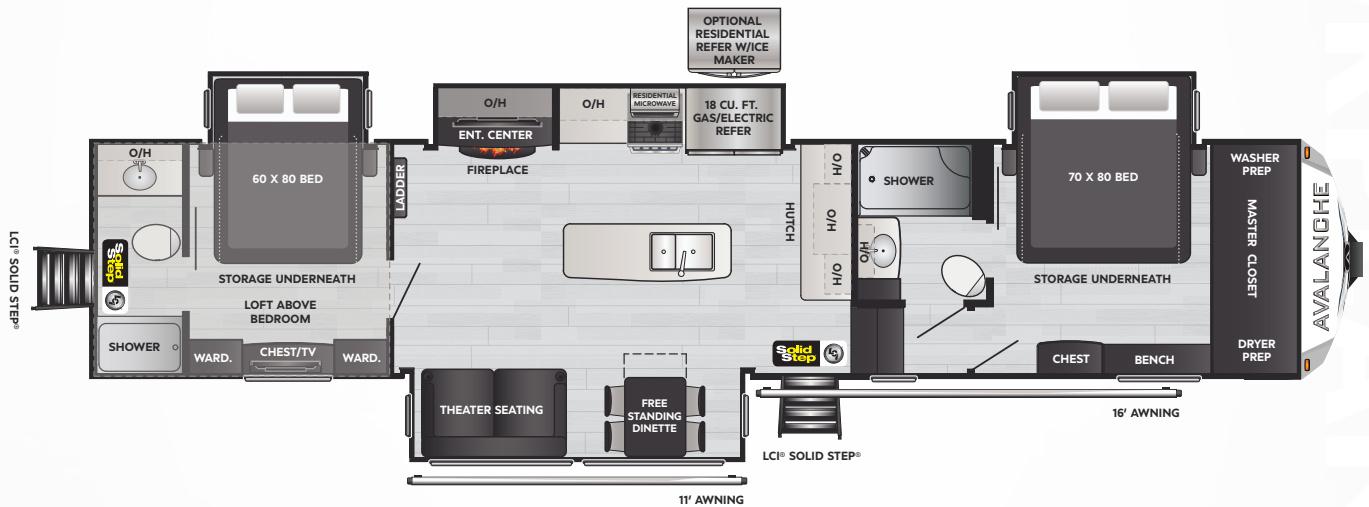
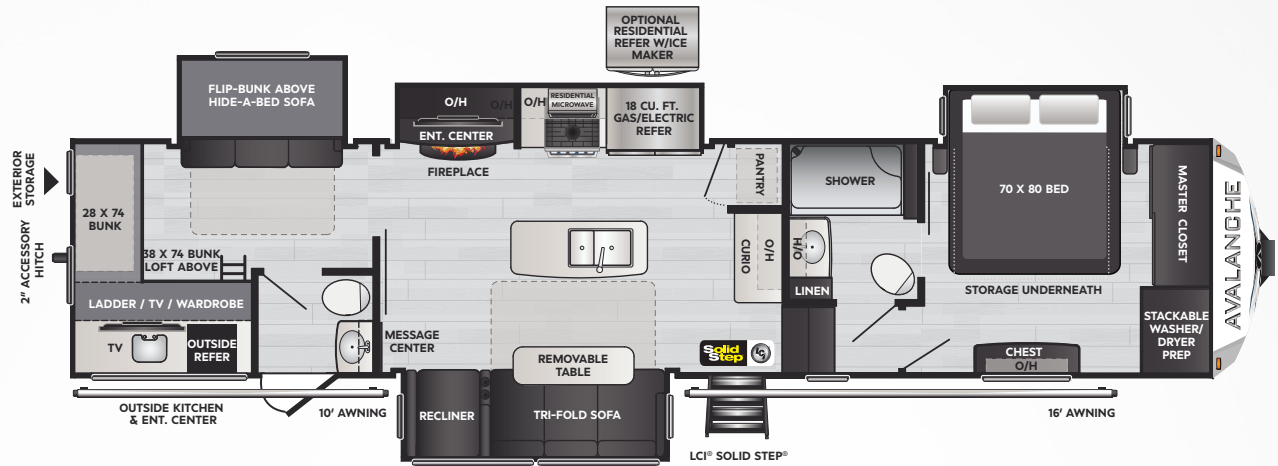

| MODEL | WEIGHT | CARRYING CAPACITY | HITCH WEIGHT | FRESH WATER** | WASTE WATER | GRAY WATER | LPG | LENGTH* | WIDTH | HEIGHT | AWNING   |
|-------|--------|-------------------|--------------|---------------|-------------|------------|-----|---------|-------|--------|----------|
| 302RS | 11755  | 3245              | 2555         | 66            | 49          | 83         | 60  | 34' 9"  | 8' 4" | 13' 2" | 16' /11' |
| 322RL | 12168  | 3332              | 2435         | 66            | 49          | 83         | 60  | 36' 9"  | 8' 4" | 13' 2" | 17' 11'  |
| 338GK | 12808  | 2692              | 2700         | 66            | 49          | 83         | 60  | 37' 11" | 8' 4" | 13' 2" | 19' /11' |
| 360FL | 13875  | 2625              | 3000         | 66            | 49          | 83         | 60  | 40' 1"  | 8' 4" | 13' 4" | 14' /11' |
| 372MB | 13466  | 3034              | 2650         | 66            | 49          | 83         | 60  | 41' 5"  | 8' 4" | 13' 4" | 11' /17' |
| 378BH | 13908  | 2592              | 2820         | 66            | 83          | 117        | 60  | 40' 7"  | 8' 4" | 13' 4" | 16' /10' |
| 390DS | 14384  | 2116              | 2740         | 66            | 98          | 132        | 60  | 42' 11" | 8' 4" | 13' 4" | 16' /11' |



## TAKE CHARGE OF HOW YOU CAMP

EXCEPTIONAL QUALITY, IMPOSSIBLY VERSATILE, SolarFlex™  
IS SHATTERING CUSTOMER'S EXPECTATIONS OF FACTORY-INSTALLED SOLAR POWER.  
EXCLUSIVELY AVAILABLE ON ALL KEYSTONE RV MODELS.



Relieve battery anxiety with legendary Lithium-ion deep cycle batteries — the ultimate replacement for lead acid. Lightweight, reliable, and longer-lasting, Dragonfly Energy batteries are made in the USA and available exclusively from Keystone RV and authorized dealers.

## MY KEYSTONE OWNER'S APP

THE ONLY APP YOU'LL NEED...

» MANUALS & QUICK START GUIDES

» HOW-TO VIDEOS

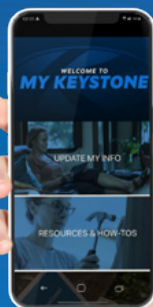

» FIRST-TIME CAMPER'S ADVICE

» ACCESS TO YOUR RV'S MOBILE APPS

Available for iOS  
and Android devices.



FOLLOW US FOR THE LATEST!



DISCLAIMER: Product information is as accurate as possible as of the date of publication of this brochure. All features, floor plans, and specifications in this brochure are subject to change without notice. Please also consult Keystone's web site at [www.keystonerv.com](http://www.keystonerv.com) for more current product information and specifications. Tow Vehicle Disclaimer. CAUTION: Owners of Keystone recreational vehicles are solely responsible for the selection and proper use of tow vehicles. All customers should consult with a motor vehicle manufacturer or their dealer concerning the purchase and use of suitable tow vehicles for Keystone products. Keystone disclaims any liability or damages suffered as a result of the selection, operation, use or misuse of a tow vehicle. KEYSTONE'S LIMITED WARRANTY DOES NOT COVER DAMAGE TO THE RECREATIONAL VEHICLE OR THE TOW VEHICLE AS A RESULT OF THE SELECTION, OPERATION, USE OR MISUSE OF THE TOW VEHICLE. \*Length is defined as the distance from the centerline of hitch pin/coupler to rear bumper of trailer. \*\* Fresh water capacity includes water heater. Please review owner's manual prior to purchase for more information on service warranties, extended use, towing and maintenance. Owner's manuals can be found at [keystonerv.com](http://keystonerv.com). PRINT 09.2022