

Jayco | Seneca & Seneca Prestige Super Class C Motorhome

# SENECA

POWER & LUXURY COMBINED



**2+3**  
YEAR | YEAR  
WARRANTY



# INTERIOR DESIGN



## CARBON



Wood



Floor



Countertop



Main Fabric

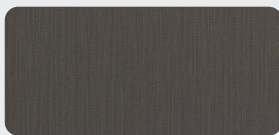

Furniture

## BRIGHTON



Wood

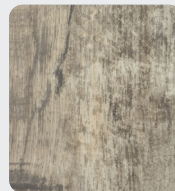

Floor

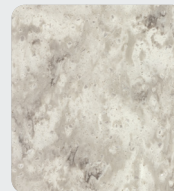

Countertop

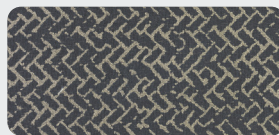

Main Fabric



Furniture



## OPTIONS

A



15 Cu. Ft. Fridge

B



Theater Sofa

C



Hide-a-bed

D



Freestanding Dinette

## 37K OPTIONS: A, D



## 37L OPTIONS: A, B

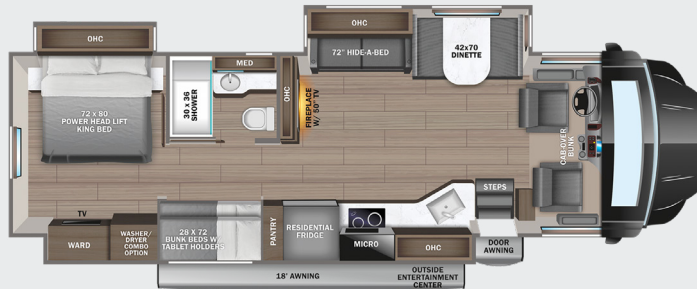

## 37M OPTIONS: A, C, D

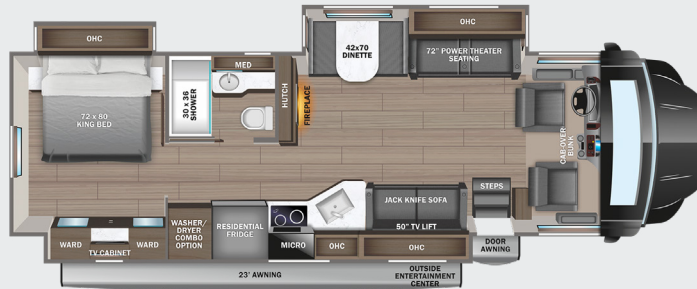

## EXTERIOR SELECTIONS



Axis Full-Body Paint



Marmot Full-Body Paint



Marten Full-Body Paint



Ocelot Full-Body Paint

# STANDARDS & OPTIONS

## CUSTOMER VALUE PACKAGE

JRIDE® PREMIUM: Computer-balanced driveshaft, rear air suspension, heavy-duty rear stabilizer bar, full air brakes, SACHS shocks

One-piece, seamless, fiberglass front and rear caps  
Automotive-bonded, panoramic window in front cap with power shade

Dual-pane, tinted, safety-glass windows  
(2) 15,000 BTU A/C units with heat pump on main A/C  
Electric patio awning with LED lights  
2,000W pure sine wave inverter  
Power cord reel with 50 amp service  
Sony® infotainment center with Apple® CarPlay and Android Auto™

Backup and side-view cameras  
Residential refrigerator  
Convection microwave oven

## DRIVING

Freightliner® S2RV chassis  
GVWR- 31,000 lb.  
GCWR- 43,000 lb.  
Cummins® ISB 6.7L 360 HP diesel engine with 800 ft.-lb. torque  
Allison® 3000 MH automatic transmission  
185 amp alternator  
G-rated highway tires- 275/80R22.5  
Alcoa® aluminum wheels  
Engine exhaust brake  
12,000 lb. rear hitch receiver  
7-pin plug  
Dual 12V chassis batteries  
100 gal. fuel tank  
10 gal. DEF tank  
Deluxe heated, remote-controlled, side-view mirrors  
6-way power driver and passenger seats  
Power windows and door locks  
Tilt steering wheel  
A/C and cruise control  
Auxiliary start switch

## EXTERIOR

StrongholdVBL™ roof, floor and sidewalls  
Bead-foam insulation (R-24 max roof, R-9 max floor and R-8 max walls)  
One-piece, seamless, crowned fiberglass roof  
Premium Sikkens full-body paint  
Automatic hydraulic leveling jacks  
Entrance door with industry's largest travel-view window  
Electric-powered entrance step  
Slideout awning(s)  
Exterior entertainment center with outside speakers and LED HD Smart TV mounted on swivel bracket  
Winegard® In-motion satellite dish  
Carpeted, full pass-through storage compartments with lockable slam-latch doors  
24.5 gal. propane tank (83 lb.)  
LP quick-connect hookup  
Thetford® Sani-Con Turbo macerator system  
Exterior utility center  
Winterization drain system  
Black tank flush  
Outside shower  
12V demand water pump  
Onan® 8,000W Quiet Diesel generator and auto-gen start

Transfer switch with reverse polarity protection  
(4) 6V AGM (220Ah) house batteries on slideout tray  
200W solar panel with dual controller  
Third brake light

## INTERIOR

Custom-molded ABS surround in cab-over area  
Overhead bunk with 750 lb. capacity  
JAYCOMMAND® powered by Firefly  
84 in. interior ceiling height with padded vinyl ceiling  
High-intensity, recessed LED ceiling lights  
Vinyl plank flooring  
Raised-panel hardwood cabinetry throughout  
Deluxe hidden cabinet hinges  
Ball-bearing drawer guides  
Jayco-exclusive, easy-operation legless dinette table  
2-point lap safety belts in all designated seating locations  
30,000 BTU auto-ignition furnace  
10 gal. gas/electric water heater  
Electric fireplace  
LED HD Smart TV in living area  
Cable TV hookup with RG-6 coax and video selector switch  
Winegard 2.0 Wi-fi/4G antenna  
Wood-framed kitchen window with spice cabinets  
2-burner induction cooktop  
LED-lit, solid-surface kitchen countertops with recessed stainless steel sink and sink covers  
Water filtration system  
Shower with decorative surround, glass door, skylight and light  
Porcelain toilet with foot flush  
Recessed stainless-steel sink  
Powered roof vent in bathroom with wall switch  
Walk-around, king-size bed with power head lift, bedspread and nightstands  
USB port and wireless charging in nightstands  
Under-bed storage  
LED HD Smart TV in bedroom  
Large wardrobes  
Bunks with industry-exclusive 300 lb. capacity each (37L)  
Wall-mounted tablet holder in each bunk (37L)  
Smoke alarm  
Carbon monoxide detector

## OPTIONS

Power theater seating (N/A 37K, STD on 37M)  
Freestanding table with 4 chairs (N/A 37L)  
15 cu. ft. 12V refrigerator  
Combination washer/dryer (N/A 37K)  
Stackable washer/dryer (37K)  
Hide-a-bed sofa (37M)  
Canadian Shaw® TRAV'LER® satellite dish  
Winegard® TRAV'LER® satellite dish - DIRECTV®  
Slide-out tray with 12V refrigerator cooler in basement

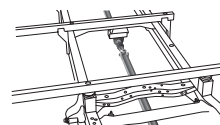

### COMPUTER-BALANCED DRIVESHAFT

Ensures smooth and efficient power transfer to the wheels

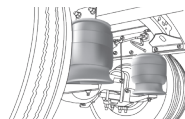

### REAR AIR SUSPENSION

Softens ride and improves handling

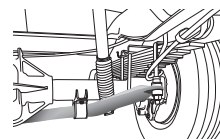

### HEAVY-DUTY REAR STABILIZER BAR

A larger bar and polyurethane bushings, instead of rubber, transfer power faster for extra support, more stability and easier handling

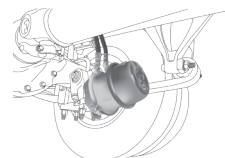

### FULL AIR BRAKES

Deliver robust stopping power, even on grades

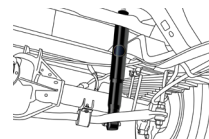

### SACHS SHOCKS ABSORBERS

Large diameter tube design pairs gas and hydraulics to resist heat and pressure while independently adjusting to changing road conditions

FLOORPLAN	GVWR (lbs.)	GCWR (lbs.)	WHEEL BASE	OVERALL LENGTH	EXTERIOR HEIGHT WITH SATELLITE AND A/C	EXTERIOR WIDTH	INTERIOR HEIGHT	FRESH WATER CAPACITY (gal.)	GRAY WASTE WATER CAPACITY (gal.)	BLACK WASTE WATER CAPACITY (gal.)
37K	31,000	43,000	279"	39' 4"	13' 4"	101"	84"	72	51/40	40/23
37L	31,000	43,000	279"	39' 4"	13' 4"	101"	84"	72	50/31	50
37M	31,000	43,000	279"	39' 4"	13' 4"	101"	84"	72	50/31	50



OPTIONS

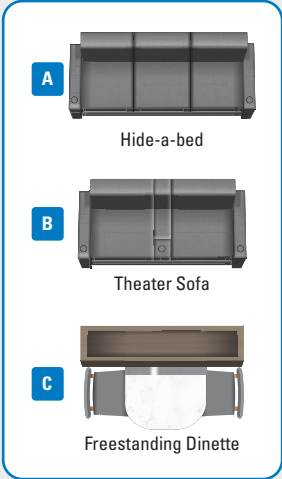

**37K** OPTIONS: C

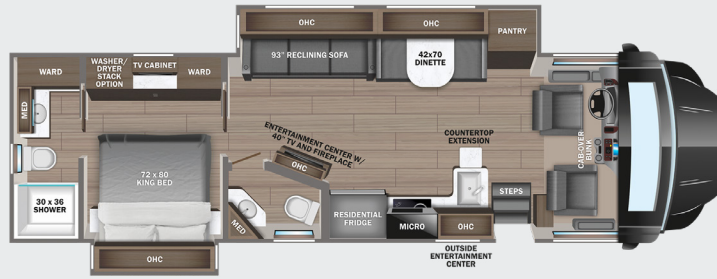

**37L** OPTIONS: B

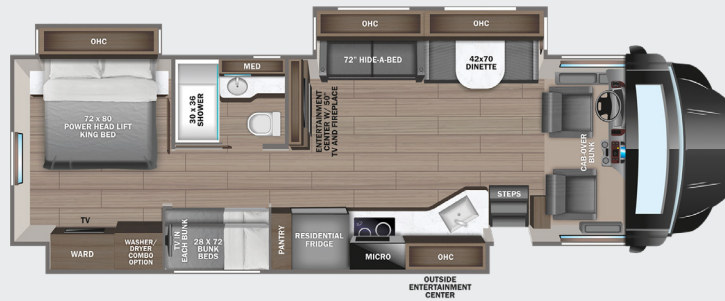

**37M** OPTIONS: A, C

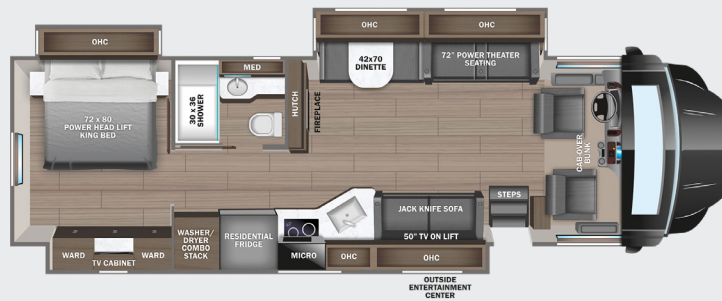

EXTERIOR SELECTIONS

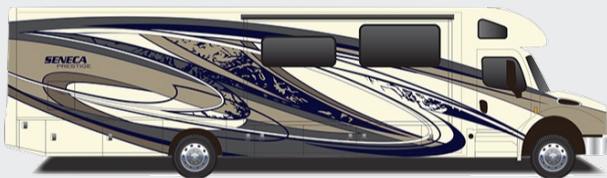

Beige Marvel Full-Body Paint

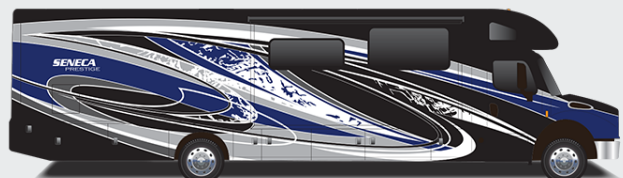

Blue Marvel Full-Body Paint

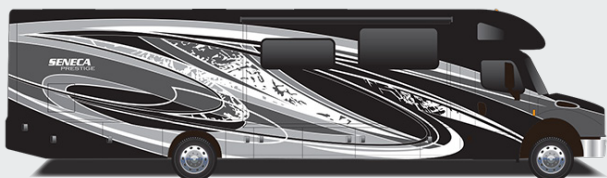

Grey Marvel Full-Body Paint

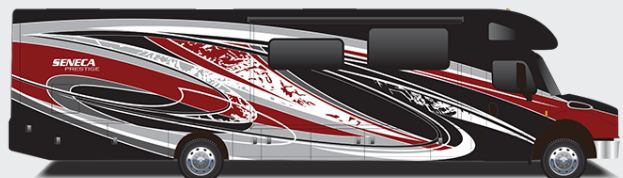

Red Marvel Full-Body Paint



# STANDARDS & OPTIONS

## CUSTOMER VALUE PACKAGE

JRIDE® PREMIUM: Computer-balanced driveshaft, rear air suspension, heavy-duty rear stabilizer bar, full air brakes, SACHS shocks

Dual-pane, tinted, safety-glass windows

Roof-mounted Girard® patio awning with LED lights

2,000W pure sine wave inverter

Power cord reel with 50 amp service

Aqua-Hot® 250D hydronic water and heating system with 5 in. LED screen

9 in. Sony® infotainment center with Apple CarPlay® and Android Auto™

Backup and side-view cameras

21 cu. ft. side-by-side residential refrigerator with ice and water in door

Flush-mounted convection microwave

## DRIVING

Freightliner® S2RV chassis

Cummins® ISB 6.7L 360 HP diesel engine with 800 ft.-lb. torque

Allison® 3000 MH automatic transmission

Variable geometry engine exhaust brake

185 amp alternator

Michelin® tires- 275/80R 22.5 14 ply

12,000 lb. rear hitch receiver

7-pin plug

Dual 12V chassis batteries

100 gal. fuel tank

10 gal. DEF tank

6-way power driver and passenger seats

Auxiliary start switch

Privacy curtains for cab area

Color-coordinated carpeted floor mat

## EXTERIOR

Onan® 8,000W diesel generator with auto-gen start

(4) 6V AGM (220Ah) house batteries on slideout tray

200W solar panel with dual controller

Dual 15,000 BTU A/C unit with heat pumps

5,000 BTU thermostat-controlled electric fireplace

Thetford® Sani-Con Turbo macerator system

Exterior utility center

Winterization drain system

Black tank flush

Outside shower

12V demand water pump

Water filtration system

Power windows and door locks

Tilt and telescoping leather-wrapped steering wheel

StrongholdVBL™ roof, floor and sidewalls for superior insulation and sound absorption

One-piece, seamless, crowned fiberglass roof

Bead-foam insulation (R-24 max roof, R-9 max floor, R-5 max walls)

One-piece, seamless, fiberglass front and rear caps

Automotive-bonded panoramic window in front cap with power shade

Premium Sikkens full-body paint

Automatic hydraulic leveling jacks

Alcoa® aluminum wheels

Exterior entertainment center with outside speakers, LED TV mounted on swivel bracket and AM/FM radio

Winegard® In-motion satellite dish

Deluxe heated, remote-controlled, side-view mirrors

Entrance door with industry's largest travel-view window

Electric-powered entrance step

Slideout awning(s)

Chrome exterior baggage door handles and locks

Carpeted, full pass-through storage compartments with lockable slam-latch doors

## INTERIOR

Custom-molded ABS surround in cab-over area

Overhead bunk with 750 lb. capacity and safety net with 300 lb. capacity

Collapsible bunk ladder

JAYCOMMAND™ powered by Firefly offers control of important coach features via LED touchscreen or mobile app

High-intensity recessed LED ceiling lights

Raised-panel hardwood cabinetry and stiles throughout

Deluxe hidden cabinet hinges

Matte-finish woodgrain porcelain floor tile with heated floor mat

Entegra-exclusive, easy-operation legless dinette table

Car seat tethers on forward-facing dinette seats

2-point lap safety belts in all designated seating locations

50 in. LED TV in living area (40 in. on 37K)

Cable TV hookup with RG-6 coax and video selector switch

Wood-framed kitchen window with spice cabinets

2-burner induction cooktop with LED display

Solid-surface kitchen countertop with large recessed stainless steel sink with sink covers

One-piece, fiberglass shower with glass door, skylight and light

Porcelain toilet with foot flush

Solid-surface bathroom sink

Powered roof vent in bathroom with wall switch

Walk-around, king-size bed with bedspread and nightstands

32 in. Smart LED TV in bedroom

Large wardrobes

Smoke alarm

Carbon monoxide detector

## OPTIONS

Power theater seating (37L only)

Freestanding table with 4 chairs (N/A 37L)

Hide-a-bed sofa (37M only)

Stackable washer/dryer

Winegard® TRAV'LER® satellite dish - DIRECTV®

Winegard® TRAV'LER® satellite dish - Dish Network®

Canadian Shaw® TRAV'LER® satellite dish

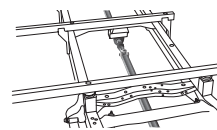

### COMPUTER-BALANCED DRIVESHAFT

Ensures smooth and efficient power transfer to the wheels

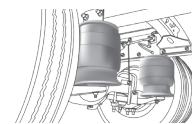

### REAR AIR SUSPENSION

Softens ride and improves handling

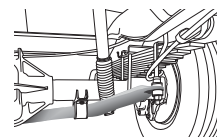

### HEAVY-DUTY REAR STABILIZER BAR

A larger bar and polyurethane bushings, instead of rubber, transfer power faster for extra support, more stability and easier handling

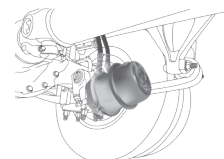

### FULL AIR BRAKES

Deliver robust stopping power, even on grades

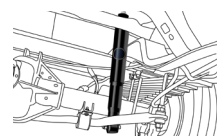

### SACHS SHOCKS ABSORBERS

Large diameter tube design pairs gas and hydraulics to resist heat and pressure while independently adjusting to changing road conditions

FLOORPLAN	GVWR (lbs.)	GCWR (lbs.)	WHEEL BASE	OVERALL LENGTH	EXTERIOR HEIGHT WITH SATELLITE AND A/C	EXTERIOR WIDTH	INTERIOR HEIGHT	FRESH WATER CAPACITY (gal.)	GRAY WASTE WATER CAPACITY (gal.)	BLACK WASTE WATER CAPACITY (gal.)
37K	31,000	43,000	279"	39' 4"	13' 4"	101"	84"	72	51/40	40/23
37L	31,000	43,000	279"	39' 4"	13' 4"	101"	84"	72	50/31	50
37M	31,000	43,000	279"	39' 4"	13' 4"	101"	84"	72	40/40	33/23



# INTERIOR DESIGN



## WOOD SELECTIONS

STONEWALL GREY

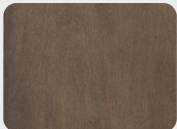

Wood

LINEN

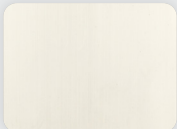

Wood

AUBURN MAPLE



Wood

ALMOND MAPLE



Wood

Accent

Accent

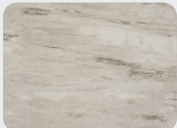

Flooring

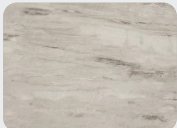

Flooring

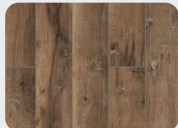

Flooring



Flooring

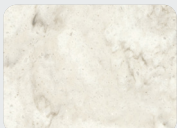

Countertop

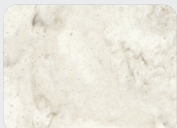

Countertop

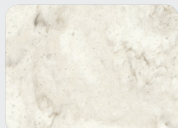

Countertop

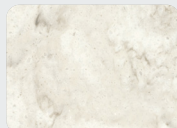

Countertop

## FABRIC SELECTIONS

WALNUT

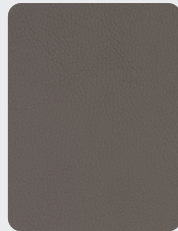

Furniture

BIRCH

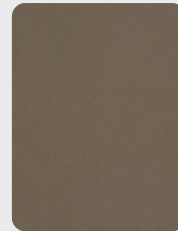

Furniture

ASPEN

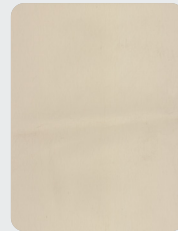

Furniture

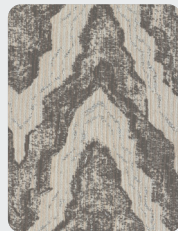

Main Fabric



Main Fabric



Main Fabric



# THE JAYCO DIFFERENCE

# FREIGHTLINER



## A FOUNDATION BUILT TO DELIVER FOR THE LONG HAUL

1. **Freightliner® S2RV chassis**
2. **Cummins® ISB 6.7L 360 HP diesel engine** features a 43,000-lb. GCWR and a 31,000-lb. GVWR; a 12,000-lb. -rated hitch; 800-lb. torque; and a gas-strut assisted hood for easy engine access
3. **Allison® 3000 MH automatic transmission** delivers power, control and traction
4. **100-gal., single-fill, between-the-rails fuel tank**
5. **Michelin® 275/80R 22.5" tires**

**2+3**  
YEAR | YEAR  
LIMITED | STRUCTURAL  
WARRANTY

### TRAVEL WITH CONFIDENCE • NO ONE OFFERS A BETTER WARRANTY

At Jayco, we build our RVs to handle every adventure, then back them with our industry-leading 2+3 limited warranty. Our 2-year limited warranty has you covered for 2 camping seasons. That's 730 days. In addition, our 3-year structural limited warranty has you covered for 3 camping seasons or 1,095 days. You won't find a better limited warranty in the business, because the only strings that we attach are those that deliver the ultimate in reliability. That's the Jayco difference. So go explore. For a copy of our 2-year limited + 3-year structural limited warranty with complete terms and conditions, please contact your local Jayco dealer.

Meet your Jayco Dealer



Scan QR  
code for  
specification  
definitions

Some specs at the time of print may include estimates.  
For the most updated information, please visit  
[Jayco.com/seneca](http://Jayco.com/seneca) or [Jayco.com/seneca-prestige](http://Jayco.com/seneca-prestige)

**Jayco, Inc. | P.O. Box 460 | Middlebury, IN 46540**

See dealer for further information and prices. All information in this brochure and on [www.jayco.com](http://www.jayco.com) is the latest available at the time of publication approval. Jayco reserves the right to make changes and to discontinue models without notice or obligation. Photography may show optional equipment or props used for decoration purposes only. RVs built for sale in Canada may differ to conform to Canadian codes. JAYCO and the JAYCO BIRD IN FLIGHT are registered trademarks of Jayco, Inc. Printed in USA 3/23 ©2023 Jayco, Inc. 2032606.2023



**Jayco - Part of the Jayco Family of Companies**