

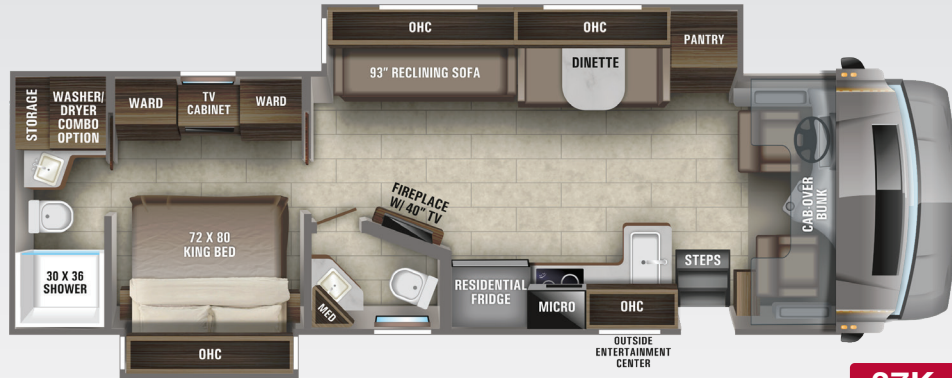

ENTEGR
COACH®

2021 ACCOLADE XL



37K

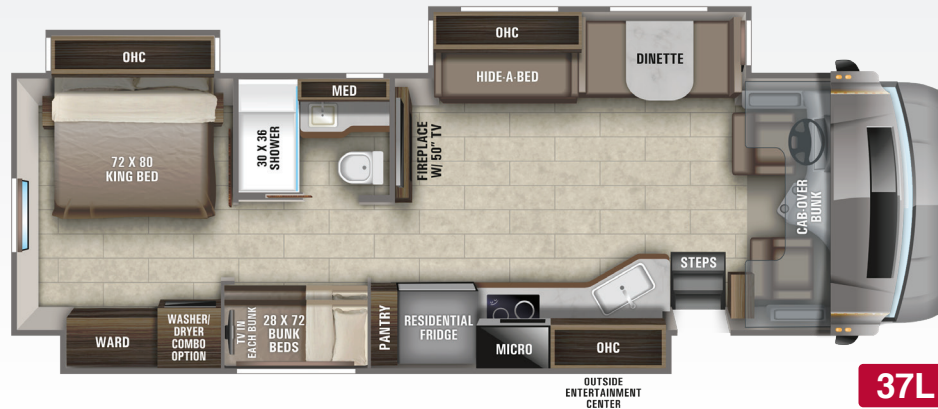

37L

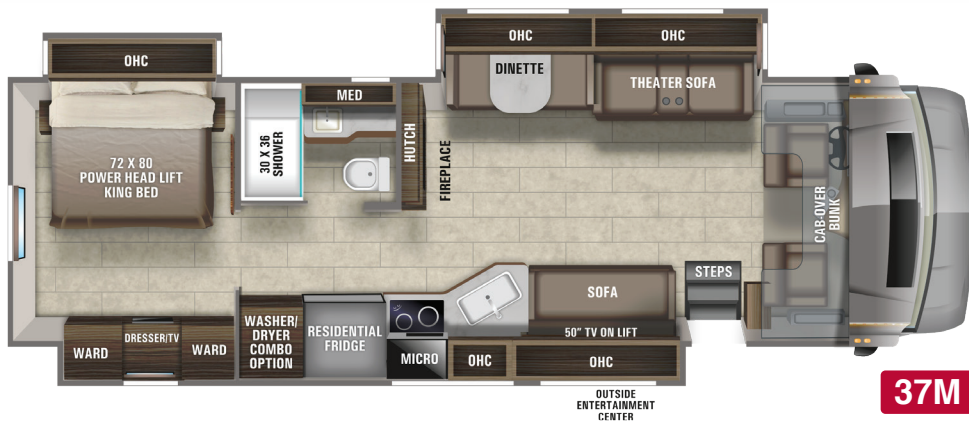

37M

FULL-BODY PAINT SELECTIONS



Beige Lightning

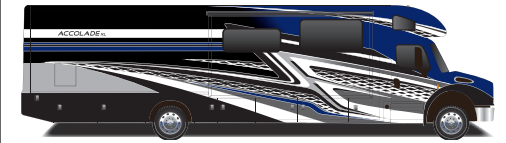

Blue Lightning

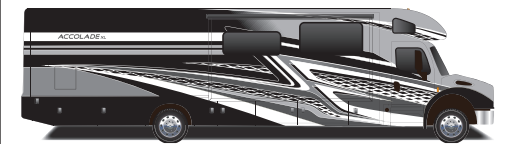

Grey Lightning

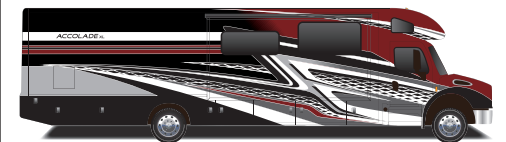

Red Lightning

2021 ACCOLADE XL

STANDARDS & OPTIONS

CUSTOMER VALUE PACKAGE

E-Z DRIVE™ PREMIER: Computer-balanced driveshaft, rear air suspension, heavy-duty rear stabilizer bar, full air brakes, SACHS shocks
 Dual-pane, tinted, safety-glass windows
 Roof-mounted Girard® NOVA II dual-pitched patio awning with LED lights
 2,000-watt pure sine wave inverter
 Power cord reel with 50-amp service
 Aqua-Hot® 250D hydronic water and heating system
 9" Sony® infotainment center with Apple CarPlay® and Android Auto™
 Backup and side-view cameras
 21-cu. ft. side-by-side residential refrigerator with ice and water in door
 Flush-mounted convection microwave

STANDARD CHASSIS EQUIPMENT

Freightliner® S2RV front engine diesel "Super-C" cab chassis
 Cummins® ISB 6.7L 360 HP diesel engine with 800 ft.-lb. torque
 Allison® 3000 MH automatic transmission
 Variable geometry engine exhaust brake
 GVWR-31,000 lb.
 GCWR - 43,000 lb.
 Front axle - 10,000 lb.
 Drive axle - 21,000 lb.
 185-amp alternator
 Michelin® tires - 275/80R 22.5 14 ply
 12,000-lb. rear hitch receiver
 7-pin plug
 Dual 12V chassis batteries - 1900 CCA
 100-gal. fuel tank
 10-gal. DEF tank
 Power windows and door locks
 Tilt and telescoping leather-wrapped steering wheel

HEAT, A/C, POWER & WATER EQUIPMENT

Dual 15,000-BTU A/C unit with heat pumps
 (4) 6V AGM (220Ah) house batteries on slideout tray
 Solar prep
 Dual 15,000-BTU A/C unit with heat pumps
 Touchstone electric 5,000 BTU thermostat controlled fireplace
 Thetford® Sani-Con Turbo Macerator system
 Exterior utility center
 Winterization drain system
 Black tank flush
 Outside shower
 12V demand water pump
 Water filtration system

STANDARD EXTERIOR EQUIPMENT

TuffShell™ vacuum-bond laminated roof, floor and sidewalls
 One-piece, seamless, crowned fiberglass roof
 Bead-foam insulation (R-24 max roof, R-9 max floor, R-5 max walls)
 One-piece, seamless, fiberglass front and rear caps
 Automotive-bonded panoramic window in front cap with power shade
 Premium Sikkens full-body paint
 Automatic hydraulic leveling jacks
 Alcoa® aluminum rims
 Exterior entertainment center with outside speakers, LED TV mounted on swivel bracket and single-disc DVD/CD, Bluetooth, USB and AM/FM radio
 Winegard® In-motion satellite dish
 Deluxe heated, remote-controlled, side-view mirrors
 Entrance door with industry's largest travel-view window
 Electric-powered entrance step
 Slideout cover awnings
 Chrome exterior baggage door handles and locks
 Carpeted, full pass-through storage compartments with lockable slam latch doors
 Flush-mount LED marker lights

COCKPIT AMENITIES

Power driver and passenger seats
 Auxiliary start switch
 Privacy curtains for cab area
 Color-coordinated carpeted floor mat

STANDARD INTERIOR EQUIPMENT

Custom-molded ABS surround in cab-over area
 Overhead bunk with 750 lb. capacity
 VegaTouch touchpad system for complete integration of coach controls (mobile app available)
 High-intensity recessed LED ceiling lights
 Raised-panel high-gloss hardwood cabinetry and stiles throughout
 Deluxe hidden cabinet hinges
 High-gloss, polished porcelain floor tile with heated floor mat
 Multi-functional legless dinette table
 50 in. LED TV in living area (40 in. on 37K)
 Sony Blu-Ray™ with HDMI® connections
 Cable TV hookup with RG-6 coax and video selector switch
 Wood-framed kitchen window with spice cabinets
 2-burner induction cooktop with LED display
 Solid-surface kitchen countertop with large recessed stainless steel sink with sink covers
 One-piece, fiberglass shower with glass door, skylight and light
 Porcelain toilet with foot flush
 Solid-surface bathroom sink

Powered roof vent in bathroom with wall switch
 Walk-around, King-sized bed with bedspread and nightstands
 32" LED TV in bedroom
 Large wardrobes

STANDARD SAFETY EQUIPMENT

2-point lap safety belts in all designated seating locations
 Third brake light
 Porch light with clear lens
 Smoke alarm
 Carbon monoxide detector

OPTIONS

Power theater seating (N/A 37K)
 Canadian Shaw® TRAV'LER® satellite dish
 Winegard® TRAV'LER® satellite dish - DIRECTV®
 Winegard® TRAV'LER® satellite dish - Dish Network®
 Combination washer/dryer (37K)
 Stackable washer/dryer (37L, 37M)
 Freestanding table with 4 chairs

ACCOLADE WARRANTY

2+3
 YEAR | YEAR
 LIMITED | STRUCTURAL
 WARRANTY

NO ONE OFFERS A BETTER WARRANTY

At Entegra Coach, we build our RVs to handle every adventure, then back them with our industry-leading 2+3 Warranty. Our 2-year limited warranty has you covered for 2 camping seasons. That's 730 days. In addition, our 3-year limited structural warranty has you covered for 3 camping seasons or 1,095 days. You won't find a better warranty in the business, because the only strings we attach are those that deliver the ultimate in reliability. For a copy of our 2-year limited + 3-year limited structural warranty with complete terms and conditions, please contact your local Entegra Coach dealer.



E-Z Drive™ Premier is a powerful blend of precise handling and renowned stability. Hands down, it's the best ride. Experience E-Z Drive for yourself—visit your local dealer and take a test drive.

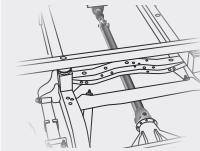

COMPUTER-BALANCED DRIVESHAFT
 Ensures smooth and efficient power transfer to the wheels

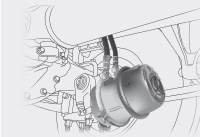

FULL AIR BRAKES
 Deliver robust stopping power, even on grades

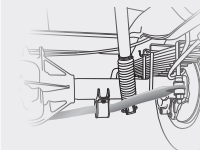

HEAVY DUTY REAR STABILIZER BAR
 A larger bar and polyurethane bushings, instead of rubber, transfer power faster for extra support, more stability and easier handling

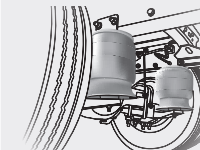

REAR AIR SUSPENSION
 Softens ride and improves handling

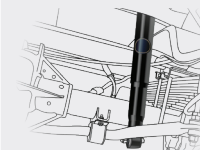

SACHS SHOCK ABSORBERS
 Large-diameter tube design pairs gas and hydraulics to resist heat and pressure while independently adjusting to and changing road conditions

Floorplan	GVWR (lbs.)	GCWR (lbs.)	Wheel Base	Exterior Length	Exterior Height	Exterior Width	Interior Height	Fresh Water Capacity (gal.)	Gray Waste Water Capacity (gal.)	Black Waste Water Capacity (gal.)	Propane (gal.)
37K	31,000	43,000	279"	39' 4"	13' 4"	101"	84"	72	51/41	40/23	24.5
37L	31,000	43,000	279"	39' 4"	13' 4"	101"	84"	72	50/31	50	24.5
37M	31,000	43,000	279"	39' 4"	13' 4"	101"	84"	72	40/40	33/23	24.5

It is important for your safety and enjoyment that you are aware of the weights and tow ratings of the RV you select. Consult a competent advisor for questions or advice. Whether you are new to RVing or a veteran, get a feel for the performance of your RV before heading out on the roadways. When you tow a vehicle with your RV, you must drive differently than when you drive a single vehicle. Practice hooking up, driving, backing up and braking in a safe environment or seek out professional instruction. Jayco affixes a weight label to each RV which lists weight information for that vehicle. Refer to that label to verify the vehicle will meet your requirements. Gross Vehicle Weight Rating (GVWR): The maximum permissible weight of the motorhome, including the Unloaded Vehicle Weight (UUV) plus passengers, personal items, all cargo, fluids, options and dealer-installed accessories. The GVWR is equal to or greater than the sum of the UUV and the Cargo Carrying Capacity. Gross Combined Weight Rating (GCWR): The maximum allowable combined weight of the motorhome used as a tow vehicle and the attached towed vehicle. (GAWR): The maximum allowable weight each axle assembly is designed to carry.

