



# Ahara

FIFTH WHEELS



**2023**  
FLOOR PLAN GUIDE



EastToWestRV.com/Ahara  
A DIVISION OF FOREST RIVER



# THE AHARA LUXURY FIFTH WHEEL IS THE NEWEST ADDITION TO THE EAST TO WEST FAMILY.

AHARA is a Sanskrit term used in yoga philosophy to refer to the vehicle, or support, of consciousness and is one of the basic principles upon which health, happiness and harmony rests. The AHARA name perfectly embodies the spirit of this thoughtfully designed luxury fifth wheel.



HITCH (LBS.): 2,185 UVW (LBS.): 11,759 CCC (LBS.): 3,741 LENGTH: 34' 9"  
EXTERIOR HEIGHT: 13' 5" WIDTH: 102" TANKS (F/G/B): 64 / 88 / 44 AWNING: 16' & 10' 6"

## 325RL

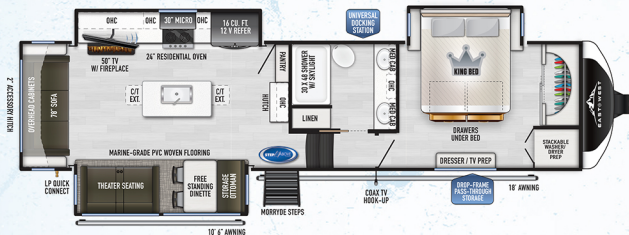

HITCH (LBS.): 2,273 UVW (LBS.): 12,345 CCC (LBS.): 3,928 LENGTH: 37' 4"  
EXTERIOR HEIGHT: 13' 5" WIDTH: 102" TANKS (F/G/B): 64 / 88 / 44 AWNING: 18' & 10' 6"

## 365RL



**AHARA** enters the 2023 model year with four floor plans and one beautiful interior décor, Barrington Maple. Standard features include 24" residential oven, 6-point hydraulic automatic leveling system, high-efficiency triple air conditioning system, high-gloss laminated sidewalls with Azdel composite panels and 102" wide-body chassis with drop-frame pass-through storage compartment.



HITCH (LBS.): 2,605 U/VW (LBS.): 14,109 CCC (LBS.): 2,496 LENGTH: 41' 5"  
EXTERIOR HEIGHT: 13' 6" WIDTH: 102" TANKS (F/G/B): 64 / 88 / 88 AWNING: 16' & 10' 6"

# 378BH-OK



HITCH (LBS.): 3,190 U/VW (LBS.): 14,559 CCC (LBS.): 2,631 LENGTH: 41' 7"  
EXTERIOR HEIGHT: 13' 6" WIDTH: 102" TANKS (F/G/B): 64 / 88 / 88 AWNING: 16' & 14'

# 380FL

## AHARA STANDARDS & OPTIONS

### AHARA TRANQUILITY PACKAGE (NEW)

- 24" Residential Oven w/ 4 Burner Range
- 16 Cubic Foot 12v French Door Refrigerator w/ Double Drawer Freezer
- Pantry/Closet & Hutch w/ Overhead Cabinets
- Hardwood Raised Panel Cabinet Doors w/ Hidden Hinges
- Solid Surface Kitchen Island Countertop Extensions
- Day & Night Slow Rise™ Roller Shades
- Pull Out Fireplace Tray w/ Hidden Storage
- 50" LED Television w/ Swing Arm & Hidden Storage
- Full Body Shower Panel w/ Rain Shower Head & Spray Wand
- Bathroom 12v MAXXAIR MAXXFAN®
- 30" Wide x 78" Tall Entry Door w/ Integrated Thin Shade™

### AHARA LUXURY PACKAGE

- Wide-Body Chassis w/ Drop-Frame Pass-Through Storage Compartment
- 6-Point Hydraulic Automatic Leveling System
- 2nd Adjustable Power Awning w/ LED Lights
- MORyde StepAbove® Entry Steps
- Solid Surface Kitchen Countertops
- Seamless Fiberglass Shower
- 50" LED Television
- HDMI/AM/FM Bluetooth Entertainment System w/ Sound Bar Speakers
- 30" Over-The-Range Residential Microwave
- Metal Slam Latch Cargo & LP Doors
- Universal All-In-One Docking Station
  - \* Outside Shower w/ Quick Connect Hose & Spray Nozzle
  - \* Waste Tank Flush
  - \* Power/Fill Fresh Water Tank for Dry Camping
  - \* Exterior Water Pump Switch
  - \* Siphon Fill or Sanitize Fresh Water Tank From Vessel Using Water Pump
  - \* EZ Winterization Valve
  - \* Battery Kill Switch
- 10 Gallon Water Heater
- Stackable Washer/Dryer Prep
- Roof Mounted Solar Prep

### AHARA 4 SEASONS PACKAGE

- Laminated Sidelwails, Slide-out End Walls, Slide-out Roofs, and Rear Wall w/ 1.5 lb. Black Foam Insulation
- High-Efficiency Triple A/C System: 3 x 13,500 BTU A/C's
- Ductless Flooring w/ 5/8" Tongue & Groove Plywood Floor Decking (No OSB)
- 40,000 BTU High-Capacity Furnace
- 40" Wide 5,000 BTU Electric Fireplace

- 12v Heat Pads on Holding Tanks
- Heated, Insulated & Enclosed Underbelly & Dump Valves w/ Circulating Heat
- Radiant Technology Composites™ Insulation in Roof, Front Cap & Underbelly
- Formaldehyde Free Fiberglass Insulation in Roof, Front Cap & Main Floor
- Dual Attic Vents

### AHARA TOWING PACKAGE

- Aerodynamic Fiberglass Front Cap
- Seamless High Visibility LED Front Cap Lights
- LED Marker Lights
- LED Taillights w/ Back-Up Lights
- MORyde CRE 3000 Suspension
- MORyde Heavy-Duty Shackles & Wet Bolt Kit
- Dexter Gladiator Thick Wall 7,000 lb. Axles w/ Nev-R-Adjust Brakes
- Heavy-Duty 4,000 lb. Springs
- Under Carriage Spare Tire & Carrier
- LionHeld Specialty Tire & Wheel "1 Year No Excuses Guarantee" Program
- Rear View Camera Prep
- 2" Rear Accessory Hitch
- Driver's Side Automatic Leveling System Control Box

### EXTERIOR

- High-Gloss Gel Coated Fiberglass Exterior
- Deep Tint Safety Glass Windows
- Residential Wood-Frame Roof
- Factory Installed Roof Ladder
- 2" Thick Double-Welded Aluminum Framed Sidelwails, Rear Wall, Front Bulkhead Wall & Slide-Out Rooms
- Double-Welded & Fully Framed Window, Entry Door, Cargo Door and Slide-out Openings
- 3" x 2" Double-Welded Aluminum Floor Joists (16" On Center)
- 50 AMP Electrical Service
- Detachable 50 AMP Power Cord
- 60 AMP Converter w/ Charge Wizard Technology & Lithium or Lead Acid Battery Selector Switch
- Adjustable Power Awning w/ LED Lights
- High-Capacity Water Pump w/ Interior & Exterior Switches
- EZ Access Low Point Drain Valves
- 30 lb. LP Bottles (2)
- LP Quick-Connect
- Winegard® Air 360 + TV Antenna w/ Wi-Fi Prep

- Exterior Cable/Satellite Hookup in Pass-Through Storage Compartment
- LED Motion Sensor Lights in Pass-Through Storage and Outdoor Kitchen Compartments
- Safety Light Kit: Entry Steps
- Marine Grade LED Light at Sewer Termination

### INTERIOR

- Barrington Maple Interior Décor
- Solid Core Cabinet Stiles
- Pre-Drilled & Screwed Cabinetry
- Ball Bearing Full Extension Drawer Guides
- Wall Hugged Theatre Seats w/ Power Recliners
- Wall Mounted Free Standing Dinette w/ 2 Chairs & Storage Ottomans
- 6" 6" Tall Main Slide-out Interior Height
- LED Kitchen Pendant Lights (2)
- LED Motion Sensor Lights in Bathroom Hallway & Bedroom Closets
- Vinyl Flooring in Living Area, Kitchen, Bathroom & Bedroom (No Carpet)
- Marine Grade Woven PVC Flooring in Flush Floor-Side-Outs
- Deep-Seated Stainless Steel Farmhouse Sink
- Roll-Up Stainless Steel Drying Rack
- Residential High-Rise Kitchen Faucet w/ Pull-Down Spray
- Kitchen 12v MAXXAIR MAXXFAN®
- Pull-Out Trash Can in Kitchen Island
- 6" 6" Tall Main Bathroom Interior Height
- Porcelain Toilet w/ Foot Flush
- Skylight Over Shower
- Extra Large Seamless Lav Top w/ Undermounted Sink
- Large Medicine Cabinet w/ Mirror
- 70" x 80" Serta® King Bed w/ Residential Bedspread
- Besides USB & Electrical Outlets
- Besides Nightstands
- Bed Base Drawers
- Bedroom Cable/Satellite Hookup

### OPTIONS

- 12 Cubic Foot 4-Door Gas/Electric Refrigerator
- Wall Mounted Booth Dinette w/ 2 Benches
- Generator Prep
- Solar Package (320-Watt Solar Panel w/ 50 AMP MPPT Controller and 2000 Watt Inverter)
- Dual Pane Windows
- Super Duty Towing Package (MORyde Rubber Pin Box & Dexter Hydraulic Disc Brakes)



**24/7 EMERGENCY  
ROADSIDE ASSISTANCE  
WITH VEHICLE PURCHASE\***

**TOWING STARTS  
TIRE CHANGES  
FLUID DELIVERY  
LOCK-OUT  
SERVICE**

**WINCH-OUT  
MOBILE MECHANIC  
TECHNICAL  
SUPPORT  
DEALER LOCATOR  
SERVICES**

**SAFERIVER  
MOTOR CLUB**

**\*VALID FOR 1 YEAR FROM DATE OF PURCHASE**



Learn More  
Scan this barcode using  
a QR Reader on your  
smart phone to learn  
more about Forest River.

3000 COUNTY ROAD E WEST ELKHART, IN 46534  
WWW.EASTTOWESTRY.COM 574.264.6664

**FREE MEMBERSHIP**  
to Forest River Owners' Group



A Robekins Hathaway company



www.ForestRiverBuyLocal.com



#### PRE-DELIVERY INSPECTION FACILITY

28,000 square feet of quality assurance. The team consists of a premium product. The team will ensure every item is inspected daily to ensure quality assurance in every unit built.

#### Specification Definitions

**GVW (Gross Vehicle Weight Rating):** is the maximum permissible weight of the vehicle fully loaded & includes all weights, including all of fluids, cargo, optional equipment and accessories. It may differ from actual performance as determined by GVW.

**GVW (Gross Vehicle Weight Rating):** is the maximum permissible weight, including cargo, fluids, optional equipment and accessories. It may differ from actual performance as determined by GVW.

**GVW (Gross Vehicle Weight Rating):** is the maximum permissible weight of the vehicle fully loaded & includes all weights, including all of fluids, cargo, optional equipment and accessories. It may differ from actual performance as determined by GVW.

**CCC (Charge Carrying Capacity):** is the amount of weight available for load and trailer weight, excluding optional equipment and accessories. It is equal to GVW minus GVW Available (GVW) should not exceed the published weight (GVW) per axle. Before filling the fresh water tank, empty the black and grey tanks to prevent from exceeding capacity.

**\*\*Excluded weight from CCC is standard hitch optional equipment.**

Each Forest River RV is weighed at the manufacturing facility prior to shipping. A label detailing the standard rated weight of the actual unit and the carrying capacity is applied to every Forest River RV to ensure your location.

The load capacity of your unit is determined by weight and by volume. Do not exceed maximum weight or volume capacity when loading your unit.

**YOUR AHARA DEALER**

All information contained in this document is believed to be accurate at the time of publication. However, during the model year, a change in materials or design may occur. Forest River, Inc. reserves the right to make any such changes without notice. Including price, color, material, equipment and specifications as well as the addition or deletion of models. Items in this brochure, however, are not Forest River dealers and are not Forest River products. Any such specifications that are not Forest River products are not Forest River products.

**Forest River**

**BUY LOCAL**

**PREFERENTIAL SERVICE**

**PRODUCT INFORMATION**