

2023

REALM

*Presidential Series*



FORETRAVEL

*The Foremost in Luxury Travel*

*The cutting edge design of the REALM Presidential Series sets it apart from every other luxury motor coach on the market today. Rivalled only by the high-end automotive world, the REALM Presidential Series exudes luxury and refinement.*



*Meticulously designed front grill, headlight accents and intricate fiberglass cap design*



*Beautifully designed caps with exceptional attention to detail & styling at every curve*



*The LED under-coach lighting package accentuates the overall look*



*LED accent lights help create a one-of-a-kind look & feel unlike that of any other luxury motor coach*



*Opulent interior décors, leathers, cabinets and ultra high-end quartz countertops*

*The Foretravel REALM Presidential Series perfectly combines power, prestige & performance!*

# FORE-SLIDE



The REALM Presidential Series slide-out rooms feature pneumatic seals that provide a literal airtight seal completely around the entire slide-out room regardless of slide position. They also feature a power drop down flooring system that gives the REALM not only a flat-floor when extended, but a true flat-floor when retracted as well. Don't look for an interior carpet lip, exterior silicone beads, pop-rivets, screws, plastic moldings, or unattractive and intrusive slide-out room mechanisms to waste your valuable storage space. On a REALM, all you will find is the absolute finest in fit, finish and function offered in a slide-out room today.

## REALM Presidential Series safety far exceeds the industry norm

Just a few highlights include:

- Spartan Advanced Protection System®
- Automatic traction control
- Collision mitigation system with Adaptive Cruise Control
- Electronic stability control
- All-wheel disc brakes
- A tire pressure sensor system
- "Premier Steer" steering assist system
- Race-inspired Bilstein® shocks validated to the REALM's specifications



Steel construction instead of aluminum



TYRON's® Bead-Lock Wheel Safety Bands



Rear Exit Door



Mobile-eye® Collision Avoidance System



Fogmaker Fire Suppression System for the engine

Just a few of the available features on the ALL NEW REALM Presidential Series

# Premiere *Steer*



Column Drive System - Arrive Relaxed & Refreshed

## Xtreme-Schemes by Foretravel



Far above the "4 color" industry norm, a REALM Presidential Series is a true rolling, artistic masterpiece.

Take **CONTROL** of your REALM!



Coach Command controls a multitude of functions including changing the undercarriage lights with precise control!

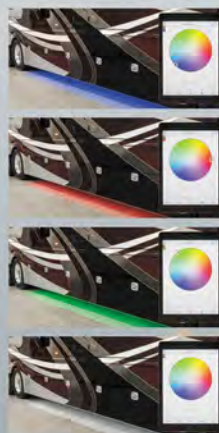

"Bird's Eye View" coach monitoring system for the absolute ultimate in coach visibility!

- Eliminates "Danger Zones" from all sides
- High resolution camera images displayed
- Easy-to-follow guidelines while backing up
- Multiple single camera views around vehicle
- Triggered single camera views around vehicle
- Toggled views for any single camera



Remote control rear camera for optimal visibility in every scenario!



Parking



Driving

CONNECTING MOBILE LIFESTYLES™



**Flat Floor Rear Bath!**

This is no small feat when compared to the competition.



REALM Presidential Series



vs. Competition

**No more unsafe & unsightly steps!**

## Exclusive to REALM & REALM Presidential is the Spartan **K4 605** chassis.

The K4605 is not only massive in stature, but boasts a best-in-class 20,000 lb. Independent Front Suspension, Cummins 605HP diesel engine, Torqued-Box Structural Frame, the **Spartan Advanced Protection System** & passive steering rear tag axle for incomparable handling and maneuverability. Once behind the wheel of a **Realm Presidential Series**, you will instantly realize that this is the pinnacle of luxury motor coach driving performance.



### Bendix® VORAD BlindSpotter

The Bendix® VORAD system uses forward & side looking radar to constantly monitor vehicles ahead and in the blind spot area.

### Independent Front Suspension

The independent front suspension is computer analyzed and custom tuned to provide optimal comfort and control.



### Passive Steer Tag Axle

### Featuring OnGuardACTIVE™

Spartan's Advanced Protection System® (APS), is the industry's first comprehensive set of RV-specific safety features designed to provide additional protection, security and value to coach buyers so you can focus on the road ahead.



### Other Features Include:

- ❑ Collision Mitigation System with Adaptive Cruise Control.
- ❑ Spartan Safe Haul™ (industry's only factory-chassis integrated air supply for tow vehicle brake systems).
- ❑ A 17 degree rear wheel cut means you can navigate the twists and tight spaces of RV parks and parking lots with greater confidence.
- ❑ Backing up your coach is hassle-free with our auto-alignment system straightening and locking the tag axle for precise maneuvering control.



# 2023 FORETRAVEL REALM *Presidential Series*

## *Cabinetry*

## *Countertops*

## *Primary Leathers*

### *Majesty*



### *Crown*



### *Dover*



## *Floorplans*

The Foretravel REALM Presidential Series is available in six Luxury Villa floor plans that offer unprecedented livability and stately accommodations befitting any RV lifestyle.



LV1

LV2

LV3

LVB

LVB w/Spa

LVMS

\*Manufacturer's options, features, colors, floor plans, etc. are subject to change without notice. Some decorations and personal effects may be for demonstration only and not be a part of the available features list or sale price.



The LV1 is a bath & 1/2 model and is highlighted by:  
Curb side dinette, Stack W/D, & 600D Aqua Hot.  
L-shaped extendable sofa, Large mid-ship QLED TV,  
& Luxurious Master Bedroom with Slumber Ease Motorized Mattress

Shown in Majesty Décor

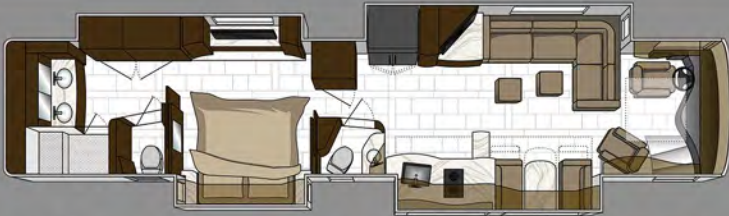

## Presidential Series - LV1





The LV2 is a bath and a half model highlighted by:  
Power lift living room TV, Extendable sofa, Stack W/D, Private water closet in master bath, Power-lift bedroom LED TV, Dual sink basins, Massive wardrobe and large master shower with multiple jets.



# Presidential Series - LV2



Shown in Dover Décor

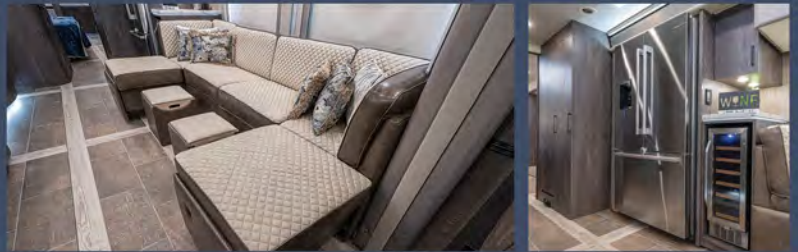





Shown in Crown Décor (Gloss) with Optional Dinette Chairs



The LV3 is a bath and a half model, highlighted by: Power-lift bedroom LED TV, large tile shower, dual sink vanity, cedar lined closet including a built-in chest of drawers. The over-sized fireplace, LED TV and custom residential furnishings gives the LV3 a beautiful and comforting quality.



## Presidential Series - LV3



Shown with Optional Dinette Chairs



Shown with Optional Dinette Chairs





The LVB is a Two Full Bath/Bunk model and is highlighted by: Drop-down living room TV, stack W/D, 600D Aqua Hot & Mach 5 water pump. Bunk beds include large LED TV's, Blu-ray players, in-direct lighting, individual A/C, charging stations and much more!

Shown in Crown Décor



Each Bunk has it's own AC vent



Each Bunk has it's own LED TV & Headphones

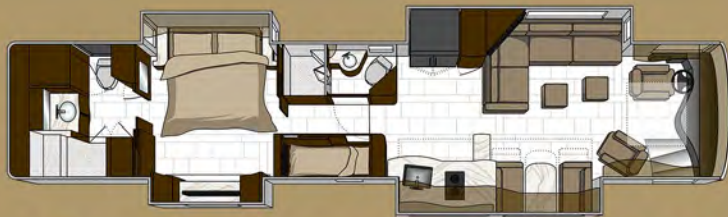

## Presidential Series - LVB

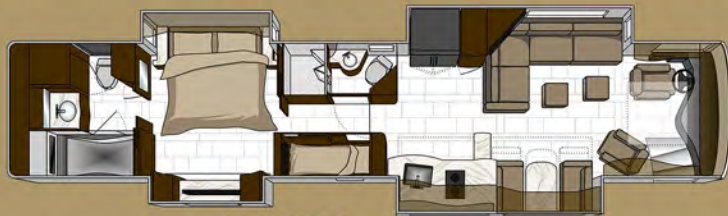

LVB WITH SPA



Each Bunk has it's own window & storage



Each Bunk has a controller for the LED Lights



Optional Spa Shown



Guest Shower





The LVMS is unlike any luxury motor coach in the world; offering multiple living & dining accommodations highlighted by the dual power adjustable dinette tables and extra large lounge as well as a master suite arrangement unlike any other.



# Presidential Series - LVMS



Shown in Majesty Décor

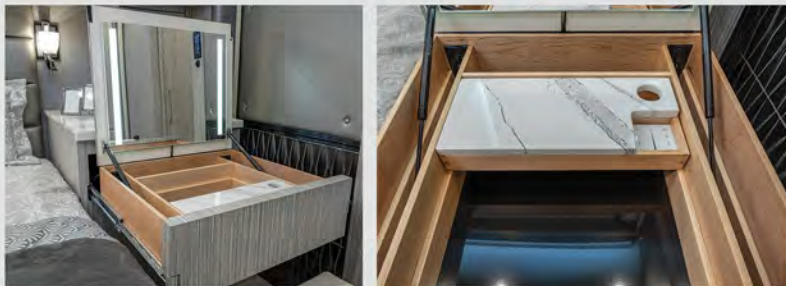

# Presidential Series



Regal paint shown



*Knight*



*Sword*



*Imperial*



*Drawbridge*



*Regal*



*Cathedral*



*Renaissance*



*Catapult*



*Royal*



*Coronation*

Artists renditions shown, design and colors are subject to change

# SWORD



*Presidential Series*



# REGAL



## *Presidential Series*

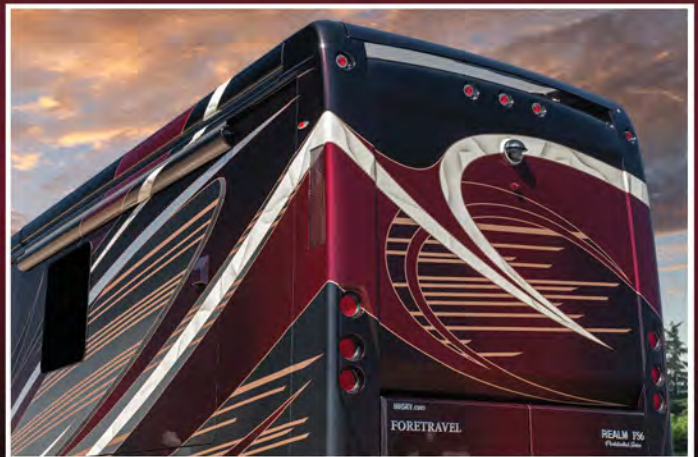
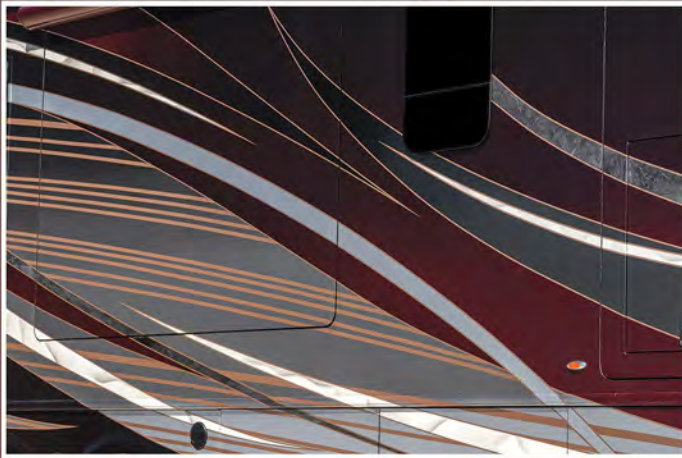

# IMPERIAL



## *Presidential Series*



# KNIGHT



*Presidential Series*





## 2023 Foretravel REALM FS605 Presidential Series Specifications

### CHASSIS FEATURES

Spartan K4 Chassis  
Cummins X15 605 HP Engine

- Peak HP 605 @ 1,800 RPM

Allison 6 Speed Transmission MH 4000

- Peak Torque 1,950 ft/lbs. @1,200 RPM

Cummins Connected Diagnostics  
Valid Air Suspension w/ VDC Control  
HWH Four Point Hydraulic Leveling Jack System  
Spartan Safe Haul  
Three Stage Engine Brake with On/ Off Switch with Control Lever  
ABS Anti-Lock Braking System with Automatic Slack Adjusters  
Electronic Suspension Control System w/ Self Leveling Feature  
Air Disc Brakes on all Wheels  
Air Hose for Tire Service  
Air line with Quick Connect  
Alcoa Aluminum Wheels with Dura-Bright Protection on All Aluminum Wheels  
Alternator - 270-amp; Leece-Neville  
Automatic Traction Control (ATC)  
Auxiliary 12V Air Compressor  
Fuel Filter / Water Separator  
Side Mounted Radiator  
**Electric Engine Block Heater**  
**Heated Automatic Air Reservoir Drains with Lanyard**  
**Remote Engine Oil Fill and Transmission Level Check**  
Front Axle - IFS (Independent Front Suspension)  
Rear Axle Ratio: 4.30:1  
New Passive Steer Tag Axle with 17 Degree Turning Radius  
20,000-lb. Towing Capacity/ 2,000-lb. Hitch Tongue with 7/4-Pin Plug  
Michelin Tires: Front 365/ 70R 22.5" Rear 315/ 80R 22.5"  
3 Year Spartan Scheduled Maintenance Included  
No Deductible 24/7 Roadside Assistance First 3 Years

### EXTERIOR FEATURES

Foretravel Exclusive Fore-Slide™ Flangeless Pneumatic Seals on All Slide Rooms  
Entry Door Awning  
Passenger Side Patio Awnings, Two Roof Mounted Electric Patio Awnings with LED Lights on Passenger Side  
\*Driver Side Patio Awning Shells, Two Roof Mounted Patio Awning Shells with LED Lights  
\*Presidential Series Badging on Front and Rear of Coach  
\*Slide-out Topper Awnings - Painted to Match w/ Graphics Painted Through Shell  
Outdoor Entertainment Package in Slide Room  
**380-Watt Solar Panel Package**  
Storage Bay:  
Lights in Storage Bay  
Freezer on Slide Out Tray  
Side Hinge Storage Doors with Remote Electric Door Locks  
Dual-Pane Tinted and Insulated Windows  
Easy View One-Piece Windshield  
Electric Executive Entry Step  
Cosmolite Roof - One Piece, Stain and UV Resistant  
LED Lights:  
Four Docking Lights  
Color Changing Ground Accent Lighting  
Xenon Low Beam Headlights  
Marker Lights  
Foretravel Projector Courtesy Puddle Logo Light on Bottom of Entry Door  
FRP Sub Floor (One-Piece)  
Heated/ Remote Chrome Mirrors with LED Turn Signals and \*Breakaway Feature  
Fresh Water Plumbing Supply Manifold with **Newly Redesigned Stainless Steel Water Manifold Cover Panel**  
Xtreme-Scheme™ Paint Designs with:  
Paint Protection Below Windshield - Armor Coat  
Full Body Exterior Paint with Multiple Clear Coat Finishes  
Roof AC Drains  
Trailer Wiring - 7 Pin Connector  
Dual Fuel/ DEF Fill Locations (Newly Increased Fuel Venting for Ease of Filling)  
**Improved Spartan Service Center Bay with Better Accessibility to Maintenance Items**  
Utility Station:  
50 Amp. Shoreline Connection  
Laser Etched Stainless Steel Utility Bay Panels  
Cable TV Connection  
**Relocated Sewer Connection Above the Cargo Floor in Utility Bay**  
Two Electric Sliding Cargo Trays  
Carpeted Storage Bays  
**Newly Redesigned Electronics Bay**  
Fog Lights  
High Beam Headlamps  
Porch Light  
\*LED Accents on Bottom of All Slide Rooms  
**Single Waste Tank with Electric Valves and Grey Water Bypass**  
Water Pump & Water Fill Controls  
**LED Accent Lights in Stainless Steel Panel**

### DASH and COCKPIT FEATURES

Push Button Ignition  
15" Digital Valid Dash w/ VDC Control  
Dimmable Accent LED Lights below the Dash  
Wireless Charger at Passenger Chair  
Illuminated Cup Holders  
Passenger Magazine Rack with Phone Storage and  
120V/ USB Charger Receptacle  
Assist Handle  
**New Color Match Steering Wheel and Dash Panel**  
Padded Dash Top  
2 Dual USB Charge Receptacles  
Battery Boost Switch/ Auto-Charge

## 2023 Foretravel REALM FS605 Presidential Series Specifications

### DASH and COCKPIT FEATURES, Continued

Cameras: 7 Total:

- One Total Vision Motorized Back-Up
- Two Side Mounted Integrated in Mirrors
- Four Perimeter 360 Birds Eye View

Dedicated Driver Monitor Camera Display for All Cameras

\*Cameras Displayed on Digital Dash

\*Ability to Display Cameras on TV's

Dash AC Fan Controls for Co-Pilot

Generator Auto Start/ Stop

Infotainment System:

- GPS, AM, FM, Sirius/XM (Subscription Required) Bluetooth, USB, and iPod Compatibility
- Integrated Cockpit Controls
- Integrated Mobileye display
- **Increased Display Monitor Size to 9"**

Passenger Touch Screen Monitor with GPS and Camera Display

Map Lights, Pilot and Co-pilot

Suspended Power Adjustable Throttle and Brake Pedals

\*Knoedler Air Ride Pilot Seat with Swivel Base, Heat, Cool and Massage Feature (With Haptic Warning System)

Villa 6-Way Power Adjustable Residential Co-Pilot Chair, Motorized Footrest/ Headrest with Heat, Cool and Massage Feature

Premiere Steer™ Steering Column Assist System

Power Tilt and Telescoping Steering Column

**Tri Touch** Smart Wheel with Radio Controls, Cruise and ICC Controls and Phone Control Integration

Electric Windshield/ Privacy Shade and Sunblock

### APPLIANCES • ELECTRONICS • LIGHTING • AUDIO-VIDEO

4K 65" QLED Smart TV in Livingroom (On Lift at Dinette, Floorplan Dependent)

4K 55" QLED Smart TV in Livingroom (Front Fold Down, Floorplan Dependent)

4K 49" QLED Smart TV in Bedroom on Lift with **Soundbar**

4K 43" QLED Above Driver and Passenger Stationary (Luxury Villa 1 Only)

4K 43" LED Smart TV Outside in Patio Entertainment Package with Soundbar

4k 43" QLED Above Sofa (Floorplan Dependent)

1080P 32" LED Above Sofa (Luxury Villa Master Suite Only)

Silverleaf Total Coach Control System with \*Rozie Controller

Touch Pad Behind Drivers Chair for Lighting and Shade Operation

Apple iPad with AV, Multiplex and Silverleaf Controls

Wi-Fi Ranger, Converge Model

Consolidated Back Up Controls for Thermostats, Water Pump, Water Fill and RVC Reset

Audio-Video:

HDMI and CAT6 Shielded A/V Cabling

5.1 Surround Sound System in Living Room

Stereo Sound System in Bedroom

Blu-Ray Player

Winegard-Rayzar Automatic Domed HDTV Antenna

Stationary HD Satellite with Component Connection Plate (**Directv or Dish Network**)

Appliances:

Convection Microwave

Residential Refrigerator

Two Burner Induction Cook Top Recessed with Cover

Bosch Washer/Dryer with Pull Out Shelf (Floorplan Dependent)

LG Combination Washer / Dryer (Bunk Floorplan Only)

Fisher Paykel Dish Drawer

\*EdgeStar 18 Bottle Wine Chiller (not available on LV3)

Dimmable Interior LED Lighting:

Under Countertops

Entry Door

Window Trim

Floor

Toe Kicks

Reading Lamps

LED Accent at Toe Kick of Cabinets

\*Head Hunter Mach 5 120V Water Pump

### INTERIOR LIVABILITY FEATURES

\*Hand Crafted Laminate Cabinetry

\*Presidential Series Professionally Designed Interiors

\*Presidential Embroidery on Driver and Passenger Chairs

Cambria Natural Quartz Countertops

\*Frameless Residential Shower Door

\*Infinity Light Box in Ceiling Recess

\*3-Form Art Inserts on Pocket Doors and Half Bath Door

\*Ability to Dump Tanks from Inside Coach

Uvia Lite added to Waste Tank (No Chemicals Required)

Filtered Ice and Water Dispenser

\*Pneumatic Pocket Doors (Single Door Only)

Heated Tile Flooring Through-out Coach

Full Flush Floor Front to Rear

120V Outlet with Dual USB Charge Ports in LR and BR

Multiplex Lighting System

Powered Step-Well Cover with Two Switch Locations

Motorized Table (Floorplan Dependent)

Foretravel Professionally Designed Bedding and Throw Pillows

Foretravel Professionally Designed Window Treatment with Electric Day/ Night Shades

Built in Vacuum with Toe Kick and Hose Connection

Beveled Mirrors on Medicine Cabinet

\*Kitchen Window

Fireplace (Floorplan Dependent)

## 2023 Foretravel REALM FS605 *Presidential Series* Specifications

### INTERIOR LIVABILITY FEATURES, Continued

\*Closet Cabinets Next to Dresser with Four Drawers at Bottom (Floorplan Dependent)  
\*Illuminated Closet Rods  
Soft Close Full Extension Ball Bearing Drawer Tracks  
Leather Coverings on Seating Surfaces  
Sofa with Integrated Air Bed  
Luxury Villa 2 Living Room Seating Option: Theatre Seating, Double Lounge Chaise and Sofa with Motorized Recliners on Each End  
**Luxury Villa Bunk Models Have Newly Redesigned Bunks to Increase Interior Bunk Space**  
**CPAP Provisions above Bed with 120V Receptacle in Overhead**  
**LED Accent Lights at Entry Steps**

### KITCHEN

\*Kitchen Utility Drawer  
Kitchen Pantry  
Kitchen Countertop Extension  
Single Bowl Kitchen Sink with Covers

### BEDROOM

\*Slumber Ease Motorized Luxury King Size Mattress  
Windows in Bed Slide Sidewall Below the Overhead

### BATH • SHOWER

Reversible Variable Speed Electric Exhaust Fan in Bath and Toilet Room with Decorative Interior Covers  
Massaging Spa (Floor Plan Dependent)  
Body Sprayer in Shower  
Built-in Shower Bench  
Showermiser Hot Water Recirculation System  
Tile Wall from Chair Rail Down in Bathroom

### HEATING • COOLING • ELECTRICAL

Onan 12.5 Kw Diesel Generator in Quiet Box  
12-Volt Battery Disconnect  
Dual 3000-Watt Xantrex Inverter/Charger  
50-Amp Shoreline Connection  
Air-Conditioning and Heating with Offset Returns for Superior Quiet Operation  
Air-Conditioning, Ducted with 3 Roof Airstats 15,000 BTU's with Heat Pumps  
Auto Temp. Start for Generator  
Low-Battery Auto-Start for Generator  
Six 4D House Batteries/ Two Engine Batteries, Group 31 with 950 CCA- Each  
50-Amp Automatic Transfer Switch with Integrated Surge Suppression  
\*Aqua Hot Hydronic Heating 600D  
Gold Heat Floor Tile Heating System (3 Zones with Scheduling Capability)  
\*Quick Access Interior Load Center

### SAFETY FEATURES

All Coaches Built to RVIA Specifications  
Rear Escape Door with Integrated Ladder  
Spartan Advanced Protection System:

- Collision Mitigation with Adaptive Cruise Control and Active Braking
- Electronic Stability Control Automatically Brakes Individual Coach Wheels to Help Drivers Maintain Control During Extreme Steering Maneuvers.
- Automatic Traction Control (ATC)
- Spartan Safe Haul™ The Industry's Only Chassis Integrated Air Braking System for Tow Vehicles to Supply Optimal Braking Performance.

Lights:

- Auto Headlights
- Illuminated Entry-Door Assist Handle
- Daytime Running Lights

Tires:

- Tyron® Bead-Lock Tire Blowout Protection (Front Tires)
- **Valor GEN 3 TPMS** Tire Pressure Monitoring System with Display Integrated on Digital Dash

Fire and Carbon Monoxide:

- Fog-Maker Engine Fire Suppression System
- Rear Egress Door with Integrated Ladder
- Fire Extinguishers
- Carbon Monoxide Detector
- Smoke Detector

Cameras (7 Total):

- Bird's Eye View 360 Camera System
- Total Vision Back-Up Camera
- Integrated on Side Mirrors

Mobile Eye Collision Avoidance and Lane Departure Technology with Intelligent High Beam Control  
\*Vorad Blind Spotter (4 Total)  
Cameras Displayed on Passenger Monitor  
Haptic Warning System on Driver Chair  
Three GFI Protected Circuits  
Electronic Safe  
Security System with Keyless Entry with Electric Storage Door Locks  
Back-up Alarm 107 decibels  
CSA Approved / Transport Canada Approved

## 2023 Foretravel REALM FS605 Presidential Series Specifications

### CAPACITIES AND MEASUREMENTS

Fresh Water	120 Gallons
Waste Tank	160 Gallons
Fuel Tank	200 Gallons
DEF Tank	15 Gallons
Interior Height	84" / 87" in Recesses
Exterior Height	13'2" - Top of Roof A/C's
Wheelbase	316"

### CHASSIS RATINGS

GVWR:	54,000 lb.
Front GAWR:	20,000 lb.
Rear GAWR:	20,000 lb.
Tag GAWR:	14,000 lb.
GCWR:	74,000 lb.

### WARRANTY

Coach:	2 Year/24,000 Miles
Chassis:	5 Year/75,000 Miles
Engine:	5 Year/100,000 Miles
Transmission:	5 Year/200,000 Miles
Chassis Frame & Cross Members	20 Year Transferable

### OPTIONS

Three Professionally Designed Interior Selections with Custom Laminate Cabinetry  
Eight Xtreme Scheme Exterior Color Selections  
Six Spacious Engineered Floor Plan Selections all with Four Fore-Slides  
Outside Stainless Steel Trim Package (New Black Stainless Option Available)  
Ottoman with Integrated Cup Holder  
**Additional House Batteries (2)**  
**Pressure Washer**

\* Items Specific but not limited to Presidential Series  
BOLD denotes new 2023 Items

Foretravel, Inc. reserves the right to change or correct product specifications/pricing at any time without incurring obligations  
2023 Foretravel REALM F605P Presidential Series Specifications



# Spartan PremierCare Plan



## Freedom To Roam. Worry-Free.

Now one of the most reliable chassis on the market has a maintenance plan to match. PremierCare is a worry-free guarantee for up to the first three years\* of ownership. Owners can enjoy scheduled maintenance, roadside assistance, and hundreds of North American service centers. The Spartan PremierCare plan covers routine maintenance services, which protect your chassis, and can be performed with an annual visit to a Spartan authorized service center. Travel with confidence knowing all service and maintenance needs will be performed by a trained professional.







FORETRAVEL



## Nationwide Foretravel & Spartan Service Network

Feel free to explore anywhere — with service centers throughout the U.S. and Canada, Foretravel and Spartan are always close by. We believe the premier chassis deserves a premier maintenance plan.



-  RV Retailer Dealerships
-  Foretravel Motorcoach (Nacogdoches, TX)
-  Spartan Service Facilities
-  Foretravel Authorized & Customer Recommended Service Facilities

\*Restrictions apply, see dealer for details



# COMPLIMENTARY PREMIERCARE PLAN<sup>®</sup>

EXCLUSIVE TO REALM & REALM PRESIDENTIAL - SPARTAN K4605 CHASSIS

## 12 Month Maintenance

Air Filter  
Check Ride Height  
Engine Oil & Filter Change  
Fuel Filter Primary  
Fuel Filter Secondary  
Inspect & Clean Cooling Package  
Inspect and Clean Battery Connections  
Lube Chassis & Fan Drive  
Refresh Hub Fluid  
Replace Fan Gear Box Fluid  
Replace Rear Differential Fluid  
Torque U-Bolts

## 24 Month Maintenance

Air Filter  
Check Ride Height  
Engine Oil & Filter Change  
Fuel Filter Primary  
Fuel Filter Secondary  
Inspect & Clean Cooling Package  
Inspect and Clean Battery Connections  
Lube Chassis & Fan Drive  
Refresh Hub Fluid  
Replace Fan Gear Box Fluid  
Replace Rear Differential Fluid  
Torque U-Bolts  
Crankcase Filter 150,000 miles or 2 Years  
DEF Filter 200,000 miles or 2 Years  
Replace Air Dryer Filter  
Replace Coolant Filter

## 36 Month Maintenance

Air Filter  
Check Ride Height  
Engine Oil & Filter Change  
Fuel Filter Primary  
Fuel Filter Secondary  
Inspect & Clean Cooling Package  
Inspect and Clean Battery Connections  
Lube Chassis & Fan Drive  
Refresh Hub Fluid  
Replace Fan Gear Box Fluid  
Replace Rear Differential Fluid  
Torque U-Bolts  
Crankcase Filter 150,000 miles or 2 Years  
DEF Filter 200,000 miles or 2 Years  
Replace Air Dryer Filter  
Replace Coolant Filter  
Add ELC Coolant Extender & Check ELC Coolant Condition

**THREE  
YEARS  
OR  
50,000  
MILES**

**REALM** *Presidential Series*

\*Maintenance must be completed at a Certified Spartan facility.  
Plan items subject to change per Spartan requirements.  
For complete details contact Spartan Chassis.



FORETRAVEL

**REALM**

*Presidential Series*



**Your Kingdom Awaits...**