

SOLLAIRE

BY PALOMINO

NON-BUNK MODELS

208 SS



242 RBS

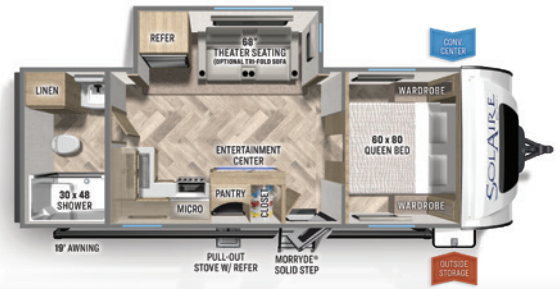

NEW

230 FKBS

COMING SOON



258 RBSS

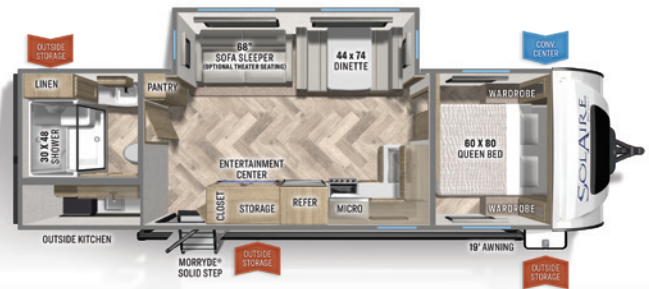

304 RKDS

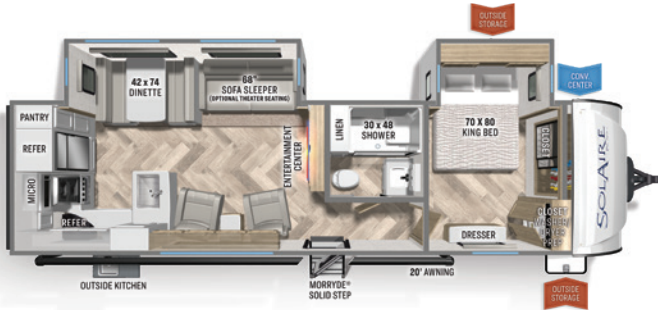

306 RKTS



BUNK MODELS

243 BHS

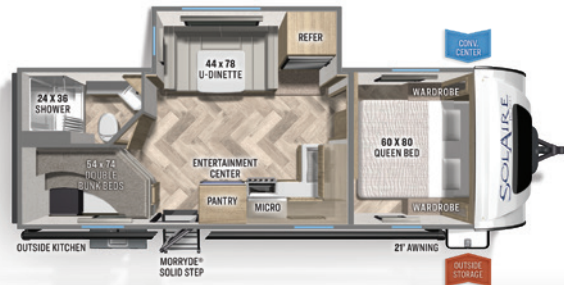

294 DBHS



315 DQBH



320 TSBH

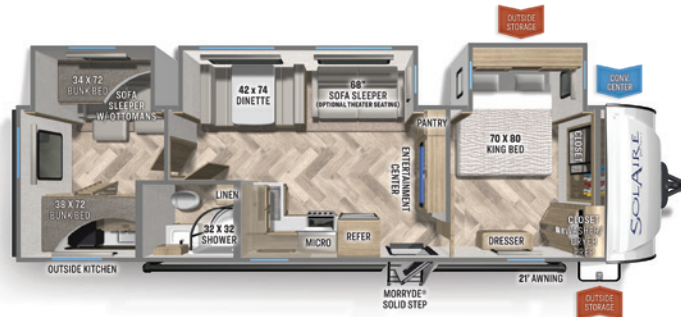

SOLAIRE

BY PALOMINO

NON-BUNKS

BUNKS

	208 SS	230 FKBS	242 RBS	258 RBSS	304 RKDS	306 RKTS	243 BHS	294 DBHS	315 DQBH	320 TSBH
Hitch Dry Weight	615	TBD	625	765	920	1013	570	675	838	1085
Dry Axle Weight	4170	TBD	5025	5595	6333	8330	4925	5680	6170	6835
Total Dry Weight	4785	TBD	5650	6360	7253	9343	5495	6355	7008	7920
GVWR	6315	TBD	7265	7765	8920	11213	7120	7675	8908	9825
Unloaded Vehicle Weight	4823	TBD	5688	6398	7291	8368	5533	6393	7046	7958
Interior Height	6'8"	TBD	6'8"	6'8"	6'8"	TBD	6'8"	6'8"	6'8"	6'8"
Exterior Height w/ AC	11'1"	TBD	11'1"	11'1"	11'1"	TBD	11'1"	11'1"	11'1"	11'1"
Exterior Width	8'	TBD	8'	8'	8'	8'	8'	8'	8'	8'
Travel Length	24'2"	TBD	27'11"	32'8"	35'2"	36'3"	28'11"	33'6"	36'4"	36'3"
Open Length	NA	TBD	NA	N/A	N/A	N/A	NA	N/A	N/A	N/A
Fresh Water Capacity (Gal.)	44	TBD	44	44	44	44	44	44	44	44
Gray Water Capacity (Gal.)	38	TBD	38	68	106	106	60	60	106	98
Black Water Capacity (Gal.)	30	TBD	38	30	38	38	30	30	38	30
Cargo Carrying Capacity (Gal.)	1492	TBD	1577	1367	1629	2845	1587	1282	1862	1867

SUPERIOR FEATURES. TOP TEN REASONS TO BUY

1. Vacuum bonded walls and roof
2. White gel-coat fiberglass exterior
3. Dexter® torsion axle
4. Outdoor convenience center for hookups
5. Fully welded aluminum super structure
6. Solid surface counter tops
7. 11 cu. ft. electric refrigerator
8. Fiberglass front cap w/ windshield and LED lights
9. TST Tire Pressure Monitoring System
10. King memory foam mattress
(Standard on 304 and 320)

SPECIFICATION DEFINITIONS

GVWR (Gross Vehicle Weight Rating) - is the maximum permissible weight of the unit when fully loaded. It includes all weights, inclusive of all fluids, cargo, optional equipment and accessories. For safety and product performance do NOT exceed the GVWR.

GAWR (Gross Axle Weight Rating) - is the maximum permissible weight, including cargo, fluids, optional equipment and accessories that can be safely supported by a combination of all axles.

UVW (Unloaded Vehicle Weight)* - is the typical weight of the unit as manufactured at the factory. It includes all weight at the unit's axle(s) and tongue or pin and LP Gas. The UVW does not include cargo, fresh potable water, additional optional equipment or dealer installed accessories.

*Estimated average based on standard build optional equipment.

CCC (Cargo Carrying Capacity)** - is the amount of weight available for fresh potable water, cargo, additional optional equipment and accessories. CCC is equal to GVWR minus UVW. Available CCC should accommodate fresh potable water (8.3 lbs per gallon). Before filling the fresh water tank, empty the black and gray tanks to provide for more cargo capacity.

** Estimated average based on standard build optional equipment

Each Forest River RV is weighed at the manufacturing facility prior to shipping. A label identifying the unloaded vehicle weight of the actual unit and the cargo carrying capacity is applied to every Forest River RV prior to leaving our facilities.

The load capacity of your unit is designated by weight, not by volume, so you cannot necessarily use all available space when loading your unit.



Learn More
Scan this barcode using a QR Reader on your smart phone to learn more about Forest River.



A Berkshire Hathaway company.



PALOMINO

1047 East M-86 | Colon, MI 49040
P: 269.432.3271 | F: 269.432.2516
www.palominorv.com