



2022 MIDWEST

2020 NORTHWEST

2020 WEST



2022 X-LITE TRAVEL TRAILERS





MODEL #: 171RBXL UVW: 3,836 LBS LENGTH: 22'8"



MODEL #: 19DBXL UVW: 4,483 LBS LENGTH: 24'8"



MODEL #: 240BHXL UVW: 5,343 LBS LENGTH: 28'10"



MODEL #: 261BHXL UVW: 4,818 LBS LENGTH: 28'8"

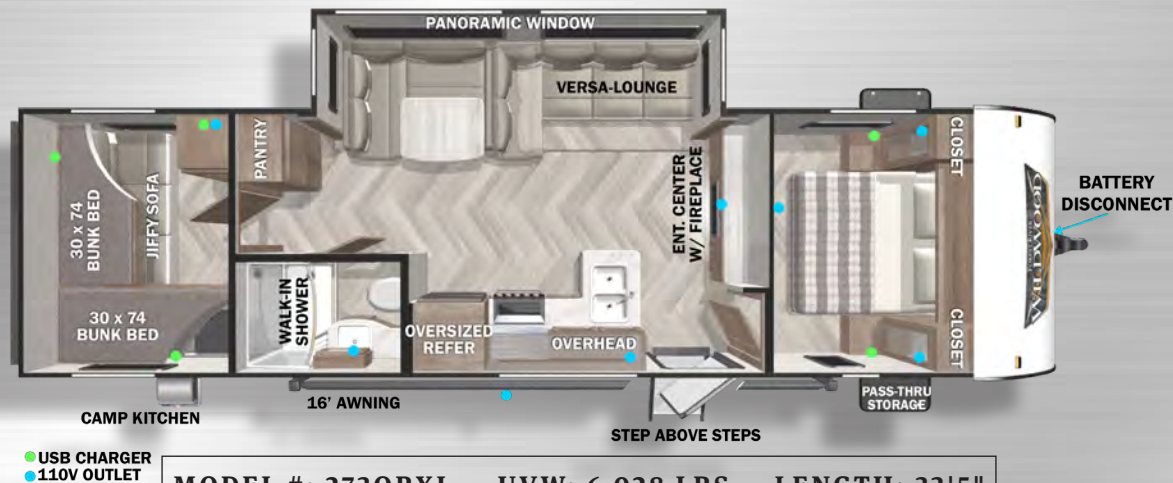

MODEL #: 273QBX UVW: 6,028 LBS LENGTH: 33'5"



MODEL #: 24RLXL UVW: 5,063 LBS LENGTH: 28'11"

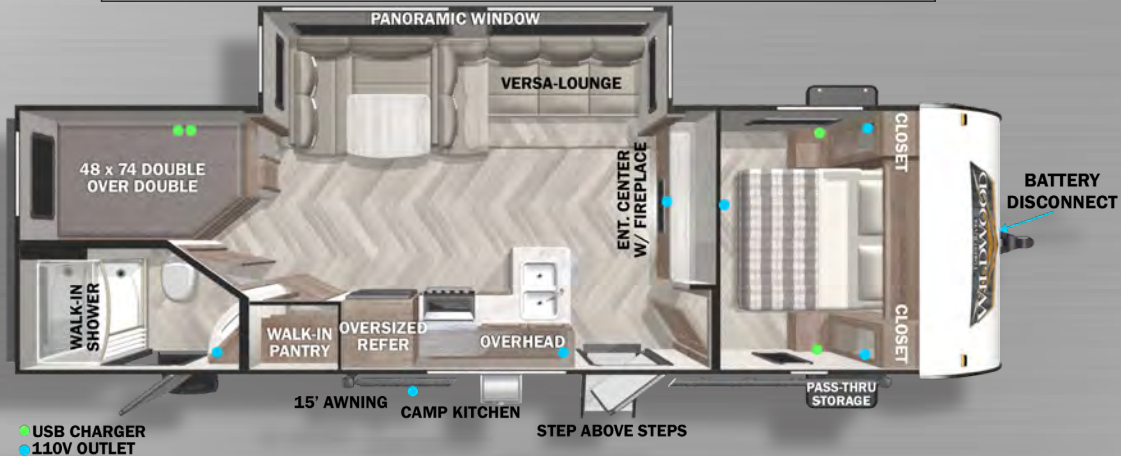

MODEL #: 263BHXL UVW: 5,854 LBS LENGTH: 31'9"



MODEL #: 28VBXL UVW: 6,208 LBS LENGTH: 33'2"



For detailed specifications, pictures & 360 Tours, visit www.forestriverinc.com/Wildwood

OR

Scan the QR code!



**24/7 EMERGENCY
ROADSIDE ASSISTANCE
WITH VEHICLE PURCHASE***

TOWING
JUMP-STARTS
TIRE CHANGES
FLUID DELIVERY
LOCKOUT
SERVICE

WINCH-OUT
MOBILE MECHANIC
TECHNICAL
SUPPORT
DEALER LOCATOR
SERVICES



*VALID FOR 1 YEAR FROM DATE OF PURCHASE

FREE MEMBERSHIP
to Forest River Owners' Group

www.forestriverfrog.com



Learn More

Scan this barcode using
a QR Reader on your
smart phone to learn
more about Forest River.



A Berkshire Hathaway company.

FOREST RIVER, INC. 55470 C.R. 1 ELKHART, IN 46515 | (574) 533-5934
WWW.FORESTRIVERINC.COM/WILDWOOD | WWW.FORESTRIVERACCESSORIES.COM



PRE-DELIVERY INSPECTION FACILITY

20,000 square feet of quality assurance. The bare essentials for a premium product.
This state-of-the-art facility gives immediate daily feedback to production for quality
assurance in every unit built.

Specification Definitions

GVWR (Gross Vehicle Weight Rating) - is the maximum
permissible weight of the unit when fully loaded. It includes all weights,
inclusive of all fluids, cargo, optional equipment and accessories. For
safety and product performance do NOT exceed the GVWR.

GAWR (Gross Axle Weight Rating) - is the maximum
permissible weight, including cargo, fluids, optional equipment and
accessories that can be safely supported by a combination of all axles.

UVW (Unloaded Vehicle Weight)* - is the typical weight
of the unit as manufactured at the factory. It includes all weight at
the unit's axle(s) and tongue or pin and LP Gas. The UVW does not
include cargo, fresh potable water, additional optional equipment
or dealer installed accessories.

*Estimated average based on standard build optional equipment.

CCC (Cargo Carrying Capacity)** - is the amount of
weight available for fresh potable water, cargo, additional optional
equipment and accessories. CCC is equal to GVWR minus UVW. Available
CCC should accommodate fresh potable water (8.3 lbs per gallon).
Before filling the fresh water tank, empty the black and gray tanks to
provide for more cargo capacity.

** Estimated average based on standard build optional equipment

Each Forest River RV is weighed at the manufacturing facility prior
to shipping. A label identifying the unloaded vehicle weight of
the actual unit and the cargo carrying capacity is applied to every
Forest River RV prior to leaving our facilities.

The load capacity of your unit is designated by weight, not by
volume, so you cannot necessarily use all available space when
loading your unit.

All information contained in this brochure is believed to be accurate at the time of publication. However, during the model year,
it may be necessary to make revisions and Forest River, Inc., reserves the right to make all such changes without notice, including
prices, colors, materials, equipment and specifications as well as the addition of new models and the discontinuance of models
shown in this brochure. Therefore, please consult with your Forest River dealer and confirm the existence of any materials, design
or specifications that are material to your purchase decision. Litho. U.S.A. FOR 1609 P/W: 2019.01.22

MEET YOUR X-LITE DEALER

CUSTOMER SATISFACTION



www.ForestRiverBuyLocal.com



WILDWOOD

PRODUCT FAMILY



FSX

X-LITE

WILDWOOD

LODGE | GRAND LODGE

HERITAGE GLEN

NORTHWEST



171RBXL



210RBXL

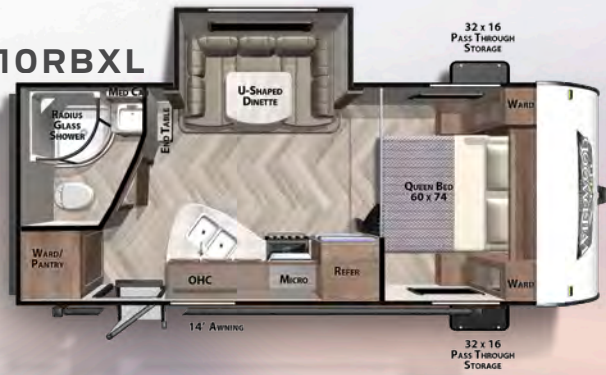

220BHXL



243BHXL



254RLXL



261BHXL



263BHXL



273QBXL



211SSXL

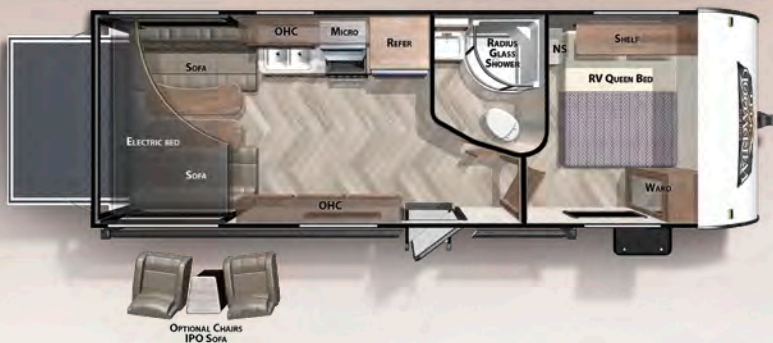

251SSXL

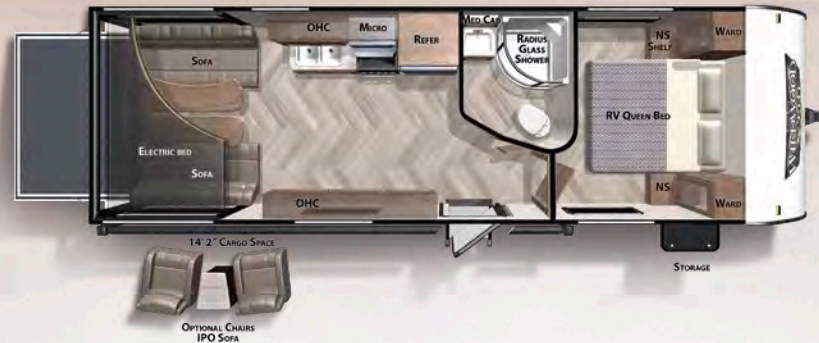

233RBXL

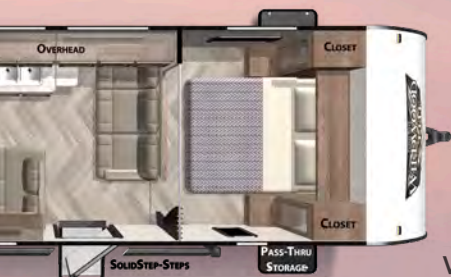

For more info, pictures
& 360 Tours, visit
www.forestriverinc.com/Wildwood

282QBXL



260RT



BEST IN CLASS PACKAGE

- » SolidStep Double Step (Main Door Only)
- » Exterior LED Light Strip Under Awning
- » Modern Cloth Roller Shades w/ AutoStop
- » Green Pkg: Furrion Solar Prep & LED Mushroom Lights
- » Power Awning w/Adjustable Legs
- » True Stabilizer Jacks w/ JT StrongArms
- » Power Tongue Jack
- » Stainless Steel Roll Up Sink Cover
- » Friction Hinge Baggage Doors
- » Large Capacity 10.7 cu ft Stainless Steel Refrigerator (12-volt) (Optional 8 or 6 cu. ft. gas/electric)
- » Black Tank Flush
- » Seamless Countertops (No T-Mold)
- » Stow N Go Storage (Bed & Dinette)
- » Updated Appliance Package
- » Electric Fireplace (N/A all models)
- » USB Port Package; Blue Tooth Stereo
- » Extra Large Panoramic Windows (On main slide)



263BHX

	171RBXL	210RBXL	220BHX	233RBXL	243BHX	254RLXL	261BHX	263BHX	273QBXL	282QBXL	211SSXL	251SSXL	260RT
HITCH WEIGHT (LBS.):	522	500	602	596	566	630	499	736	752	768	740	746	650
UVW (LBS.):	4092	4830	4800	5278	5492	5793	5025	6406	6550	6564	5262	5664	5276
CCC (LBS.):	3430	2670	2802	2318	2074	1837	2474	1330	2002	2004	3278	2882	3174
EXT. LENGTH	23' 0"	25' 2"	27' 8"	26' 3"	28' 2"	30' 8"	28' 7"	31' 11"	33' 8"	33' 4"	27' 5"	29' 5"	28' 8"
EXT. HEIGHT W/AC	10' 1"	10' 3"	10' 3"	10' 3"	10' 1"	10' 3"	10' 1"	10' 3"	10' 3"	10' 3"	11' 8"	11' 8"	10' 6"
EXTERIOR WIDTH	96"	96"	96"	96"	96"	96"	96"	96"	96"	96"	96"	96"	96"
FRESH WATER (GAL.)	42	61	42	42	61	61	29	61	61	61	61	61	42
GREY WATER (GAL.)	32	42	60	32	60	32	32	74	32	32	28	28	28
BLACK WATER (GAL.)	32	32	32	32	32	42	28	32	42	42	32	32	32
AWNING SIZE	10	14'	12'	14'	12'	16'	12'	16'	16'	16'	18'	18'	15



**24/7 EMERGENCY
ROADSIDE ASSISTANCE
WITH VEHICLE PURCHASE***

TOWING	WINCH-OUT
JUMP-STARTS	MOBILE MECHANIC
TIRE CHANGES	TECHNICAL
FLUID DELIVERY	SUPPORT
LOCKOUT	DEALER LOCATOR
SERVICE	SERVICES



***VALID FOR 1 YEAR FROM DATE OF PURCHASE**

FREE MEMBERSHIP
to Forest River Owners' Group

www.forestriverfrog.com



Learn More
Scan this barcode using
a QR Reader on your
smart phone to learn
more about Forest River.



A Berkshire Hathaway company.

FOREST RIVER, INC. 55470 C.R. 1 ELKHART, IN 46515 | (574) 533-5934
WWW.FORESTRIVERINC.COM/WILDWOOD | WWW.FORESTRIVERACCESSORIES.COM



PRE-DELIVERY INSPECTION FACILITY

20,000 square feet of quality assurance. The bare essentials for a premium product. This state-of-the-art facility gives immediate daily feedback to production for quality assurance in every unit built.

Specification Definitions

GVWR (Gross Vehicle Weight Rating) - is the maximum permissible weight of the unit when fully loaded. It includes all weights, inclusive of all fluids, cargo, optional equipment and accessories. For safety and product performance do NOT exceed the GVWR.

GAWR (Gross Axle Weight Rating) - is the maximum permissible weight, including cargo, fluids, optional equipment and accessories that can be safely supported by a combination of all axles.

UVW (Unloaded Vehicle Weight)* - is the typical weight of the unit as manufactured at the factory. It includes all weight at the unit's axle(s) and tongue or pin and LP Gas. The UVW does not include cargo, fresh potable water, additional optional equipment or dealer installed accessories.

*Estimated average based on standard build optional equipment.

CCC (Cargo Carrying Capacity)** - is the amount of weight available for fresh potable water, cargo, additional optional equipment and accessories. CCC is equal to GVWR minus UVW. Available CCC should accommodate fresh potable water (8.3 lbs per gallon). Before filling the fresh water tank, empty the black and gray tanks to provide for more cargo capacity.

** Estimated average based on standard build optional equipment

Each Forest River RV is weighed at the manufacturing facility prior to shipping. A label identifying the unloaded vehicle weight of the actual unit and the cargo carrying capacity is applied to every Forest River RV prior to leaving our facilities.

The load capacity of your unit is designated by weight, not by volume, so you cannot necessarily use all available space when loading your unit.

All information contained in this brochure is believed to be accurate at the time of publication. However, during the model year, it may be necessary to make revisions and Forest River, Inc., reserves the right to make all such changes without notice, including prices, colors, materials, equipment and specifications as well as the addition of new models and the discontinuance of models shown in this brochure. Therefore, please consult with your Forest River dealer and confirm the existence of any materials, design or specifications that are material to your purchase decision. Litho. U.S.A. FOR 1609 P/W: 2019.01.22

MEET YOUR X-LITE DEALER

WILDWOOD

PRODUCT FAMILY



X-LITE



WILDWOOD



DLX | LODGE | GRAND LODGE

CUSTOMER SATISFACTION

FOREST RIVER
encourages you to

BUY LOCAL

PREFERENTIAL SERVICE

PRODUCT INFORMATION

www.ForestRiverBuyLocal.com



FOREST RIVER
WILDWOOD

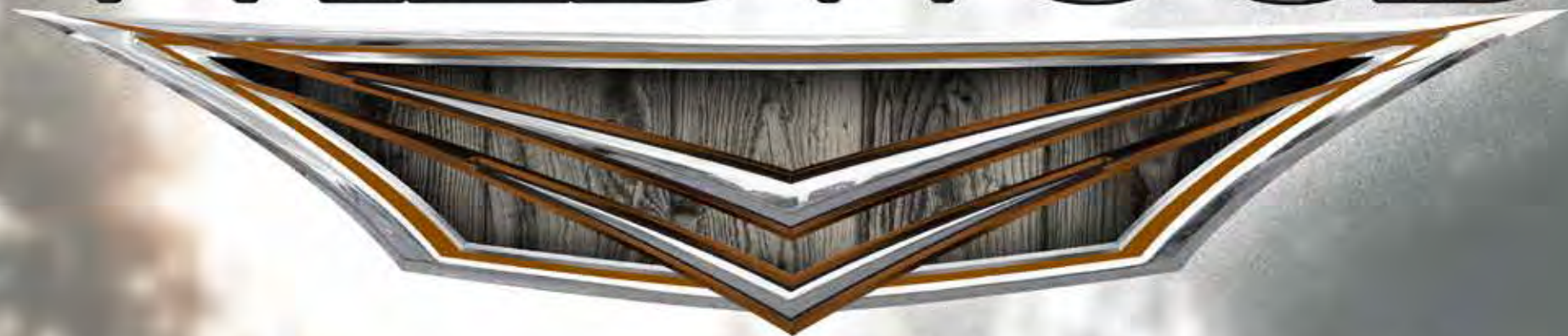

ADVENTURE AWAITS... GO FIND IT!

WILDWOOD





TRAVEL TRAILERS

INTERIOR COLORS AND EQUIPMENT MAY VARY

27RKS

DRY WEIGHT 7,154 LBS

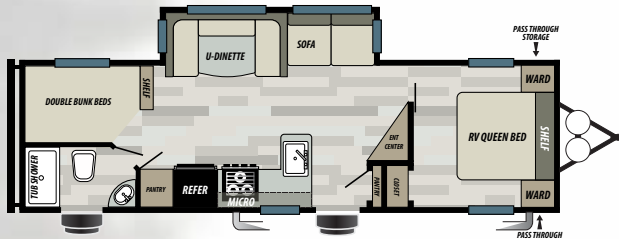

26DBUD

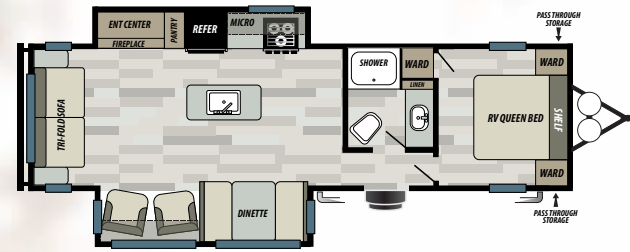

27RE

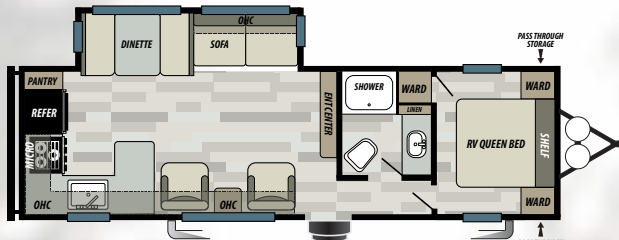

27RKS

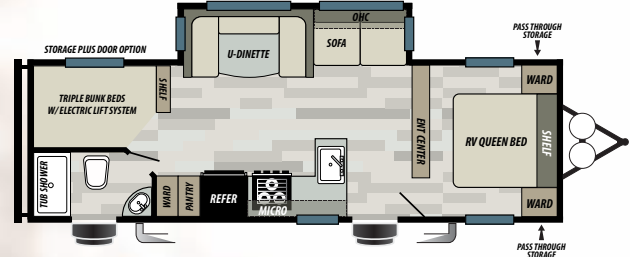

27TDSS

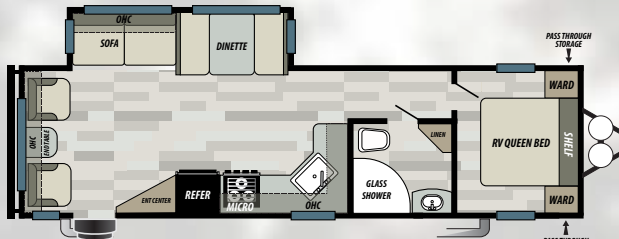

28RLSS

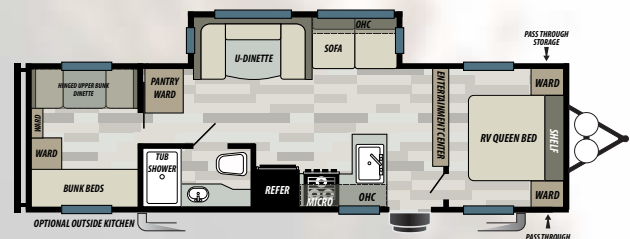

30QBSS

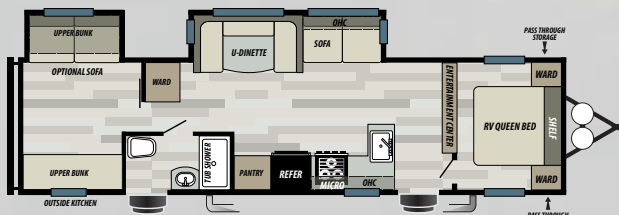

32BHDS

	26DBUD	27RE	27RKS	27TDSS	28RLSS	30QBSS	32BHDS
HITCH WEIGHT (LBS.)	866	877	836	806	844	817	931
GROSS VEHICLE WEIGHT RATING (LBS.)	9999	9999	9999	9980	9999	9985	9999
UNLOADED VEHICLE WEIGHT (LBS.)	7258	7965	7154	6662	7048	7145	8403
CARGO CARRYING CAPACITY (LBS.)	2741	1996	2845	3318	2913	2840	1596
EXTERIOR LENGTH (FT.)	33' 1"	34' 1"	33' 6"	32'	34' 9"	33' 10"	36' 4"
EXTERIOR HEIGHT (FT.)	11' 3"	11' 3"	11' 2"	11' 2"	11' 3"	11' 3"	11' 3"
FRESH WATER (GAL.)	56	56	56	56	56	56	56
GREY WATER (GAL.)	75	60	65	75	80	60	58
BLACK WATER (GAL.)	40	30	28	40	35	30	30
TIRE SIZE (IN.)	15	15	15	15	15	15	15

STANDARDS & OPTIONS

CONSTRUCTION AND EXTERIOR

5/8 TONGUE AND GROOVE FLOOR DECKING
FULL WALK ON SEAMLESS PVC ROOF WITH A 15 YEAR
MANUFACTURER DEFECT WARRANTY
EXTRA-LARGE FULL PASS THROUGH STORAGE (PER FP)
MILDEW RESISTANT VINYL PATIO AWNING
SAFETY GLASS WINDOWS
POWDER COATED I-BEAM FRAME
CAMBERED CHASSIS
GAS/ELECTRIC QUICK RECOVERY DSI WATER HEATER
WATER HEATER BYPASS
2" WALL CONSTRUCTION, 16"(OR LESS) ON CENTER
TRIPLE SEAL SLIDE OUT SYSTEM
FLUSH FLOOR ELECTRIC SLIDE OUT
SWING ARM ENTRY ASSIST HANDLE
TWO MARINE GRADE EXTERIOR SPEAKERS
AERODYNAMIC FRONT RADIUS PROFILE
SMOOTH .40 MIL ALUMINUM FRONT WRAP
EASY LUBE AXLES W/ SELF ADJUSTING BRAKES
ONE PIECE SLIP RESISTANT VINYL FLOOR
R-7 FIBERGLASS INSULATION THROUGHOUT
TEXTURED ROCKGAURD
HURRICANE STRAPS
LP QUICK DISCONNECT
1 1/4" RECEIVER
7 WAY CORD HOLSTER

KITCHEN

NEW SHAKER STYLE CABINET DOORS
HIDDEN HINGES THROUGHOUT
DOUBLE DOOR REFER (2YR WARRANTY)
HIGH RISE SPRING FAUCET
RESIDENTIAL STYLE UNDER MOUNT KITCHEN SINK
3-BURNER, HIGH OUTPUT RANGE WITH OVEN (2YR
WARRANTY)
FULL EXTENSION BALL BEARING DRAWER GUIDES
SHELVING IN OVERHEAD CABINETS IN THE KITCHEN
LARGE POTS AND PANS STORAGE UNDER DINETTE (PER
FP)
HIGH DEFINITION COUNTERTOPS

LIVING ROOM

80" INTERIOR HEIGHT
DUCTED 15 K A/C ROOF AIR CONDITIONER
HUGE STORAGE DRAWER UNDER JIFFY SOFA
LARGE DINETTE PICTURE WINDOW
DIGITAL ANTENNA WITH BOOSTER
BLUETOOTH FM STEREO
30K BTU SUBURBAN FORCED AIR DSI FURNACE W/
DIGITAL THERMOSTAT (2 YR WARRANTY)
IN-FLOOR DUCTED HEAT
CABLE TV HOOKUP LIVING ROOM AND BEDROOM

BEDROOM

NEW UPGRADED MATTRESS WITH PILLOW TOP IN
MASTER BED
STRUT LIFTED STORAGE AREA UNDER BED
BEDSIDE 110-VOLT POWER OUTLETS (2)
BEDSIDE USB CHARGERS (2)
SOLID BEDROOM PRIVACY DOOR (PER FP)
BEDSIDE HAMPER ACCESS (PER FP)

BATHROOM

12-VOLT POWER BATH ROOF EXHAUST FAN
FOOT FLUSH TOILET
HIGH DEFINITION COUNTERTOPS

SECURITY AND SAFETY

LP LEAK DETECTOR
SMOKE DETECTOR
CARBON MONOXIDE DETECTOR
FIRE EXTINGUISHER
WELDED HEAVY DUTY SAFETY CHAINS
ELECTRIC FULL SELF-ADJUSTING BRAKES
GFI RECEPTACLES
ANSI 119.2 CERTIFIED
MEETS ALL NATIONAL HIGHWAY ADMINISTRATION
SPECS
RVIA APPROVED PRODUCT



X-LITE



INTERIOR COLORS AND EQUIPMENT MAY VARY

190RBXL

DRY WEIGHT 4,558 LBS

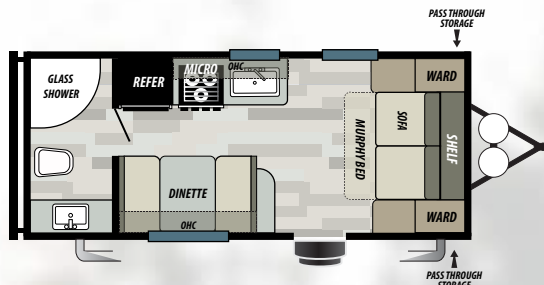

190RBXL

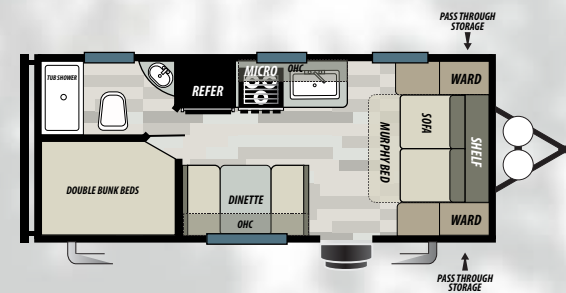

201BHXL

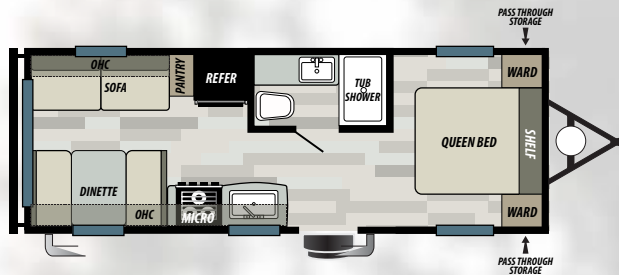

202RDXL

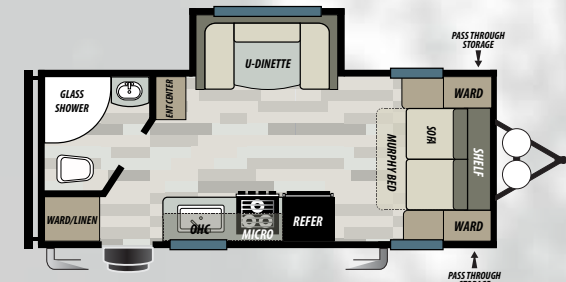

212RBXL

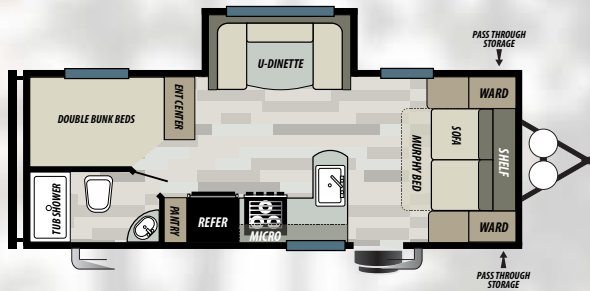

221BHXL

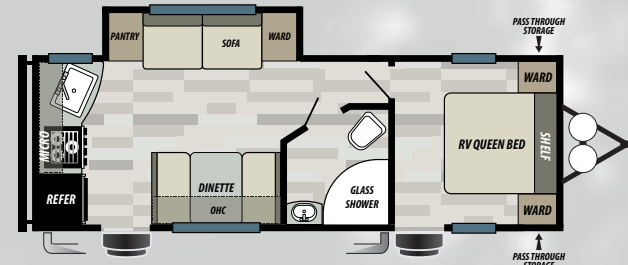

231RKXL

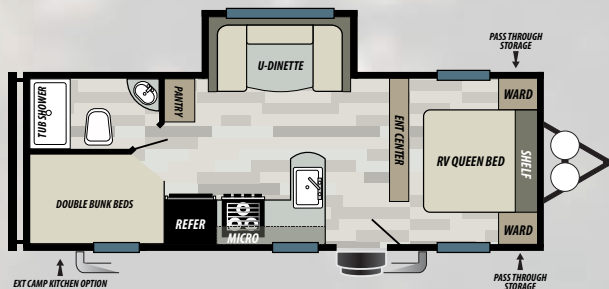

241BHXL

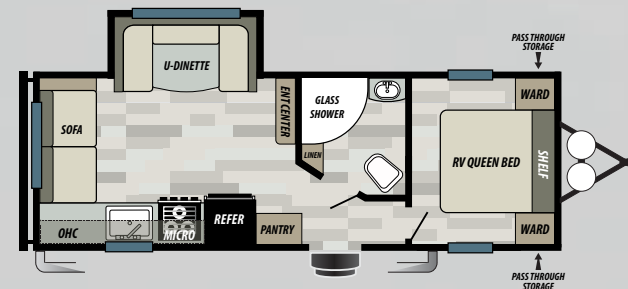

241RLXL

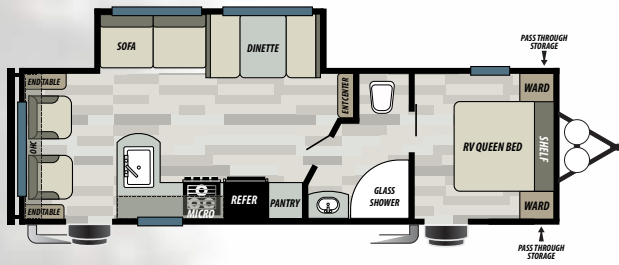

254RLXL

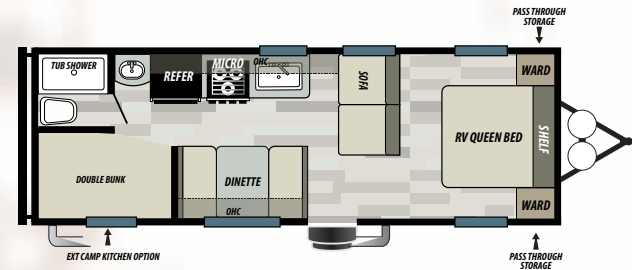

261BHL

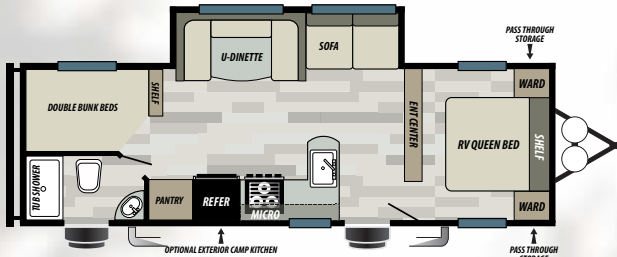

263BHL

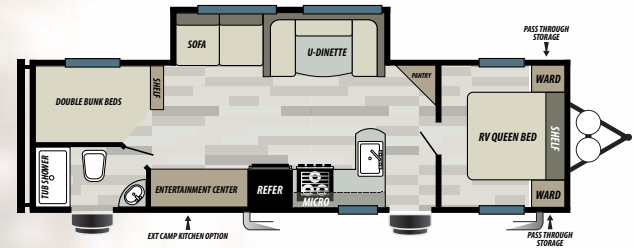

271BHL

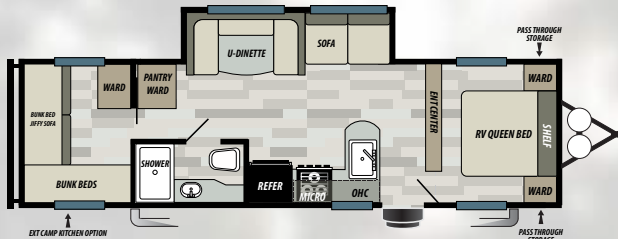

273QBL

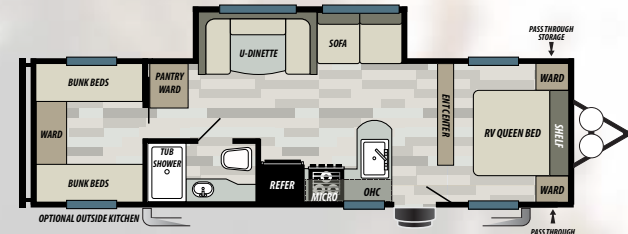

282QBL



STANDARD FEATURES

POPULAR OPTIONS

RANGE WITH OVEN IPO OF COOKTOP
SPARE TIRE AND CARRIER
DUCTED A/C (PER FP)
OUTSIDE CAMP AND OUTDOOR KITCHENS (PER FP)
POWER STABILIZER JACKS
SINK COVERS

[illegible]

SELECTS

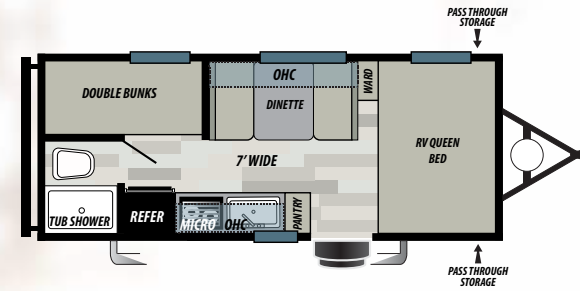

177BQ

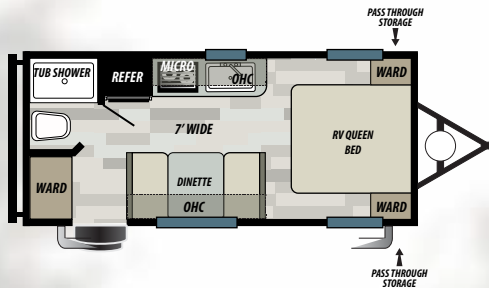

177FQ

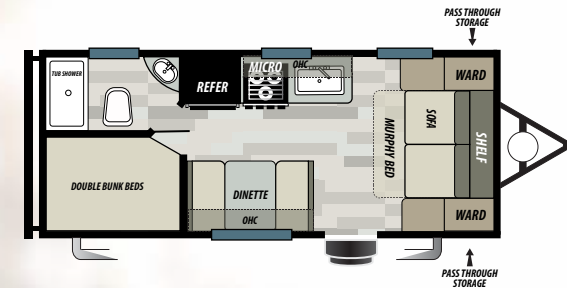

178DB

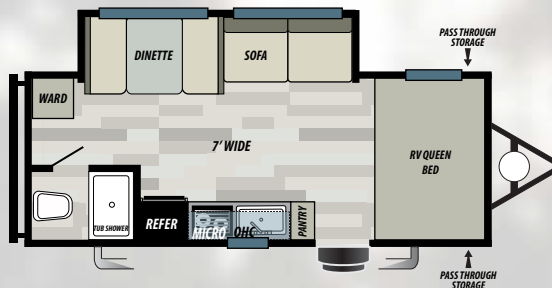

197SS

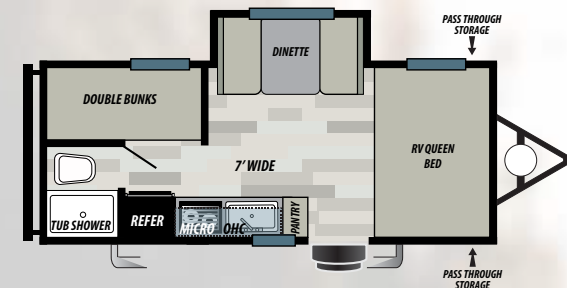

207BH

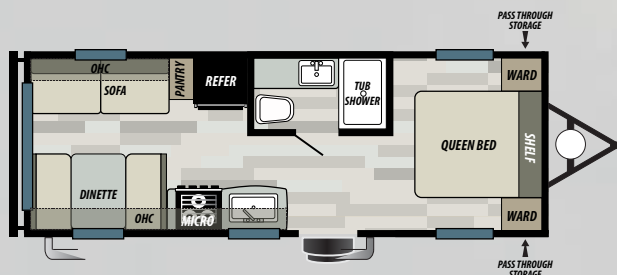

208RD

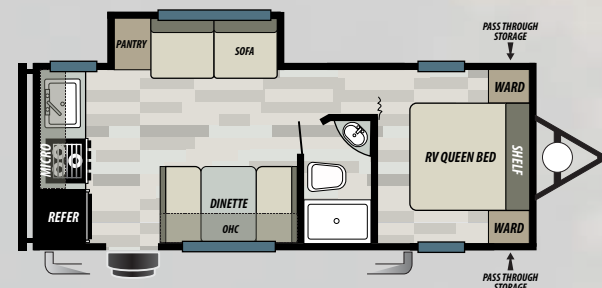

228RK

STANDARDS & OPTIONS

STANDARD FEATURES

NEW 6-WAY ADJUSTABLE HIDDEN HINGES
 STAINLESS STEEL SINGLE POLE FAUCET
 AERODYNAMIC FRONT PROFILE
 SHAKER STYLE CABINET DOORS
 NEW 3 BURNER COOK TOP
 13.5K A/C
 TEXTURED ROCK GUARD
 NEW LP QUICK CONNECT
 NEW DOUBLE DOOR GAS & ELECTRIC REFER
 NEW RESIDENTIAL SINGLE BOWL SINK
 MICROWAVE WITH CAROUSEL
 AWNING
 6 GAL GAS DSI WATER HEATER
 1-20LB LP BOTTLE
 AUTO IGNITION 20K BTU FURNACE
 NEW EXTERIOR TV HOOK UP
 MINI-BLINDS THROUGHOUT
 NEW TEDDY BEAR BUNK MATS (PER F/P)
 WATER HEATER BY-PASS
 FULL WALK ON SEAMLESS ROOF WITH A
 15 YEAR MANUFACTURER DEFECT WARRANTY
 KITCHEN DRAWER W/BALL BEARING GUIDES
 HIGH DEFINITION COUNTERTOPS
 78" INTERIOR HEIGHT
 E-Z LUBE AXLES W/SELF-ADJUSTING BRAKES

POPULAR OPTIONS

POWER AWNING W/ ADJUSTABLE LEGS
 BLUETOOTH STEREO WITH REMOTE
 BACKUP CAMERA PREP
 SOLAR PREP
 NEW USB PORTS
 SPARE TIRE AND CARRIER
 SKYLIGHT OVER TUB
 POWER TONGUE JACK
 STABILIZER JACKS (2 OR 4)

	177BQ	177FQ	178DB	197SS	207BH	208RD	228RK	267SS	268BH
HITCH WEIGHT (LBS.)	445	430	485	495	470	565	550	655	545
GROSS VEHICLE WEIGHT RATING (LBS.)	4845	4830	5585	5595	4870	7565	7550	8455	7545
UNLOADED VEHICLE WEIGHT (LBS.)	3374	3334	4033	4113	3728	4235	4708	5280	4559
CARGO CARRYING CAPACITY (LBS.)	1471	1496	1552	1482	1142	3292	2842	3175	2986
EXTERIOR LENGTH (FT.)	22' 8"	22' 8"	24'	24' 2"	22' 11"	25' 10"	26' 3"	31'	28' 8"
EXTERIOR HEIGHT (FT.)	10' 3"	10' 3"	10' 3"	10' 5"	10' 5"	10' 5"	10' 5"	10' 9"	10' 5"
FRESH WATER (GAL.)	48	48	48	48	48	48	48	48	48
GREY WATER (GAL.)	22	22	28	22	22	30	52	28	28
BLACK WATER (GAL.)	22	22	30	22	22	30	28	22	30
TIRE SIZE (IN.)	15	15	15	15	15	15	15	15	15

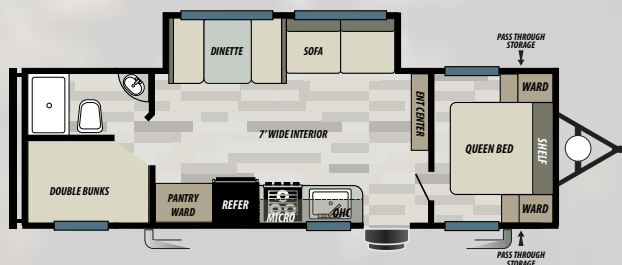

267SS

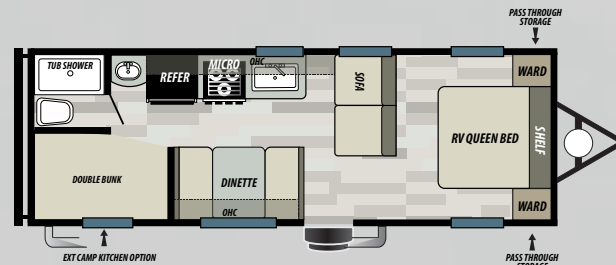

268BH



SELECT



www.forestriverfrog.com



Learn More
Scan this barcode using
a QR Reader on your
smart phone to learn
more about Forest River.



A Berkshire Hathaway company.

FOREST RIVER INC., 255 S PEPPER AVE RIALTO, CA 92376 | (909) 873-3777
WWW.FORESTRIVERINC.COM/WILDWOOD | WWW.FORESTRIVERACCESSORIES.COM
EFFECTIVE FOR UNITS PRODUCED STARTING SEPTEMBER 1ST, 2019

CUSTOMER SATISFACTION



www.ForestRiverBuyLocal.com

YOUR WILDWOOD DEALER

Specification Definitions

GVWR (Gross Vehicle Weight Rating) - is the maximum permissible weight of the unit when fully loaded. It includes all weights, inclusive of all fluids, cargo, optional equipment and accessories. For safety and product performance do NOT exceed the GVWR.

GAWR (Gross Axle Weight Rating) - is the maximum permissible weight, including cargo, fluids, optional equipment and accessories that can be safely supported by a combination of all axles.

UVW (Unloaded Vehicle Weight)* - is the typical weight of the unit as manufactured at the factory. It includes all weight at the unit's axle(s) and tongue or pin and LP Gas. The UVW does not include cargo, fresh potable water, additional optional equipment or dealer installed accessories.

*Estimated average based on standard build optional equipment.

CCC (Cargo Carrying Capacity)** - is the amount of weight available for fresh potable water, cargo, additional optional equipment and accessories. CCC is equal to GVWR minus UVW. Available CCC should accommodate fresh potable water (8.3 lbs per gallon). Before filling the fresh water tank, empty the black and gray tanks to provide for more cargo capacity. ** Estimated average based on standard build optional equipment

Each Forest River RV is weighed at the manufacturing facility prior to shipping. A label identifying the unloaded vehicle weight of the actual unit and the cargo carrying capacity is applied to every Forest River RV prior to leaving our facilities. The load capacity of your unit is designated by weight, not by volume, so you cannot necessarily use all available space when loading your unit.

All information contained in this brochure is believed to be accurate at the time of publication. However, during the model year, it may be necessary to make revisions and Forest River, Inc., reserves the right to make all such changes without notice, including prices, colors, materials, equipment and specifications as well as the addition of new models and the discontinuance of models shown in this brochure. Therefore, please consult with your Forest River dealer and confirm the existence of any materials, design or specifications that are material to your purchase decision. Litho. U.S.A. FOR 1420 P/W: 2019.3.1