

Meet the Micro Minnie FLX

The new Micro Minnie FLX provides all the comforts of home in camp or for up to five days off the grid, without a generator or external hook-ups.

- » 5 integrated technologies enhance your experience on and off the grid:
 - o Two 190-watt solar panels with 30-amp charge controller and side-mount solar prep
 - o 320-amp-hour lithium-ion battery
 - o 3,000-watt inverter
 - o Efficient Truma systems – AquaGo® water heater, VarioHeat furnace, and Aventa air conditioner – conserve energy and are all operated from a single control panel
 - o High efficiency appliances like the Showermiser system reduce water waste by instantly providing hot water and a 10.3 cu. ft. Dometic® 12-volt refrigerator runs directly off the battery
- » 4 slideout-equipped floorplans sleep up to 5
- » Full galley with microwave convection oven, 3-burner cooktop, refrigerator and stainless-steel sink
- » Complete bath with shower, medicine cabinet and linen closet on select floorplans
- » Expansive living space and storage in a compact, easy-towing camper

WINNEBAGO





WEIGHTS MEASURES	2100BH	2108DS	2108FBS	2306BHS
Exterior Length	21'11"	22'7"	22'7"	25'8"
Exterior Height (including A/C)	10'4"	10'4"	10'4"	10'4"
Exterior Width	7'0"	7'0"	7'0"	7'0"
Interior Height	6'4"	6'4"	6'4"	6'4"
GVWR (lbs.)	5,500	5,500	5,500	6,000
Dry Weight (lbs.)	3,860	4,140	4,040	4,500
Dry Hitch Weight (lbs.)	430	410	435	495
Axles (lbs.)	2@3,000	2@3,000	2@3,000	2@4,000
Tire Size	235/75R15	235/75R15	235/75R15	235/75R15
Fresh Water (Tank Only) (gal.)	31	31	31	31
Black Tank Capacity (gal.)	25	25	25	25
Gray Tank Capacity (gal.)	25	25	25	25
LP Capacity (lbs.)	40	40	40	40
Awning Length	13'	15'	15'	15'
Furnace (BTU)	18,000	18,000	18,000	18,000
Water Heater (gal.)	6	6	6	6

2100BH



2108DS

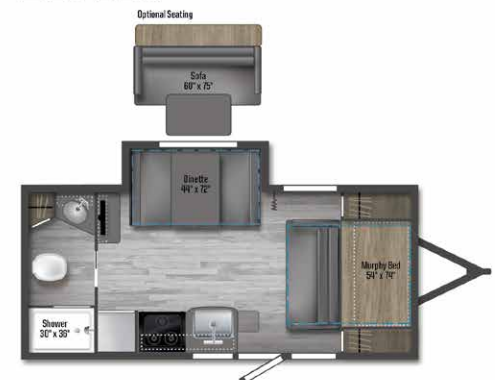

2108FBS



2306BHS



Because features, specifications, equipment, and options may vary from those highlighted in this brochure, the buyer is responsible for confirming with the dealer the features, specifications, equipment, and options included on their specific vehicle. In addition, Winnebago's program of continuous product improvement may result in changes to vehicle specifications, equipment, model availability, and price without notice.

Dotted lines denote overhead storage areas. Blue dashed lines denote sleeping areas. Floorplans are representations only and are subject to change. Please contact a certified Winnebago dealer for more information.