

# MEET THE NEW SUNSTAR

With updated styling and legendary Winnebago® quality, the Sunstar® Class A gas coach is perfect for entertaining your family and friends.

**WINNEBAGO**



## **Simply the Best**

Best in class features include highest exterior storage capacity, largest holding tanks and most expansive views, thanks to its 1-piece windshield and streamlined A-pillars.

## **Contemporary Design**

New contemporary interior styling featuring a spacious lounge, luxurious Ultrafabrics® Select furnishings, and available powered StudioLoft™ bed.

## **One Panel, One App**

Winnebago Control™ provides convenient access to all major coach systems from an easy-to-use control panel or your phone app.

## **Exterior Upgrades**

Arrive in style with the available "High-Rez" Exterior Upgrade Package featuring premium full-body paint, LED lamps and more.

## **Beautiful Scenery**

Frameless, tinted windows offer stunning, unobstructed views from your coach.



## Weights & Measurements

|   | 29V     | 33K     |
|---|---------|---------|
| Length                                    | 30'     | 34'3"   |
| Exterior Height                           | 12'1"   | 12'4"   |
| Exterior Width                            | 8'5.5"  | 8'5.5"  |
| Exterior Storage (cu.ft.)                 | 122     | 122     |
| Awning Length                             | 17'     | 15'     |
| Interior Height                           | 6'8"    | 6'10"   |
| Interior Width                            | 8'0.25" | 8'0.25" |
| Freshwater Tank Capacity (gal.)           | 71      | 93      |
| Water Heater Capacity (gal.)              | 6       | 6       |
| Holding Tank Capacity - Black/Gray (gal.) | 40/61   | 75/102  |
| LP Capacity (lbs.)                        | 76.14   | 76.14   |
| Fuel Capacity (gal.)                      | 80      | 80      |
| GCWR (lbs.)                               | 23,000  | 26,000  |
| GVWR (lbs.)                               | 18,000  | 22,000  |
| GAWR - Front (lbs.)                       | 7,000   | 8,000   |
| GAWR - Rear (lbs.)                        | 12,000  | 15,000  |
| Wheelbase                                 | 190"    | 208"    |
| Sleeps                                    | 5       | 6       |

Winnebago's® continuing program of product improvement makes specifications, equipment, model availability, and prices subject to change without notice. Published content reflects the most current product information at the time of printing. Please consult your dealer for individual vehicle features and specifications.

## Décor

### TOWN & COUNTRY

w/Salinas Cabinetry and Light Ultra Select



Ultrafabrics Select



Feature Fabric

Wall Board



Bedspread

Countertop



Residential Vinyl Flooring

Salinas

### 29V

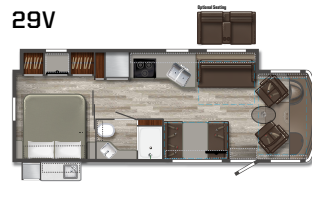

### TOWN & COUNTRY

w/Salinas Cabinetry and Dark Ultra Select



Ultrafabrics Select



Feature Fabric

Wall Board



Bedspread

Countertop



Residential Vinyl Flooring

Salinas

### 33K



## Exteriors



### FLINTSTONE



### DEEP SEA



### TOREADOR



### CLOUDBURST



### MOONLIGHT



SCAN THIS QR CODE  
TO LEARN MORE ABOUT THIS MODEL

**Note:** Dotted lines denote overhead storage area. Blue dashed lines denote sleeping areas. Floorplans are representations only and are subject to change. Please contact a certified Winnebago dealer for more information.