

ACCOLADE XL

SUPER CLASS C DIESEL MOTOR COACH



2022



ENTEGR A
COACH®



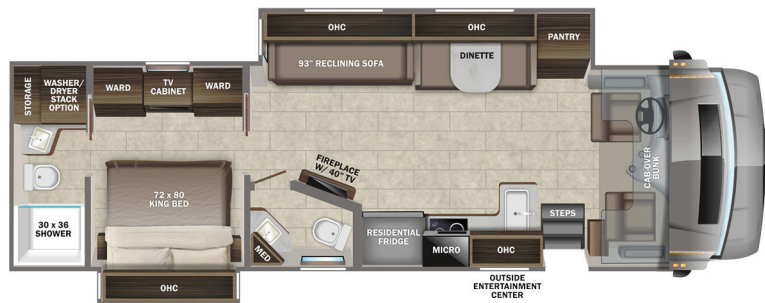

37K OPTIONS
C



37L OPTIONS
A AND C

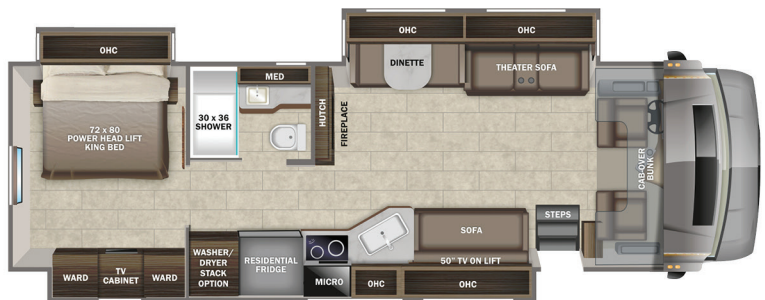

37M OPTIONS
B AND C

OPTIONS



Theater Sofa Option

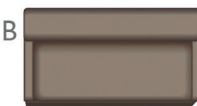

72" Hide-A-Bed
Sofa Option



Freestanding
Dinette Option

WOOD OPTIONS

Almond Maple



Auburn Maple



Stonewall Grey



EXTERIOR SELECTIONS



Beige Lightning Paint



Blue Lightning Paint



Grey Lightning Paint



Red Lightning Paint

FABRIC OPTIONS

Eggshell

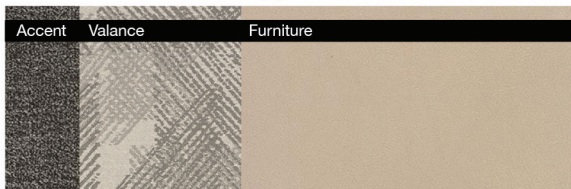

Onyx

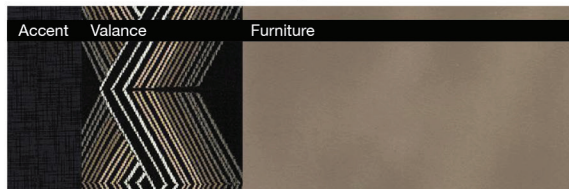

Pinecone



CUSTOMER VALUE PACKAGE

E-Z DRIVE™ PREMIER: Computer-balanced driveshaft, rear air suspension, heavy-duty rear stabilizer bar, full air brakes, SACHS shocks
Dual-pane, tinted, safety-glass windows
Roof-mounted Girard® NOVA II dual-pitched patio awning with LED lights
2,000-watt pure sine wave inverter
Power cord reel with 50-amp service
Aqua-Hot® 250D hydronic water and heating system
9-in. Sony® infotainment center with Apple CarPlay® and Android Auto™
Backup and side-view cameras
21-cu.ft. residential refrigerator with ice and water in door
Residential-size convection microwave

STANDARD CHASSIS EQUIPMENT

Freightliner® S2RV chassis
Cummins® ISB 6.7L 360 HP diesel engine with 800 ft.-lb. torque
Allison® 3000 MH automatic transmission
Engine exhaust brake
GVWR - 31,000 lb.
GCWR - 43,000 lb.
Front axle - 10,000 lb.
Drive axle - 21,000 lb.
185-amp alternator
Michelin® tires- 275/80R 22.5 14 ply
12,000-lb. rear hitch receiver
7-pin plug
Dual 12V chassis batteries
100-gal. fuel tank
10-gal. DEF tank

HEAT, A/C, POWER & WATER EQUIPMENT

Onan® 8,000-watt diesel generator with auto-gen start
(4) 6V AGM (220Ah) house batteries on slideout tray
190W solar panel with dual controller
Dual 15,000-BTU A/C unit with heat pumps
Touchstone electric 5,000 BTU thermostat controlled fireplace
Thetford® Sani-Con Turbo Macerator system
Exterior utility center
Winterization drain system
Black tank flush
Outside shower
12V demand water pump
Water filtration system

STANDARD EXTERIOR EQUIPMENT

TuffShell™ vacuum-bond laminated roof, floor and sidewalls
One-piece, crowned fiberglass roof
Bead-foam insulation (R-24 max roof, R-9 max floor, R-5 max walls)
One-piece, seamless, fiberglass front and rear caps
Automotive-bonded panoramic window in front cap with power shade
Premium Sikkens full-body paint
Automatic hydraulic leveling jacks
Alcoa® aluminum rims
Exterior entertainment center with outside speakers, LED TV mounted on swivel bracket and single-disc DVD/CD/AM/FM radio
Winegard® In-motion satellite dish
Deluxe heated, remote-controlled, side-view mirrors
Entrance door with industry's largest travel-view window
Electric-powered entrance step
Slideout cover awnings
Chrome exterior baggage door handles and locks
Lockable, pass-through storage compartments with metal slam latches
Roof ladder

COCKPIT AMENITIES

Power windows and door locks
Tilt and telescoping leather-wrapped steering wheel
Power driver and passenger seats
Auxiliary start switch
Privacy curtains for cab area
Carpeted cab floor mat
A/C and cruise control

STANDARD INTERIOR EQUIPMENT

Custom-molded ABS surround in cab-over area
Overhead bunk with 750 lb. capacity
Firefly Multiplex System
High-intensity recessed LED ceiling lights
Raised-panel high-gloss hardwood cabinetry and stiles throughout
Deluxe hidden cabinet hinges
Porcelain tile floor with heated floor mat
Entegra-exclusive, easy-operation legless dinette table
50-in. LED TV in living area (40 in. on 37K)
Cable TV hookup with RG-6 coax and video selector switch
Winegard 2.0 Wi-Fi/4G antenna
Wood-framed kitchen window with spice cabinets
2-burner induction cooktop
Solid-surface kitchen countertop with large integrated stainless steel sink with sink covers
One-piece, fiberglass shower with glass door, skylight and light

Porcelain toilet with foot flush
Solid-surface bathroom sink
Powered roof vent in bathroom with wall switch
Walk-around, king-size bed with bedspread and nightstands
32-in. LED TV in bedroom
Large wardrobes
Bunks with industry-exclusive 300 lb. capacity each (37L)

STANDARD SAFETY EQUIPMENT

2-point lap safety belts in all designated seating locations
Third brake light
Porch light with clear lens
Smoke alarm
Carbon monoxide detector
Driver and passenger airbags

OPTIONS

Power theater seating (37L, STD on 37M)
Freestanding table with 4 chairs (N/A 37L)
Stackable washer/dryer
Winegard® TRAV'LER® satellite dish - DIRECTV®
Winegard® TRAV'LER® satellite dish - Dish Network®
Canadian Shaw® TRAV'LER® satellite dish

WARRANTY

2+3
YEAR LIMITED | YEAR STRUCTURAL
WARRANTY

NO ONE OFFERS A BETTER WARRANTY

At Entegra Coach, we build our RVs to handle every adventure, then back them with our industry-leading 2+3 limited warranty. Our 2-year limited warranty has you covered for 2 camping seasons. That's 730 days. In addition, our 3-year structural limited warranty has you covered for 3 camping seasons or 1,095 days. You won't find a better limited warranty in the business, because the only strings we attach are those that deliver the ultimate in reliability. For a copy of our 2-year limited + 3-year structural limited warranty with complete terms and conditions, please contact your local Entegra Coach dealer.

It is important for your safety and enjoyment that you are aware of the weights and tow ratings of the RV you select. Consult a competent advisor for questions or advice. Whether you are new to RVing or a veteran, get a feel for the performance of your RV before heading out on the roadways. When you tow a vehicle with your RV, you must drive differently than when you drive a single vehicle. Practice hooking up, driving, backing up and braking in a safe environment or seek out professional instruction. Jayco affixes a weight label to each RV which lists weight information for that vehicle. Refer to that label to verify the vehicle will meet your requirements. Gross Vehicle Weight Rating (GVWR): The maximum permissible weight of the motorhome, including the Unloaded Vehicle Weight (UUV) plus passengers, personal items, all cargo, fluids, options and dealer-installed accessories. The GVWR is equal to or greater than the sum of the UUV and the Cargo Carrying Capacity. Gross Combined Weight Rating (GCWR): The maximum allowable combined weight of the motorhome used as a tow vehicle and the attached towed vehicle.

Floorplan	GVWR (lbs.)	GCWR (lbs.)	Wheel Base	Overall Length	Exterior Height w/ A/C & Satellite	Exterior Width	Interior Height	Fresh Water Capacity (gal.)	Grey Waste Water Capacity (gal.)	Black Waste Water Capacity (gal.)
37K	31,000	43,000	279	39' 4"	13' 4"	101	84	72	51/40	40/23
37L	31,000	43,000	279	39' 4"	13' 4"	101	84	72	50/31	50
37M	31,000	43,000	279	39' 4"	13' 4"	101	84	72	40/40	33/23

ENTEGRA

COACH®

Part of the Jayco Family of Companies

Entegra Coach, Inc., P.O. Box 460, Middlebury, IN 46540, www.entegracoach.com. See dealer for further information and prices. All information in this brochure is the latest available at the time of publication approval. Entegra Coach reserves the right to make changes and to discontinue models without notice or obligation. Photos in this brochure may show optional equipment and props for photography purposes. RVs built for sale in Canada may differ to conform to Canadian codes. ©2021 Entegra Coach, Inc. Printed in U.S.A. 257100

#WeAreEntegra



Learn more at
entegracoach.com/accolade-xl