

LUXURY CROSSOVER  
TOY HAULER



***ROAD WARRIOR***

 BROUGHT TO YOU BY  
HEARTLAND®



# TOP 5 EXTERIOR FEATURES

- 1 | Upgraded CRE3000 suspension with the bolt kit for superior travel
- 2 | 100 Watt solar panel with inverter prep
- 3 | Sleek and aerodynamic for a streamlined ride
- 4 | Two 30 gallon fuel tanks, lockable and tucked out of sight.
- 5 | MORryde Pin Box made with a rubber spring providing more flexibility and absorbs the transfer of energy from your RV to your truck.

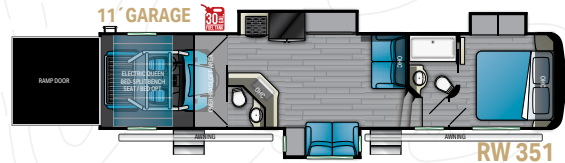

**LENGTH: 41' 6" | HEIGHT: 13' 3" | HITCH: 2,800 LBS.**  
**DRY: 14,530 LBS. | GVWR: 17,250 LBS. | SLEEP CAPACITY: 7-8**

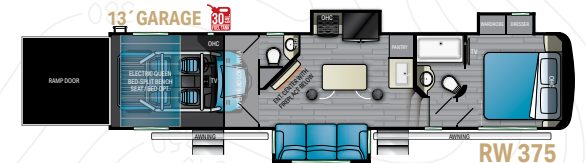

**LENGTH: 41' 6" | HEIGHT: 13' 3" | HITCH: 2,975 LBS.**  
**DRY: 13,860 LBS. | GVWR: 16,250 LBS. | SLEEP CAPACITY: 7-8**

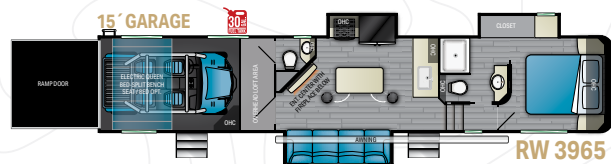

**LENGTH: 45' 8" | HEIGHT: 13' 3" | HITCH: 4,150 LBS.**  
**DRY: 15,546 LBS. | GVWR: 20,000 LBS. | SLEEP CAPACITY: 5-6**

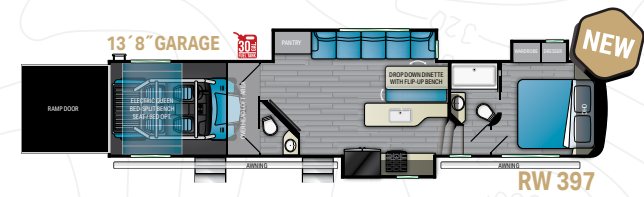

**LENGTH: 43' 10" | HEIGHT: 13' 3" | HITCH: TBD LBS.**  
**DRY: TBD LBS. | GVWR: TBD LBS. | SLEEP CAPACITY: 7-8**



## TOP 5 INTERIOR FEATURES

- 1 | Entertainment center with JBL Hi-Fi sound system with subwoofer
- 2 | Garage with Tie Downs: professionally installed tie downs for securing heavy toys
- 3 | High efficiency A/C system & 12 volt tank heaters
- 4 | Easily raise or lower the back door with no extra hardware.
- 5 | Luxury fireplace creating a warm ambiance. (standard on most models).

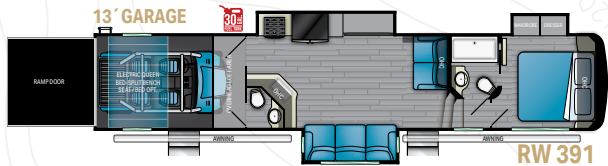

**LENGTH: 45' 6" | HEIGHT: 13' 3" | HITCH: 3,540 LBS.**  
**DRY: 15,800 LBS. | GVWR: 20,000 LBS. | SLEEP CAPACITY: 7-8**

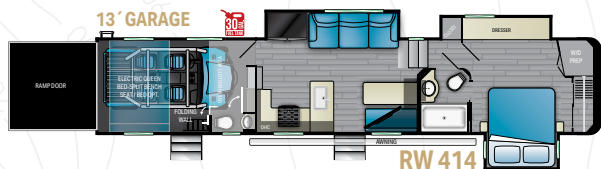

**LENGTH: 44' 6" | HEIGHT: 13' 3" | HITCH: 3,662 LBS.**  
**DRY: 16,240 LBS. | GVWR: 20,000 LBS. | SLEEP CAPACITY: 5-6**

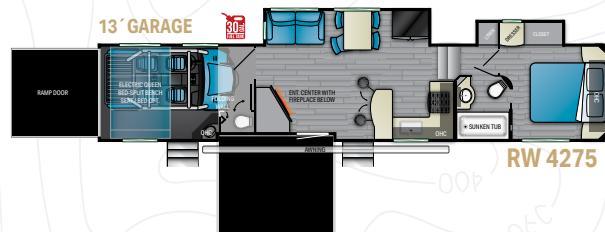

**LENGTH: 45' 8" | HEIGHT: 13' 3" | HITCH: 3,525 LBS.**  
**DRY: 15,729 LBS. | GVWR: 20,000 LBS. | SLEEP CAPACITY: 5-6**





## SPECIAL FEATURES



Luxury Fireplace



JBL Hi-Fi sound system

## INTERIOR FABRIC DECOR OPTIONS



Shadow Stone

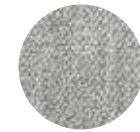

Country Creek

## VISIT US ONLINE



For more information and to take a virtual walk-through, visit [www.heartlandrvs.com](http://www.heartlandrvs.com)

Your authorized Heartland dealer:

### ROAD WARRIOR FIGHTER PACKAGE:

- Hardwood Cabinet Doors
- Solid Surface Counter Tops
- Stainless Steel Kitchen Sink & Faucet
- 5.5 Onan Generator
- Mor-Ryde Flip Tread Rear Entry Step
- Under Step Cargo Storage Box
- Frame Welded Tie Downs
- 21" Oven
- 30" OTR Microwave
- 18 Cu Gas/Electric Refrigerator
- 10 Gal DSI 110/12V Water Heater (20GPH)
- Washer/Dryer Prep
- Residential Style Furniture w/USB Ports
- LED Lighting
- 40" Fireplace
- 1 Pc Fiberglass Shower w/Glass Door
- Nev-R-Adjust Brake Pkg
- 50 AMP Service
- Battery Disconnect
- U.D.C. w/Black Tank Flush & Exterior Shower
- Heated Enclosed Underbelly
- Spare Tire
- Back-up Camera Prep
- Dual Power Awning w/LED Light
- 30 Gallon Fuel Station w/ 2nd 30 Gallon Aux Tank
- AC System
- Rear Garage Screen
- Ladder

### ROAD WARRIOR GLADIATOR PACKAGE:

- Hydraulic 6-pt Level Up
- Mor-Ryde 3000 Suspension
- Mor-Ryde Upgraded Rubber Pin Box
- Mor-Ryde Step Above Entry Step
- G-Range Tires
- EZ Lube Dexter 7000# Axles

### ROAD WARRIOR CHAMPION PACKAGE:

- 50" LED Living Room TV
- JBL Upgraded Sound System & Subwoofer
- 32" Bedroom TV
- 40" Garage TV
- Central Vac System
- Ramp Door Patio Kit with Step
- Rear Electric Patio Awning

### AVAILABLE OPTIONS:

- Air Compressor Option
- Removable Edged Cargo Carpet
- 3 Season Garage Wall
- Mega Sofa (4275 Only)
- 3rd A/C Option (Double Axle Only)

### FULL BODY PAINT OPTIONS

- Shadow 
- Phantom 



Product information is as accurate as possible as of the date of publication of this brochure. Due to Heartland's commitment to continuous product improvement, floorplans, materials, components, features, measurements, specifications, options, etc. are subject to change at any time without notice or obligation. In certain conditions some additional equipment may be needed. Photos may show optional equipment or props used for photography purposes only. Heartland has listed the approximate base weight of the trailer without the optional equipment included. Optional equipment will impact the weight of the trailer. Please locate the weight sticker attached to the trailer you are considering for the most accurate trailer weight. Tow Vehicle Caution: Owners of Heartland recreational vehicles are solely responsible for the selection and proper use of tow vehicles. All customers should consult with the motor vehicle manufacturer or their dealer concerning the purchase and use of suitable tow vehicles for Heartland products. Heartland disclaims any liability or damages suffered as a result of the selection, operation, use or misuse of a tow vehicle. Heartland's limited warranty does not cover damage to the recreational vehicle or the tow vehicle as a result of the selection of the tow vehicle. Overall length for a Fifth Wheels is defined as the body length of the trailer excluding hitch meaning bumper to cap. The overall length for a Travel Trailer is defined as the body length of the trailer including hitch, meaning bumper to hitch(pin). It does not include rear ladder of spare tire. Optional pin boxes will affect overall length. SPRING 12/22 (REV 1)