

A HIGHER LEVEL
OF EXPECTATIONS



ELKRIDGE

 BROUGHT TO YOU BY
HEARTLAND

TOP 5 EXTERIOR FEATURES

- 1 THE ELKRIDGE EXTRA MILE**
 - Zero Gravity Entrance Step Friendly for All Ages
 - 12v Power Cord Reel: Quick and Easy Set up and Tear Down
 - Elkridge Cold Weather Package with 12v Heating Pads on Tanks
- 2 STORE MORE PASS-THROUGH STORAGE**
 - Innovative Storage Design that Can NOT Be Shopped
 - Three Points of Access Provides Easy Loading and Unloading
 - Maximized Storage Capacity on a Non-Drop Frame
- 3 ELKRIDGE EASY TOW**
 - Double 7,000lb Dexter EZ Lube Axels
 - MORryde 3000 Suspension with Leaf Springs
 - Upgraded Rota Flex Pin Box to Help Prevent Against Coach Chucking
- 4 LET'S GO HYDRAULIC**
 - 6pt Hydraulic Level-Up: 50% Faster than Electric
 - One Touch Auto Level Capability
 - Hydraulic Slide Out System on Main Deck
- 5 ELKRIDGE DURABILITY**
 - Double Layer Azdel Composite Panels
 - TPO Roofing Material with 4" Aluminum Wrapped Edge
 - 10" Powder Coated Steel I-Beam Frame Front to Rear

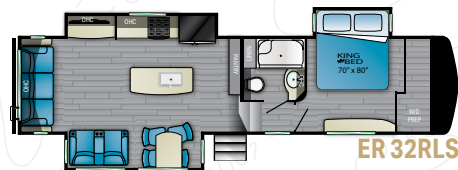

ER 32RLS
 LENGTH - 36' 11" | HEIGHT - 13' 3" | HITCH - 2,260 LBS.
 DRY - 12,000 LBS. | GVWR - 16,000 LBS. | SLEEP CAPACITY - 3-4

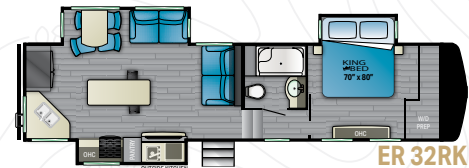

ER 32RK
 LENGTH - 36' 6" | HEIGHT - 13' 4" | HITCH - 2,400 LBS.
 DRY - 10,955 LBS. | GVWR - 15,000 LBS. | SLEEP CAPACITY - TBD

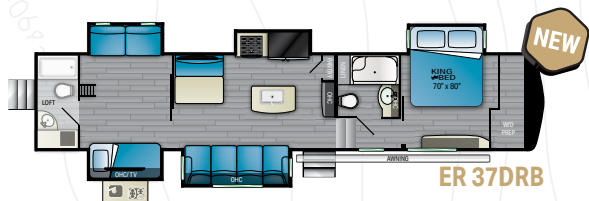

ER 37DRB
 LENGTH - 43' 0" | HEIGHT - 13' 4" | HITCH - TBD LBS.
 DRY - TBD LBS. | GVWR - TBD LBS. | SLEEP CAPACITY - 3-4

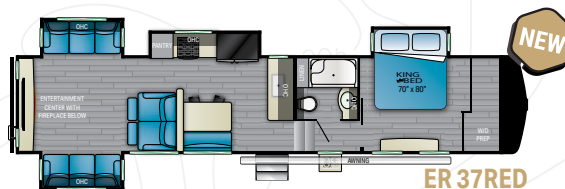

ER 37RED
 LENGTH - 40' 6" | HEIGHT - 13' 4" | HITCH - 2,780 LBS.
 DRY - 12,545 LBS. | GVWR - 15,500 LBS. | SLEEP CAPACITY - 5-6

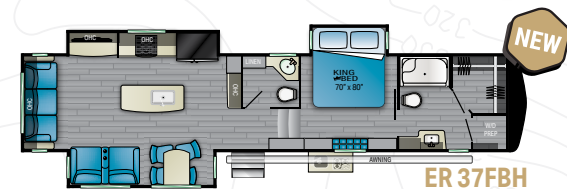

ER 37FBH
 LENGTH - 42' 4-1/4" | HEIGHT - 13' 4" | HITCH - 2,660 LBS.
 DRY - 12,905 LBS. | GVWR - 16,660 LBS. | SLEEP CAPACITY - 3-4

TOP 5

INTERIOR FEATURES



- 1 | **TECH FRIENDLY RV**
 - Big Screen TV with Built-In Sound Bar and HDMI Port
 - Winegard 360 Air + with Satellite and Wifi Prep
 - USB Charging Ports and Wireless Charging Stations Throughout
- 2 | **LET'S GO STANDARD**
 - Tri-Fold Sleeper Sofas and Theater Seating
 - 40" Electric Fireplace with Accent Lighting
 - King Bed with Under Bed Storage and Nightstands
- 3 | **MASTER CHEF KITCHEN**
 - 14.9cu ft Residential French Door Refrigerator
 - 22" Stainless Steel Oven with 3 Burner Cooktop and 30" Microwave
 - Abundant Kitchen Storage and Solid Surface Area in All Floorplans
- 4 | **VORTEX DUAL DUCTED A/C SYSTEM**
 - 15k Main A/C With 13.5k Secondary A/C Standard
 - H-Ducted for High Efficiency Output
 - Independent Thermostats Per A/C for Ease of Control
- 5 | **NO CARPET ZONE**
 - High End Woven Flooring in All Dinette Slide outs
 - Easy to Maintain and Clean
 - Pet Friendly and Anti-Microbial

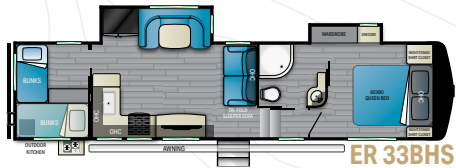

ER 33BHS

LENGTH - 36' 3" | HEIGHT - 13' 4" | HITCH - 2,150 LBS.
 DRY - 10,745 LBS. | GVWR - 15,500 LBS. | SLEEP CAPACITY - 7-8

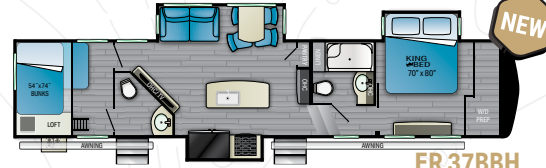

ER 37BBH

LENGTH - 42' 5-1/4" | HEIGHT - 13' 4" | HITCH - 2,630 LBS.
 DRY - 12,770 LBS. | GVWR - 16,630 LBS. | SLEEP CAPACITY - 7-8

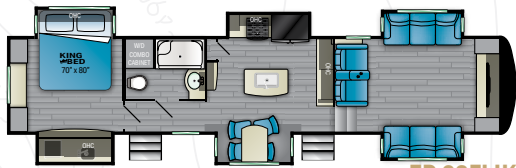

ER 38FLIK

LENGTH - 42' 4" | HEIGHT - 13' 3" | HITCH - 3,000 LBS.
 DRY - 13,460 LBS. | GVWR - 16,000 LBS. | SLEEP CAPACITY - 5-6

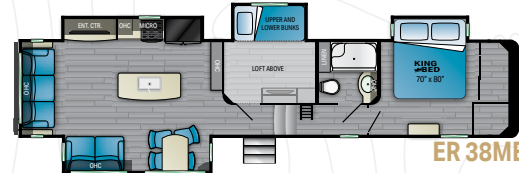

ER 38MB

LENGTH - 42' 6" | HEIGHT - 13' 3" | HITCH - 2,470 LBS.
 DRY - 13,210 LBS. | GVWR - 16,000 LBS. | SLEEP CAPACITY - 7-8

SPECIAL FEATURES

ELKRIDGE SUITE PACKAGE:

- Solid Stained Hardwood Interior Cabinets
- Dinette Table w/ 4 Chairs
- Solid Surface Countertops
- Drawers w/ Solid Bottoms & Full Extension Drawer Guides
- Stainless Steel Kitchen Sink w/ Residential Style Faucet
- Stainless Steel Gas Oven & 3 Burner Cook Top & Glass Stove Cover
- 30" Microwave
- Stainless Steel Residential Refrigerator
- 40" Electric Fireplace
- 15K BTU Ducted A/C System
- 12 Gal DSI 110/12V Water Heater
- 48" Shower w/ Skylight
- Porcelain Foot Flush Toilet
- Stackable Washer/Dryer Prep,
- King Bed
- Cold Crack Resistant Floor
- LED TV
- Tri-Fold Sleeper Style Sofa
- Theater Style Seats
- LED Interior Lighting

INTERIOR UPGRADE OPTIONS:

- 12 Cu. Stainless Steel Gas/Electric RV Refer
- Booth Dinette IPO of Free Standing Table & Chairs
- 32" LED TV in Bedroom

ELKRIDGE SUMMIT PACKAGE:

- High Gloss Sidewalls
- Painted Fiberglass Front Cap
- Universal Docking Station w/ Black Tank Flush & Exterior Shower
- Aluminum Framed & Laminated Sidewalls w/ Azdel
- Tinted Safety Glass Windows
- 16" Aluminum Rims
- F-Rated Tires
- Spare Tire
- EZ Lube Dexter Axles
- 6 Point Leveling
- 2nd A/C
- 50 Amp Service
- Nev-R-Adjust Brake Package
- Heated & Enclosed Underbelly
- Slam Baggage Style Doors
- Stop/Turn/Tail Lights
- Twin 30# LP
- Back-Up Camera Prep
- Power Awning w/ LED Light
- Solar Prep
- Solid Entrance Step Above
- 70" Tri-Fold Sofa(38MB/38RSRT)
- Winegard Air 360

EXTERIOR OPTIONS:

- Generator Prep



Stor More Storage



Zero Gravity Steps

INTERIOR FABRIC DECOR OPTIONS



River Bed

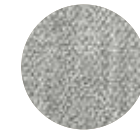

Seaport

VISIT US ONLINE

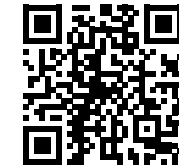

For more information and to take a virtual walk-through, visit www.heartlandrvs.com

Your authorized Heartland dealer:



Product information is as accurate as possible as of the date of publication of this brochure. Due to Heartland's commitment to continuous product improvement, floorplans, materials, components, features, measurements, specifications, options, etc. are subject to change at any time without notice or obligation. In certain conditions some additional equipment may be needed. Photos may show optional equipment or props used for photography purposes only. Heartland has listed the approximate base weight of the trailer without the optional equipment included. Optional equipment will impact the weight of the trailer. Please locate the weight sticker attached to the trailer you are considering for the most accurate trailer weight. Tow Vehicle Caution: Owners of Heartland recreational vehicles are solely responsible for the selection and proper use of tow vehicles. All customers should consult with the motor vehicle manufacturer or their dealer concerning the purchase and use of suitable tow vehicles for Heartland products. Heartland disclaims any liability or damages suffered as a result of the selection, operation, use or misuse of a tow vehicle. Heartland's limited warranty does not cover damage to the recreational vehicle or the tow vehicle as a result of the selection of the tow vehicle. Overall length for a Fifth Wheels is defined as the body length of the trailer excluding hitch meaning bumper to cap. The overall length for a Travel Trailer is defined as the body length of the trailer including hitch, meaning bumper to hitch/pin. It does not include rear ladder of spare tire. Optional pin boxes will affect overall length. .SPRING 12/22 (REV 1)