

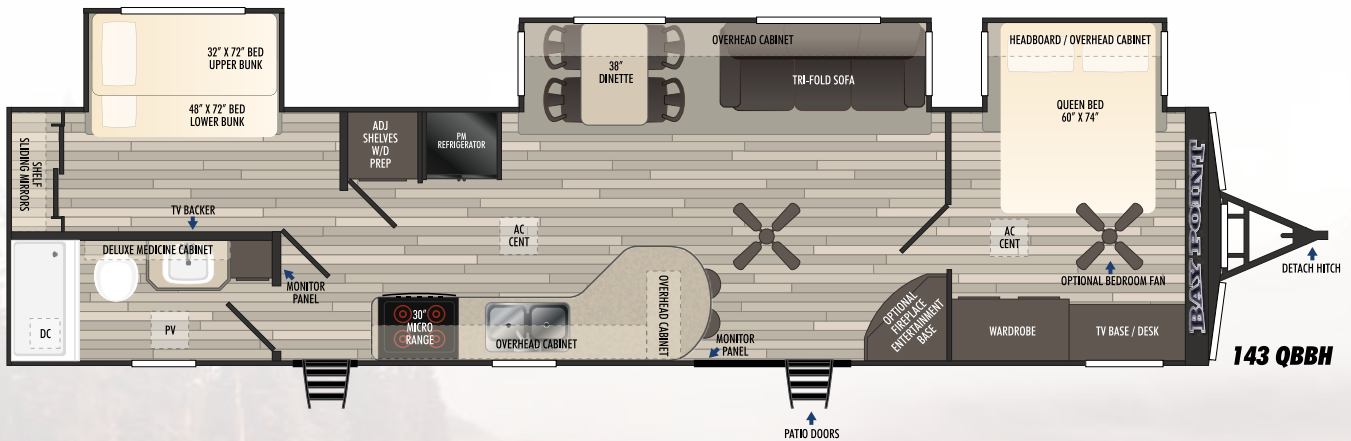

Customer Driven Products • Quality Driven Products • Customer Driven Experience



The residential design of the Bay Point destination trailer truly gives you the feeling of home. The taller ceilings and a wider body provide you the room for longer vacations. The spacious kitchen and living room give you full size appliances, loads of storage, and plenty of room to relax or entertain friends. Make Bay Point your comfortable home away from home.



143 QBBH

| Model | GVWR | Dry Wgt | Hitch Wgt | Ext Length | Ext Height | Axles | Fresh | Gray | Black | Water Htr | Awning | AC(s) | Furnace |
|-----------------|--------|---------|-----------|------------|------------|-------|-------|------|-------|-----------|--------|-------|---------|
| 143 QBBH | 14,000 | 12,242 | 1,500 | 43' | 13'4" | 2 | 49 | 98 | 49 | 20 | 21' | 15K | 40K BTU |

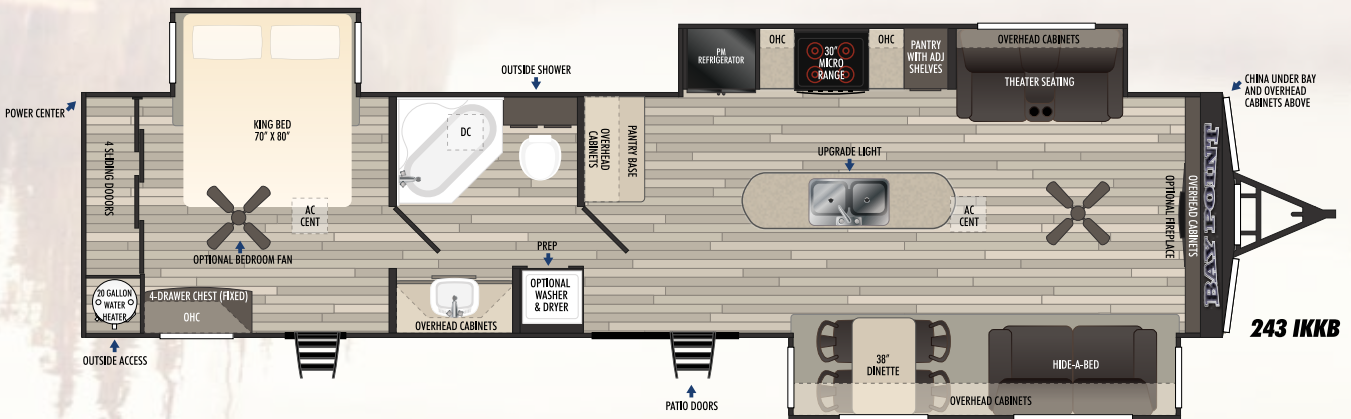

243 IKKB

| Model | GVWR | Dry Wgt | Hitch Wgt | Ext Length | Ext Height | Axles | Fresh | Gray | Black | Water Htr | Awning | AC(s) | Furnace |
|-----------------|--------|---------|-----------|------------|------------|-------|-------|------|-------|-----------|--------|-------|---------|
| 243 IKKB | 14,000 | 12,366 | 1,910 | 43' | 13'4" | 2 | 49 | 98 | 49 | 20 | 17' | 15K | 40K BTU |



30" Residential Micowave.



Residential DVD Sound Bar & 30" 4 Color Fireplace.



Residential Raised Panel Cabinetry.

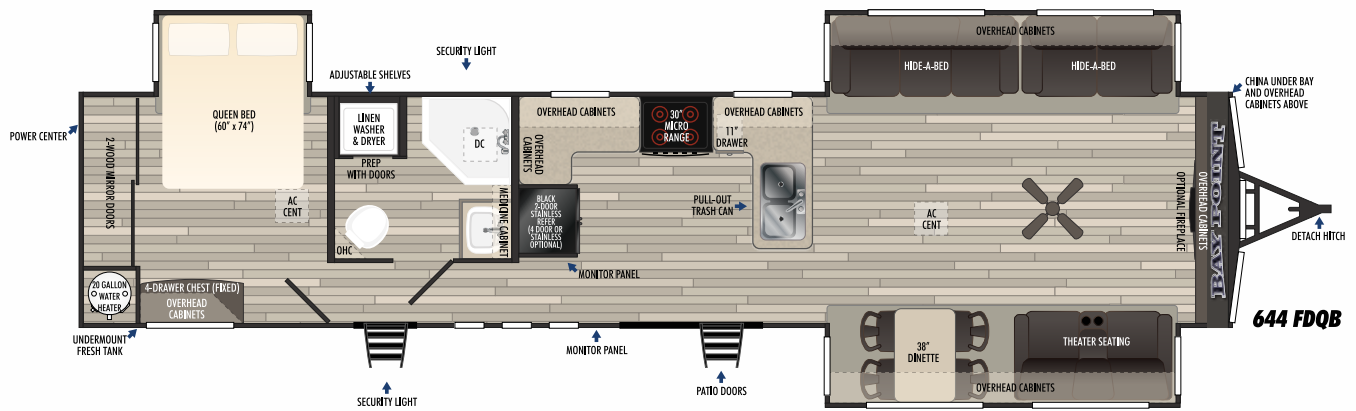

644 FDQB

| Model | GVWR | Dry Wgt | Hitch Wgt | Ext Length | Ext Height | Axles | Fresh | Gray | Black | Water Htr | Awning | AC(s) | Furnace |
|----------|--------|---------|-----------|------------|------------|-------|-------|------|-------|-----------|--------|-------|---------|
| 644 FDQB | 14,000 | 12,646 | 1,990 | 44' | 13'4" | 2 | 49 | 98 | 49 | 20 | 19' | 15K | 40K BTU |

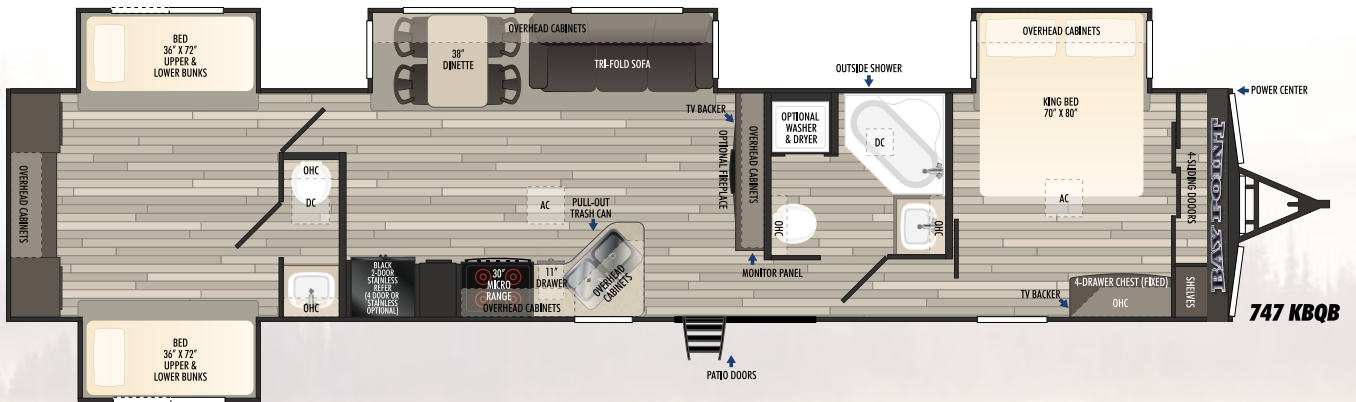

747 KBQB

| Model | GVWR | Dry Wgt | Hitch Wgt | Ext Length | Ext Height | Axles | Fresh | Gray | Black | Water Htr | Awning | AC(s) | Furnace |
|----------|--------|---------|-----------|------------|------------|-------|-------|------|-------|-----------|--------|-------|---------|
| 747 KBQB | 18,000 | 14,196 | 1,530 | 47' | 13'4" | 3 | 49 | 98 | 98 | 20 | 21' | 15K | 40K BTU |

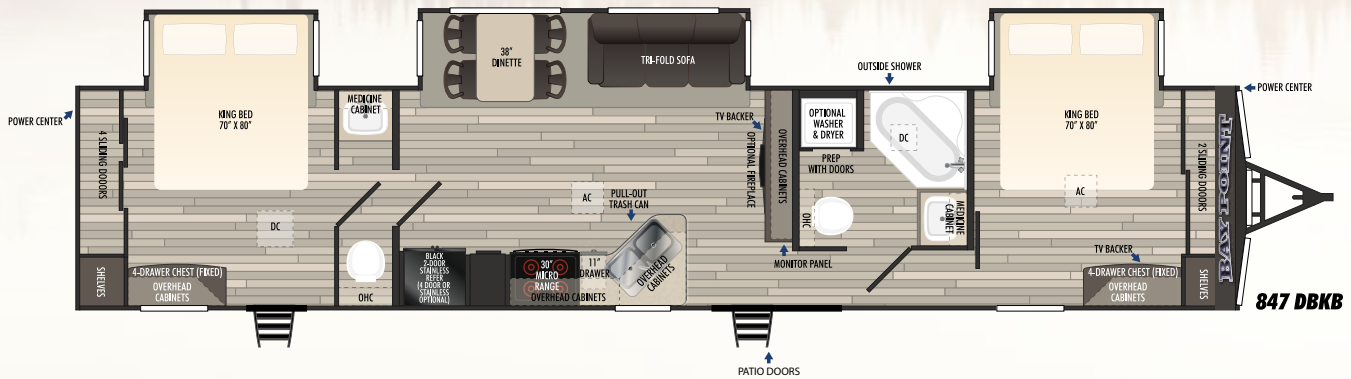

847 DBKB

| Model | GVWR | Dry Wgt | Hitch Wgt | Ext Length | Ext Height | Axles | Fresh | Gray | Black | Water Htr | Awning | AC(s) | Furnace |
|----------|--------|---------|-----------|------------|------------|-------|-------|------|-------|-----------|--------|-------|---------|
| 847 DBKB | 18,000 | 13,896 | 1,530 | 47' | 13'4" | 3 | 49 | 98 | 98 | 20 | 21' | 15K | 40K BTU |



Large Mirrored Closet in Master Bedroom.



Bay Point 644FDQB U-Shape Kitchen.



Residential 30" 5-Burner Stove.



CUSTOMER DRIVEN EXPERIENCE



Bay Point 644FDQB Stainless Steel Appliance Option.



Bay Point 644FDQB Front Entertainment Center.



Bay Point 644FDQB Theater Seat & Table & 4 Chairs.



Bay Point 243IKKB 3 Mirrored Medicine Cabinet.



Bay Point 243IKKB 70x80 King Bed.



Bay Point 243IKKB Island Kitchen.

On Point Exterior Package

102" Exterior, 8' Ceiling Height, 7' Slide Height, 12" I-Beam Super Frame, 7,000# Axles, Detachable Hitch, 2"x4" Transverse Floor Joists, 5/8" Tongue & Groove Plywood Flooring, 2"x2" Side Walls 16"OC, R-7 Fiber-glass Insulation, R-38 Foil Wrap Roof & Floor, Aluminum Mesa Siding .030, 5' Thermal-Pane Patio Door, Quad Steps Front & Rear, Entrance, 8800 Series Max Air Flow Tinted Windows, 3/8" Roof Decking W/ Rubber Roof, Power Awning W/LED Light Strip, Integrated Exterior Marine Grade Speakers, Exterior Security Lights, 2 - 30 lb LP Tanks W/Auto Regulator & Cover, 2nd AC Prepped, 50 AMP Electrical Service W/36' Marincos Detachable Power Cord

Bay Point Luxury Interior Package

Whirlpool 16 CU.FT. Frost Free Refrigerator, Whirlpool 30" Free Standing 4 Burner Gas Range, Whirlpool 30" Microwave W/Light & Fan, Large Stainless-Steel Double Bowl Sink W/Pull Out Sprayer, Residential Raised Panel Toasted Pecan Cabinetry, 12v LED Lights, Wood Dinette Table W/4 Chairs, Deluxe Crown Molding, Shaw Residential Polyester Carpet, Vinyl Comfort Back Flooring, 6 Panel Raised Interior Passage Doors, Night Shades Throughout, Deluxe Window Valances W/Lambrequins, Vertical Blind Patio Door, DVD Sound Bar W/Speakers, Power Ceiling Fan W/Switch, Residential 20 Gallon Electric Water Heater, 40,000 BTU Ducted Furnace, 15K BTU AC, 60x74 Queen Bed W/Innerspring Mattress, Deluxe Queen Headboard, Mirrored Sliding Wardrobe Doors W/Lower Drawers, Residential Porcelain Toilet, Deluxe Medicine Cabinet W/Mirror, Fiberglass Garden Tub or Neo Angle Shower W/Glass Door, Bathroom Towel Holder, Soap Dish, Toilet Paper Holder, USB Outlets Master Bedroom, Entertainment Center, Bunks

Interior Options

- ☐ Fantastic Fan
- ☐ 10 Gallon Gas/Electric Water Heater
- ☐ Stainless Steel Appliance Package
- ☐ Bedroom Ceiling Fan
- ☐ Trundle Bed (747KBQB Only)
- ☐ 30" 4-Color Fireplace
- ☐ Full Size Washer & Dryer

Exterior Options

- ☐ 2 Pair Manual Corner Stabilizer Jacks
- ☐ Thermo Pane Windows
- ☐ Outside Shower
- ☐ 2nd 15,000 BTU AC w/Heat Strip

Your Local Dealer:

