

STANDARD GRAPHICS

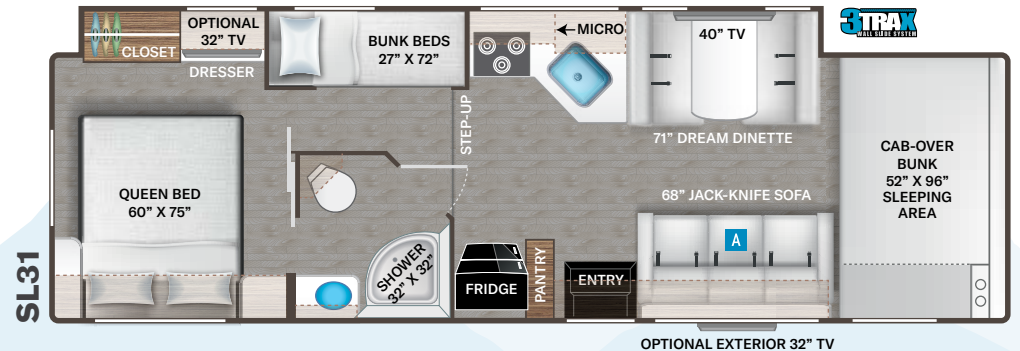
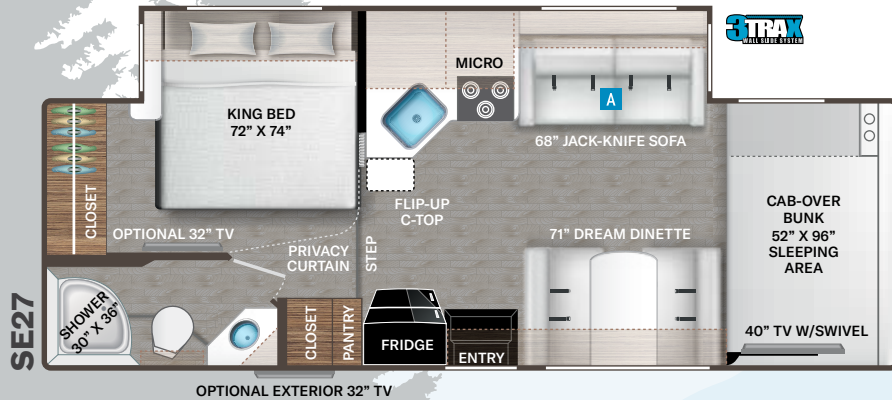
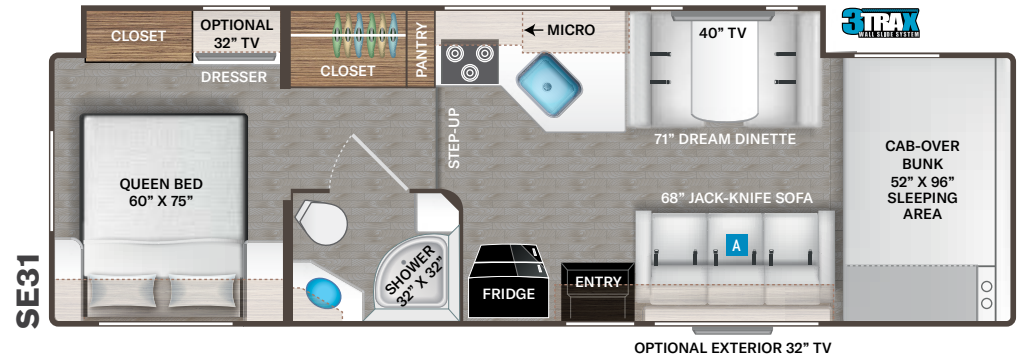
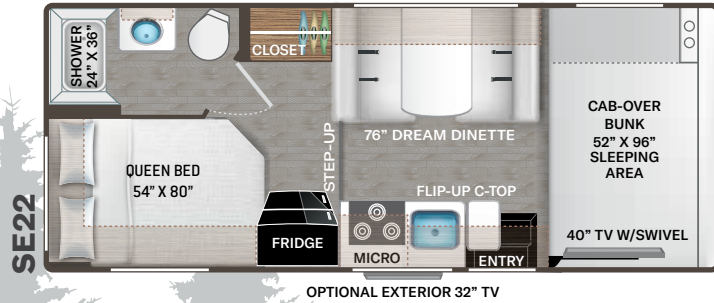
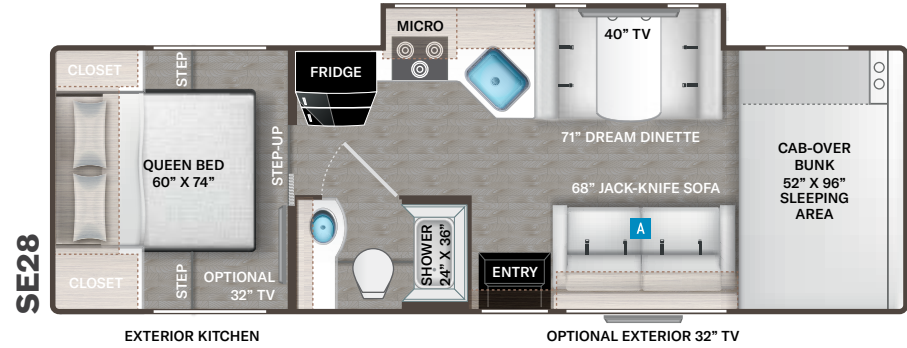

# QUANTUM<sup>™</sup> SE

Option Available on  
Select Floor Plans:

OPTIONAL THEATER SEATING

# Featured Highlights

## CONSTRUCTION & EXTERIOR

- Ford® E-Series Chassis - 7.3L V8, 325HP & 450 lb-ft Torque - w/TPM's
- SmoothTECH™ by Mor-Ryde (SL31 & SE31)
- One-Piece Fiberglass Front Cap
- Slick Fiberglass Exterior with Graphics Package
- MEGA-Storage™ Compartment
- Portable Table in MEGA-Storage™ Compartment (SE28)
- Welded Tubular Aluminum Roof & Sidewall Cage Construction
- Lighted Rotocast Storage Compartments with Single ON/OFF Interior Switch
- Flush Mount Radius Compartment Doors
- Premium One-Piece Crossflex™ Roofing
- Power Patio Awning with Integrated LED Lighting
- Black Framed Windows
- Drop Down Stairwell Entrance Step with Accent Light Under Step on Separate Switch

## CONSTRUCTION & EXTERIOR OPTIONS

- Chevy® Chassis - 6.6L V8, 401HP & 464 lb-ft Torque (SE22)
- Electric Stabilizing System (STD - SE27, SE31 & SL31)
- Exterior Pull-out Kitchen with Griddle and 12-volt Cooler (SE28)

## AUTOMOTIVE & COCKPIT

- 7" Touchscreen Dash Radio, Apple CarPlay™, Android Audio® with Back-Up Monitor
- SiriusXM® Tuner & Antenna
- Steering Wheel Audio & Camera Controls on Ford® E-Series Chassis Only
- Deluxe Exterior Mirrors
- Emergency Engine Start Switch
- Aluminum Running Boards
- Valve Stem Extenders (SE31 & SL31)

- Stainless Steel Wheel Liners
- LED Taillights

## AUTOMOTIVE & COCKPIT OPTIONS

- Heated/Remote Exterior Mirrors with Integrated Side View Cameras
- Leatherette Captain's Chairs
- Power Driver's Seat - Ford® E-Series Chassis Only (SE27, SE28, SE31 & SL31)
- Dash Appliqué
- Cockpit Carpet Mat
- Keyless Entry System with Valve Stem Extenders

## INTERIOR

- 84" Interior Ceiling Height
- Residential Vinyl Flooring
- Hard Vinyl Ceiling
- Ceiling Ducted Air Conditioning System (SE27, SE28, SE31 & SL31)
- Weathered Cherry Flat Panel Cabinet Doors with Nickel Finish Hardware
- Decorative Glass Inserts in Kitchen Overhead Cabinet Doors (N/A with Ivory Coast)
- Pressed Laminate Countertops
- LED Lighting
- Wall Cubby with Net & USB Charging Port
- Cab-Over Sleeping Area with Cup Holders and Telescoping Bunk Ladder
- Leatherette Jack-Knife Sofa (SE27, SE28, SE31 & SL31)
- Leatherette Dream Dinette® Booth
- Wireless Phone Charger with USB Plug on Dinette Table Top
- Single Child Safety Tether in Dinette
- Window Privacy Shades

## INTERIOR OPTIONS

- Ivory Coast Cabinets with Black Hardware and Faucets

- Leatherette Theater Seating IPO Sofa (SE27, SE28, SE31 & SL31)
- Cab-Over Child Safety Net
- 12-volt Attic Fan with Cover in Cab-Over Bunk

## KITCHEN

- Double Door Refrigerator (SE22, SE27 & SE28)
- 12-volt Refrigerator with Auto Generator Start (SE31 & SL31)
- Recessed 3-Burner Gas Cooktop with Glass Cover (SE22, SE27 & SE28)
- Recessed 3-Burner Gas Cooktop/Oven with Glass Cover (SE31 & SL31)
- Microwave Oven
- Range Hood with Task Lighting Above Cooktop
- Pop-Up Countertop Outlet & Charging Center for Electronics (SE27, SE28, SE31 & SL31)
- Flip-Up Countertop Extension (SE22 & SE27)
- Large Single Bowl Stainless Steel Sink with Single Handle Faucet & Pull Down Sprayer
- Kitchen Countertop LED Accent Lighting
- Decorative Kitchen Tile Backsplash (SE27)
- Waste Basket
- 12-volt Ceiling Vent with Under Cabinet Switch

## KITCHEN OPTIONS

- Recessed 3-Burner Gas Cooktop/Oven with Glass Cover (SE22, SE27 & SE28)
- Convection Microwave Oven (SE22, SE27 & SE28)

## BEDROOM & BATHROOM

- Queen Size Bed (SE22, SE28, SE31 & SL31)
- King Size Bed (SE27)
- Bunk Beds with Telescoping Ladder (SL31)
- Bedspread & Pillow Shams
- Headboard (SE28)
- Bedroom USB Charging Center for Electronics
- Bedroom 12-volt Outlet for CPAP Machine

- Power Bath Vent with Wall Switch in Bathroom
- Foot Flush Porcelain Toilet
- Stainless Steel Bathroom Sink
- Robe/Towel Hooks in Bathroom
- Shower Curtain (SE22)
- Shower with Curved Anti-Microbial Shower Curtain (SE28)
- Shower with Glass Door (SE27, SE31 & SL31)
- Showermi\$er Hot Water Recycling System

## BEDROOM & BATHROOM OPTIONS

- 12-volt Attic Fan with Cover in Bedroom (N/A with Dual A/C Option)

## ENTERTAINMENT

- 40" TV on Manual Swivel in Cab-Over (SE22 & SE27R)
- 40" TV in Living Area (SE28, SE31 & SL31)
- Bedroom TV Prep (SE27R, SE28, SE31 & SL31)
- Tablet Holders and USB Charge Ports in Bunk Beds (SL31)
- HDMI Video Distribution Box (SE27R, SE28, SE31 & SL31)
- Cable TV Ready
- HD/DSS Satellite Ready
- Satellite Mounting Backer in Roof
- Winegard® Connect™ 2.0 WiFi / 4G / TV Antenna

## ENTERTAINMENT OPTIONS

- 32" TV in Bedroom (SE27R, SE28, SE31 & SL31)
- 32" Exterior TV on Swivel Bracket with Bluetooth® Built-in Sound Bar and Radio

## ELECTRICAL & PLUMBING

- 4.0 kw Gas Generator
- Automatic Transfer Switch with Power Protection

- Automatic Shoreline-to-Generator Transfer Switch
- 30-amp Shoreline Power Cord
- Battery Disconnect Switch
- Battery Tray for Four (4) Batteries
- Solar Prep - Includes Solar Controller
- 6-gallon DSI Gas/Electric Water Heater
- Water Heater Bypass System
- Systems Control Center
- Single Roof Air Conditioner (SE22, SE27 & SE28)
- Single, High Output, Roof Air Conditioner (SE31 & SL31)
- Exterior LP Connection (SE27, SE28, SE31 & SL31)
- Exterior Water Spray Port (SE28)
- 360° Siphon RV Holding Tank Vent Cap
- 1" Fresh Water Tank Drain
- Black Tank Flush System

## ELECTRICAL & PLUMBING OPTIONS

- Single, High Output, Roof Air Conditioner IPO Standard Roof Air Conditioner (SE22, SE27, & SE28)
- Dual Roof Air Conditioners IPO Standard Roof Air Conditioner (SE31 & SL31)
- 100-watt Solar Charging System with Solar Controller
- Outside Shower (STD SE31 & SL31 - N/A SE28)
- Holding Tanks with Heat Pads (STD SE31 & SL31)
- Second Auxiliary House Battery (STD SE31 & SL31)

	SE22	SE27	SE28	SE31	SL31
Chassis	Ford / Chevy	Ford	Ford	Ford	Ford
Gross Vehicle (GVWR)	12,500 / 12,300	14,500	14,500	14,500	14,500
Gross Combined (GCWR)	18,500 / 16,000	22,000	22,000	22,000	22,000
Wheel Base	158" / 159"	209"	212"	223"	223"
Exterior Length (w/o ladder)	24'-1" / 24'-7"	29'-1"	30'	32'-4"	32'-8"
Exterior Height (w/AC)	11'	11'-2"	11'	11'-2"	11'-2"
Exterior Width (w/o mirrors)	99"	99"	99"	99"	99"
Interior Height (living area)	84"	84"	84"	84"	84"
Awning Size	15'	20'	14'	16'	16'
Fuel (gal)	55 / 57	55	55	55	55
LPG (lbs)	40.9	40.9	40.9	40.9	40.9
Fresh/Waste/Gray Water (gal)	40 / 24.5 / 37	40 / 34.5 / 37	40 / 26 / 32	40 / 28 / 28	40 / 28 / 28
Water Heater (gal)	6	6	6	6	6
Furnace (BTUs)	19,000	30,000	30,000	30,000	30,000
Exterior Storage Capacity (cu. ft.)	50.3	55.5	99.9	55.7	55.7
Hitch Weight Rating (lbs)	8,000	8,000	8,000	8,000	8,000

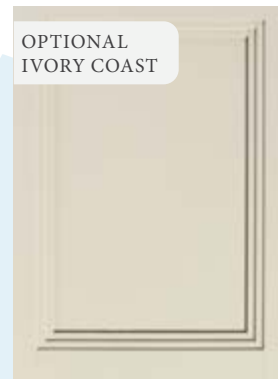

OPTIONAL IVORY COAST

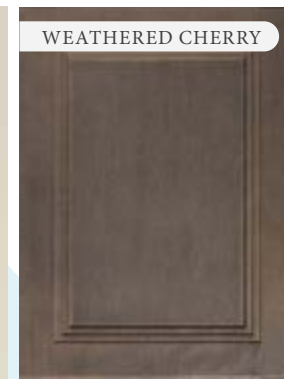

WEATHERED CHERRY



FLOORING



IMPORTANT—PLEASE READ: This brochure reflects product design, fabrication, material, components and specifications at the date of printing, which date is disclosed below. Please visit us online at ThorMotorCoach.com or consult with your selling dealership for the latest in standards, options, specification and technical information. Photographs in the brochure may depict optional equipment or may only be available in certain floor plans. Components, appliances and the chassis may have been manufactured in a calendar year before the vehicle's designated model year. All capacities are approximate. The actual length of the vehicle may differ from that indicated in the brochure due to variances in the manufacturing processes and/or installed components. All dry weights are based on standard model features and do not include optional features or equipment. Component part and appliance manufacturers issue limited warranties covering portions of the vehicle not covered under the limited warranty we issue. Copyright Thor Motor Coach, Inc. © MY 04/01/2022

Made to fit.

P.O. Box 1486, Elkhart, IN 46515 Sales Department: 800.860.5658

