

FIND YOUR  
TRUE NORTH



  
**NORTH TRAIL**  
EAST COAST

 BROUGHT TO YOU BY  
**HEARTLAND**

# TOP 5 EXTERIOR FEATURES

- 1 | Prepped for anything - Prepped for tire pressure monitoring system, back up camera, solar and slide out topper
- 2 | Super King Kong sized pass-through storage
- 3 | 4" Thick vacuum bond laminated roof
- 4 | 2" Thick Azdel fortified sidewall construction
- 5 | Secure ride equipped - featuring top of line axles, galvanized metal wheel wells, Wide Trax suspension, heated and enclosed underbelly



**NT 21RBSS**

LENGTH - 22' 1/2" | HEIGHT - 11' 4" | HITCH - 538 LBS.  
 DRY - 4,534 LBS. | GVWR - 6,900 LBS. | SLEEP CAPACITY - 3-4

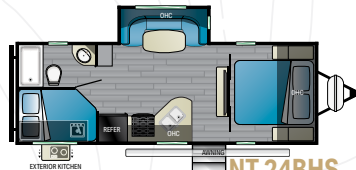

**NT 24BHS**

LENGTH - 27' 11" | HEIGHT - 11' 4" | HITCH - 550 LBS.  
 DRY - 5,400 LBS. | GVWR - 6,900 LBS. | SLEEP CAPACITY - 7-8

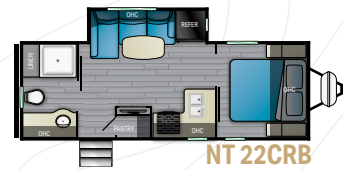

**NT 22CRB**

LENGTH - 28' 1/2" | HEIGHT - 11' 4" | HITCH - 500 LBS.  
 DRY - 5,366 LBS. | GVWR - 6,900 LBS. | SLEEP CAPACITY - 3-4

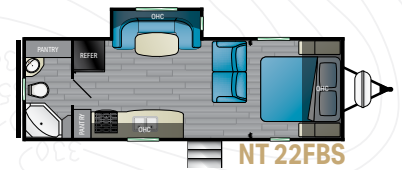

**NT 22FBS**

LENGTH - 29' 5" | HEIGHT - 11' 4" | HITCH - 395 LBS.  
 DRY - 5,497 LBS. | GVWR - 6,900 LBS. | SLEEP CAPACITY - 5-6

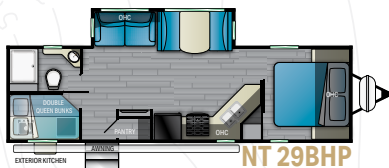

**NT 29BHP**

LENGTH - 33' 3-1/2" | HEIGHT - 11' 4" | HITCH - 468 LBS.  
 DRY - 6,818 LBS. | GVWR - 8,600 LBS. | SLEEP CAPACITY - 9+

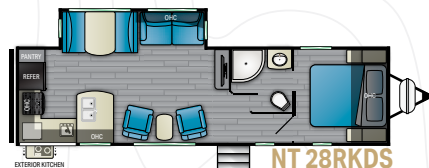

**NT 28RKDS**

LENGTH - 34' 8" | HEIGHT - 11' 4" | HITCH - 542 LBS.  
 DRY - 6,780 LBS. | GVWR - 8,600 LBS. | SLEEP CAPACITY - 5-6



**NT 31QUBH**

LENGTH - 35' 3-1/2" | HEIGHT - 11' 4" | HITCH - 798 LBS.  
 DRY - 7,036 LBS. | GVWR - 8,600 LBS. | SLEEP CAPACITY - 9+

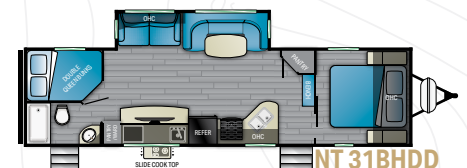

**NT 31BHDD**

LENGTH - 36' 0" | HEIGHT - 11' 4" | HITCH - 672 LBS.  
 DRY - 7,012 LBS. | GVWR - 8,600 LBS. | SLEEP CAPACITY - 9+

# TOP 5 INTERIOR FEATURES

- 1 | Blackout roller shades in main slideout and bedroom (where applicable)
- 2 | Butcher block style kitchen countertops
- 3 | Stainless steel appliances
- 4 | Value hide - E - center with hidden valuable storage area (most models)
- 5 | Comfort select 72" x 80" gel infused residential king bed mattress

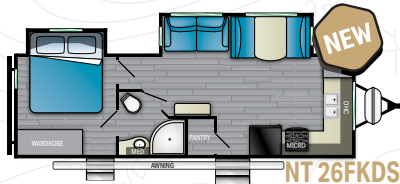

LENGTH - 29' 8 1/4" | HEIGHT - 11' 4" | HITCH - 972 LBS.  
 DRY - 6,672 LBS. | GVWR - 9,772 LBS. | SLEEP CAPACITY - 5-6

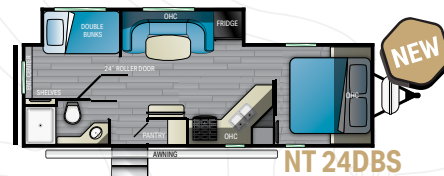

LENGTH - 30' 10-1/2" | HEIGHT - 11' 4" | HITCH - 806 LBS.  
 DRY - 6,316 LBS. | GVWR - 8,600 LBS. | SLEEP CAPACITY - 7-8

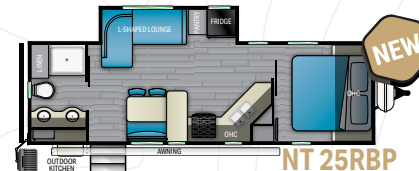

LENGTH - 30' 10-1/2" | HEIGHT - 11' 4" | HITCH - 700 LBS.  
 DRY - 6,278 LBS. | GVWR - 8,600 LBS. | SLEEP CAPACITY - 3-4

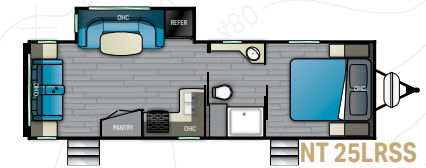

LENGTH - 31' 11" | HEIGHT - 11' 4" | HITCH - 688 LBS.  
 DRY - 6,026 LBS. | GVWR - 7,400 LBS. | SLEEP CAPACITY - 3-4

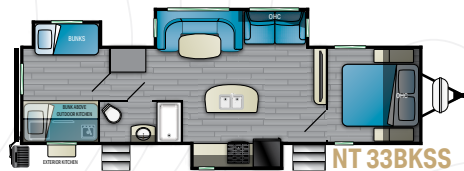

LENGTH - 36' 9-1/2" | HEIGHT - 11' 6" | HITCH - 774 LBS.  
 DRY - 7,908 LBS. | GVWR - 9,600 LBS. | SLEEP CAPACITY - 9+

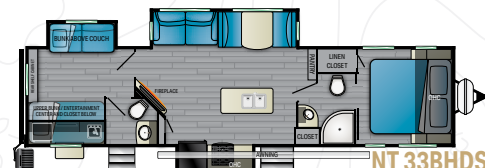

LENGTH - 37' 7-1/2" | HEIGHT - 11' 6" | HITCH - 992 LBS.  
 DRY - 8,015 LBS. | GVWR - 9,600 LBS. | SLEEP CAPACITY - 9+

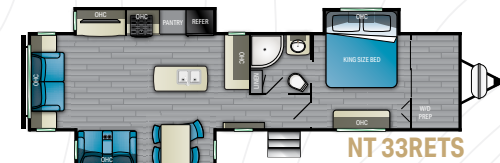

LENGTH - 39' 8" | HEIGHT - 11' 8" | HITCH - 780 LBS.  
 DRY - 8,840 LBS. | GVWR - 9,900 LBS. | SLEEP CAPACITY - 4

## NORTH TRAIL UPGRADED KITCHEN (STANDARD):

- Upgraded door and cabinet hardware
- Oven range combo with glass top
- Upgraded Decorative Glass
- Removable Inside / Outside Dinette Table (Select Models)
- 12V Stainless Steel 10.7 CuFt Refer
- Stainless Steel Appliance Package (N/A gas electric refer)
- Large Viewing Window in Kitchen (Select Models)
- Stainless Steel ball bearing drawer guides
- Deep Pantry with Shelves (Most Models)
- Hidden Hinges

## ULTIMATE ENTERTAINMENT PACKAGE (SELECT MODELS):

- 50" HD TV
- 26" Fireplace

## POWER PACKAGE (FORCED ON ALL UNITS):

- Power Stab Jacks
- LED Lighting with Quick Charge USB Ports
- Power Tongue Jacks

## INTERIOR UPGRADES:

- 8 CuFt Gas / Electric Refer IPO 12V 10.7 CuFt Stainless

## EXTERIOR UPGRADES:

- Front Cap with LED Lights (Forced)

## HEATING AND COOLING UPGRADES:

- 15K A/C ipo 13.5K A/C
- 50 AMP Service w/second A/C Prep (24DBS, 25RBP, 28RKDS, 29BHP, 31BHHDD, 31QUBH, 33BHDS, 33BKSS ONLY) (Forced in 33RETS)

## NORTH TRAIL LIGHTWEIGHT PACKAGE:

- Laminated Crowned Roof
- Block Foam Brick Insulation
- 2" Laminated Sidewalls
- Enclosed & Heated Underbelly
- Tinted Safety Glass Windows
- Aluminum Rims
- Electric Awning W/ LED Lights
- Spare Tire
- Wide Trax Suspension System
- King Bed Standard
- Night shades and roller shades
- Dual 20# LP Tanks with Auto Change Over
- Dual Ducted 13.5 BTU A/C
- Wifi Prep
- Outside Shower
- Power Vent in Bathroom
- Skylight in Bathroom
- Slam Latch Storage Doors
- Black Tank Flush
- 6.0 Gallon DSI Gas / Electric Water Heater
- Under bed storage with quick store bed base
- FM Stereo with HDMI pass through
- Cable Ready
- 55 AMP 12 Volt Power Converter
- Diamond Plate Front
- Solid Entry Steps
- Solar Prep
- Back Up Camera Prep
- Tire Pressure Monitoring Sensor prepped

## SPECIAL FEATURES



USB port accessibility



Smooth Ride

## INTERIOR FABRIC DECOR OPTIONS



Urban Cottage

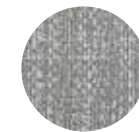

Crystal Bay

## VISIT US ONLINE



Your authorized Heartland dealer:



For more information and to take a virtual walk-through, visit [www.heartlandrvs.com](http://www.heartlandrvs.com)

