

FIND YOUR
TRUE NORTH



NORTH TRAIL
EAST + WEST COAST

 BROUGHT TO YOU BY
HEARTLAND

FIND YOUR
TRUE NORTH

NORTH TRAIL
EAST COAST

 BROUGHT TO YOU BY
HEARTLAND

TOP 5 EXTERIOR FEATURES

- 1 Prepped for anything - Prepped for tire pressure monitoring system, back up camera, solar and slide out topper
- 2 Super King Kong sized pass-through storage
- 3 4" Thick vacuum bond laminated roof
- 4 2" Thick Azdel fortified sidewall construction
- 5 Secure ride equipped - featuring top of line axles, galvanized metal wheel wells, Wide Trax suspension, heated and enclosed underbelly

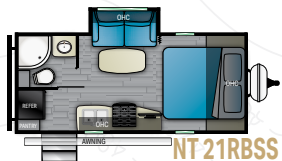

NT 21RBSS

LENGTH - 22' 1/2" | HEIGHT - 11' 4" | HITCH - 538 LBS.
 DRY - 4,534 LBS. | GVWR - 6,900 LBS. | SLEEP CAPACITY - 3-4

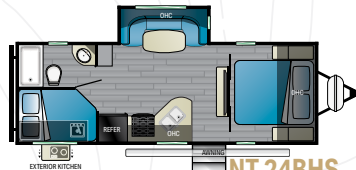

NT 24BHS

LENGTH - 27' 11" | HEIGHT - 11' 4" | HITCH - 550 LBS.
 DRY - 5,400 LBS. | GVWR - 6,900 LBS. | SLEEP CAPACITY - 7-8

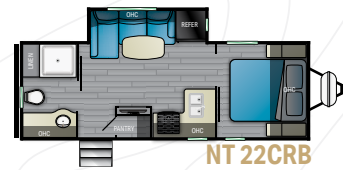

NT 22CRB

LENGTH - 28' 1/2" | HEIGHT - 11' 4" | HITCH - 500 LBS.
 DRY - 5,366 LBS. | GVWR - 6,900 LBS. | SLEEP CAPACITY - 3-4

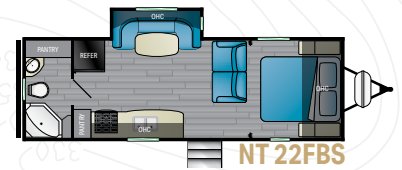

NT 22FBS

LENGTH - 29' 5" | HEIGHT - 11' 4" | HITCH - 395 LBS.
 DRY - 5,497 LBS. | GVWR - 6,900 LBS. | SLEEP CAPACITY - 5-6

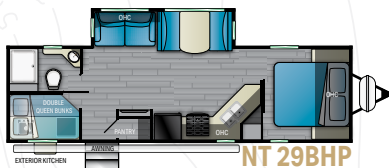

NT 29BHP

LENGTH - 33' 3-1/2" | HEIGHT - 11' 4" | HITCH - 468 LBS.
 DRY - 6,818 LBS. | GVWR - 8,600 LBS. | SLEEP CAPACITY - 9+

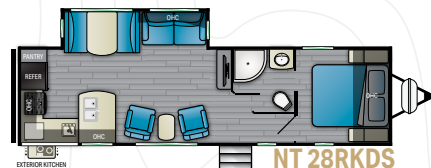

NT 28RKDS

LENGTH - 34' 8" | HEIGHT - 11' 4" | HITCH - 542 LBS.
 DRY - 6,780 LBS. | GVWR - 8,600 LBS. | SLEEP CAPACITY - 5-6

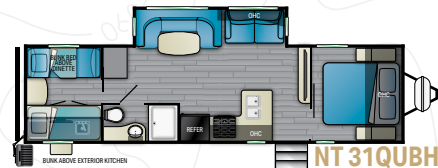

NT 31QUBH

LENGTH - 35' 3-1/2" | HEIGHT - 11' 4" | HITCH - 798 LBS.
 DRY - 7,036 LBS. | GVWR - 8,600 LBS. | SLEEP CAPACITY - 9+

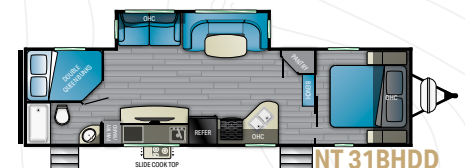

NT 31BHDD

LENGTH - 36' 0" | HEIGHT - 11' 4" | HITCH - 672 LBS.
 DRY - 7,012 LBS. | GVWR - 8,600 LBS. | SLEEP CAPACITY - 9+

TOP 5 INTERIOR FEATURES

- 1 | Blackout roller shades in main slideout and bedroom (where applicable)
- 2 | Butcher block style kitchen countertops
- 3 | Stainless steel appliances
- 4 | Value hide - E - center with hidden valuable storage area (most models)
- 5 | Comfort select 72" x 80" gel infused residential king bed mattress

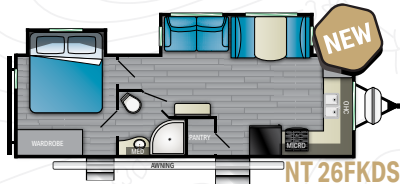

LENGTH - 29' 8 1/4" | HEIGHT - 11' 4" | HITCH - 972 LBS.
 DRY - 6,672 LBS. | GVWR - 9,772 LBS. | SLEEP CAPACITY - 5-6

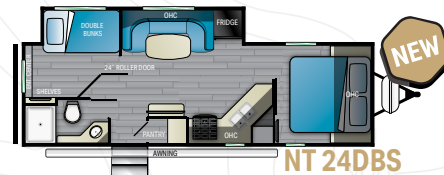

LENGTH - 30' 10-1/2" | HEIGHT - 11' 4" | HITCH - 806 LBS.
 DRY - 6,316 LBS. | GVWR - 8,600 LBS. | SLEEP CAPACITY - 7-8

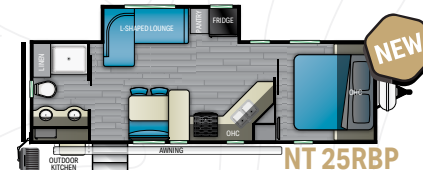

LENGTH - 30' 10-1/2" | HEIGHT - 11' 4" | HITCH - 700 LBS.
 DRY - 6,278 LBS. | GVWR - 8,600 LBS. | SLEEP CAPACITY - 3-4



LENGTH - 31' 11" | HEIGHT - 11' 4" | HITCH - 688 LBS.
 DRY - 6,026 LBS. | GVWR - 7,400 LBS. | SLEEP CAPACITY - 3-4

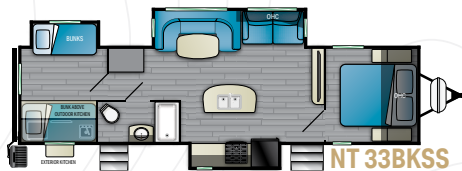

LENGTH - 36' 9-1/2" | HEIGHT - 11' 6" | HITCH - 774 LBS.
 DRY - 7,908 LBS. | GVWR - 9,600 LBS. | SLEEP CAPACITY - 9+

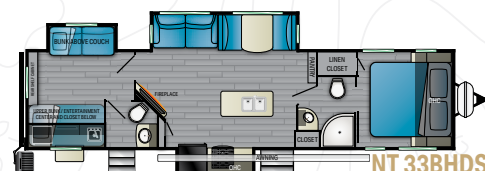

LENGTH - 37' 7-1/2" | HEIGHT - 11' 6" | HITCH - 992 LBS.
 DRY - 8,015 LBS. | GVWR - 9,600 LBS. | SLEEP CAPACITY - 9+

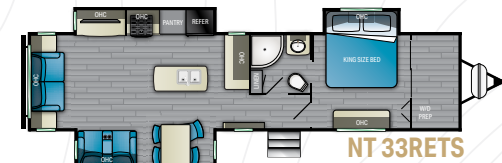

LENGTH - 39' 8" | HEIGHT - 11' 8" | HITCH - 780 LBS.
 DRY - 8,840 LBS. | GVWR - 9,900 LBS. | SLEEP CAPACITY - 4

NORTH TRAIL UPGRADED KITCHEN (STANDARD):

- Upgraded door and cabinet hardware
- Oven range combo with glass top
- Upgraded Decorative Glass
- Removable Inside / Outside Dinette Table (Select Models)
- 12V Stainless Steel 10.7 CuFt Refer
- Stainless Steel Appliance Package (N/A gas electric refer)
- Large Viewing Window in Kitchen (Select Models)
- Stainless Steel ball bearing drawer guides
- Deep Pantry with Shelves (Most Models)
- Hidden Hinges

ULTIMATE ENTERTAINMENT PACKAGE (SELECT MODELS):

- 50" HD TV
- 26" Fireplace

POWER PACKAGE (FORCED ON ALL UNITS):

- Power Stab Jacks
- LED Lighting with Quick Charge USB Ports
- Power Tongue Jacks

INTERIOR UPGRADES:

- 8 CuFt Gas / Electric Refer IPO 12V 10.7 CuFt Stainless

EXTERIOR UPGRADES:

- Front Cap with LED Lights (Forced)

HEATING AND COOLING UPGRADES:

- 15K A/C ipo 13.5K A/C
- 50 AMP Service w/second A/C Prep (24DBS, 25RBP, 28RKDS, 29BHP, 31BHHDD, 31QUBH, 33BHDS, 33BKSS ONLY) (Forced in 33RETS)

NORTH TRAIL LIGHTWEIGHT PACKAGE:

- Laminated Crowned Roof
- Block Foam Brick Insulation
- 2" Laminated Sidewalls
- Enclosed & Heated Underbelly
- Tinted Safety Glass Windows
- Aluminum Rims
- Electric Awning W/ LED Lights
- Spare Tire
- Wide Trax Suspension System
- King Bed Standard
- Night shades and roller shades
- Dual 20# LP Tanks with Auto Change Over
- Dual Ducted 13.5 BTU A/C
- Wifi Prep
- Outside Shower
- Power Vent in Bathroom
- Skylight in Bathroom
- Slam Latch Storage Doors
- Black Tank Flush
- 6.0 Gallon DSI Gas / Electric Water Heater
- Under bed storage with quick store bed base
- FM Stereo with HDMI pass through
- Cable Ready
- 55 AMP 12 Volt Power Converter
- Diamond Plate Front
- Solid Entry Steps
- Solar Prep
- Back Up Camera Prep
- Tire Pressure Monitoring Sensor prepped

SPECIAL FEATURES



USB port accessibility



Smooth Ride

INTERIOR FABRIC DECOR OPTIONS



Urban Cottage

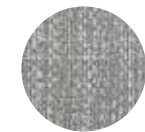

Crystal Bay

VISIT US ONLINE



Your authorized Heartland dealer:



For more information and to take a virtual walk-through, visit www.heartlandrvs.com



Product information is as accurate as possible as of the date of publication of this brochure. Due to Heartland's commitment to continuous product improvement, floorplans, materials, components, features, measurements, specifications, options, etc. are subject to change at any time without notice or obligation. In certain conditions some additional equipment may be needed. Photos may show optional equipment or props used for photography purposes only. Heartland has listed the approximate base weight of the trailer without the optional equipment included. Optional equipment will impact the weight of the trailer. Please locate the weight sticker attached to the trailer you are considering for the most accurate trailer weight. Tow Vehicle Caution: Owners of Heartland recreational vehicles are solely responsible for the selection and proper use of tow vehicles. All customers should consult with the motor vehicle manufacturer or their dealer concerning the purchase and use of suitable tow vehicles for Heartland products. Heartland disclaims any liability or damages suffered as a result of the selection, operation, use or misuse of a tow vehicle. Heartland's limited warranty does not cover damage to the recreational vehicle or the tow vehicle as a result of the selection of the tow vehicle. Overall length for a Fifth Wheels is defined as the body length of the trailer excluding hitch meaning bumper to cap. The overall length for a Travel Trailer is defined as the body length of the trailer including hitch, meaning bumper to hitch/pin. It does not include rear ladder of spare tire. Optional pin boxes will affect overall length. SPRING 12/22 (REV 1)

FIND YOUR
TRUE NORTH



 **NORTH TRAIL**
WEST COAST

 BROUGHT TO YOU BY
HEARTLAND

TOP 5

EXTERIOR FEATURES

- 1 | Prepped for anything - Prepped for tire pressure monitoring system, back up camera, and slide out topper
- 2 | Super King Kong sized pass-through storage
- 3 | Solar and Polar package - 20 watt Solar panel with onboard charge controller
- 4 | 2" Thick Azdel fortified aluminum sidewall construction
- 5 | Secure ride equipped - Top of the line axles, galvanized metal wheel wells, Wide Trax suspension, Heated and enclosed underbelly

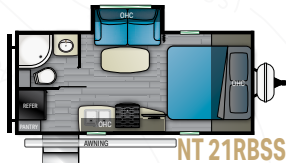

NT 21RBSS

LENGTH - 22' 1/2" | HEIGHT - 11' 4" | HITCH - 538 LBS.
 DRY - 4,534 LBS. | GVWR - 6,900 LBS. | SLEEP CAPACITY - 3-4

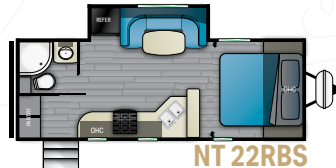

NT 22RBS

LENGTH - 26' 5-1/2" | HEIGHT - 11' 4" | HITCH - 700 LBS.
 DRY - 5,260 LBS. | GVWR - 7,500 LBS. | SLEEP CAPACITY - 3-4

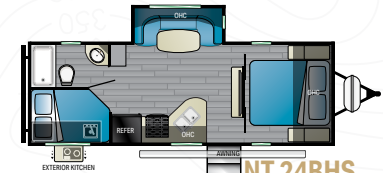

NT 24BHS

LENGTH - 27' 11" | HEIGHT - 11' 4" | HITCH - 550 LBS.
 DRY - 5,400 LBS. | GVWR - 6,900 LBS. | SLEEP CAPACITY - 7-8

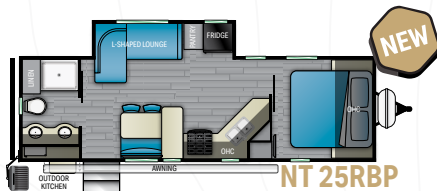

NT 25RBP

LENGTH - 30' 10-1/2" | HEIGHT - 11' 4" | HITCH - 700 LBS.
 DRY - 6,278 LBS. | GVWR - 8,600 LBS. | SLEEP CAPACITY - 3-4

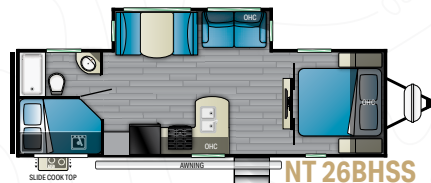

NT 26BHSS

LENGTH - 31' 11-1/2" | HEIGHT - 11' 4" | HITCH - 720 LBS.
 DRY - 6,340 LBS. | GVWR - 9,520 LBS. | SLEEP CAPACITY - 7-8

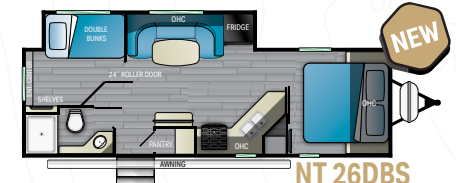

NT 26DBS

LENGTH - 30' 7-1/2" | HEIGHT - 11' 4" | HITCH - 820 LBS.
 DRY - 6,380 LBS. | GVWR - 7,820 LBS. | SLEEP CAPACITY - 7-8

TOP 5 INTERIOR FEATURES

- 1 | Polar Shield Sidewall with tinted windows and nightshades
- 2 | Butcher block style kitchen countertops
- 3 | Stainless steel appliances
- 4 | Value hide - E - center with hidden valuable storage area (most models)
- 5 | Comfort select 72" x 80" gel infused residential king bed mattress

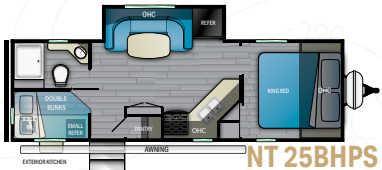

NT 25BHPS

LENGTH - 29' 4-1/2" | **HEIGHT** - 11' 4" | **HITCH** - 800 LBS.
DRY - 6,040 LBS. | **GVWR** - 7,800 LBS. | **SLEEP CAPACITY** - 8

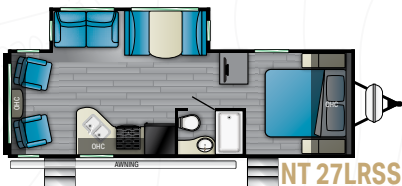

NT 27LRSS

LENGTH - 30' 1" | **HEIGHT** - 11' 4" | **HITCH** - 660 LBS.
DRY - 5,860 LBS. | **GVWR** - 7,660 LBS. | **SLEEP CAPACITY** - 5-6



NORTH TRAIL UPGRADED KITCHEN (STANDARD):

- Upgraded door and cabinet hardware
- Oven range combo with glass top
- Upgraded Decorative Glass
- Removable Inside / Outside Dinette Table (Select Models)
- 12V Stainless Steel 10.7 CuFt Refer
- Stainless Steel Appliance Package (N/A gas electric refer)
- Large Viewing Window in Kitchen (Select Models)
- Stainless Steel ball bearing drawer guides
- Deep Pantry with Shelves (Most Models)
- Hidden Hinges

ULTIMATE ENTERTAINMENT PACKAGE (SELECT MODELS ONLY):

- 50" HD TV
- 26" Fireplace

POWER PACKAGE (FORCED ON ALL UNITS):

- Power Stab Jacks
- LED Lighting with Quick Charge USB Ports
- Power Tongue Jacks

EXTERIOR UPGRADES:

- Front Cap with LED Lights (Forced)

HEATING AND COOLING UPGRADES:

- 15K A/C in place of 13.5K A/C
- 50AMP service 2nd AC prep (select models only)

NORTH TRAIL LIGHTWEIGHT PACKAGE:

- Laminated Crowned Roof
- Block Foam Brick Insulation
- 2" Laminated Sidewalls
- Enclosed & Heated Underbelly
- Tinted Safety Glass Windows
- Aluminum Rims
- Electric Awning W/ LED Lights
- Spare Tire
- Wide Trax Suspension System
- King Bed Standard
- Night Shades
- Dual 20# LP Tanks with Auto Change Over
- Dual Ducted 13.5 BTU A/C
- Wifi Prep
- Outside Shower
- Power Vent in Bathroom
- Skylight in Bathroom
- Slam Latch Storage Doors
- Black Tank Flush
- 6.0 Gallon DSI Gas / Electric Water Heater
- Under bed storage with quick store bed base.
- FM Stereo with HDMI pass through
- Cable Ready
- 55 AMP 12 Volt Power Converter
- Diamond Plate Front
- Solid Entry Steps
- Solar Prep
- Back Up Camera Prep
- Slide Topper Prep
- Tire Pressure Motoring Sensor Prepped

SPECIAL FEATURES



USB port accessibility



Smooth Ride

INTERIOR FABRIC DECOR OPTIONS



Urban Cottage

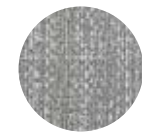

Crystal Bay

VISIT US ONLINE



Your authorized Heartland dealer:



For more information and to take a virtual walk-through, visit www.heartlandrvs.com



Product information is as accurate as possible as of the date of publication of this brochure. Due to Heartland's commitment to continuous product improvement, floorplans, materials, components, features, measurements, specifications, options, etc. are subject to change at any time without notice or obligation. In certain conditions some additional equipment may be needed. Photos may show optional equipment or props used for photography purposes only. Heartland has listed the approximate base weight of the trailer without the optional equipment included. Optional equipment will impact the weight of the trailer. Please locate the weight sticker attached to the trailer you are considering for the most accurate trailer weight. Tow Vehicle Caution: Owners of Heartland recreational vehicles are solely responsible for the selection and proper use of tow vehicles. All customers should consult with the motor vehicle manufacturer or their dealer concerning the purchase and use of suitable tow vehicles for Heartland products. Heartland disclaims any liability or damages suffered as a result of the selection, operation, use or misuse of a tow vehicle. Heartland's limited warranty does not cover damage to the recreational vehicle or the tow vehicle as a result of the selection of the tow vehicle. Overall length for a Fifth Wheels is defined as the body length of the trailer excluding hitch meaning bumper to cap. The overall length for a Travel Trailer is defined as the body length of the trailer including hitch, meaning bumper to hitch/pin. It does not include rear ladder of spare tire. Optional pin boxes will affect overall length. SPRING 12/22 (REV 1)